

The City of Puyallup does not authorize or permit work on private property or outside City limits.

Work shall immediately cease in the work zone for a pedestrian spotter, available at all times, to escort pedestrians around the work area.

- 1 FOR TWO-WAY TRAFFIC WORK ZONES
- 2 FLAGGERS SHALL REMAIN IN RADIO CONTACT
AT ALL TIMES
- 3 TRAFFIC CONTROL DEVICES SHALL BE 28"
RETROREFLECTIVE CONES
- 4 USE "BE PREPARED TO STOP" SIGN BETWEEN
"FLAGGER AHEAD" AND "LANE CLOSED AHEAD" SIGNS
ON HIGH VOLUME ROADS, SUCH AS:
43RD AVE SE, 9TH ST SW, 5TH ST SW, SHAW RD,
AND OTHER STREETS WITH COMPARABLE VOLUMES
- 5 SIGN SPACING SHALL BE 350 FEET WHEN
SPEED LIMIT IS GREATER THAN 30 MPH
- 6 SIGN SPACING SHALL BE 100 FEET WHEN
SPEED LIMIT IS 30 MPH OR LESS
- 7 CALL COMM CENTER DAY OF CLOSURE 841-5431
7.1 CLOSURE FOR WEEKDAYS ONLY
7.2 TIMES: 9:00 AM TO 3:00 PM
- 8 DISTANCE BETWEEN CONES EQUALS SPEED LIMIT
IN UNITS OF FEET

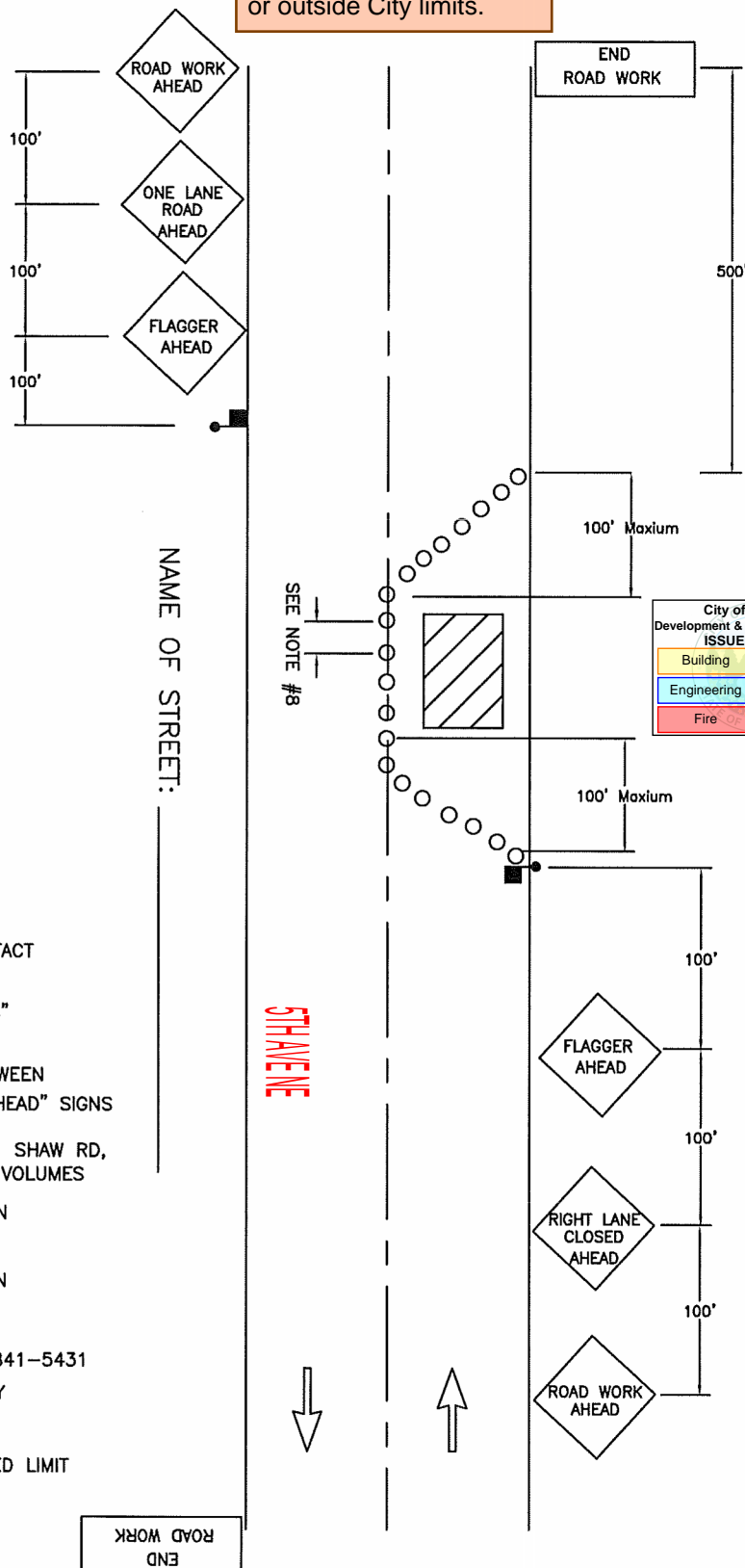

**CITY OF
PUYALLUP
TRAFFIC
ENGINEERING
DIVISION**

LANE CLOSURE ON TWO-LANE ROAD USING FLAGGERS

DRAWN J. HUNTER	PLOTTING SCALE NTS/ 1=1	DATE APPROVED 04-03	REVISED 09-30-09	TCP STANDARD NO. 7
FILE NAME I:\DRAWINGS\PUBLIC WORKS\TRAFFIC\TCP	CHECKED BY M. FORD	REVISED BY S. TANDLE		