

Welcome Ramp Systems, Inc.
Component Aluminum Ramp System
for Safe, User-Friendly Building Access.
www.welcomerampsystems.com

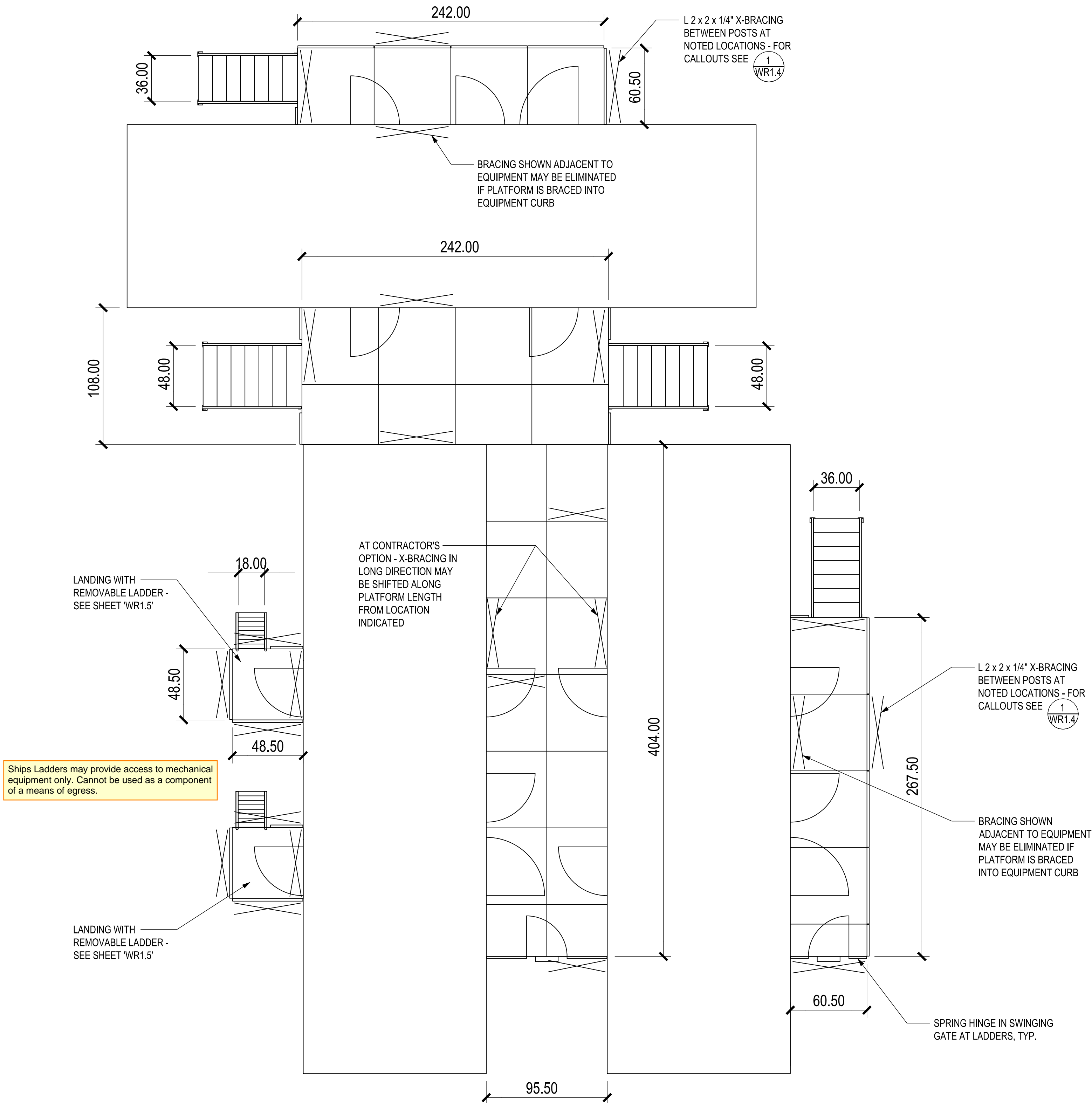

WEST GENERATOR YARD

N.T.S.

1

CODE COMPLIANCE

- 2021 INTERNATIONAL BUILDING CODE CH. 10 COMPLIANT.
- MAX RAMP SLOPE = 1:12 (VERT / HORIZ)
- CROSS SLOPE, MAX = 2%
- STAIR RISE = 7" MAX, 4" MIN
- DESIGN LOADING:
 - DECK / RAMP 100 PSF
 - STAIR RAMP 300 LBS CONC. PER TREAD
 - RAILING 50 PLF OR 200 LBS CONC.
 - LATERAL LOAD 600# PEDESTRIAN DYNAMIC LOADING PER 30-FT RAMP
- WIND LOAD 104 MPH, EXP B, Kzt=1.0
- SEISMIC LOAD Sds=1.006
SITE CLASS = D- DEFAULT
- DOOR CLEARANCE AS REQUIRED BY IBC
- STANDARD 3 LINE RAIL FOR COMPONENTS 30" OR LESS FROM GRADE TO WALKING SURFACE OF RAMP, LANDING OR STAIR.
- 42" VERTICAL PICKET GUARDRAIL FOR COMPONENTS OVER 30" FROM GRADE TO WALKING SURFACE OF RAMP, LANDING OR STAIR.
- GRASPABLE CONTINUOUS HANDRAIL AT 36" OFF RAMP, PLATFORM, OR STAIR NOSING. INSTALL BOTH SIDES OF STAIRS AND RAMP.
- HANDRAILS TO EXTEND 12" HORIZONTALLY OVER WALKING SURFACE AND RETURN TO WALL OR RAILING COLUMN.
- RAMP AND RAILINGS TO HAVE CURBS WHICH DO NOT ALLOW PASSAGE OF 4" SPHERE WHERE ORIGINAL POSITION OF SPHERE IS WITHIN 4" OF THE WALKING SURFACE.
- LEADING EDGE OF ALL STAIR TREADS AND PLATFORMS AT STAIRS TO HAVE A 2-INCH WIDE CONTRASTING STRIPE ACROSS FULL WIDTH OF STAIR.
- FOOTING INFORMATION:
12" x 12" x 1-1/2" PRESSURE TREATED WOOD OR 12" x 12" PRE-MANUFACTURED ABS PAD REQUIRE UNDER ALL ADJUSTABLE LEGS. WHERE ONE COLUMN SUPPORTS FOUR CORNERS OF P55 LANDING OR ONE COLUMN SUPPORTS TWO CORNERS OF P65 LANDING USE 16" x 16" PAD

GENERAL NOTES

- THESE PLANS AND SPECIFICATIONS ARE NOT VALID FOR ANY OTHER ASSEMBLY THAN PRODUCTS PRODUCED BY WELCOME RAMP SYSTEMS, INC. PRODUCTS PRODUCED THE STANDARDS SET FORTH IN THESE DRAWINGS AND ACCOMPANYING DESIGN.
- THE RAMP SYSTEM, STAIRS AND PLATFORM HAVE BEEN DESIGNED TO MEET IBC REQUIREMENTS.
- RAMP DESIGN LIMITS: THE SLOPE SHALL BE 1:12 THE MAXIMUM CROSS SLOPE SHALL BE LESS THAN 2%. THE MAXIMUM RUN SHALL BE 30". THE MAXIMUM HEIGHT WITHOUT ADDITIONAL ENGINEERING JUSTIFICATION SHALL BE 48" FROM THE PLATFORM TO FINISHED GRADE.
- WELCOME RAMPS, PLATFORMS, AND STAIRS ARE DESIGNED TO BE ANCHORED INTO ADJACENT MODULAR BUILDING AS WELL AS TO BE FULLY INDEPENDENT FREE STANDING CONDITIONS.
- DETAILS SHOW MOST USED HEIGHTS, OTHER HEIGHTS ARE SIMILAR.

MATERIAL SPECIFICATIONS

PLANKING:

- THIS DESIGN IS LIMITED TO GALVANIZED METAL PLANKING MATERIALS. ALUMINUM PLANKING MAY BE PROVIDED IF REVIEWED AND APPROVED.
- RAMP: ALL PLANKING SHALL BE 13 GA 12" W x 1 1/2" DEEP.
- PLATFORM: ALL PLANKING SHALL BE 13 GA 12" W x 1 1/2" D. SEE PLAN FOR LENGTH.
- STAIRS: ALL PLANKING SHALL BE 11 GA 12" W x 2" DEEP.

LEGS:

- LEVELING FEET ASSUMED TO BE PLACED ON SUITABLE FIRM BEARING GROUND.
- LEG MATERIAL SHALL BE 2" SQUARE x 0.125" ALUM. TUBING.
- LEG POCKETS SHALL BE 2.25" SQ x 0.125" ALUM. TUBING.
- ADJUSTING BOLT - 3/8" x 2 1/4" GRADE 5 CAP SCREW W/ NYLON LOCK NUT, ZINC PLATED.

ALUMINUM:

- 1 1/2" DIA ALUM. HANDRAIL SHALL BE 6063-T5 WITH A YIELD STRESS OF 16 KSI.
- ALL OTHER ALUMINUM PARTS SHALL BE 6061-T6 ALUMINUM WITH A YIELD STRESS OF 35 KSI.

HAND RAILS:

- STANDARD HANDRAIL (W/O PICKETS) IS ALLOWED ON FINISHED PLATFORM HEIGHTS OF 30" AND LESS. ALL PLATFORM HEIGHTS ABOVE 30" SHALL USE PICKET STYLE HANDRAILS.
- STAIRS AND RAMPS: USE 1 1/2" SQ x 5/32" THICK WALLED TUBING FOR POSTS AND HORIZONTAL RAILS EXCEPT FOR THE TOP 1-1/2" DIA ROUND HANDRAIL.
- PLATFORM: USE 1 1/2" SQ x 5/32" THICK WALLED TUBING FOR POSTS AND USE 1-1/2" SQ x 5/32" FOR HORIZONTAL RAILS.
- HEIGHT, TOP OF GRIPPING SURFACES OF HANDRAIL SHALL BE 36 INCHES VERTICALLY ABOVE WALKING SURFACES.

WELDING:

- ALL REFERENCES TO WELDING ON PLAN SET REFER TO IN-PLANT FABRICATION. NO ON-SITE WELDING IS REQUIRED.
- FABRICATION PLANT WELDING BY WELDERS CERTIFIED BY A THIRD PARTY INSPECTOR AND IN ACCORDANCE WITH ANSI / AWS D1.2 CODE.
- WELD SIZES ARE EQUAL OR LARGER THAN THE ELEMENT BEING WELDED.
- WELDING IS ALL AROUND UNLESS OTHERWISE NOTED. CARE SHALL BE TAKEN TO AVOID EXCESS WARPING OF WELDED ELEMENTS.
- CONTRACTOR TO CERTIFY ASSEMBLED PARTS ARE PER THE DRAWINGS PER IBC 1704.2.5.

BOLTS:

- ALL BOLTS SHALL BE GRADE 5 ZINC PLATED, UNLESS OTHERWISE SPECIFIED.
- PROVIDE LOCKING WASHERS UNDER ALL NUTS AND ANCHOR BOLTS UNLESS OTHERWISE SPECIFIED.
- HIGH STRENGTH BOLTS ARE DESIGNED AT LESS THAN 50% CAPACITY FOR ADDITIONAL FACTOR OF SAFETY AND DO NOT REQUIRE SPECIAL INSPECTION.

TEKS SCREWS:

- ZINC PLATED #10 x 1 1/4", SELF TAPPING.

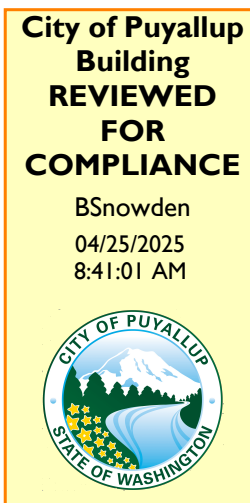
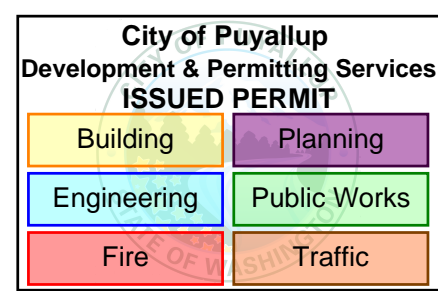

The approved construction plans, documents, and all engineering must be posted on the job at all inspections in a visible and readily accessible location.

Full sized legible color plans are required to be provided by the permittee on site for inspection.

Approval of submitted plans is not an approval of omissions or oversights by this office or non compliance with any applicable regulations of local government. The contractor is responsible for making sure that the building complies with all applicable codes and regulations of the local government.

PRCTI20250361

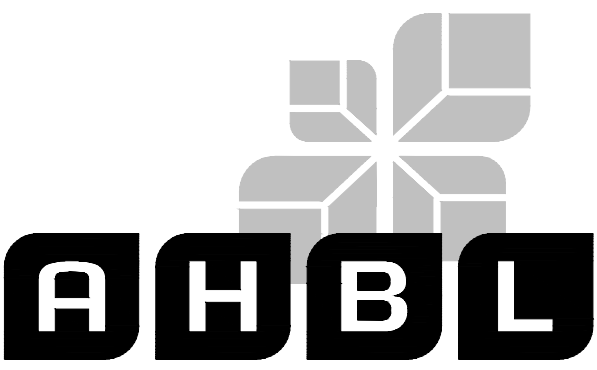

2215 North 30th Street, Suite 300, Tacoma, WA 98403
253.383.2422 TEL 253.383.2572 FAX www.ahbl.com WEB

Project Title:

CENTERIS PUYALLUP
ACCESS PLANS
DECK, RAMP &
STAIRS

Client:

WELCOME RAMP
SYSTEMS INC.

3902 B St NW Ste B, Auburn, WA 98001

Project No.

2241015.20

Issue Set & Date:

PERMIT SUBMITTAL

3.03.2025



NOTICE:
ALTERATION OF THIS DOCUMENT SHALL INVALIDATE THE PROFESSIONAL SEAL AND SIGNATURE. PUBLICATION OF THIS DOCUMENT DOES NOT CONSTITUTE FIRM REVIEWED OR ENDORSEMENT. THIS DOCUMENT IS FOR USE ONLY FOR THE PROJECT IDENTIFIED IN THE TITLE BLOCK AND IS NOT TO BE USED FOR REPAIR, REDESIGN, OR OTHER TO THAT PROJECT OR FOR ANY OTHER PROJECT.

A

A

A

PLAN REVIEW RESPONSE 4/17/2025

Revisions:

Sheet Title:

WEST GENERATOR
YARD ACCESS
PLATFORM PLANS

Designed by: DAR Drawn by: KJK Checked by: ADM

Sheet No.

WR1.1

1 of 7 Sheets

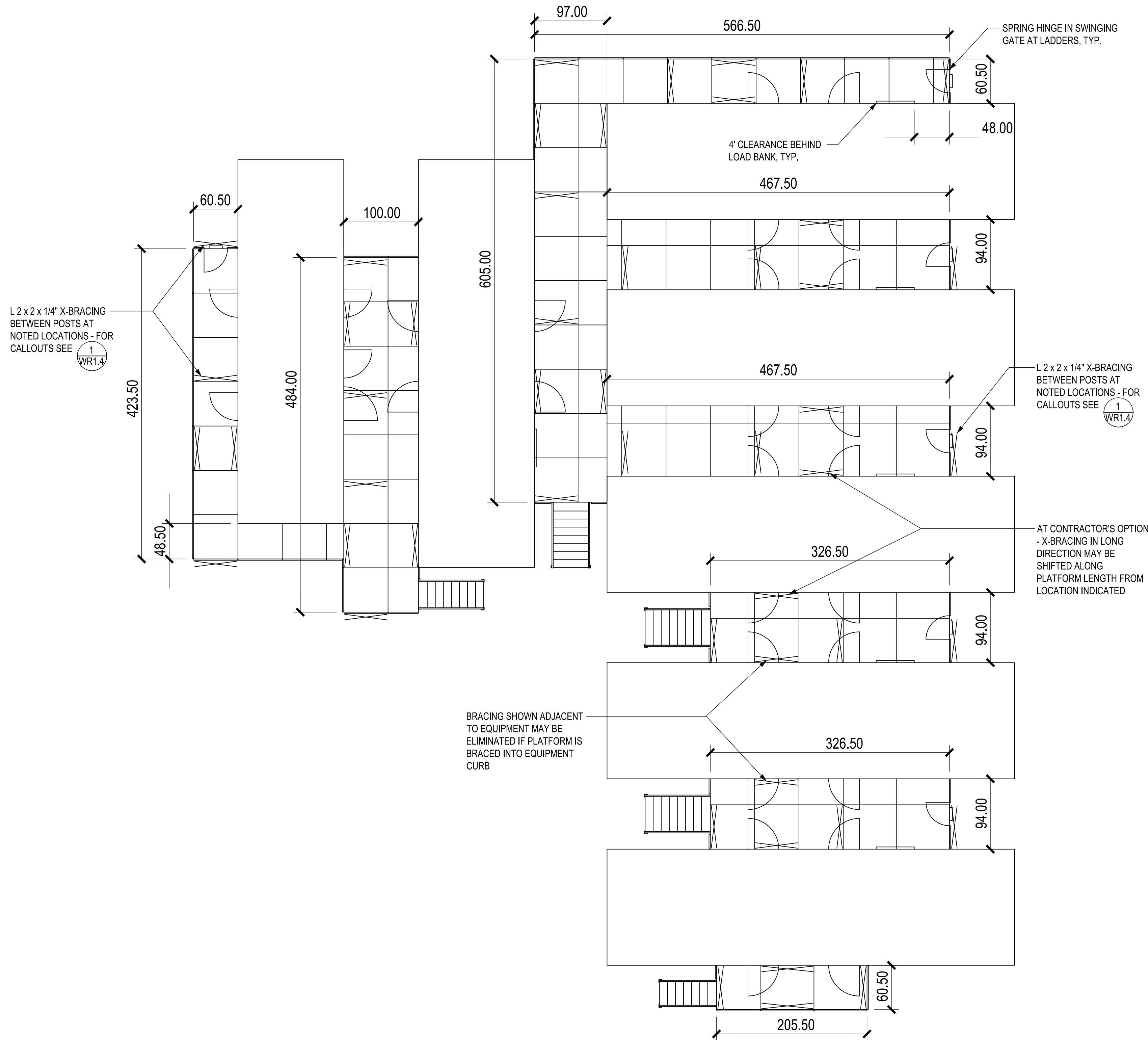

CODE COMPLIANCE

- 2021 INTERNATIONAL BUILDING CODE CH. 10 COMPLIANT.
- MAX RAMP SLOPE = 1:12 (VERT / HORIZ)
- CROSS SLOPE, MAX = 2%
- STAIR RISE = 7" MAX, 4" MIN
- DESIGN LOADING:
 - DECK / RAMP 100 PSF
 - STAIR TREAD 300 LBS CONC. PER TREAD
 - RAILING 50 PLF OR 200 LBS CONC.
 - LATERAL LOAD 600# PEDESTRIAN DYNAMIC LOADING PER 30-FT RAMP
 - WIND LOAD 104 MPH, EXP B, Kzt=1.0
 - SEISMIC LOAD Sds=1.006 SITE CLASS = D-DEFAULT
- DOOR CLEARANCE AS REQUIRED BY IBC
- STANDARD 3 LINE RAIL FOR COMPONENTS 30" OR LESS FROM GRADE TO WALKING SURFACE OF RAMP, LANDING OR STAIR.
- 42" VERTICAL PICKET GUARDRAIL FOR COMPONENTS OVER 30" FROM GRADE TO WALKING SURFACE OF RAMP, LANDING OR STAIR.
- GRASPABLE CONTINUOUS HANDRAIL AT 36" OFF RAMP, PLATFORM, OR STAIR NOSING. INSTALL BOTH SIDES OF STAIRS AND RAMP.
- HANDRAILS TO EXTEND 12" HORIZONTALLY OVER WALKING SURFACE AND RETURN TO WALL OR RAILING COLUMN.
- RAMP AND RAILINGS TO HAVE CURBS WHICH DO NOT ALLOW PASSAGE OF 4" SPHERE WHERE ORIGINAL POSITION OF SPHERE IS WITHIN 4" OF THE WALKING SURFACE.
- LEADING EDGE OF ALL STAIR TREADS AND PLATFORMS AT STAIRS TO HAVE A 2-INCH WIDE CONTRASTING STRIPE ACROSS FULL WIDTH OF STAIR.
- FOOTING INFORMATION:
12" x 12" x 1-1/2" PRESSURE TREATED WOOD OR 12" x 12" PRE-MANUFACTURED ABS PAD REQUIRE UNDER ALL ADJUSTABLE LEGS. WHERE ONE COLUMN SUPPORTS FOUR CORNERS OF P65 LANDING OR ONE COLUMN SUPPORTS TWO CORNERS OF P65 LANDING USE 16" x 16" PAD

GENERAL NOTES

- THESE PLANS AND SPECIFICATIONS ARE NOT VALID FOR ANY OTHER ASSEMBLY THAN PRODUCTS PRODUCED BY WELCOME RAMP SYSTEMS, INC. PRODUCTS PRODUCED THE STANDARDS SET FORTH IN THESE DRAWINGS AND ACCOMPANYING DESIGN.
- THE RAMP SYSTEM, STAIRS AND PLATFORM HAVE BEEN DESIGNED TO MEET IBC REQUIREMENTS.
- RAMP DESIGN LIMITS: THE SLOPE SHALL BE 1:12 THE MAXIMUM CROSS SLOPE SHALL BE LESS THAN 2%. THE MAXIMUM RUN SHALL BE 30". THE MAXIMUM HEIGHT WITHOUT ADDITIONAL ENGINEERING JUSTIFICATION SHALL BE 48" FROM THE PLATFORM TO FINISHED GRADE.
- WELCOME RAMPS, PLATFORMS, AND STAIRS ARE DESIGNED TO BE ANCHORED INTO ADJACENT MODULAR BUILDING AS WELL AS TO BE FULLY INDEPENDENT FREE STANDING CONDITIONS.
- DETAILS SHOW MOST USED HEIGHTS, OTHER HEIGHTS ARE SIMILAR.

MATERIAL SPECIFICATIONS

- PLANKING:**
- THIS DESIGN IS LIMITED TO GALVANIZED METAL PLANKING MATERIALS. ALUMINUM PLANKING MAY BE PROVIDED IF REVIEWED AND APPROVED.
 - RAMP: ALL PLANKING SHALL BE 13 GA 12" W x 1 1/2" DEEP.
 - PLATFORM: ALL PLANKING SHALL BE 13 GA 12" W x 1 1/2" D. SEE PLAN FOR LENGTH.
 - STAIRS: ALL PLANKING SHALL BE 11 GA 12" W x 2" DEEP.

- LEGS:**
- LEVELING FEET ASSUMED TO BE PLACED ON SUITABLE FIRM BEARING GROUND.
 - LEG MATERIAL SHALL BE 2" SQUARE x 0.125" ALUM. TUBING.
 - LEG POCKETS SHALL BE 2.25" SQ x 0.125" ALUM. TUBING.
 - ADJUSTING BOLT - 3/8" x 2 1/4" GRADE 5 CAP SCREW W/ NYLON LOCK NUT, ZINC PLATED.

- ALUMINUM:**
- 1 1/2" DIA ALUM. HANDRAIL SHALL BE 6063-T5 WITH A YIELD STRESS OF 16 KSI.
 - ALL OTHER ALUMINUM PARTS SHALL BE 6061-T6 ALUMINUM WITH A YIELD STRESS OF 35 KSI.

- HAND RAILS:**
- STANDARD HANDRAIL (W/O PICKETS) IS ALLOWED ON FINISHED PLATFORM HEIGHTS OF 30" AND LESS. ALL PLATFORM HEIGHTS ABOVE 30" SHALL USE PICKET STYLE HANDRAILS.
 - STAIRS AND RAMPS: USE 1 1/2" SQ x 5/32" THICK WALLED TUBING FOR POSTS AND HORIZONTAL RAILS EXCEPT FOR THE TOP 1-1/2" DIA ROUND HANDRAIL.
 - PLATFORM: USE 1 1/2" SQ x 5/32" THICK WALLED TUBING FOR POSTS AND USE 1-1/2" SQ x 5/32" FOR HORIZONTAL RAILS.
 - HEIGHT, TOP OF GRIPPING SURFACES OF HANDRAIL SHALL BE 36 INCHES VERTICALLY ABOVE WALKING SURFACES.

- WELDING:**
- ALL REFERENCES TO WELDING ON PLAN SET REFER TO IN-PLANT FABRICATION. NO ON-SITE WELDING IS REQUIRED.
 - FABRICATION PLANT WELDING BY WELDERS CERTIFIED BY A THIRD PARTY INSPECTOR AND IN ACCORDANCE WITH ANSI / AWS D1.2 CODE.
 - WELD SIZES ARE EQUAL OR LARGER THAN THE ELEMENT BEING WELDED.
 - WELDING IS ALL AROUND UNLESS OTHERWISE NOTED. CARE SHALL BE TAKEN TO AVOID EXCESS WARPING OF WELDED ELEMENTS.
 - FABRICATOR TO CERTIFY ASSEMBLED PARTS ARE PER THE DRAWINGS PER IBC 1704.2.5.

- BOLTS:**
- ALL BOLTS SHALL BE GRADE 5 ZINC PLATED, UNLESS OTHERWISE SPECIFIED.
 - PROVIDE LOCKING WASHERS UNDER ALL NUTS AND ANCHOR BOLTS UNLESS OTHERWISE SPECIFIED.
 - HIGH STRENGTH BOLTS ARE DESIGNED AT LESS THAN 50% CAPACITY FOR ADDITIONAL FACTOR OF SAFETY AND DO NOT REQUIRE SPECIAL INSPECTION.

- TEKS SCREWS:**
- ZINC PLATED #10 x 1 1/4", SELF TAPPING.

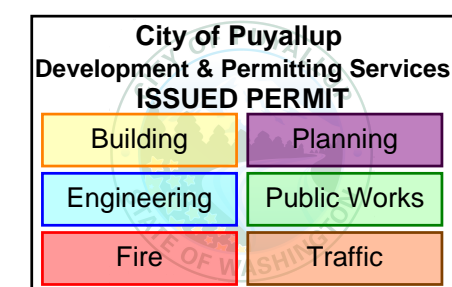

EAST GENERATOR YARD

N.T.S.

1

PRCTI20250361

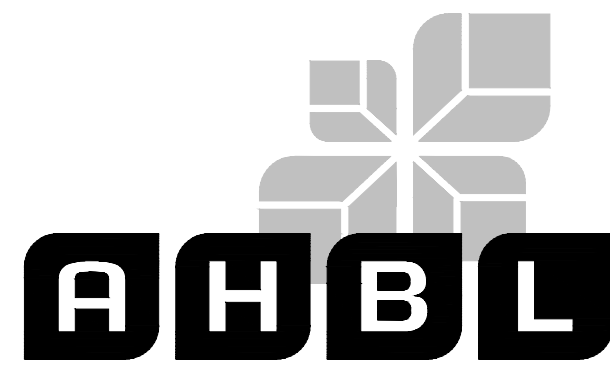

2215 North 30th Street, Suite 300, Tacoma, WA 98403
253.383.2422 TEL 253.383.2572 FAX www.ahbl.com web

Project Title:

CENTERIS PUYALLUP
ACCESS PLANS
DECK, RAMP &
STAIRS

Client:

WELCOME RAMP
SYSTEMS INC.

3902 B St NW Ste B, Auburn, WA 98001

Project No.

2241015.20

Issue Set & Date:

PERMIT SUBMITTAL

3.03.2025

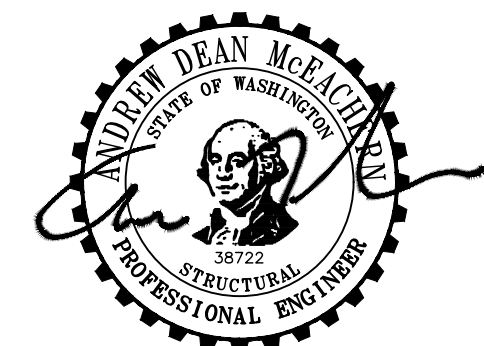

NOTICE:
ALTERATION OF THIS DOCUMENT SHALL INVALIDATE THE PROFESSIONAL SEAL AND SIGNATURE. PUBLICATION OF THIS DOCUMENT DOES NOT CONSTITUTE FIRM REVIEWED OR ENDORSED. RIGHT IN THE DOCUMENT IS FOR USE ONLY FOR THE PROJECT IDENTIFIED IN THE TITLE BLOCK AND IS NOT TO BE USED FOR REPAIR, REDESIGN OR ADDITION TO THAT PROJECT OR FOR ANY OTHER PROJECT.

PLAN REVIEW RESPONSE 4/17/2025

Revisions:

Revisions:

Revisions:

Revisions:

Sheet Title:

EAST GENERATOR
YARD ACCESS
PLATFORM PLANS

Designed by: DAR Drawn by: KJK Checked by: ADM

Sheet No.

WR1.2

2 of 7 Sheets

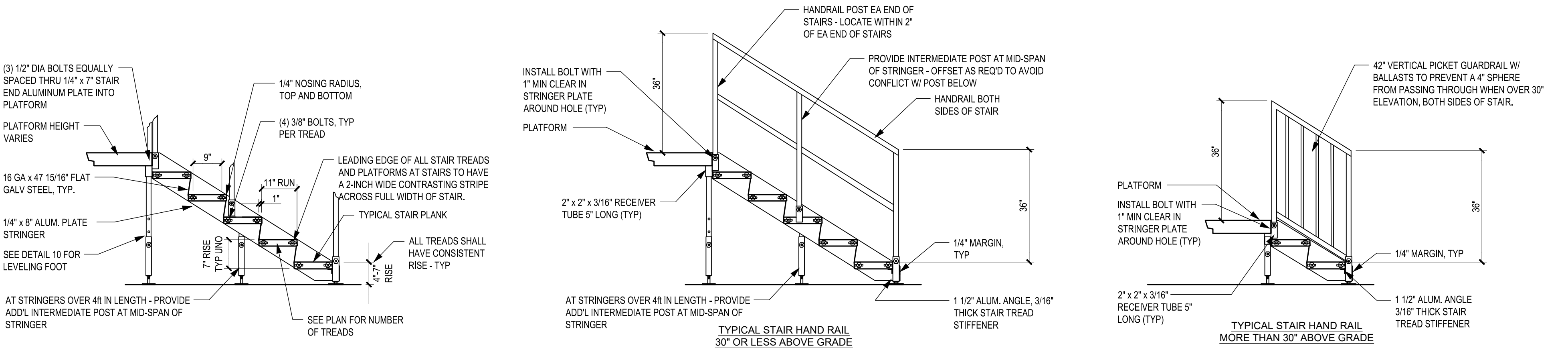

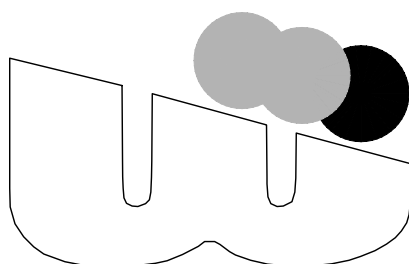

Welcome Ramp Systems, Inc.

Component Aluminum Ramp System
for Safe, User-Friendly Building Access.
www.welcomerampsystems.com

PRCTI20250361

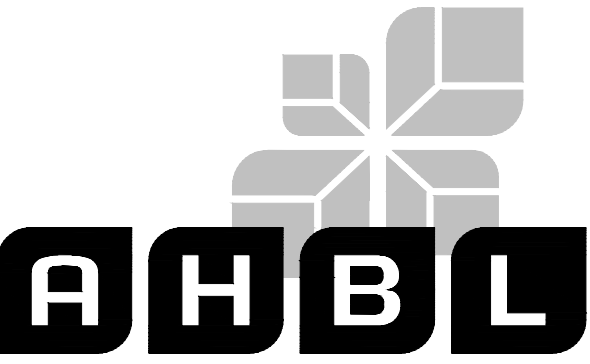

TACOMA • SEATTLE • SPOKANE • TRI-CITIES

2215 North 30th Street, Suite 300, Tacoma, WA 98403
253.383.2422 TEL 253.383.2572 FAX www.ahbl.com WEB

Project Title:

CENTERIS PUYALLUP
ACCESS PLANS
DECK, RAMP &
STAIRS

Client:

WELCOME RAMP
SYSTEMS INC.

3902 B St NW Ste B, Auburn, WA 98001

Project No.

2241015.20

Issue Set & Date:

PERMIT SUBMITTAL

3.03.2025

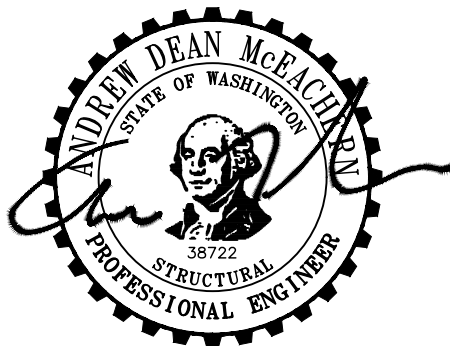

NOTICE:
ALTERATION OF THIS DOCUMENT SHALL INVALIDATE THE
PROFESSIONAL SEAL AND SIGNATURE. PUBLICATION OF THIS
DOCUMENT DOES NOT TRANSFER FROM ISSUED OWNERSHIP
RIGHTS IN THE DOCUMENT. IT IS TO BE USED ONLY FOR THE PROJECT
IDENTIFIED IN THE TITLE BLOCK AND IS NOT TO BE USED FOR
REPAIR, REDESIGN, OR ADDITION TO THAT PROJECT OR FOR ANY
OTHER PROJECT.

Revisions:

Sheet Title:

STANDARD DETAILS

Designed by: DAR Drawn by: KJK Checked by: ADM

Sheet No.

WR1.3

3 of 7 Sheets

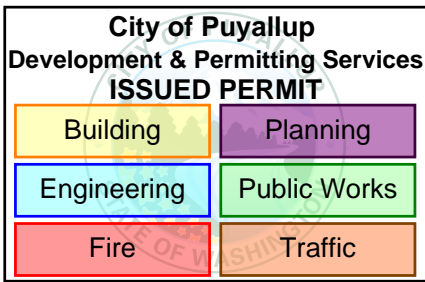

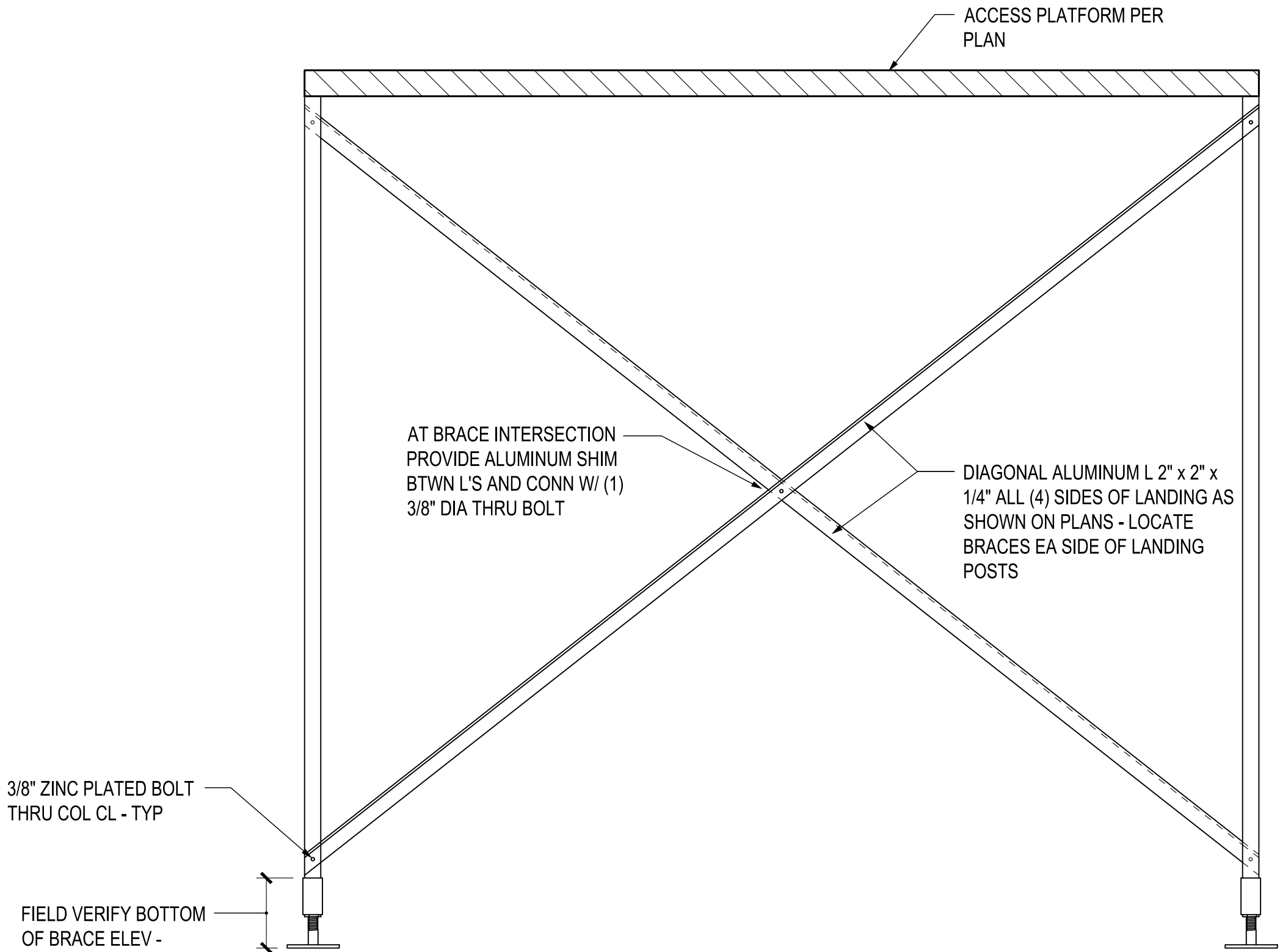

ELEVATION - TYPICAL LANDING BRACING

N.T.S.

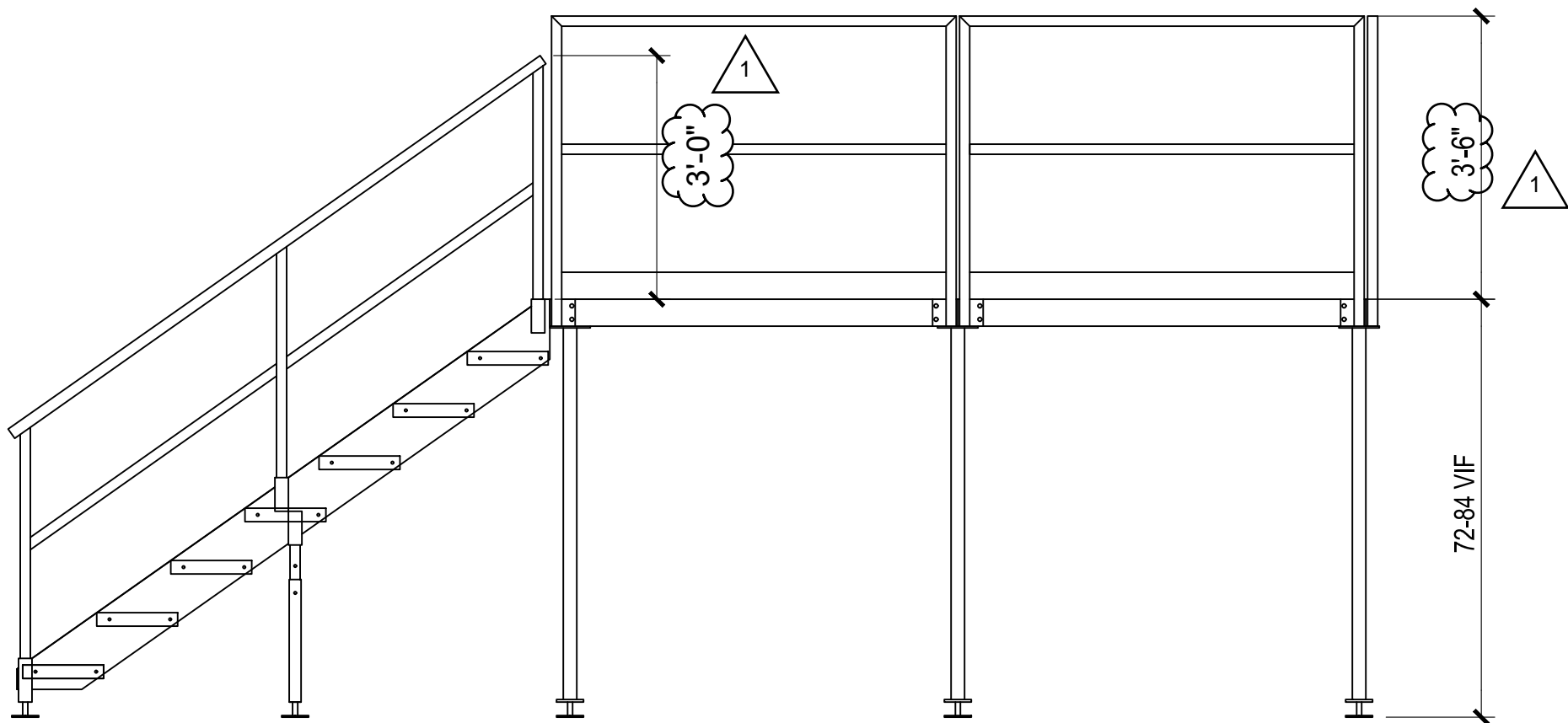

TYPICAL LANDING ELEVATION

N.T.S.

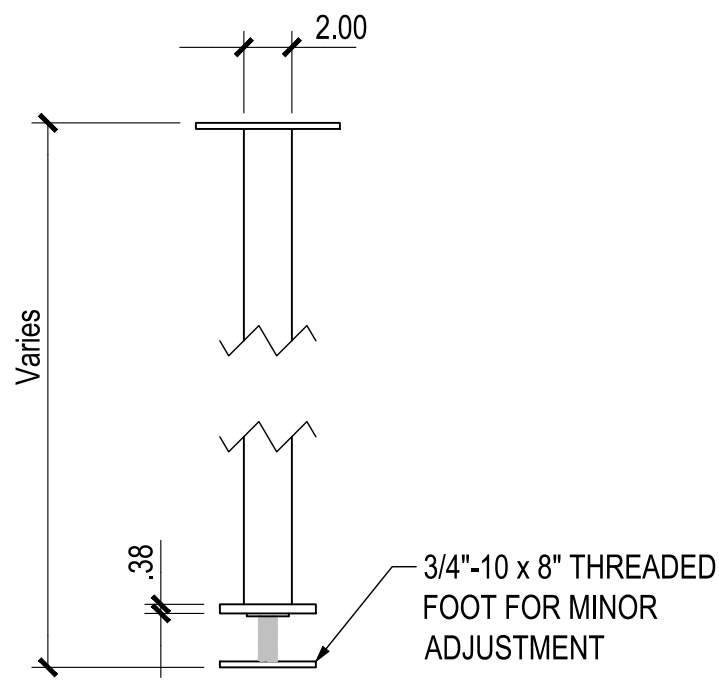

COLUMN

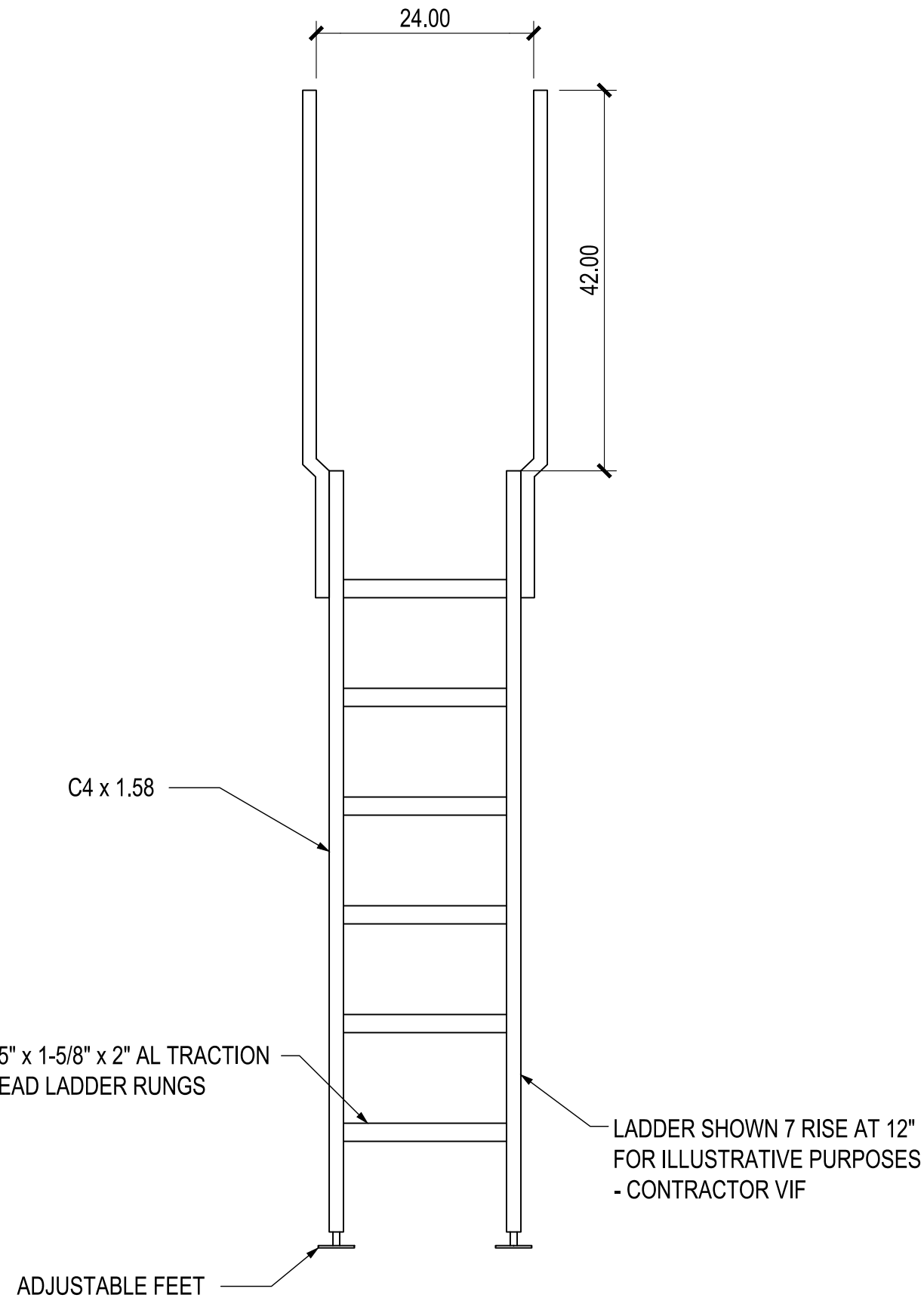

LADDER ELEVATION

N.T.S.

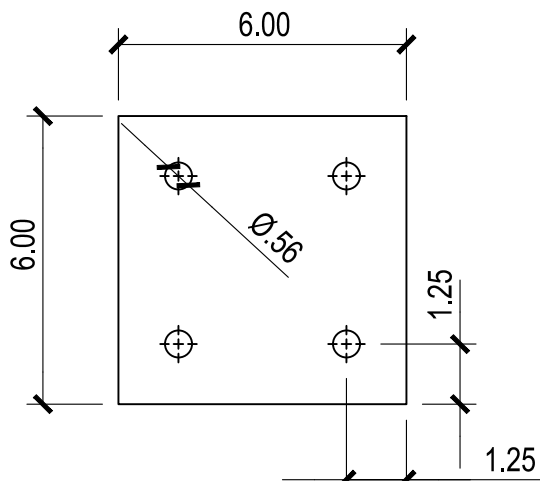

COLUMN MOUNTING PLATE

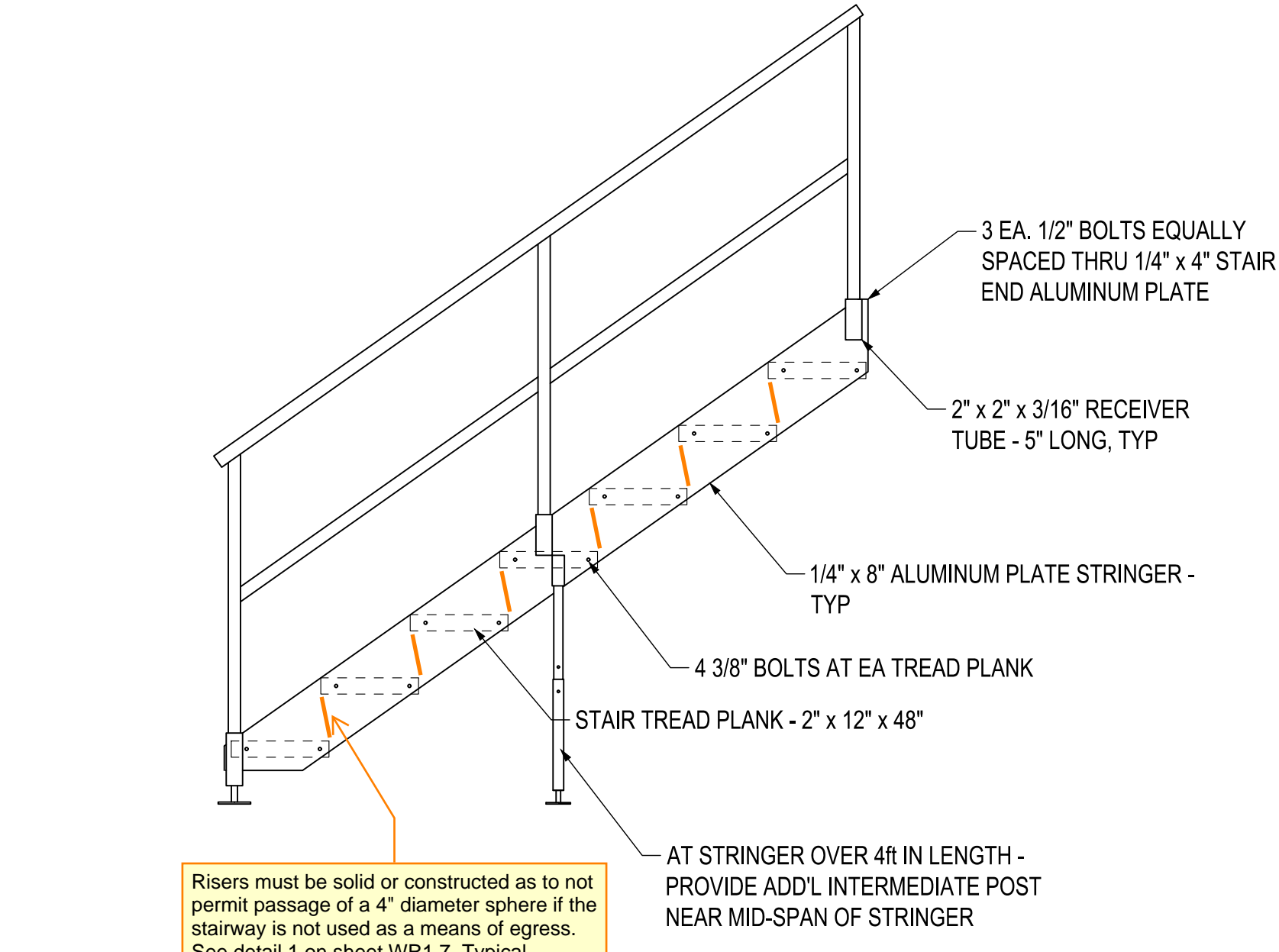

TYPICAL STAIR ELEVATION

N.T.S.

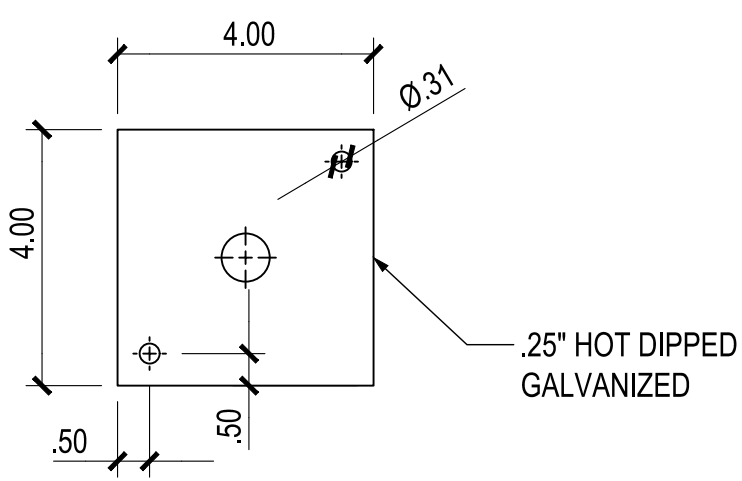

THREADED ADJUSTMENT FOOT

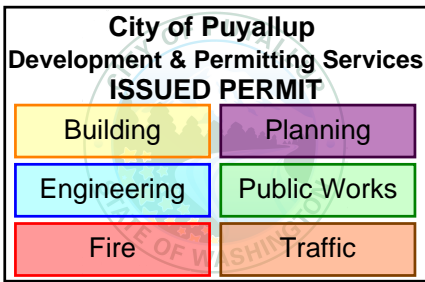

PRCTI20250361

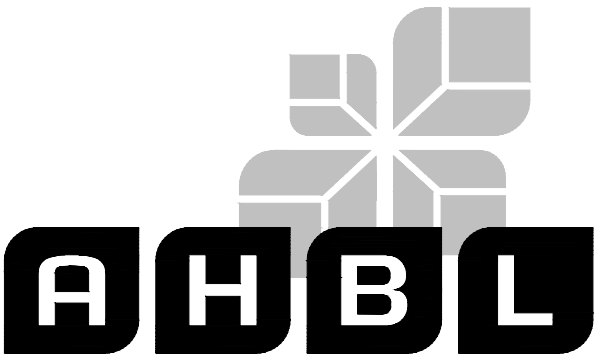

TACOMA • SEATTLE • SPOKANE • TRI-CITIES

2215 North 30th Street, Suite 300, Tacoma, WA 98403
253.383.2422 TEL 253.383.2572 FAX www.ahbl.com WEB

Project Title:

**CENTERIS PUYALLUP
ACCESS PLANS
DECK, RAMP &
STAIRS**

Client:

**WELCOME RAMP
SYSTEMS INC.**

3902 B St NW Ste B, Auburn, WA 98001

Project No.

2241015.20

Issue Set & Date:

PERMIT SUBMITTAL

3.03.2025



NOTICE:
ALTERATION OF THIS DOCUMENT SHALL INVALIDATE THE
PROFESSIONAL SEAL AND SIGNATURE. PUBLICATION OF THIS
DOCUMENT DOES NOT CONSTITUTE FIRM REVENUE OWNERSHIP.
RIGHTS IN THE DOCUMENT IS FOR USE ONLY FOR THE PROJECT
IDENTIFIED IN THE TITLE BLOCK AND IS NOT TO BE USED FOR
REPAIR, REVISION, OR ADDITION TO THAT PROJECT OR FOR ANY
OTHER PROJECT.

A

A

A

PLAN REVIEW RESPONSE 4/17/2025

Revisions:

Sheet Title:

STANDARD DETAILS

Designed by: DAR Drawn by: KJK Checked by: ADM

Sheet No.

WR1.4

4 of 7 Sheets

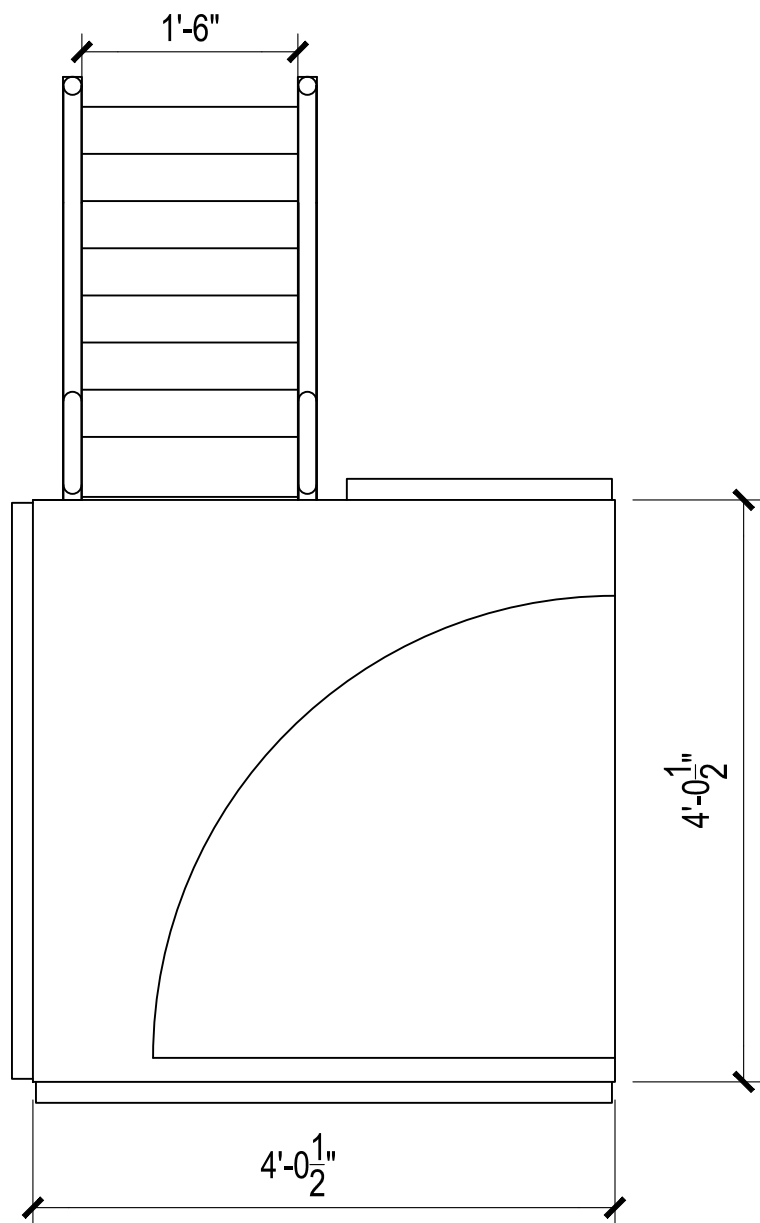

PLATFORM SUPPORT MEMBER

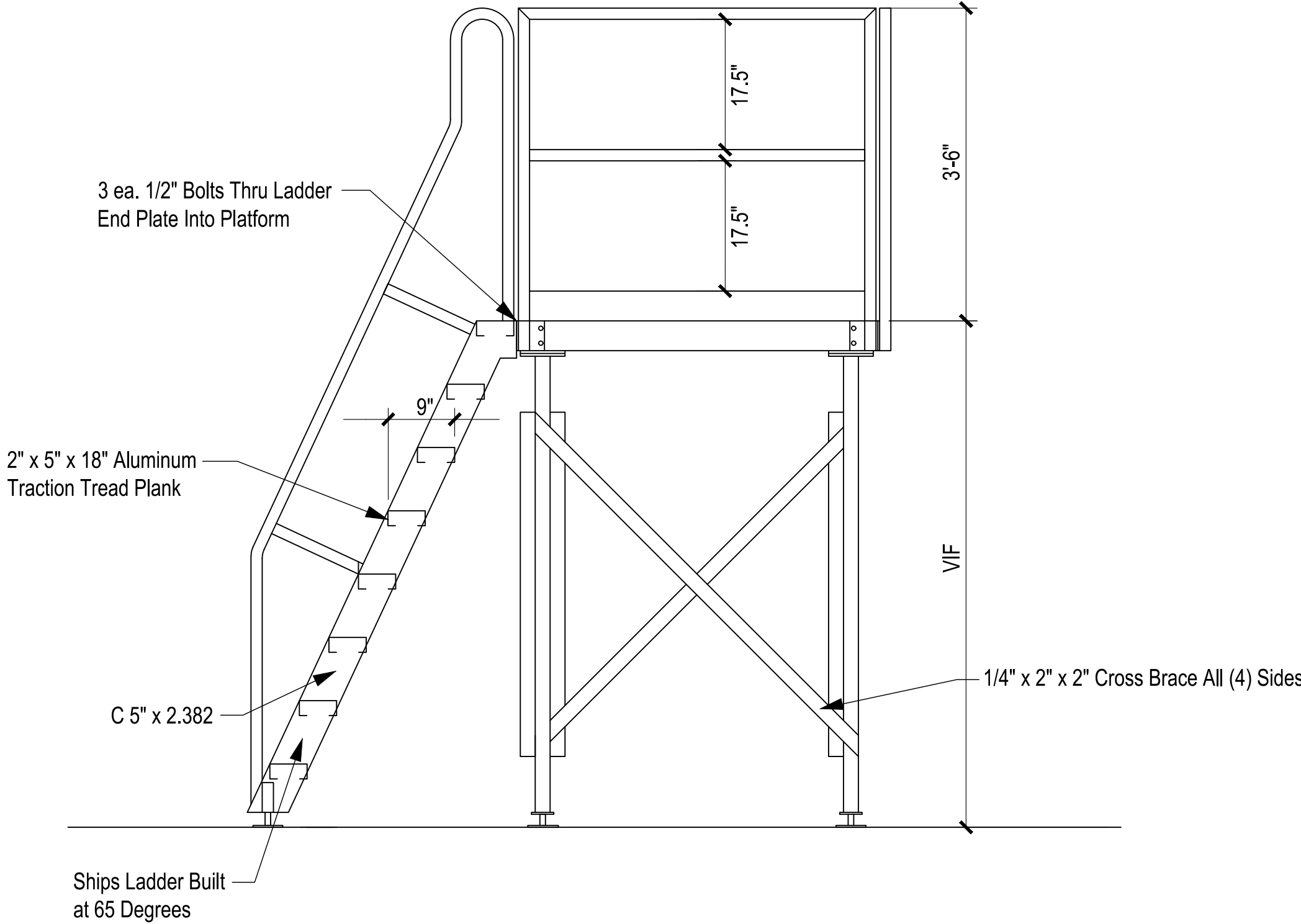
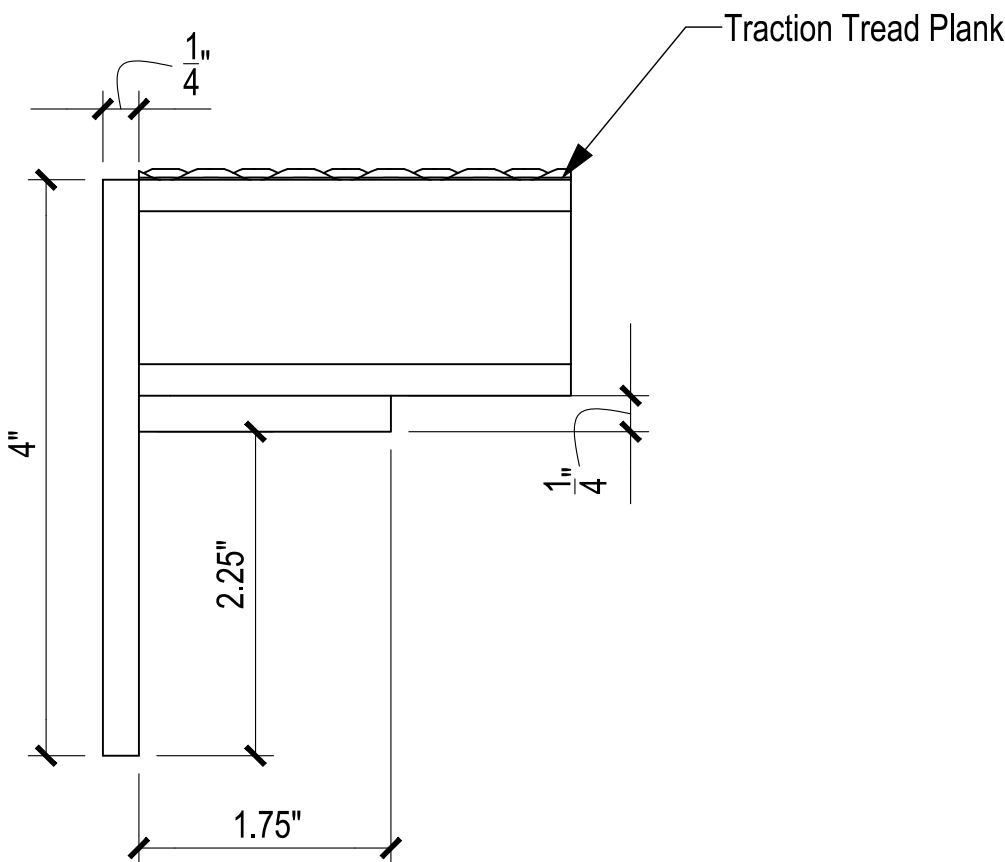

ATTACHMENT

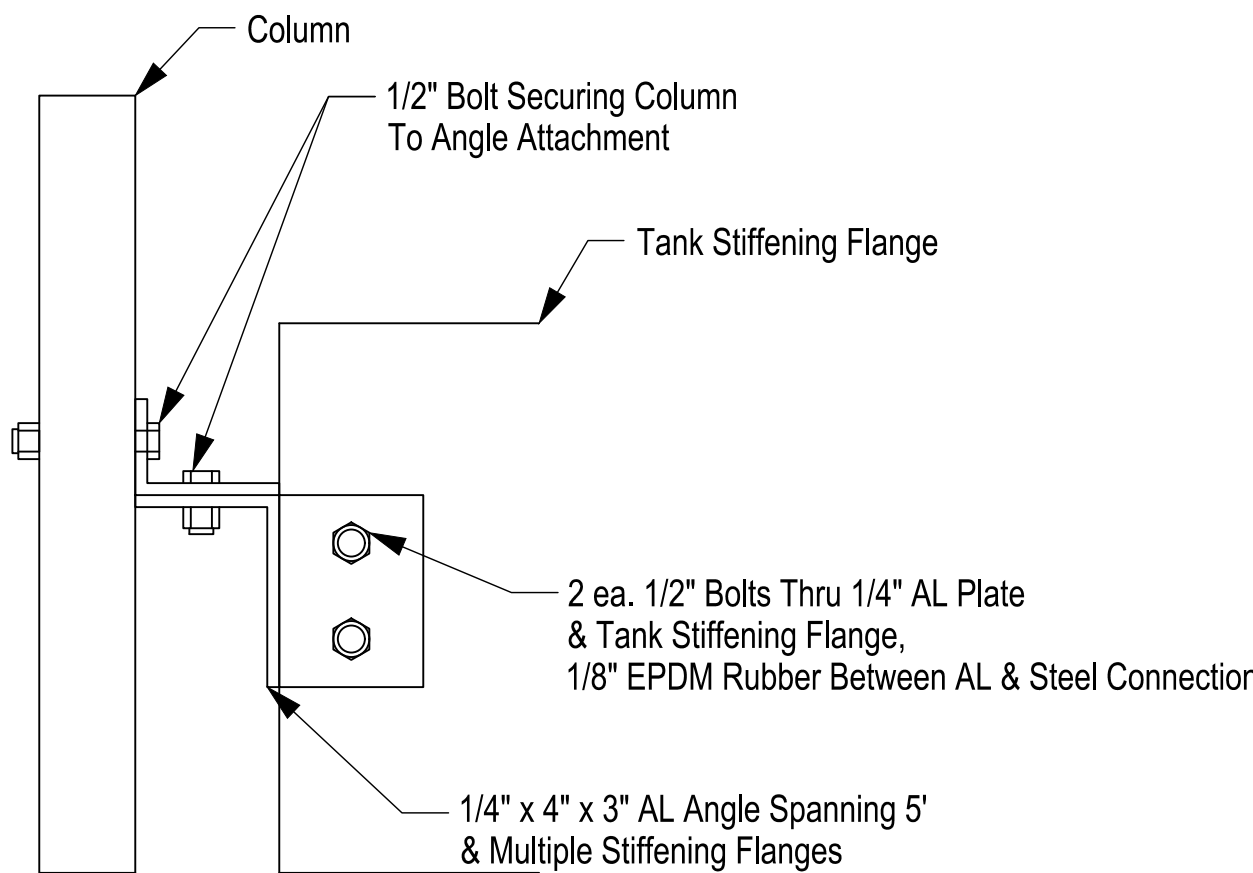

Code Compliance

1. Stair Rise = 12" Max
2. Design Loading:
 - 2.1. Platform 100 PSF Min.
 - 2.2. Stair Tread 300 LBS./Tread min.
 - 2.3. Railing 50 PLF/200 LBS. CONC.
 - 2.4. Lateral Load 600# Pedestrian Dynamic
 - 2.5. Wind Load 104 MPH, EXP B, Kzt=1.0
 - 2.6. Seismic Load Sds= 1.006, Seismic CAT. 'D'
3. Graspable Continuous Round Handrail At 36" Off Stair Nosing. Install Both Sides Of Stairs.
4. Platforms To Have 4" Toe Kick.
5. Footing Information
Pre Manufactured ABS Pads Under All Adjustable Legs On Asphalt Or Solis

Material Specifications

Planking

- Platform: All Planking Shall Be .125" 6" W x 1-1/2" Deep AL
- Ships Ladders: All Planking Shall Be .125" 5" W x 2" Deep AL

Legs

- Leveling Feet Assumed To Be Placed On Suitable Firm Bearing Ground.
- Leg Material Shall Be 2" sq. x .125" AL. Tubing.
- Leg Mounting Plates Shall Be .375" x 6" SQ AL Plate
- Adjustable Bolt- 3/8" x 2-1/4" Grade 5 Cap Screw W/Nylon Lock Nut, Zinc Plated

Aluminum

- The 1-1/2" AL. Round Handrail Shall Be 6063 T-5 With A Yield stress Of 16 KSI.
- All Other Aluminum Parts Shall Be 6061 Aluminum With A Yield Stress Of 35 KSI.

Hand Rails

- Stairs: Use 1-1/2" Sq. x .156" Thick Walled Tubing For Posts And Horizontal Rails Except The Top 1-1/2" Round Graspable Handrail.
- Platform: Use 1-1/2" Sq. x .156" Thick Walled Tubing For Posts And All Horizontal Rails.

Welding

- All References To Welding On Plan Set Refer To In-Plant Fabrication. No On Site Welding Is Required.
- Fabrication Plant Welding By Welders In Accordance With ANSI/AWS D1.2 Code.
- Weld Sizes Are To Be Equal To Or Larger Than The Element Being Welded.
- Welding Is All Around Unless Otherwise Noted. Care Is Taken To Avoid Excess Warping Of Welded Elements.
- Fabricator To Certify Assembled Parts Are Per Drawings.

Bolts

- All Bolts Shall Be Grade 5 Zinc Plated, Unless Otherwise Specified. Provide Locking Washers Under All Nuts.
- High Strength Bolts Are Designed At less Than 50% Capacity For Additional Factor Of Safety And Do Not Require Special Inspection.

Tech Screws

- Zinc Plated # 12 x 1-1/4" Pan Head

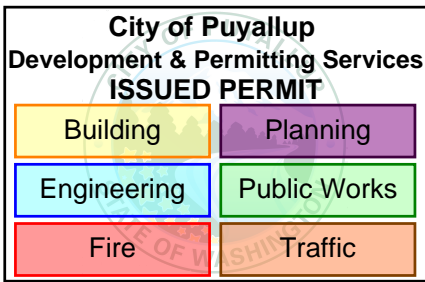

PRCTI20250361

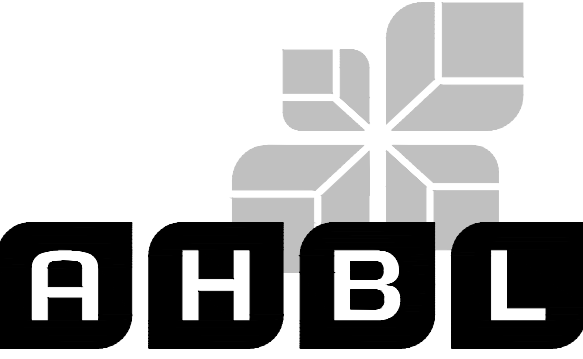

2215 North 30th Street, Suite 300, Tacoma, WA 98403
253.383.2422 TEL 253.383.2572 FAX www.ahbl.com WEB

Project Title:

CENTERIS PUYALLUP
ACCESS PLANS
DECK, RAMP &
STAIRS

Client:

WELCOME RAMP
SYSTEMS INC.

3902 B St NW Ste B, Auburn, WA 98001

Project No.

2241015.20

Issue Set & Date:

PERMIT RESUBMITTAL

2.25.2025

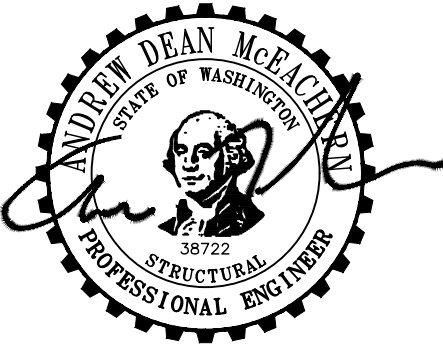

NOTICE:
ALTERATION OF THIS DOCUMENT SHALL INVALIDATE THE
PROFESSIONAL SEAL AND SIGNATURE. PUBLICATION OF THIS
DOCUMENT DOES NOT CONSTITUTE FIRM RESERVE OWNERSHIP
RIGHTS IN THE DOCUMENT. IT IS FOR USE ONLY FOR THE PROJECT
IDENTIFIED IN THE TITLE BLOCK AND IS NOT TO BE USED FOR
REPAIR, REDESIGN, OR VARIATION TO THAT PROJECT OR FOR ANY
OTHER PROJECT.

△	
△	
△	
△	
Revisions:	

Sheet Title:

LANDING PLANS AND
LADDER DETAILS

Designed by: DAR Drawn by: KJK Checked by: ADM

Sheet No.

WR1.5

5 of 7 Sheets

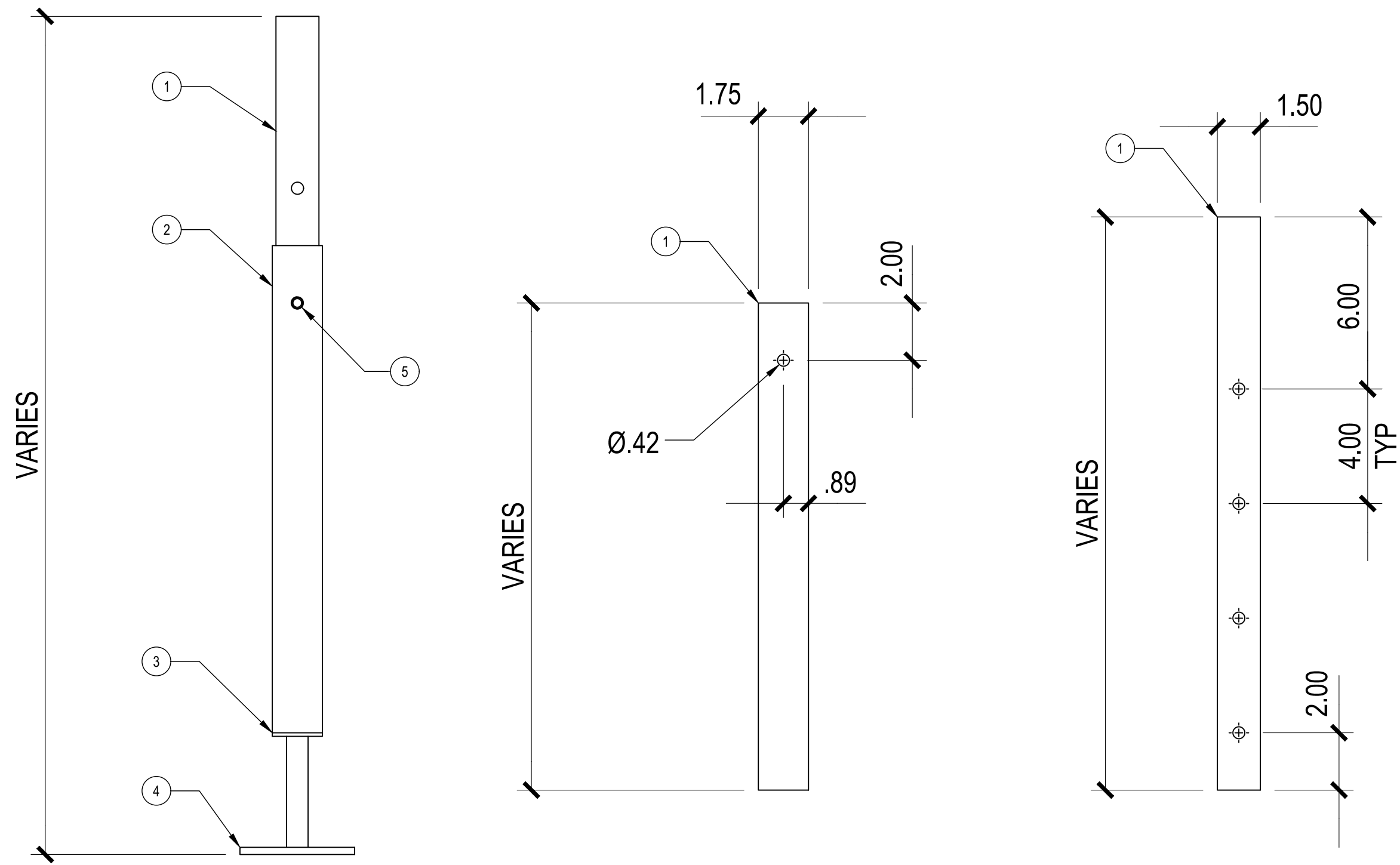

ADJUSTABLE COLUMN ASSEMBLY

TYPICAL

1

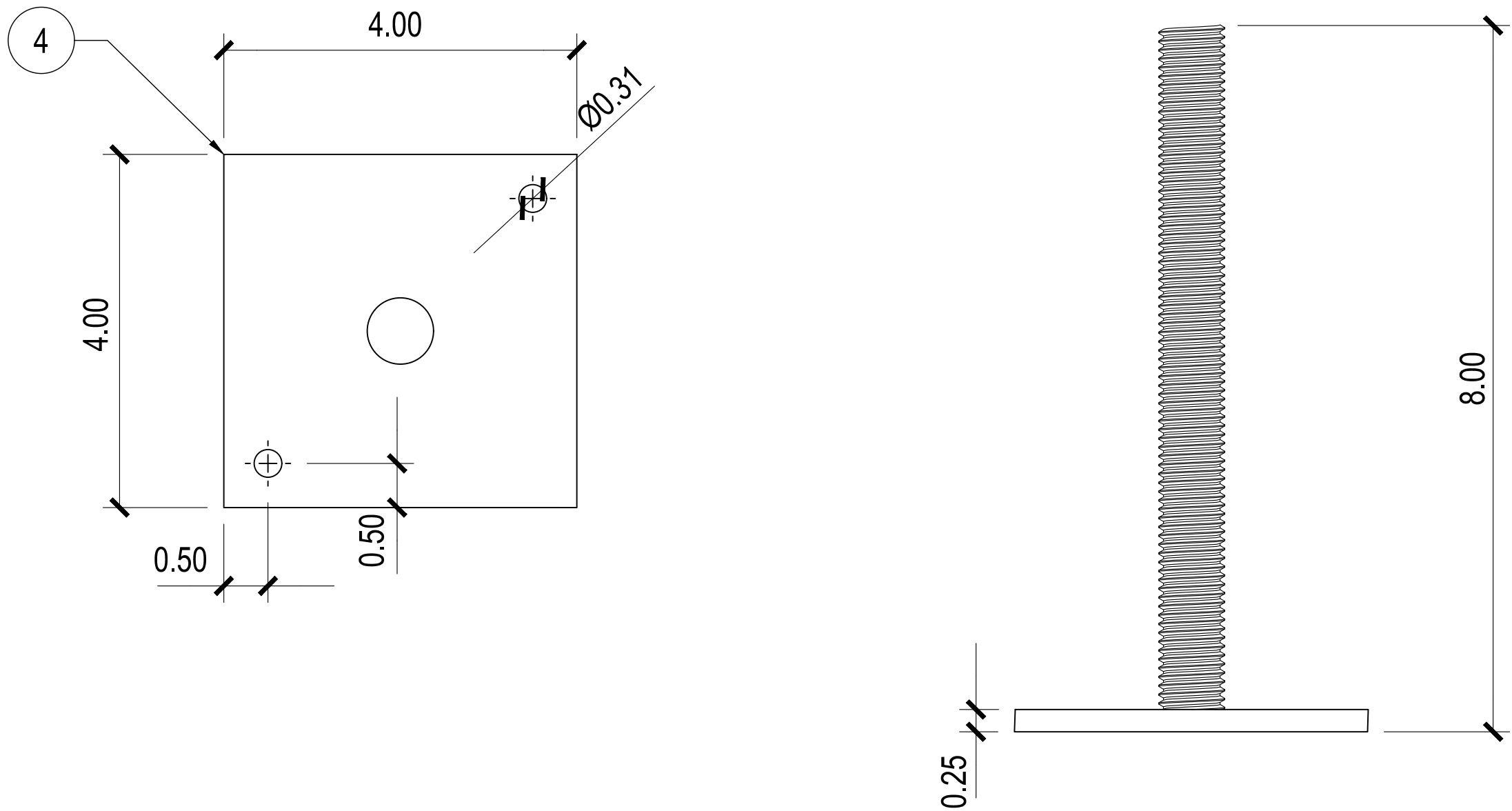

ADJUSTABLE COLUMN LEVELING FOOT

TYPICAL

2

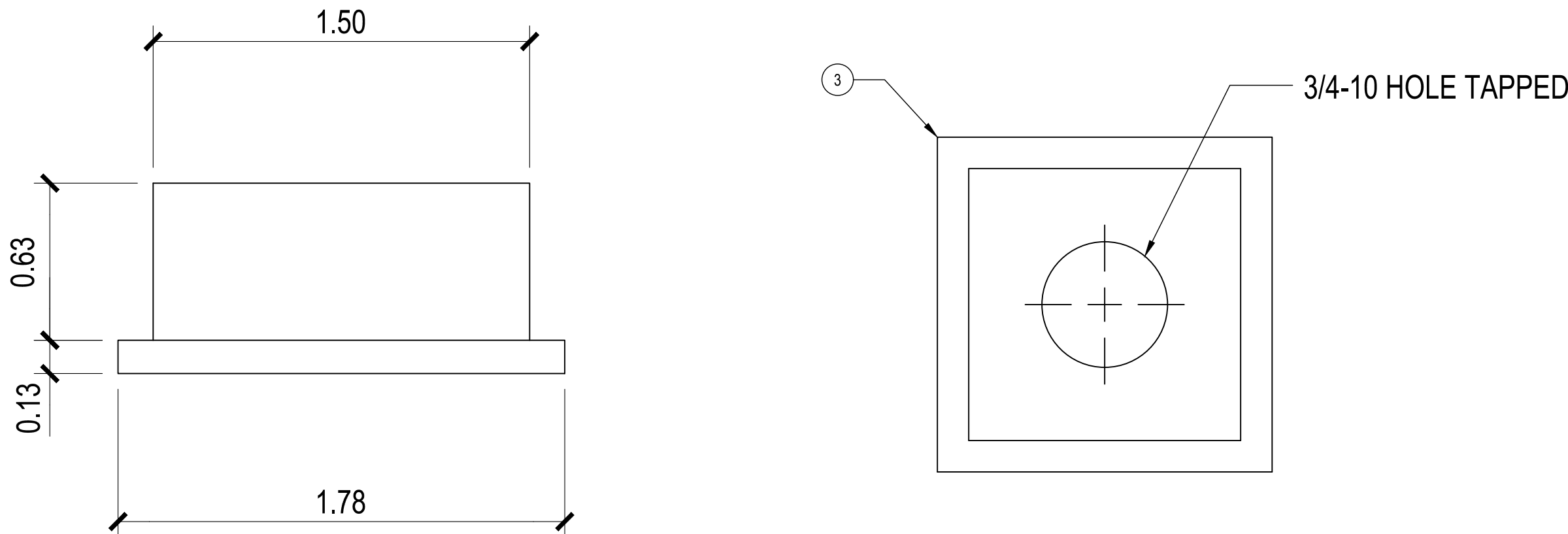

ADJUSTABLE COLUMN NUT

TYPICAL

3

ADJUSTABLE COLUMN PART SCHEDULE			A
ITEM NO.	PART NUMBER	DESCRIPTION.	QTY.
1	ADJUSTABLE COLUMN INSIDE TUBE	2" x 2" x .125" WALL SQUARE TUBE 6061 T6 ALUMINUM	1
2	ADJUSTABLE COLUMN OUTSIDE SLEEVE	2.25" x 2.25" x .125" WALL SQUARE TUBE 6061 T6 ALUMINUM	1
3	ADJUSTABLE COLUMN NUT	1.78" x 1.78" x .75" BAR STOCK 6061 T6 ALUMINUM	1
4	ADJUSTABLE COLUMN LEVELING FOOT	3/4"-10 x 8" THREADED ROD PLUG WELDED TO 1/4" x 4" SQ. STEEL PLATE HOT DIPPED GALVANIZED	1
5	ADJUSTABLE BOLT	3/8"-16 x 2-1/4" GRADE 5 ZINC HEX HEAD CAP SCREW W/ NYLON LOCKING NUT	1

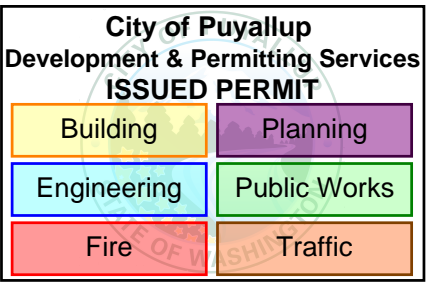

PRCTI20250361

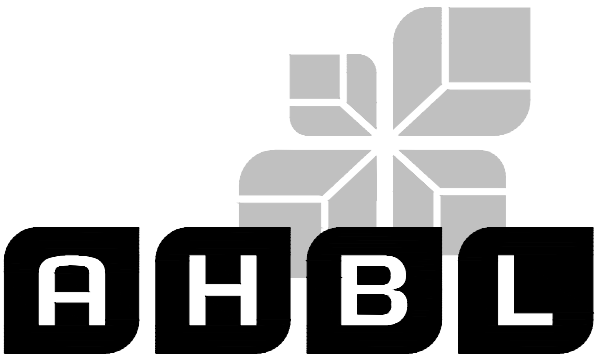

2215 North 30th Street, Suite 300, Tacoma, WA 98403
253.383.2422 TEL 253.383.2572 FAX www.ahbl.com WEB

Project Title:

CENTERIS PUYALLUP
ACCESS PLANS
DECK, RAMP &
STAIRS

Client:

WELCOME RAMP
SYSTEMS INC.

3902 B St NW Ste B, Auburn, WA 98001

Project No.

2241015.20

Issue Set & Date:

PERMIT SUBMITTAL

3.03.2025

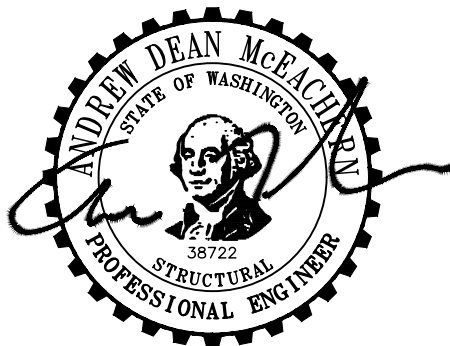

NOTICE:
ALTERATION OF THIS DOCUMENT SHALL INVALIDATE THE
PROFESSIONAL SEAL AND SIGNATURE. PUBLICATION OF THIS
DOCUMENT DOES NOT CONSTITUTE FIRM REISSUED OWNERSHIP
RIGHTS IN THE DOCUMENT. IT IS FOR USE ONLY FOR THE PROJECT
IDENTIFIED IN THE TITLE BLOCK AND IS NOT TO BE USED FOR
REPAIR, REVISION, OR ADDITION TO THAT PROJECT OR FOR ANY
OTHER PROJECT.

Revisions:

Revisions:

Revisions:

Revisions:

Sheet Title:

STANDARD DETAILS

Designed by: DAR
Drawn by: KJK
Checked by: ADM

Sheet No.

WR1.6

6 of 7 Sheets

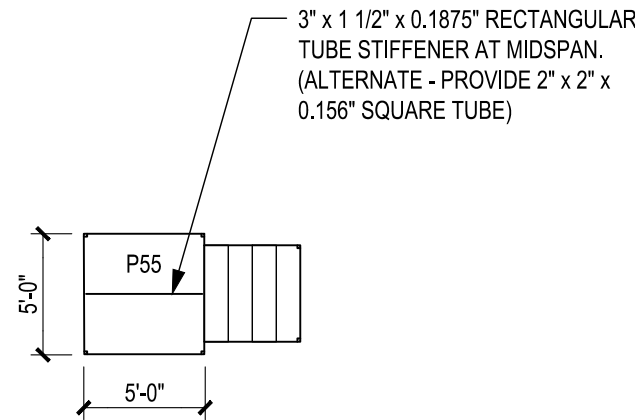

TYPICAL SINGLE DOOR CONFIGURATION

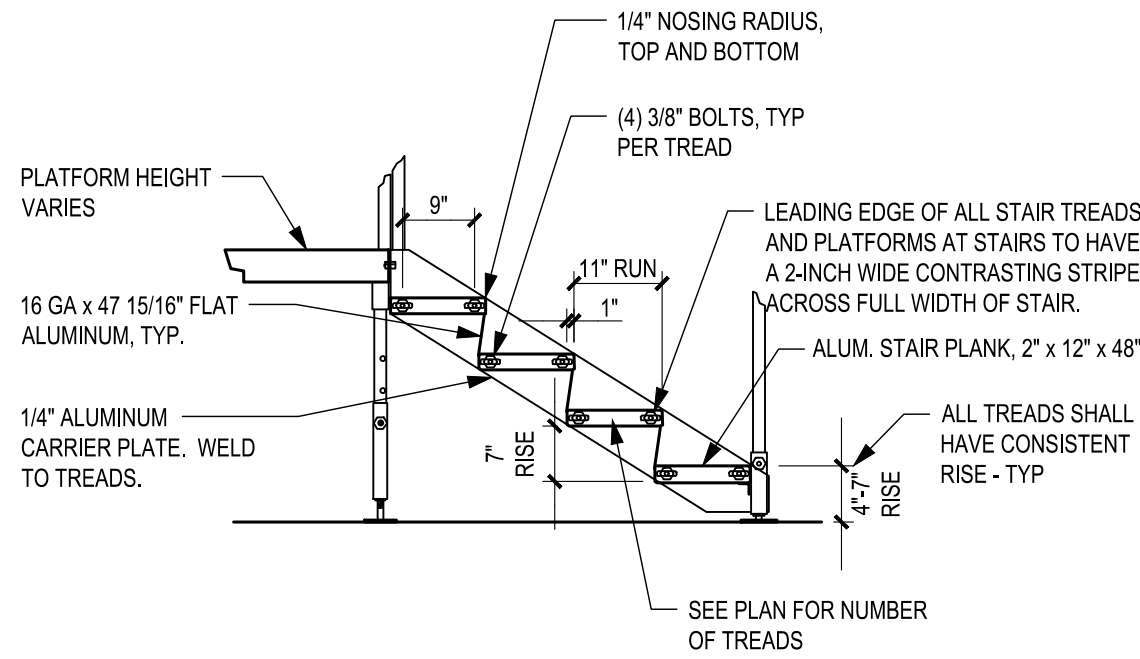

SECTION - TYPICAL STAIR

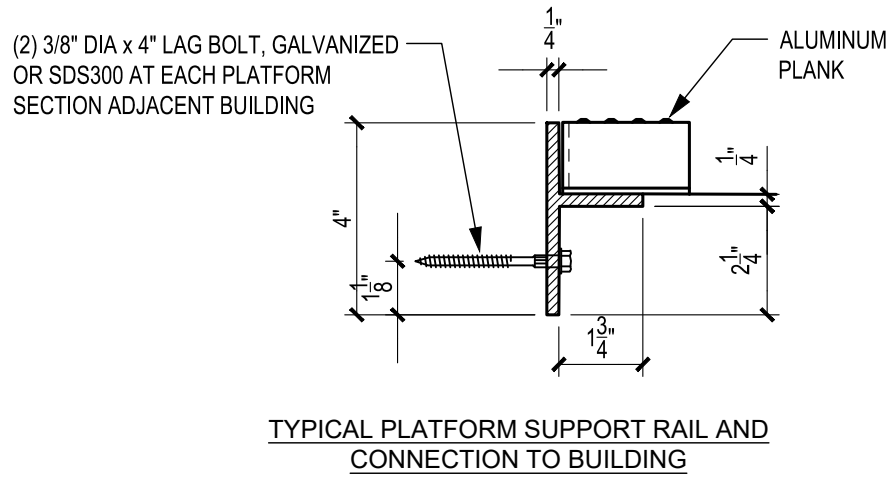

SECTION - PLATFORM SUPPORT RAIL

Welcome Ramp Systems, Inc.
Component Aluminum Ramp System
for Safe, User-Friendly Building Access.
www.welcomerampsystems.com

CODE COMPLIANCE

- INTERNATIONAL BUILDING CODE CH. 10 COMPLIANT
- CROSS SLOPE, MAX = 2%
- STAIR RISE = 7" MAX, 4" MIN
- DESIGN LOADING:
 - DECK / RAMP 100 PSF
 - STAIR TREAD 300 LBS CONC. PER TREAD

GENERAL NOTES

- THESE PLANS AND SPECIFICATIONS ARE NOT VALID FOR ANY OTHER ASSEMBLY THAN PRODUCTS PRODUCED BY WELCOME RAMP SYSTEMS, INC. PRODUCTS PRODUCED THE STANDARDS SET FORTH IN THESE DRAWINGS AND ACCOMPANYING DESIGN.
- THE RAMP SYSTEM, STAIRS AND PLATFORM HAVE BEEN DESIGNED TO MEET IBC REQUIREMENTS.
- RAMP DESIGN LIMITS: THE SLOPE SHALL BE 1:12 THE MAXIMUM CROSS SLOPE SHALL BE LESS THAN 2%. THE MAXIMUM RUN SHALL BE 30'. THE MAXIMUM HEIGHT WITHOUT ADDITIONAL ENGINEERING JUSTIFICATION SHALL BE 48" FROM THE PLATFORM TO FINISHED GRADE.
- WELCOME RAMPS, PLATFORMS, AND STAIRS ARE DESIGNED TO BE ANCHORED INTO ADJACENT MODULAR BUILDING AS WELL AS TO BE FULLY INDEPENDENT FREE STANDING CONDITIONS.
- DETAILS SHOW MOST USED HEIGHTS, OTHER HEIGHTS ARE SIMILAR.
- THE TREAD PLATES ON THIS SHEET ARE DESIGNED FOR STRENGTH. IT IS RECOMMEND THAT TREADS BE REINFORCED WITH STIFFENERS PER PLAN.

MATERIAL SPECIFICATIONS

PLANKING:

- THIS DESIGN IS LIMITED TO GALVANIZED METAL PLANKING MATERIALS.
- RAMP: ALL PLANKING SHALL BE 0.125" x 6" W x 1 1/2" DEEP.
- STAIRS: ALL PLANKING SHALL BE 0.125" x 12" W x 2" DEEP.
- MATERIAL: ALL PLANKING SHALL BE 0.125" 5052-H32 ALUMINUM. 23 KSI TENSILE YIELD STRENGTH.

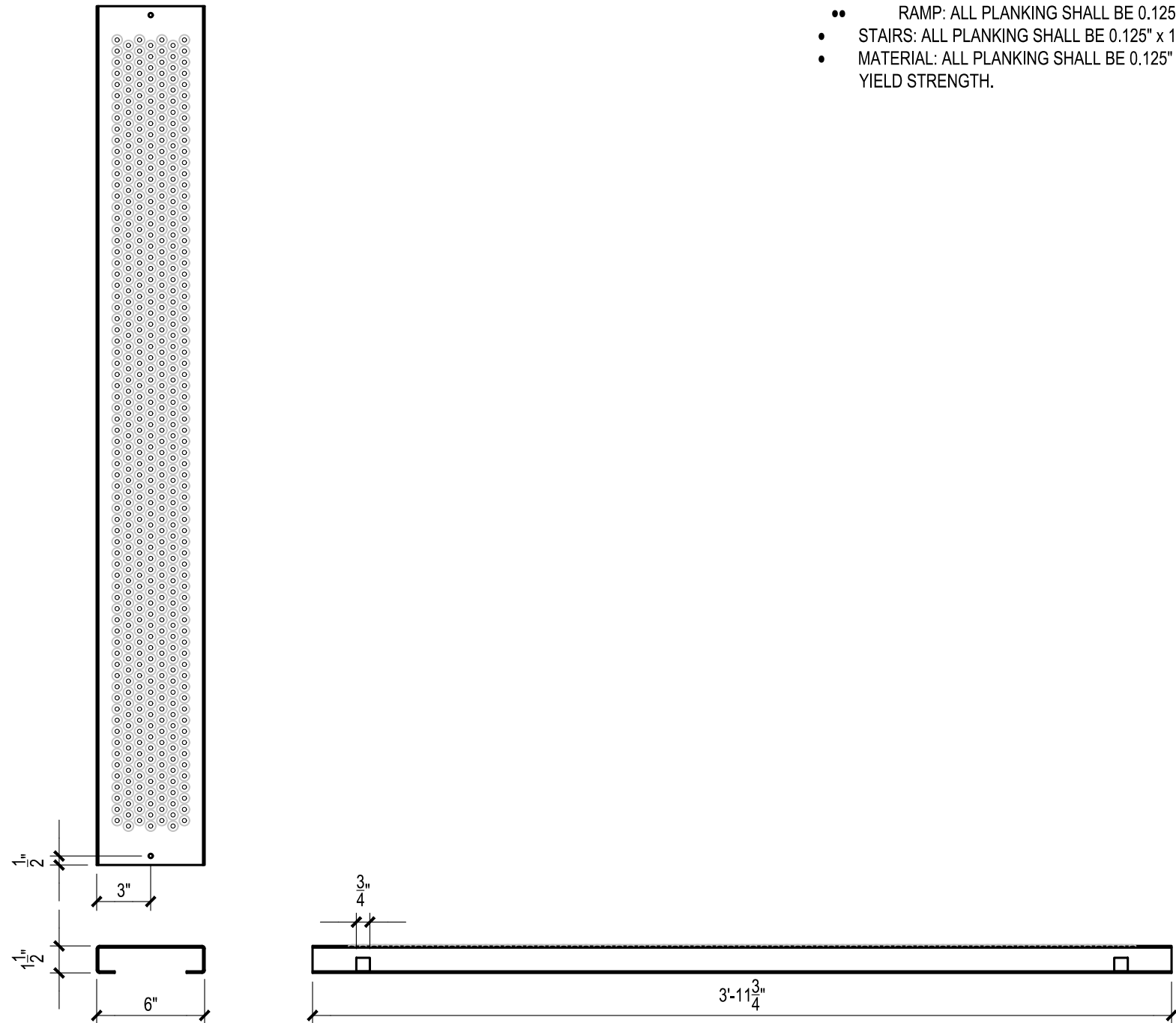

6" x 1.5" x 47.75" OR 60" SIMILAR TREAD PLATE

1 1/2" = 1'-0"

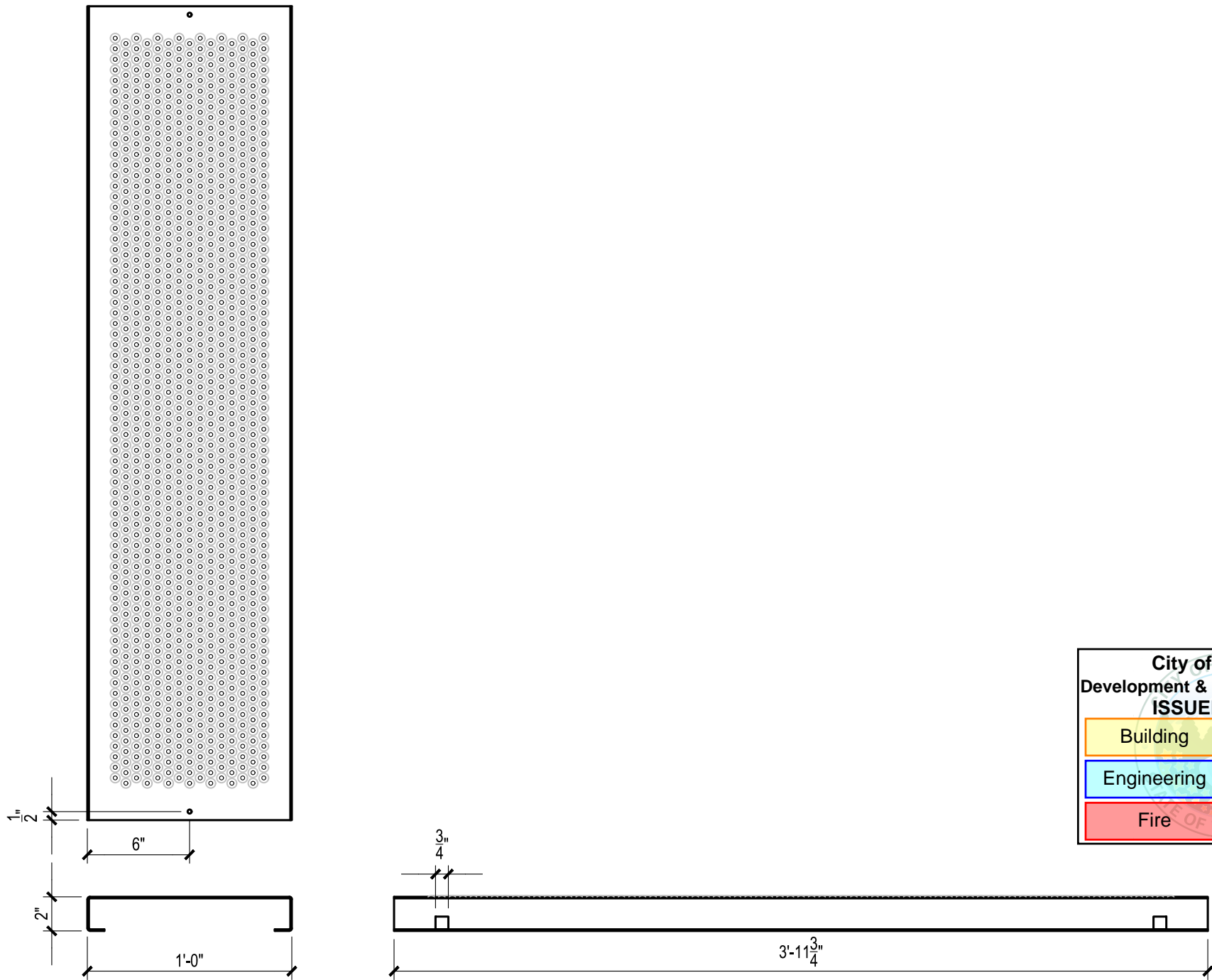

12" x 2" x 47.75" TREAD PLATE

1 1/2" = 1'-0"

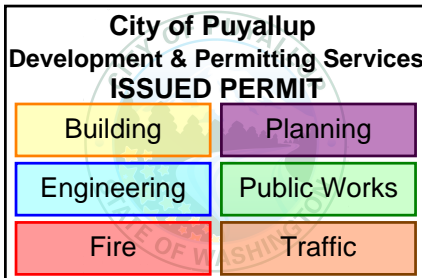

PRCTI20250361

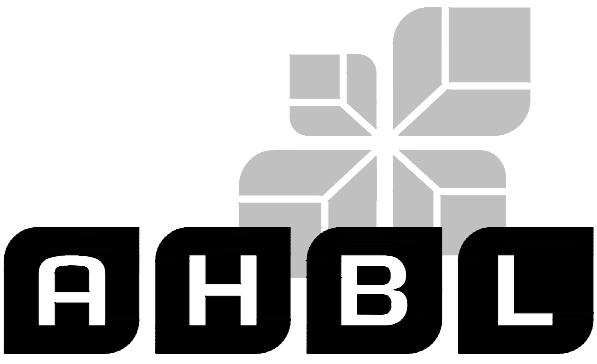

TACOMA • SEATTLE • SPOKANE • TRI-CITIES

2215 North 30th Street, Suite 300, Tacoma, WA 98403
253.383.2422 TEL 253.383.2572 FAX www.ahbl.com WEB

Project Title:

CENTERIS PUYALLUP
ACCESS PLANS
DECK, RAMP &
STAIRS

Client:

WELCOME RAMP
SYSTEMS INC.

3902 B St NW Ste B, Auburn, WA 98001

Project No.

2241015.20

Issue Set & Date:

PERMIT SUBMITTAL

3.03.2025



NOTICE:
ALTERATION OF THIS DOCUMENT SHALL INVALIDATE THE PROFESSIONAL SEAL AND SIGNATURE. PUBLICATION OF THIS DOCUMENT DOES NOT CONSTITUTE FROM REISSUED OWNERSHIP. RIGHT IN THE DOCUMENT IS FOR USE ONLY FOR THE PROJECT IDENTIFIED IN THE TITLE BLOCK AND IS NOT TO BE USED FOR REPAIR, REDESIGN OR MODIFICATION TO THAT PROJECT OR FOR ANY OTHER PROJECT.

Revisions:

A	
A	
A	
A	

Sheet Title:

ALUMINUM TREAD
OPTION

Designed by: DAR
Drawn by: KJK
Checked by: ADM

Sheet No.

WR1.7

7 of 7 Sheets