

Plan Change Request

Development Services
333 S. Meridian
Puyallup, WA 98371
Phone: 253-864-4165
www.cityofpuyallup.org



A plan change request is necessary for civil projects that propose substantial changes to the approved civil plans and requires additional review by City of Puyallup review staff. This application should be filled out completely and sent directly to the City Review Engineer assigned to the civil permit application via email.

Project Information

Site Address/ Parcel #: 3002 E Pioneer Permit #: PRCCP20240569 **PCR 001**
Owner: Greg Helle Email: greg.helle@ashnw.com
Design Engineer: Todd Sawin Email: tsawin@ahbl.com
Contractor: McKee Enterprises Email: chrisr@mckeeenterprisesllc.com

Originator of the Request: ☐ Owner ☒ Design Engineer ☒ Contractor ☐ City of Puyallup

- Does this request require a deviation from city standards? ☐ Yes ☒ No
- If yes, submit an [Alternative Method's Request](#) via the [CityView Portal](#) instead of this form

➤ Indicate the development infrastructure being affected

☐ Road ☒ Storm ☐ Water ☐ Sanitary ☐ Grading ☐ Erosion Control

➤ Specify the approved civil plans affected: R4.1

➤ Describe the change(s) being requested:

Revisions to the stormwater treatment and conveyance system to the east of the Pioneer driveway.

➤ All signatures are required to process this request unless initiated by the City of Puyallup. Final approval/denial will be made by the City Review Engineer. All changes must be fully approved/denied prior to any work on the requested changes. Any work completed prior to approval is at the risk of the developer/contractor and may not be approved by the City.

Owner

City Inspector
for Jason Little

Design Engineer

City Reviewer



Contractor

Approved
Approved/ Denied

Date: 06/30/2025

EAST TOWN CROSSING PIONEER WAY IMPROVEMENTS

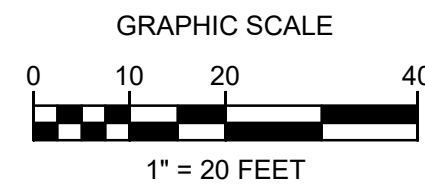
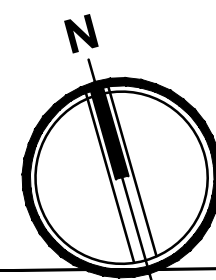
SEC. 26,35/ TWP. 20 N./ RGE. 4 E., W.M.



APPROVED

BY: CITY OF PUYALLUP
DEVELOPMENT ENGINEERING

DATE:

NOTE: THIS APPROVAL IS VOID
AFTER 180 DAYS FROM APPROVAL
DATE.
THE CITY WILL NOT BE
RESPONSIBLE FOR ERRORS
AND/OR OMISSIONS ON THESE
PLANS.
FIELD CONDITIONS MAY DICTATE
CHANGES TO THESE PLANS AS
DETERMINED BY THE
DEVELOPMENT ENGINEERING
MANAGER.

PCR 001
PRCCP20240569

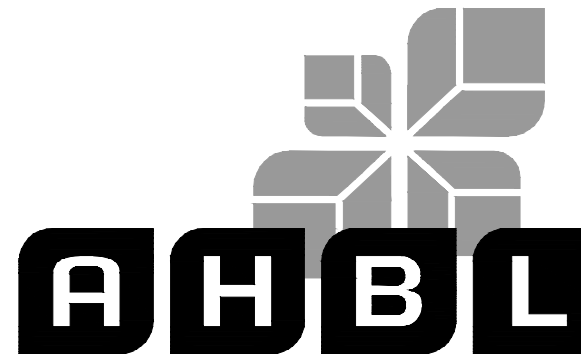

TACOMA • SEATTLE • SPOKANE • TRI-CITIES

2215 North 30th Street, Suite 300, Tacoma, WA 98403
253.383.2422 TEL 253.383.2572 FAX www.ahbl.com WEB

Project Title:

**EAST TOWN CROSSING
FRONTAGE
IMPROVEMENTS**

Client:

ASH DEVELOPMENT

GREG HELLE

GREG.HELLE@ASHNW.COM

Project No.

2230752

Issue Set & Date:

PERMIT SUBMITTAL

06/27/2025

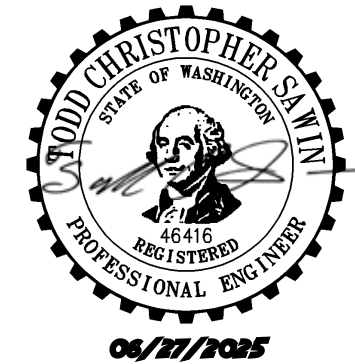

NOTICE
ALTERATION OF THIS DOCUMENT SHALL VALIDATE THE
PROFESSIONAL SEAL AND SIGNATURE. PARAGRAPHS OF
THIS DOCUMENT SHALL NOT BE SUBJECT TO ANY
CHANGES WITHOUT THE WRITTEN CONSENT OF THE
ENGINEER. THIS NOTICE IS THE PROPERTY OF THE
ENGINEER AND IS NOT TO BE USED FOR ANY OTHER PROJECT
WITHOUT THE WRITTEN CONSENT OF THE ENGINEER.

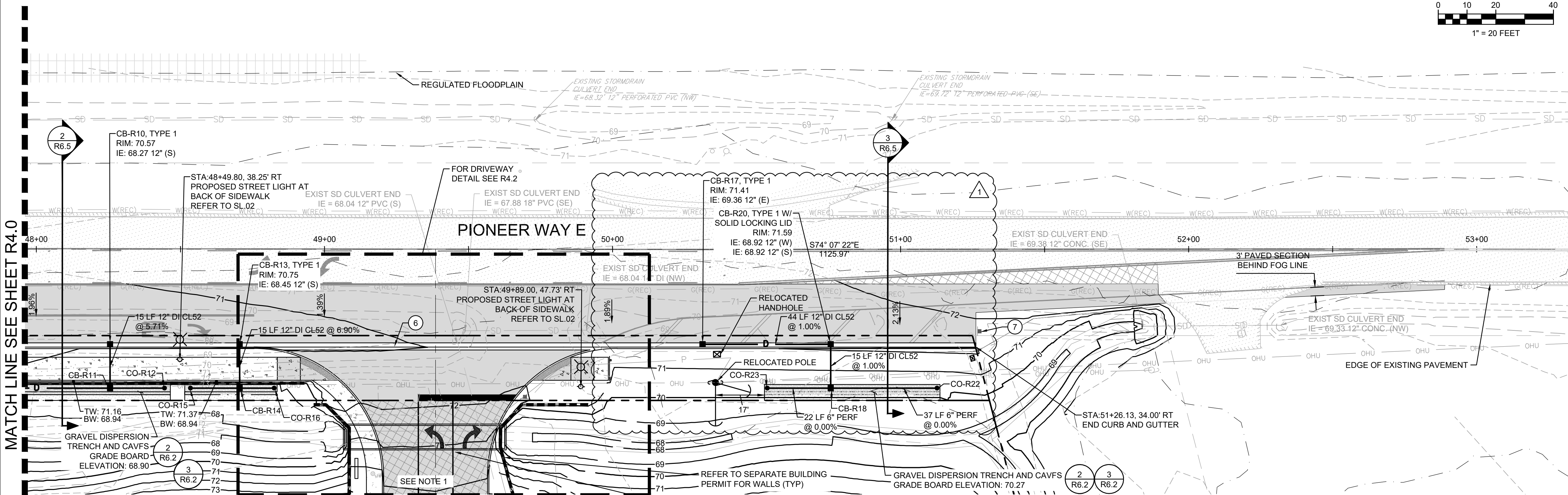

ONSITE WORK FOR REFERENCE. SEE PERMIT
PRCCP20230970 FOR WORK WITHIN PROPERTY

SEE SHEET R4.3 FOR ESD DIAGRAM
FOR UNPROTECTED RIGHT AND LEFT
TURN ENTERING PIONEER

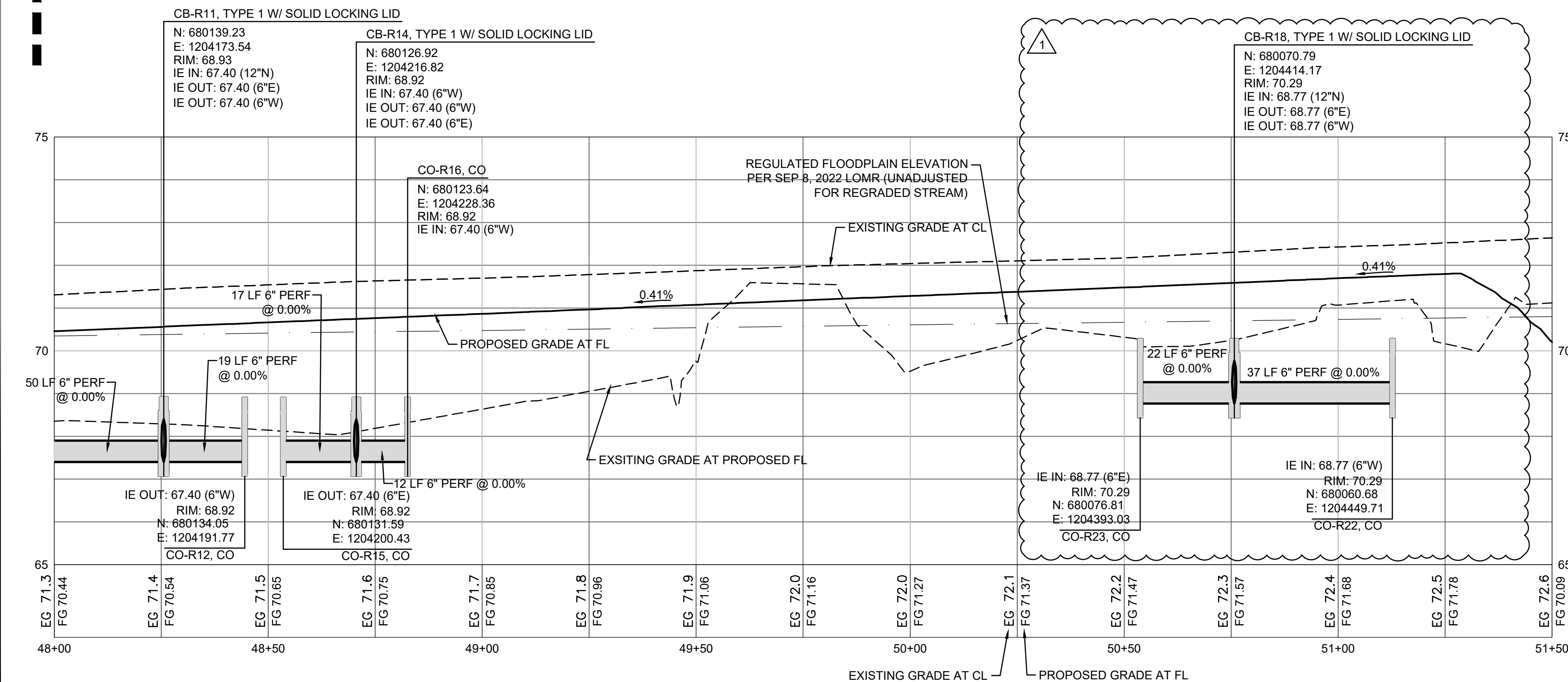

LEGEND:

---	RIGHT-OF-WAY/PROPERTY LINE
---	CENTERLINE
++++	PERVIOUS ASPHALT PAVEMENT
----	ASPHALT PAVEMENT - STD. DUTY
----	PERVIOUS CONCRETE SIDEWALK
----	DETECTABLE WARNING SURFACE
----	ASPHALT PAVEMENT - ATB
----	GRIND AND OVERLAY
■	CATCH BASIN - TYPE 1- SEE CITY STANDARD NO. 02.01.03 ON SHEET R6.2
D	STORM DRAINAGE PIPING
----	KEYSTONE RETAINING WALL
CG	CONCRETE CURB AND GUTTER - SEE CITY STANDARD NO. 01.02.09 ON SHEET R6.8
FC	FLUSH CURB

KEYNOTES

- ADA RAMP - SINGLE DIRECTIONAL
- ADA RAMP - PARALLEL
- CROSSWALK STRIPING - SEE CITY STANDARD NO. 01.03.11
ON SHEET PM-04
- NOT USED
- BOX CULVERT
- CONCRETE VALLEY GUTTER
- TYPE 3 OBJECT MARKERS (OM-3R) - PER COP 01.03.13

NOTE:

- PER THE APPROVED PRELIMINARY SITE PLAN CONDITIONS,
AT THE DISCRETION OF THE CITY, THE CITY MAY RESTRICT
OUTBOUND LEFT TURNS FROM THE E PIONEER ACCESS IN
THE FUTURE. AT THE REQUEST OF THE CITY, THE OWNERS,
HEIRS, SUCCESSORS, AND ASSIGNS AGREE TO RENOVATE
AND/OR IMPROVE DRIVEWAY ACCESS IN ACCORDANCE WITH
THE CITY OF PUYALLUP MUNICIPAL CODE AND ENGINEERING
STANDARDS.
- PERFORATED PIPES IN DISPERSION TRENCH SHALL HAVE
DOWNTURNED ELBOWS WITHIN THE CATCH BASIN TO
PREVENT SEDIMENT BUILD UP WITHIN PIPES.



Know what's below.
Call before you dig.

R4.1