

TRAFFIC CONTROL PLAN

~~HOURS OF TCP:~~ MONDAY-THURSDAY  
10AM-2PM  
**24 HR CONTACT:**  
KEVIN HARMON  
CABLECOM  
360.322.2805  
KEVIN.HARMON@CABLECOMLLC.NET  
**JOB NUMBER:** JB0002114498-5  
**JOB ADDRESS:** 1601 39TH AVE SE,  
PUYALLUP.  
**DESCRIPTION:** ACCESS UTILITY POLE AT  
PROPOSED LOCATION.

**LEGEND**

- ● ● TRAFFIC SAFETY DRUMS
- ⏏ ⏏ TEMP SIGN LOCATION
- ➡➡➡ ARROWBOARD
- ⊗ UTILITY POLE
- 🚚 WORK VEHICLE



TYPE OF TCP: WORK HOURS  
PHASE OF WORK: ACCESS

LANE WIDTH (FEET)	MINIMUM TAPER LENGTH = L (FEET)					
	POSTED SPEED (MPH)					
	25	30	35	40	45	50
10	105	150	205	270	450	500
11	115	165	225	295	495	550
12	125	180	245	320	540	600

CHANNELIZATION DEVICE SPACING (FEET)		
MPH	TAPER	TANGENT
50	40	80
35/45	30	60
25/30	20	40

SIGN SPACING = X		
RURAL ROADS	45/55 MPH	500'±
RURAL ROADS & URBAN ARTERIALS	35/40 MPH	350'±
RURAL ROADS & URBAN ARTERIALS	25/30 MPH	200'±
RESIDENTIAL & BUSINESS DISTRICTS		
URBAN STREETS	25 MPH OR LESS	100'±

BUFFER DATA											
LONGITUDINAL BUFFER SPACE = B											
SPEED (MPH)	20	25	30	35	40	45	50	55	60	65	
LENGTH (FEET)	115	155	200	250	305	360	425	495	570	645	

(1) ALL SPACING MAY BE ADJUSTED TO ACCOMMODATE INTERCHANGE RAMP, AT-GRADE INTERSECTIONS AND DRIVEWAYS  
(2) THIS SPACING MAY BE REDUCED IN URBAN AREAS TO FIT ROADWAY CONDITIONS

**PEDESTRIAN ESCORT:** STOP WORK, SECURE PASSABLE ADA COMPLIANT PEDESTRIAN ACCESS ON EXISTING SIDEWALK (4' MIN.). CLEAR ZONE MUST BE FREE OF OVERHEAD HAZARDS WHEN PEDESTRIANS ARE MOVING THROUGH THE WORK ZONE.

**ROAD WORK ALLOWED:**  
Monday - Thursday  
10AM - 2PM  
Call communications center at 253-287-4456 on day of work.  
Request a job start inspection through the CityView portal.  
  
The City-issued permit packet shall be posted at the job site and available to inspectors at all times.

City of Puyallup  
Development & Permitting Services  
ISSUED PERMIT

Building	Planning
Engineering	Public Works
Fire	Traffic



TRAFFIC CONTROL SUPERVISOR

*SK*

SPEED  
LIMIT  
**35**

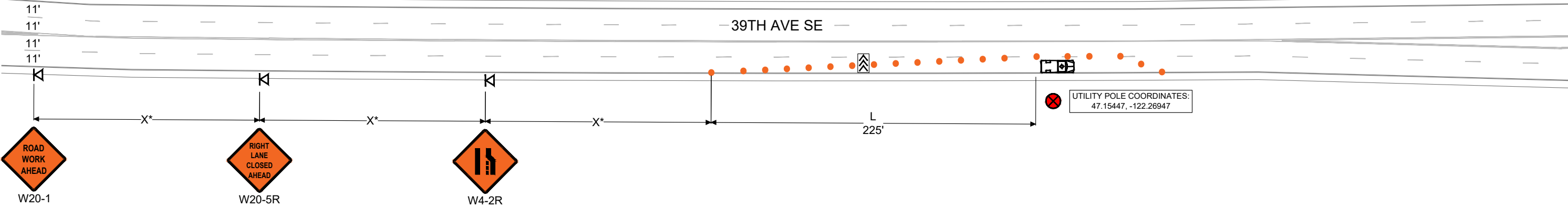

- NOTES:**
1. ALL SIGNS ARE 36"-48" ACROSS
  2. ASTERISK DENOTES X, L, OR B DISTANCES ARE NOT TO SCALE
  3. CONTRACTOR SHALL ALWAYS PROVIDE ACCESS TO DRIVEWAYS
  4. STANDARD ADVANCE WARNING SIGNS SHALL BE USED FOR PLATES OR ROUGH ROAD DURING AFTER-HOURS, INCLUDING "MOTORCYCLIST" SIGN
  5. FLAGGERS SHALL BE USED IN ACCORDANCE WITH WAC 468-95-302. UPO WILL BE REQUIRED IF A TRAFFIC SIGNAL COULD BE COUNTERMANDED
  6. SIDEWALKS ARE EITHER OPEN OR NOT OPEN. A SIDEWALK IS CLOSED IF A MINIMUM 4' PATH CANNOT BE MAINTAINED MEASURED FROM PROPERTY LINE, OR 5.5' IF CREATED FROM FACE OF CURB

**BOOKER**  
ENGINEERING

SPENCER KARINIEMI  
TRAFFIC CONTROL SUPERVISOR  
360-722-2852

