

### SITE SPECIFIC NOTES

- P01 (568400-155042)
- ZIPTIE SEC TO NEUT APPROX 150' TO P02
  - TRANSFER EXISTING S/L (SLAP4314)
  - RAISE EXIST STREET LIGHT ARM APPROX 12'-18" (\_\_\_\_) ABOVE TOP COMMS
  - ADD S/L MOLDING GRND WIRE (8920300)
  - CREW TO MAINTAIN SAFETY SPACE CLEARANCES

- P03 (568324-155041)
- ZIPTIE SEC TO NEUT APPROX 150' TO P04
  - CREW TO MAINTAIN MIN. 30" OF MIDSPAN CLEARANCE

- P05 (568323-155054)
- REPLACE EXIST 40' POLE
  - INST NEW 45' CL1 POLE (6010,1000 PD451)
  - INST 1Ø SGL PTP (6031,1010 TAN112)
  - TRANSFER EXIST OH SEC
  - TOP POLE TO COMMS

- P06 (568323-155072)
- REPLACE EXIST 40' POLE
  - INST NEW 45' CL1 POLE (6010,1000 PD451)
  - INST 1Ø DE (6031,1040 DE2115)
  - TRANSFER EXIST 50kVA 120/240v XF W/ LB C/O FUSED AT 15T (342300)
  - TRANSFER EXIST OH SEC
  - TRANSFER EXIST OH SPAN GUY
  - TRANSFER EXIST S/L (SLAP4309)
  - TOP POLE TO COMMS

- P07 (568322-155085)
- REPLACE EXIST 40' POLE
  - INST NEW 45' CL4 POLE (6010,1000 PD454)
  - TRANSFER EXIST OH SEC
  - INST NEW 3" RISER (6042,1000RIS3CSS) ON S/O BKTS APPROX. 40'(\_\_\_\_) UP POLE
  - SPLICE AT BASE OF POLE NEW 1/0 UG TPX APPROX 40'(\_\_\_\_) THROUGH NEW RISER
  - TRANSFER EXIST SPAN GUY
  - TOP POLE TO COMMS

- P08 (568322-155116)
- REPLACE EXIST 40' POLE
  - INST NEW 45' CL1 POLE (6010,1000 PD451)
  - INST 1Ø SGL PTP (6031,1010 TAN112)
  - TRANSFER EXIST 25kVA 120/240v XF W/ LB C/O FUSED AT 10T (342200)
  - TRANSFER EXIST OH SEC
  - TOP POLE TO COMMS

- P09 (568321-155129)
- REPLACE EXIST 40' POLE
  - INST NEW 45' CL3 POLE (6010,1000 PD453)
  - INST 1Ø SGL PTP (6031,1010 TAN112)
  - TRANSFER EXIST OH SEC
  - TOP POLE TO COMMS

- P10 (568321-155144)
- REPLACE EXIST 45' POLE
  - INST NEW 50' CL2 POLE (6010,1000 PD502)
  - INST NEW 3Ø SGL ARM (6033,1010 TAN312)
  - INST NEW 1Ø POLE MOUNTED TAP (6043,1000 TSU1C1) W/ LB C/O FUSED AT 40T (3412500)
  - INST EXIST SWITCH #P2653
  - TRANSFER EXIST OH SEC
  - TRANSFER EXIST S/L (SLAP4307)
  - TOP POLE TO COMMS

- P11 (568318-155228)
- REPLACE EXIST 40' POLE
  - INST NEW 45' CL2 POLE (6010,1000 PD452)
  - TRANSFER EXIST OH SEC
  - TRANSFER EXIST S/L (SLAP4246)
  - INST 3/8" SIDEWALK GUY (6013,0180 GYD3PB) ATTACH TO EXIST ANCHOR
  - TOP POLE TO COMMS

- P12 (568286-155175)
- REPLACE EXIST 40' POLE
  - INST NEW 45' CL1 POLE (6010,1000 PD402)
  - TRANSFER EXIST OH SPAN GUY
  - INST 7/16" SIDEWALK GUY (6013,0180 GYD7PB) ATTACH TO EXIST ANCHOR
  - TOP POLE TO COMMS

- P13 (568283-155209)
- WRECK OUT EXIST 1/0 OH TPX APPROX. 100'(\_\_\_\_) TO P14

- P15 (568285-155208)
- RAISE EXIST STREET LIGHT ARM APPROX 12'-18" (\_\_\_\_) ABOVE TOP COMMS
  - ADD S/L MOLDING GRND WIRE (8920300)
  - EXTEND EXIST 3" RISER APPROX. 1'(\_\_\_\_) OR AS MUCH AS POSSIBLE
  - SPLICE ON TOP OF RISER 1/0 UG APPROX. 5'(\_\_\_\_) IF NECESSARY

- P16 (568273-155175)
- REPLACE EXIST 40' POLE
  - INST NEW 45' CL2 POLE (6010,1000 PD452)
  - INST 1Ø SGL PTP (6031,1010 TAN112)
  - INST NEW 13x24 SEC FG HH. SEE HH01 NOTES
  - TRANSFER EXIST OH SEC
  - TOP POLE TO COMMS

- P17 (568260-155174)
- REPLACE EXIST 40' POLE
  - INST NEW 45' CL1 POLE (6010,1000 PD451)
  - INST 1Ø SGL PTP (6031,1010 TAN112)
  - TRANSFER EXIST 25kVA 120/240v XF W/ LB C/O FUSED AT 10T (342200)
  - TRANSFER EXIST OH SEC
  - TRANSFER EXIST S/L (SLAP4209)
  - TOP POLE TO COMMS

Site specific notes, pole tables, and other content on the site plan does not match the permit application for removing six poles. Redact any unrelated work from the site plan or update the project description on the application to match the proposed scope of work.

POLE RETIREMENT TABLE							TEMP TRANSFERS			ST. LIGHT TRANSFERS		
SITE #	POLE DATA				POLE		TEL	TV	FIBER	TRAN	RMVD	ID NUMBER
	GRID #	HEIGHT	CLASS	YEAR	TOPPED	RMVD						
P05	568323-155054	40	1	1985	<input type="checkbox"/>	<input type="checkbox"/>	<input type="checkbox"/>	<input type="checkbox"/>	<input type="checkbox"/>	<input type="checkbox"/>	<input type="checkbox"/>	
P06	568323-155072	40	UNK	UNK	<input type="checkbox"/>	<input type="checkbox"/>	<input type="checkbox"/>	<input type="checkbox"/>	<input type="checkbox"/>	<input type="checkbox"/>	<input type="checkbox"/>	
P07	568322-155085	40	4	1958	<input type="checkbox"/>	<input type="checkbox"/>	<input type="checkbox"/>	<input type="checkbox"/>	<input type="checkbox"/>	<input type="checkbox"/>	<input type="checkbox"/>	
P08	568322-155116	40	UNK	UNK	<input type="checkbox"/>	<input type="checkbox"/>	<input type="checkbox"/>	<input type="checkbox"/>	<input type="checkbox"/>	<input type="checkbox"/>	<input type="checkbox"/>	
P09	568321-155129	40	5	1956	<input type="checkbox"/>	<input type="checkbox"/>	<input type="checkbox"/>	<input type="checkbox"/>	<input type="checkbox"/>	<input type="checkbox"/>	<input type="checkbox"/>	
P10	568321-155144	45	2	UNK	<input type="checkbox"/>	<input type="checkbox"/>	<input type="checkbox"/>	<input type="checkbox"/>	<input type="checkbox"/>	<input type="checkbox"/>	<input type="checkbox"/>	
P11	568318-155228	40	UNK	UNK	<input type="checkbox"/>	<input type="checkbox"/>	<input type="checkbox"/>	<input type="checkbox"/>	<input type="checkbox"/>	<input type="checkbox"/>	<input type="checkbox"/>	
P12	568286-155175	40	UNK	UNK	<input type="checkbox"/>	<input type="checkbox"/>	<input type="checkbox"/>	<input type="checkbox"/>	<input type="checkbox"/>	<input type="checkbox"/>	<input type="checkbox"/>	
P16	568273-155175	40	2	1979	<input type="checkbox"/>	<input type="checkbox"/>	<input type="checkbox"/>	<input type="checkbox"/>	<input type="checkbox"/>	<input type="checkbox"/>	<input type="checkbox"/>	
P17	568260-155174	40	1	1993	<input type="checkbox"/>	<input type="checkbox"/>	<input type="checkbox"/>	<input type="checkbox"/>	<input type="checkbox"/>	<input type="checkbox"/>	<input type="checkbox"/>	

### POWER GENERAL NOTES

- All materials to be installed in accordance with Puget Sound Energy's (PSE) standards. Any deviation from this work sketch must be AUTHORIZED by Poteko's Project Manager and NOTED on the Foreman's Copy.
- All switching arrangements and/or outage arrangements are to be made with the Project Manager at least three (3) working days in advance.
- Contact the Utilities Underground Location Center (1-800-424-5555) at least 48 hours prior to commencing work to get the underground facilities located.
- All work is to be done in accordance with local municipal and county permit requirements as applicable.
- Inclement weather conditions may cause delays in construction times and dates.

#### EROSION & SEDIMENT CONTROL REQUIREMENTS

EROSION & SEDIMENT CONTROL SHALL BE PER PSE STANDARD PRACTICE 0150.3200 TECHNIQUES FOR TEMPORARY EROSION & SEDIMENT CONTROL & ANY ADDITIONAL LOCAL JURISDICTION REQUIREMENTS. (LOCAL JURISDICTIONS MAY HAVE ADDITIONAL REQUIREMENTS INCLUDING NOTES DETAILING WHERE EROSION OR SEDIMENT CONTROL STRUCTURES ARE TO BE INSTALLED, CROSS SECTION DETAILS OF THE TYPICAL EROSION STRUCTURES, & SPECIAL REQUIREMENTS FOR WORK IN SENSITIVE AREAS.)

PRFUP20251237

#### POLE TABLE (NEW)

Site #	Pole Data				
	Grid #	Height	Class	Year	Remarks / Location Ref.
P05	568323-155054	45	1	N/A	
P06	568323-155072	45	UNK	N/A	
P07	568322-155085	45	4	N/A	
P08	568322-155116	45	UNK	N/A	
P09	568321-155129	45	3	N/A	
P10	568321-155144	50	2	N/A	
P11	568318-155228	45	UNK	N/A	
P12	568286-155175	45	UNK	N/A	
P16	568273-155175	45	2	N/A	
P17	568260-155174	45	1	N/A	

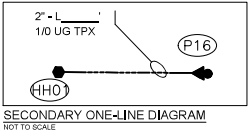
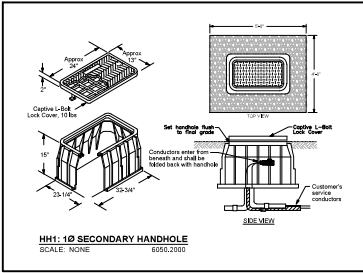

- HH01
- INST NEW 13x24 SEC FG HH (6050,2000 HH14350) AT BASE OF P16
  - INST 4 POS FARGOS
  - TRANSFER EXIST 3" RISER
  - REPULL NEW 350 UG TPX APPROX. 45' (\_\_\_\_) TO EXIS HANDHOLE

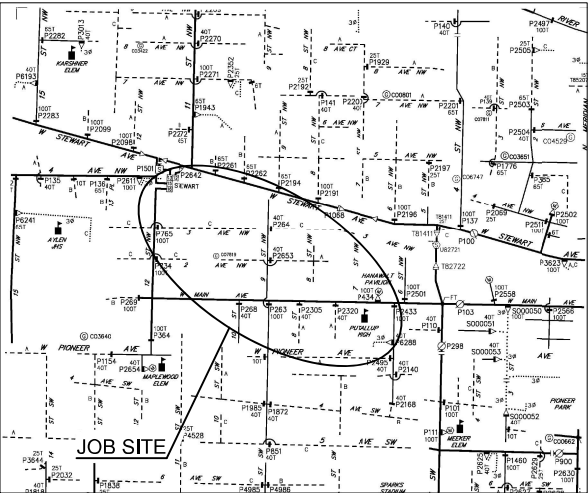

OH CIRCUIT MAP: D2004E112

SCALE 6" = 1 MILE

#### TRANSFORMER TRANSFER

New pole at site: **P06**  
Grid Number: **568323-155072**  
kVA Rating: **50kVA 120/240v**

Foreman to redline the following information

Company ID#: \_\_\_\_\_  
Primary phase connected to: \_\_\_\_\_  
Tested Secondary Voltage: \_\_\_\_\_ /

#### TRANSFORMER TRANSFER

New pole at site: **P08**  
Grid Number: **568322-155116**  
kVA Rating: **25kVA 120/240v**

Foreman to redline the following information

Company ID#: \_\_\_\_\_  
Primary phase connected to: \_\_\_\_\_  
Tested Secondary Voltage: \_\_\_\_\_ /

#### TRANSFORMER TRANSFER

New pole at site: **P17**  
Grid Number: **568260-155174**  
kVA Rating: **25kVA 120/240v**

Foreman to redline the following information

Company ID#: \_\_\_\_\_  
Primary phase connected to: \_\_\_\_\_  
Tested Secondary Voltage: \_\_\_\_\_ /

PROJECT PHASE	NOTIF#	ORDER#
PWR	512702367	186061933
Superior		
Sub Order		101148385/10836527
		N/A
		N/A

Developer: Yes	<input checked="" type="checkbox"/>	PSE
No	<input type="checkbox"/>	
"Locates Required"	<input checked="" type="checkbox"/>	No
"Outages Required"	<input checked="" type="checkbox"/>	No
"Flagging Required"	<input checked="" type="checkbox"/>	No

FUNCTION	CONTACT	PHONE NO	DATE
3			
2			
1			
REV#	DATE	BY	DESCRIPTION
COUNTY	PIERCE	Emer Sect	Gas Wk Ctr
1/4 SEC	T20 R04E S28	N/A	PLAT MAP
U-MAP NO (POWER)	A2004E109	OH CKT MAP	D2004E112

JOINT FACILITIES ARRANGEMENTS			
UTILITIES	N/A	N/A	N/A
CONTACT	N/A	N/A	N/A
PHONE#	N/A	N/A	N/A

PSI	PUGET SOUND ENERGY	ENGR1 LUMEN TK#5044288	INCIDENT N/A	MAOP N/A
DESIGNED BY POTELOCO		RPLC (10) POLES, EXT. SEC RISER, ZIPTIE SEC, WRKOUT SEC.	Gas Order N/A	Elect Order 186061933
		711 W MAIN PUYALLUP, WA 98371	SCALE AS NOTED	PAGE 1/1

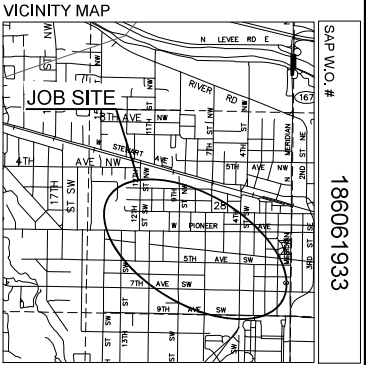

FOREMAN (CHECK BOX WHEN COMPLETED)

☐ PSE Equipment LOCKED/SECURED & Work Area left in CLEAN/SAFE Condition.

☐ Grid, Cable, and Switch numbers BEST FILED & VERIFIED.

☐ Field Changes REDLINED on As-built.

☐ Material VERIFIED and CHANGES noted on Paperwork.

☐ Total PRIMARY Cable noted on As-built.

☐ Company ID#s RECORDED in correct location on As-built.

☐ Indicate correct FUSE SIZE on As-built & VERIFY proper PHASE.

☐ Deviations noted on the As-built and their reason.

☐ I certify that the work performed meets PSE's standards and procedures and that all quality requirements are met.

Foreman's Signature \_\_\_\_\_ Date \_\_\_\_\_

Print Name \_\_\_\_\_

2 BUSINESS DAYS BEFORE YOU DIG			
REAL ESTATE/EASEMENT	PERMIT	CITY OF PUYALLUP	
N/A			

FUNCTION	CONTACT	PHONE NO	DATE
PROJECT MGR	M. TANKERSLEY	253-563-6175	3/21/2022
ENGR - POWER	J. REYNA	253-259-7076	3/21/2022
ENGR - GAS	N/A	N/A	N/A
CHECKED BY	M. COBBINAH	N/A	3/21/2022
APPROVED BY			
FOREMAN #1			
FOREMAN #2			
MAPPING			