

Hampton Inn - Puyallup
Site Map

Property Address: 1515 S. Meridian
Puyallup, WA 98371

City of Puyallup
Development & Permitting Services
ISSUED PERMIT

Building	Planning
Engineering	Public Works
Fire	Traffic

island dog
SIGNS LLC

4 2 5 . 8 4 4 . 2 3 3 3
P.O. Box 3155, Redmond, WA 98073-3155
www.islanddogsigns.com

Client : Hampton Inn & Suites

Contact : Victor Sung

e. victor@sung.studio
t. 626.200.5079

Date: 09.04.25

- Revisions:
- Approved as is☐
- Approved with revisions☐
- Redesign & resubmit☐

Filename: 250517 Hampton Inn
Wayfinding Signage Permit.pdf

Drawn By:

Approved By:

Date:

This is an original unpublished design document created by Island Dog Signs LLC and Submitted for your review. This document and its contents are property of Island Dog Signs LLC until paid for, and its contents shall not be reproduced, copied photographed, exhibited or used in any fashion without the expressed written approval of Island Dog Signs LLC.

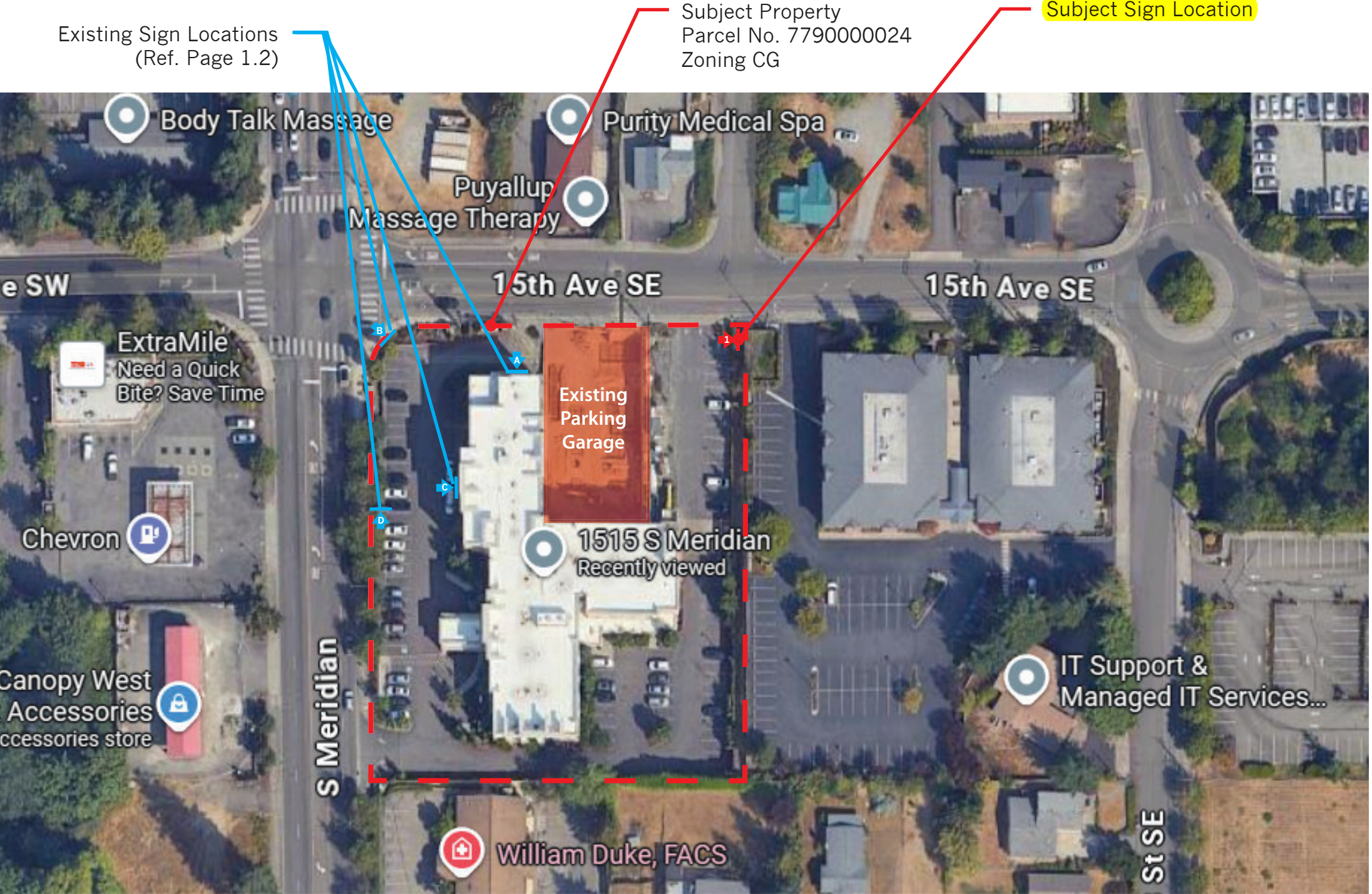

Imagery ©2025 Airbus, Maxar Technologies, Map data ©2025 200 ft

S. Meridian

Property Frontage = ~325 Ft.
Building Frontage = ~255 Ft.

15th Avenue SE

Property Frontage = ~260 Ft.
Building Frontage = ~120 Ft.

PRSG20251258

City of Puyallup
Planning
Division
APPROVED

See permit conditions.
JHulseLew
10/13/2025
2:11:24 PM

Hampton Inn - Puyallup

Existing Signage

City of Puyallup Development & Permitting Services ISSUED PERMIT			
Building	Planning		
Engineering	Public Works		
Fire	Traffic		



island dog
SIGNS LLC

4 2 5 . 8 4 4 . 2 3 3 3
P.O. Box 3155, Redmond, WA 98073-3155
www.islanddogsigns.com

Client : Hampton Inn & Suites

Contact : Victor Sung

e. victor@sung.studio
t. 626.200.5079



Location A
Illuminated Wall Sign
Approx. 60 SqFt.



Location B
Non-Illuminated Wall Sign
Approx. 30 SqFt.



Location C
Illuminated Wall Sign
Approx. 60 SqFt.



Location D
Monument Sign
Approx. 30 SqFt.

Date: 09.04.25

Revisions:
Approved as is ☐
Approved with revisions ☐
Redesign & resubmit ☐

Filename: 250517 Hampton Inn
Wayfinding Signage Permit.pdf

Drawn By:

Approved By:

Date:

This is an original unpublished design document created by Island Dog Signs LLC and Submitted for your review. This document and its contents are property of Island Dog Signs LLC until paid for, and its contents shall not be reproduced, copied, photographed, exhibited or used in any fashion without the expressed written approval of Island Dog Signs LLC.