

# FITTER/LISTER NOTES

1. ALL DROPS ARE TO BE PER FLEX DETAIL '1' WITH 48" EASYFLEX U.N.O.
2. ALL HANGERS ARE TO BE PER DETAIL 'SW' U.N.O.
3. REPLACE EXISTING ESFR PENDENT HEADS ABOVE NEW OFFICE WITH NEW F1FR PENDENT HEADS IN 1x1/2" BUSHINGS.
4. SEND 2 FT. OF BULK 3/8" ATR FOR CTS HANGER RODS.
5. ALL SPRINKLERS TO BE CENTERED IN 2' DIRECTION ONLY OF 2' x 4' TILES
6. J112 EXTENDED COVERAGE SPRINKLERS SPACED AT 20'X20' MAX SPACING W/ 8FT MINIMUM SPACE BETWEEN HEADS.
7. WHERE ARMOVERS ARE PARALLEL WITH STIFFENERS, CUT IN BELOW STIFFENER.
8. EXCLUDING WORK ON OVERTIME OR AFTER HOURS.
9. EXCLUDING RELOCATING OR MODIFYING THE EXISTING SPRINKLER SYSTEM TO ACCOMMODATE THE WORK OF OTHER TRADES.

# GENERAL NOTES

1. ALL STEEL PIPE TO BE AS FOLLOWS UNLESS NOTED OTHERWISE:

STEEL PIPE ASTM A-795 OR BETTER						
PIPE SIZE	SCHEDULE	WALL THICKNESS (INCHES)	INTERNAL DIAMETER (INCHES)	END PREP TYPES ALLOWED	WEIGHT OF PIPE (LBS/FT)	CAPACITY (GPM)
1	40	0.133	1.049	THREADED, CUT GROOVED, ROLL GROOVED, PLAN END, POLISHED	2.05	0.044

\*\* WALL THICKNESS PER NFPA # 13

2. ALL GROOVED COUPLINGS TO BE RIGID TYPE UNLESS NOTED (|||) WHICH ARE FLEXIBLE.

# SCOPE OF WORK

SMITH FIRE SYSTEMS (SFS) WILL MODIFY THE EXISTING SPRINKLER SYSTEM TO ACCOMMODATE THE NEW WALLS.

## CLARIFICATIONS:

1. ALL AREAS PROTECTED BY A WET PIPE SYSTEM MUST BE MAINTAINED AT 40°F IN ORDER TO PREVENT FREEZING.
2. SPRINKLER MODIFICATIONS ARE BASED UPON HAVING ADEQUATE PRESSURE AVAILABLE AT THE POINT OF CONNECTION
3. MATERIALS INSTALLATION AND DESIGN PER NFPA 13 STANDARDS AS SELECTED BY SFS.
4. ROUGH-IN OF NEW SPRINKLER DROPS MUST BE COMPLETED BEFORE NEW WALLS OR CEILING ARE INSTALLED.

## EXCLUSIONS:

1. SAFE OFF OR A SEPARATE DEMO TRIP IS NOT INCLUDED UNO.
2. FLOOR MUST BE FREE AND CLEAR OF MERCHANDISE, STOCK, RACKING OR CONSTRUCTION MATERIALS TO ALLOW FOR ACCESS TO PIPE AT THE STRUCTURE.
3. CUTTING PATCHING OR FIRE CAULKING OF WALLS, CEILING, OR FLOORS
4. ACCESS PANELS OF ANY KIND.
5. DOH, FM, INSURANCE, OR OTHER OUTSIDE REVIEW REQUIREMENTS, APPROVALS OR FEES
6. HEAT TRACE OR INSULATION OF ANY KIND
7. ANY WORK OUTSIDE THIS TENANT SPACE
8. PAINTING OR LABELING OF PIPE
9. REPLACEMENT OF PAINTED, DAMAGED, OR CORRODED SPRINKLERS.
10. ELECTRICAL OR ALARM WORK OF ANY KIND.
11. BACKFLOW INSTALLATION, MODIFICATION, OR CERTIFICATION (IF REQUIRED)
12. REPAIRS OR MODIFICATIONS TO THE EXISTING SYSTEM BEYOND THE SCOPE DESCRIBED ABOVE.
13. FIRE WATCH OR TEMPORARY SPRINKLER PROTECTION DURING CONSTRUCTION.
14. MODIFICATIONS REQUIRED TO ACCOMMODATE THE WORK OF OTHER TRADES
15. STRUCTURAL ANALYSIS, SEISMIC INVESTIGATION, OR PE REVIEW UNO
16. UNDERGROUND WORK OF ANY KIND

## DESIGN CRITERIA:

PER NFPA 13 2019 AND THE CITY OF PUYALLUP.

EXISTING CRITERIA:  
OFFICE - LIGHT HAZARD

NEW DESIGN CRITERIA:  
OFFICE - LIGHT HAZARD

## TENANT IMPROVEMENT:

THIS PROJECT IS A TENANT IMPROVEMENT. THIS FACILITY HAS ALREADY BEEN PROTECTED BY A FIRE SPRINKLER SYSTEM. SMITH FIRE SYSTEMS IS ADDING AND/OR RELOCATING SPRINKLER HEADS TO ACCOMMODATE THE NEW TENANT WALL, CEILING, LIGHTING, AND HVAC LAYOUT. ALL WORK WILL BE DONE WITHOUT AFFECTING THE CAPABILITY OF THE EXISTING SYSTEM; THEREFORE, NO NEW HYDRAULIC CALCULATIONS ARE NECESSARY.

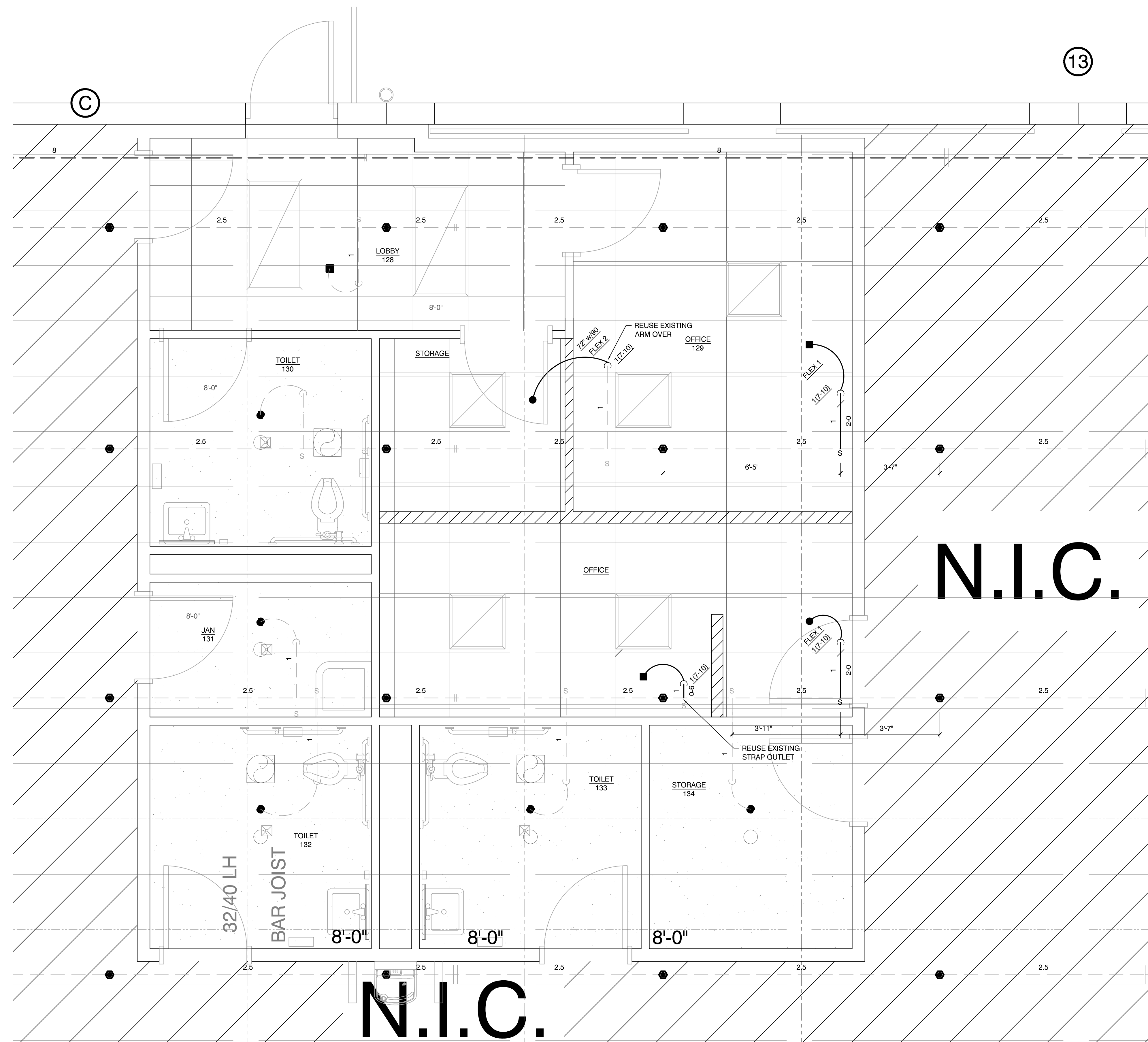

N.I.C.

SPRINKLER PLAN

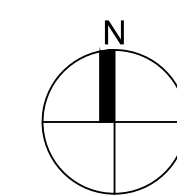

SCALE 1/2"=1'-0"

## WALL LEGEND

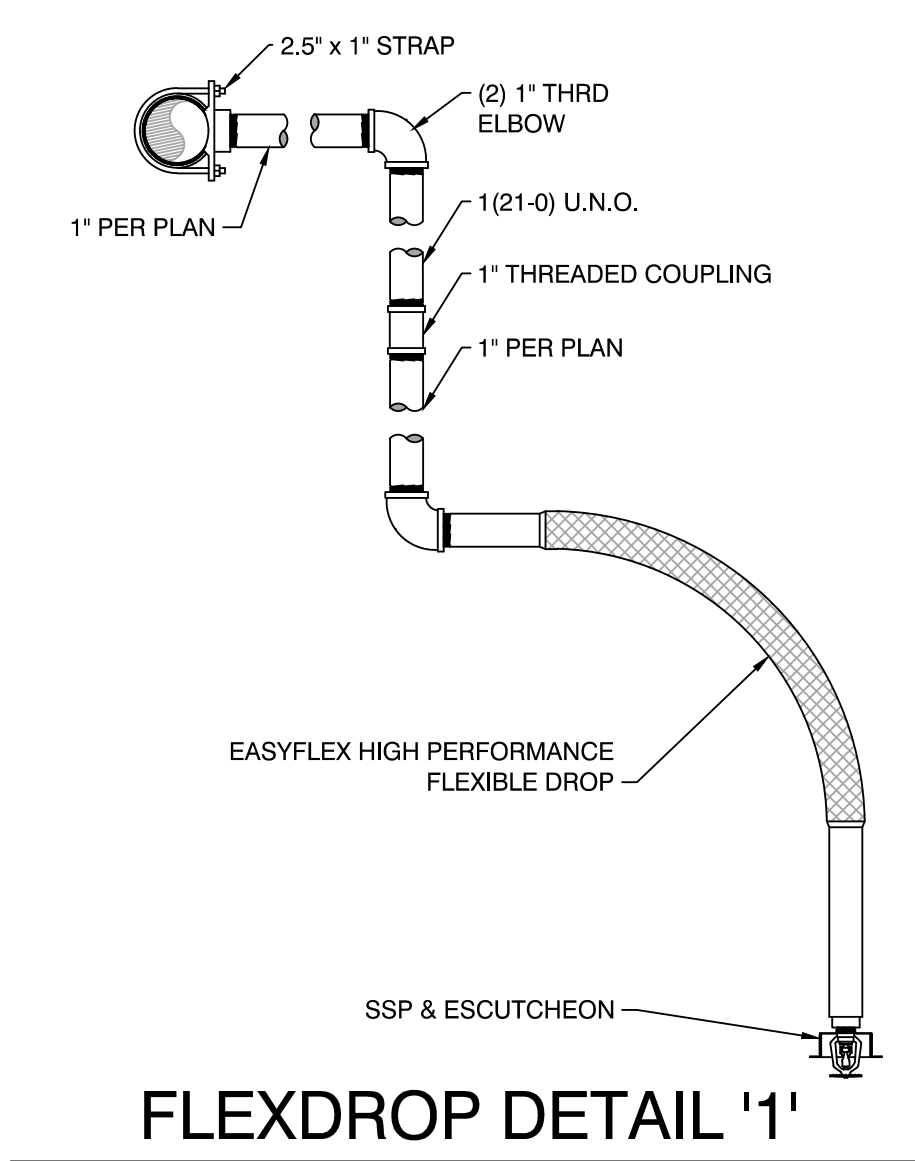

FLEXDROP DETAIL '1'

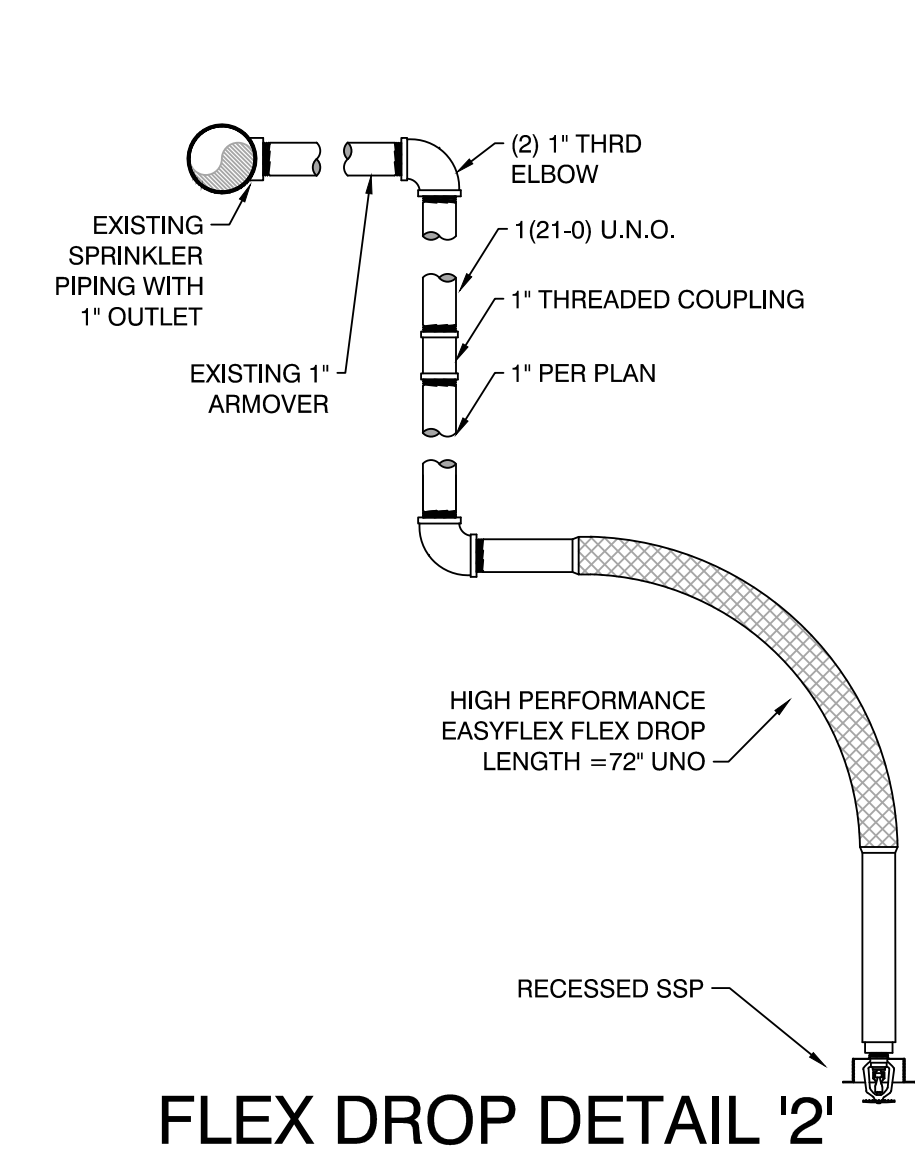

FLEX DROP DETAIL '2'

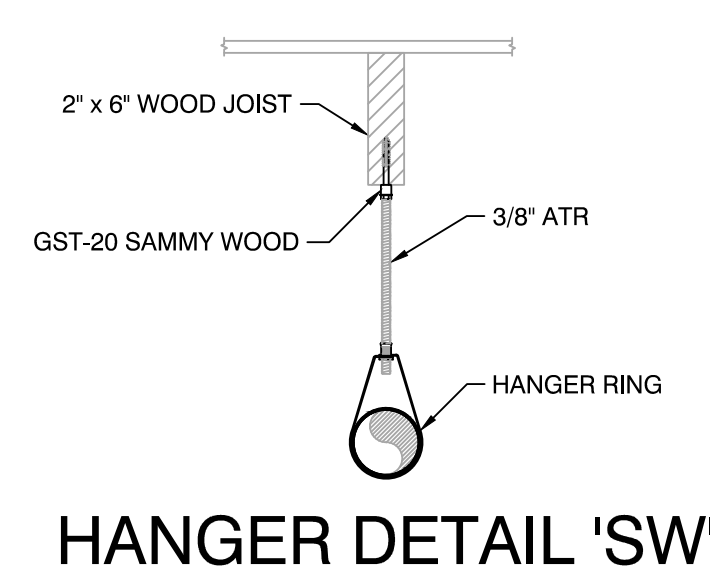

HANGER DETAIL 'SW'

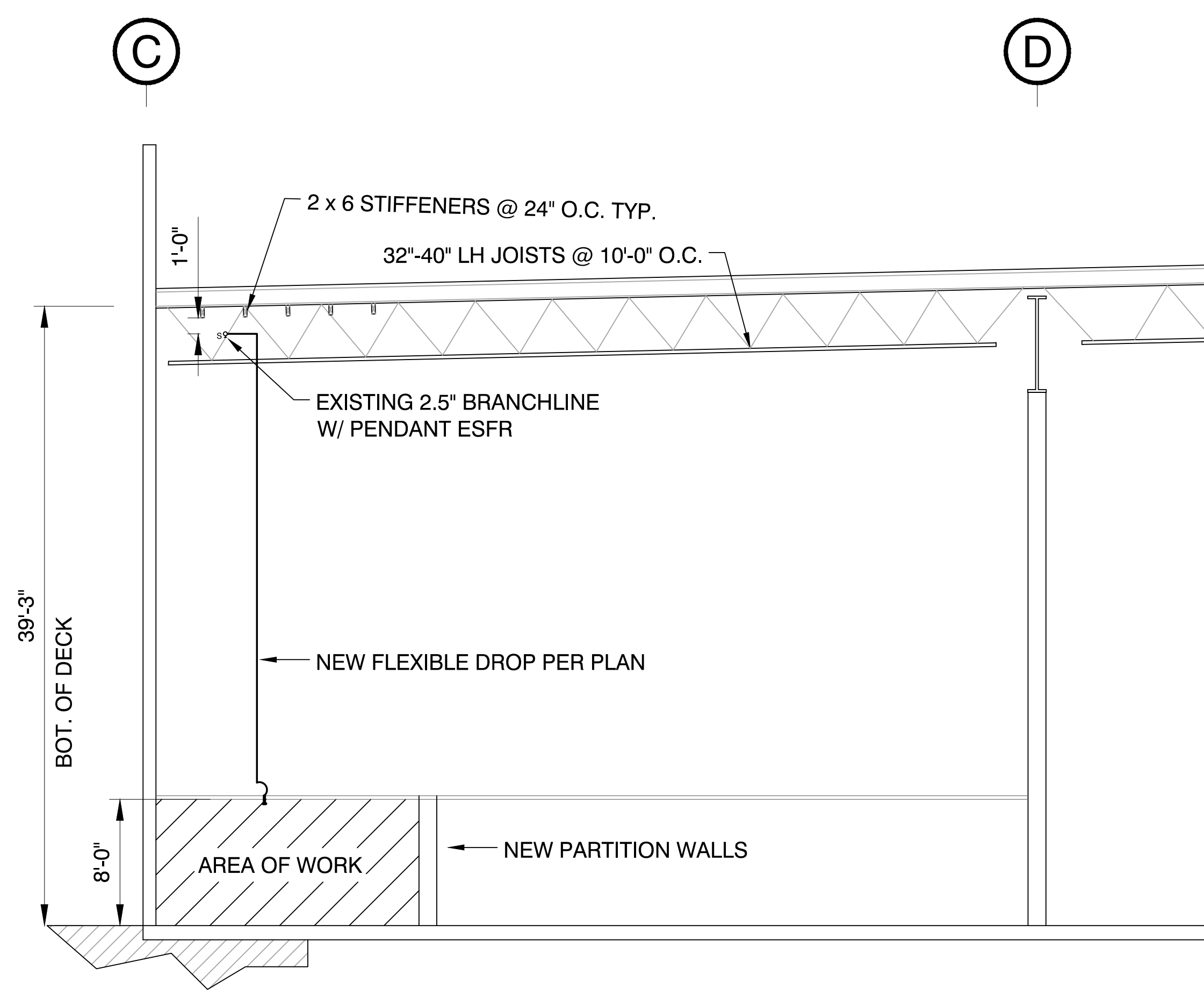

BUILDING SECTION A

NTS

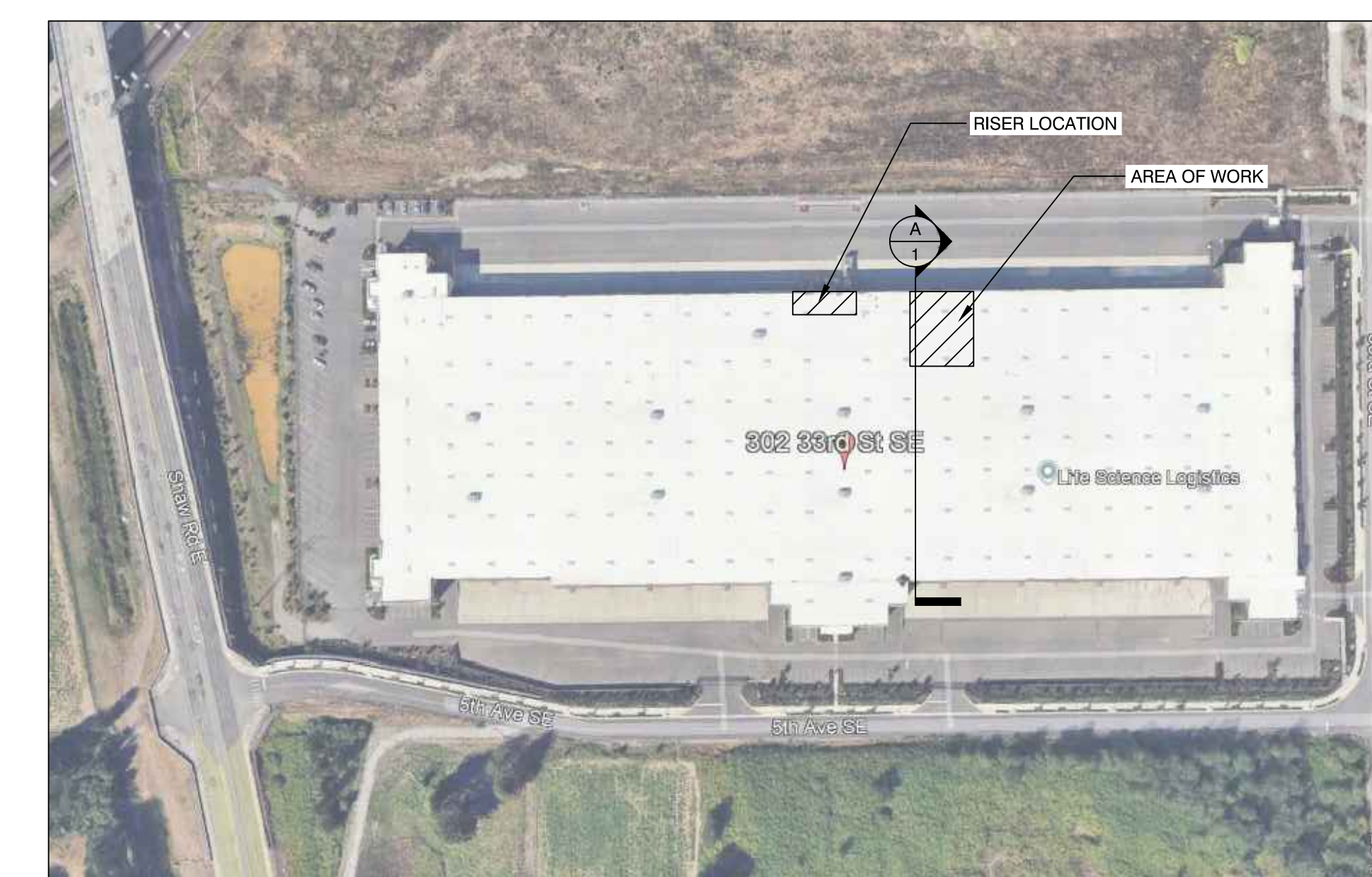

SITE PLAN

NTS

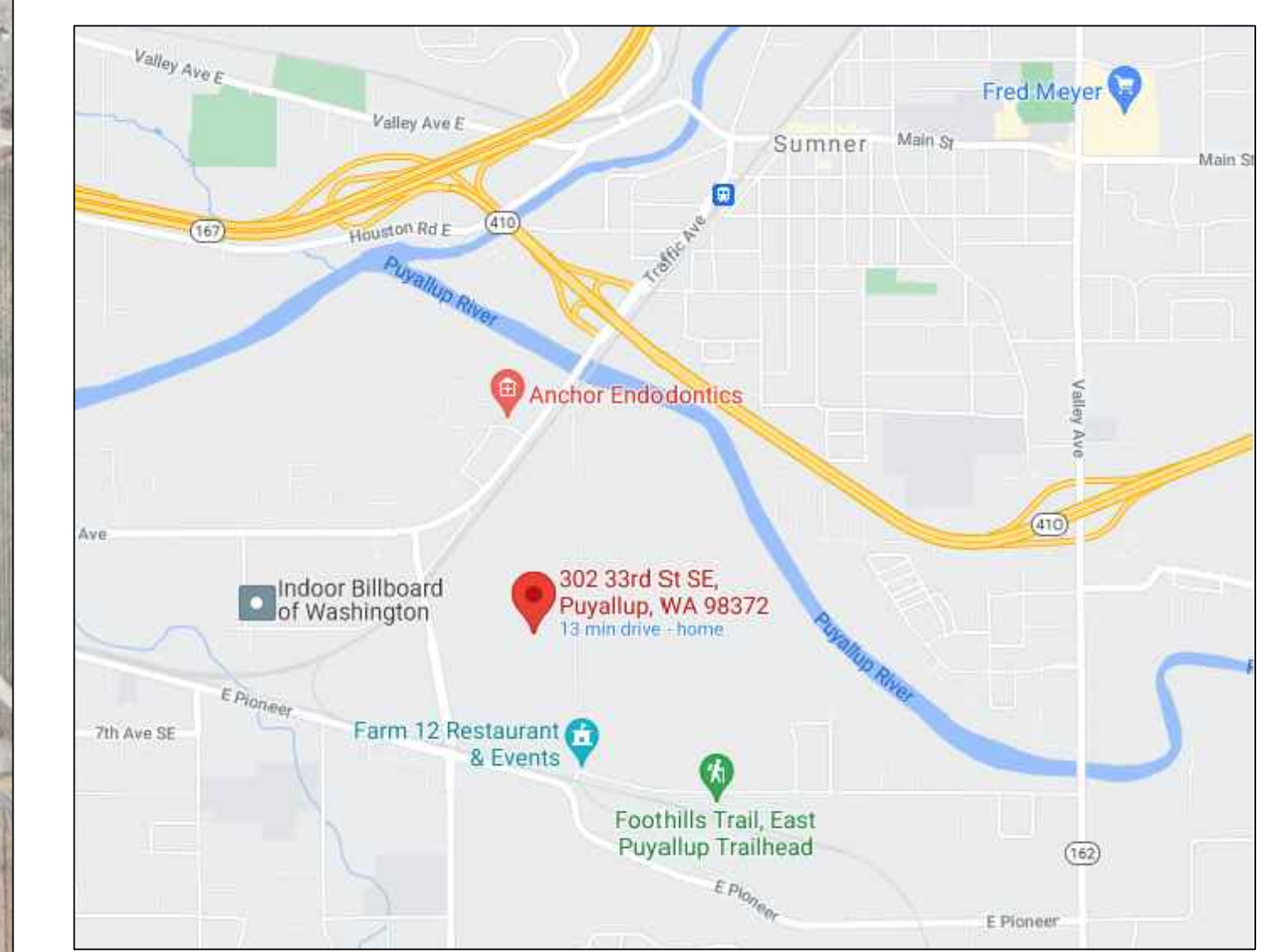

AREA MAP

NTS

City of Puyallup  
Fire  
REVIEWED FOR COMPLIANCE

THE APPROVED CONSTRUCTION PLANS AND ALL ENGINEERING MUST BE POSTED ON THE JOB AT ALL INSPECTIONS IN A VISIBLE AND READILY ACCESSIBLE LOCATION.

Approval of submitted plans is not an approval of omissions or oversight by this office or noncompliance with any applicable regulations of local government. The contractor is responsible for making sure that the building complies with all applicable building codes and regulations of the local government.

City of Puyallup  
Development & Permitting Services  
ISSUED PERMIT

Building	Planning
Engineering	Public Works
Fire	Traffic

ABBREVIATIONS	SYMBOL LEGEND
AFV ABOVE FINISHED FLOOR	(12) CENTERLINE OF PIPE TO REFERENCED STRUCTURE IN INCHES
BOB BOTTOM OF BEAM	NEW 1" PLUG
BOB BOTTOM OF DECK	NEW 1/2" PLUG
BOB BOTTOM OF JOIST	LETTER INDICATES TYPE
BOB BOTTOM OF PURLIN	2-WAY EARTHQUAKE SWAY BRACE
BOB BOTTOM OF TRUSS	LETTER INDICATES TYPE
CTS CUT TO SIZE	NEW STRAP OUTLET
FD FIELD DIMENSION	NEW MECHANICAL TEE OUTLET
FROM INSIDE FACE OF WALL	RELOCATED EXISTING SPRINKLER
FROM OUTSIDE FACE OF WALL	RELOCATED EXISTING SPRINKLER
NAS NO AUTO SPRINKLERS	NEW FULL HEIGHT WALL
NIC NOT IN CONTRACT	NEW LOW WALL
NCE NOT EXISTING	NEW SOFFIT WALL
NCE NOT EXISTING	
ONE ONE END	
THRO THROUGH	

SYMBOL LEGEND	PIPE LEGEND
(12) CENTERLINE OF PIPE TO REFERENCED STRUCTURE IN INCHES	NEW SPRINKLER PIPE
NEW 1" PLUG	EXISTING SPRINKLER PIPE
NEW 1/2" PLUG	RELOCATED EXISTING PIPE
LETTER INDICATES TYPE	NEW FLEXDROP
2-WAY EARTHQUAKE SWAY BRACE	RELOCATED EXISTING FLEX
LETTER INDICATES TYPE	
NEW STRAP OUTLET	
NEW MECHANICAL TEE OUTLET	
RELOCATED EXISTING SPRINKLER	
RELOCATED EXISTING SPRINKLER	
NEW FULL HEIGHT WALL	
NEW LOW WALL	
NEW SOFFIT WALL	

PIPE LEGEND	FLEX LEGEND
NEW SPRINKLER PIPE	ACT = STANDARD OSSB BRACKET
EXISTING SPRINKLER PIPE	GWB = T-BAR, OTBS ENDS, AND OSSB CLAMP
RELOCATED EXISTING PIPE	HCB = T-BAR, HCB ENDS, AND OSSB CLAMP
NEW FLEXDROP	HCB = T-BAR, OTBS ENDS, AND OSSB CLAMP
RELOCATED EXISTING FLEX	TEK = (2) 1/4"x1/2" TEK SCREW
	WDS = (2) #10x1.5" WOOD SCREW
	90"x1/2" = 90° NIPPLE 6" LONG
	9"x1/2" = 9" LONG x 1/2" EXTENDED NIPPLE

WALL LEGEND		SPRINKLER LEGEND	
EXISTING WALL		EXISTING	
NEW WALL TO CEILING		NEW	
NEW FULL HEIGHT WALL		RELIABLE	RA1414
NEW LOW WALL		RELIABLE	RA7216
NEW SOFFIT WALL			

NO.	DATE	BY	REASON FOR REVISION
1	09/22/25	YC	COMMENT FROM AHJ

BUILDING INFORMATION	
MAINTENANCE CONTACT:	
ALARM COMPANY:	
ALARM PHONE:	
ALARM CODE:	
ALARM PASSWORD:	
FIRE DEPARTMENT:	
FIRE DEPT. PHONE:	

CONTRACT WITH:	
CONTRACTOR NAME	SMITH FIRE SYSTEMS, INC.
STREET ADDRESS	1106 54th AVE EAST
CITY, STATE, ZIP	TACOMA, WA 98424
CONTR. REG. NO.	SMITHS13607
PHONE:	(253) 828-1880
FAX:	(253) 828-2350

MARSHAL OFFICE TI	
DESIGNER	YIU CHEN
PROJECT MGR	LANE L.
DATE	09/22/2025
SHEET	1 OF 1
JOB NO.	T125061