

TEMPORARY TRAFFIC CONTROL PLAN

All proposed franchise utilities shall be located within a recorded utility easement or in the public right-of-way as determined by the City of Puyallup. The City of Puyallup does not authorize or permit utility work on private property.

Work shall immediately cease in the work zone for a pedestrian spotter, available at all times, to escort pedestrians around the work area.

City of Puyallup
Development & Permitting Services
ISSUED PERMIT

Building	Planning
Engineering	Public Works
Fire	Traffic

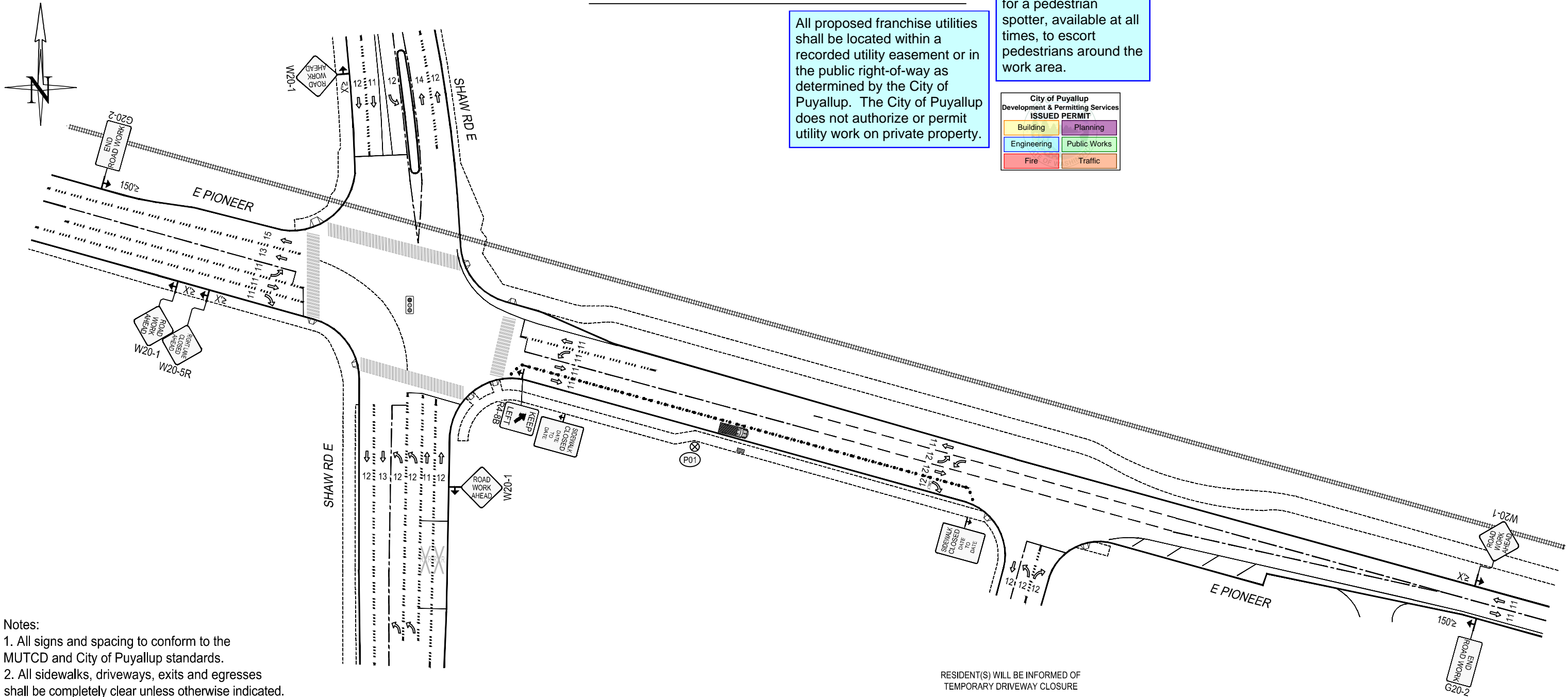

- Notes:
1. All signs and spacing to conform to the MUTCD and City of Puyallup standards.
 2. All sidewalks, driveways, exits and egresses shall be completely clear unless otherwise indicated.
 3. Channelizing devices are 28" traffic cones. Use traffic drums (barrels) with steady burning Type C lights on all State Routes and Hwys.
 4. Sign size can be a minimum of 36" x 36" and shall not obstruct pedestrian access.
 5. Crew is required to leave a minimum of 11' for traveling lane width.
 6. Alert affected residents and businesses.
 7. Work to take place during approved work hours. (Generally between 9 a.m. and 4 p.m. on non-arterials and from 9 a.m. to 3 p.m. on arterials. If night time work is approved, Night time work to take place between _____ and _____.)
 8. Flaggers shall remain in radio contact at all times.
 9. All Flagger and Downstream tapers shall be 50'-100'.
 10. Work area will be 41' South of CL of E Pioneer & 270' East of CL of Shaw Rd E.

LEGEND

	WORK PIT
	28" TRAFFIC CONE
	TRAFFIC FLOW
	WORK VEHICLE/ FLASHING LIGHTS
	SIGN LOCATION
	RIGHT OF WAY
	WORK AREA
	CHEVRON ARROW BOARD
	UNIFORMED POLICE OFFICER
	FLAGGER

$$L = \frac{W \cdot S^2}{60}$$

SIGN SPACING	
MPH	"X"
60/65	1000'
45/55	500'
35/40	350'
25/30	100'

DISTANCE BETWEEN CONES EQUALS SPEED LIMIT IN UNIT FEET. TAPER LENGTHS EQUALS WIDTH OF OFFSET (LANE WIDTH) TIMES SPEED SQUARED DIVIDED BY 60. SIGN SPACING SHALL BE 350' WHEN THE SPEED LIMIT IS GREATER THAN 30 MPH. DISTANCE BETWEEN SIGNS IS MANDATORY UNLESS FIELD CONDITIONS DETERMINE OTHERWISE.

ALL EQUIPMENT AND WORKERS MUST BE OUT OF THE ROW PRIOR TO 3 P.M. NO EXCEPTION

PUGET SOUND ENERGY

Contact:
John Crofoot
425-424-6658
John.Crofoot@pse.com

Project Address:
3002 E PIONEER, PUYALLUP, WA

MINIMUM TAPER LENGTH=L (FT.)											
LANE WIDTH	POSTED SPEED (MPH)										
	20	25	30	35	40	45	50	55	60	65	70
10	70	105	150	205	270	475	500	550	-	-	-
11	75	115	165	225	295	495	550	605	660	-	-
12	80	125	180	245	320	540	600	660	720	780	840

Puget Sound Energy
Traffic Control Supervisor:
Jason Bisenius
Card No. ES2 000394
Card Exp. 01/31/2028
Jason.Bisenius@pse.com
(425)424-7316

10/20/2025	REV 0
Job # 515418174/107063979	
Page	1 OF 1