

PRFUP202200191f  
 east bound traffic is  
 required to move  
 into the west bound  
 lane use TCP No.  
 01 (attached)

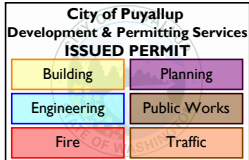

Distance between cones equals speed limit in unit feet  
 Taper length equals width of offset times speed squared divided by 60  
 Sign spacing shall be 100 feet when speed limits is 30 MPH or less  
 Sign spacing shall be 350 feet when speed limit is greater than 30 MPH  
 Distance between signs is mandatory unless field conditions determine otherwise

**CLOSURE ALLOWED:**  
 Monday - Friday  
 9AM - 3PM  
 Call communications center  
 at 253-287-4456 on day of  
 closure.

### NOTES:

- 1 FOR TWO-WAY TRAFFIC WORK ZONES
- 2 FLAGGERS SHALL REMAIN IN RADIO CONTACT AT ALL TIMES
- 3 TRAFFIC CONTROL DEVICES SHALL BE 28" RETROREFLECTIVE CONES
- 4 USE "BE PREPARED TO STOP" SIGN BETWEEN "FLAGGER AHEAD" AND "LANE CLOSED AHEAD" SIGNS ON HIGH VOLUME ROADS, SUCH AS:  
 43RD AVE SE, 9TH ST SW, 5TH ST SW, SHAW RD, AND OTHER STREETS WITH COMPARABLE VOLUMES
- 5 SIGN SPACING SHALL BE 350 FEET WHEN SPEED LIMIT IS GREATER THAN 30 MPH
- 6 SIGN SPACING SHALL BE 100 FEET WHEN SPEED LIMIT IS 30 MPH OR LESS
- 7 CALL COMM CENTER DAY OF CLOSURE 841-5431
  - 7.1 CLOSURE FOR WEEKDAYS ONLY
  - 7.2 TIMES: 9:00 AM TO 3:00 PM
- 8 DISTANCE BETWEEN CONES EQUALS SPEED LIMIT IN UNITS OF FEET

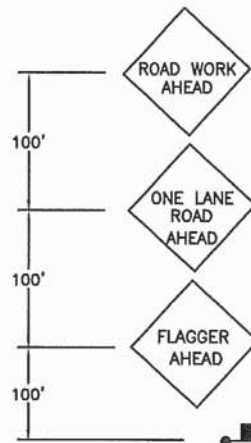

NAME OF STREET: \_\_\_\_\_

SEE NOTE #8



END  
 ROAD WORK



**CITY OF  
 PUYALLUP  
 TRAFFIC  
 ENGINEERING  
 DIVISION**

## LANE CLOSURE ON TWO-LANE ROAD USING FLAGGERS

DRAWN J. HUNTER	PLOTTING SCALE NTS/ 1=1	DATE APPROVED 04-03	REVISED 09-30-09	TCP STANDARD
FILE NAME I:\DRAWINGS\PUBLIC WORKS\TRAFFIC\TCP	CHECKED BY M. FORD	REVISED BY S. TANDLE	NO. 7	