



# City of Puyallup Application for Building Permit

**333 S. Meridian  
Puyallup, WA 98371  
Tel: (253) 864-4165  
[permitcenter@ci.puyallup.wa.us](mailto:permitcenter@ci.puyallup.wa.us)**

**PRCTI20220474**

|   |  |  |  |
|---|--|--|--|
| Parcel No: 0420222056, 0420222055, 0420226014, 0420226015 |  | Site Address: 407 Valley Ave NE Puyallup, WA 98372 |  |
| 0420226016 & 0420222051, 0420226013                       |  |  |  |
| Owner Name: Meridian Pointe Apartments, LLC               | Tel: 206-241-4800  |  |  |
| Owner Address: 17786 Des Moines Memorial Dr.              | City: Burien, WA   | Zip: 98148   |  |
| Contractor Name: Farrell-McKenna Construction, LLC        | Tel: 206-241-2600  |  |  |
| Contractor Address: 17786 Des Moines Memorial Dr.         | City: Burien, WA   | Zip: 98148   |  |
| WA State License: FARREC*005L6                            | Exp Date: 6/24/22  | City Business License: Yes - Exp 11/30/22          |  |
| Contact Name: Sean McKenna                                | Email: Sean@farrellpi.com                                |  |  |
| Contact Tel: 206-241-2600                                 | Fax: 206-241-2600  |  |  |
| Lender Name: PNC Real Estate / Midland Loan Services      | Address: 10851 Mastin Ste 700<br>Overland Park, KS 66210 | Tel: 913-253-9438                                  |  |

**Project Description:** Interior Unit Building Renovation - BUILDING 'F' 102/202/302 Unit Stack  
 If the project disturbs one acre or more, the applicant must apply for a NPDES Construction stormwater general permit from the Department of Ecology. For additional information visit DOE website [www.ecy.wa.gov/programs/wq/stormwater/construction](http://www.ecy.wa.gov/programs/wq/stormwater/construction)

### ***Building Permit Information***

|                                |                     |                         |   |
|--------------------------------|---------------------|-------------------------|---|
| COMMERCIAL OR RESIDENTIAL      | Commercial          | TYPE OF CONSTRUCTION    | Type V - 1 Hr                                 |
| OCCUPANCY TYPE                 | R-2                 | FIRST FLOOR SQ. FT.     | 3,862 gross SF                                |
| OCCUPANCY LOAD                 | 12                  | SECOND FLOOR SQ. FT.    | including Decks,<br>Storage and<br>Breezeways |
| # OF DWELLING UNITS            | 3                   | BASEMENT SQ. FT.        |   |
| # OF BEDROOMS                  | 6                   | GARAGE SQ. FT.          |   |
| # OF BATHROOMS                 | 6                   | COVERED PORCH SQ. FT.   |   |
| BUILDING HEIGHT                |                     | PATIO SQ. FT.           |   |
| ZONING                         | 1305 - Multi Family | DECK SQ. FT.            |   |
| LOT SIZE SQ. FT.               |                     | HEAT TYPE               | Electric                                      |
| LOT COVERAGE: (%)              |                     | CHANGE OF USE?          | No  |
| IMPERVIOUS SURFACE SQ. FT.     |                     | AIR CONDITIONED?        | No  |
| PROJECT DISTURBED AREA SQ. FT. |                     | FIRE SPRINKLERS?        | Yes   |
| SEWER OR SEPTIC                | Sewer               | LOCATED IN FLOOD PLAIN? |   |
| WATER PURVEYOR                 |                     | <b>VALUATION</b>        | <b>\$ 36,539.71</b>                           |

**I HEREBY CERTIFY THAT I HAVE READ AND EXAMINED THIS APPLICATION AND KNOW THE SAME TO BE TRUE AND CORRECT. ALL PROVISIONS OF LAWS AND ORDINANCES GOVERNING THIS TYPE OF WORK WILL BE COMPLIED WITH WHETHER SPECIFIED HEREIN OR NOT.**

**BY LEAVING THE CONTRACTOR INFORMATION SECTION BLANK, I HEREBY CERTIFY FURTHER THAT CONTRACTORS (GENERAL OR SUBCONTRACTORS) WILL NOT BE HIRED TO PERFORM ANY WORK IN ASSOCIATION WITH THIS PERMIT. I ALSO CERTIFY THAT IF I DO CHOOSE TO HIRE A CONTRACTOR (GENERAL OR SUBCONTRACTOR) I WILL ONLY HIRE THOSE CONTRACTORS THAT ARE LICENSED BY THE STATE OF WASHINGTON.**

[Handwritten Signature]

**SIGNATURE OWNER / AUTHORIZED AGENT**

Sean McKenna, Manager

**PRINT NAME**

3/9/22

**DATE**

# **MECHANICAL**

| Quantity Scheduled | Description   | Permit Rate Per Unit | Total Price   |
|--------------------|---|----------------------|---------------|
| 3                  | <b>Permit Issuance</b>                                    | <b>40.00</b>         | <b>120.00</b> |
|                    | Supplemental Permit                                       | 9.60                 |               |
|                    | AC Unit – Stand Alone                                     | 19.55                |               |
|                    | Install Furnace / Burner up to 100,000 BTU                | 19.55                |               |
|                    | Install Furnace / Burner over 100,000 BTU                 | 24.00                |               |
|                    | Install / Relocate Floor Furnace & Vent                   | 19.55                |               |
|                    | Install / Relocate Recessed Wall Space Heater             | 19.55                |               |
|                    | Appliance Vent – Separate                                 | 9.60                 |               |
|                    |   |                      |               |
|                    | Repair Heating / Cooling Unit                             | 18.11                |               |
|                    |   |                      |               |
|                    | Heat Pump/Boiler / Compress. 3 HP; up to 6 Tons; 100,000  | 19.55                |               |
|                    | Heat Pump/Boiler / Compress. 3-15 HP or 500,000 BTU       | 35.95                |               |
|                    | Heat Pump/Boiler / Compress 15-30 HP or 1,000,000 BTU     | 49.28                |               |
|                    | Heat Pump/Boiler / Compress 30-50 HP or 1,750,000 BTU     | 73.30                |               |
|                    | Heat Pump/Boiler / Compress over 50 HP or over 1,750,000  | 122.48               |               |
|                    |   |                      |               |
|                    | Separate Air Handling Unit to 10,000 CFM                  | 14.10                |               |
|                    | Separate Air Handling Unit over 10,000 CFM                | 23.92                |               |
|                    | Stationary Evaporative Cooler                             | 14.10                |               |
|                    |   |                      |               |
| 6                  | Exhaust Vent Fan with Single Duct (Bath Fan)              | 14.10                | 84.60         |
|                    | Vent System Apart from Heating or AC                      | 14.10                |               |
|                    | Mechanical Exhaust Hood / Duct (Range Hood) - Residential | 14.10                |               |
|                    | Mechanical Exhaust Hood w/Make-up Air - Commercial        | 35.95                |               |
|                    |   |                      |               |
|                    | Commercial / Industrial Incinerator                       | 24.00                |               |
|                    |   |                      |               |
|                    | Gas Piping: (1 - 4 outlets)                               | 6.30                 |               |
|                    | (5 or more outlets / per outlet)                          | 1.30                 |               |
|                    |   |                      |               |
|                    | Unclassified Appliance or Equipment (Fireplace, etc.)     | 14.10                |               |
|                    |   |                      |               |
|                    | Mechanical Duct Work: (1 – 5 Diffusers)                   | 14.10                |               |
|                    | (6 – 10 Diffusers)  | 19.55                |               |
|                    | (11 or more Diffusers)                                    | 24.00                |               |
|                    |   |                      |               |
| <b>TOTAL:</b>      |   |                      | <b>204.60</b> |

# PLUMBING

| Quantity Scheduled | Description                                  | Rate Per Unit | Total  | Quantity Scheduled | Description                    | Rate Per Unit | Total  |
|--------------------|--|---------------|--------|--------------------|--------------------------------|---------------|--------|
| 3                  | Permit Issuance                              | 40.00         | 120.00 |                    | <b>GREASE TRAP/INTERCEPTOR</b> |               |        |
|                    | <b>RESIDENTIAL (1 &amp; 2 DWELLINGS)</b>     |               |        |                    | Grease Trap                    | 13.00         |        |
|                    | 1 Bathroom                                   | 160.00        |        |                    | Grease Interceptor             | 13.00         |        |
|                    | 2 Bathroom                                   | 200.00        |        |                    | <b>BACK FLOW DEVICE</b>        |               |        |
|                    | 3 Bathroom                                   | 240.00        |        |                    | Per Unit                       | 26.00         |        |
|                    | Alterations <b>each fixture</b>              | 13.00         |        |                    | <b>MEDICAL GAS SYSTEM</b>      |               |        |
|                    | Water Heater                                 | 13.00         |        |                    | Medical Gas Piping System      | 80.00         |        |
|                    | <b>***COMMERCIAL***</b>                      |               |        |                    | Surgical Vacuum System         | 80.00         |        |
|                    | New Const. <b>each fixture</b>               | 13.00         |        |                    | Gas Piping: (1 - 4 outlets)    | 8.50          |        |
|                    |  |               |        |                    | (5 or more outlets/per outlet) | 2.00          |        |
| 15                 | Alterations <b>each fixture</b>              | 13.00         | 195.00 |                    | Dental Chair or Unit           | 40.25         |        |
|                    | Drinking Fountain, Water Cooler, Ice Machine | 40.25         |        |                    | <b>OTHER (NOT LISTED)</b>      |               |        |
|                    | Sump, Sewage Ejector Pump                    | 13.00         |        |                    |                                |               |        |
| 3                  | Garbage Disposal                             | 13.00         | 39.00  |                    |                                |               |        |
| 3                  | Water Heater                                 | 13.00         | 39.00  |                    |                                |               |        |
|                    | <b>SUB-TOTAL:</b>                            |               | 393.00 |                    | <b>SUB-TOTAL:</b>              |               |        |
|                    |  |               |        |                    | <b>TOTAL:</b>                  |               | 393.00 |

**\*\*\*COMMERCIAL PROJECTS: Please complete "System Development Calculation Sheet" \*\*\***

A water availability/approval letter shall be submitted with this application for any property located outside the city's water service area.

Fruitland Mutual Water Co. – (253) 848-5519 / Valley Water Co. – (253) 841-9698 / Tacoma Water Co. – (253) 502-8600

## Plan Submittal Checklist for Single Family Residence

- 2 (two) copies of a site plan, drawn to scale on 8½" x 11". Details to include setbacks, easements, other structures & features, adjacent right-of-way, drive access, septic and/or utility lines, and contours of slopes over 15% grade at 2-foot intervals.
  - 2 (two) sets of plans (**Engineer or Architect Stamped** on all sheets)
    - Foundation Plan: footing size, wall height, section & reinforcing. Provide design calculations for basement walls that are not supported by concrete cross walls spaced per table 404.1b.
    - Floor plan with room use identified  Floor framing plan for each floor (post & beam or joist w/ size & spacing)  Ceiling/roof framing plan or truss layout w/ reactions from truss manufacturer  Truss layout with hanger and reactions for girder/carrier trusses  Truss drawings for TJI's or BCI's  Truss specifications packet **Engineer Stamped**
    - Window & door sizes, header sizes, U-values
    - Complete building sections - special sections (show floor, wall & ceiling height, insulation R-value of floors, walls & ceilings. Show sections through stairs - headroom)
    - Construction details (i.e. structural members, insulation, sheathing, siding, roofing, bracing, dimensions, etc.)
    - Exterior porches & decks (resistance to decay including support footings)
    - Special equipment (fireplace, woodstove, hydro-massage tub, etc.)
    - Location of all smoke detectors
    - Handrail/guardrail details for stairs, landings, decks
  - Energy Worksheets: <http://www.energy.wsu.edu/BuildingEfficiency/EnergyCode.aspx>
  - 2 (two) sets Engineering plans/calculations for special conditions – **Engineer stamped**
    - Basement & retaining walls 4 feet and higher  Beams supporting combined roof & floor loads  Beams supporting other beams or girder trusses  Shear walls when bracing not provided as required.
  - If less than 2,000 square feet of new + replaced hard surface: submit a temporary sediment and erosion control plan per the 2014 update to the 2012 Stormwater Management Manual for Western Washington
  - If greater than 2,000 square feet of new + replaced hard surface: submit a Stormwater site plan, report and temporary sediment and erosion control plan and report that satisfy the 2014 update to the 2012 Stormwater Management Manual for Western Washington and City standards
  - Plan Review Fee
- 

## Plan Submittal Checklist for Commercial Projects

- 2 (two) copies of a site plan, drawn to scale on 8½" x 11". Details to include setbacks, easements, soil reports, other structures & features, adjacent right-of-way, drive access, septic and/or utility lines, and contours of slopes over 15% grade at 2-foot intervals, Fire Department access and hydrants, and names of adjacent streets.
- 2 (two) complete sets of plans. (**Engineer or Architect Stamped** on all sheets)
- 2 (two) sets of structural calculations – **Engineer Stamped**
- 1 (one) set of specifications
- Driveways, sidewalks, parking, and accessible routes
- Exterior elevations  Complete building sections - special sections
- Building code summary  Proposed use  Construction Type  Occupancy Group Classification  Allowable Area  Actual Area  Dimension yard width on site plan where used for allowable area increase.
- Occupant load calculations and exiting, including exit width calculations
- Energy worksheets including envelope calculations, HVAC, and lighting budget
- Foundation plan including footing sizes, wall heights, cross-sections and reinforcing  Floor plan with room use identified for each floor  Floor framing plan each floor (slab, post & beam or joist)  Ceiling/roof framing plan or truss layout with girder truss reactions
- Window & door sizes, header sizes, and U-Values
- Construction details (i.e. structural members, insulation, sheathing, roofing, diaphragms, shear walls)
- Handrail / guardrail / stair details (with headroom) for stairs and landings
- Smoke detectors, fire alarm, sprinkler system details (if required)
- Engineering for special conditions (truss, basement, retaining walls, shear walls, lateral bracing, load transfer etc.)
- Plumbing plans including layout and fixture count - **Plumbing Fixture Worksheet is required with plumbing plans**
- Special equipment (Kitchen, HVAC, Boiler, fireplace, woodstove, etc.)
- Mechanical plans including layout, location and make/model of equipment
- Traffic Scoping Worksheet
- Plan Review Fee

**CFP LEGEND**

- WALLS/DOORS
- FINISHES
- DETAILING
- SCHEMATIC
- FINISHES

**GENERAL FINISH NOTES**

1. SEE FINISH SCHEDULE
2. FINISHES ARE NECESSARY FOR SCHEDULED TRADES
3. FINISHES ARE NECESSARY FOR ALL TRADES
4. CONTRACTOR IS RESPONSIBLE TO VERIFY ALL FINISHES TO BE USED AND TO OBTAIN ALL NECESSARY APPROVALS FROM THE ARCHITECT AND ALL APPLICABLE AGENCIES PRIOR TO CONSTRUCTION. FINISHES MUST BE OF A QUALITY AND TYPE THAT MEET THE DESIGN INTENT AND ALL APPLICABLE AGENCIES.
5. ALL ITEMS TO BE CONTRACTOR PROVIDED UNLESS OTHERWISE NOTED.
6. FINISHES ARE SUBJECT TO CHANGE WITHOUT NOTICE.
7. FINISHES ARE SUBJECT TO CHANGE WITHOUT NOTICE.
8. FINISHES ARE SUBJECT TO CHANGE WITHOUT NOTICE.
9. FINISHES ARE SUBJECT TO CHANGE WITHOUT NOTICE.
10. FINISHES ARE SUBJECT TO CHANGE WITHOUT NOTICE.

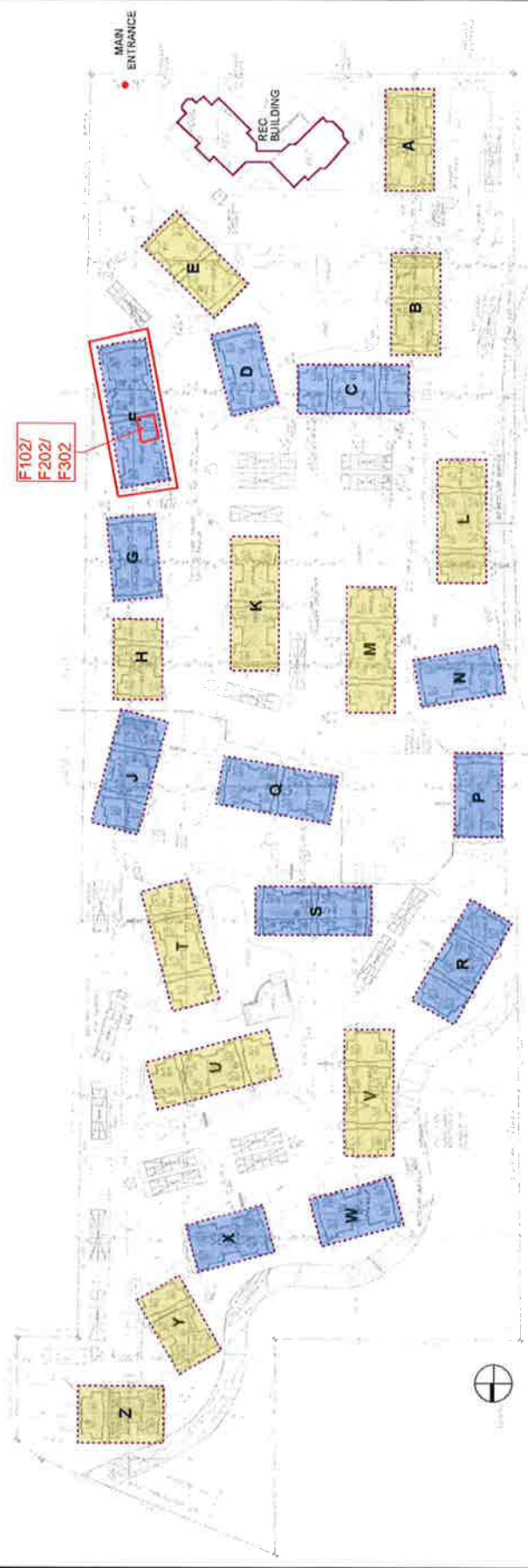

|  |          |
|--|----------|
| PROJECT  | J.B.     |
| DATE   | 04/20/20 |
| SCALE  | AS SHOWN |
| <b>SITE PLAN:<br/>BUILDING<br/>SCHEME PLAN</b> |          |
| DATE   | 3/25/20  |
| PROJECT NUMBER                                 |          |

**ID0.1**

① SITE PLAN - BUILDING SCHEME PLAN  
SCALE: NONE