

N

PRUSR20220749

- A. Excavation location
 - B. 4" pvc clean out
 - C. Tables & Benches
- P = Parking

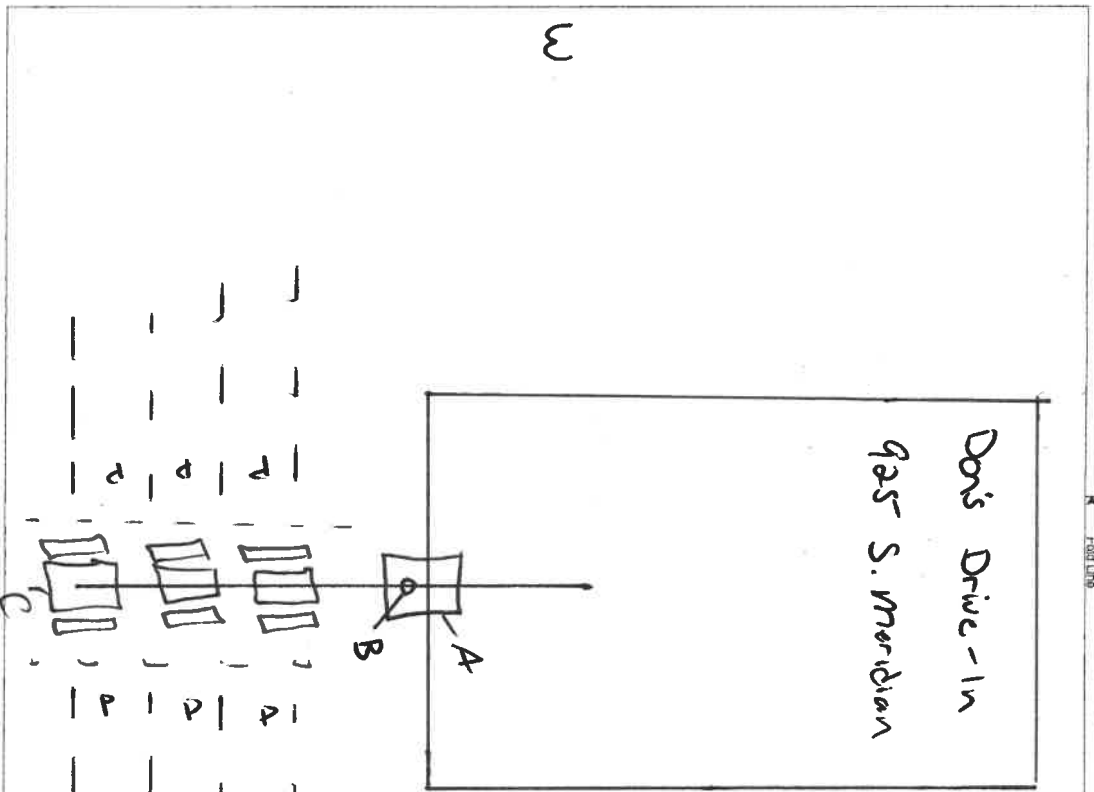

The applicant shall request an inspection with a City Engineering Inspector through the CityView portal least 48 hours in advance of job start.

THE APPLICANT IS RESPONSIBLE TO SCHEDULE ALL UTILITY INSPECTIONS PRIOR TO BACKFILLING.

City of Puyallup
Development
Engineering
APPROVED

See permit for additional requirements.

Linda Lian
05/11/2022
10:39:33 AM



Site Plan Template
City of Puyallup Development Center
333 S Meridian, Puyallup, WA 98371; 253-964-4165

Property Owner _____

Parcel Number _____
Site Address _____

925 S. Meridian

Sheet _____
of _____
Sheet _____

S

E