



City of Puyallup Application for Building Permit

PRCTI20220799

**333 S. Meridian
Puyallup, WA 98371
Tel: (253) 864-4165
permitcenter@ci.puyallup.wa.us**

Parcel No: 0420222056, 0420222055, 0420226014, 0420226015 0420226016 & 0420222051, 0420226013		Site Address: 407 Valley Ave NE Puyallup, WA 98372	
Owner Name: Meridian Pointe Apartments, LLC	Tel: 206-241-4800		
Owner Address: 17786 Des Moines Memorial Dr.	City: Burien, WA	Zip: 98148	
Contractor Name: Farrell-McKenna Construction, LLC	Tel: 206-241-2600		
Contractor Address: 17786 Des Moines Memorial Dr.	City: Burien, WA	Zip: 98148	
WA State License: FARREC*005L6	Exp Date: 6/24/22	City Business License: Yes - Exp 11/30/22	
Contact Name: Sean McKenna	Email: Sean@farrellpi.com		
Contact Tel: 206-241-2600	Fax: 206-241-2600		
Lender Name: PNC Real Estate / Midland Loan Services	Address: 10851 Mastin Ste 700 Overland Park, KS 66210	Tel: 913-253-9438	

Project Description: Interior Unit Building Renovation - BUILDING 'B' 104/204 Unit Stack If the project disturbs one acre or more, the applicant must apply for a NPDES Construction stormwater general permit from the Department of Ecology. For additional information visit DOE website www.ecy.wa.gov/programs/wq/stormwater/construction

Building Permit Information

COMMERCIAL OR RESIDENTIAL	Commercial	TYPE OF CONSTRUCTION	Type V - 1 Hr
OCCUPANCY TYPE	R-2	FIRST FLOOR SQ. FT.	2,040 gross SF
OCCUPANCY LOAD	8	SECOND FLOOR SQ. FT.	including Decks, Storage and Breezeways
# OF DWELLING UNITS	2	BASEMENT SQ. FT.	
# OF BEDROOMS	2	GARAGE SQ. FT.	
# OF BATHROOMS	2	COVERED PORCH SQ. FT.	
BUILDING HEIGHT		PATIO SQ. FT.	
ZONING	1305 - Multi Family	DECK SQ. FT.	
LOT SIZE SQ. FT.		HEAT TYPE	Electric
LOT COVERAGE: (%)		CHANGE OF USE?	No
IMPERVIOUS SURFACE SQ. FT.		AIR CONDITIONED?	No
PROJECT DISTURBED AREA SQ. FT.		FIRE SPRINKLERS?	Yes
SEWER OR SEPTIC	Sewer	LOCATED IN FLOOD PLAIN?	
WATER PURVEYOR		VALUATION	\$ 20,241.18

I HEREBY CERTIFY THAT I HAVE READ AND EXAMINED THIS APPLICATION AND KNOW THE SAME TO BE TRUE AND CORRECT. ALL PROVISIONS OF LAWS AND ORDINANCES GOVERNING THIS TYPE OF WORK WILL BE COMPLIED WITH WHETHER SPECIFIED HEREIN OR NOT.

BY LEAVING THE CONTRACTOR INFORMATION SECTION BLANK, I HEREBY CERTIFY FURTHER THAT CONTRACTORS (GENERAL OR SUBCONTRACTORS) WILL NOT BE HIRED TO PERFORM ANY WORK IN ASSOCIATION WITH THIS PERMIT. I ALSO CERTIFY THAT IF I DO CHOOSE TO HIRE A CONTRACTOR (GENERAL OR SUBCONTRACTOR) I WILL ONLY HIRE THOSE CONTRACTORS THAT ARE LICENSED BY THE STATE OF WASHINGTON.

[Handwritten Signature]

SIGNATURE OWNER / AUTHORIZED AGENT

Sean McKenna, Manager

PRINT NAME

5/10/22

DATE

MECHANICAL

Quantity Scheduled	Description	Permit Rate Per Unit	Total Price
2	Permit Issuance	40.00	80.00
	Supplemental Permit	9.60	
	AC Unit – Stand Alone	19.55	
	Install Furnace / Burner up to 100,000 BTU	19.55	
	Install Furnace / Burner over 100,000 BTU	24.00	
	Install / Relocate Floor Furnace & Vent	19.55	
	Install / Relocate Recessed Wall Space Heater	19.55	
	Appliance Vent – Separate	9.60	
	Repair Heating / Cooling Unit	18.11	
	Heat Pump/Boiler / Compress. 3 HP; up to 6 Tons; 100,000	19.55	
	Heat Pump/Boiler / Compress. 3-15 HP or 500,000 BTU	35.95	
	Heat Pump/Boiler / Compress 15-30 HP or 1,000,000 BTU	49.28	
	Heat Pump/Boiler / Compress 30-50 HP or 1,750,000 BTU	73.30	
	Heat Pump/Boiler / Compress over 50 HP or over 1,750,000	122.48	
	Separate Air Handling Unit to 10,000 CFM	14.10	
	Separate Air Handling Unit over 10,000 CFM	23.92	
	Stationary Evaporative Cooler	14.10	
2	Exhaust Vent Fan with Single Duct (Bath Fan)	14.10	28.20
	Vent System Apart from Heating or AC	14.10	
	Mechanical Exhaust Hood / Duct (Range Hood) - Residential	14.10	
	Mechanical Exhaust Hood w/Make-up Air - Commercial	35.95	
	Commercial / Industrial Incinerator	24.00	
	Gas Piping: (1 - 4 outlets)	6.30	
	(5 or more outlets / per outlet)	1.30	
	Unclassified Appliance or Equipment (Fireplace, etc.)	14.10	
	Mechanical Duct Work: (1 – 5 Diffusers)	14.10	
	(6 – 10 Diffusers)	19.55	
	(11 or more Diffusers)	24.00	
TOTAL:			108.20

PLUMBING

Quantity Scheduled	Description	Rate Per Unit	Total	Quantity Scheduled	Description	Rate Per Unit	Total
2	Permit Issuance	40.00	80.00		GREASE TRAP/INTERCEPTOR		
	RESIDENTIAL (1 & 2 DWELLINGS)				Grease Trap	13.00	
	1 Bathroom	160.00			Grease Interceptor	13.00	
	2 Bathroom	200.00			BACK FLOW DEVICE		
	3 Bathroom	240.00			Per Unit	26.00	
	Alterations each fixture	13.00			MEDICAL GAS SYSTEM		
	Water Heater	13.00			Medical Gas Piping System	80.00	
	COMMERCIAL				Surgical Vacuum System	80.00	
	New Const. each fixture	13.00			Gas Piping: (1 - 4 outlets)	8.50	
					(5 or more outlets/per outlet)	2.00	
6	Alterations each fixture	13.00	78.00		Dental Chair or Unit	40.25	
	Drinking Fountain, Water Cooler, Ice Machine	40.25			OTHER (NOT LISTED)		
	Sump, Sewage Ejector Pump	13.00					
2	Garbage Disposal	13.00	26.00				
2	Water Heater	13.00	26.00				
	SUB-TOTAL:		210.00		SUB-TOTAL:		
					TOTAL:		210.00

*****COMMERCIAL PROJECTS: Please complete "System Development Calculation Sheet" *****

A water availability/approval letter shall be submitted with this application for any property located outside the city's water service area.

Fruitland Mutual Water Co. – (253) 848-5519 / Valley Water Co. – (253) 841-9698 / Tacoma Water Co. – (253) 502-8600

OFF LEGEND

- WALL FINISH TAG
- FINISH TAG
- DETAIL TAG
- SPACE 1
- SPACE 2

GENERAL FINISH NOTES

1. SEE FINISH TAGS FOR FINISH SCHEDULES.
2. FINISH TAGS SHOWN ARE NECESSARY FOR SCHEDULED FINISHES.
3. SEE FINISH TAGS FOR FINISH SCHEDULES.
4. CONTRACTOR IS RESPONSIBLE TO ATTACHMENT FOR FINISH TAGS. CONTRACTOR SHALL VERIFY FINISHES, QUANTITIES, REFLECTANCES, TOUGHNESS, REFLECTANCE, AND FINISH ATTACHMENT.
5. ALL ITEMS TO BE CONTRACTOR RESPONSIBLE UNLESS OTHERWISE NOTED.
6. SEE FINISH TAGS FOR FINISH SCHEDULES.
7. SEE FINISH TAGS FOR FINISH SCHEDULES.
8. SEE FINISH TAGS FOR FINISH SCHEDULES.
9. SEE FINISH TAGS FOR FINISH SCHEDULES.
10. SEE FINISH TAGS FOR FINISH SCHEDULES.

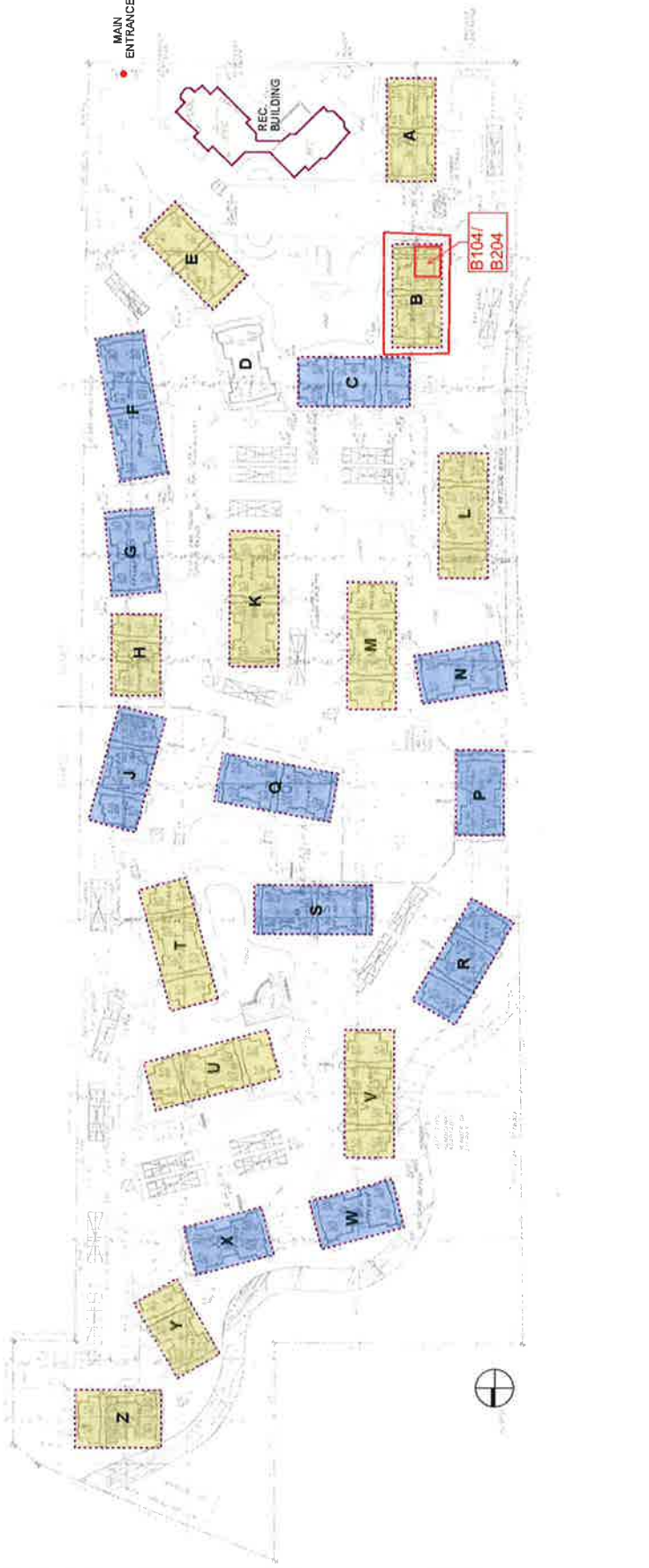

① SITE PLAN - BUILDING SCHEME PLAN SCALE: 1/8" = 1'-0"