



# CERTIFICATE OF WATER AVAILABILITY

PRCTI20220739

## PART A - TO BE COMPLETED BY APPLICANT

PROJECT ADDRESS: 4301 S MERIDIAN ST, PUYALLUP, WA 98373  
APPLICATION NUMBER: 20000239081  
SUBDIVISION/PROJECT NAME: PROPOSED REMODEL-4301 S Meridian STE D  
PARCEL: PA0419102074

Proposed Water Usage: 00000(# of connections)  
Customer Type: **COMMERCIAL**  
Is there an Auxiliary Source of Water on the Parcel? **NO**

I, the undersigned, or my appointed representative have requested the following purveyor to certify willingness and ability to provide the indicated service. I have read and understand the information provided by the water purveyor on this certificate, and acknowledge that the proposed project may require improvements to the water system which would incur my financial obligation. Prior to final approval for construction of the water facilities, it is understood that a legal contract between myself and the water utility which specifies the term of water service, operational responsibilities, and financial obligation may be required.

NAME: **THE ROCK WOOD FIRED PIZZA** SIGNATURE: \_\_\_\_\_

ADDRESS: **14209 19TH STREET E SUITE 102** CITY: **SUMNER** STATE: **WA** ZIP: **98390**

(Please ensure that the above is completed PRIOR to submittal to Tacoma Water)

## PART B - TO BE COMPLETED BY WATER PURVEYOR

Water System To Provide Service **CITY OF TACOMA** State ID# **86800N**

Equivalent Residential Units: 00000  
The proposed development is within our approved water service area.

This water utility will be providing service.

**BUILDING PLANS COMPLETE WITH PLUMBING & MECHANICAL MUST BE SUBMITTED FOR PLAN REVIEW BEFORE SERVICE IS AVAILABLE.**

Approved number of connections: N/A Existing source capacity **164 MGD**  
Number of Current/existing users: N/A Existing Storage: **41 MG**

Water service will be provided by:  
Direct Connection to approved, existing water main.

Are water system facilities approved in accordance to DOH requirements? **YES**.

Water service will be made available to this project by (date): N/A. The date that water service is made available is determined after the customer meets the requirements for service as indicated by the Water Division, in accordance with City Code 12.10, and upon receipt of applicable permits.

Please be advised that we expect any facility that uses a significant quantity of water to use excellent water conservation practices. It is our understanding that in the case of gas fired turbine power plants, excellent water conservation practices include dry condenser cooling methods.

Please call Jane Evancho, Water Resource Planning Manager, at (253) 502-8738 or Linda McCrea, Water Superintendent, at (253) 502-8245 if you have any questions.



# CERTIFICATE OF WATER AVAILABILITY

PRCTI20220739

PROJECT ADDRESS: 4301 S MERIDIAN ST, PUYALLUP, WA 98373  
APPLICATION NUMBER: 20000239081  
SUBDIVISION/PROJECT NAME: PROPOSED REMODEL-4301 S Meridian STE D  
PARCEL: PA0419102074

**FIRE FLOW INFORMATION:**  
FOR ALL COMMERCIAL PROJECTS.

**WATER MAINS:**

\* Location of nearest main capable of supplying at least 500 GPM: **43RD AVE SW**

If not in street at front of property, distance from property to above main is: **N/A** feet.

\*Estimated Fire Flow at 20 PSI is: **1500** ± GPM for **60** minutes.

\*Estimated static pressure at project location is: **58** ± PSI.

**NOTE:**

If specific data are required, contact Tacoma Water to arrange for a flow test. Tests will be conducted by the Water Division at the expense of the applicant.

**HYDRANTS:**

\* Distance from centerline of property frontage to nearest hydrant measured along routes of fire apparatus travel is: **00000** ± feet.

THE AMOUNT OF AVAILABLE FIRE FLOW INDICATED ABOVE IS IN ADDITION TO REQUIREMENTS FOR NORMAL DOMESTIC MAXIMUM USE. A WATER SYSTEM VICINITY MAP WHICH SHOWS THE WATER MAINS AND HYDRANTS SERVING THIS PROJECT IS REQUIRED FOR ALL PROJECTS.

A contract **has not** been signed with the applicant for water service.  
The above information is an accurate account of the existing or necessary water system facilities.

**FOR PRELIMINARY SHORT PLAT OR SUBDIVISIONS:**

We understand that this document, in absence of a legal contract, constitutes a certification of willingness and ability to provide water service subject to the conditions noted.

WATER PURVEYOR: **CITY OF TACOMA, T.P.U., WATER DIVISION.**

DATE: **06/01/2022**

SIGNATURE: Elizabeth Combs

TITLE: USRI

**FOR FINAL SHORT PLAT, SUBDIVISION, BUILDING PERMIT, SEPTIC DESIGN: WATER MAIN ONLY APPROVED FOR FINAL ACCEPTANCE, NOT PRIVATE CONTRACT ACCEPTANCE**

We the undersigned water purveyor, certify that we will assume full operational and maintenance responsibility for the above water system which has been designed, approved, and installed in accordance with Washington Administrative Code 246-290, RCW 90.44 (Water Rights Permits), Pierce County Code 17C.60.165 and 19D.130, and an approved water system comprehensive plan.

WATER PURVEYOR: **CITY OF TACOMA, T.P.U., WATER DIVISION.**

DATE: **06/01/2022**

SIGNATURE: Elizabeth Combs

TITLE: USRI

**This certificate is valid for a period of THREE YEARS from the date of issue solely for the specific property/project indicated. Changes in the number of lots and/or use will require re-application by the applicant, evaluation by the department and issuance of a new certificate. (Board of Health Resolution No. 2001-3282 - Land Use Regulations) THE ABILITY TO PROVIDE SERVICE IS DEPENDENT ON PIERCE COUNTY'S WILLINGNESS TO PERMIT THE INSTALLATION, WHICH MAY INCLUDE CUTTING THE DRIVING SURFACE OF THE STREET.**

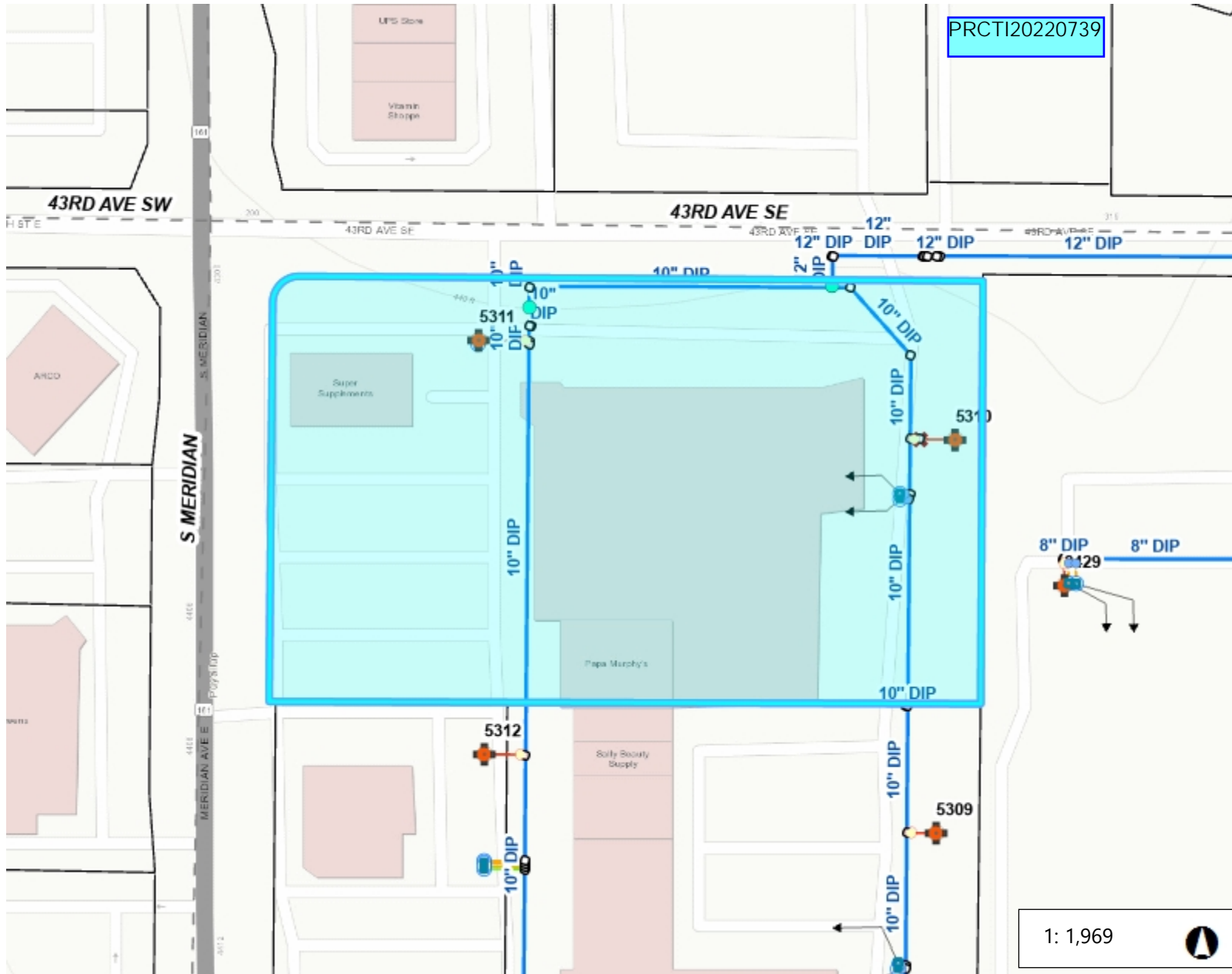

PRCT120220739

Legend

- State Route Milepost Markers
- Large Meter Vaults
- Map Markups**
- Completed
- Rejected
- Review
- Submitted
- Curb Stop Valves
- Pumps
- System Valves**
- Open
- Closed
- Unknown
- Control Valves**
- Air Control
- Check
- Pressure Reducing
- Pressure Relief
- All Other Control Valves
- Hydrant Valves**
- Hydrants
- Blue Hydrants
- Design (Not Constructed)
- In-Service
- Process Valves**
- Blowoff

1: 1,969



328.2 0 164.10 328.2 Feet

WGS\_1984\_Web\_Mercator\_Auxiliary\_Sphere  
Tacoma Water Maps

This map is a user generated static output from an Internet mapping site and is for reference only. Data layers that appear on this map may or may not be accurate, current, or otherwise reliable.

THIS MAP IS NOT TO BE USED FOR NAVIGATION

Notes