

PRPF20220743

**City of Puyallup  
Building  
ACCEPTED**

JMontgomery  
07/01/2022  
8:41:41 AM



**City of Puyallup  
Development  
Engineering  
APPROVED**

See permit  
for additional  
requirements.

Linda Lian  
07/21/2022  
12:23:55 PM



T 253.627.4367 F 253.627.4395 WWW.BCRADESIGN.COM  
2109 PACIFIC AVENUE, SUITE 300, TACOMA, WA 98402

6129 REGISTERED ARCHITECT  
James T. Wolch  
STATE OF WASHINGTON

PROJECT:  
PUYALLUP SCHOOL DISTRICT  
**KESSLER**  
1501 39th AVE SW  
PUYALLUP, WA 98373

REVISIONS
Δ 06.06.2022

DATE: 11.18.2020  
BCRA NO: 20115.00.00  
DRAWN BY:  
REVIEWED BY: Reviewer  
SHEET TITLE: SITE PLAN



**A-111**

PERMIT SET

The applicant shall request an inspection with a City Engineering Inspector through the CityView portal least 48 hours in advance of job start.

Refer to the Stormwater Fact Sheet and City standard details 02.03.02 & 05.02.01 for typical erosion and sedimentation control methods. Attached in CityView

Control of roof downspouts is required. Refer to standard details 02.05.01 & 02.05.03 for typical control methods

**CITY OF PUYALLUP**  
Planning Division Approved Site Plan  
(253) 864-4165  
MINIMUM SETBACK REQUIREMENTS

Front Yard: 20 Ft    Rear Yard: 20 Ft  
Interior Side Yard: Left: 20 Ft    Right: 20 Ft  
Street Side Yard:  
Zoning District: Public Facilities (PF)  
Permit #: PRPF20220743

Additional Conditions/Comments

Staff: GClark  
Date: 07/08/2022  
Front, rear, and side yard property lines shall be marked with string from surveying pins prior to footing inspection.

City of Puyallup Development & Permitting Services ISSUED PERMIT

Building	Planning
Engineering	Public Works
Fire	Traffic

NOTE: WETLAND AND BUFFER ARE INFORMATIONAL ONLY AND ADDED AS AN OVERLAY FROM THE KESSLER CENTER CIVIL PERMIT DOCUMENTS ON TO THE ARCHITECTURAL SITE PLAN. SEE KESSLER CENTER CIVIL SITE DEVELOPMENT PERMIT FOR DETAILS.

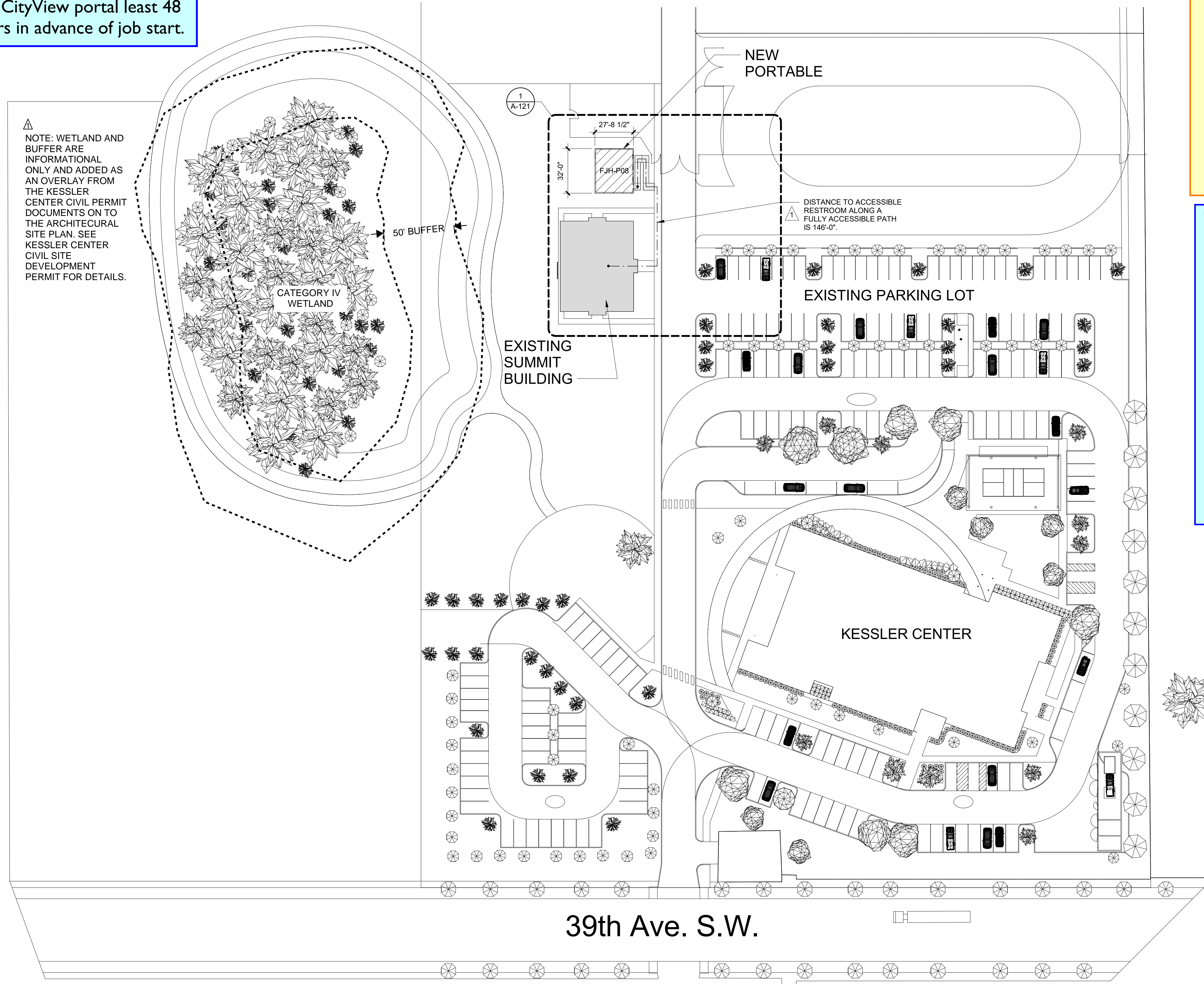

① OVERALL SITE PLAN  
1" = 40'-0"

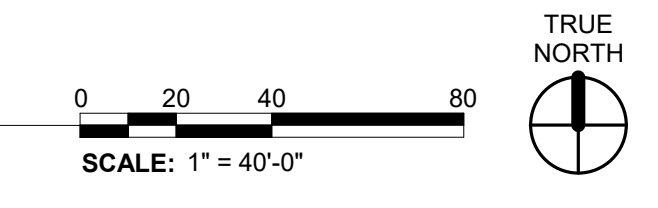

IF SHEET MEASURES LESS THAN 24"X36", IT IS A REDUCED PRINT. REDUCE SCALE ACCORDINGLY

PRPF20220743

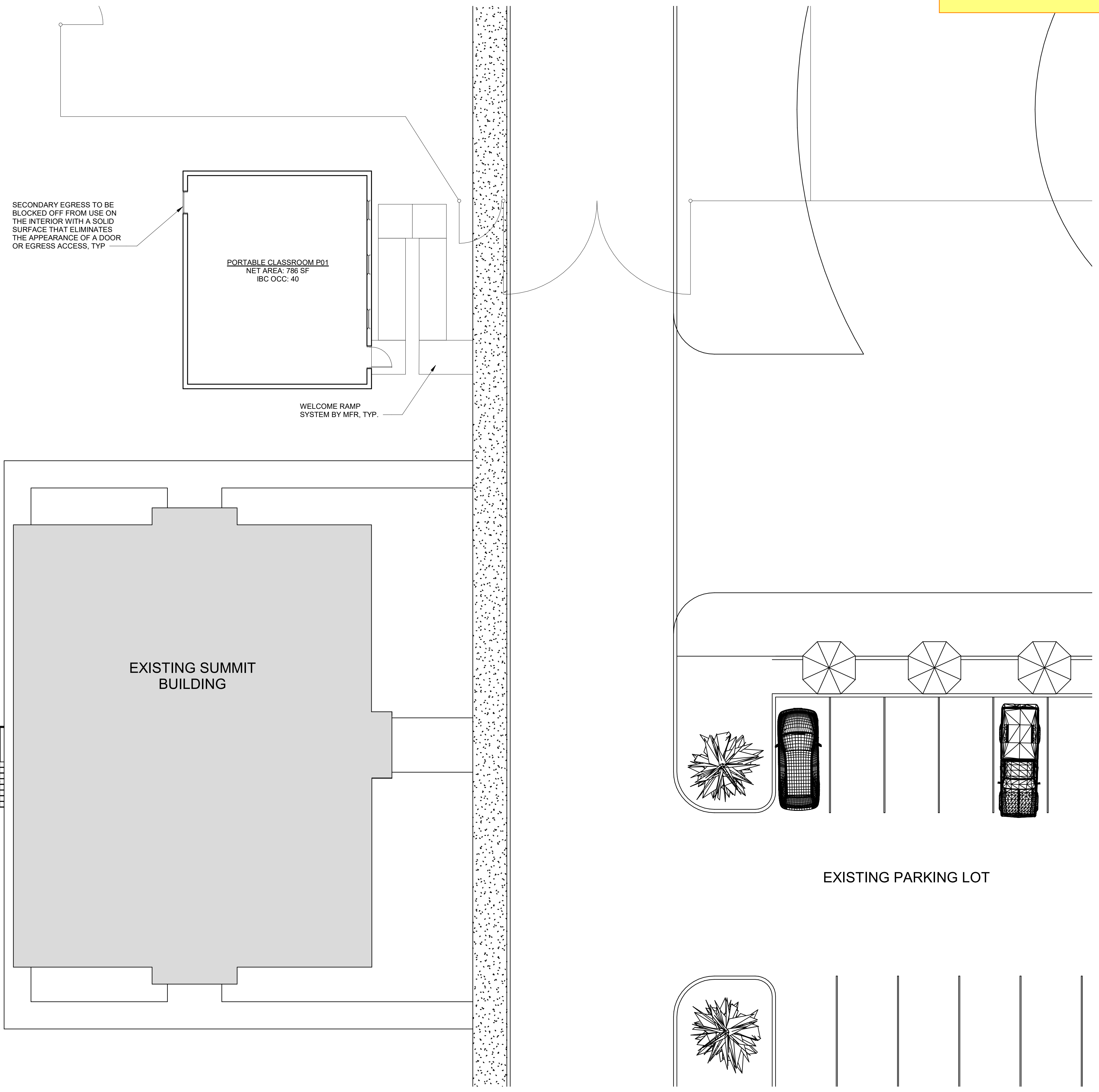
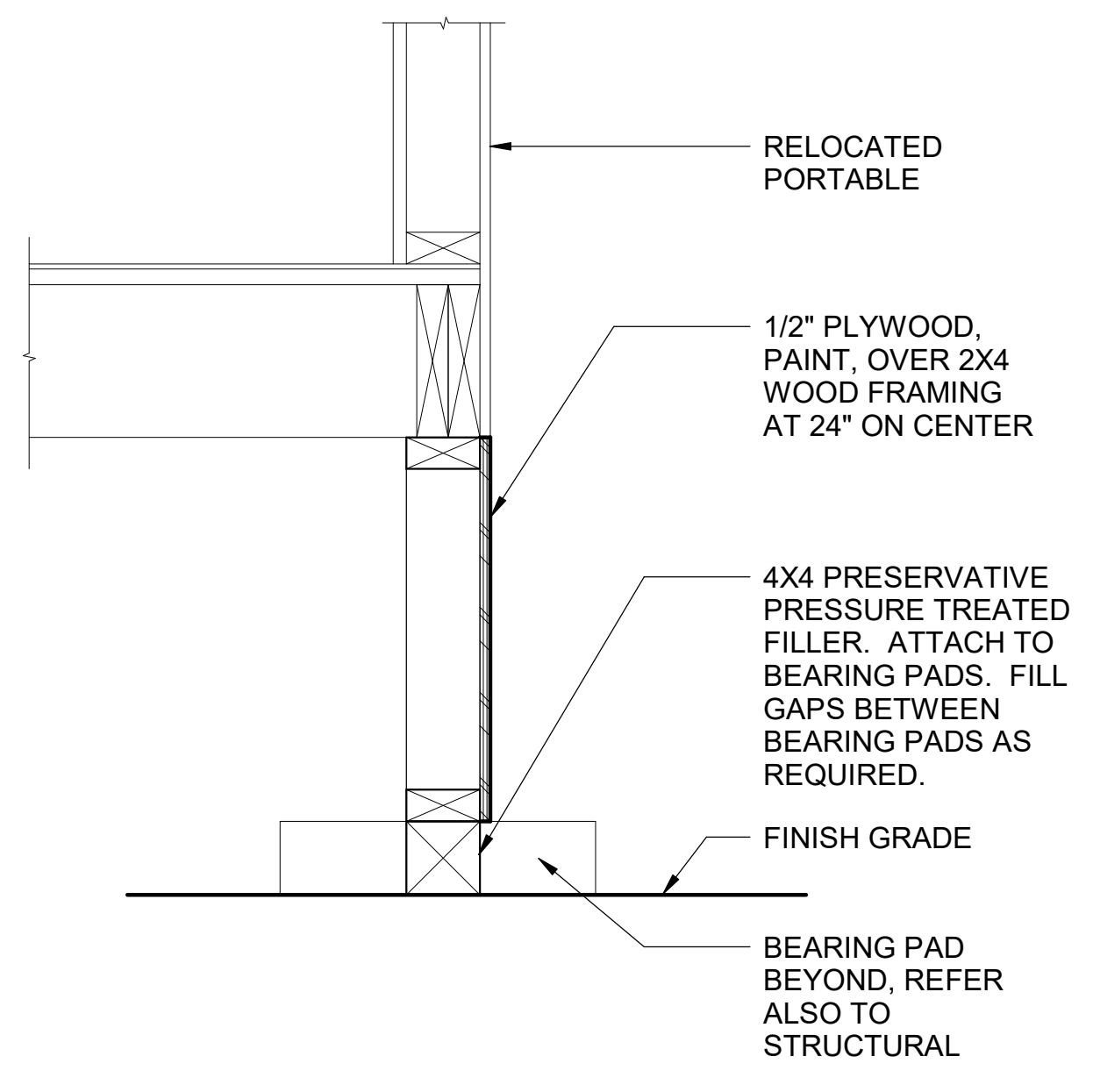

2 SKIRTING DETAIL  
1 1/2" = 1'-0"

FLOOR PLAN LEGEND

NOTE: NOT ALL LEGEND ITEMS MAY BE PRESENT ON THIS SHEET

- EXISTING WALL IN RELOCATED PORTABLE
- NEW WALL
- EXISTING WINDOW IN RELOCATED PORTABLE
- EXISTING DOOR IN RELOCATED PORTABLE
- DOOR
- D/S DOWNSPOUT - PVC PIPE

FINISHES AND MATERIALS

- PUYALLUP SCHOOL DISTRICT STANDARD FOR MINI BLINDS WILL BE PROVIDED AT ALL WINDOWS TO REDUCE GLARE. TYPICAL BLINDS ARE LEVOLOR 1" MINI-BLINDS, OR EQUAL.
- FLOOR FINISHES WILL BE PER PUYALLUP SCHOOL DISTRICT STANDARDS FOR PORTABLES WHICH IS CARPETING BY COLLINS & AIKMAN. CARPETING WILL BE CLEANED AND MAINTAINED AS IS STANDARD FOR PSD.
- THE WELCOME RAMP SYSTEM IS PERFORATED METAL AND IS NON-SLIP.
- THERE ARE 25 DOUBLE COAT HOOKS PROVIDED IN EACH STANDARD INDIVIDUAL CLASSROOM.

MECHANICAL AND MATERIALS

- A MINIMUM OF 30 FOOT/CANDLES OF LIGHTING WILL BE PROVIDED.
- PER IBC, THE MAXIMUM OCCUPANCY OF A SINGLE PORTABLE IS 39 OCCUPANTS. THE SINGLE PORTABLE HEAT PUMP IS 1285 CFM. 1285 CFM / 39 PEOPLE = 32.9 CFM/PERSON.
- PER IBC, THE MAXIMUM OCCUPANCY OF A CLASSROOM IN A DOUBLE PORTABLE IS 37. THE HEAT PUMPS IN THE DOUBLE PORTABLES ARE 1395 CFM. 1395/37 = 37.7 CFM/PERSON.
- THE PORTABLE HVAC SYSTEMS ARE NOT DESIGNED WITH DEDICATED OUTDOOR AIR CAPABILITY.

City of Puyallup  
Development & Permitting Services  
ISSUED PERMIT

Building	Planning
Engineering	Public Works
Fire	Traffic

1 ENLARGED SITE PLAN  
1/8" = 1'-0"

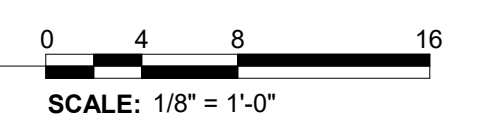

6129 REGISTERED ARCHITECT  
*James T. Wolch*  
JAMES T. WOLCH  
STATE OF WASHINGTON

PROJECT:  
PUYALLUP SCHOOL DISTRICT  
**KESSLER**  
1501 39th AVE SW  
PUYALLUP, WA 98373

REVISIONS

NO.	DATE	DESCRIPTION

DATE: 11.18.2020  
BCRA NO: 20115.00.00  
DRAWN BY:  
REVIEWED BY:  
SHEET TITLE: ENLARGED PLANS AND DETAILS

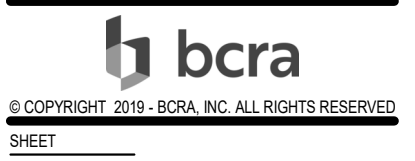

**A-121**  
PERMIT SET

IF SHEET MEASURES LESS THAN 24"X36", IT IS A REDUCED PRINT. REDUCE SCALE ACCORDINGLY