

PRFUP2022112

City of Puyallup Development & Permitting Services ISSUED PERMIT	
Building	Planning
Engineering	Public Works
Fire	Traffic

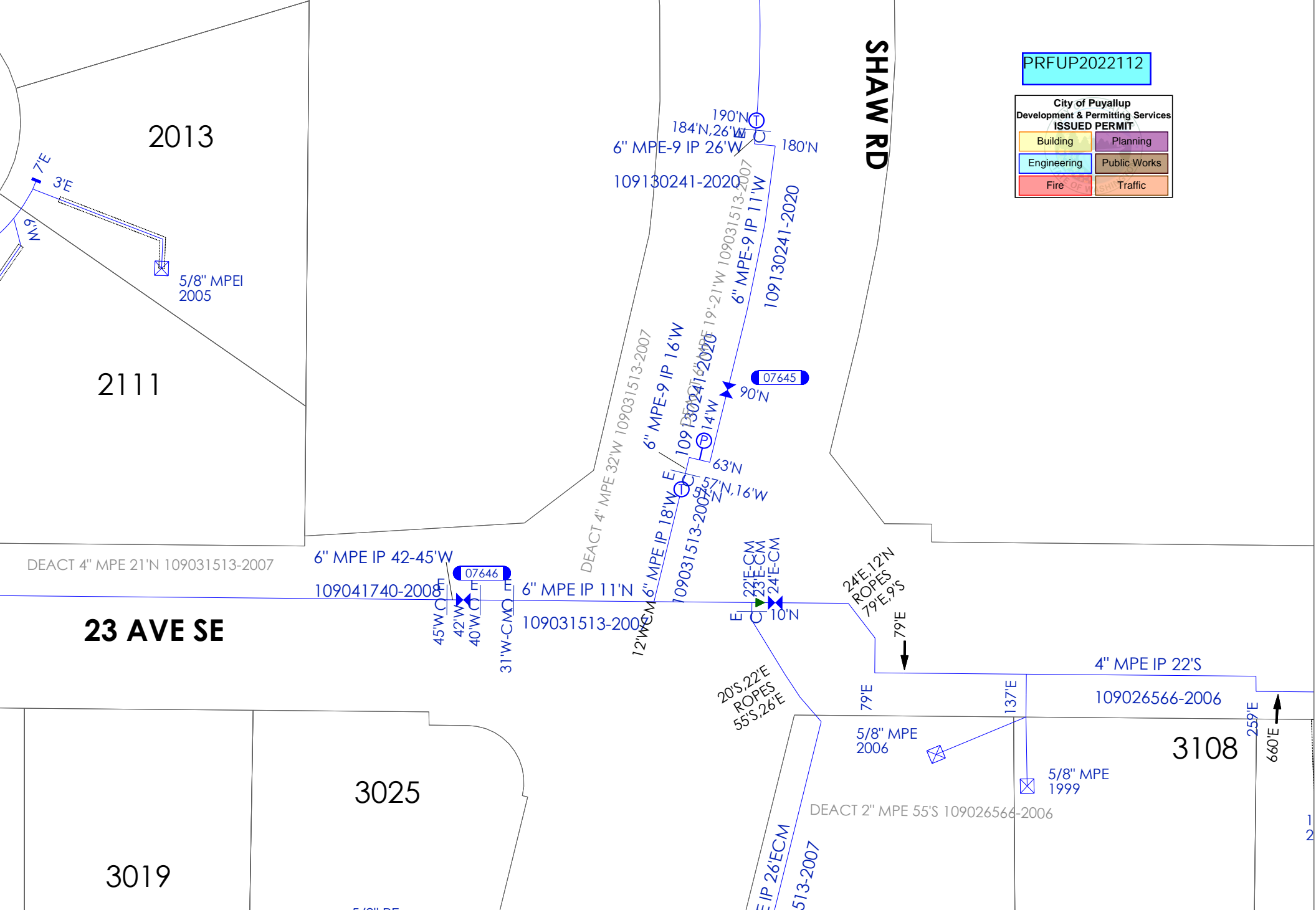

DEACT 4" MPE 21'N 109031513-2007

23 AVE SE

SHAW RD

D1904E008, R2004E140, A2004E140
 S248074, Q251077
 06-15-2022

Scale 1:519

Lat\Long=47.1699, -122.2529



The information on the attached maps is subject to change without notice. Puget Sound Energy makes no warranty, expressed or implied, concerning the suitability of this information for any purpose. Recipient agrees to not disclose this confidential information to any other person or entity unless authorized in writing by Puget Sound Energy. This map is not to be used for determining the actual location of any PSE facilities (call 811).