

TEMPORARY TRAFFIC CONTROL PLAN

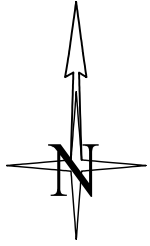

Flaggers shall remain in radio contact at all times

When shifting traffic into a turn lane the use of double cones is required. Device spacing 1/2 distance for opposing traffic

For approved Traffic Control Plans that necessitate the use of police officer assistance, Puyallup Police officers will be utilized. Contact Tamara Ferrin at 253-841-5436 or email at: TAME@ci.puyallup.wa.us

Distance between cones equals speed limit in unit feet
 Taper length equals width of offset times speed squared divided by 60
 Sign spacing shall be 100 feet when speed limits is 30 MPH or less
 Sign spacing shall be 350 feet when speed limit is greater than 30 MPH
 Distance between signs is mandatory unless field conditions determine otherwise

PRFUP2022112

WORK ALLOWED
 MONDAY THROUGH
 THURSDAY BETWEEN
 THE HOURS OF 10AM AND
 12PM. THE ROAD MUST
 BE FULLY OPENED BY
 NOON, NO EXCEPTIONS

The applicant is responsible to notify the city of a job start 48 hours in advance using the CityView portal.

The permit and traffic control plans shall be posted at the job site and available to inspectors at all times.

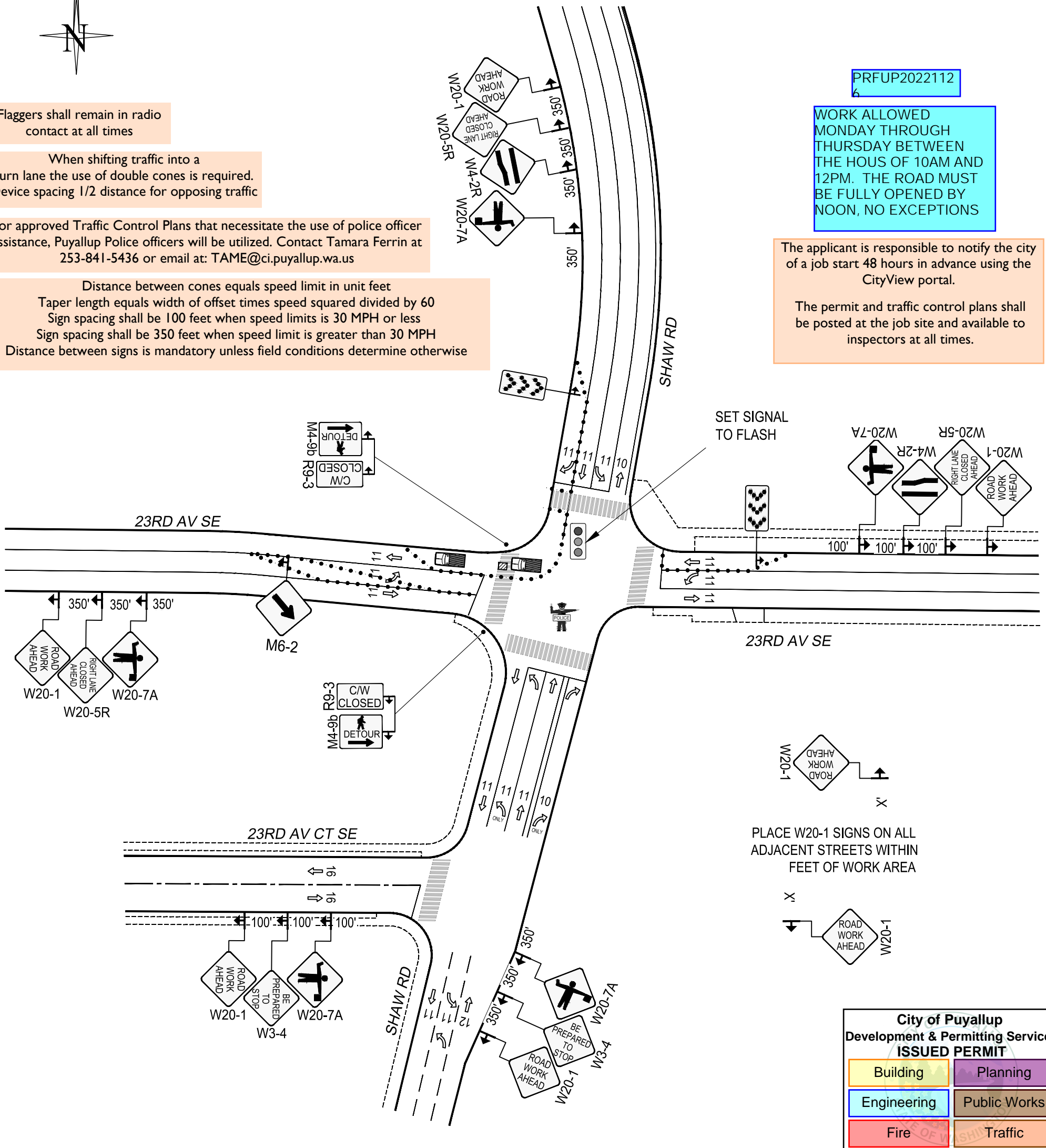

PLACE W20-1 SIGNS ON ALL ADJACENT STREETS WITHIN FEET OF WORK AREA

City of Puyallup
 Development & Permitting Services
ISSUED PERMIT

| | |
|-------------|--------------|
| Building | Planning |
| Engineering | Public Works |
| Fire | Traffic |

Notes:

- All signs and spacing to conform to the MUTCD and City of Puyallup standards.
- All sidewalks, driveways, exits and egresses shall be completely clear unless otherwise indicated.
- Channelizing devices are 28" traffic cones. Use traffic drums (barrels) with steady burning Type C lights on all State State Routes and Hwys.
- Sign size can be a minimum of 36" x 36" and shall not obstruct pedestrian access.
- Crew is required to leave a minimum of 11' for traveling lane width.
- Alert affected residents and businesses.
- Work to take place between 9 a.m. and 4 p.m. unless otherwise specified. All work for arterials and major roadways will be from 9 a.m. to 3 p.m.
- Work area will be approx. 12' NCL of 23rd Av SE & 42' WCL of Shaw Av E.

$$L = \frac{W \cdot S^2}{60}$$

| SIGN SPACING | |
|--------------|-------|
| MPH | "X" |
| 60/65 | 1000' |
| 45/55 | 500' |
| 35/40 | 350' |
| 25/30 | 100' |

CHANNELIZATION DEVICE SPACING
 DISTANCE BETWEEN CONES EQUALS SPEED LIMIT IN UNITS OF FEET

LEGEND

- 28" TRAFFIC CONE
- VALVE LOCATION
- TRAFFIC FLOW
- UNIFORMED POLICE OFFICER
- FLAGGER
- WORK VEHICLE/ FLASHING LIGHTS
- SIGN LOCATION
- RIGHT OF WAY ROW
- CHEVRON ARROW BOARD

| | | | | |
|----------------------------------|--|---|-------------------|------------------|
| <p>PUGET SOUND ENERGY</p> | <p>Designer: Stephen R Gadke 425-424-6431 stephen.gadke@pse.com</p> | <p>Puget Sound Energy Traffic Control Supervisor: Stephen R Gadke Card No. 012922 Exp. 7/31/2025 stephen.gadke@pse.com (425) 424-6431 <i>Stephen R Gadke</i></p> | <p>06/30/2022</p> | <p>REV 0</p> |
| | <p>Project Address: 3rd Av SE & Shaw Av E Puyallup, WA</p> | <p>Job # 11865042</p> | | |
| | | <p>Page 1 OF 1</p> | | |