

SITE PLAN
SCALE: 1" = 50'

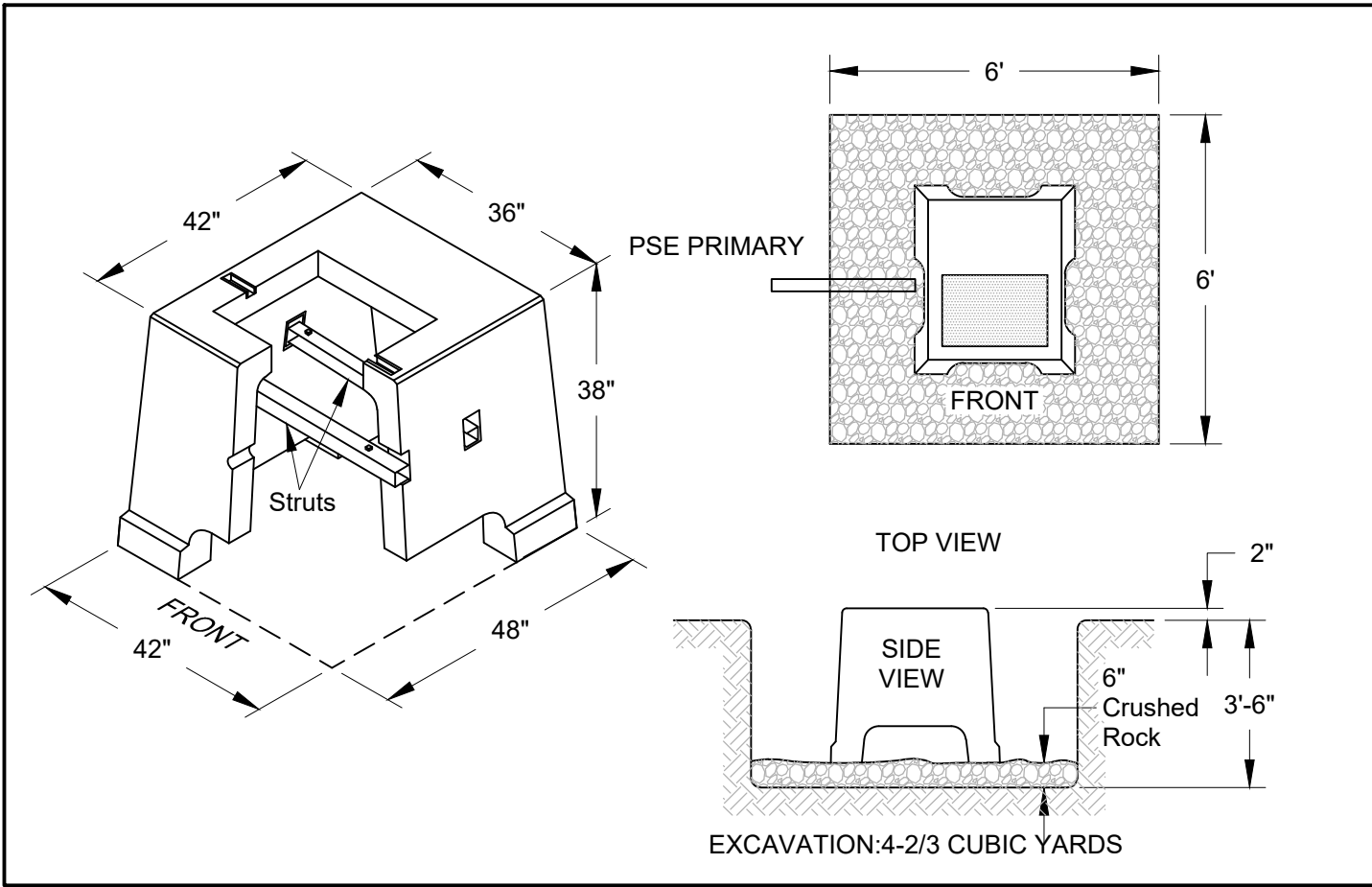

CUSTOMER-SUPPLIED EXCAVATION FOR VAULT (V01)
SCALE: NONE

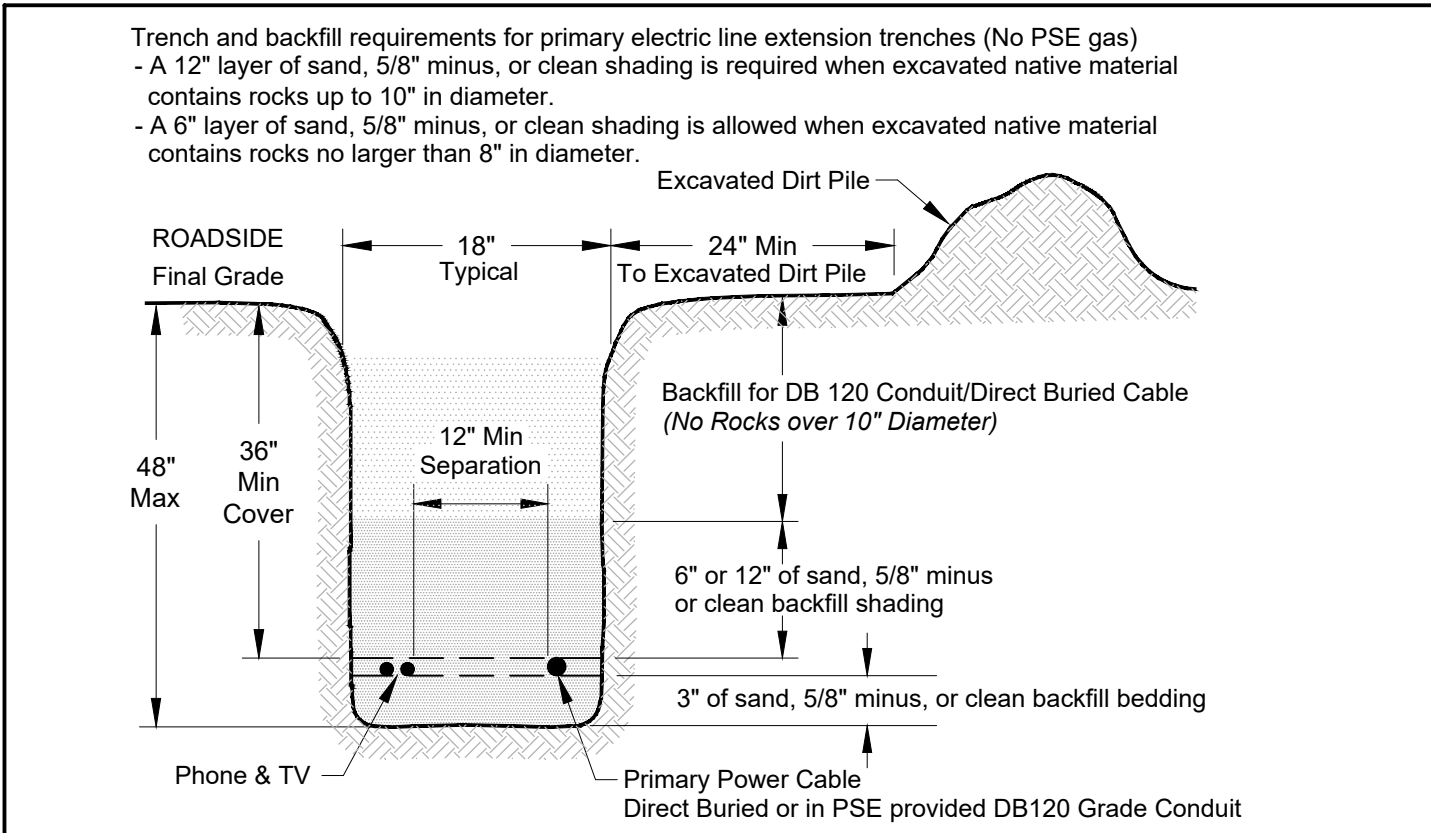

CUSTOMER-SUPPLIED TRENCH FOR PRIMARY CABLE (J01 TO V01)
SCALE: NONE

J01: 567124-155961
INST. 1 - 1/0 L/B ELBOW
INST. CABLE TAGS EJD701

V01:
INST. MP HH & GNDS
SET 25 KVA PM TRF. 120/240V
INST. 1 - L/B ELBOW & 1 - DUST CAP
INST. CABLE TAGS EJD701
INST. GRID. 567112-155968
CONNECT & TAG CUSTOMER RAN UG SVC LINES (1 RUN OF #2KCM)

J01 TO V01:
INST. 1 - 4" DB120 CONDUIT ±20FT
(BILLABLE: 25FT)(ACTUAL:)
INST. 1 - 1/0 AL. SOL. JACKETED PRI. CABLE +- 40' IN CUSTOMER PROVIDE TRENCH
(BILLABLE: 40FT)(ACTUAL:)

M01:
UG PERM
(IN ROW)

CUSTOMER NOTES:
SITE MUST BE READY 1 WEEK PRIOR TO CONSTRUCTION
CUSTOMER TO PROVIDE ALL TRENCHING AND EXCAVATION

3-19A

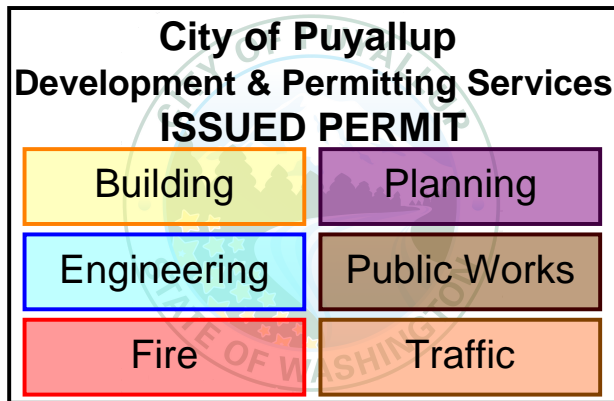

The applicant is responsible to notify the city of a job start 48 hours in advance using the CityView portal.

The permit and traffic control plans shall be posted at the job site and available to inspectors at all times.

Call Jeff Hill, City Inspector,
at 253-204-5633 prior to starting any work.

FOREMAN MUST FILL IN	
CABLE #:	EJD701
MANUFACTURER:	
YEAR MANUFACT:	
COMPOUND:	

CIRCUIT LOADING TABLE				
Circuit:	SHA-17	AØ	BØ	CØ
As Of:	2020	Customer Split Load: 1		
		Power Factor: .85		
		Phase to Gnd Voltage: 7200		
Existing Peak Load:	A Phase	B Phase	C Phase	
	94.0	89.0	97.0	
Estimated New Load:	####	0.2	####	
Total:	94.0	89.2	97.0	

TRANSFORMER INSTALLATION (PM)	
Installed at site:	V01
Grid Number:	567112-155968
kVA Rating:	25kVA 120/240V
Material ID#:	6247000
Foreman to redline the following information	
Company ID#:	
Primary phase connected to:	
Tested Secondary Voltage	/

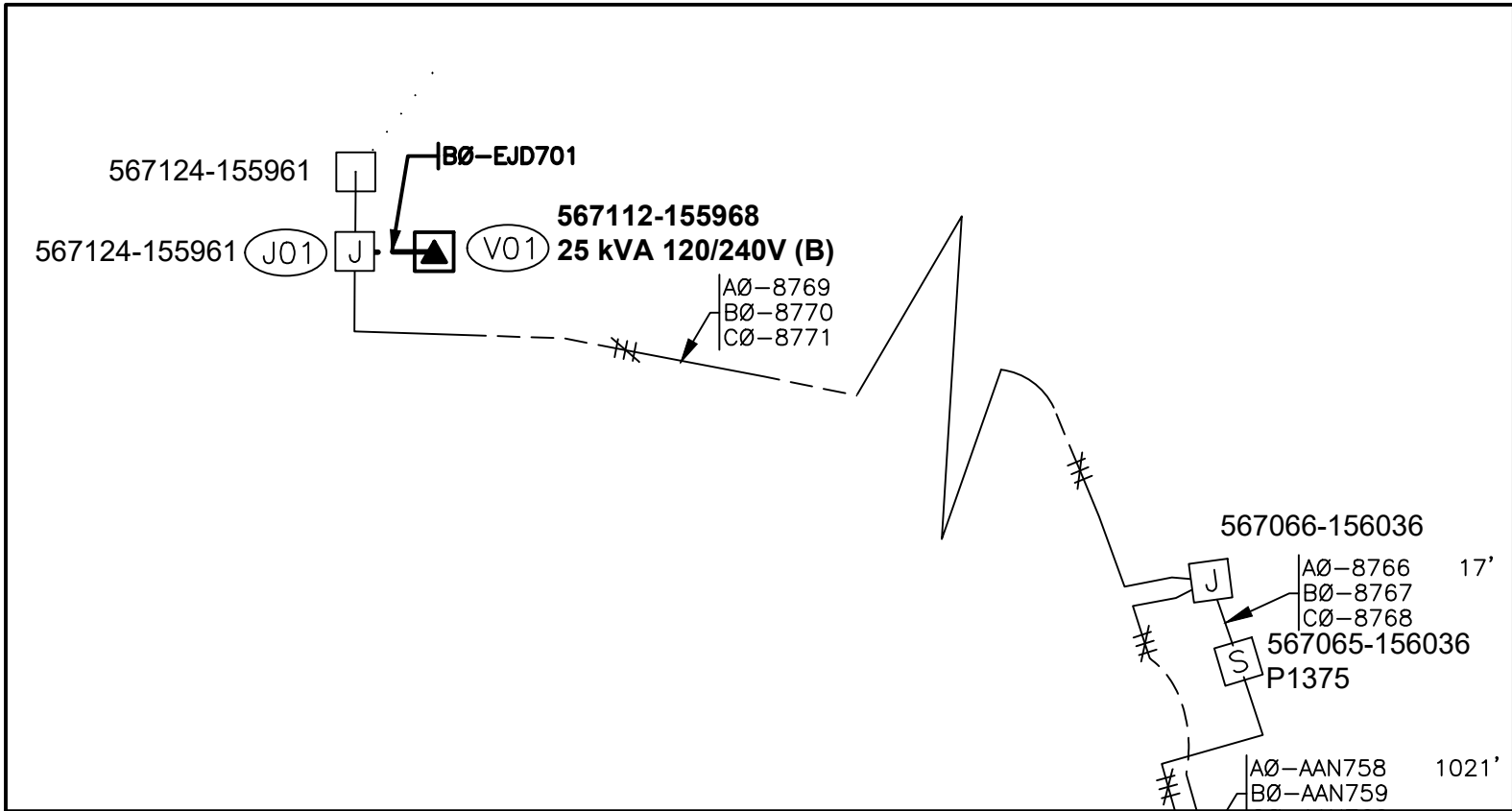

UNDERGROUND CIRCUIT MAP
SCALE: NONE

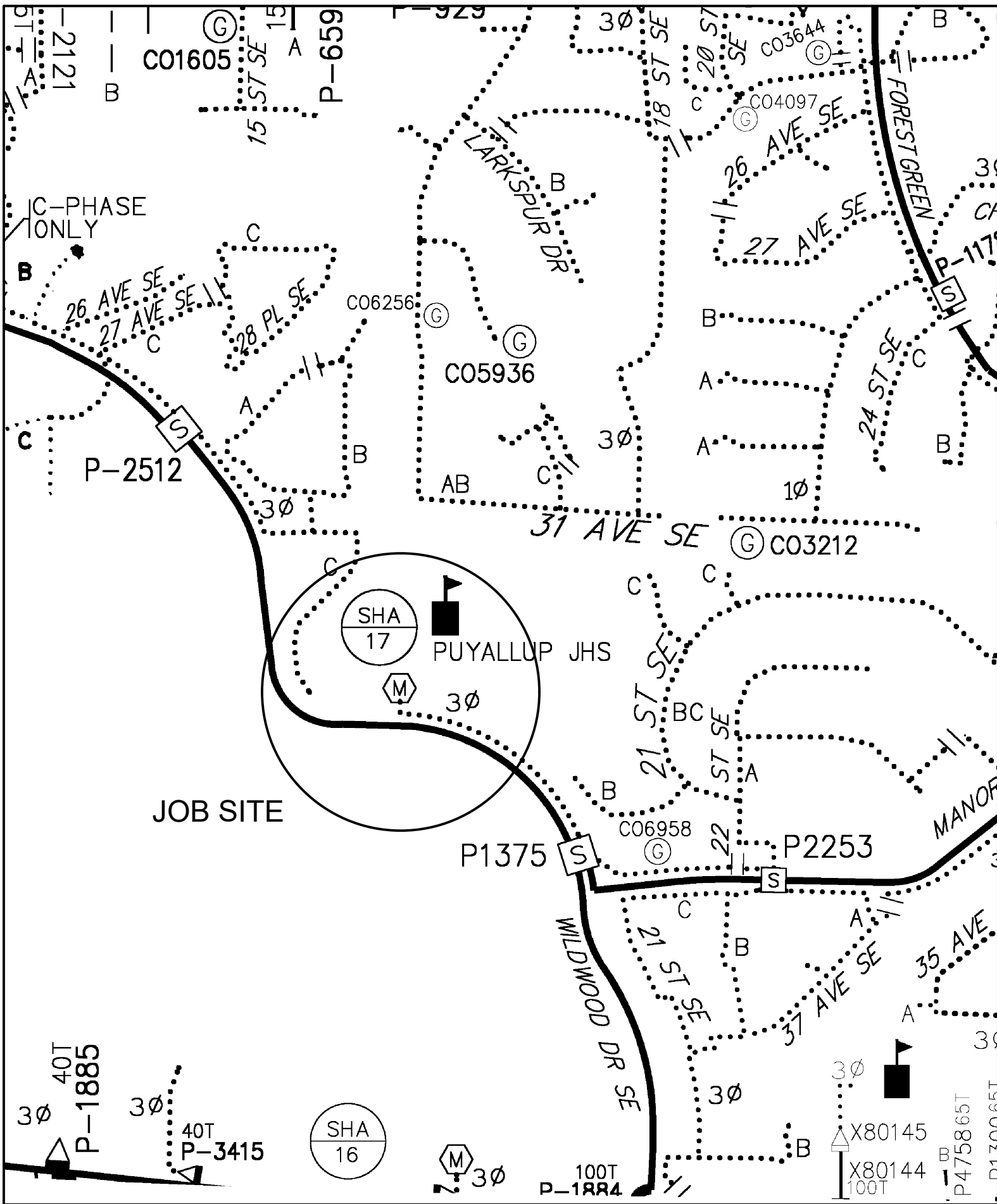

POWER GENERAL NOTES - COMMERCIAL PROJECT

- All materials to be installed in accordance with Puget Sound Energy's (PSE) standards. Any deviation from this work sketch must be AUTHORIZED by PSE's Project Manager and NOTED on the Foremans' Copy.
- All switching arrangements and/or outage arrangements are to be made with the Project Manager at least three (3) working days in advance.
- Contact the Utilities Underground Location Center (1-800-424-5555) at least 48 hours prior to commencing work to get the underground facilities located.
- STAKING: The customer will provide all staking (transformer, handhole, trench, grade, lot, pole, sidewalk, etc.). See sketch and details for locations. Equipment locations must be approved by the Project Manager.
- SITE PREPARATION: The work area will be at or near finished grade, clear of trench spoils or construction materials which would restrict construction and/or equipment access, before work can begin.
- Roads shall be paved or have a compacted, crushed rock base in place.
- CLEARANCES: Transformers require a minimum of 6 feet from fire fighting equipment, 10 feet from combustible walls, overhangs, doors, and windows, and a minimum of 5 feet from the back of curb (or guard posts will be required per PSE standards). All conduits and vaults are to be at least 5 feet away from water, storm and sewer lines when paralleling them in the right of way, and at least 1 foot when crossing them.
- All work is to be done in accordance with local municipal and county permit requirements as applicable.
- Customer/Developer is responsible to provide, install and maintain all secondary service cables, conduits and crossings from the individual unit's meter base to the designated connection point.
- Inclement weather conditions may cause delays in construction times and dates.
- EXCAVATION: The customer is to provide all trenching, backfill, vault excavations, compaction and restoration per this sketch and per PSE standards. A minimum protective cover of 36" is required over PSE's primary voltage equipment and 24" is required of PSE's secondary voltage equipment. The customer will provide any and all shoring or they will side slope the trench to 1:1.

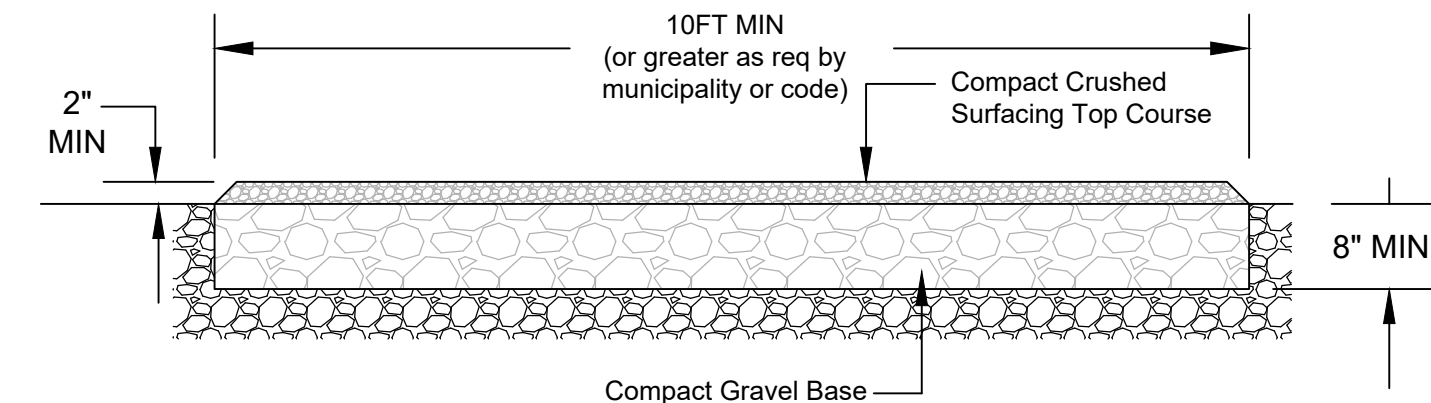

CUSTOMER-PSE REQUIRED EQUIPMENT ACCESS ROAD
SCALE: NONE

EROSION & SEDIMENT CONTROL REQUIREMENTS

EROSION & SEDIMENT CONTROL SHALL BE PER PSE STANDARD PRACTICE 0150.3200 TECHNIQUES FOR TEMPORARY EROSION & SEDIMENT CONTROL & ANY ADDITIONAL LOCAL JURISDICTION REQUIREMENTS. (LOCAL JURISDICTIONS MAY HAVE ADDITIONAL REQUIREMENTS INCLUDING NOTES DETAILING WHERE EROSION OR SEDIMENT CONTROL STRUCTURES ARE TO BE INSTALLED, CROSS SECTION DETAILS OF THE TYPICAL EROSION STRUCTURES, & SPECIAL REQUIREMENTS FOR WORK IN SENSITIVE AREAS.)

FOREMAN (CHECK BOX WHEN COMPLETED)		
<input type="checkbox"/>	PSE Equipment LOCKED/SECURED & Work Area left in CLEAN/SAFE Condition.	
<input type="checkbox"/>	Grid, Cable, and Switch numbers INSTALLED & VERIFIED.	
<input type="checkbox"/>	Field Changes RED-LINED on As-built.	
<input type="checkbox"/>	Material VERIFIED and CHANGES noted on Paperwork.	
<input type="checkbox"/>	Total PRIMARY Cable noted on As-built.	
<input type="checkbox"/>	Company ID#s RECORDED in correct location on As-built.	
<input type="checkbox"/>	Indicate correct FUSE SIZE on As-built & VERIFY proper PHASE.	
<input type="checkbox"/>	Deviations noted on the As-built and their reason.	
<input type="checkbox"/>	I certify that the work performed meets PSE's standards and procedures and that all quality requirements are met.	
Foreman's Signature _____		
Print Name _____ Date _____		

Vicinity Map	
105100388	
JOB SITE	
Owner / Developer Contact Info	
PUYALLUP SCHOOL DIST 3	
323 12th St NW	
Puyallup, WA 98371	
ATTN: OANA STEPHENS 206-441-4522 office	

Project Manager Contact Information:		
Manager:	Danielle Rickett	
Cell Phone:	253-290-2528	
E-Mail:	Danielle.Rickett@pse.com	

CALL 811 TWO BUSINESS DAYS BEFORE YOU DIG			
THIS SKETCH NOT TO BE RELIED UPON FOR EXACT LOCATION OF EXISTING FACILITIES			
REAL ESTATE/EASEMENT		PERMIT	
N/A		YES	
FUNCTION	CONTACT	PHONE NO	DATE
PROJECT MGR	D. Rickett	253-290-2528	6/10/22
ENGR - POWER	DANIEL GAKIN	425-466-2218	6/10/22
ENGR - GAS	N/A	N/A	N/A
DRAWN BY	DANIEL GAKIN	425-466-2218	6/10/22
CHECKED BY	LUANNE YU	N/A	6/22/22
APPROVED BY	Nate Lenth	(253) 970-7284	6/10/22
FOREMAN #1			
FOREMAN #2			
MAPPING			

JOINT FACILITIES ARRANGEMENTS			
UTILITIES	N/A	N/A	N/A
CONTACT	N/A	N/A	N/A
PHONE#	N/A	N/A	N/A

PSE	PUGET SOUND ENERGY	PUYALLUP SCHOOL DIST 3	COMMERCIAL UG L/E	3213 WILDWOOD PARK DR # LIGHTS	INCIDENT	MAOP
					N/A	N/A
					Gas Order	Elect Order
					N/A	105100388
					SCALE	PAGE
					AS NOTED	1/1