



City Engineering
333 S. Meridian
Puyallup, WA 98371
Tel: (253) 864-4165
Fax: (253) 840-6678

PLAN CHANGE REQUEST

DATE: 08-01-2022 PERMIT NO./REF NO: PRCCP20220609-CV1

1. PROJECT: WSF SillyVille Train Expansion ADDRESS: 110 9th Ave SW Unit 24 Puyallup, WA 98371
2. OWNER: Western Washington Fair Association EMAIL: alan@thefair.com
3. DESIGN ENGINEER: JMJ TEAM EMAIL: justin@jmjteam.com
4. CONTRACTOR: Fletcher Contractors EMAIL: ryan@fletchercontractors.com
5. ORIGINATOR OF REQUEST:
 OWNER DESIGN ENGINEER CONTRACTOR CITY OF PUYALLUP
6. DOES THIS REQUEST REQUIRE A DEVIATION FROM AN EXISTING CITY STANDARD? YES NO
7. IF YES, PLEASE SUBMIT AN ALTERNATIVE METHODS FOR CONSTRUCTION MATERIALS REQUEST APPLICATION (AMR).
8. IF NO, PLEASE COMPLETE THE FOLLOWING:
9. APPROVED CIVIL PLAN SHEET NUMBERS AFFECTED: C3-101, C3-201
10. WHAT PART OF THE CITY AND/OR DEVELOPMENT INFRASTRUCTURE IS BEING AFFECTED?
 ROAD STORM WATER SANITARY GRADING EROSION CONTROL
11. DESCRIBE THE CHANGE BEING REQUESTED: (ATTACH ADDITIONAL INFORMATION AS NECESSARY)

Revised infiltration basin layout as a result of existing grades. Updated plan view and added profile view to show the required ponding area, check dams, liner, and overflow pipe.

12. ALL SIGNATURES ARE REQUIRED TO PROCESS THIS REQUEST UNLESS INITIATED BY THE CITY. FINAL APPROVAL/DENIAL WILL BE MADE BY THE CITY ENGINEER. ALL CHANGES WILL BE FULLY APPROVED/DENIED PRIOR TO ANY WORK ON REQUESTED CHANGES. ANY WORK COMPLETED PRIOR TO APPROVAL IS AT THE RISK OF THE DEVELOPER/CONTRACTOR AND MAY NOT BE APPROVED BY THE CITY ENGINEER.

[Signature]
OWNER

[Signature]
DESIGN ENGINEER

[Signature]
CONTRACTOR

[Signature]
CITY INSPECTOR

[Signature]
CITY REVIEWER

APPROVED / DENIED

8/5/2022

DATE

Path: \\A:\1507 - Washington State Fair\1507-002-08 Sillyville Train Expansion\CAD\ 1507002-008-UT-STRM.dwg Plotted by: JMJ Team Date: 01-Aug-22 12:31:07pm

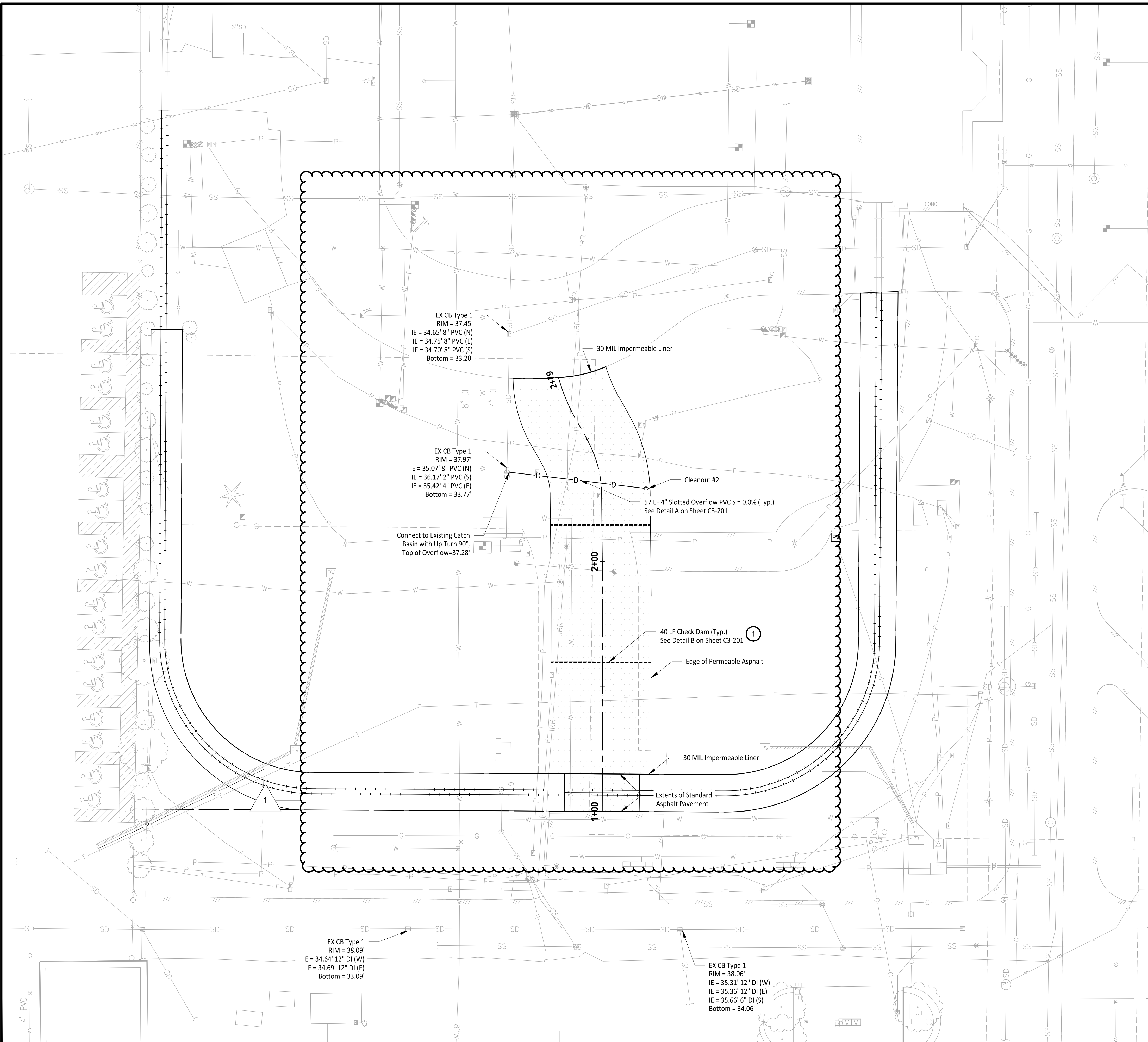

CONSTRUCTION NOTES

- 1 Check Dam to be installed under Permeable Pavement to maintain stormwater separation in pathways. See section B on Sheet C3-201.
- 2 Permeable Pavements to include 4" Slotted PVC underdrains with Solid Wall PVC Connection to Catch Basins. See Section A on Sheet C3-201 for Details.
- 3 See Permeable Path Profile on Sheet C3-201 for Check Dam Elevations.

GENERAL NOTES

1. Contractor to Pothole, locate Horizontal and Vertical Utilities and Verify with Engineer prior to any Utility Work.
2. Cleanouts shall be installed at each change of direction greater than 45 degrees in storm lines. Where more than one change of direction occurs in a run of piping, only one cleanout shall be required for each 40 feet of developed length of drainage piping.

Storm Structure Table		
Elevation Point	Rim Elevation (ft)	Invert Elevation (ft)
Cleanout #1	38.03	35.38
Cleanout #2	38.51	36.54
Cleanout #3	38.87	36.98
Cleanout #4	39.32	37.32
Cleanout #5	39.26	38.00
Cleanout #6	39.39	37.89

Owner/Developer:

Washington State Fair
110 9th Ave SW
Puyallup, WA 98371
(253) 841-5356

Architect:

Engineer:

JMJTEAM
Justin Jones, PE
905 Main St. Suite 200
Sumner, WA 98390
(206) 596-2020

Project:

Sillyville Train Expansion

ONE INCH AT FULL SCALE.
IF NOT, SCALE ACCORDINGLY



08-01-22

REV	DATE	DESCRIPTION
1	08-01-22	Plan Revision

DRAWN BY: DESIGN BY: JJ

PROJ. NO: 1507-002-08
DATE: August 1, 2022

SHEET NAME: Storm Plan

DWG. C3-101

APPROVED

By: *Justin M. Jones*
CITY OF PUYALLUP
DEVELOPMENT ENGINEERING

DATE: 8/5/2022

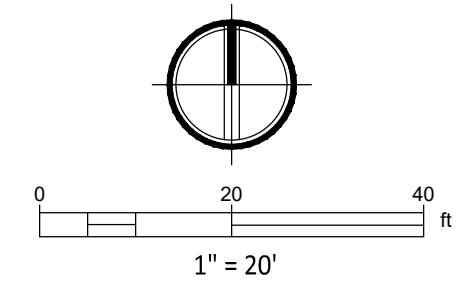

NOTE: THIS APPROVAL IS VOID AFTER 180 DAYS FROM APPROVAL DATE.
THE CITY WILL NOT BE RESPONSIBLE FOR ERRORS AND/OR OMISSIONS ON THESE PLANS.
FIELD CONDITIONS MAY DICTATE CHANGES TO THESE PLANS AS DETERMINED BY THE DEVELOPMENT ENGINEERING MANAGER.

CALL TWO BUSINESS DAYS BEFORE YOU DIG
1-800-424-5555
UTILITIES UNDERGROUND LOCATION CENTER

Path: U:\1507 - Washington State Fair\1507-002-08 Sillyville Train Expansion\CAD\ Plotted by: JMJ Team Date: 02-Aug-22 09:16:28am

Owner/Developer:

Washington STATE FAIR
PUYALLUP

Washington State Fair
110 9th Ave SW
Puyallup, WA 98371
(253) 841-5356

Architect:

Engineer:



Justin Jones, PE
905 Main St. Suite 200
Sumner, WA 98390
(206) 596-2020

Project:

Sillyville Train Expansion

ONE INCH AT FULL SCALE.
IF NOT, SCALE ACCORDINGLY



REV	DATE	DESCRIPTION
1	08-01-22	Plan Revision

DRAWN BY: DESIGN BY: JJ

PROJ. NO: 1507-002-08

DATE: August 1, 2022

SHEET NAME

Storm Details

DWG. C3-201

13 OF 23

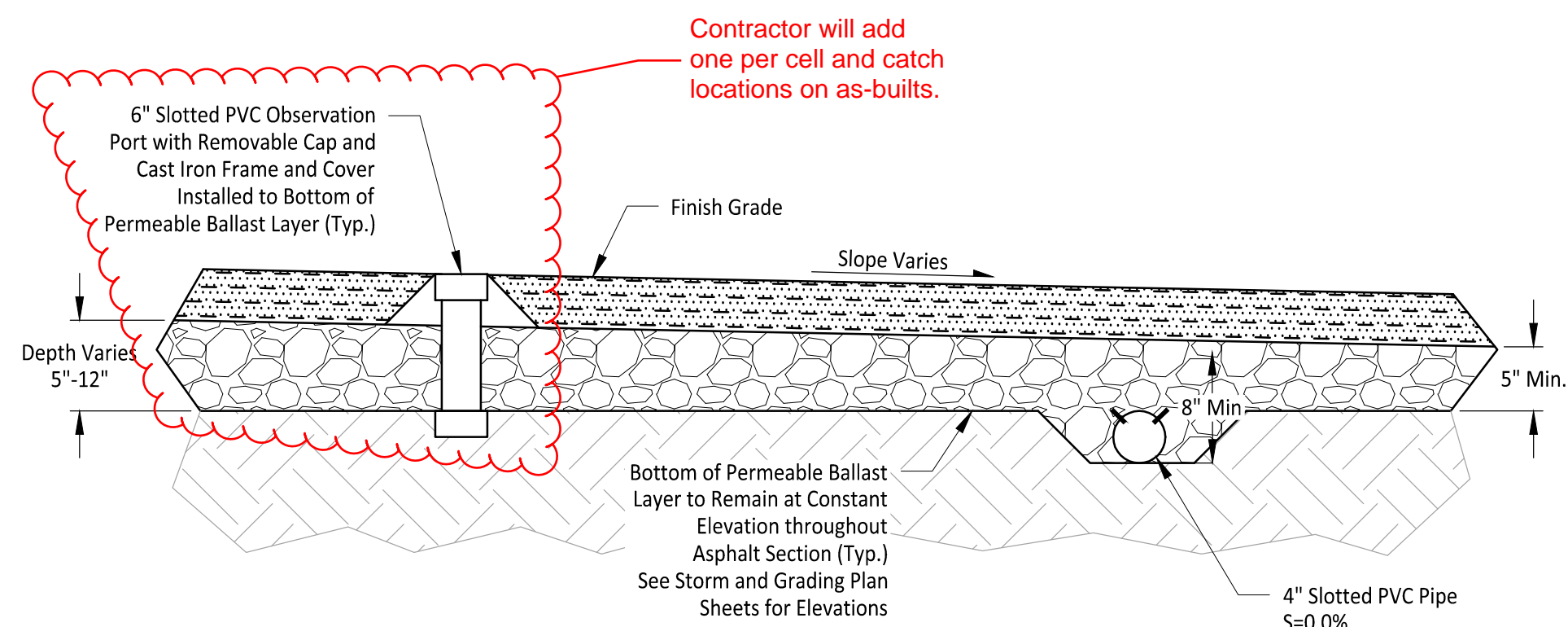

Permeable Asphalt Pavement Underdrain
SECTION A
1" = 1' C3-201

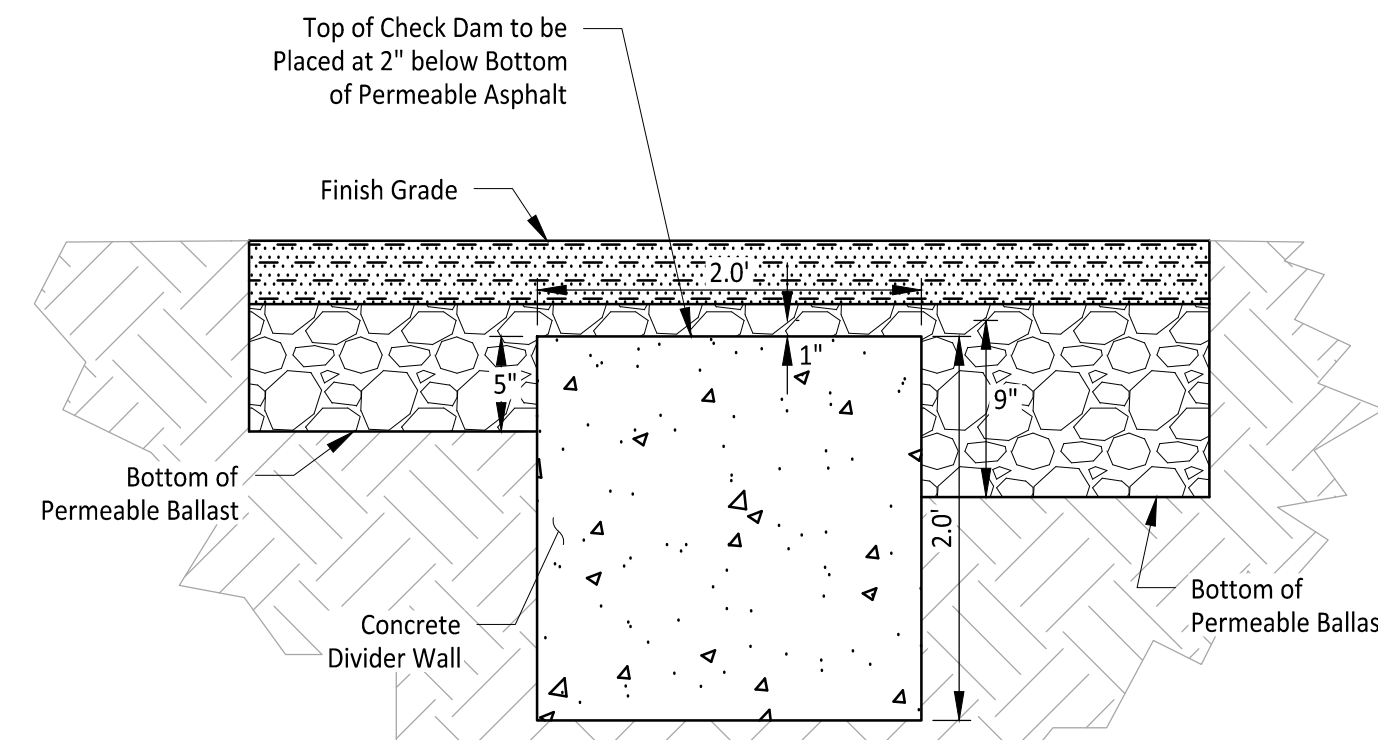

Permeable Asphalt Check Dam
SECTION B
1" = 1' C3-201

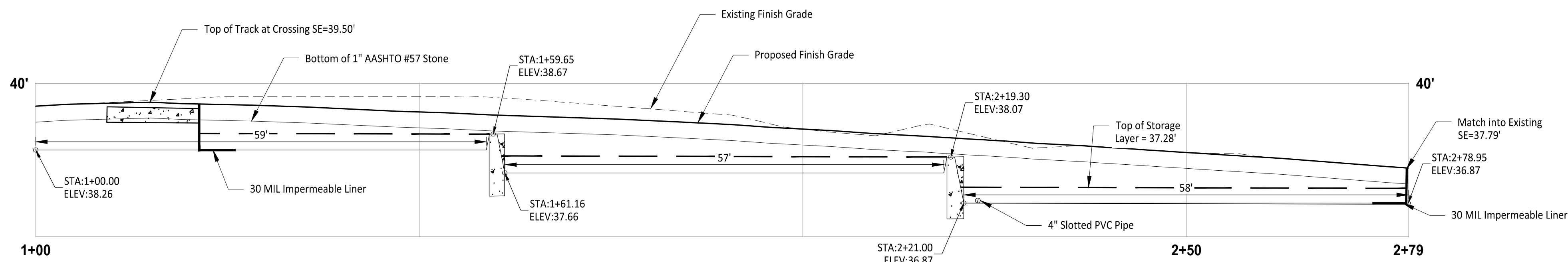

Permeable Path Profile
HORIZ: 1" = 10'
VERT: 1" = 5'

APPROVED
BY: *Lance D. Holloman*
CITY OF PUYALLUP
DEVELOPMENT ENGINEERING
DATE: 8/5/2022
NOTE: THIS APPROVAL IS VOID AFTER 180 DAYS FROM APPROVAL DATE. THE CITY WILL NOT BE RESPONSIBLE FOR ERRORS AND/OR OMISSIONS ON THESE PLANS. FIELD CONDITIONS MAY DICTATE CHANGES TO THESE PLANS AS DETERMINED BY THE DEVELOPMENT ENGINEERING MANAGER.

CALL TWO BUSINESS DAYS BEFORE YOU DIG
 1-800-424-5555
UTILITIES UNDERGROUND LOCATION CENTER