

APPROVED PLAN
CITY OF PUYALLUP
PLANNING DIVISION

APPROVED BY: GClark
DATE: 05/25/2022
CASE NO. PLPSG202200751
CONDITIONS:

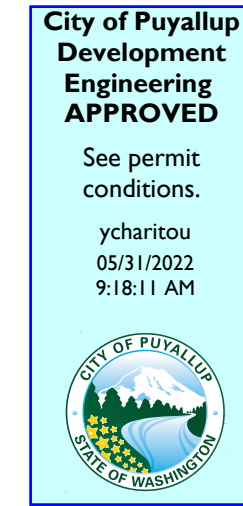

Tax Parcel: 0420281162
Address: 150 RIVER RD

Call Before You Dig. It's the law.
Dial 811 or call 1-800-424-5555.

Civil permit: E-21-0239

City of Puyallup
Development & Permitting Services
ISSUED PERMIT

Building	Planning
Engineering	Public Works
Fire	Traffic

**KORUM
LINCOLN
'VITRINE'
DEALERSHIP**

REMDEL/ ADDITION
FOR
SOUTHWEST CORNER
PROPERTIES

150 RIVER ROAD
PUYALLUP, WA 98371

GENERAL NOTES

REVISIONS

DRAWING ISSUED FOR
COORDINATION

DATE 10 SEPT 2020

PROJECT# 1820.00
DRAWN BY: KL
CHECKED BY: DB
PLOT SCALE: 1:1
DRAWING SCALE:
1" = 20'-0"

DRAWING CONTENTS
**PRELIMINARY
ARCHITECTURAL
SITE PLAN**

DRAWING NO.

A1.1

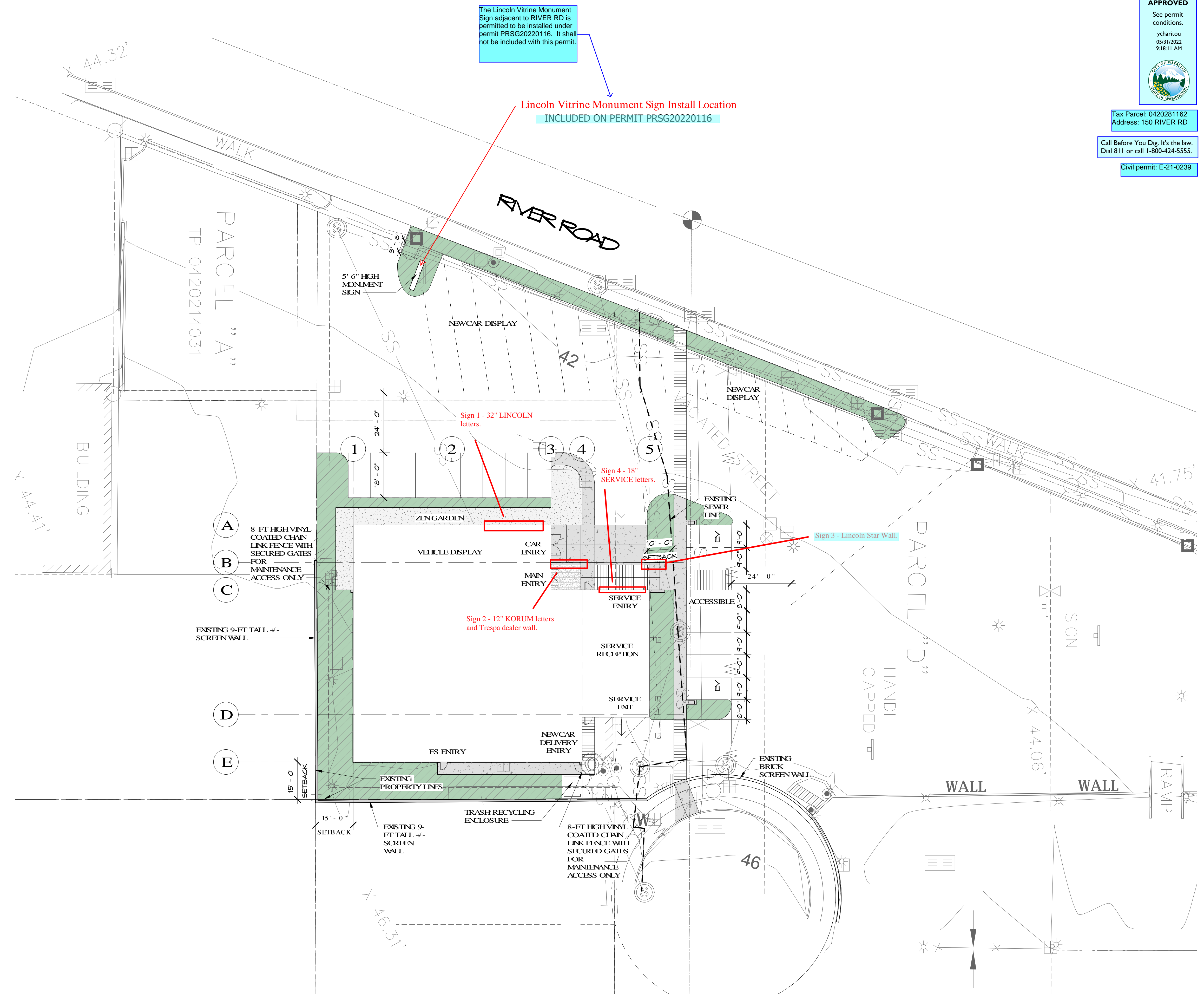

The Lincoln Vitrine Monument Sign adjacent to RIVER RD is permitted to be installed under permit PRSG20220116. It shall not be included with this permit.

Lincoln Vitrine Monument Sign Install Location
INCLUDED ON PERMIT PRSG20220116

1 PRELIMINARY ARCHITECTURAL SITE PLAN
1" = 20'-0"

