

PLANT LEGEND			
TREES			
SYMBOL	QTY	DESCRIPTION	SIZE
	3	Acer ginnala Amur Maple	1" Cal. Min Well Formed / 8' Min. Ht.
	2	Syringa reticulata 'Ivory Silk' Ivory Silk Lilac	1" Cal. Min Well Formed / 8' Min. Ht.
	16	Cedrus deodara 'Karl Fuchs' Karl Fuchs Deodar Cedar	8' Ht. Min. Well Formed
	4	Chamaecyparis lawsoniana 'Grayswood Pillar' Lawson's Cypress 'Grayswood Pillar'	8' Ht. Min. Well Formed
	6	Picea omorika 'Pendula' Weeping Serbian Spruce	8' Ht. Min. Well Formed
	2	Pinus nigra 'Pom Pom form' Black Pine	8' Ht. Min. 5 pom poms
	1	Parrotia persica Persian Parrotia	1" Cal. Min Well Formed / 8' Min. Ht.
	1	Chamaecyparis lawsoniana 'Wissel's Saguaro' Wissel's Saguaro False Cypress	8' Ht. Min. B&B
	1	Cornus nuttallii Flowering Dogwood	NATIVE 2" Cal. Min Well Formed
SHRUBS & GROUND COVERS			
SYMBOL	QTY	DESCRIPTION	SIZE
	41	Pinus mugo pumillo or combination of similar dwarf Dwarf Mugo Pine	3 Gal. Min.
	4	Myrica californica Pacific Wax Myrtle	NATIVE 3 Gal. Min.
	5	Nandina domestica compacta 'Gulf Stream' Gulf Stream Nandina	3 Gal. Min.
	58	Carex testacea Orange Sedge	2 Gal. Min.
	12	Hakonechloa macra 'Aureola' Japanese Forest Grass	2 Gal. Min.
	59	Mahonia confusa 'Narihira' Narihira Mahonia	3 Gal. Min.
	9	Taxus baccata 'Fastigiata' Irish Yew	3 Gal. Min.
	17	Thuja plicata 'Little Gem' Little Gem Arborvitae	5 Gal. or B&B
		Fragaria chiloensis Wild Strawberry	NATIVE 1 Gal. Min.
		Ophiopogon planifolius 'nigra' Black Mondo Grass @20" OC Triangular Spacing	1 Gal. Min.
		Arctostaphylos uva-ursi 'Massachusetts' Kinnickinnick @24" OC Triangular Spacing	NATIVE 1 Gal. Min.
		Ophiopogon japonicus 'nana' Dwarf Mondo Grass @2" OC Triangular Spacing - split gallon pots into plugs and spread throughout area at 2' spacing	1 Gal. Min.
		Ajuga reptans 'Chocolate Chip' Chocolate Chip Carpet Bugle at 18" OC Triangular Spacing	1 Gal. Min.
	24 - One man 5 - Two man 5 - Three man	Landscape Boulders - Granite w/ Smooth Edges Interesting Formation	
Sod - Low Grow Low Water Seed mix			

NOTE: CONTRACTOR SHALL SUBMIT PLANT LIST PRIOR TO PURCHASING AND INSTALLING PLANT MATERIAL. ANY SUBSTITUTIONS SHALL BE APPROVED BY LANDSCAPE ARCHITECT AND CITY.

TOTAL TOP SOIL AND MULCH CALCULATIONS

SOIL DEPTH	TOTAL LANDSCAPE AREA SOILS
8"	2702 X (8") .66 / 27=66 CUBIC YARDS
18"	4354 X (18") 1.5 / 27 = 242 CUBIC YARDS

NOTE: A MINIMUM OF 25 PERCENT OF THE SHRUBS AND GROUND COVERS USED IN PROJECTS UNDER THE REQUIREMENTS OF THE PMC AND THE VMS SHALL BE NATIVE TO THE PUGET SOUND REGION (VMS 7.3). 3 NATIVE SHRUBS / GC VARIETIES PROPOSED / 11 SHRUBS = 27%

■ SILVA SOIL CELLS - SEE DETAIL SHEET L2 SOILS FOR SOIL CELLS SHALL BE PER MANUFACTURER'S SPECIFICATIONS.

— DEEP ROOT - ROOT BARRIER 24" DEEP PANELS - AS INDICATED ON PLAN

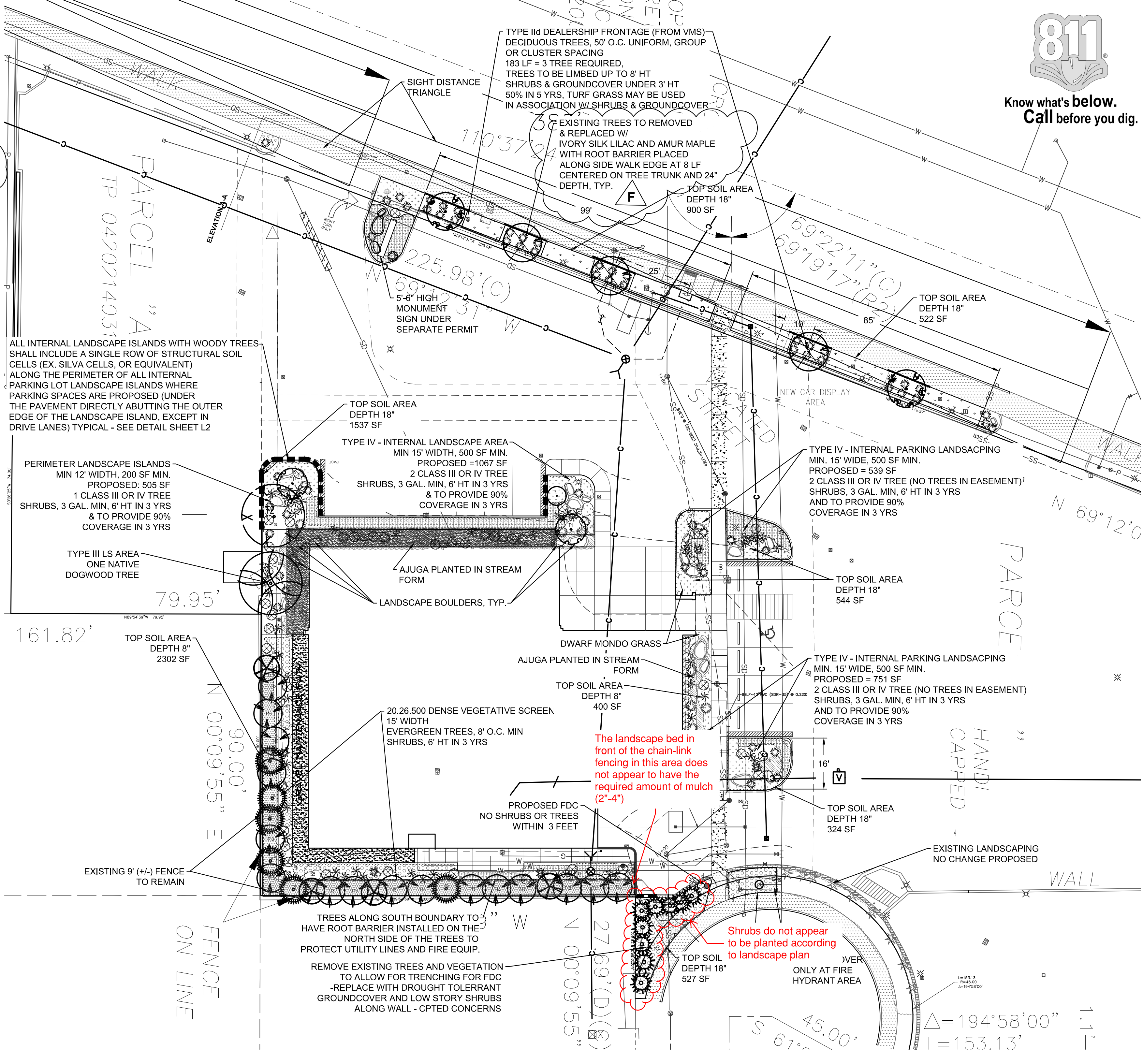

PROJECT: KORUM LINCOLN 150 RIVER ROAD PUYALLUP, WA

- REVISIONS:
- C. REVISED TO NEW SITE LAYOUT & AGENCY COMMENTS
 - E. REVISED TO NEW SITE LAYOUT & AGENCY COMMENTS
 - F. REVISED PER AGENCY COMMENTS
 - G. REVISED PER AGENCY COMMENTS
 - H. REVISED PER AGENCY COMMENTS

DRAWING ISSUED FOR: AGENCY REVIEW

DATE: JULY 7, 2021

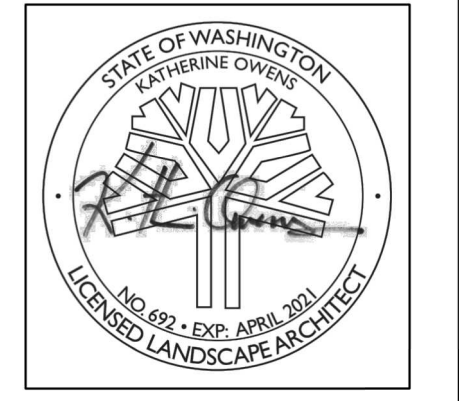

PROJECT NO.: 2077
FILE NAME: 2077LSF
X-REFS: CIVIL
DRAWN BY: KLO
CHECKED BY: KLO
PLOT SCALE: 1:1
DRAWING SCALES: 1:20, 1:4

DRAWING CONTENTS: LANDSCAPE PLANTING PLAN, NOTES & DETAILS

DRAWING NO.: L1

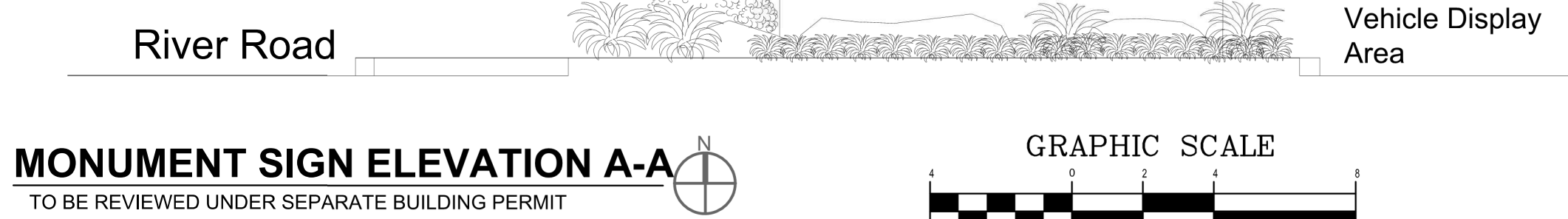

TO BE REVIEWED UNDER SEPARATE BUILDING PERMIT

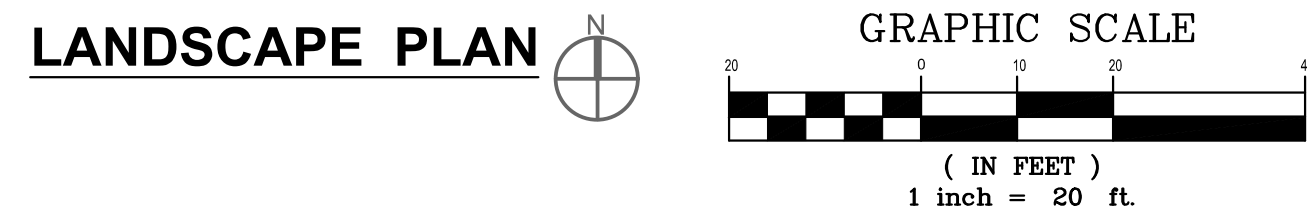
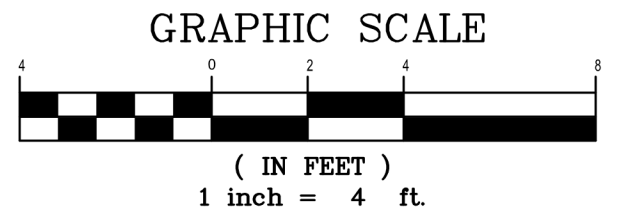

CITY OF PUYALLUP
Planning Division
Approved Landscape Plan
(253) 864-4165

Staff: KWals
Date: 07/09/2021
THIS APPROVAL IS VOID AFTER 180 DAYS FROM APPROVAL DATE. THE CITY IS NOT RESPONSIBLE FOR ERRORS OR OMISSIONS ON THESE PLANS. FIELD CONDITIONS MAY DICTATE CHANGES TO THESE PLANS AS DETERMINED BY THE PLANNING DIRECTOR, DESIGNER, OR PROJECT PLANNER.

NOTE: If street trees are required, Call Planning Division for final inspection: (253) 864-4165 (Option 3) Root barriers are required around street trees in accordance with city standard detail. Top soil shall be installed in accordance with city standards - field verification required. Failure to install top soil and root barriers in accordance with the city standards may result in rejection of installation.