

## PRFUP2022126

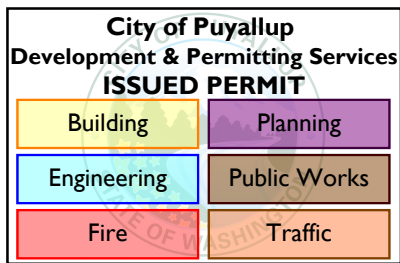

## SITE SPECIFIC NOTES

P01 (568241-155305)

- REPLACE EXIST POLE PER TRANSMISSION WO# 111027668
- INST 3Ø PRI NEUT DBL DE ARM (6033.3064 DDEP313)
- TRANSFER EXIST 600A 3Ø GANG (ops) (6022.2000 DLSG15) EXTEND ARM IF NECESSARY
- EXTEND CONTROL ARM IF NECESSARY
- INST EXIST SW #P298
- TRANSFER EXIST OH SEC
- TOP POLE TO COMMS

P02 (568255-155305)

- RAISE EXIST S/L 12-18" ABOVE TOP COMMS
- CREW TO MAINTAIN SAFETY SPACE CLEARANCES

P03 (568280-155305)

- RAISE SECONDARY 35'-0" AGL
- CREW TO MAINTAIN MIN. 30 MIDSPAN CLEARANCES

## POWER GENERAL NOTES

1. All materials to be installed in accordance with Puget Sound Energy's (PSE) standards. Any deviation from this work sketch must be AUTHORIZED by Potelco's Project Manager and NOTED on the Foreman's Copy.
2. All switching arrangements and/or outage arrangements are to be made with the Project Manager at least three (3) working days in advance.
3. Contact the Utilities Underground Location Center (1-800-424-5555) at least 48 hours prior to commencing work to get the underground facilities located.
4. All work is to be done in accordance with local municipal and county permit requirements as applicable.
5. Inclement weather conditions may cause delays in construction times and dates.

## EROSION & SEDIMENT CONTROL REQUIREMENTS

EROSION & SEDIMENT CONTROL SHALL BE PER PSE STANDARD PRACTICE - 0150 3200 TECHNIQUES FOR TEMPORARY EROSION & SEDIMENT CONTROL & ANY ADDITIONAL LOCAL JURISDICTION REQUIREMENTS. (LOCAL JURISDICTIONS MAY HAVE ADDITIONAL REQUIREMENTS INCLUDING NOTES DETAILING WHERE EROSION OR SEDIMENT CONTROL STRUCTURES ARE TO BE INSTALLED, CROSS SECTION DETAILS OF THE TYPICAL EROSION STRUCTURES, & SPECIAL REQUIREMENTS FOR WORK IN SENSITIVE AREAS.)

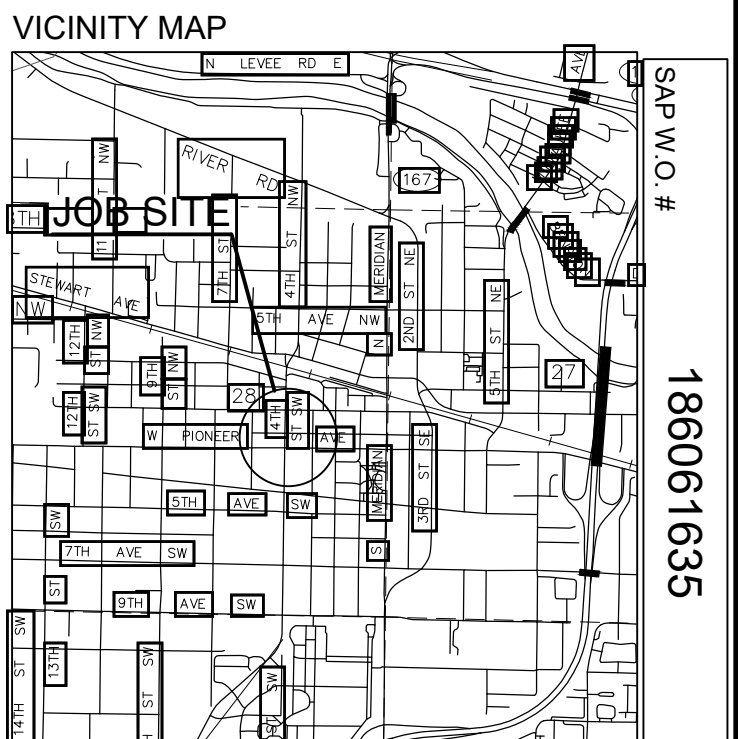
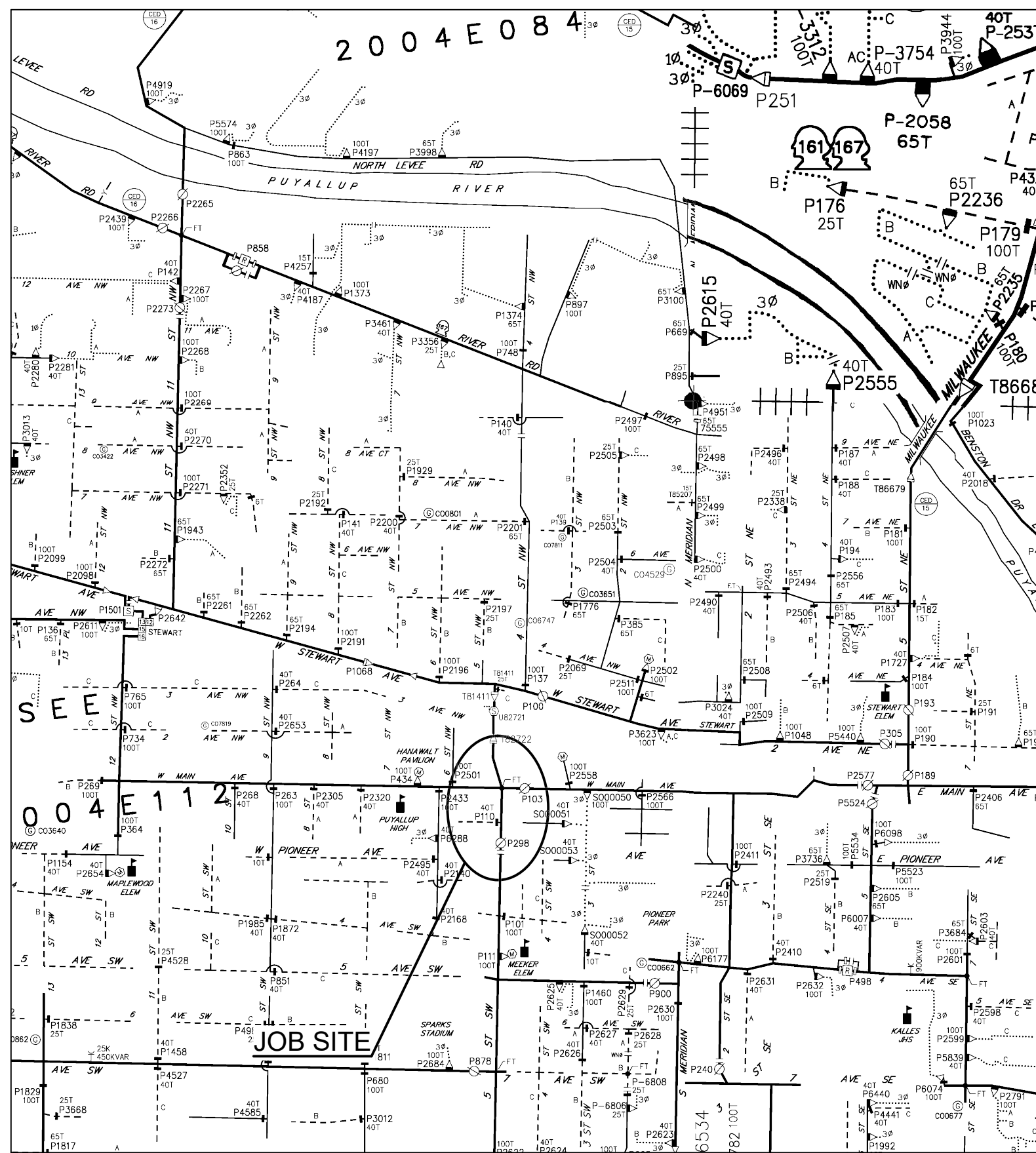
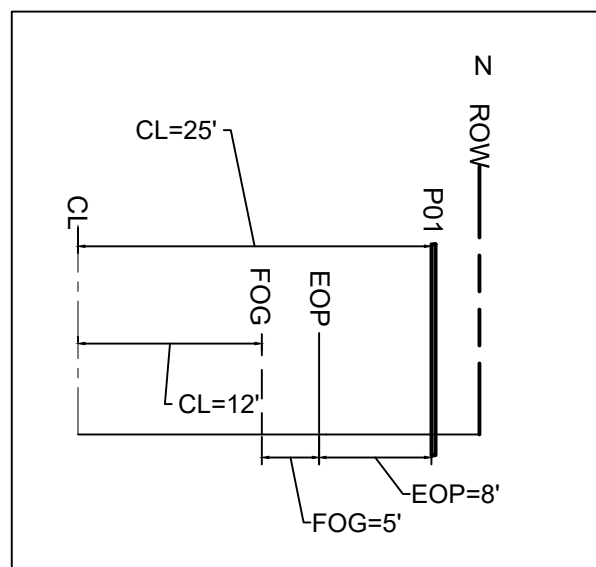

FOREMAN (CHECK BOX WHEN COMPLETED)

- ☐ PSE Equipment LOCKED/SECURED & Work Area left in CLEAN/SAFE Condition.
- ☐ Grid, Cable, and Switch numbers INSTALLED & VERIFIED.
- ☐ Field Changes RED-LINED on As-built.
- ☐ Material VERIFIED and CHANGES noted on Paperwork.
- ☐ Total PRIMARY Cable noted on As-built.
- ☐ Company ID#'s RECORDED in correct location on As-built.
- ☐ Indicate correct FUSE SIZE on As-built & VERIFY proper PHASE.
- ☐ Deviations noted on the As-built and their reason.

☐ I certify that the work performed meets PSE's standards and procedures and that all quality requirements are met.

Foreman's Signature

Print Name \_\_\_\_\_

**CALL (800) 424-5555**

**2 BUSINESS DAYS BEFORE YOU DIG**

PROJECT PHASE		NOTIF#	ORDER#
<b>PWR</b>	Superior	512583816	186061635
	Sub Order		N/A
			N/A
			N/A

	Developer	Yes	<u>Yes</u>	<u>PSE</u>
"Locates Required"		No	No	
"Outages Required"		<u>Yes</u>	No	
"Flagging Required"		<u>Yes</u>	No	

3					FUNCTION	CONTACT	PHONE NO	DATE
2					PROJECT MGR	V. PLUYIOSE	253-553-6176	4/6/2022
1					ENGR - POWER	J. REYNA	253-259-7076	4/6/2022
REV#	DATE	BY	DESCRIPTION		ENGR - GAS	N/A	N/A	N/A
COUNTY		Emer Sect	Gas Wk Ctr	POWER WK CTR	DRAWN BY	M.COBBINAH	N/A	4/6/2022
PIERCE		N/A	N/A	QSWPRE	CHECKED BY			
1/4 SEC		OP MAP		PLAT MAP	APPROVED BY			
T20-R04E-S28		N/A		N/A	FOREMAN #1			
U-JAP NO (POWER)		OH CKT MAP	UG CKT MAP	CIRCUIT NO	FOREMAN #2			
A2004E112		D2004E112,104	R2004E112	STW-16	MAPPING			



ENGR1 MCI TK#5001551  
1) TRANS POLE,RAISE S/L,RAISE DIST,RAISE SEC  
421 W PIONEER PUYALLUP, WA 98371

INCIDENT N/A	MAOP N/A
Gas Order N/A	Elect Order 186061635
SCALE AS NOTED	PAGE 1/1