

Puget Sound Energy  
 Traffic Control Supervisor:  
 Gregory Harwood  
 Card No. 012238  
 Card Exp. 09/30/2023  
 gregory.harwood@pse.com  
 (425) 424-6425  
*Gregory Harwood*

**MOBILE WORK ZONE  
 TREE TRIMMING PROJECT**

**TCP - 2 SHOULDER CLOSURE WHERE SIDEWALK IS IMPACTED**

**City of Puyallup  
 Development & Permitting Services  
 ISSUED PERMIT**

Building	Planning
Engineering	Public Works
Fire	Traffic

PRFUP20221768



Asplundh Vegetation Management  
 Typical Scenario TCP's, King County, WA  
 December 12, 2021  
 gregory.harwood@pse.com  
 (425) 424-6425  
 SHEET 2 December 12, 2021

**CLOSURE ALLOWED:**

Monday 10AM - 2PM  
 Tuesday - Thursday 9AM - 2PM

Call communications center at 253-287-4456 on day of closure.  
 Request a job start inspection through the CityView portal.

The City-issued permit packet shall be posted at the job site and available to inspectors at all times.

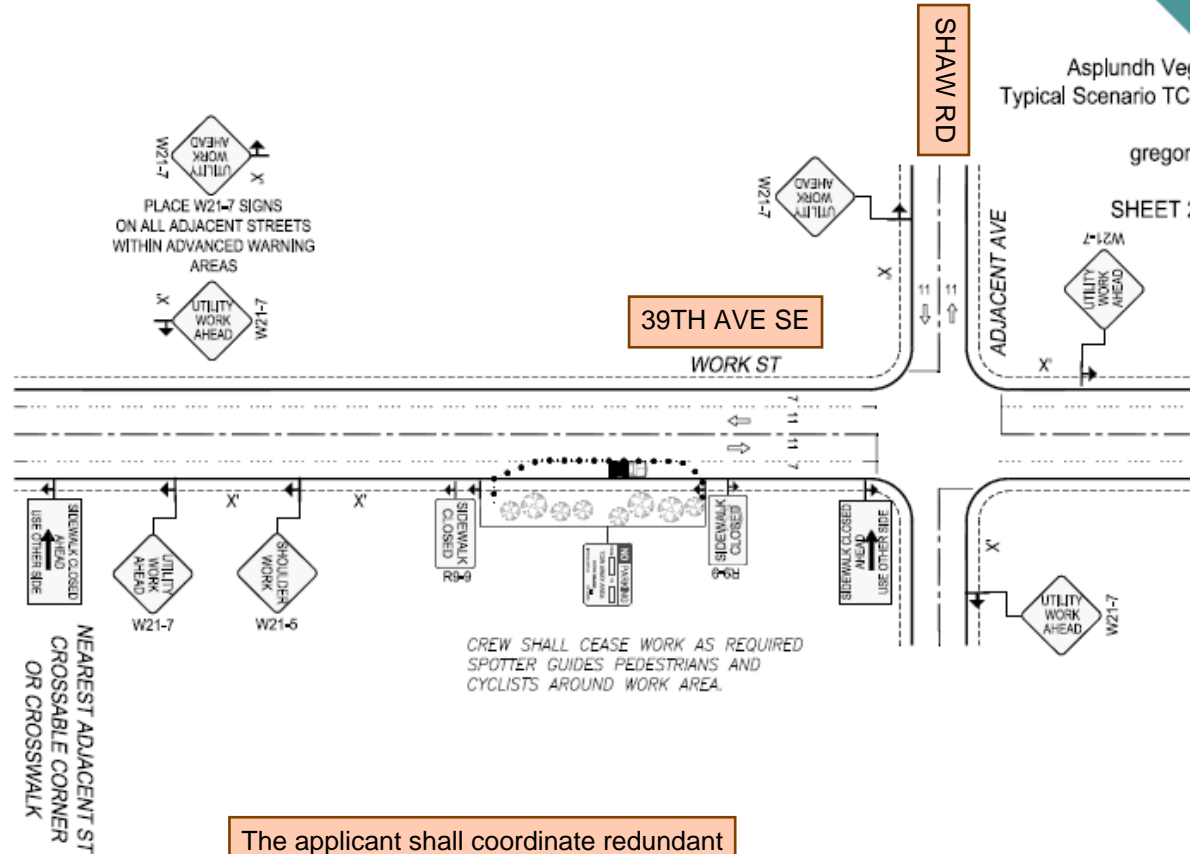

- Notes:
1. All signs and spacing to conform to the MUTCD and King County, WA standards.
  2. All sidewalks, driveways, exits and egresses shall be completely clear unless otherwise indicated.
  3. All vehicles shall stay as far right as possible and shall adjust its spacing to accommodate changing sight distance and other field conditions.
  4. Mobile work is continuously moving or stopped for a brief period of time, less than 15 minutes.
  5. Should the work duration continue on longer than the 15 minute Maximum the Work Zone Traffic Control Setup shall be reconfigured and adjusted to meet the requirements of the Short Duration Stationary Right Shoulder Closure Set-up.
  6. This typical may be used for vehicle based operations such as setting up stationary traffic control (placing cones, drums and signs), but is not to be used for operations that involve workers on foot performing roadway and/or appurtenance repairs.
  7. No-park signs shall be in place 48 hours before job start.

The applicant shall coordinate redundant traffic control devices with other traffic control plans authorized near this site.

Lane Taper Length =  

$$\frac{(\text{width of taper offset}) \times (\text{speed limit})^2}{(\text{width of taper typically measured as width of lane})}$$

- Traffic control devices shall be 28 inch retro-reflective cones.
- Taper length equals width of offset times speed limit squared divided by 60.
- Sign spacing shall be 100 feet when speed limit is 30 mph or less.
- Sign spacing shall be 350 feet when speed limit is greater than 30 mph.
- Distance between cones equals speed limit in unit-feet.
- Travel lane width must be a minimum of 11 feet at all times.
- All flaggers and spotters shall remain in radio contact at all times.

Work shall immediately cease in the work zone for a pedestrian spotter, available at all times, to escort pedestrians around the work area.

**CHANNELIZATION  
 DEVICE SPACING**

MPH	TAPER	TANGENT
55/70	40	80
35/45	30	60
25/30	20	40

NOT TO SCALE

**LEGEND**

- 28" TRAFFIC CONE
- TREELINE
- TRAFFIC FLOW
- FLAGGER
- WORK VEHICLE/  
FLASHING LIGHTS
- SIGN LOCATION
- RIGHT OF WAY

Puget Sound Energy  
 Traffic Control Supervisor:  
 Gregory Harwood  
 Card No. 012238  
 Card Exp. 09/30/2023  
 gregory.harwood@pse.com  
 (425)424-6425  
*Gregory Harwood*

**MOBILE WORK ZONE  
 TREE TRIMMING PROJECT**

TCP - 11 RIGHT LANE CLOSURE

City of Puyallup  
 Development & Permitting Services  
**ISSUED PERMIT**

Building	Planning
Engineering	Public Works
Fire	Traffic

PRFUP20221768



Asplundh Vegetation Management  
 Typical Scenario TCP's, King County, WA  
 December 12, 2021  
 gregory.harwood@pse.com  
 (425) 424-6425  
 SHEET 11 December 12, 2021

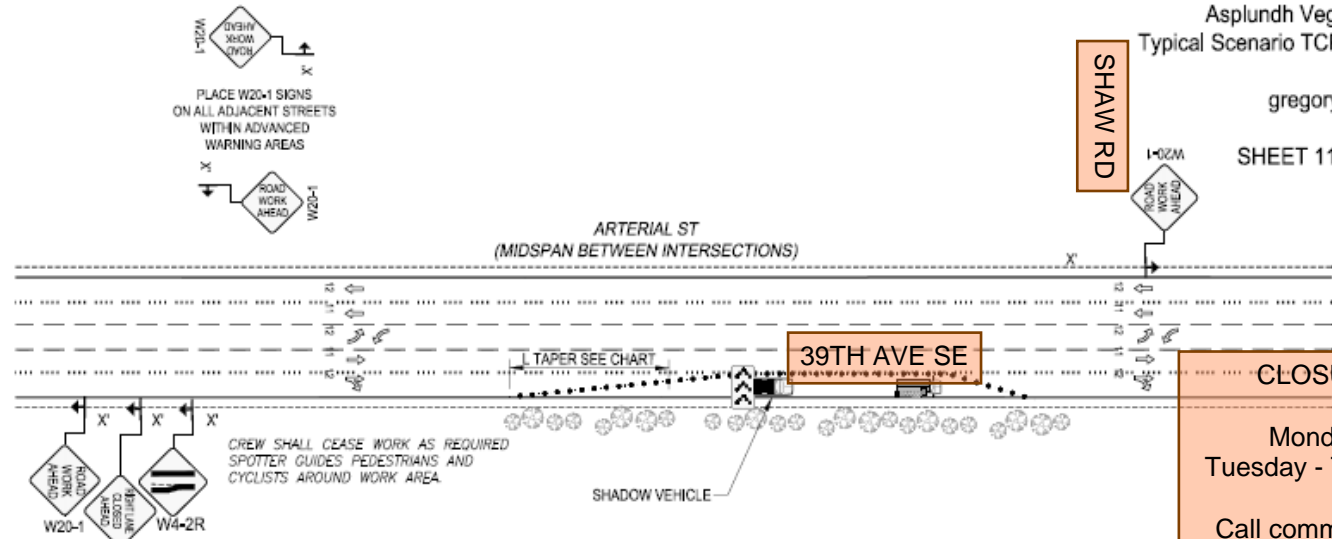

**CLOSURE ALLOWED:**

Monday 10AM - 2PM  
 Tuesday - Thursday 9AM - 2PM

Call communications center at 253-287-4456 on day of closure. Request a job start inspection through the CityView portal.

The City-issued permit packet shall be posted at the job site and available to inspectors at all times.

- Notes:
1. All signs and spacing to conform to the MUTCD and King County, WA standards.
  2. All sidewalks, driveways, exits and egresses shall be completely clear unless otherwise indicated.
  3. All vehicles shall stay as far right as possible and shall adjust its spacing to accommodate changing sight distance and other field conditions.
  4. Mobile work is continuously moving or stopped for a brief period of time, less than 15 minutes.
  5. Should the work duration continue on longer than the 15 minute Maximum the Work Zone Traffic Control Setup shall be reconfigured and adjusted to meet the requirements of the Short Duration Stationary Right Shoulder Closure Set-up.
  6. This typical may be used for vehicle based operations such as setting up stationary traffic control (placing cones, drums and signs), but is not to be used for operations that involve workers on foot performing roadway and/or appurtenance repairs.
  7. No-park signs shall be in place 48 hours before job start.

The applicant shall coordinate redundant traffic control devices with other traffic control plans authorized near this site.

Lane Taper Length = 
$$\frac{(\text{width of taper offset}) \times (\text{speed limit})^2}{(\text{width of taper typically measured as width of lane})}$$

- Traffic control devices shall be 28 inch retro-reflective cones.
- Taper length equals width of offset times speed limit squared divided by 60.
- Sign spacing shall be 100 feet when speed limit is 30 mph or less.
- Sign spacing shall be 350 feet when speed limit is greater than 30 mph.
- Distance between cones equals speed limit in unit-feet.
- Travel lane width must be a minimum of 11 feet at all times.
- All flaggers and spotters shall remain in radio contact at all times.

Work shall immediately cease in the work zone for a pedestrian spotter, available at all times, to escort pedestrians around the work area.

CHANNELIZATION DEVICE SPACING		
MPH	TAPER	TANGENT
55/70	40	80
35/45	30	60
25/30	20	40

NOT TO SCALE

**LEGEND**

- 28" TRAFFIC CONE
- TREELINE
- TRAFFIC FLOW
- WORK VEHICLE/ FLASHING LIGHTS
- SIGN LOCATION
- RIGHT OF WAY