

CPFD

A PORTION OF THE NE 1/4 AND THE SE 1/4 OF SEC. 21, TWN. 20 N, RGE. 04 E, W.M. CITY OF PUYALLUP, PIERCE COUNTY, WASHINGTON

LEGEND:

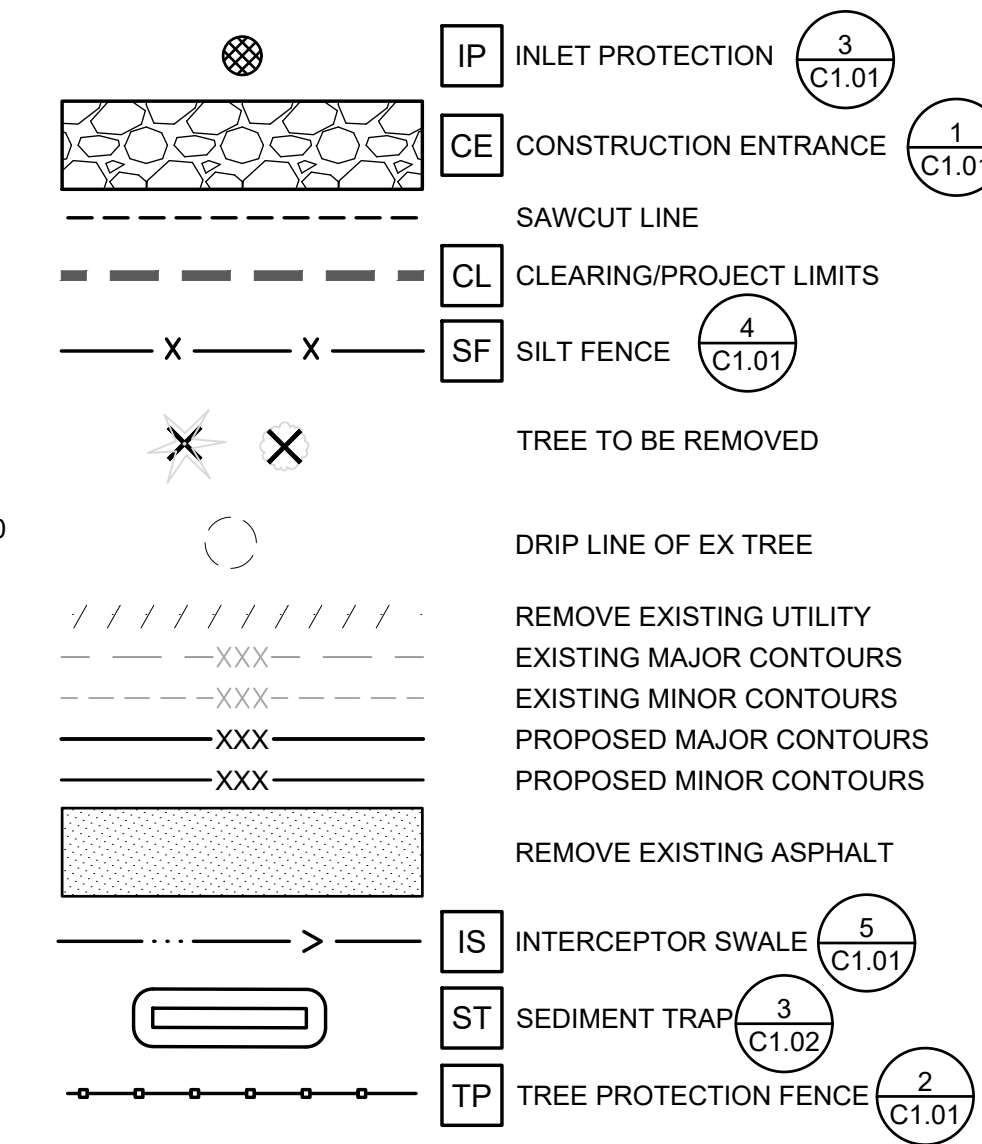

APPROVED

BY: CITY OF PUYALLUP
DEVELOPMENT ENGINEERING

DATE:

NOTE: THIS APPROVAL IS VOID AFTER 180 DAYS FROM APPROVAL DATE. THE CITY WILL NOT BE RESPONSIBLE FOR ERRORS AND/OR OMISSIONS ON THESE PLANS. FIELD CONDITIONS MAY DICTATE CHANGES TO THESE PLANS AS DETERMINED BY THE DEVELOPMENT ENGINEERING MANAGER.

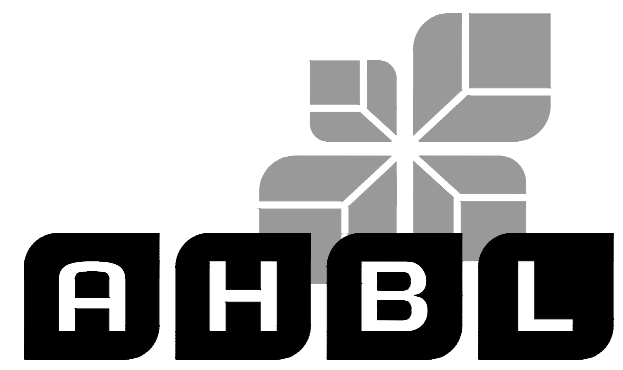

TACOMA · SEATTLE · SPOKANE · TRI-CITIES

2215 North 30th Street, Suite 300, Tacoma, WA 98403
253.383.2422 TEL 253.383.2572 FAX www.ahbl.com WEB

Project Title:

COASTAL PACIFIC FOOD DISTRIBUTION PUYALLUP

Client:

AWB ENGINEERS

1942 NORTHWOOD DRIVE
SALISBURY, MARYLAND 21801

Matt Smith

Project No.:

2230491.11

Issue Set & Date:

PERMIT SET

02/28/2024

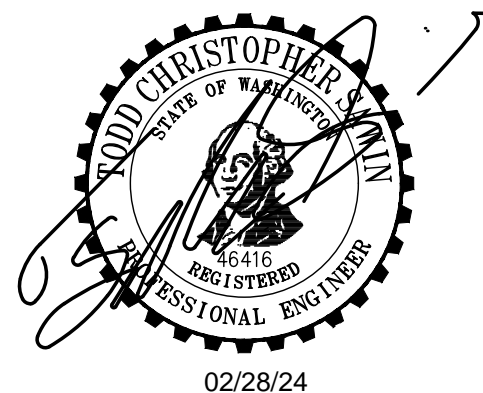

NOTICE:
ALTERATION OF THIS DRAWING SHALL VALIDATE THE PROFESSIONAL SEAL AND SIGNATURE. PUBLICATION OF THIS DOCUMENT DOES NOT REPRESENT THAT THE ORIGINAL DRAWING IS THE ONLY COPY OF THE PROJECT. ANY CHANGES TO THIS DRAWING SHALL BE MADE BY THE ORIGINAL DESIGNER OR A PERSON AUTHORIZED BY HIM OR HER FOR ANY OTHER PROJECT.

KEYNOTES

- 1 PRESERVE AND PROTECT EXISTING TREES TO REMAIN. PROVIDE TREE PROTECTION WHERE INDICATED
- 2 PRESERVE AND PROTECT EXISTING UTILITY TO REMAIN
- 3 EXISTING UTILITY POLE TO BE REMOVED
- 4 RELOCATE EXISTING FIRE HYDRANT
- 5 DEMOLISH EXISTING TRASH ENCLOSURE
- 6 EXISTING SURFACE FEATURE AND FOUNDATION TO BE REMOVED
- 7 REMOVE EXISTING ASPHALT AND CURBING
- 8 REMOVE EXISTING STRIPING
- 9 DEMOLISH EXISTING STORM PIPE OR STRUCTURE
- 10 CONTRACTOR SHALL SWEEP PAVEMENT TO PREVENT TRACKING OF SEDIMENT OFFSITE
- 11 CONTRACTOR SHALL PROTECT EXISTING STORMWATER TREATMENT SYSTEM FOR NEIGHBORING PROPERTIES

DEMOLITION NOTES

1. DEMOLITION: IT IS THE INTENT UNDER THE WORK OF THIS CONTRACT TO INCLUDE, BUT NOT LIMITED TO, THE DEMOLITION OF ALL EXISTING BUILDINGS, PAVING, UTILITIES, BOLLARDS, GATES AND OTHER EXISTING SITE IMPROVEMENTS INCLUDING THE UNDERGROUND COMPONENTS AS CLARIFIED BY THIS DRAWING. IT IS THE CONTRACTOR'S RESPONSIBILITY TO FULLY REVIEW THE SITE CONDITIONS AND TO CORRELATE THESE OBSERVATIONS WITH THE PROJECT WORK AND INCLUDE ALL NECESSARY DEMOLITION, WHETHER SHOWN OR NOT, AND INCLUDE ALL SUCH COSTS IN THE SCOPE OF WORK.
2. CLEARING: IT IS THE INTENT UNDER THE WORK OF THIS CONTRACT TO CONDUCT ALL CLEARING NECESSARY TO BE ABLE TO COMPLETE ALL THE WORK OF THIS PROJECT.
3. CONTRACTOR SHALL LEGALLY DISPOSE ALL DEMOLISHED AND REMOVED MATERIALS OFF THE OWNER'S PROPERTY UNLESS INDICATED OTHERWISE.
4. DEMOLITION WORK MAY OCCUR OUTSIDE OF PROJECT LIMIT.

TESC NOTES

1. APPROVAL OF THIS EROSION AND SEDIMENT CONTROL (ESC) PLAN DOES NOT CONSTITUTE AN APPROVAL OF PERMANENT ROAD OR DRAINAGE DESIGN (E.G., SIZE AND LOCATION OF ROADS, PIPES, RESTRICTORS, CHANNELS, RETENTION FACILITIES, UTILITIES, ETC.).
2. THE IMPLEMENTATION OF THESE ESC PLANS AND THE CONSTRUCTION, MAINTENANCE, REPLACEMENT, AND UPGRADING OF THESE ESC FACILITIES IS THE RESPONSIBILITY OF THE APPLICANT/ESC SUPERVISOR UNTIL ALL CONSTRUCTION IS APPROVED.
3. THE BOUNDARIES OF THE CLEARING LIMITS SHOWN ON THIS PLAN SHALL BE CLEARLY FLAGGED BY A CONTINUOUS LENGTH OF SURVEY TAPE (OR FENCING, IF REQUIRED) PRIOR TO CONSTRUCTION. DURING THE CONSTRUCTION PERIOD, NO DISTURBANCE BEYOND THE CLEARING LIMITS SHALL BE PERMITTED. THE CLEARING LIMITS SHALL BE MAINTAINED BY THE APPLICANT/ESC SUPERVISOR FOR THE DURATION OF CONSTRUCTION.
4. THE ESC FACILITIES SHOWN ON THIS PLAN MUST BE CONSTRUCTED PRIOR TO OR IN CONJUNCTION WITH ALL CLEARING AND GRADING SO AS TO ENSURE THAT THE TRANSPORT OF SEDIMENT TO SURFACE WATERS, DRAINAGE SYSTEMS, AND ADJACENT PROPERTIES IS MINIMIZED.
5. THE ESC FACILITIES SHOWN ON THIS PLAN ARE THE MINIMUM REQUIREMENTS FOR ANTICIPATED SITE CONDITIONS. DURING THE CONSTRUCTION PERIOD, THESE ESC FACILITIES SHALL BE UPGRADED AS NEEDED FOR UNEXPECTED STORM EVENTS AND MODIFIED TO ACCOUNT FOR CHANGING SITE CONDITIONS (E.G., ADDITIONAL SUMP PUMPS, RELOCATION OF DITCHES AND SILT FENCES, ETC.).
6. THE ESC FACILITIES SHALL BE INSPECTED DAILY BY THE APPLICANT/ESC SUPERVISOR AND MAINTAINED TO ENSURE CONTINUED PROPER FUNCTIONING. WRITTEN RECORDS SHALL BE KEPT OF WEEKLY REVIEWS OF THE ESC FACILITIES DURING THE WET SEASON (OCT. 1 TO APRIL 30) AND OF MONTHLY REVIEWS DURING THE DRY SEASON (MAY 1 TO SEPT. 30).
7. ANY AREAS OF EXPOSED SOILS, INCLUDING ROADWAY EMBANKMENTS, THAT WILL NOT BE DISTURBED FOR TWO DAYS DURING THE WET SEASON OR SEVEN DAYS DURING THE DRY SEASON SHALL BE IMMEDIATELY STABILIZED WITH THE APPROVED ESC METHODS (E.G., SEEDING, MULCHING, PLASTIC COVERING, ETC.).
8. ANY AREA NEEDING ESC MEASURES NOT REQUIRING IMMEDIATE ATTENTION SHALL BE ADDRESSED WITHIN FIFTEEN (15) DAYS.
9. THE ESC FACILITIES ON INACTIVE SITES SHALL BE INSPECTED AND MAINTAINED A MINIMUM OF ONCE A MONTH OR WITHIN FORTY-EIGHT (48) HOURS FOLLOWING A STORM EVENT.
10. AT NO TIME SHALL MORE THAN ONE (1) FOOT OF SEDIMENT BE ALLOWED TO ACCUMULATE WITHIN A CATCH BASIN. ALL CATCH BASINS AND CONVEYANCE LINES SHALL BE CLEANED PRIOR TO PAVING. THE CLEANING OPERATION SHALL NOT FLUSH SEDIMENT-LADEN WATER INTO THE DOWNSTREAM SYSTEM.
11. STABILIZED CONSTRUCTION ENTRANCES AND ROADS SHALL BE INSTALLED AT THE BEGINNING OF CONSTRUCTION AND MAINTAINED FOR THE DURATION OF THE PROJECT. ADDITIONAL MEASURES, SUCH AS WASH PADS, MAY BE REQUIRED TO ENSURE THAT ALL PAVED AREAS ARE KEPT CLEAN FOR THE DURATION OF THE PROJECT.
12. ANY PERMANENT FLOW CONTROL FACILITY USED AS A TEMPORARY SETTLING BASIN SHALL BE MODIFIED WITH THE NECESSARY EROSION CONTROL MEASURES AND SHALL PROVIDE ADEQUATE STORAGE CAPACITY. IF THE FACILITY IS TO FUNCTION ULTIMATELY AS AN INFILTRATION SYSTEM, THE TEMPORARY FACILITY MUST BE GRADED SO THAT THE BOTTOM AND SIDES ARE AT LEAST THREE FEET ABOVE THE FINAL GRADE OF THE PERMANENT FACILITY.
13. WHERE STRAW MULCH FOR TEMPORARY EROSION CONTROL IS REQUIRED, IT SHALL BE APPLIED AT A MINIMUM THICKNESS OF 2 TO 3 INCHES.
14. PRIOR TO THE BEGINNING OF THE WET SEASON (OCT. 1), ALL DISTURBED AREAS SHALL BE REVIEWED TO IDENTIFY WHICH ONES CAN BE SEEDED IN PREPARATION FOR THE WINTER RAINS. DISTURBED AREAS SHALL BE SEEDED WITHIN ONE WEEK OF THE BEGINNING OF THE WET SEASON. A SKETCH MAP OF THOSE AREAS TO BE SEEDED AND THOSE AREAS TO REMAIN UNCOVERED SHALL BE SUBMITTED TO THE CITY INSPECTOR. THE CITY INSPECTOR CAN REQUIRE SEEDING OF ADDITIONAL AREAS IN ORDER TO PROTECT SURFACE WATERS, ADJACENT PROPERTIES, OR DRAINAGE FACILITIES.
15. UPON COMPLETION OF THE PROJECT, ALL DISTURBED AREAS MUST BE STABILIZED AND BEST MANAGEMENT PRACTICES REMOVED IF APPROPRIATE.

CONSTRUCTION SEQUENCE:

1. HOLD A PRECONSTRUCTION MEETING WITH THE CITY AND OBTAIN REQUIRED PERMITS.
2. ESTABLISH CLEARING AND GRADING LIMITS.
3. CONSTRUCT TEMPORARY CONSTRUCTION ENTRANCE.
4. CONSTRUCT PERIMETER DITCHES, SILT FENCES, AND OTHER EROSION CONTROL DEVICES AS SHOWN.
5. CONSTRUCT PROTECTION DEVICES FOR CRITICAL AREAS AND SIGNIFICANT TREES PROPOSED FOR RETENTION.
6. SCHEDULE AN EROSION CONTROL INSPECTION WITH THE CITY.
7. CONSTRUCT STORM DRAINAGE FACILITIES. PROVIDE EMERGENCY OVERFLOW AS APPLICABLE.
8. ALL DITCHES AND SWALES AS SHOWN SHALL BE PROVIDED TO DIRECT ALL SURFACE WATER TO THE SEDIMENTATION POND AS CLEARING AND GRADING PROGRESSES. NO UNCONTROLLED SURFACE WATER SHALL BE ALLOWED TO LEAVE THE SITE OR BE DISCHARGED TO A CRITICAL AREA AT ANY TIME DURING THE GRADING OPERATIONS.
9. GRADING ACTIVITIES CAN BEGIN ONLY AFTER ALL DRAINAGE AND EROSION CONTROL MEASURES ARE IN PLACE.
10. PROVIDE ROUTINE MAINTENANCE FOR EROSION CONTROL MEASURES AS REQUIRED.

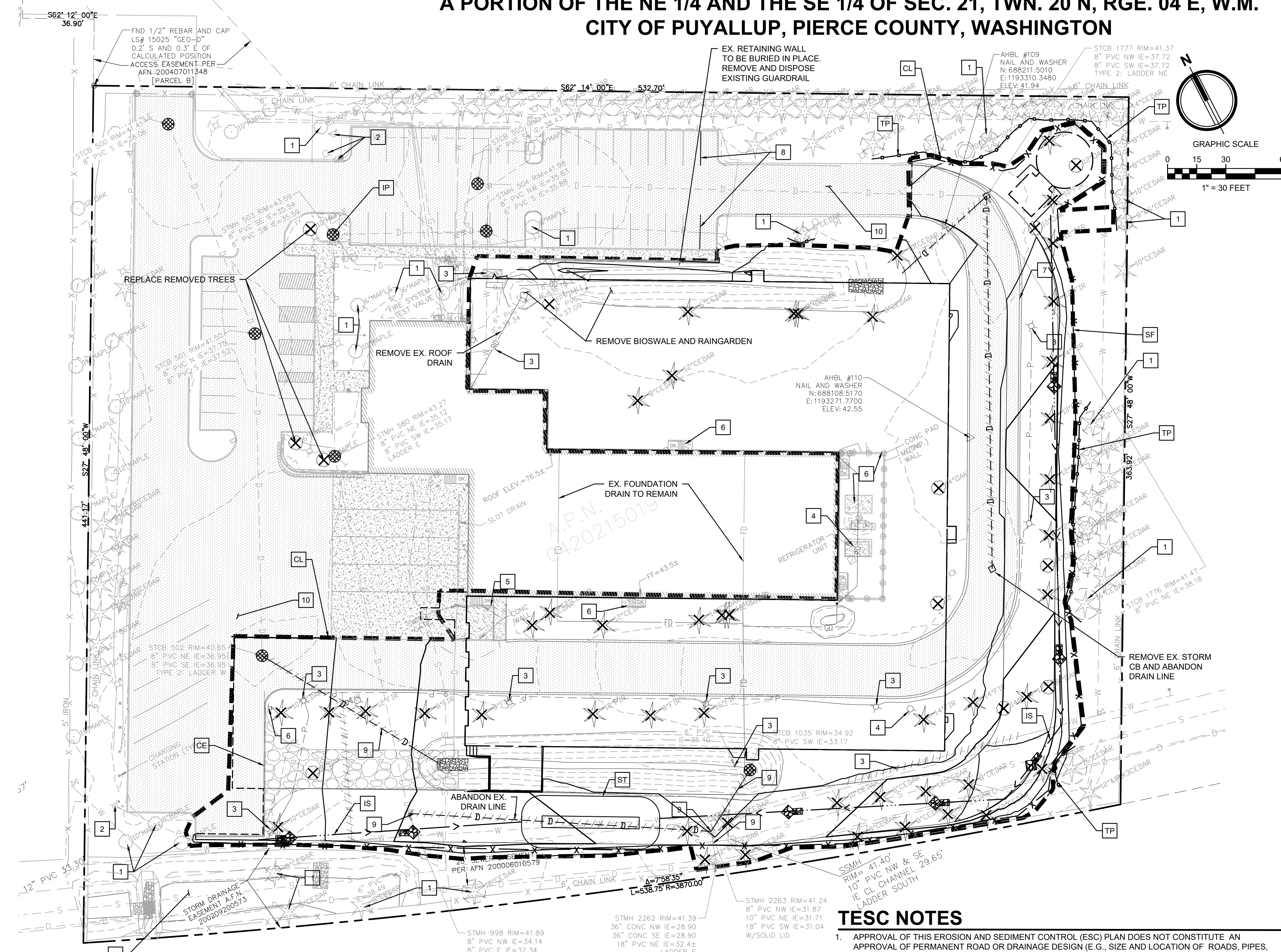

Know what's below.
Call before you dig.

CPFD

A PORTION OF THE NE 1/4 AND THE SE 1/4 OF SEC. 21, TWN. 20 N, RGE. 04 E, W.M. CITY OF PUYALLUP, PIERCE COUNTY, WASHINGTON

APPROVED

BY
CITY OF PUYALLUP
DEVELOPMENT ENGINEERING

DATE

NOTE: THIS APPROVAL IS VOID AFTER 180 DAYS FROM APPROVAL DATE. THE CITY WILL NOT BE RESPONSIBLE FOR ERRORS AND/OR OMISSIONS ON THESE PLANS. FIELD CONDITIONS MAY DICTATE CHANGES TO THESE PLANS AS DETERMINED BY THE DEVELOPMENT ENGINEERING MANAGER.

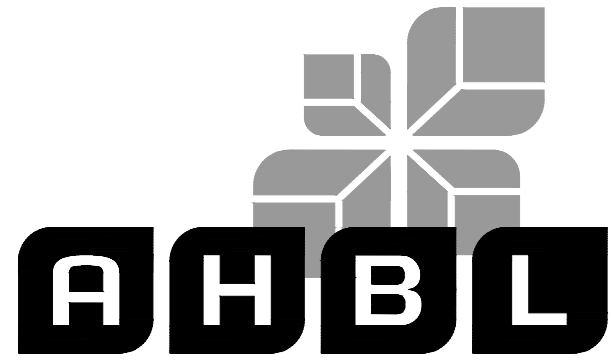

TACOMA · SEATTLE · SPOKANE · TRI-CITIES

2215 North 30th Street, Suite 300, Tacoma, WA 98403
253.383.2422 TEL 253.383.2572 FAX www.ahbl.com WEB

Project Title:

COASTAL PACIFIC FOOD DISTRIBUTION PUYALLUP

Client:

AWB ENGINEERS

1942 NORTHWOOD DRIVE
SALISBURY, MARYLAND 21801

Matt Smith

Project No.

2230491.11

Issue Set & Date:

PERMIT SET

02/28/2024

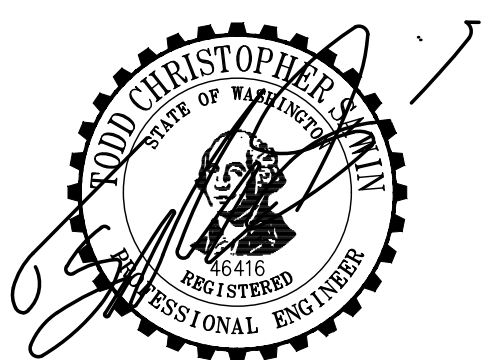

02/28/24

NOTICE: ALTERATION OF THIS DOCUMENT SHALL INVALIDATE THE PROFESSIONAL SEAL AND SIGNATURE. PUBLICATION OF THIS DOCUMENT DOES NOT CONSTITUTE PROFESSIONAL ENGINEERING REVIEW. THE DOCUMENT IS THE PROPERTY OF THE CITY OF PUYALLUP AND IS TO BE USED ONLY FOR THE PROJECT SPECIFIED IN THE BLOCK AND NOT TO BE USED FOR OTHER PURPOSES OR IN CONNECTION WITH ANY OTHER PROJECT.

- ALL LIMITS OF CLEARING AND AREAS OF VEGETATION PRESERVATION AS PRESCRIBED ON THE PLANS SHALL BE CLEARLY FLAGGED IN THE FIELD AND OBSERVED DURING CONSTRUCTION.
- ALL REQUIRED SEDIMENTATION AND EROSION CONTROL FACILITIES MUST BE CONSTRUCTED AND IN OPERATION PRIOR TO ANY LAND CLEARING AND/OR OTHER CONSTRUCTION TO ENSURE THAT SEDIMENT LADEN WATER DOES NOT ENTER THE NATURAL DRAINAGE SYSTEM. THE CONTRACTOR SHALL SCHEDULE AN INSPECTION OF THE EROSION CONTROL FACILITIES PRIOR TO ANY LAND CLEARING AND/OR CONSTRUCTION. ALL EROSION AND SEDIMENT FACILITIES SHALL BE MAINTAINED IN A SATISFACTORY CONDITION AS DETERMINED BY THE CITY, UNTIL SUCH TIME THAT CLEARING AND/OR CONSTRUCTION IS COMPLETED AND THE POTENTIAL FOR ON-SITE EROSION HAS PASSED. THE IMPLEMENTATION, MAINTENANCE, REPLACEMENT, AND ADDITIONS TO THE EROSION AND SEDIMENTATION CONTROL SYSTEMS SHALL BE THE RESPONSIBILITY OF THE PERMITEE.
- THE EROSION AND SEDIMENTATION CONTROL SYSTEM FACILITIES DEPICTED ON THESE PLANS ARE INTENDED TO BE MINIMUM REQUIREMENTS TO MEET ANTICIPATED SITE CONDITIONS. AS CONSTRUCTION PROGRESSES AND UNEXPECTED OR SEASONAL CONDITIONS DICTATE, FACILITIES WILL BE NECESSARY TO ENSURE COMPLETE SILTATION CONTROL ON THE SITE. DURING THE COURSE OF CONSTRUCTION, IT SHALL BE THE OBLIGATION AND RESPONSIBILITY OF THE PERMITEE TO ADDRESS ANY NEW CONDITIONS THAT MAY BE CREATED BY HIS ACTIVITIES AND TO PROVIDE ADDITIONAL FACILITIES, OVER AND ABOVE THE MINIMUM REQUIREMENTS, AS MAY BE NEEDED TO PROTECT ADJACENT PROPERTIES, SENSITIVE AREAS, NATURAL WATER COURSES, AND/OR STORM DRAINAGE SYSTEMS.
- APPROVAL OF THESE PLANS IS FOR GRADING, TEMPORARY DRAINAGE, EROSION AND SEDIMENTATION CONTROL ONLY. IT DOES NOT CONSTITUTE AN APPROVAL OF PERMANENT STORM DRAINAGE DESIGN, SIZE OR LOCATION OF PIPES, RESTRICTORS, CHANNELS, OR RETENTION FACILITIES.
- ANY DISTURBED AREA WHICH HAS BEEN STRIPPED OF VEGETATION AND WHERE NO FURTHER WORK IS ANTICIPATED FOR A PERIOD OF 30 DAYS OR MORE, MUST BE IMMEDIATELY STABILIZED WITH MULCHING, GRASS PLANTING, OR OTHER APPROVED EROSION CONTROL TREATMENT APPLICABLE TO THE TIME OF YEAR IN QUESTION. GRASS SEEDING ALONE WILL BE ACCEPTABLE ONLY DURING THE MONTHS OF APRIL THROUGH SEPTEMBER INCLUSIVE. SEEDING MAY PROCEED OUTSIDE THE SPECIFIED TIME PERIOD WHENEVER IT IS IN THE INTEREST OF THE PERMITEE BUT MUST BE AUGMENTED WITH MULCHING, NETTING, OR OTHER TREATMENT APPROVED BY THE CITY.
- IN CASE EROSION OR SEDIMENTATION OCCURS TO ADJACENT PROPERTIES, ALL CONSTRUCTION WORK WITHIN THE DEVELOPMENT THAT WILL FURTHER AGGRAVATE THE SITUATION MUST CEASE, AND THE OWNER/CONTRACTOR WILL IMMEDIATELY COMMENCE RESTORATION METHODS. RESTORATION ACTIVITY WILL CONTINUE UNTIL SUCH TIME AS THE AFFECTED PROPERTY OWNER IS SATISFIED.
- NO TEMPORARY OR PERMANENT STOCKPILING OF MATERIALS OR EQUIPMENT SHALL OCCUR WITHIN CRITICAL AREAS OR ASSOCIATED BUFFERS, OR THE CRITICAL ROOT ZONE FOR VEGETATION PROPOSED FOR RETENTION.

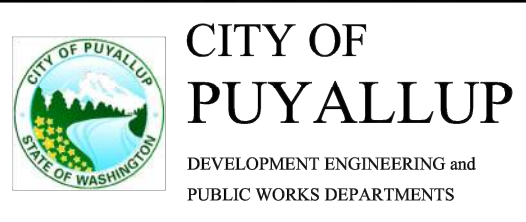

CITY OF PUYALLUP
DEVELOPMENT ENGINEERING and PUBLIC WORKS DEPARTMENTS

GRADING, EROSION, AND SEDIMENTATION CONTROL NOTES

- NOTE:
- GEOTEXTILE MIRAFI 500 X OR APPROVED EQUAL SHALL BE PLACED UNDER THE ENTIRETY OF THE TEMPORARY ENTRANCE.
 - ADDITIONAL ROCK SHALL BE ADDED PERIODICALLY TO MAINTAIN PROPER FUNCTION OF THE PAD.
 - IF THE PAD DOES NOT ADEQUATELY REMOVE THE MUD FROM THE VEHICLE'S WHEELS, THE WHEELS SHALL BE HOSED OFF BEFORE THE VEHICLE ENTERS A PAVED STREET. THE WASHING SHALL BE DONE ON AN AREA COVERED WITH CRUSHED ROCK AND WASH WATER SHALL DRAIN TO A SEDIMENT RETENTION FACILITY OR THROUGH A SILT FENCE.

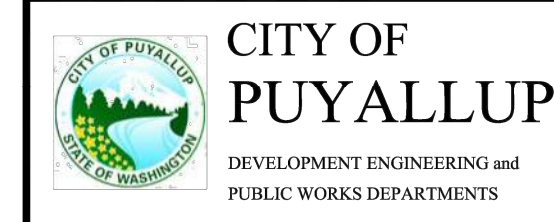
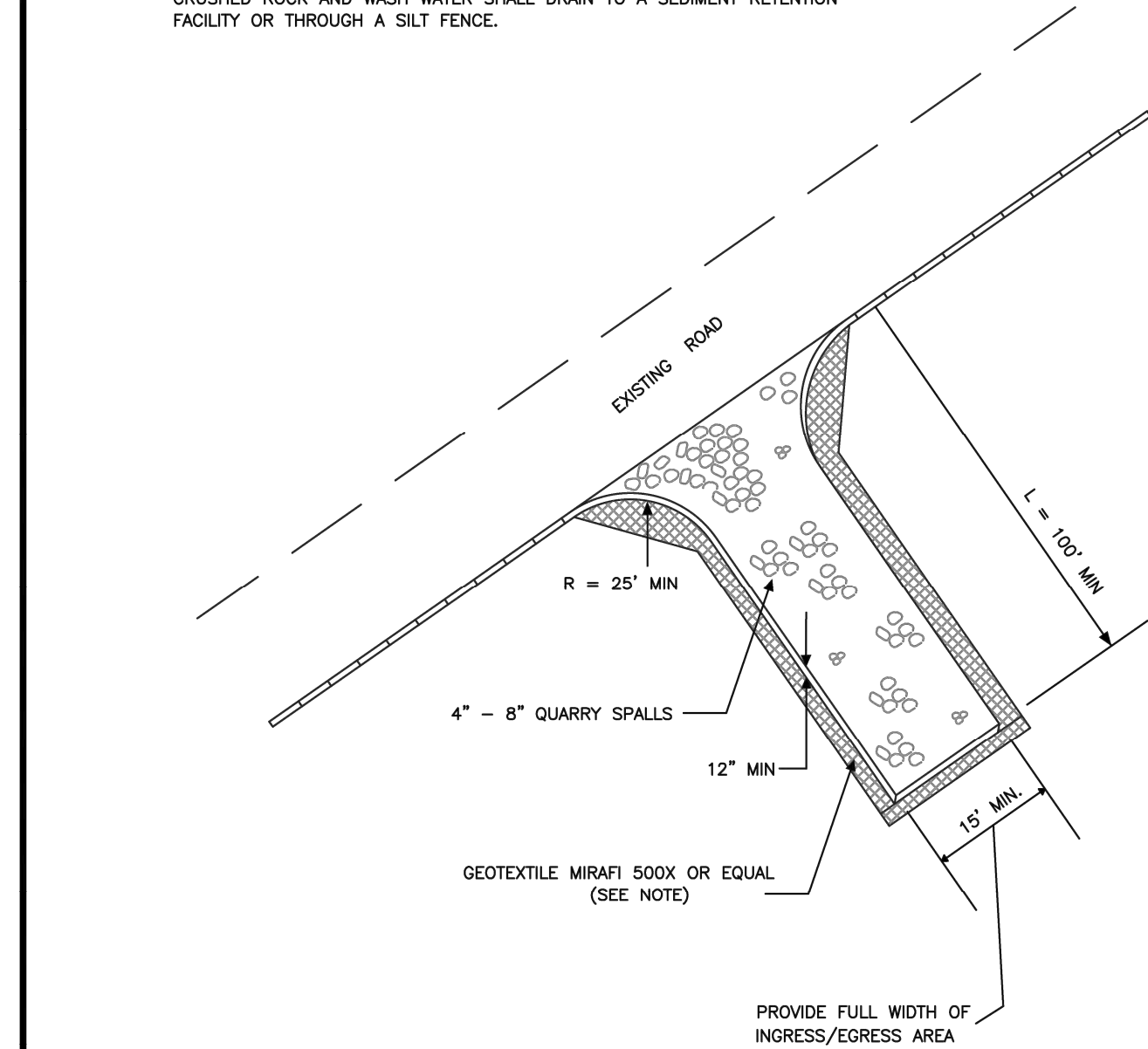

CITY OF PUYALLUP
DEVELOPMENT ENGINEERING and PUBLIC WORKS DEPARTMENTS

TEMPORARY CONSTRUCTION ENTRANCE

DEMOLITION GENERAL NOTES

- CONTRACTOR IS RESPONSIBLE FOR ENSURING THAT ALL UTILITIES HAVE BEEN DISCONNECTED PRIOR TO COMMENCING DEMOLITION.
- DEMOLITION: IT IS THE INTENT OF THE WORK UNDER THIS CONTRACT TO INCLUDE THE DEMOLITION OF ALL EXISTING BUILDINGS, PAVING, UTILITIES AND OTHER EXISTING SITE IMPROVEMENTS INCLUDING THEIR UNDERGROUND COMPONENTS AS INDICATED BY THIS DRAWING AND AS REQUIRED FOR NEW CONSTRUCTION. IT IS THE CONTRACTOR'S RESPONSIBILITY TO FULLY REVIEW THE SITE CONDITIONS AND TO CORRELATE THESE OBSERVATIONS WITH THE PROJECT WORK AND INCLUDE ALL NECESSARY DEMOLITION, WHETHER SHOWN OR NOT, AND INCLUDE ALL SUCH COSTS IN THE BASE BID.
- CLEARING: IT IS THE INTENT OF THE WORK UNDER THIS CONTRACT TO CONDUCT ALL CLEARING NECESSARY TO BE ABLE TO COMPLETE ALL THE WORK OF THIS PROJECT.
- CONTRACTOR SHALL LEGALLY DISPOSE OF THE OWNER'S PROPERTY, ALL DEMOLISHED AND REMOVED MATERIALS, UNLESS INDICATED OTHERWISE.
- IT IS THE RESPONSIBILITY OF THE CONTRACTOR TO COMPLETELY COORDINATE UTILITY DEMOLITION WITH NEW CONSTRUCTION.
- ANY ABANDONED SIDE SEWER(S) SHALL BE PLUGGED OR CAPPED PER CITY OF PUYALLUP STANDARDS.
- CONTRACTOR SHALL MINIMIZE DUST GENERATION ON-SITE BY SPRINKLING THE SITE WITH WATER UNTIL SURFACE IS WET.
- REMOVE CONCRETE SIDEWALK AT THE NEAREST JOINT, UNLESS NOTED OTHERWISE.
- THIS PLAN IS USED IN CONJUNCTION WITH THE CSWPPP AND NPDES CONSTRUCTION STORM WATER PERMIT.
- ANY EXISTING UNDERGROUND STORAGE TANK TO BE REMOVED/ABANDONED PER DOE/DOH REGULATIONS. PROVIDE DOCUMENTATION OF REMOVAL/ABANDONMENT TO CITY INSPECTOR.
- COORDINATE TREE REMOVAL/RETENTION WITH LANDSCAPE PLANS.

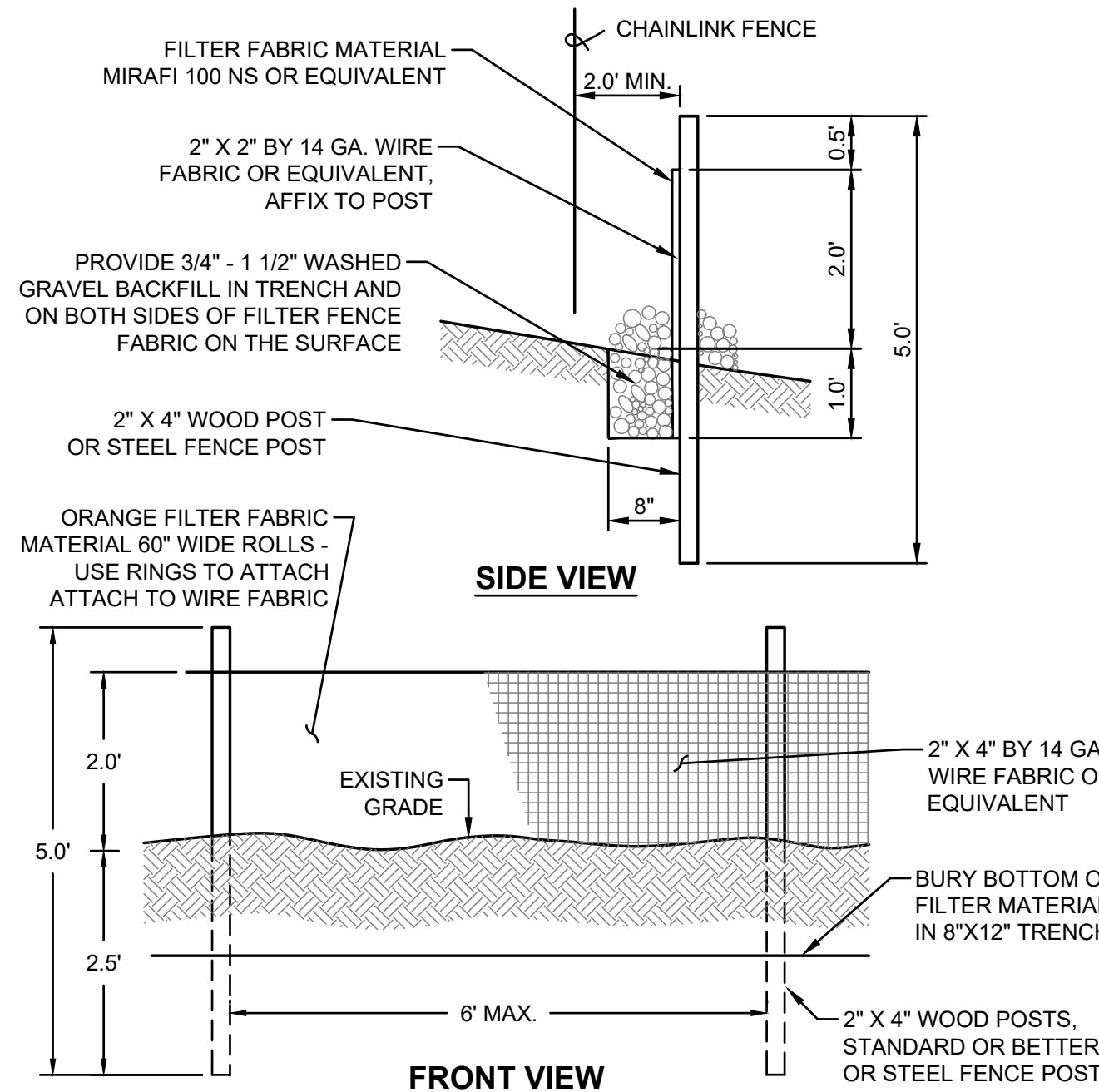

4 SILT FENCE

NOT TO SCALE

NOTES:

- THE FILTER FABRIC SHALL BE PURCHASED IN A CONTINUOUS ROLL CUT TO THE LENGTH OF THE BARRIER TO AVOID USE OF JOINTS. WHEN JOINTS ARE NECESSARY, FILTER CLOTH SHALL BE SPICED TOGETHER ONLY AT A SUPPORT POST WITH A MINIMUM SIX-INCH OVERLAP, AND BOTH ENDS SECURELY FASTENED TO THE POST.
- THE FILTER FABRIC FENCE SHALL BE INSTALLED TO FOLLOW THE CONTOURS (WHERE FEASIBLE). THE FENCE POSTS SHALL BE SPACED A MAXIMUM OF SIX FEET APART AND DRIVEN SECURELY INTO THE GROUND (MINIMUM OF 30").
- A TRENCH SHALL BE EXCAVATED, ROUGHLY EIGHT INCHES WIDE AND TWELVE INCHES DEEP, UPSLOPE AND ADJACENT TO THE WOOD POST TO ALLOW THE FILTER FABRIC TO BE BURIED.
- WHEN STANDARD STRENGTH FILTER FABRIC IS USED, A WIRE MESH SUPPORT FENCE SHALL BE FASTENED SECURELY TO THE UPSLOPE SIDE OF THE POSTS USING HEAVY-DUTY WIRE STAPLES AT LEAST ONE INCH LONG, TIE WIRES, OR HOG RINGS. THE WIRE SHALL EXTEND INTO THE TRENCH A MINIMUM OF FOUR INCHES AND SHALL NOT EXTEND MORE THAN THIRTY SIX INCHES ABOVE THE ORIGINAL GROUND SURFACE.
- THE STANDARD STRENGTH FILTER FABRIC SHALL BE STAPLED OR WIRED TO THE FENCE, AND TWENTY INCHES OF THE FABRIC SHALL BE EXTENDED INTO THE TRENCH. THE FABRIC SHALL NOT EXTEND MORE THAN THIRTY SIX INCHES ABOVE THE ORIGINAL GROUND SURFACE. FILTER FABRIC SHALL NOT BE STAPLED TO EXISTING TREES.
- WHEN EXTRA-STRENGTH FILTER FABRIC AND CLOSER POST SPACING ARE USED, THE WIRE MESH SUPPORT FENCE MAY BE ELIMINATED. IN SUCH A CASE, THE FILTER FABRIC IS STAPLED OR WIRED DIRECTLY TO THE POSTS WITH ALL OTHER PROVISIONS OF STANDARD NOTE (S) APPLYING.
- THE TRENCH SHALL BE BACKFILL WITH 3/4 INCH MINIMUM DIAMETER WASHED GRAVEL.
- FILTER FABRIC FENCES SHALL BE REMOVED WHEN THEY HAVE SERVED THEIR USEFUL PURPOSE, BUT NOT BEFORE THE UPSLOPE AREA HAS BEEN PERMANENTLY STABILIZED.
- FILTER FABRIC FENCES SHALL BE INSPECTED IMMEDIATELY AFTER EACH RAINFALL AND AT LEAST DAILY DURING PROLONGED RAINFALL. ANY REQUIRED REPAIRS SHALL BE MADE IMMEDIATELY.
- CONTRIBUTING LENGTH TO FENCE SHALL NOT BE MORE THAN 100 FEET.
- DO NOT INSTALL BELOW AN OUTLET PIPE OR WEIR.
- DO NOT DRIVE OVER OR FILL OVER FILTER FABRIC FENCE.

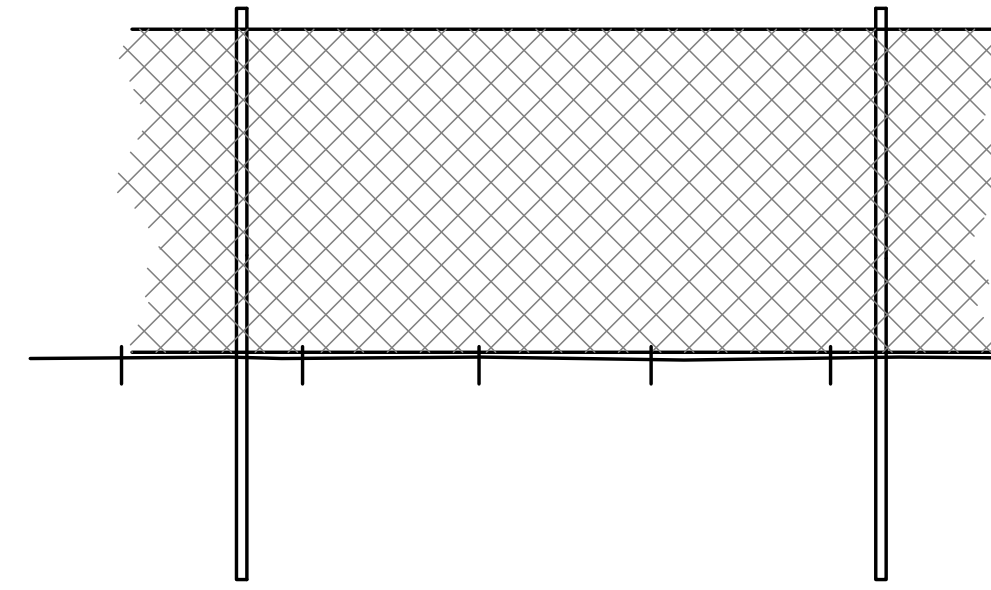

- THE TREE PROTECTION FENCE SHOULD BE MAINTAINED THROUGHOUT GRADING AND CONSTRUCTION AND SHALL NOT BE REMOVED UNTIL FINAL LANDSCAPING IS IN PROGRESS. AT NO TIME SHALL EQUIPMENT ENTER INTO THE ROOT PROTECTION ZONE (RPZ). ALL BRUSH CLEANUP WITHIN THE RPZ SHOULD BE COMPLETED BY HAND TO PREVENT DISTURBANCE OF NATIVE GROUND COVERS. NO CUTS OR FILLS OF UTILITY TRENCHING, MODIFICATIONS TO DRAINAGE, ETC. SHALL IMPACT THE RPZ. NO WIRES, CABLES, OR OTHER DEVICES SHOULD BE ATTACHED TO PROTECTED TREES DURING CONSTRUCTION.
- IF IMPACTS MUST OCCUR WITHIN THE RPZ, CONTACT THE LANDSCAPE ARCHITECT PRIOR TO THE OPERATIONS TO DETERMINE THE PROPER PROCEDURE TO PROTECT THE TREES HEALTH.
- CONTRACTOR SHALL REFER TO SPECIFICATIONS FOR ADDITIONAL INFORMATION.

2 TREE PROTECTION FENCE

NOT TO SCALE

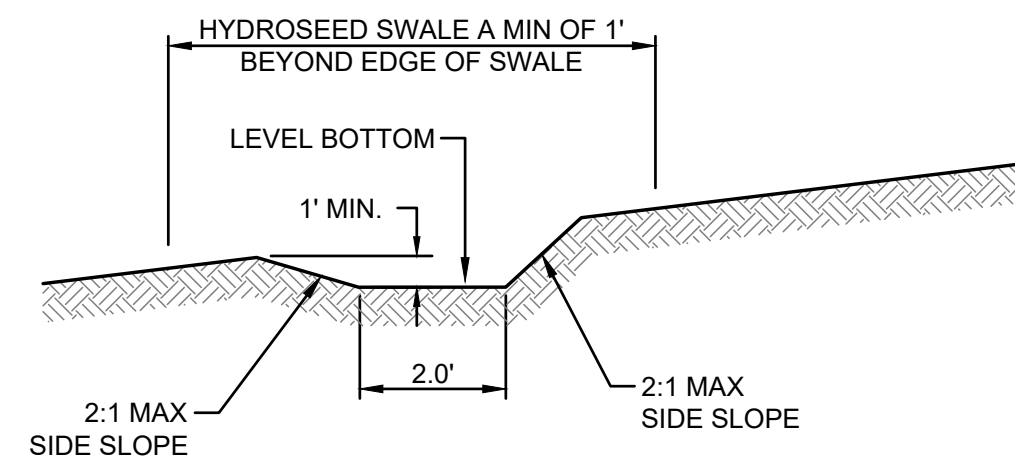

5 INTERCEPTOR SWALE

NOT TO SCALE

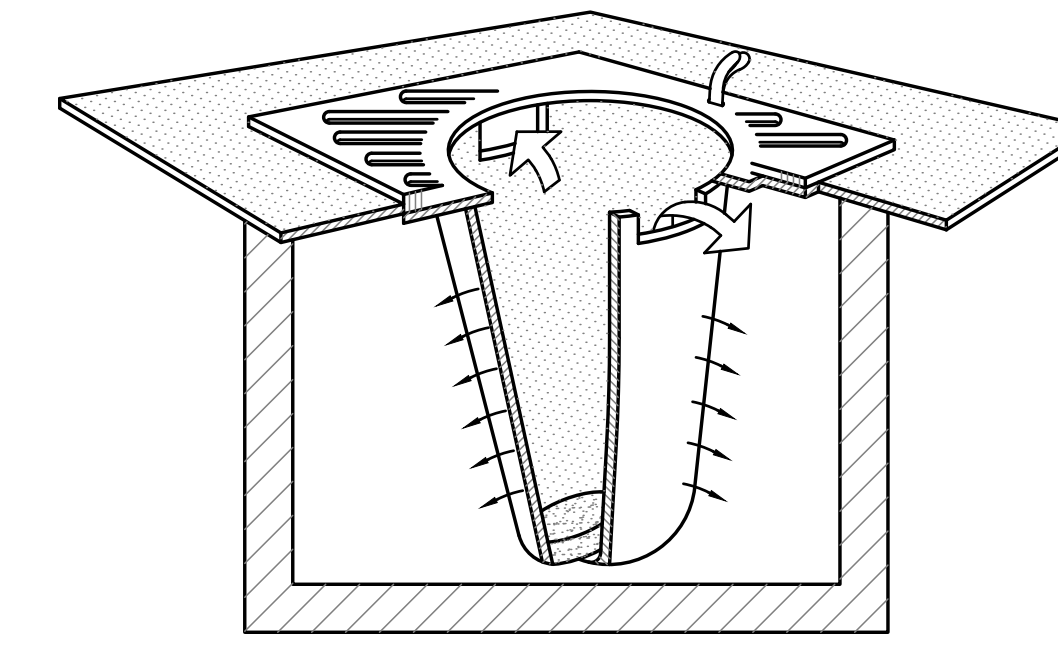

- NOTES:
- FILTERS SHALL BE INSPECTED AFTER EACH STORM EVENT AND CLEANED OR REPLACED WHEN 1/3 FULL.
 - INSTALL INLET PROTECTION IN ALL NEW STORM STRUCTURES THAT WILL COLLECT STORMWATER AS THEY ARE INSTALLED.

3 INLET PROTECTION

NOT TO SCALE

PLASTIC COVERING NOTES

- PLASTIC SHEETING SHALL HAVE A MINIMUM THICKNESS OF 6 MILS AND SHALL MEET THE REQUIREMENTS OF THE WASHINGTON STATE DEPARTMENT OF TRANSPORTATION STANDARD SPECIFICATIONS SECTION 9-14.5(3).
- COVERING SHALL BE INSTALLED AND MAINTAINED TIGHTLY IN PLACE BY USING SANDBAGS OR TIRES ON ROPES WITH A MAXIMUM 10-FOOT GRID SPACING IN ALL DIRECTIONS. ALL SEAMS SHALL BE TAPED OR WEIGHTED DOWN FULL LENGTH. SEAMS SHALL HAVE AT LEAST A 12 INCH OVERLAP.
- CLEAR PLASTIC COVERING SHALL BE INSTALLED IMMEDIATELY ON AREAS SEEDED BETWEEN NOVEMBER 1 AND MARCH 31 AND REMAIN UNTIL VEGETATION IS FIRMLY ESTABLISHED.
- WHEN COVERING IS USED ON UN-SEEDED SLOPES, IT SHALL BE KEPT IN PLACE UNTIL THE NEXT SEEDING PERIOD.
- PLASTIC COVERING SHALL BE BURIED TWO FEET AT THE TOP OF SLOPES IN ORDER TO PREVENT SURFACE WATER FLOW BENEATH SHEETS.
- PROPER MAINTENANCE OF COVERING INCLUDES, BUT IS NOT NECESSARILY LIMITED TO, REGULAR CHECKS FOR AND REPAIRS OF RIPS AND DISLOADED ENDS.

ESC MAINTENANCE REQUIREMENTS:

- EROSION AND SEDIMENTATION CONTROL FACILITIES SHALL BE INSPECTED AFTER EACH STORM EVENT AND DAILY DURING PROLONGED RAINFALL.
- NECESSARY REPAIRS OR REPLACEMENT OF FACILITIES SHALL BE ACCOMPLISHED PROMPTLY.
- SEDIMENT DEPOSITS SHALL BE REMOVED AFTER EACH STORM EVENT OR WHEN THE LEVEL OF DEPOSITION REACHES APPROXIMATELY ONE-HALF THE MAXIMUM POTENTIAL DEPTH.
- SEDIMENT DEPOSITS REMAINING IN PLACE AFTER THE ESC FACILITIES ARE NO LONGER REQUIRED SHALL BE DRESSED TO CONFORM TO THE EXISTING GRADE, PREPARED AND SEEDED.
- TEMPORARY EROSION AND SEDIMENTATION CONTROL FACILITIES SHALL BE MAINTAINED BY:

ESC HYDROSEEDING NOTES

- HYDROSEEDING SHALL BE APPLIED TO ALL DISTURBED NON-PAVED SURFACES WHERE INDICATED.
 - HYDROSEEDING TO BE THE FOLLOWING MIXTURE:
- | TYPE OF MIXTURE | PROPORTIONS BY WEIGHT | PERCENT PURITY | PERCENT GERMINATION |
|----------------------------------|-----------------------|----------------|---------------------|
| PERENNIAL RYE GRASS | 40% | 90% | 90% |
| CREeping RED FESCUE | 40% | 90% | 90% |
| PREINOCULATED WHITE DUTCH CLOVER | 10% | 95% | 90% |
| COLONIAL BENT GRASS | 10% | 90% | 90% |
- APPLICATION TO BE 100 LBS/ACRE.
 - 500 LBS/ACRE 10-20-20 FERTILIZER, 2000 LBS/ACRE MULCH AND 40 LBS/ACRE SOIL STABILIZER TO BE APPLIED WITH SEED MIXTURE.



Know what's below.
Call what you dig.

Designed by: JI Drawn by: CM Checked by: TS

Sheet No.

C1.01

6 of 25 Sheets

CPFD

A PORTION OF THE NE 1/4 AND THE SE 1/4 OF SEC. 21, TWN. 20 N, RGE. 04 E, W.M. CITY OF PUYALLUP, PIERCE COUNTY, WASHINGTON

APPROVED

BY CITY OF PUYALLUP
DEVELOPMENT ENGINEERING

DATE _____
NOTE: THIS APPROVAL IS VOID AFTER 180 DAYS FROM APPROVAL DATE. THE CITY WILL NOT BE RESPONSIBLE FOR ERRORS AND/OR OMISSIONS ON THESE PLANS. FIELD CONDITIONS MAY DICTATE CHANGES TO THESE PLANS AS DETERMINED BY THE DEVELOPMENT ENGINEERING MANAGER.

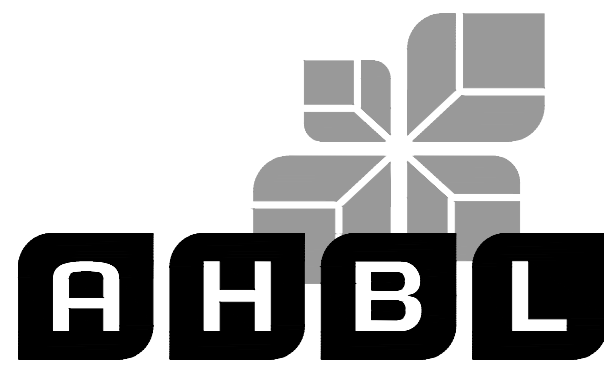

TACOMA · SEATTLE · SPOKANE · TRI-CITIES

2215 North 30th Street, Suite 300, Tacoma, WA 98403
253.383.2422 TEL 253.383.2572 FAX www.ahbl.com WEB

Project Title:

**COASTAL
PACIFIC FOOD
DISTRIBUTION
PUYALLUP**

Client:

AWB ENGINEERS

1942 NORTHWOOD DRIVE
SALISBURY, MARYLAND 21801

Matt Smith

Project No.

2230491.11

Issue Set & Date:

PERMIT SET

02/28/2024

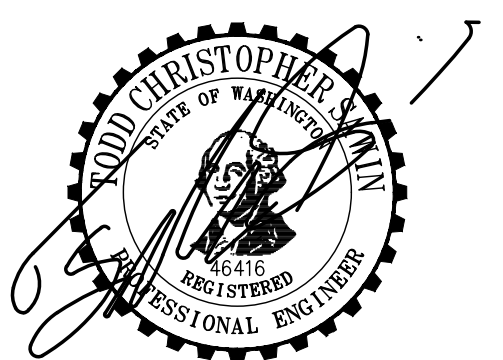

02/28/24

NOTICE
ALTERATION OF THIS DOCUMENT SHALL INVALIDATE THE PROFESSIONAL SEAL AND SIGNATURE. PUBLICATION OF THIS DOCUMENT DOES NOT REPRESENT THE REGISTERED ENGINEER'S ENDORSEMENT OF THE DESIGN OR THE USE ONLY FOR THE PROJECT SPECIFIED IN THE TITLE BLOCK AND IS NOT TO BE USED FOR OTHER PROJECTS, OR ADDITION TO THAT PROJECT OR FOR ANY OTHER PROJECT.

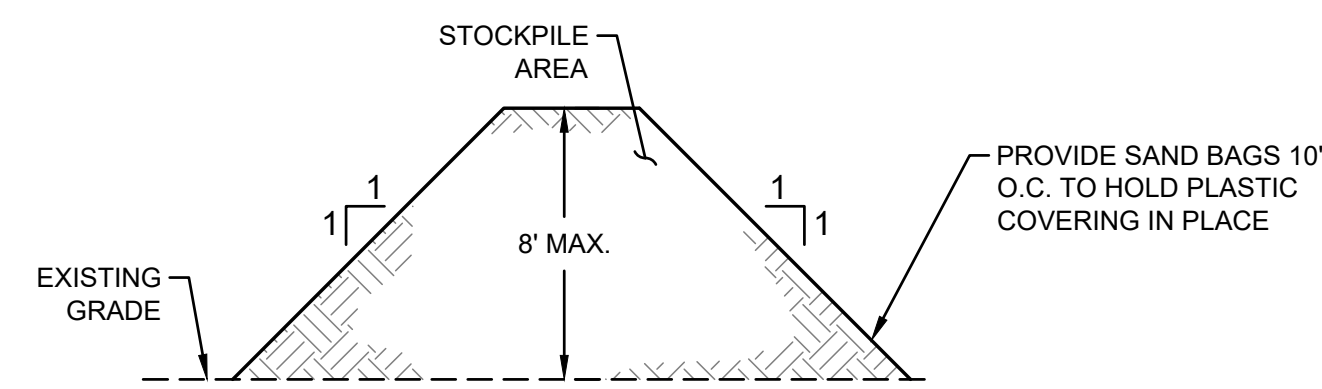

- NOTES:
- STOCKPILES SHALL BE STABILIZED WITH PLASTIC COVERING OR OTHER APPROVED DEVICE.
 - SEDIMENT LEACHING FROM STOCKPILES SHALL BE PREVENTED DURING ALL SEASONS.

SOIL STOCKPILE NOTES

- STOCKPILES SHALL BE STABILIZED (WITH PLASTIC COVERING OR OTHER APPROVED DEVICE) DAILY BETWEEN NOVEMBER 1 AND MARCH 31.
- IN ANY SEASON, SEDIMENT LEACHING FROM STOCK PILES MUST BE PREVENTED.
- TOPSOIL SHALL NOT BE PLACED WHILE IN A FROZEN OR MUDDY CONDITION, WHEN THE SUBGRADE IS EXCESSIVELY WET, OR WHEN CONDITIONS EXIST THAT MAY OTHERWISE BE DETRIMENTAL TO PROPER GRADING OR PROPOSED SODDING OR SEEDING.
- PREVIOUSLY ESTABLISHED GRADES ON THE AREAS TO BE TOPSOILED SHALL BE MAINTAINED ACCORDING TO THE APPROVED PLAN.
- ALL STOCKPILES SHALL BE COVERED WITH PLASTIC COVERING. SEE PLASTIC COVERING NOTES ON THIS SHEET.

1 STOCKPILE COVERING

NOT TO SCALE

Figure II-3.26: Cross Section of Sediment Trap

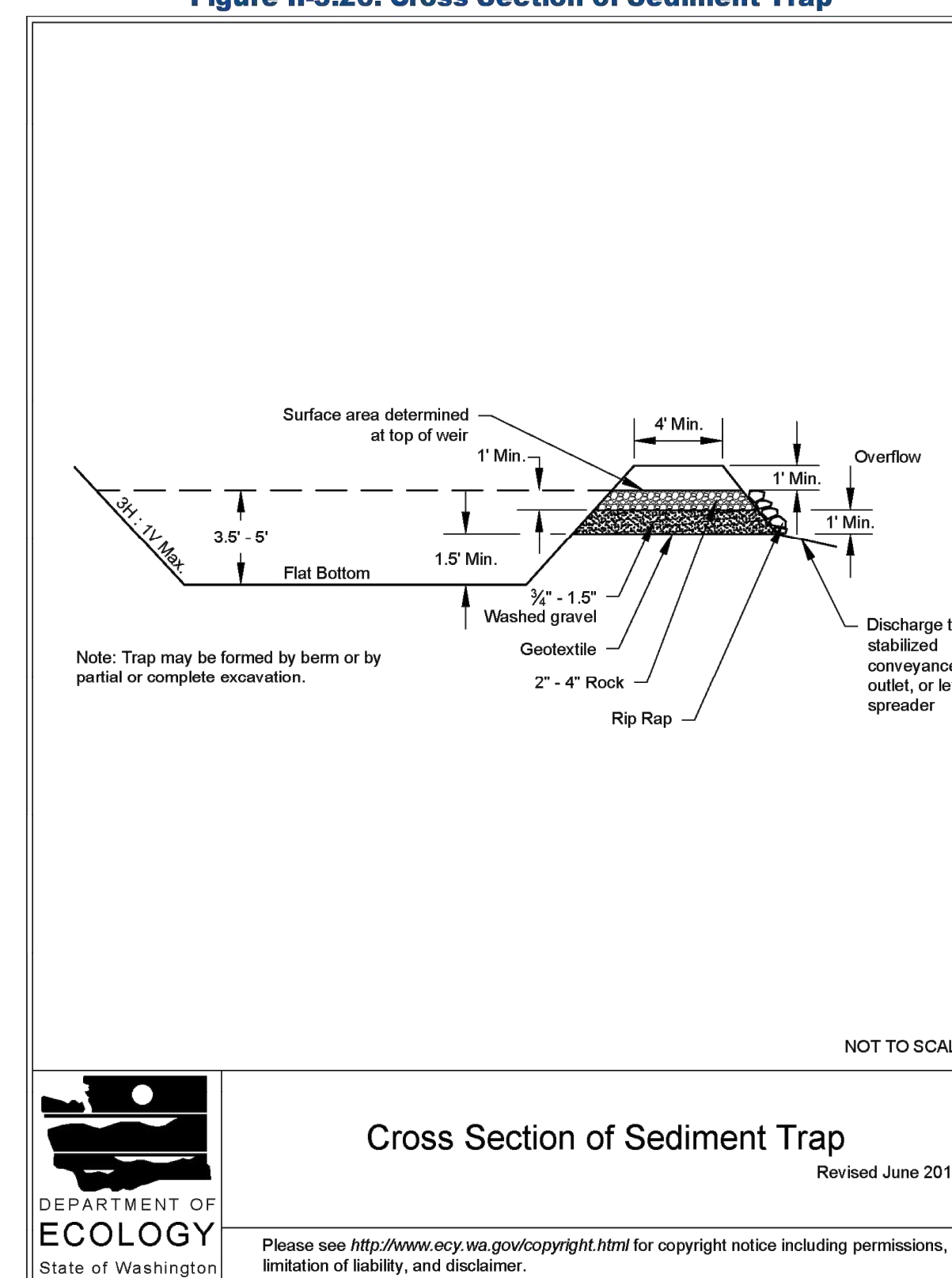

NOT TO SCALE

DEPARTMENT OF ECOLOGY
State of Washington

Cross Section of Sediment Trap
Revised June 2016

Please see <http://www.ecy.wa.gov/copyright.html> for copyright notice including permissions, limitation of liability, and disclaimer.

2019 Stormwater Management Manual for Western Washington

Volume II - Chapter 3 - Page 386

3 TEMPORARY SEDIMENT TRAP

NOT TO SCALE

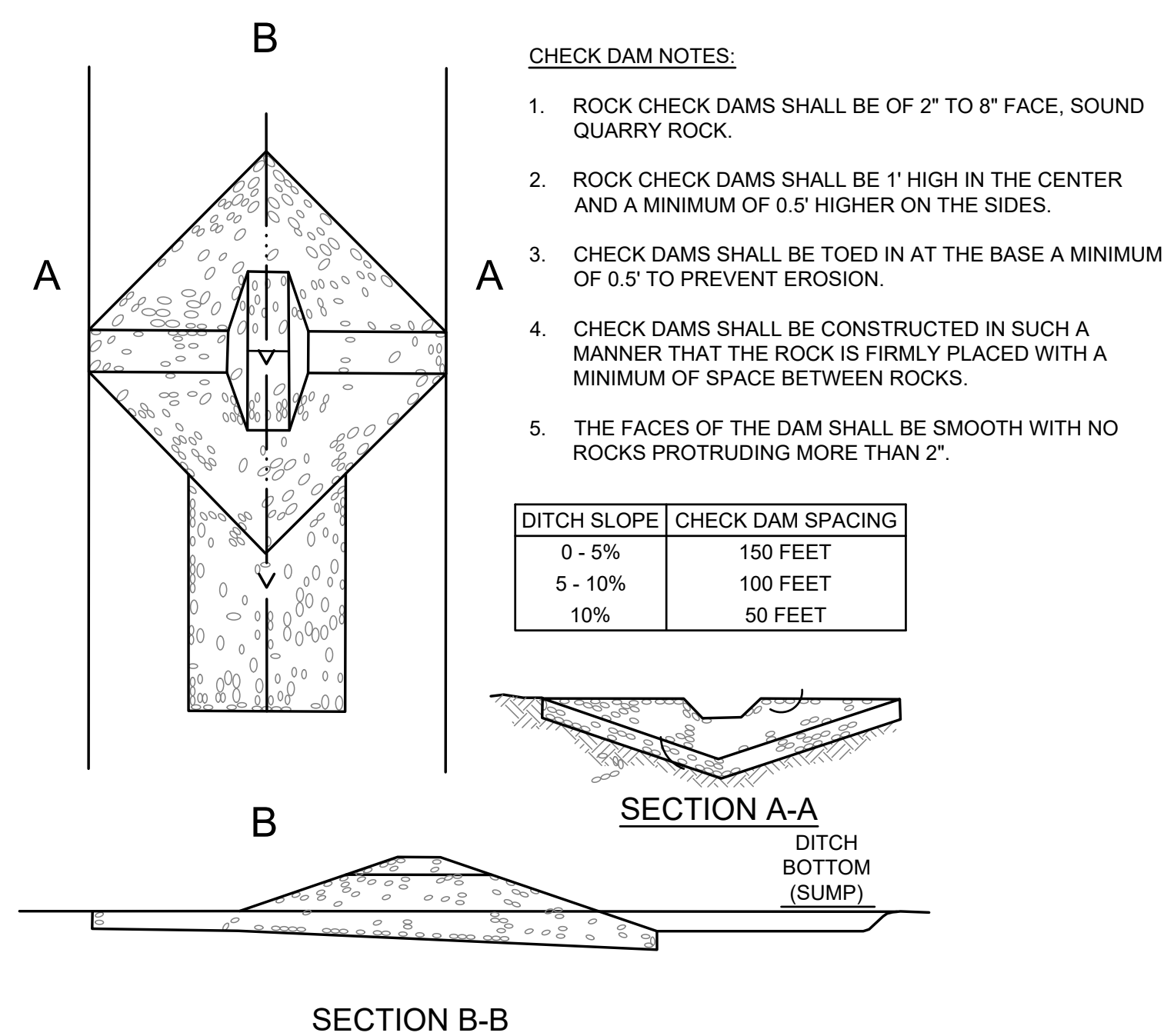

CHECK DAM NOTES:

- ROCK CHECK DAMS SHALL BE OF 2" TO 8" FACE, SOUND QUARRY ROCK.
- ROCK CHECK DAMS SHALL BE 1' HIGH IN THE CENTER AND A MINIMUM OF 0.5' HIGHER ON THE SIDES.
- CHECK DAMS SHALL BE TOED IN AT THE BASE A MINIMUM OF 0.5' TO PREVENT EROSION.
- CHECK DAMS SHALL BE CONSTRUCTED IN SUCH A MANNER THAT THE ROCK IS FIRMLY PLACED WITH A MINIMUM OF SPACE BETWEEN ROCKS.
- THE FACES OF THE DAM SHALL BE SMOOTH WITH NO ROCKS PROTRUDING MORE THAN 2".

DITCH SLOPE	CHECK DAM SPACING
0 - 5%	150 FEET
5 - 10%	100 FEET
10%	50 FEET

2 ROCK CHECK DAM

NOT TO SCALE



Know what's below.
Call before you dig.

△
△
△
△

Revisions:

Sheet Title:

TESC PLAN DETAILS

Designed by: JI Drawn by: CM Checked by: TS

Sheet No.

C1.02

7 of 25 Sheets