

NAME OF STREET: PIONEER

PRROW20240607

| | |
|--|--------------|
| City of Puyallup Development & Permitting Services ISSUED PERMIT | |
| Building | Planning |
| Engineering | Public Works |
| Fire | Traffic |

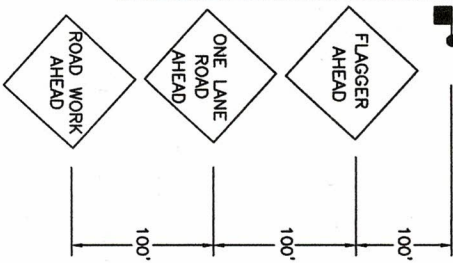
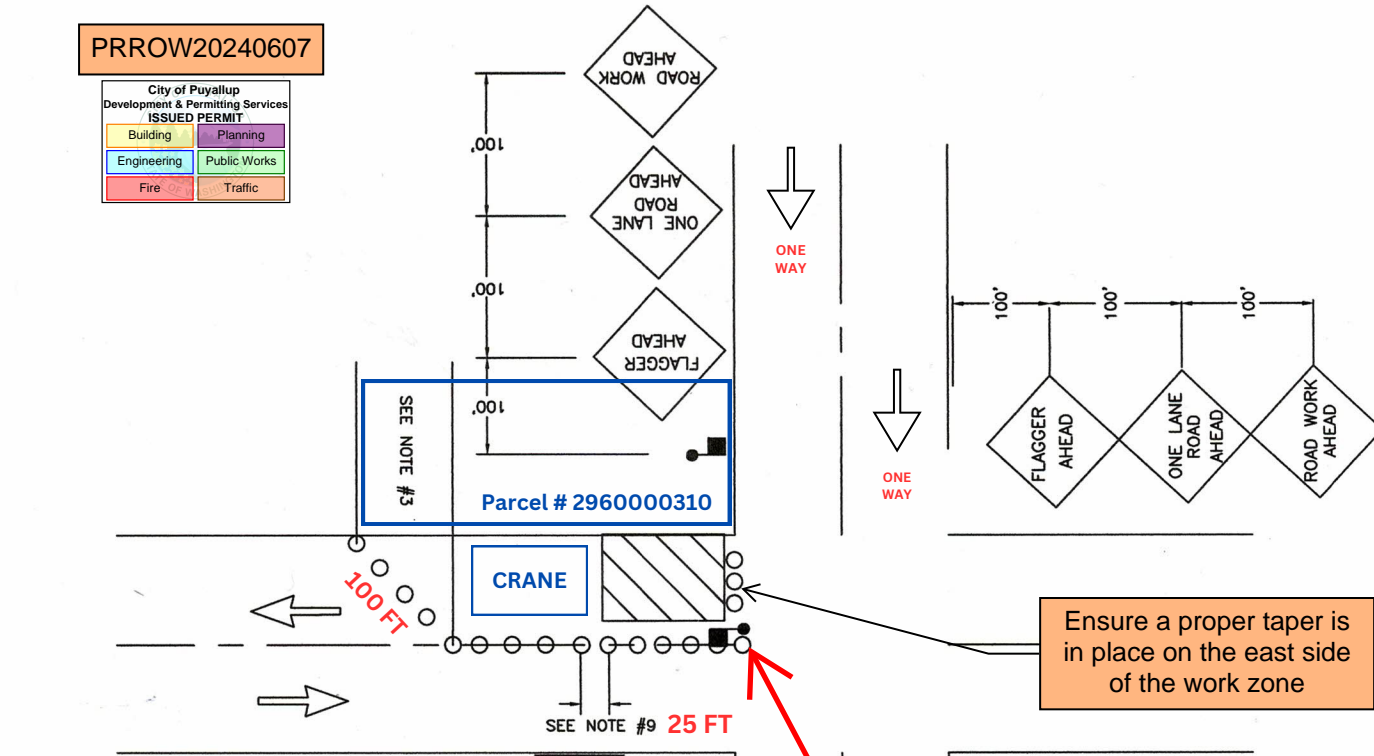

NOTES:

- 1 FOR ONE-WAY WORK ZONES SUCH AS: MERIDIAN, BYPASS
- 2 TRAFFIC CONTROL DEVICES SHALL BE RETROREFLECTIVE DRUMS OR 28" CONES
- 3 TAPER LENGTH 100' MAXIMUM
- 4 DISTANCE BETWEEN SIGNS IS MANDATORY UNLESS FIELD CONDITIONS DETERMINE OTHERWISE
- 5 SIGN SPACING SHALL BE 100 FEET WHEN SPEED LIMIT IS 30 MPH OR LESS
- 6 SIGN SPACING SHALL BE 350 FEET WHEN SPEED LIMIT IS GREATER THAN 30 MPH
- 7 CALL COMM CENTER DAY OF CLOSURE 841-5431
- 8 IF LEFT TURN MOVEMENT IS PROHIBITED DETOUR ROUTE
- 9 DISTANCE BETWEEN CONES EQUALS IN UNITS OF FEET

NAME OF STREET: MERIDIAN

The applicant shall notify property owner(s) of blocked driveway(s) at least 24 hours in advance.

Work shall immediately cease in the work zone for a pedestrian spotter, available at all times, to escort pedestrians around the work area

Night work required.
 Closure allowed Sunday night - Thursday night 9p.m. - 5a.m. only.
 Prior to scheduling work coordinate with the city by calling the Engineering Inspection Message Line: Phone: 253-435-3650
 A minimum of 48 hours advance notice is required for coordination/scheduling purposes. Also see Minimum Requirements for Night Traffic Control TE-007, attached.

Night Work Requirement:
 Applicant must provide 48hr. notification to residents and businesses within 300 feet of the work area either via door hanger, message board or signs posted visibly along the right-of-way

Call communications center at 253-287-4456 on day of closure.

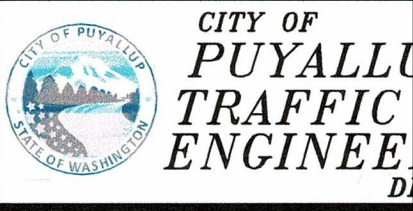

PRROW20240607

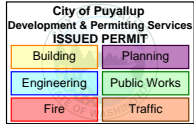

2nd St SW

NAME OF STREET:

NAME OF STREET:

W. Pioneer

SIDEWALK CLOSED
←
CROSS HERE

SIDEWALK CLOSED

SIDEWALK CLOSED
←
CROSS HERE

NOTES:

- 1 GIVE 24 HR NOTICE TO BUSINESS/RESIDENTS IMPACTED BY CLOSURE
- 2 "NO PARKING" EASELS MAY BE REQUIRED IN IMMEDIATE AREA OF WORK ZONE
- 3 CALL COMM CENTER DAY OF CLOSURE 253-287-4456
- 4 KEEP CLOSURE TO MINIMUM AMOUNT OF TIME AS POSSIBLE TO COMPLETE JOB
- 5 FLAGGERS MAYBE NEEDED TO ASSIST W/ CROSSING PEDESTRIANS NEAR SCHOOLS OR HIGH PEDESTRIAN USE AREAS

S. Meridian



**CITY OF
PUYALLUP
TRAFFIC
ENGINEERING
DIVISION**

SIDEWALK CLOSURE

| | | | | |
|---|----------------------------|------------------------|--------------|-----------------|
| DRAWN J. HUNTER | PLOTTING SCALE NTS/ 1=1 | DATE APPROVED 04-03 | REVISED | TCP STANDARD |
| FILE NAME I:\DRAWINGS\PUBLIC WORKS\TRAFFIC\TCP | CHECKED BY M. FORD | REVISED BY | NO. 6 | |