

2 ENLARGED RAMP AND STAIR PLAN SCALE: 1/4"=1'-0"

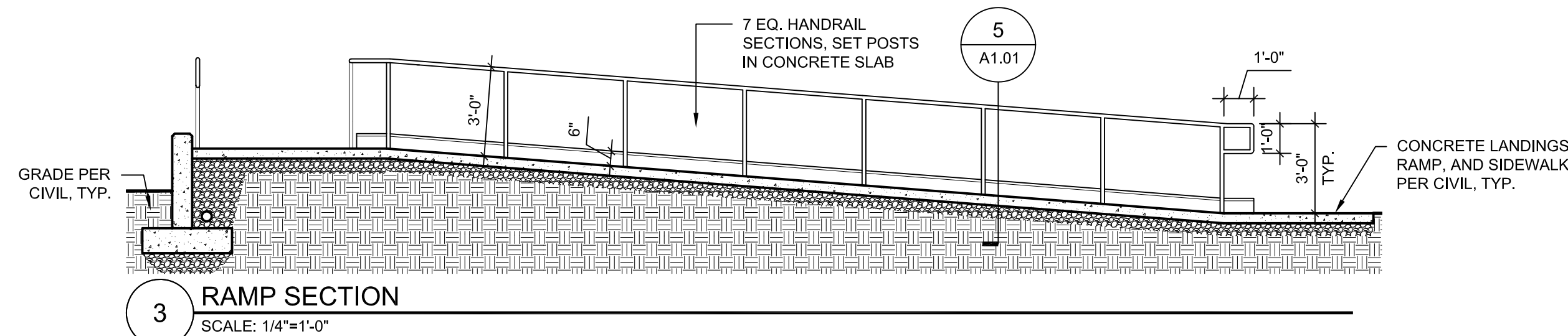

3 RAMP SECTION SCALE: 1/4"=1'-0"

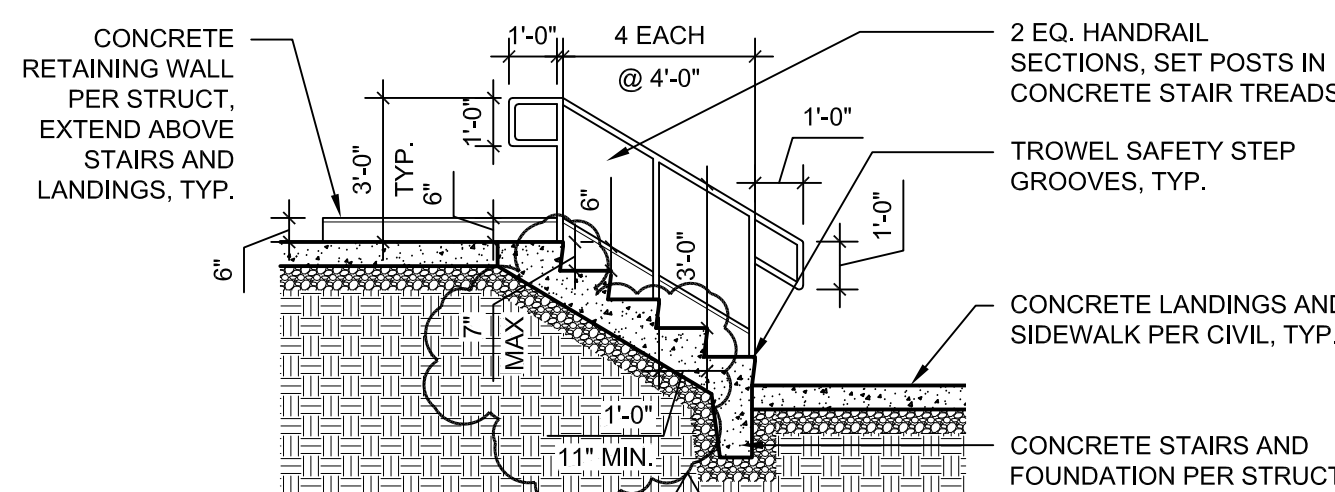

4 STAIR SECTION SCALE: 1/4"=1'-0"

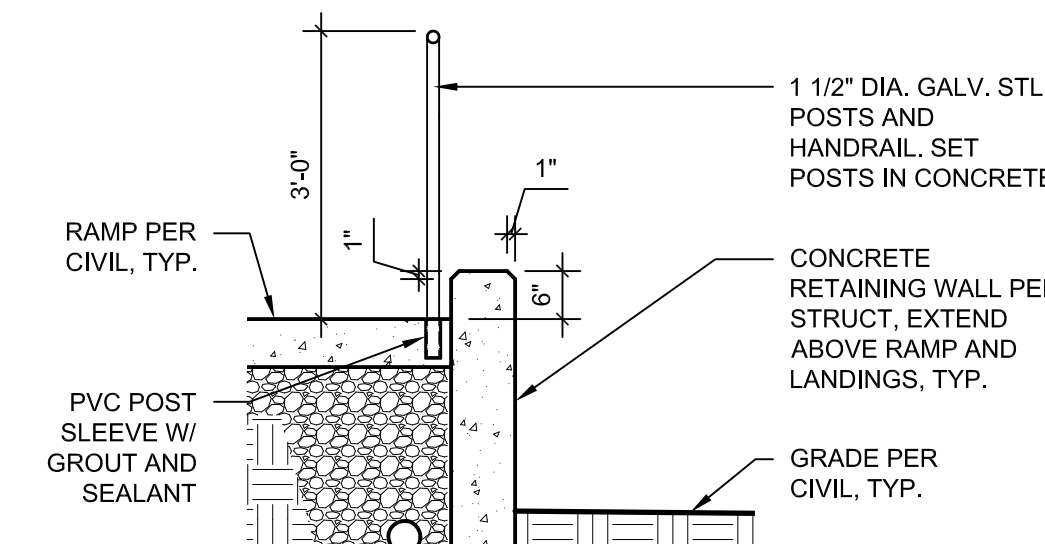

5 HANDRAIL DETAIL @ RAMP, STAIR SIM. SCALE: 1/2"=1'-0"

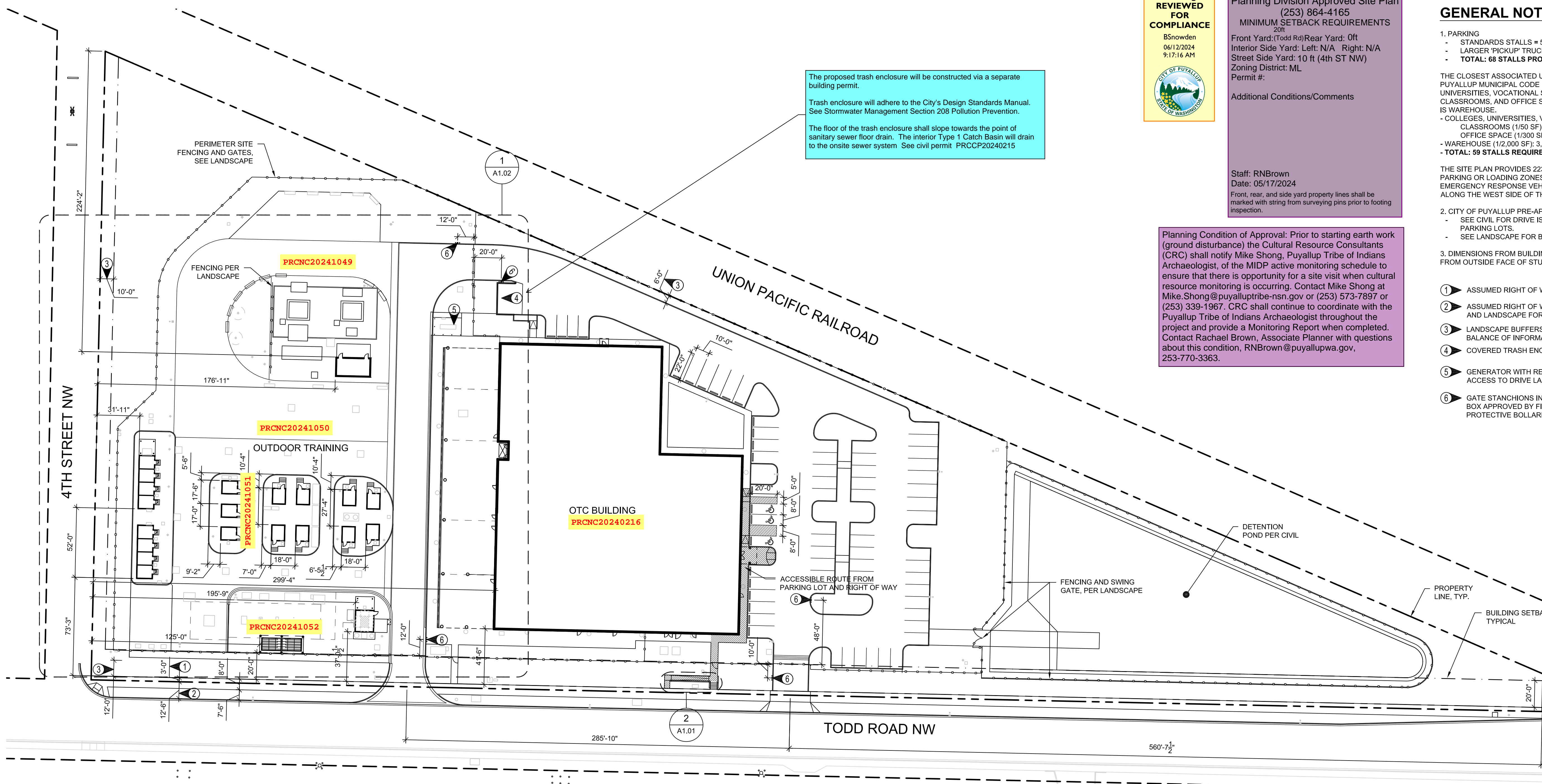

1 SITE PLAN SCALE: 1"=40'-0"

The proposed trash enclosure will be constructed via a separate building permit. Trash enclosure will adhere to the City's Design Standards Manual. See Stormwater Management Section 208 Pollution Prevention. The floor of the trash enclosure shall slope towards the point of sanitary sewer floor drain. The interior Type 1 Catch Basin will drain to the onsite sewer system. See civil permit PRCCP20240215

CITY OF PUYALLUP Planning Division Approved Site Plan (253) 864-4165 MINIMUM SETBACK REQUIREMENTS Front Yard: (Todd Rd) Rear Yard: 0ft Interior Side Yard: Left: N/A Right: N/A Street Side Yard: 10 ft (4th St NW) Zoning District: ML Permit #: Additional Conditions/Comments Staff: RNBrown Date: 05/17/2024 Front, rear, and side yard property lines shall be marked with string from surveying pins prior to footing inspection.

Planning Condition of Approval: Prior to starting earth work (ground disturbance) the Cultural Resource Consultants (CRC) shall notify Mike Shong, Puyallup Tribe of Indians Archaeologist, of the MIDP active monitoring schedule to ensure that there is opportunity for a site visit when cultural resource monitoring is occurring. Contact Mike Shong at Mike.Shong@puyalluptribe-nsn.gov or (253) 573-7897 or (253) 339-1967. CRC shall continue to coordinate with the Puyallup Tribe of Indians Archaeologist throughout the project and provide a Monitoring Report when completed. Contact Rachael Brown, Associate Planner with questions about this condition. RNBrown@puyallupwa.gov, 253-770-3363.

GENERAL NOTES:

- 1. PARKING - STANDARDS STALLS = 58 - LARGER PICKUP/TRUCK STALLS (10'X22') = 10 - TOTAL: 68 STALLS PROVIDED THE CLOSEST ASSOCIATED USE TYPE DEFINED IN THE PUYALLUP MUNICIPAL CODE (PMC) ARE: COLLEGES, UNIVERSITIES, VOCATIONAL SCHOOLS, WHICH INCLUDES CLASSROOMS, AND OFFICE SPACES. THE OTHER USE TYPE IS WAREHOUSE. - COLLEGES, UNIVERSITIES, VOCATIONAL SCHOOLS CLASSROOMS (1/50 SF): 2,430 SF / 50 = 49 OFFICE SPACE (1/300 SF): 2,190 SF / 300 SF = 8 - WAREHOUSE (1/2,000 SF): 3,088 SF / 2,000 SF = 2 - TOTAL: 59 STALLS REQUIRED THE SITE PLAN PROVIDES 223 LINEAL FEET OF PARALLEL PARKING OR LOADING ZONES FOR LARGE PSE AND EMERGENCY RESPONSE VEHICLES. THESE ARE LOCATED ALONG THE WEST SIDE OF THE OTC BUILDING 2. CITY OF PUYALLUP PRE-APPLICATION REQUIREMENTS - SEE CIVIL FOR DRIVE ISLES, PAVING/CURBS, AND PARKING LOTS. - SEE LANDSCAPE FOR BUFFERS AND FENCING. 3. DIMENSIONS FROM BUILDINGS TO PROPERTY LINES ARE FROM OUTSIDE FACE OF STUD OR CMU, TYP. 1 ASSUMED RIGHT OF WAY DEDICATION 2 ASSUMED RIGHT OF WAY IMPROVEMENTS. SEE CIVIL AND LANDSCAPE FOR BALANCE OF INFORMATION 3 LANDSCAPE BUFFERS. SEE LANDSCAPE FOR BALANCE OF INFORMATION 4 COVERED TRASH ENCLOSURE 5 GENERATOR WITH REMOVABLE BOLLARDS AND ACCESS TO DRIVE LANE FOR REFUELING 6 GATE STANCHIONS INCLUDING SECURE KEY BOX APPROVED BY FIRE DEPARTMENT AND PROTECTIVE BOLLARDS, SEE ELEC.

City of Puyallup Development Engineering APPROVED See permit for additional requirements. Linda Lian 06/12/2024 2:26:32 PM

In accordance with Puyallup Municipal Code 11.08.135 this project is required to make improvements to any street frontage that is damaged or that no longer meets current City or ADA design standard. Building occupancy will not be granted until the installation is completed and a final approval granted

In accordance with Puyallup Municipal Code 14.02.220(3) this project is required to install a double detector check valve assembly (DDCAV). Building occupancy will not be granted until the installation is completed and a final approval granted.

Sediment control and erosion procedures shall be practiced eliminating and preventing off site damage. Stormwater runoff originating upgrade of exposed areas shall be controlled to reduce erosion and sediment loss during the period of exposure. See civil permit PRCCP20240215 for specifications Roof downspout control is required. Steps shall be taken to prevent drainage onto adjacent lots. See civil permit PRCCP20240215 for specifications Call Before You Dig. It's the law. Locate all utilities prior to starting work Dial 811 or call 1-800-424-5555.

City of Puyallup Development & Permitting Services ISSUED PERMIT Building Planning Engineering Public Works Fire Traffic

100% CD SET table with columns REV, ISSUED FOR, DATE

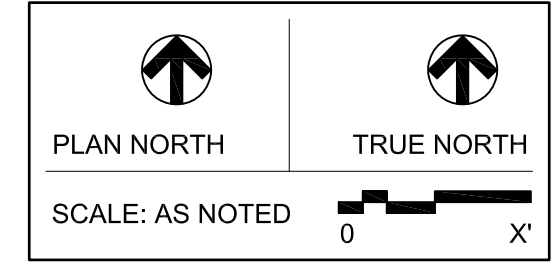

PSE - OPERATIONAL TRAINING CENTER OVERALL SITE PLAN PROJECT No: 202202.06 DRAWN BY: MR CHECKED BY: AK DATE ISSUED: 01/26/24

EV Charging Infrastructure per sheet E1.01 Multiple Site Plans were submitted. The Building inspector must be provided with the Site Plan that has the Planning Department's stamp during inspection.