



City of Puyallup
Engineering Division
 333 S. Meridian, Puyallup, WA 98371
 (253) 864-4165
 www.cityofpuyallup.org

Certificate of Water Availability

Part A: Completed by Applicant on Permit Application

Subject Site Address:

819 21ST ST SE, PUYALLUP, WA 98372

Assessor's Tax Parcel Number:	Permit Number:
0420263083	PRCWSA20241097
Subdivision/Project Name:	Subject Site Use Type:
CCCS W/A FOR PORTABLES LOCATION PROJECT	Commercial

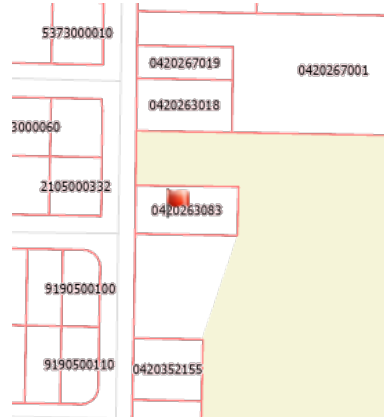

Part B: Completed by Water Purveyor

State ID #: 70050H

Water system to provide service: City of Puyallup

Existing source capacity: 10,000,000 GPD

Existing storage (distribution capacity): 19.3 million gallons

Number of current/existing users: Multiple

Approved number of connections: One (1)

Are water system facilities approved according to DOH requirements? Yes

Is the proposed development within City Approved Service Area? Yes No

Is the water utility providing the service? Yes No

Water service will be made available to this project by (date): Within 30 days of permit payment

Has a contract been signed with the applicant for the water service? Yes No

Water service will be provided by:

Direct connection to approved, existing water main.

Extension of existing water main(s), if necessary.

New water system in accordance with WAC 246-290 and Pierce County Ordinances 86-117S3 and 92-99.

Notes



City of Puyallup
Engineering Division
 333 S. Meridian, Puyallup, WA 98371
 (253) 864-4165
 www.cityofpuyallup.org

Fire Flow Information

Fire flow information for all projects including single family residential, multi-family, commercial, and industrial. The amount of available fire flow indicated herein is in addition to requirements for normal domestic maximum use. A water system vicinity map which shows the water mains and fire hydrants serving this project is required for all projects.

Water Main:

Location of nearest water main capable of supplying at least 750 GPM:

21 st St SE

Approximate distance from property frontage centerline to abovementioned water main in feet:

41

Approximate fire flow in GPM available at 20 psi for 120 minutes:

Greater than 1950

Approximate static pressure at project location in pounds per square inch (psi):

48

Fire Hydrant:

Approximate distance from property frontage centerline to nearest hydrant (measured along routes of fire apparatus travel) in feet:

114

City of Puyallup fire hydrant number:

SE 050

Willingness to Serve

The above information is an accurate account of the existing or necessary water system facilities.

For PRELIMINARY short plat, subdivision, land development, or building permit, we understand that this document, in absence of a legal contract, constitutes certification of willingness and ability to provide water service. It is further understood that, in the absence of an approved comprehensive plan, additional engineering approval has been obtained which demonstrates that facilities to provide water service to this project are available or can be constructed.

For FINAL short plat, subdivision, building permit, building occupancy, or septic design, we the undersigned water purveyor, certify that we will assume full operational and maintenance responsibility for the above water system which has been designed, approved and installed in accordance with Washington Administrative Code 246-290, RCW 90.44 (Water Rights Permits), Pierce County Ordinances 86-117S3 and 92-99, and an approved water system comprehensive plan.

Adam Hunt

Adam Hunt | Engineering Technician
 (253) 841-5577 | AHunt@PuyallupWA.gov

Water Purveyor: CITY OF PUYALLUP

Signature Date: July 30, 2024

Certification Expiration Date: July 30, 2027

A Bond or Assignment of Funds (please attach) is acceptable for final land division applications only. This certificate is not a guarantee of future water availability. Rather, it is an indication of the current City's willingness to sell water subject to any applicable state or federal regulation or rule. Future federal regulations under the Environmental Species Act may limit or eliminate the City's future ability to purvey or sell water outside its city limits.



City of Puyallup

Engineering Division

333 S. Meridian, Puyallup, WA 98371

(253) 864-4165

www.cityofpuyallup.org



Water System Vicinity Map Exhibit

The printed information was derived from digital databases within the City of Puyallup geographic information system. The City of Puyallup cannot accept responsibility for any errors, omissions, or positional accuracy, and therefore, there are no warranties which accompany this map exhibit. Users of this information should review or consult the primary data and information sources to ascertain the usability of the information.

