

Job #: 108651339
 Date: 6/27/24
 Jurisdiction: PUYALLUP
 ROW Permit: Yes
 Est. Start Date: 6/28/24
 Est. Duration: 1/2 Day (4 Hours)

Service Address: 819 21ST ST SE
 City: PUYALLUP Zip: 98372
 Site Contact: KEN SCHMIDT Phone: (253) 365-3974
 Site Contact Email: KEN@MOUNTAINCONST.COM
 PM / Inspector: LUTHGARD RIMORIN Phone: (253) 278-1118
 Customer Email: KEN@MOUNTAINCONST.COM Phone: (253) 365-3974

Job Description

Project Scope: SHORT SIDE GAS MAIN UNDER ASPHALT. 3'X4' CUT TO ACCESS MAIN. THEN C&C EXISTING 1/2" STW GAS SVC @ MAIN, NO FUTURE RECONNECT. ON SITE CONTACT: KEN SCHMIDT @ 253-365-3974, PM/LUTHER RIMORIN 253-278-1118

New Construction:	No
Construction Method	Trench
Building Foundation Type	Slab
Septic System	No

Soil Condition: 0 - 20ppm

Soil Management: Clean

PLAT Map: 249.076

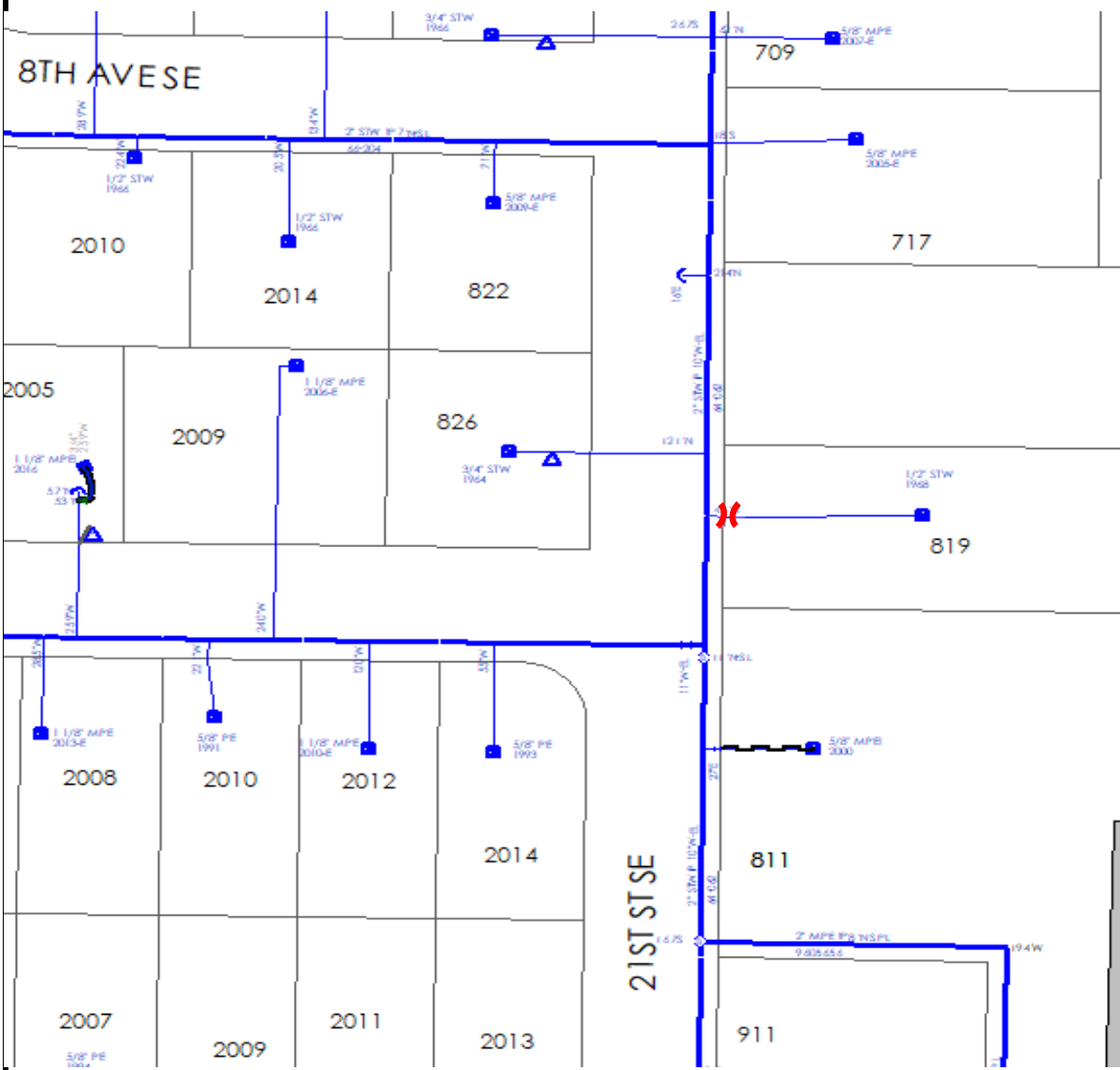

A 10" diameter core drill is allowed for potholing. For pothole windows larger than 10" in diameter or trenching completed in existing roadway, the contractor shall restore the pavement by installing the trench patch and then grinding/overlaying. All roadway restoration and street patches shall comply with City Standard Detail 01.01.20.

Any public curb, gutter, or sidewalk broken now or during the course of construction shall be removed and replaced per City Standards.

City of Puyallup
 Development & Permitting Services
 ISSUED PERMIT

Building	Planning
Engineering	Public Works
Fire	Traffic

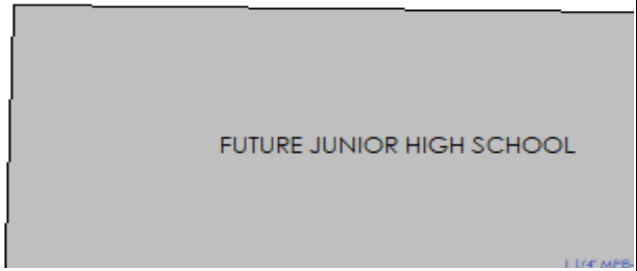

Work Location						Size of Cut	Surface Type	
41'	North	of CL	OF 9TH AVE SE	&	10'	West	OF EL ON 21ST ST SE	
		of CL		&			of CL	
		of CL		&			of CL	
Service Information				Street Information				Job Type
Diameter:	1/2" STW			Flaggers #:	0	Arterial:	Yes	Cut & Cap
EFV:	0			Police #:	0	TCP:	Yes	Tie-In Fitting
Meter:				Speed Limit:	25	No Parks #:	0	
Meter Loc:	0			Trolley Lines:	No	Mtr Hoods #:	0	
Del Press:				Traffic Signal:		Bus Stop:	No	
Bollards:	2.5" #		4" #	ADA Ramps #:	0	Route #'s:		LAK - Lakewood

