

TEMPORARY TRAFFIC CONTROL PLAN

PRFUP20241445

City of Puyallup
Development & Permitting Services
ISSUED PERMIT

Building	Planning
Engineering	Public Works
Fire	Traffic

CLOSURE ALLOWED:
Monday - Thursday
9AM - 2PM

Call communications center at 253-287-4456 on day of closure. Request a job start inspection through the CityView portal.

The City-issued permit packet shall be posted at the job site and available to inspectors at all times.

When shifting traffic into a turn lane, use of double cones is required. Traffic device spacing shall be half distance for opposing traffic devices.

Work shall immediately cease in the work zone for a pedestrian spotter, available at all times, to escort pedestrians around the work area.

The applicant shall notify public transportation agencies whose routes or stops are affected by the traffic control plan 24 hours in advance of job start. (Pierce County Transit Construction Coordinator: 253-581-8000)

Lane Taper Length = $\frac{\text{width of taper offset} \times (\text{speed limit})^2}{60}$
(width of taper typically measured as width of lane)

- Traffic control devices shall be 28 inch retro-reflective cones.
- Taper length equals width of offset times speed limit squared divided by 60.
- Sign spacing shall be 100 feet when speed limit is 30 mph or less.
- Sign spacing shall be 350 feet when speed limit is greater than 30 mph.
- Distance between cones equals speed limit in unit-feet.
- Travel lane width must be a minimum of 11 feet at all times.
- All flaggers and spotters shall remain in radio contact at all times.

TRAFFIC CONTROL PLAN NOTES

1. OPPOSING CONES SHALL BE 1/2 SPACING.
2. NOTED LANE SHIFT IS TYP PER SETUP THROUGHOUT ROW WORK.

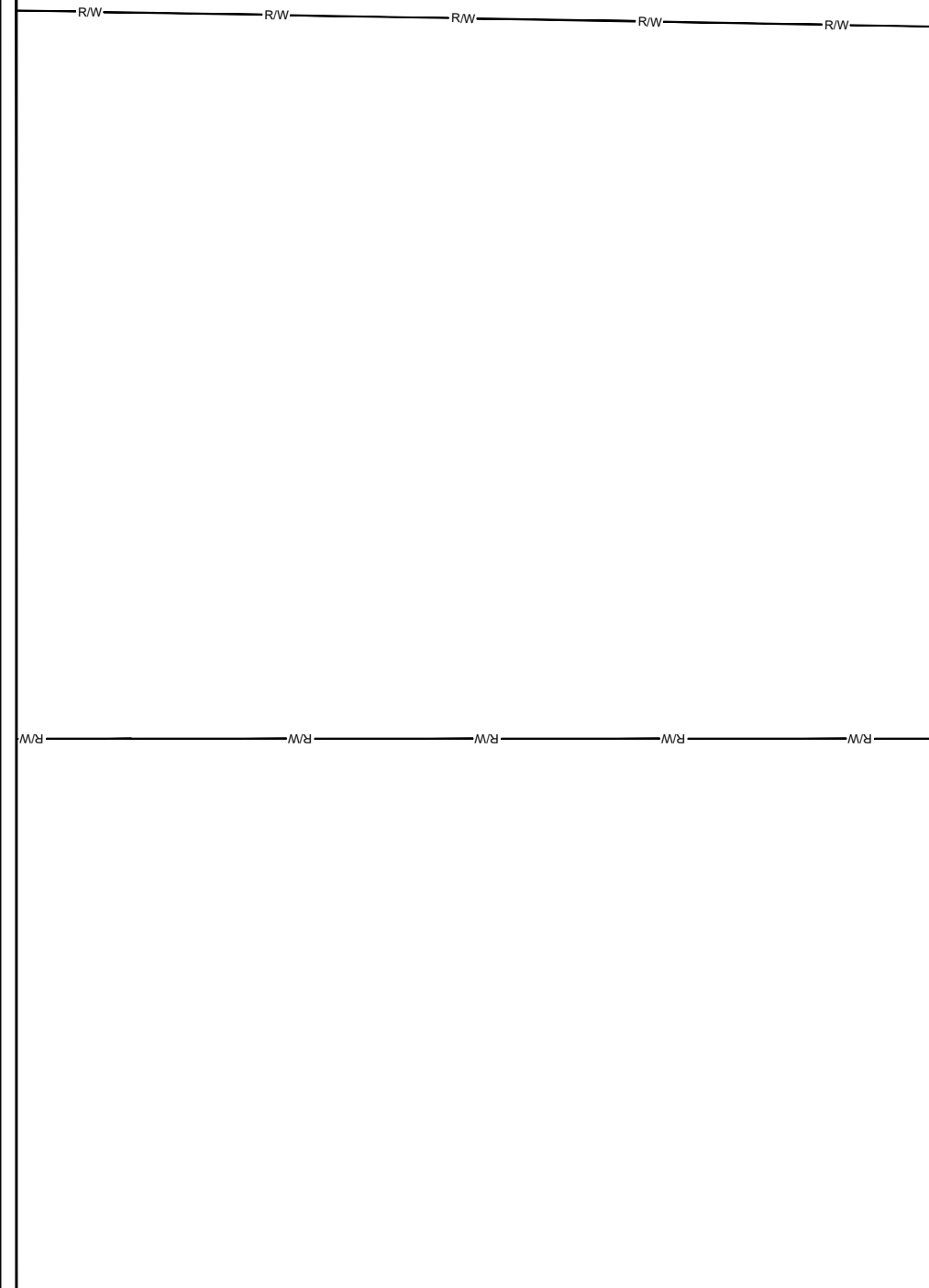
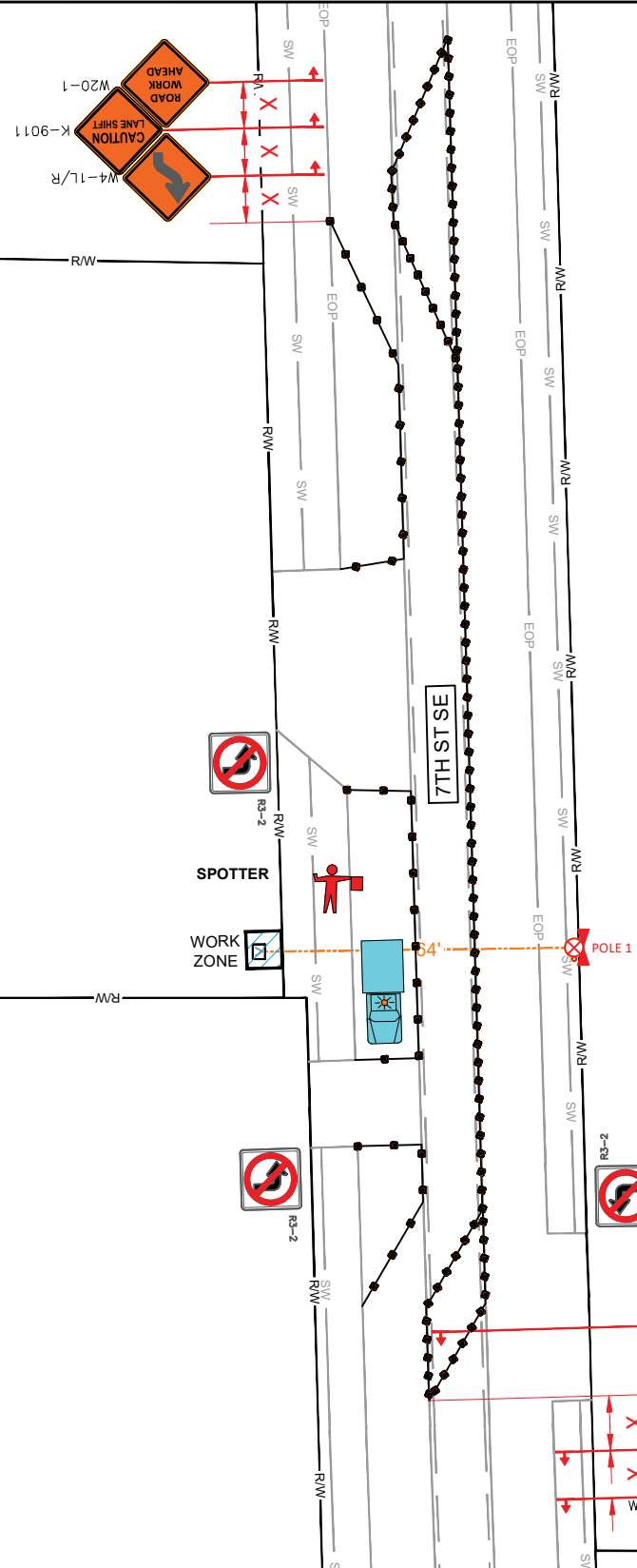

TCP DEVICE LEGEND

WARNING SIGN	POLICE OFFICER
REGULATORY SIGN	FLAGGER STATION
TRAFFIC CONE	SPOTTER STATION
PATROL CAR	FLASHING ARROW
LIT INTERSECTION	FLASHING DOUBLE ARROW
UNLIT INTERSECTION	FLASHING CAUTION
WORK VEHICLE	(MERGE LEFT OR RIGHT)

TRAFFIC CONTROL PLAN GENERAL NOTES

1. AN ARROWBOARD SHALL MEET THE MINIMUM SIZE, LEGIBILITY DISTANCE, NUMBER OF ELEMENTS AND OTHER SPECIFICATIONS SHOWN.
2. LENGTH OF ARROW EQUALS 48", WIDTH OF ARROWHEAD EQUALS 24".
3. TYPE A, B AND C ARROW BOARDS SHALL HAVE SOLID RECTANGULAR APPEARANCES. A TYPE D ARROW BOARD SHALL CONFORM TO THE SHAPE OF THE ARROW.
4. MAINTAIN DRIVEWAY ACCESS AT ALL TIMES
5. SIDEWALK ARE EITHER OPEN OR NOT OPEN. A SIDEWALK IS CLOSED IF A MINIMUM 5' PATH CANNOT BE MAINTAINED MEASURED FROM PROPERTY LINE, OR 5.5' IF CREATED FROM FACE OF CURB. (PEDESTRIAN PATH PROVIDED WHERE REQUIRED) AND WILL BE MONITORED BY A SPOTTER TO ENSURE FLOW AND SAFETY DURING WORK UNLESS OTHERWISE NOTED. A SPOTTER SHALL NOT DIRECT TRAFFIC.
6. NO EXCEPTION TAKEN- CONTRACTOR IS RESPONSIBLE FOR ADA COMPLIANCE.
7. ALL CONTROL SET-UP, SIGN SPACING AND PROCEDURES. WILL CONFORM TO SPECIFICATIONS STATED IN THE FEDERAL MANUAL ON UNIFORMED TRAFFIC CONTROL DEVICES (M.U.T.C.D).
8. CITIES AND VARIOUS MUNICIPALITIES MAY HAVE ALSO ADOPTED SPECIALIZED GUIDELINES FOR TRAFFIC CONTROL WITHIN THEIR JURISDICTION. IT IS THE RESPONSIBILITY OF THE ON-SITE TRAFFIC CONTROL PERSONAL TO SEE IF AND ANY SPECIAL CONDITIONS EXIST.
9. FLAGGERS SHALL BE USED IN ACCORDANCE WITH WAC 468-95-302.
10. IF ONLY ONE LANE IS OPEN IN A DIRECTION THAT LANE SHALL BE A MINIMUM OF 11' WIDE. UNLESS SPOTTER/FLAGGERS ARE USED, IN WHICH CASE THE LANE CAN BE A MINIMUM OF 10'.
11. ALL ROW WORK MUST YIELD TO SCHOOL TRANSIT, EMPLOYEES AND CHILDREN. WHILE PASSENGER LOADING/UNLOADING, STOPPED OR SLOWING; CEASE WORK, YIELD. WHEN SCHOOL TRANSIT, AND/OR PEDESTRIANS, DEPART COMMENCE WORK.

LONGITUDINAL BUFFER SPACE =LBS

SPEED (MPH)	20	25	30	35	40	45	50	55	60	65	70
DISTANCE (FT)	115	155	200	250	305	360	425	495	570	645	730

TAPER LENGTH IN FEET=L (FEET)

LANE WIDTH (FEET)	POSTED SPEED LIMIT (MPH)										
	25	30	35	40	45	50	55	60	65	70	
10	105	150	205	270	450	500	550	-	-	-	
11	115	160	225	295	495	550	605	660	-	-	
12	125	180	245	320	540	600	660	720	780	840	

ADVANCED WARNING SIGN SPACING

ROAD TYPE	SPEED	DISTANCE BETWEEN ADVANCED WARNING SIGNS			
		X	X	X	X
FREWAYS & EXPRESSWAYS	55/75 MPH	1500 ±	1500 ±	1500 ±	1500 ±
RURAL HIGHWAYS	60/65 MPH	800 ±	800 ±	800 ±	800 ±
RURAL ROADS	45/55 MPH	500 ±	500 ±	500 ±	500 ±
RURAL ROADS & URBAN ARTERIAL	35/40 MPH	350 ±	350 ±	350 ±	N/A
RURAL ROADS, RESIDENTIAL & BUSINESS DISTRICTS	25/30 MPH	200 ± (2)	200 ± (2)	200 ± (2)	N/A
URBAN STREETS	25 MPH OR LESS	100 ± (2)	100 ± (2)	100 ± (2)	N/A

(1) ALL SPACING MAY BE ADJUSTED TO ACCOMMODATE INTERCHANGE RAMP, AT-GRADE INTERSECTIONS, AND DRIVEWAYS.
(2) THIS SPACING MAY BE REDUCED IN URBAN AREAS TO FIT ROADWAY CONDITIONS.

Mastec
Network Solutions

COMCAST
811
Know what's below. Call before you dig. DIGALERT
CALL TOLL FREE 888-888-8888
48 HOURS BEFORE YOU DIG
UNDERGROUND SERVICE ALERT
811

SITE NAME: JB0001604934
LOCATION ADDRESS: 2323 7TH ST SE PUYALLUP, WA 98374
COMCAST JOB NUMBER: JB0001604934

TRAFFIC CONTROL PLAN

Mastec
Network Solutions

RYAN KETTELLS
ID: P101KM
TCS NO. 012654
EXPIRES: 11/30/24

RPK
STAMP

DRAWN BY: HR
DATE: 05/07/24

REVISIONS

DATE	DESCRIPTION	INITIAL

SCALE: 1"=40'
SHEET 1 OF 1