



City Engineering
333 S. Meridian
Puyallup, WA 98371
Tel: (253) 864-4165
Fax: (253) 840-6678

PLAN CHANGE REQUEST

DATE: 08/15/24 PERMIT NO./REF NO: PRCCP20240215

1. PROJECT: PSE - OTC ADDRESS: 325 Todd Road NW

2. OWNER: Puyallup Training Property, LLC EMAIL: agarciamendoza@trammellcrow.com

3. DESIGN ENGINEER: Miles McEathron EMAIL: mmceathron@freelandengineering.com

4. CONTRACTOR: Pennon Construction EMAIL: jacobb@pennonconstruction.com

5. ORIGINATOR OF REQUEST:
 OWNER DESIGN ENGINEER CONTRACTOR CITY OF PUYALLUP

6. DOES THIS REQUEST REQUIRE A DEVIATION FROM AN EXISTING CITY STANDARD? YES NO

7. IF YES, PLEASE SUBMIT AN ALTERNATIVE METHODS FOR CONSTRUCTION MATERIALS REQUEST APPLICATION (AMR).

8. IF NO, PLEASE COMPLETE THE FOLLOWING:

9. APPROVED CIVIL PLAN SHEET NUMBERS AFFECTED: C2.2E, C2.2F, C2.2G

10. WHAT PART OF THE CITY AND/OR DEVELOPMENT INFRASTRUCTURE IS BEING AFFECTED?
 ROAD STORM WATER SANITARY GRADING EROSION CONTROL

11. DESCRIBE THE CHANGE BEING REQUESTED: (ATTACH ADDITIONAL INFORMATION AS NECESSARY)

This change will move the water main along Todd Road from the south side to the north side of the road. This will shorten the hydrant laterals and eliminate paving work on the south side of the road.

12. ALL SIGNATURES ARE REQUIRED TO PROCESS THIS REQUEST UNLESS INITIATED BY THE CITY. FINAL APPROVAL/DENIAL WILL BE MADE BY THE CITY ENGINEER. ALL CHANGES WILL BE FULLY APPROVED/DENIED PRIOR TO ANY WORK ON REQUESTED CHANGES. ANY WORK COMPLETED PRIOR TO APPROVAL IS AT THE RISK OF THE DEVELOPER/CONTRACTOR AND MAY NOT BE APPROVED BY THE CITY ENGINEER.

Alex Garcia Mendoza
OWNER

Miles McEathron
DESIGN ENGINEER

Jacob B. Pennon
CONTRACTOR

CITY INSPECTOR

James Calver
CITY REVIEWER

APPROVED / DENIED

08/21/2024

DATE

PRCCP20240215
PCR001
8/21/2024

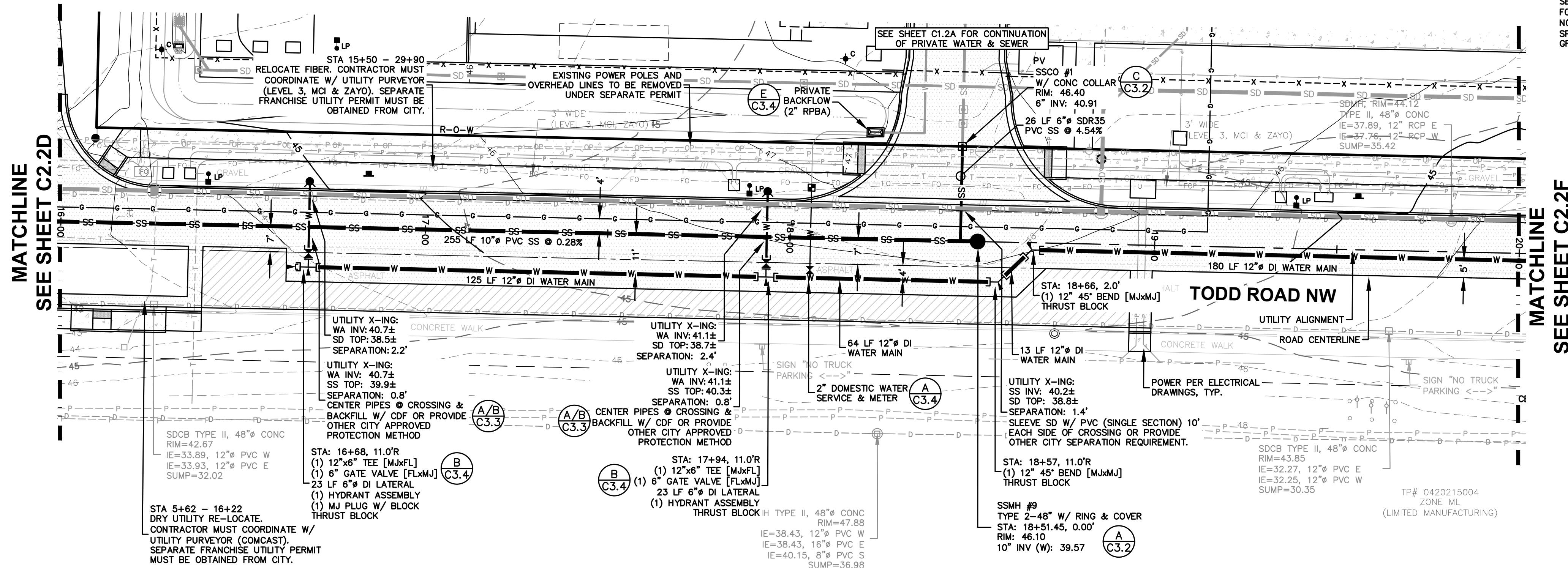

WATER & SEWER PLAN
SCALE: 1" = 20'

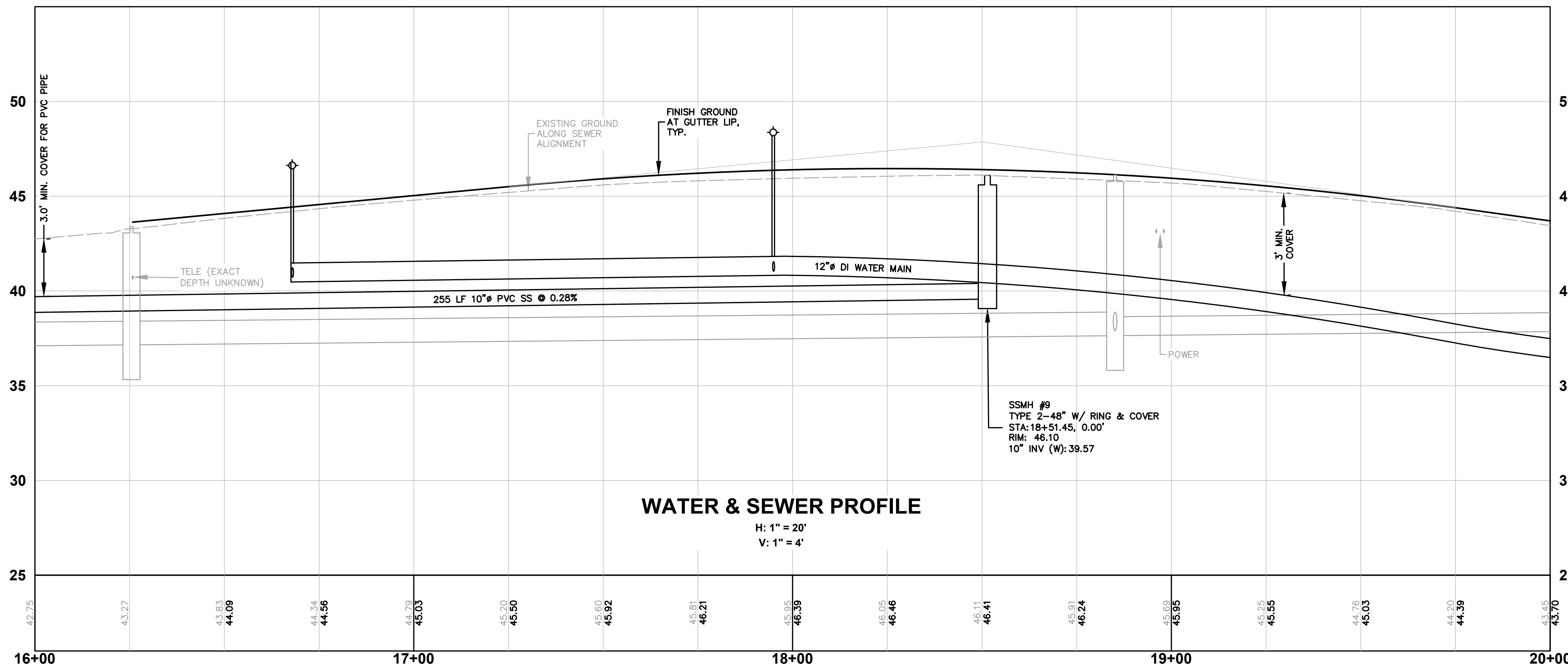

WATER & SEWER PROFILE
H: 1" = 20'
V: 1" = 4'

GENERAL NOTES

- SEWER AND WATER SYSTEM SHALL BE CONSTRUCTED TO CURRENT CITY OF PUYALLUP STANDARDS.
- TYPICAL UTILITY TRENCH EXCAVATION, BEDDING AND BACKFILL SHALL COMPLY WITH CITY STANDARD DETAIL 06.01.01 REQUIREMENTS (SEE DETAIL F/C3.10).
- THE MINIMUM VERTICAL SEPARATION BETWEEN CROSSING WATER AND SEWER SHALL BE 18 INCHES. IF THIS CRITERION CANNOT BE MET, THE CONTRACTOR SHALL ISOLATE THE SEWER AND WATER LINES BY ENGASMENT, SHIELDING, OR OTHER APPROVED METHODS IN ACCORDANCE WITH CITY OF PUYALLUP WATER MAIN CROSSING NOTES AND DETAILS (SEE DETAIL B/C3.3 & C/C3.3).
- MINIMUM 12 INCHES VERTICAL SEPARATION BETWEEN STORM OVER SEWER. MINIMUM 18 INCHES VERTICAL SEPARATION BETWEEN SEWER OVER STORM. ADDITIONAL PROTECTION MAY BE REQUIRED FOR SOME INSTALLATIONS: PROVIDE PVC SLEEVE (SINGLE SECTION, NO JOINTS) 10 FEET EACH SIDE OF CROSSING & FILL ANNULAR SPACE BETWEEN SLEEVE AND STORM PIPE W/ NON-SHRINK GROUT.

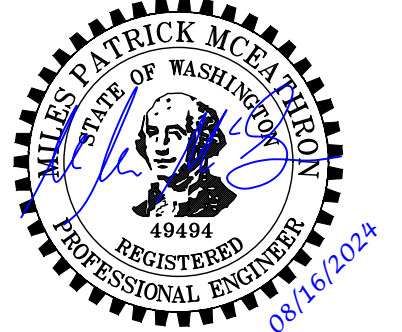

APPROVED

BY: _____
CITY OF PUYALLUP
DEVELOPMENT ENGINEERING

DATE: _____

NOTE: THIS APPROVAL IS VOID AFTER 180 DAYS FROM APPROVAL DATE. THE CITY WILL NOT BE RESPONSIBLE FOR ERRORS AND/OR OMISSIONS ON THESE PLANS. FIELD CONDITIONS MAY DICTATE CHANGES TO THESE PLANS AS DETERMINED BY THE DEVELOPMENT ENGINEERING MANAGER.

APPROVED

BY: _____
CITY OF PUYALLUP
WATER PURVEYOR

DATE: _____

NOTE: THIS APPROVAL IS VOID AFTER 180 DAYS FROM APPROVAL DATE. THE CITY WILL NOT BE RESPONSIBLE FOR ERRORS AND/OR OMISSIONS ON THESE PLANS. FIELD CONDITIONS MAY DICTATE CHANGES TO THESE PLANS AS DETERMINED BY THE WATER PURVEYOR.

CONFORMED SET

REV	ISSUED FOR	DATE

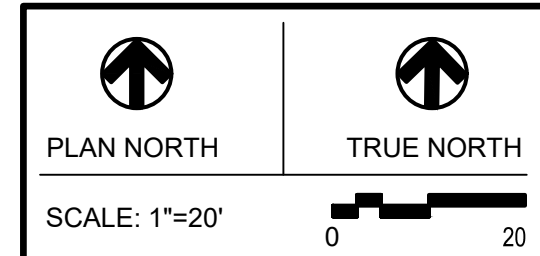

PSE - OPERATIONAL TRAINING CENTER

WATER & SEWER PLAN & PROFILE- 16+00 - 20+00

PROJECT No: 22219
DRAWN BY: MPM
CHECKED BY: THF
DATE ISSUED: 08/16/2024

C2.2E

PRCCP20240215
PCR001
8/21/2024

GENERAL NOTES

- SEWER AND WATER SYSTEM SHALL BE CONSTRUCTED TO CURRENT CITY OF PUYALLUP STANDARDS.
- TYPICAL UTILITY TRENCH EXCAVATION, BEDDING AND BACKFILL SHALL COMPLY WITH CITY STANDARD DETAIL 06.01.01 REQUIREMENTS (SEE DETAIL F/C3.10).
- THE MINIMUM VERTICAL SEPARATION BETWEEN CROSSING WATER AND SEWER SHALL BE 18 INCHES. IF THIS CRITERION CANNOT BE MET, THE CONTRACTOR SHALL ISOLATE THE SEWER AND WATER LINES BY ENCASMENT, SHIELDING, OR OTHER APPROVED METHODS IN ACCORDANCE WITH CITY OF PUYALLUP WATER MAIN CROSSING NOTES AND DETAILS (SEE DETAIL B/C3.3 & C/C3.3).
- MINIMUM 12 INCHES VERTICAL SEPARATION BETWEEN STORM OVER SEWER. MINIMUM 18 INCHES VERTICAL SEPARATION BETWEEN SEWER OVER STORM. ADDITIONAL PROTECTION MAY BE REQUIRED FOR SOME INSTALLATIONS: PROVIDE PVC SLEEVE (SINGLE SECTION, NO JOINTS) 10 FEET EACH SIDE OF CROSSING & FILL ANNULAR SPACE BETWEEN SLEEVE AND STORM PIPE W/ NON-SHRINK GROUT.

ZERVAS

ARCHITECTURE | INTERIOR DESIGN

zervasgroup.com
209 Prospect Street
Bellingham, WA 98225
360.734.4744

FREELAND & ASSOCIATES

220 West Champion Street, Suite 200 t: 360.650.1408
Bellingham, WA 98225 f: 360.650.1401

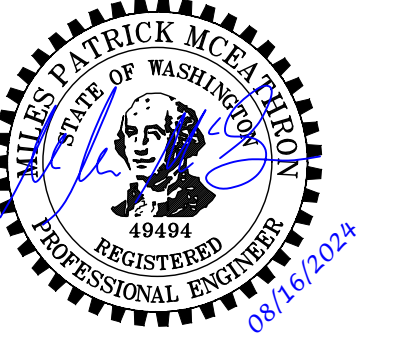

Know what's below.
Call before you dig.

APPROVED

BY: CITY OF PUYALLUP
DEVELOPMENT ENGINEERING

DATE:

NOTE: THIS APPROVAL IS VOID AFTER 180 DAYS FROM APPROVAL DATE. THE CITY WILL NOT BE RESPONSIBLE FOR ERRORS AND/OR OMISSIONS ON THESE PLANS. FIELD CONDITIONS MAY DICTATE CHANGES TO THESE PLANS AS DETERMINED BY THE DEVELOPMENT ENGINEERING MANAGER.

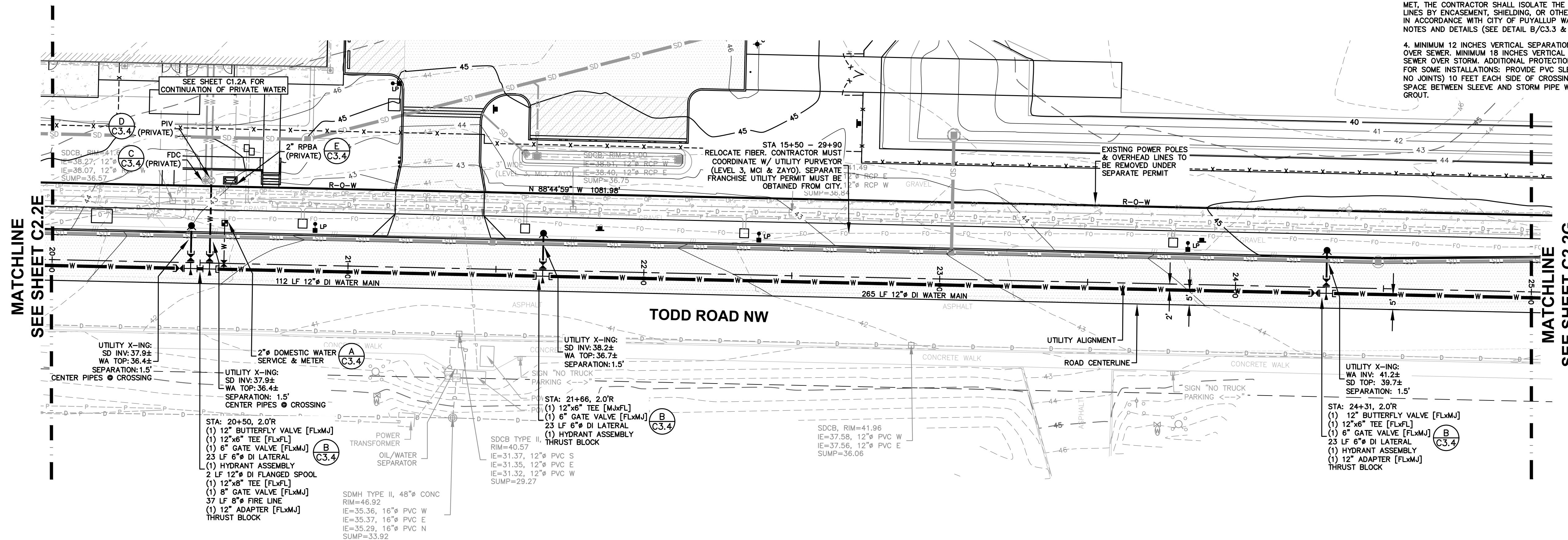

WATER PLAN
SCALE: 1" = 20'

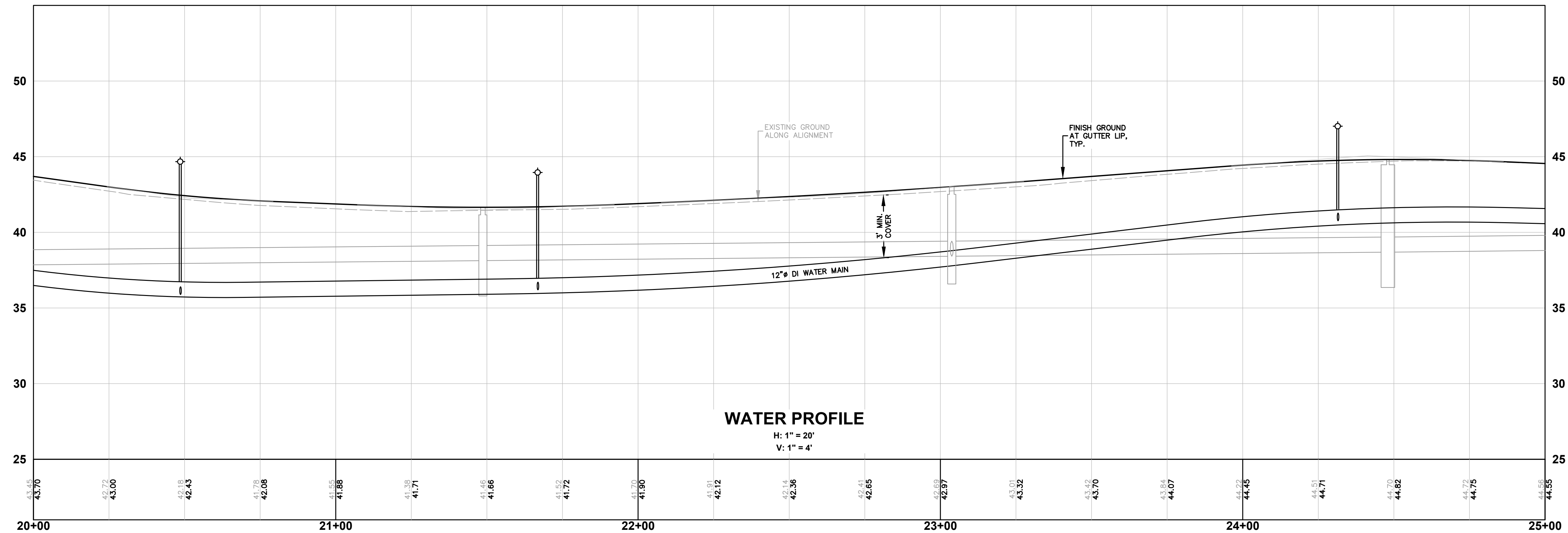

WATER PROFILE
H: 1" = 20'
V: 1" = 4'

APPROVED

BY: CITY OF PUYALLUP
WATER PURVEYOR

DATE:

NOTE: THIS APPROVAL IS VOID AFTER 180 DAYS FROM APPROVAL DATE. THE CITY WILL NOT BE RESPONSIBLE FOR ERRORS AND/OR OMISSIONS ON THESE PLANS. FIELD CONDITIONS MAY DICTATE CHANGES TO THESE PLANS AS DETERMINED BY THE WATER PURVEYOR.

CONFORMED SET

REV	ISSUED FOR	DATE

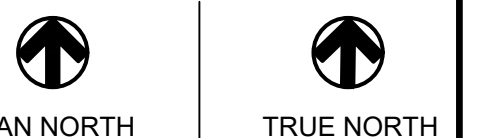

SCALE: 1" = 20'

PSE - OPERATIONAL TRAINING CENTER

WATER PLAN & PROFILE - 20+00 - 25+00

PROJECT No: 22219
DRAWN BY: MPM
CHECKED BY: THF
DATE ISSUED: 08/16/2024

C2.2F

PRCCP20240215
PCR001
8/21/2024

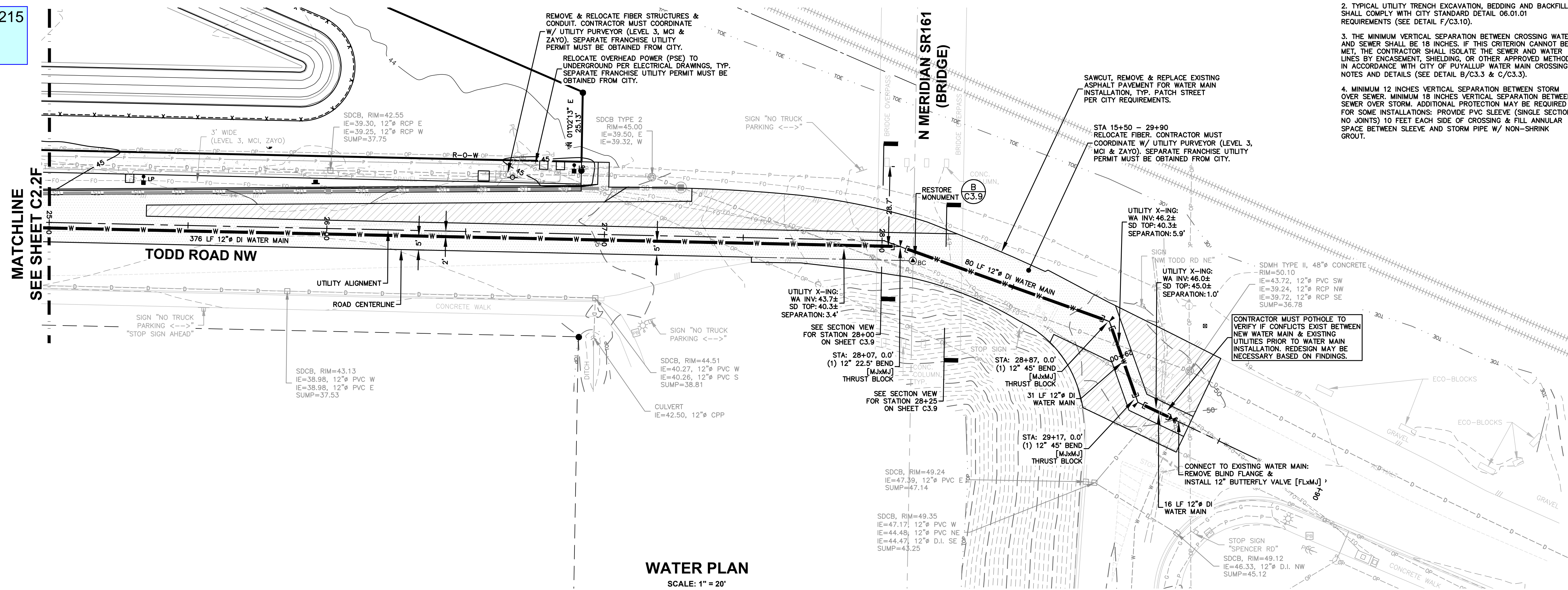

WATER PLAN
SCALE: 1" = 20'

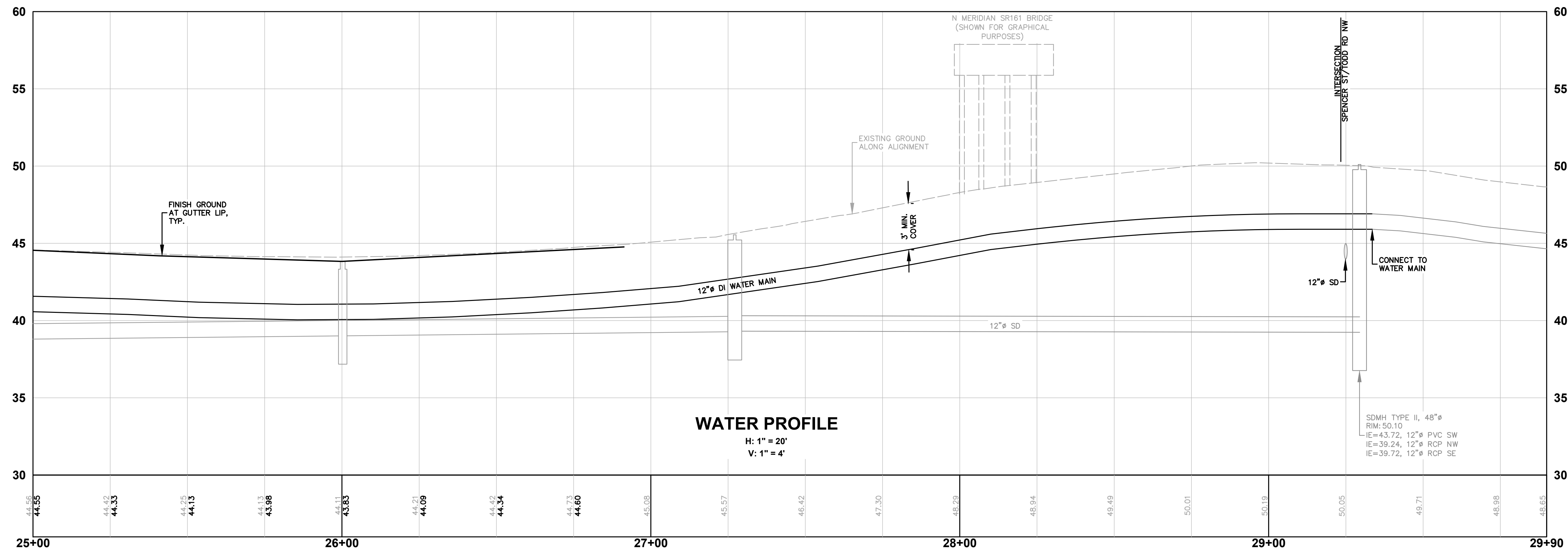

WATER PROFILE
H: 1" = 20'
V: 1" = 4'

GENERAL NOTES

- SEWER AND WATER SYSTEM SHALL BE CONSTRUCTED TO CURRENT CITY OF PUYALLUP STANDARDS.
- TYPICAL UTILITY TRENCH EXCAVATION, BEDDING AND BACKFILL SHALL COMPLY WITH CITY STANDARD DETAIL 06.01.01 REQUIREMENTS (SEE DETAIL F/C3.10).
- THE MINIMUM VERTICAL SEPARATION BETWEEN CROSSING WATER AND SEWER SHALL BE 18 INCHES. IF THIS CRITERION CANNOT BE MET, THE CONTRACTOR SHALL ISOLATE THE SEWER AND WATER LINES BY ENGAGEMENT, SHIELDING, OR OTHER APPROVED METHODS IN ACCORDANCE WITH CITY OF PUYALLUP WATER MAIN CROSSING NOTES AND DETAILS (SEE DETAIL B/C3.3 & C/C3.3).
- MINIMUM 12 INCHES VERTICAL SEPARATION BETWEEN STORM OVER SEWER. MINIMUM 18 INCHES VERTICAL SEPARATION BETWEEN SEWER OVER STORM. ADDITIONAL PROTECTION MAY BE REQUIRED FOR SOME INSTALLATIONS: PROVIDE PVC SLEEVE (SINGLE SECTION, NO JOINTS) 10 FEET EACH SIDE OF CROSSING & FILL ANNULAR SPACE BETWEEN SLEEVE AND STORM PIPE W/ NON-SHRINK GROUT.

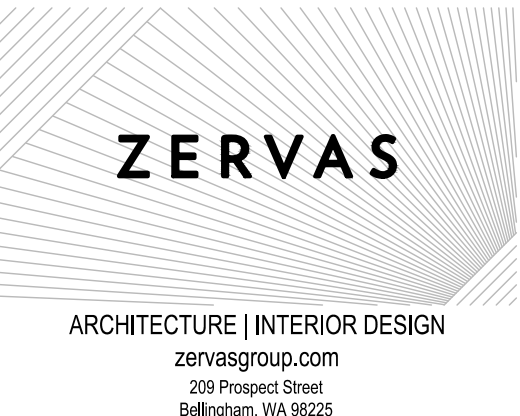

APPROVED

BY: _____
CITY OF PUYALLUP
DEVELOPMENT ENGINEERING

DATE: _____

NOTE: THIS APPROVAL IS VOID AFTER 180 DAYS FROM APPROVAL DATE. THE CITY WILL NOT BE RESPONSIBLE FOR ERRORS AND/OR OMISSIONS ON THESE PLANS. FIELD CONDITIONS MAY DICTATE CHANGES TO THESE PLANS AS DETERMINED BY THE DEVELOPMENT ENGINEERING MANAGER.

APPROVED

BY: _____
CITY OF PUYALLUP
WATER PURVEYOR

DATE: _____

NOTE: THIS APPROVAL IS VOID AFTER 180 DAYS FROM APPROVAL DATE. THE CITY WILL NOT BE RESPONSIBLE FOR ERRORS AND/OR OMISSIONS ON THESE PLANS. FIELD CONDITIONS MAY DICTATE CHANGES TO THESE PLANS AS DETERMINED BY THE WATER PURVEYOR.

CONFORMED SET

REV	ISSUED FOR	DATE

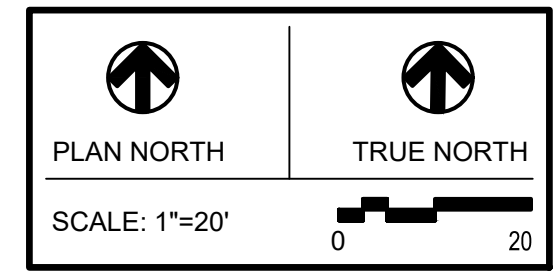

PSE - OPERATIONAL TRAINING CENTER

WATER PLAN & PROFILE - 25+00 - 29+90

PROJECT No: 22219
DRAWN BY: MPM
CHECKED BY: THF
DATE ISSUED: 08/16/2024

C2.2G