

CASCADE CHRISTIAN SCHOOL CAMPUS - ELEMENTARY SCHOOL PORTABLES

GRADING, DRAINAGE & UTILITIES PLAN - PROJECT WORK AREA 2

A PORTION OF THE S 1/2 OF SECTION 26 AND N 1/2 OF SECTION 35, TOWNSHIP 20 NORTH, RANGE 4 EAST, W.M.
PIERCE COUNTY, WASHINGTON (CITY OF PUYALLUP)

BEFORE YOU DIG
CALL
1-800-424-5555
NOT LESS THAN 48 HOURS BEFORE
BEGINNING EXCAVATION UNLESS ANY
UNDERGROUND UTILITIES MAY BE LOCATED.

CASCADE CHRISTIAN SCHOOL CAMPUS ELEMENTARY SCHOOL PORTABLES
GRADING, DRAINAGE & UTILITIES PLAN - PROJECT WORK AREA 2

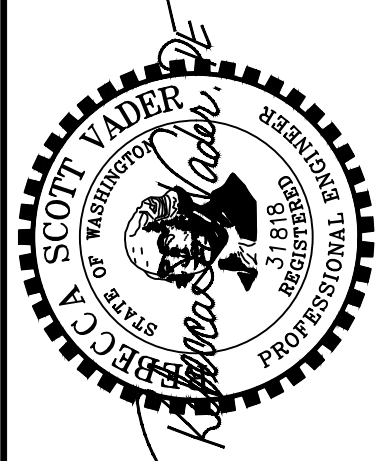

VADER
ENGINEERING
6817 27TH ST W, #55353
TACOMA, WA 98164
253.363.2085
vader@vaderengineering.com

NO.	REVISION

PROJECT NO: 2409
SCALE: 1" = 20'
DESIGNED: RSV
DRAWN: BDS
SAVED: 10/3/2024
PLOT DATE: 10/4/2024

C6
SHEET 6 OF 10

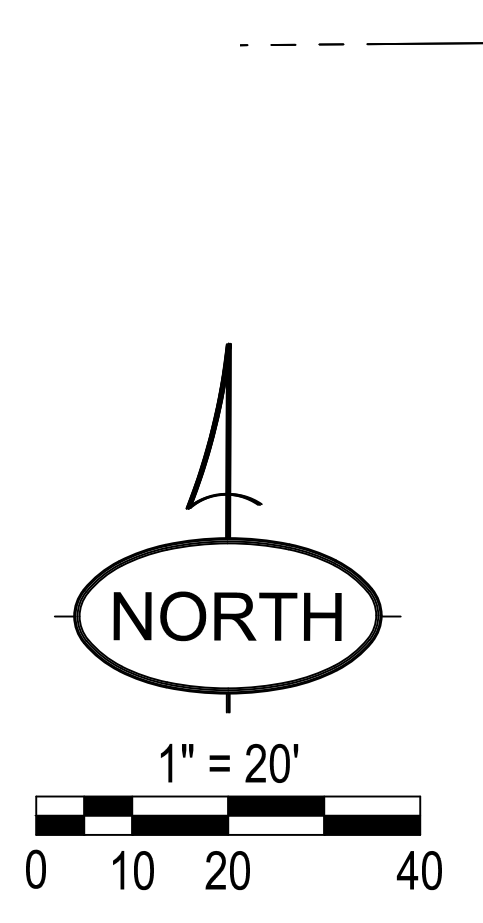

City of Puyallup
Development & Permitting Services
ISSUED PERMIT

Building	Planning
Engineering	Public Works
Fire	Traffic

BASIS OF BEARING MONUMENTED CENTERLINE OF 21ST STREET EAST, THAT BEING N0°43'16"E
DATUM VERTICAL DATUM: NAVD 88 - BASED ON PIERCE COUNTY GIS CONTOUR INTERVAL: 2' HORIZONTAL DATUM: NAD 83-91 (WASHINGTON STATE SOUTH ZONE)
SITE BENCHMARK MONUMENT IN CASE WITH 3" BRASS DISK, 0.8' BELOW RIM, POINT NUMBER 501 AT INTX. 9TH AVE. CT E., & 21ST ST. E. ELEVATION=64.528.

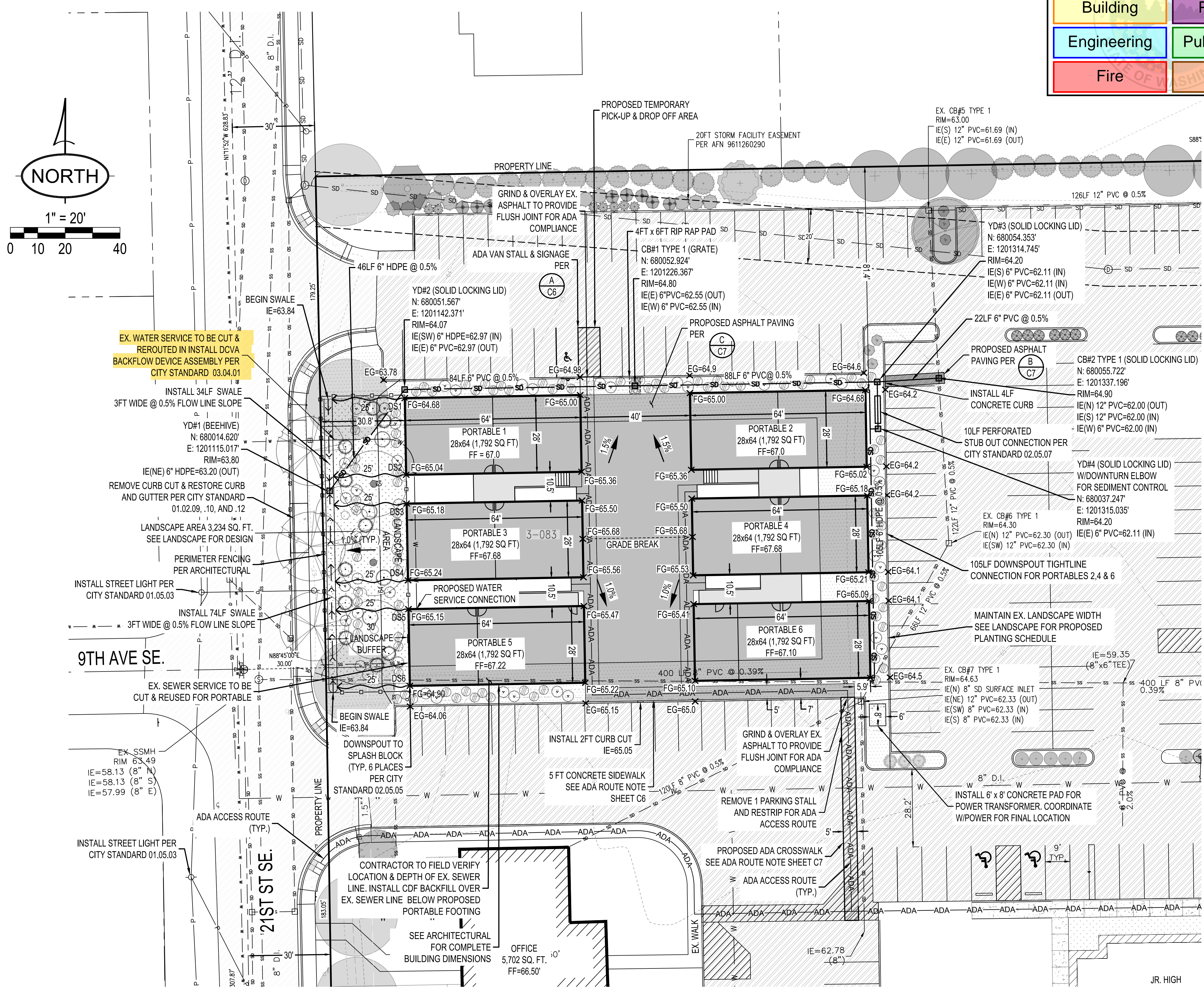

ADA ROUTE
CONTRACTOR TO FIELD VERIFY ADA COMPLIANCE ALONG PROPOSED ACCESSIBILITY ROUTE. FIELD VERIFY EXISTING PAVEMENT MAINTAINS MAX 2% CROSS SLOPE ALONG ADA ROUTE AND MAX 5% RUNNING SLOPES. FOR NEW PAVEMENT, DESIGN TO MAX 1.5% CROSS SLOPE AND MAX 4% RUNNING SLOPE WHERE POSSIBLE. NOTE, DESIGN TO MAX 1.5% SLOPES IN ALL DIRECTIONS AT RAMP LANDINGS, PATH INTERSECTIONS, AND TURNS ALONG PATH WHERE NECESSARY, DESIGN NEW ADA RAMPS TO MAX 7.5% RUNNING SLOPE AND 1.5% CROSS SLOPE. INSTALL DETECTABLE WARNING STRIPS AT ENDS OF ADA ROUTE BEFORE ENTERING A CROSS WALK, PER ADA STANDARDS. GRIND/OVERLAY ASPHALT PAVEMENT AS NECESSARY TO ACHIEVE ADA COMPLIANT GRADES. USE CONCRETE PAVEMENT FOR IMPROVED GRADING ACCURACY OF ADA COMPLIANCE.

ADA PARKING
CONTRACTOR TO FIELD VERIFY ADA COMPLIANCE WITHIN PROPOSED ADA PARKING AREAS. FIELD VERIFY EXISTING PAVEMENT MAINTAINS MAX 2% SLOPE IN ALL DIRECTIONS. FOR NEW PAVEMENT, DESIGN TO MAX 1.0% SLOPE WHERE POSSIBLE. GRIND/OVERLAY ASPHALT PAVEMENT AS NECESSARY TO ACHIEVE ADA COMPLIANT GRADES. USE CONCRETE PAVEMENT FOR IMPROVED GRADING ACCURACY OF ADA COMPLIANCE.

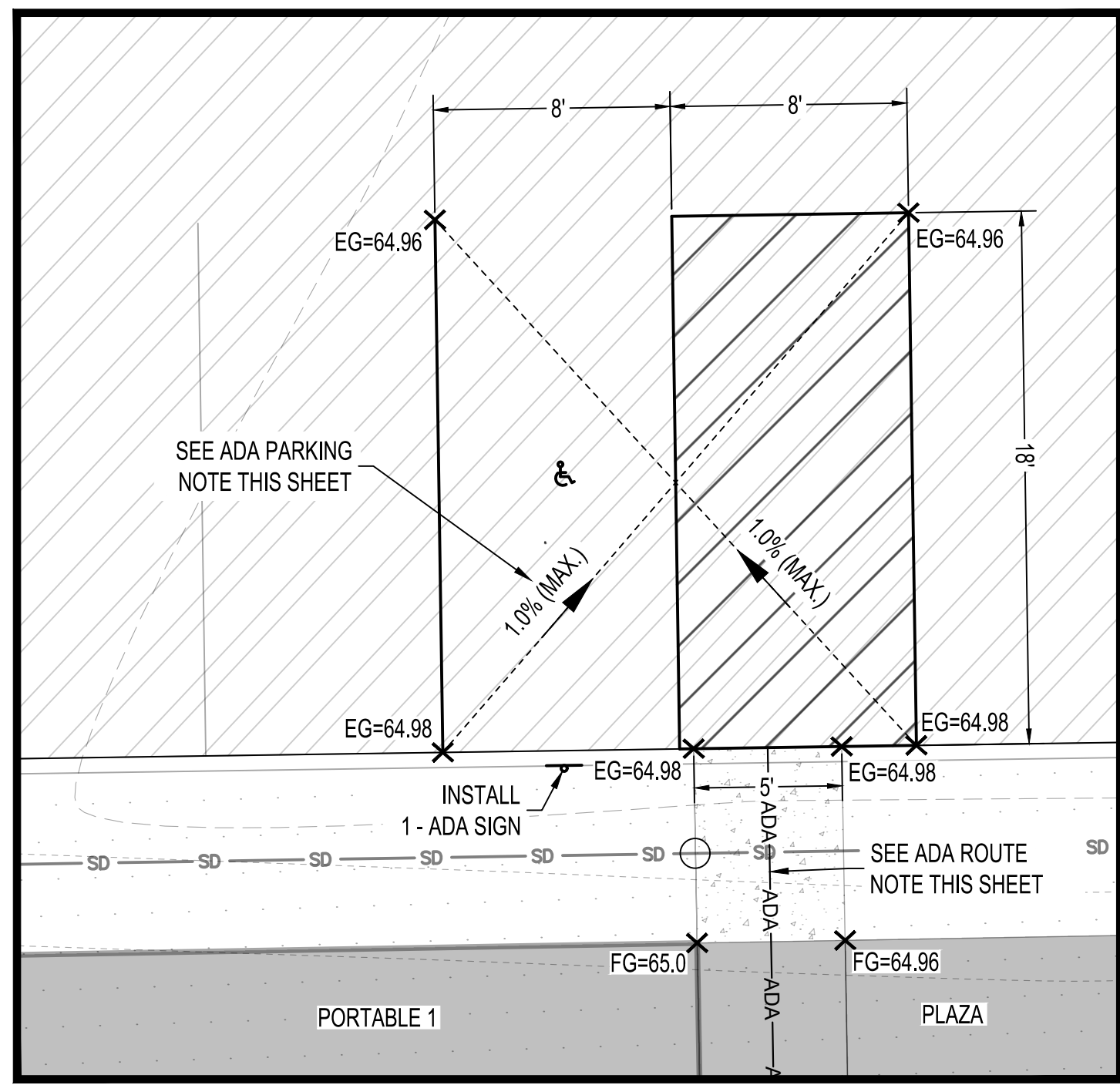

ADA-VAN PARKING STALL DETAIL

SCALE: 1" = 5'