

PRFUP20241305

City of Puyallup Development & Permitting Services ISSUED PERMIT	
Building	Planning
Engineering	Public Works
Fire	Traffic

Job Location: **325 TODD RD NW**

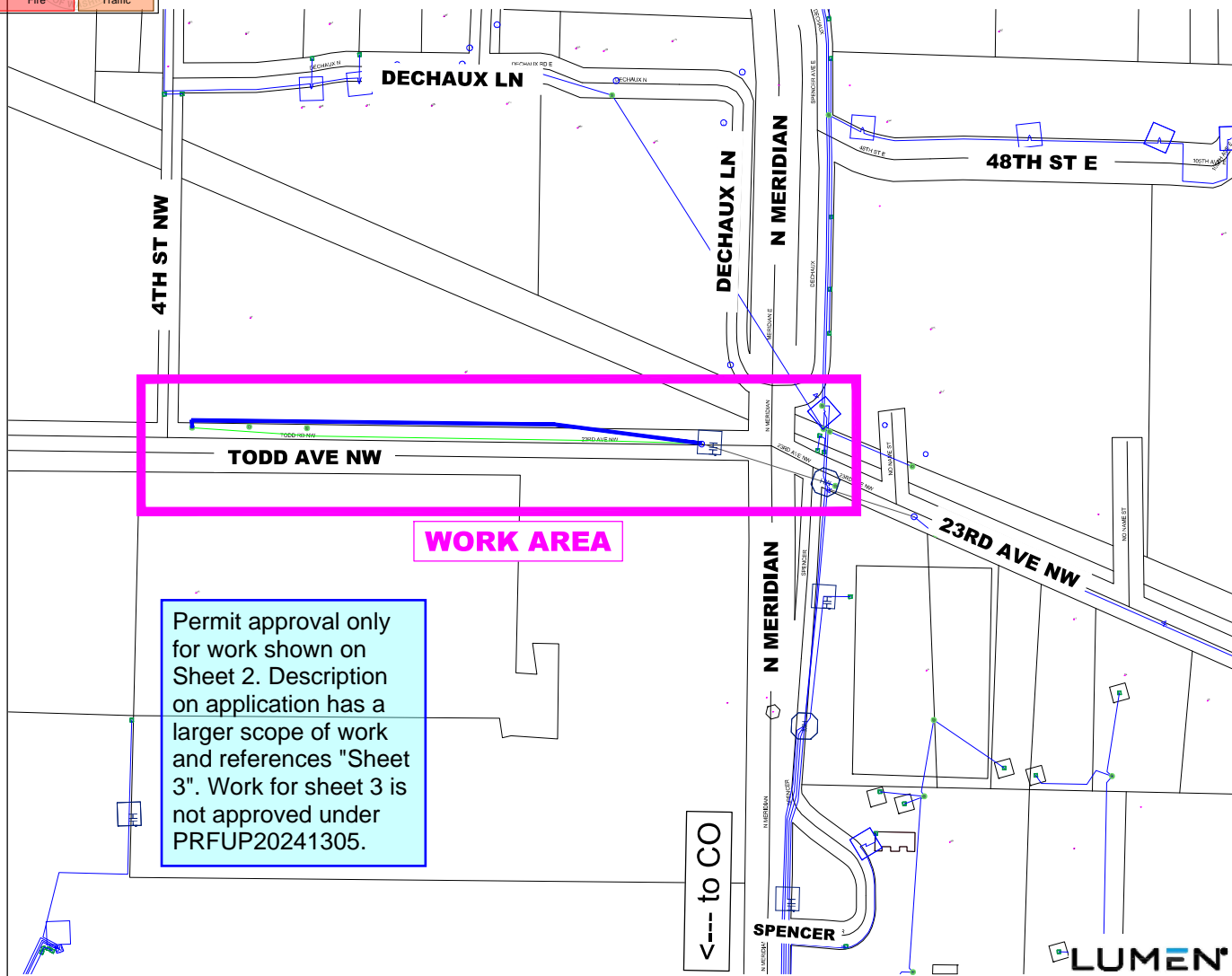

Narrative/Special Remarks

THIS JOB WILL HAVE LUMEN COORDINATE WITH THE CUSTOMER AND DEVELOPER, TO PERFORM REMOVAL WORK OF AERIAL CABLE IN AREA, AND CONVERTING PATHWAY TO A NEW 1X4" UG CONDUIT PATHWAY. JOB IS LOCATED AT 325 TODD RD NW, WITHIN ROUTE OF THE PUYALLUP WIRE CENTER. Lumen to remove aerial cable, developer Pennon Construction to place 1x 4" for Lumen under future sidewalk (in a JUT with other utilities) Pennon representatives: Jacob Brown 206-399-3083

DEVELOPER CONTACT **TRAMMEL CROW COMPANY**
N/A

Held Order Information

Service Order # _____ Customer Terminal: _____
Customer Name: _____ Cable Assignment: _____
Customer Address: _____ F1: _____
F2: _____
Cross Connect: _____

Misc. Information

List all associated projects _____
Permit Information
Right of Way Required **False**
State Permit Required **False**
County Permit Required **NO**
City Permit Required **False**
Additional Permit Information _____
Site Location ID # (BVAPP) _____
Trench Open Date: _____
Cut Sheets: **False**
RW 15
CZ 9
NOTIFY CONVERSATION NUMBER _____
FW Contracts: _____
2023-000009: **NSC**

REVISIONS

DATE	REVISION DESCRIPTION
6/20/2024	REMOVED POLES FROM OLD AERIAL ROUTE, UPDATED DEV CONDUIT TERMINATION POINT.

ISSUE: #2	EXCEPT AS MAY BE OTHERWISE PROVIDED BY CONTRACT, THESE DRAWINGS AND SPECIFICATIONS SHALL REMAIN THE PROPERTY OF CENTURYLINK BEING ISSUED IN STRICT CONFIDENCE AND SHALL NOT BE REPRODUCED, COPIED, OR USED FOR ANY PURPOSE WITHOUT SPECIFIC WRITTEN PERMISSION.	
WC CLLI: PYLPWA01	SECTION: 21 - 22	DESC: BART - PSE New Training Center - 325 Todd Rd NW, Puyallup
TOWNSHIP: 20N	EXCH KEY: 5406	REM KEY: N/A
RANGE: 4E	SCALE: NTS	DATE: 6/11/2024
		SHEET: 1 OF 2

FW PROJECT	WFMT PROJECT	COMMUNITY NAME	ENGINEERING CONTACT	CONTRACT ENGINEER	CONSTRUCTION COORDINATOR	SPLICING COORDINATOR
P.220807	-----	NAME: PUYALLUP CITY: PUYALLUP	NAME: THINH PHAM PHONE: 253-458-6567	NAME: JONATHAN HOLLAND COMPANY: MOUNTAIN LTD	NAME: MATTHEW MORROW PHONE: 206-595-9681	NAME: NSC PHONE: N/A

Any public curb, gutter, or sidewalk broken now or during the course of construction shall be removed and replaced per City Standards.

All proposed franchise utilities shall be located within a recorded utility easement or in the public right-of-way as determined by the City of Puyallup. The City of Puyallup does not authorize or permit utility work on private property.

Facilities located in a pedestrian access route, shall have a slip resistant surface, no vertical discontinuities exceeding 1/4" maximum unless beveled between 1/4" and 1/2", or any horizontal surface openings more than 1/2".

PRFUP20241305

City of Puyallup Development & Permitting Services ISSUED PERMIT			
Building	Planning	Engineering	Public Works
Fire	Traffic		

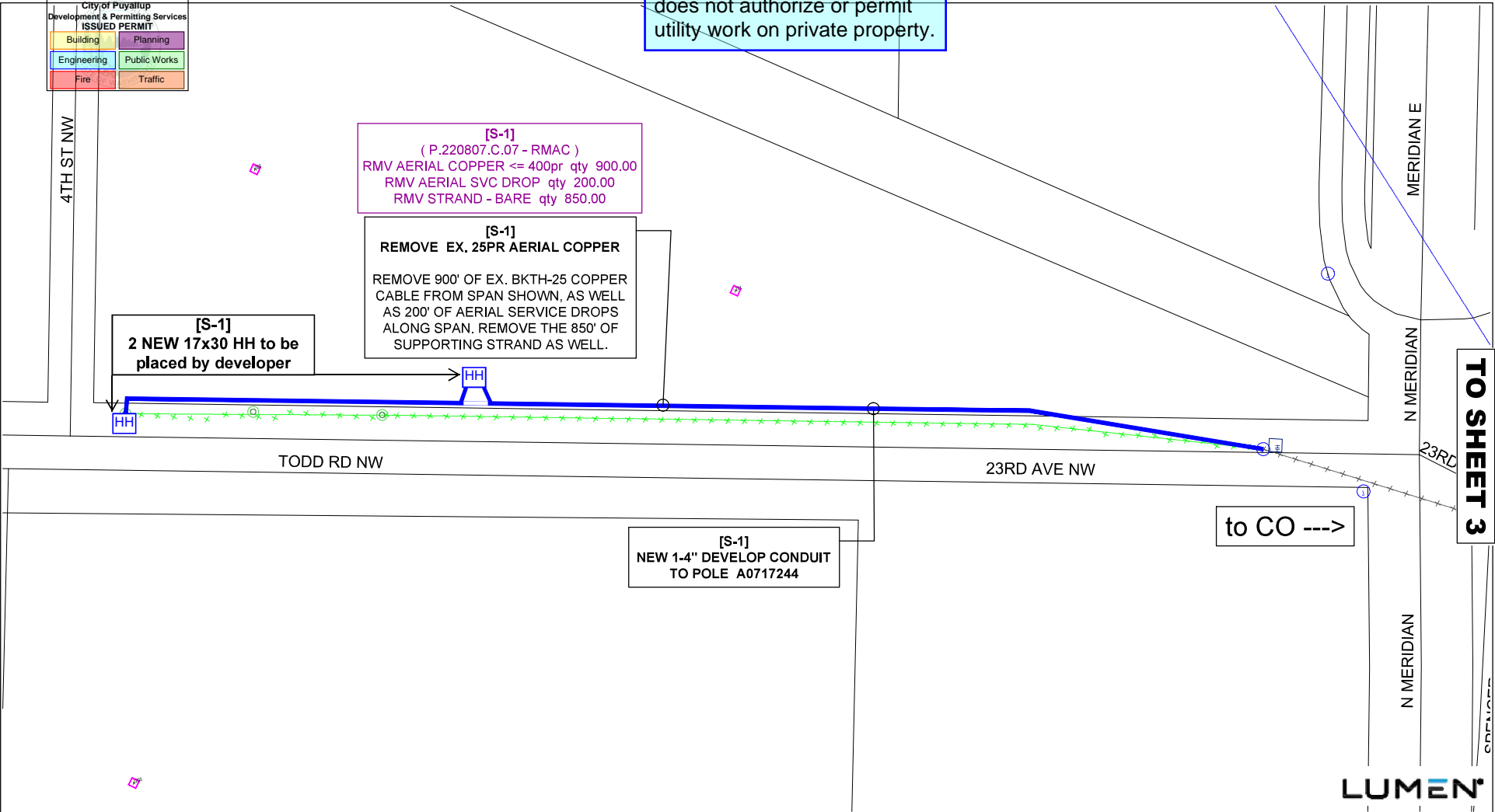

[S-1]
(P.220807.C.07 - RMAC)
RMV AERIAL COPPER <= 400pr qty 900.00
RMV AERIAL SVC DROP qty 200.00
RMV STRAND - BARE qty 850.00

[S-1]
REMOVE EX. 25PR AERIAL COPPER
REMOVE 900' OF EX. BKTH-25 COPPER
CABLE FROM SPAN SHOWN, AS WELL
AS 200' OF AERIAL SERVICE DROPS
ALONG SPAN. REMOVE THE 850' OF
SUPPORTING STRAND AS WELL.

[S-1]
2 NEW 17x30 HH to be
placed by developer

[S-1]
NEW 1-4" DEVELOP CONDUIT
TO POLE A0717244

to CO --->

SEE REDLINES AND DEV PLANS FOR ADDITIONAL DETAILS

REVISIONS	
DATE	DESCRIPTION
6/20/24	REM POLES ALONG OLD AERIAL, UPD. DEV CONDUIT LOCATION

ECD: 8/30/2024

FW PROJECT	WFMT PROJECT:	COMMUNITY NAME	ENGINEERING CONTACT	CONTRACT ENGINEER	CONSTRUCTION COORDINATOR	SPLICING COORDINATOR
P.220807	-.-.-.-.-	NAME: PUYALLUP CITY: PUYALLUP	NAME: THINH PHAM PHONE: 253-458-6567	NAME: JONATHAN HOLLAND COMPANY: MOUNTAIN LTD	NAME: MATTHEW MORROW PHONE: 206-595-9681	NAME: N/A PHONE: N/A

ISSUE:	#2	EXCEPT AS MAY BE OTHERWISE PROVIDED BY CONTRACT, THESE DRAWINGS AND SPECIFICATIONS SHALL REMAIN THE PROPERTY OF CENTURYLINK BEING ISSUED IN STRICT CONFIDENCE AND SHALL NOT BE REPRODUCED, COPIED, OR USED FOR ANY PURPOSE WITHOUT SPECIFIC WRITTEN PERMISSION.
WC CLLI:	PYLPWA01	
SECTION:	21	
TOWNSHIP:	20N	
RANGE:	4E	DESC: BART - PSE New Training Center - 325 Todd Rd NW, Puyallup
		EXCH KEY: 5406
		REM KEY: N/A
		SCALE: NTS
		DATE: 6/13/2024
		SHEET: 2 OF 2