

PROJECT LOCATION



PROJECT INFORMATION:

APPLICABLE CODES: (INCLUDING STATE AND LOCAL AMENDMENTS OF FOLLOWING LISTED CODES)
STATE OF WASHINGTON:
HOSPITAL CODE: WASHINGTON STATE ADMINISTRATIVE CODE FOR HOSPITALS, RULES AND REGULATIONS, WAC 246-320
GUIDELINES FOR DESIGN AND CONSTRUCTION OF HEALTH CARE FACILITIES (GUIDELINES), 2014 EDITION, FACILITY GUIDELINES INSTITUTE (FGI)
BUILDING CODE: INTERNATIONAL BUILDING CODE (IBC), 2021 EDITION
INTERNATIONAL CODE COUNCIL (ICC), (A117.1-2017: WAC 51-50)
MECHANICAL CODE: INTERNATIONAL MECHANICAL CODE (IMC), 2021 EDITION
INTERNATIONAL FUEL GAS CODE (IFGC), 2021 EDITION
NATIONAL FUEL GAS CODE (NFGC), WAC 51-52, 2021 EDITION
PLUMBING CODE: UNIFORM PLUMBING CODE (UPC): WAC 51-56, 2021 EDITION
ENERGY CODE: WASHINGTON STATE ENERGY CODE: WAC 51-11, 2021 EDITION
ELECTRICAL CODE: NATIONAL ELECTRICAL CODE (NEC), 2021 EDITION: WAC 296-46B
LIFE SAFETY CODE: NATIONAL FIRE PROTECTION ASSOCIATION (NFPA-101), 2012 EDITION
FIRE CODE: INTERNATIONAL FIRE CODE (IFC), 2021 EDITION: WAC 51-54
PROJECT DATA:
AUTHORITY: CITY OF PUYALLUP
SEISMIC ZONE: 3
FROST LINE: 12 INCHES
SNOW LOAD: 25 PSF
WIND EXPOSURE: 85 MPH - EXPOSURE B
CONSTRUCTION TYPE: V-B
OCCUPANCY: B
FIRE PROTECTION: AUTOMATIC FIRE ALARM
AUTOMATIC FIRE SPRINKLER SYSTEM
Tax parcel number: 7790000566

PROJECT TEAM:

OWNER:
MultiCare Health System
401 15th Ave SE
Puyallup, WA 98372
Contact: Aaron Fliche
Aaron.Fliche@MultiCare.org
(253) 697-2309
FACILITY CONTACTS:
CBRE, MultiCare Health System Account
911 South 5th Street, Mail Stop 911-1-CONS
Tacoma, WA 98405
Contact: Eliene Celis
Eliene.Celis@MultiCare.org
(206) 331-2680
ARCHITECT:
InSight Healthcare Architecture, LLC
16824 44th Ave West, #170
Lynnwood, WA 98037
Contact: Karsea Langlois
Principal Architect
Karsea@InsightArch.us
(206) 601-6645

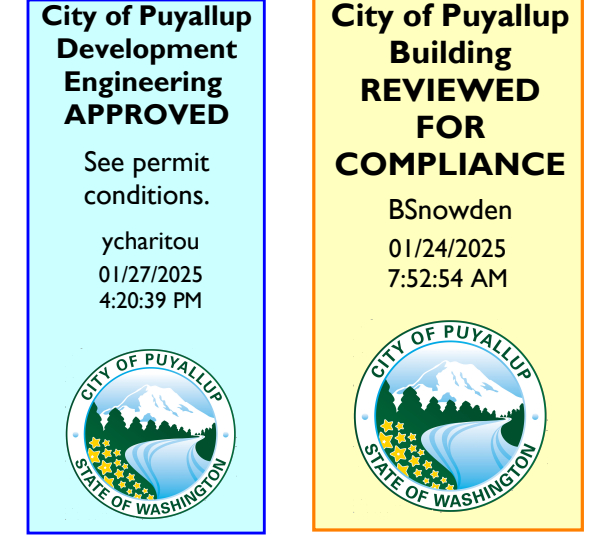

INDEX TO DRAWING SET:

Table with 2 columns: Code (A0.0 to A8.0) and Description (PROJECT INFO, INDEX, SITE PLAN, LIFE SAFETY PLAN, LEVEL 1 PLAN, etc.)



PROJECT DESCRIPTION:

MODIFICATIONS TO THE EXISTING KITCHEN, INCLUDING:
Kitchen 176
- Remove existing flooring and replace with a similar, anti-slip flooring.
- Replace stainless-steel sink with new stainless-steel double-basin sink.
- Remove double oven and cooktop, replace with a stove and fan.
- Replace countertop and backsplash throughout the kitchen.
- Remove and relocate sanitation holder to the area behind the door.
Wall Outside of Kitchen
- Install (2) cabinets. The shelving inside of the cabinet will be adjustable to accommodate totes, highchairs, extra chairs, etc.
- The cabinet will have also Kitlock cipher locks installed to keep items locked.
Evaluation Room 161
- Remove the existing carpet and replace it with new flooring.

GRAPHIC SYMBOLS:

Table of graphic symbols including North Arrow, Grid Line, Building Section, Wall Section, Detail, Interior Elevation, Elevation Mark, Revision Mark, Property Corners, Cut Line, and Center Line.

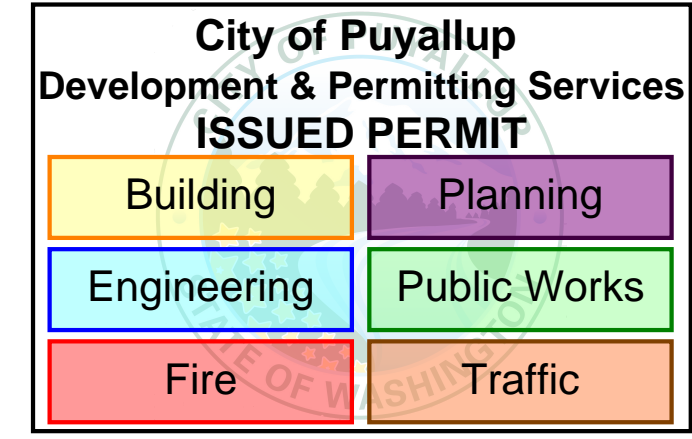

Approval of submitted plans is not an approval of omissions or oversights by this office or non compliance with any applicable regulations of local government. The contractor is responsible for making sure that the building complies with all applicable codes and regulations of the local government.
The approved construction plans, documents, and all engineering must be posted on the job at all inspections in a visible and readily accessible location.
Full sized legible color plans are required to be provided by the permittee on site for inspection.

OWNER:



PROJECT NAME:

MultiCare Children's Therapy Unit: Kitchen Alterations
402 15th Ave SE
Puyallup, WA 98372

Table with columns: MARK, DATE, DESCRIPTION. Includes permit set and permit set rev #1 entries.

PROJECT NO. 31269
DRAWN BY: K. LANGLOIS
DATE: 11 NOVEMBER 2024
COPYRIGHT TO: InSight Healthcare Architecture

SHEET TITLE: PROJECT INFO / INDEX / SITE PLAN

SHEET #: T0.0

City of Puyallup
Development & Permitting Services
ISSUED PERMIT

Building	Planning
Engineering	Public Works
Fire	Traffic

InSight
HealthCare Architecture
Karsesa@InSightArch.us
16824 44th Ave W, #170
Lynnwood, WA 98037
206-601-6645

8466 REGISTERED ARCHITECT
Karsesa Langlois
Karsesa M. Langlois
STATE OF WASHINGTON

OWNER:
MultiCare
BetterConnected

PROJECT NAME:
MultiCare Children's Therapy Unit: Kitchen Alterations
402 15th Ave SE
Puyallup, WA 98372

MARK	DATE	DESCRIPTION
	11/11/2024	PERMIT SET
1	1/6/2025	PERMIT SET REV #1

PROJECT NO. 31269
DRAWN BY: K. LANGLOIS
DATE: 11 NOVEMBER 2024
COPYRIGHT TO:
InSight Healthcare Architecture

SHEET TITLE:
LEVEL 1 PLAN

SHEET #:
A1.0

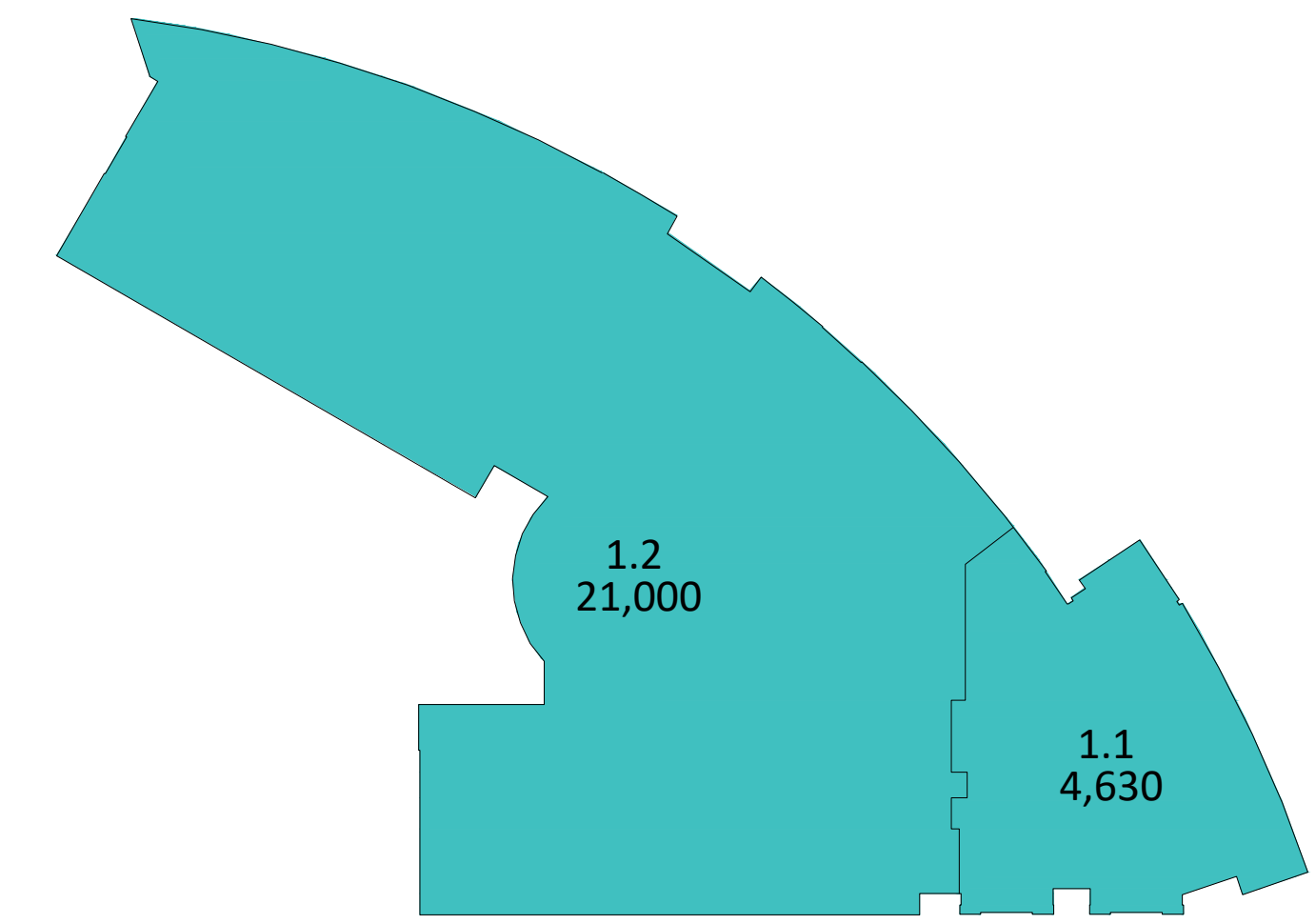

OCCUPANCY

OCCUPANCY - LEVEL 1						
COMP ID	AREA (SF)	OCCUPANCY	AREA USAGE	OCCUPANT LOAD	OCCUPANTS	SPRINKLER SYSTEM
1.1	4,630 SF	BUSINESS	SLEEP STUDY	100 SF	47	YES
1.2	21,000 SF	BUSINESS	MEDICAL OFFICES	100 SF	210	YES
	25,630 SF					

LEVEL 1 - LIFE SAFETY PLAN
NOT TO SCALE

WALL TYPE RATING LEGEND		SYMBOLS	
	2-HR FIRE BARRIER (SHAFT, ELEVATOR)		HORIZONTAL EXIT
	EXIT PASSAGEWAY(2-HR)		EXIT DISCHARGE
	EXIT STAIR(2-HR)		EXIT ACCESS
	2-HR FIRE+SMOKE BARRIER (SMOKE COMPARTMENT)		HAZARDOUS AREA
	SMOKE BARRIER (1-HR) (SMOKE COMPARTMENT)		DISTANCE TO EXIT
	1-HR FIRE BARRIER (HAZARDOUS AREA)		FIRE EXTINGUISHER
	SMOKE PARTITION(NR) (HAZARDOUS AREA)		FIRE ALARM PULL STATION
	SUITE(NR)		ANNUNCIATOR
	CORRIDOR WALL(NR)		EXIT SIGN
	EXIT ACCESS CORRIDOR(NR)		ARROW(S) INDICATE DIRECTION IF SHOWN
	BUSINESS OCCUPANCY		

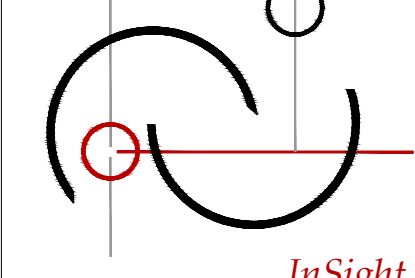

InSight
HealthCare Architecture
Karsosa@InsightArch.us
16824 44th Ave W, #170
Lynnwood, WA 98037
206-601-6645

8466 REGISTERED ARCHITECT
Karsosa Langlois
Karsosa M. Langlois
STATE OF WASHINGTON

City of Puyallup
Development & Permitting Services
ISSUED PERMIT

Building	Planning
Engineering	Public Works
Fire	Traffic

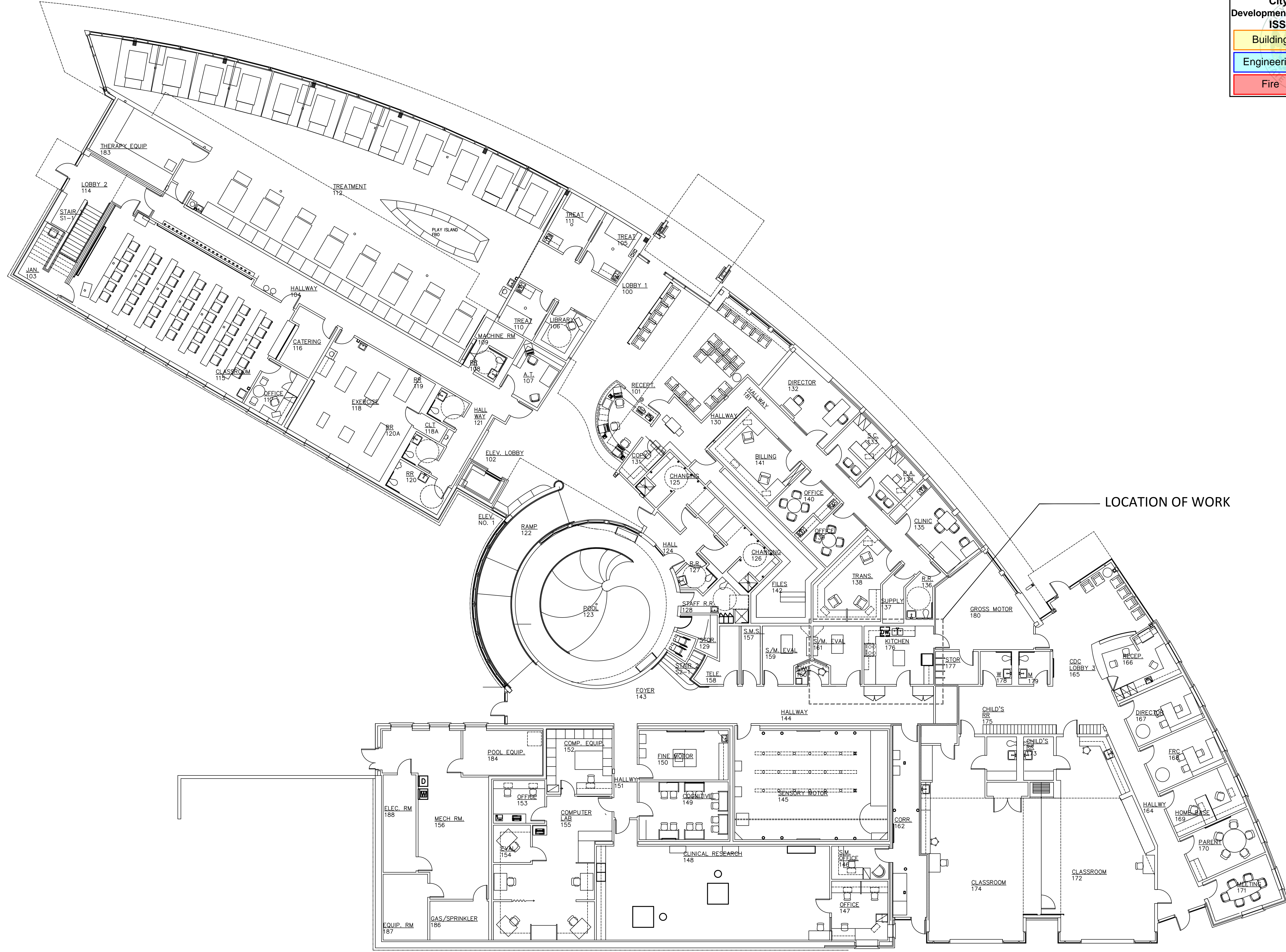

LOCATION OF WORK

LEVEL 1 PLAN
SCALE: 1" = 10'-0"

OWNER:



PROJECT NAME:

MultiCare
Children's
Therapy Unit:

Kitchen
Alterations

402 15th Ave SE
Puyallup, WA 98372

MARK	DATE	DESCRIPTION
	11/11/2024	PERMIT SET

PROJECT NO. 31269

DRAWN BY: K. LANGLOIS

DATE: 11 NOVEMBER 2024

COPYRIGHT TO:
InSight Healthcare Architecture

SHEET TITLE:

LEVEL 1 PLAN

SHEET #:

A1.0

City of Puyallup
Development & Permitting Services
ISSUED PERMIT

Building	Planning
Engineering	Public Works
Fire	Traffic

GENERAL NOTES

1. THE CONTRACTOR SHALL VERIFY AND COORDINATE ALL DRAWINGS, DIMENSIONS, SPECIFICATIONS AND SCHEDULES PRIOR TO PROCEEDING WITH ANY WORK OR FABRICATION. NOTIFY ARCHITECT IMMEDIATELY OF ANY UNCERTAINTY OR DISCREPANCY.
2. DRAWINGS SHALL NOT BE SCALED.
3. WHERE NOTES ON THE DRAWINGS INDICATE A CONDITION AT ONE LOCATION, WHETHER INDICATED AS TYPICAL OR NOT, THE NOTE SHALL APPLY TO ALL SIMILAR LOCATIONS, UNO.
4. SEE SHEET TO.0 FOR ADDITIONAL NOTES, SYMBOLS, ABBREVIATIONS, ETC.
5. SEE CODE PLAN AND DETAILS, FOR EXTENT OF RATED WALLS, CEILINGS, OPENINGS & DETAIL.
6. GRID LINES ARE TO CENTERLINE OF STEEL AND STUDS @ FRAMED WALLS, UNO.
7. ALL INTERIOR WALL DIMENSIONS ARE TO FACE OF FINISHED WALL, AND ROUGH OPENINGS, UNLESS NOTED OTHERWISE OR INDICATED ON DETAILS.
8. DOORS ARE TYPICALLY LOCATED BY DETAIL. WHERE A DIMENSION IS INDICATED ON PLAN FOR DOORS AND RELITES THEY WILL SUPERSEDE DETAIL DIMENSIONS.
9. REFER TO DETAIL 5/AB.0 FOR MANEUVERING CLEARANCES AT DOORS.
10. ALL BUILDING SIGNAGE AND IDENTIFYING DEVICES TO COMPLY WITH THE REQUIREMENTS OF THE A.D.A. (AMERICANS WITH DISABILITIES ACT).
11. FINISH FLOORING TO EXTEND TO WALLS BELOW ALL CASEWORK NOT PERMANENTLY ATTACHED TO THE FLOOR UNLESS NOTED OTHERWISE.
12. PROVIDE SOLID BLOCKING @ ALL CASEWORK AT TOP AND BOTTOM OF UPPERS AND AT TOP OF COUNTERS AND LOWER CABINETS. PROVIDE BLOCKING IN WALLS FOR WALL MOUNTED/SUPPORTED ITEMS INCLUDING TV BRACKETS, SHELVES, LOCKERS, WHITE BOARDS, PROJECTION SCREENS, ETC. VERIFY BLOCKING REQUIREMENTS WITH SUPPLIER/MFR OF PRODUCT TO BE MOUNTED.
13. WHERE A MECHANICAL PIPE OR DUCT CHASE IS INDICATED ON THE FLOOR PLAN, VERIFY SIZE OF CHASE REQUIRED FOR MECHANICAL ITEMS.
14. WHERE EXISTING WALL-MOUNTED ITEMS ARE NOTED, INSTALL ITEM NOTED ON DEMOLITION PLANS TO BE SALVAGED.

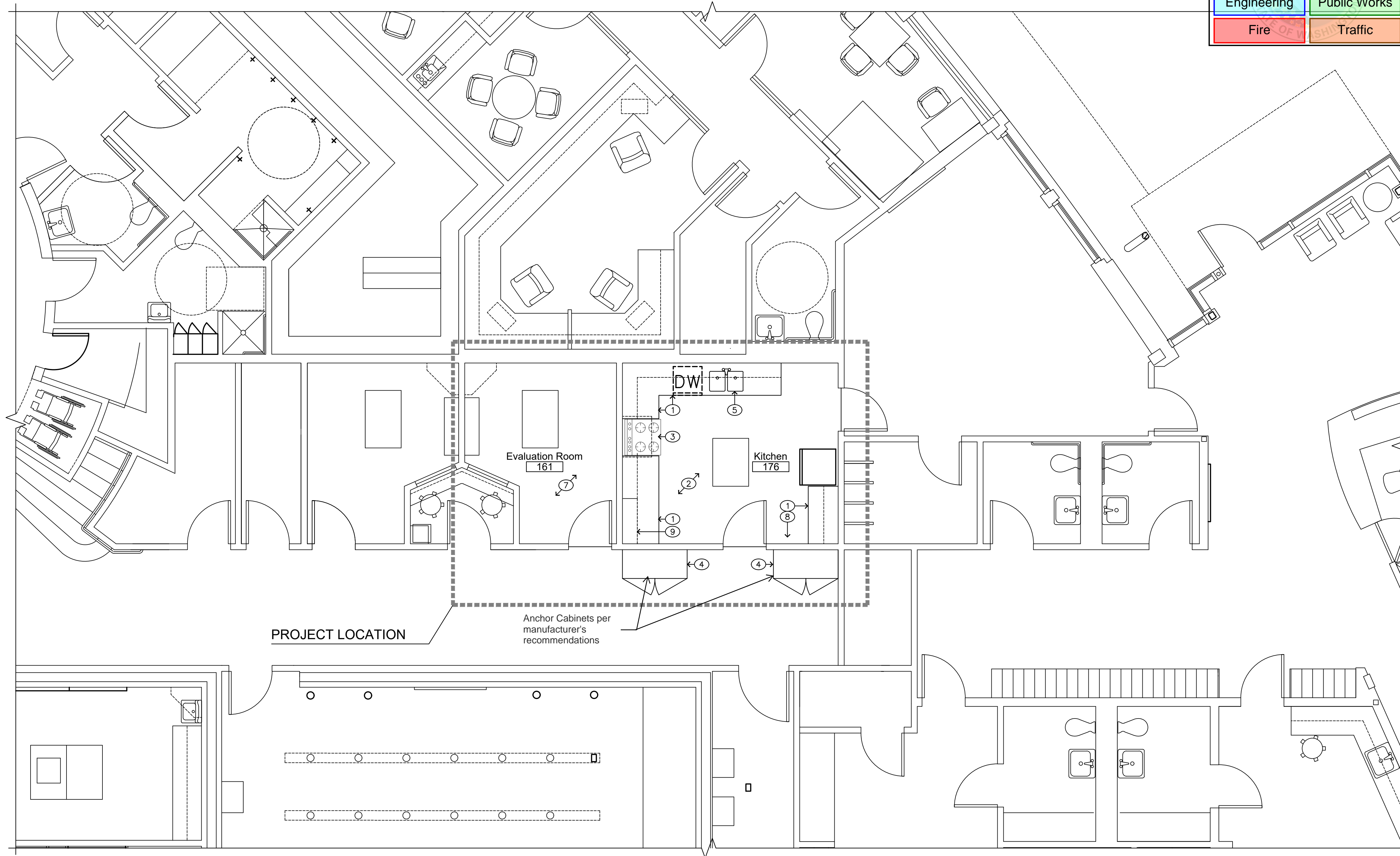

KEYED NOTES

- 1 NEW P-LAM COUNTERTOP W/ 4" BACKSPASH - RADIUS OUTSIDE CORNERS 2". P-LAM COLOR: TBD
- 2 NEW SHEET VINYL FLOORING WITH 4" INTEGRAL COVED BASE. BIOSPEC MD, COLOR: TBD
- 3 NEW FREE-STANDING RANGE / OVEN
- 4 NEW 52"W X 24"D X 84"H CABINET WITH 20 DEGREE SLANT-TOP AND KITLOCKS - SEE DETAIL 1/A3.0. P-LAM TO MATCH SURFACES IN SENSORY MOTOR ROOM (ACROSS THE HALL FROM KITCHEN)
- 5 NEW DOUBLE-COMPARTMENT STAINLESS STEEL SINK AND GOOSENECK FAUCET WITH WRIST-BLADE HANDLES. WRAP ALL EXPOSED PIPES.
- 6 PATCH AND PAINT ALL MODIFIED SURFACES - MATCH EXISTING
- 7 NEW SHEET VINYL FLOORING WITH 4" RUBBER BASE. BIOSPEC MD, COLOR: TBD
- 8 RELOCATED SANITATION STATION
- 9 MODIFY DEPTH OF EXISTING CABINETS ABOVE REMOVED DOUBLE OVENS TO MATCH DEPTH OF ADJACENT EXISTING CABINETS. INSTALL NEW P-LAM ON UNFINISHED FACE OF ADJACENT CABINET WITH ARPA "LAVANDA" #0607.

DETAILED LEVEL 1 PLAN: PROPOSED

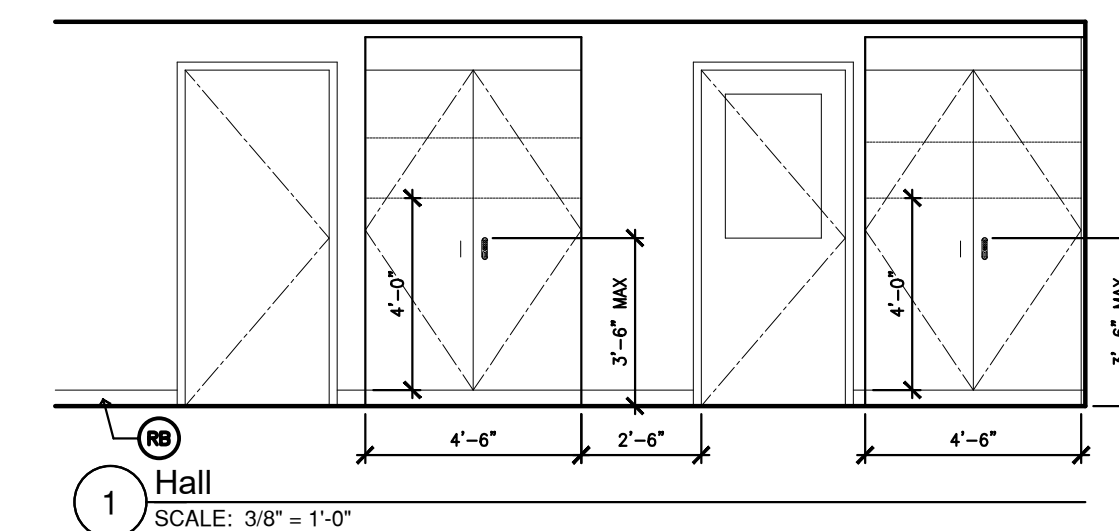

InSight
HealthCare Architecture
 Karsese@InsightArch.us
 16824 44th Ave W, #170
 Lynnwood, WA 98037
 206-601-6645

8466 REGISTERED ARCHITECT
Karsese M. Langlois
 Karsese M. Langlois
 STATE OF WASHINGTON

OWNER:

MultiCare
BetterConnected

PROJECT NAME:

MultiCare
Children's
Therapy Unit:
Kitchen
Alterations

402 15th Ave SE
 Puyallup, WA 98372

MARK	DATE	DESCRIPTION
	11/11/2024	PERMIT SET

PROJECT NO. 31269

DRAWN BY: K. LANGLOIS

DATE: 11 NOVEMBER 2024

COPYRIGHT TO:

InSight Healthcare Architecture

SHEET TITLE:

DETAILED
LEVEL 1 PLAN:
PROPOSED

SHEET #:

A3.0

