

PRPF20250508

Design No. U303

February 8, 2024

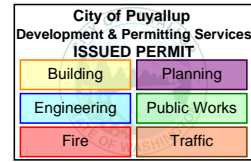

Bearing Wall Rating — 1 Hr

This design was evaluated using a load design method other than the Limit States Design Method (e.g., Working Stress Design Method). For jurisdictions employing the Limit States Design Method, such as Canada, a load restriction factor shall be used — See Guide [BXUV](#) or [BXUV7](#)

* Indicates such products shall bear the UL or cUL Certification Mark for jurisdictions employing the UL or cUL Certification (such as Canada), respectively.

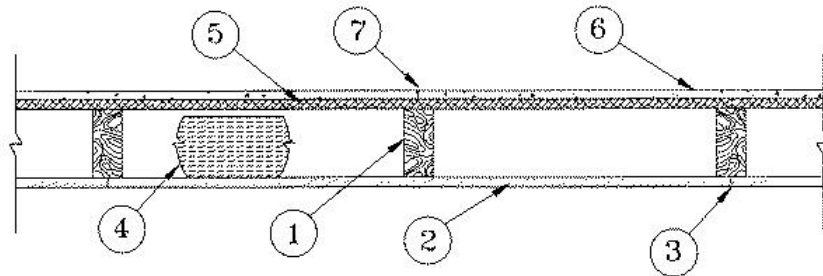

1. **Wood Studs** — Nom 2 by 4 in. spaced 16 in. OC, effectively cross-braced.

2. **Gypsum Board*** — 5/8 in. thick, with square or tapered edges, applied vertically or horizontally with vertical joints centered over studs. Horizontal joints need not be backed by framing. Fastened to studs and plates with 1-7/8 in. long 6d cement coated nails spaced 7 in. OC or with 1-7/8 in. long Type S screws spaced 8 in. OC, or 1-1/4 in. long Type W coarse thread gypsum panel steel screws spaced a max 8 in. OC, with last screw 1 in. from edge of board. 54 in. widths applied horizontally.
CGC INC — Types AR, C, IP-AR, IP-X1, IP-X2, IPC-AR, SCX, ULIX, ULX, WRC, WRX.

UNITED STATES GYPSUM CO — Types AR, C, FRX-G, IP-AR, SCX, IP-X1, IP-X2, IPC-AR, ULIX, ULX, WRC or WRX.

USG BORAL DRYWALL SFZ LLC — Types C, SCX

USG MEXICO S A DE C V — Types AR, C, IP-AR, IP-X1, IP-X2, IPC-AR, SCX, ULX, WRC or WRX.

3. **Joints** — When tapered edge gypsum board is used, joints covered with joint compound and paper tape. As an alternate, gypsum veneer plaster may be applied to the entire surface of Classified veneer baseboard with joints reinforced with paper tape. When square-edge gypsum board is used, treatment of joints is optional.

4. **Batts and Blankets*** — Min 3 in. thick mineral wool batts, friction fit between studs.
THERMAFIBER/OWENS CORNING — Type SAFB, SAFB FF

ROCKWOOL — Type SAFEnSOUND, min. 1.8 pcf.

5. **Sheathing** — Min 15/32 in. thick, 4 ft wide, wood structural panels, min grade "sheathing" applied vertically, with vertical joints centered over studs. Attached to studs with 10d galv nails 6 in. OC at the perimeter and 12 in. OC in the field. Sheathing fully covered with a weather resistive barrier.

6. **Cementitious Backer Units*** — 1/2 or 5/8 in. thick, installed vertically or horizontally over the sheathing with vertical joints centered over studs. All joints offset min 12 in. from underlying sheathing joints. Fastened to studs and plates with corrosion resistant 2-1/4 in. long chamfered, ribbed wafer head screws with a minimum head diameter of .400 inches or 2-1/4 in. hot-dipped galvanized roofing nails spaced 8 in. OC.
UNITED STATES GYPSUM CO — Type DCB.

USG MEXICO S A DE C V — Type DCB.

7. **Joints** — Cement board joints need not be treated.

8. **Vapor Retarder , Water Barrier or Weather Resistive Barrier** — (Optional, not shown) — As required

* Indicates such products shall bear the UL or cUL Certification Mark for jurisdictions employing the UL or cUL Certification (such as Canada), respectively.