

* Note existing plumbing on backside of wall,
 • Cold line
 • Hot line

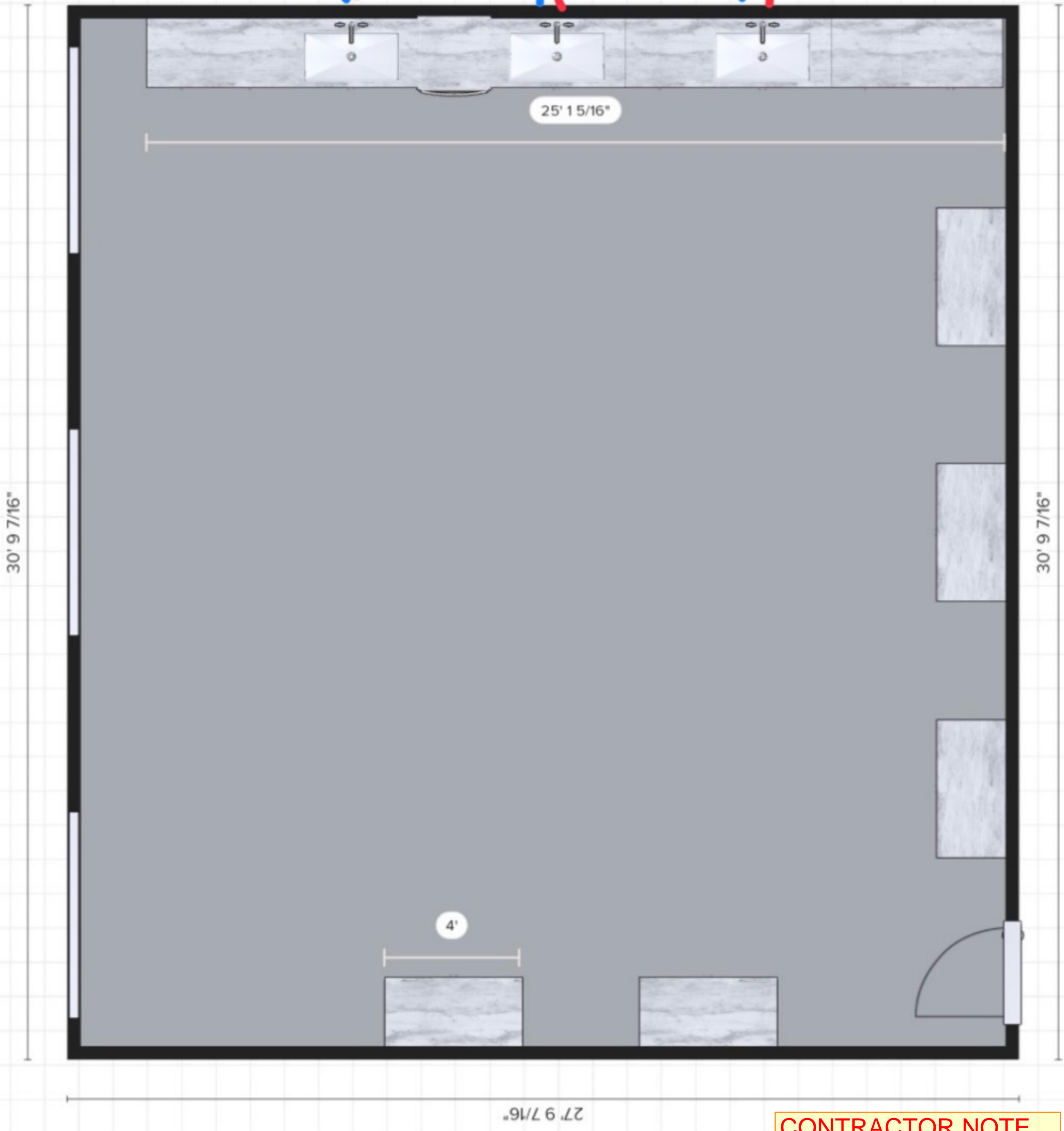
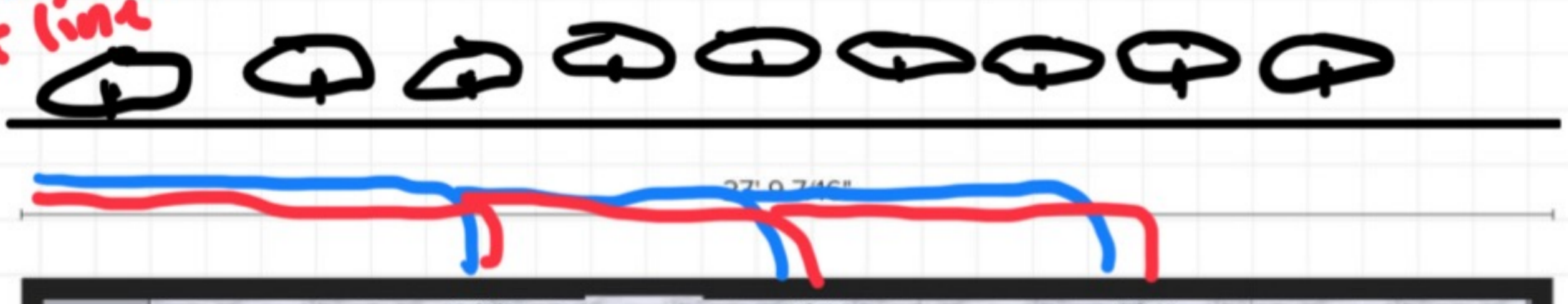

PRCTI20250675

The approved construction plans, documents, and all engineering must be posted on the job at all inspections in a visible and readily accessible location.

Full sized legible color plans are required to be provided by the permittee on site for inspection.

CONTRACTOR NOTE
 Licensed plumber will provide fixture count at time of rough in for inspector to review. To include supply and drainage sizing

Approval of submitted plans is not an approval of omissions or oversights by this office or non compliance with any applicable regulations of local government. The contractor is responsible for making sure that the building complies with all applicable codes and regulations of the local government.

**City of Puyallup
 Building
 REVIEWED
 FOR
 COMPLIANCE**

SKinnear
 06/18/2025
 3:49:36 PM

City of Puyallup
 Development & Permitting Services
 ISSUED PERMIT

Building	Planning
Engineering	Public Works
Fire	Traffic