

A3 OVERALL FLOOR PLAN
SCALE: 1/16" = 1'-0"

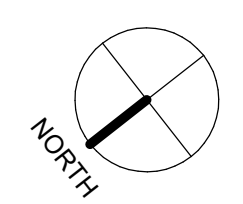

ANNOTATED PLAN NOTES

- WHERE SHOWN, ALL FURNITURE & EQUIPMENT PLANS SHOWN AS DASHED ARE FOR REFERENCE ONLY. REFER PLANS & SPECIFICATIONS FOR ALL BASE CONTRACT FURNITURE TO BE PROVIDED.
- REFER FINISH SHEETS FOR FLOOR FINISH PATTERNS & FLOOR TRANSITION LOCATIONS.
- CONTRACTOR TO PROVIDE BLOCKING BEHIND ALL CABINETS, COAT HOOKS, TV LOCATIONS AS WELL AS ALL WALL MOUNTED ACCESSORIES, INCLUDING TOILET ROOM ACCESSORIES, TOILET ROOM PARTITIONS, ETC.
- ALL MECHANICAL, ELECTRICAL, PLUMBING, & AV SYSTEMS SHALL BE CONCEALED WITHIN WALL PARTITIONS OR CEILING CAVITY UNLESS THERE IS EXPOSED STRUCTURE. REFER REFLECTED CEILING PLANS FOR ADDITIONAL INFORMATION.
- REFER DOOR SCHEDULE & WINDOW ELEVATIONS FOR ADDITIONAL INFORMATION.
- PROVIDE ACCESS DOORS IN PARTITIONS AT ALL LOCATIONS REQUIRED. ACCESS DOORS SHALL MAINTAIN FIRE RATING OF WALL. COORDINATE ALL LOCATIONS NOT SHOWN ON DRAWINGS W/ ARCHITECT PRIOR TO LOCATING IN THE FIELD.
- WHEN AN UNDERSLAB VAPOR BARRIER OR SIMILAR EXISTS DURING NEW UNDERSLAB WORK, THE NEW UNDERSLAB VAPOR BARRIER OR SIMILAR INTO EXISTING CONDITIONS.

PLAN LEGEND

- AREA NOT IN CONTRACT (N.I.C.)
- EXISTING WALL
- NEW WALL - REFER WALL TYPES SCHEDULE
- EXISTING GLAZING SYSTEM TO REMAIN
- NEW GLAZING SYSTEM - REFER WINDOW ELEVATIONS
- EXISTING DOOR TO REMAIN
- NEW DOOR - REFER DOOR SCHEDULE

WALL TYPE KEY LEGEND

REFER WALL TYPE SHEET (A500) FOR CONSTRUCTION OF NEW WALL ASSEMBLIES.

WALL TAG NOMENCLATURE

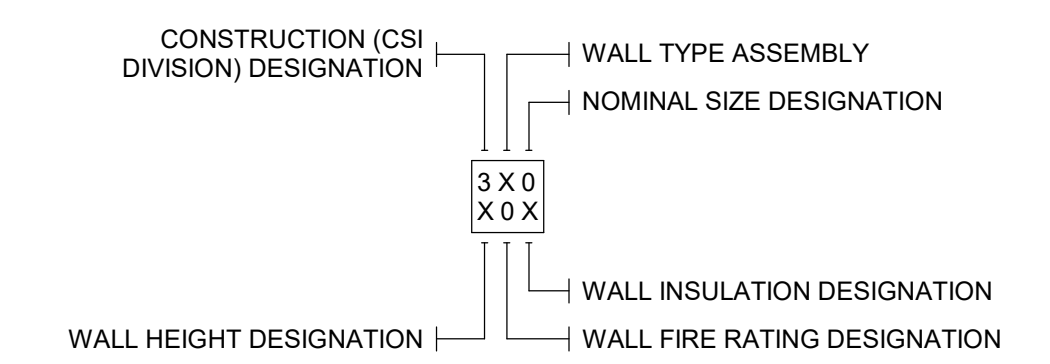

CONSTRUCTION DESIGNATION

- 3XD DIVISION 03 - CONCRETE
- 4XD DIVISION 04 - MASONRY
- 5XD DIVISION 05 - COLD FORMED METAL STUD FRAMING (STRUCTURAL)
- 6XD DIVISION 06 - WOOD STUD FRAMING
- 9XD DIVISION 09 - NON-LOAD BEARING METAL STUD FRAMING

NOMINAL SIZE DESIGNATION

- | CONCRETE | MASONRY |
|----------|--------------------|
| 4 = 4" | 4 = 4" (3-5/8") |
| 6 = 6" | 6 = 6" (5-5/8") |
| 8 = 8" | 8 = 8" (7-5/8") |
| 10 = 10" | 10 = 10" (9-5/8") |
| 12 = 12" | 12 = 12" (11-5/8") |

METAL STUD

- 0 = 7/8" FURRING CHANNEL
- 1 = 1-5/8"
- 2 = 2-1/2"
- 3 = 3-5/8"
- 4 = 4"
- 6 = 6"
- 8 = 8"
- 10 = 10"

WOOD STUD

- 1 = 1x (3/4" x X) FURRING
- 2 = 2x2 (1-1/2" x 1-1/2")
- 3 = 2x3 (1-1/2" x 2-1/2")
- 4 = 2x4 (1-1/2" x 3-1/2")
- 6 = 2x6 (1-1/2" x 5-1/2")
- 8 = 2x8 (1-1/2" x 7-1/4")
- 10 = 2x10 (1-1/2" x 9-1/4")
- 12 = 2x12 (1-1/2" x 11-1/4")

WALL FIRE RATING DESIGNATION

- 0 = NON-RATED ASSEMBLY
- 1 = (1) HOUR FIRE RATED ASSEMBLY
- 2 = (2) HOUR FIRE RATED ASSEMBLY
- 3 = (3) HOUR FIRE RATED ASSEMBLY
- 4 = (4) HOUR FIRE RATED ASSEMBLY

WALL INSULATION DESIGNATION

- = NO INSULATION
- B = BATT INSULATION
- R = RIGID INSULATION
- S = CLOSED CELL SPRAY INSULATION

WALL HEIGHT DESIGNATION

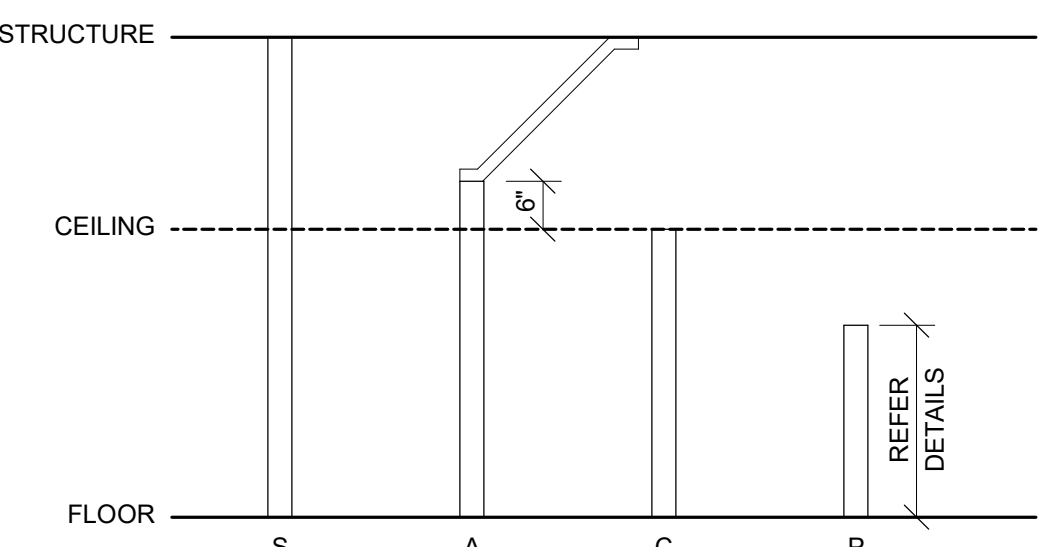

PROLOGIS
**RIVERFRONT INDUSTRIAL PARK -
SPECULATIVE T.I.**
1601 INDUSTRIAL PARKWAY, SUITE 101
PUYALLUP, WA 98371
ISSUED FOR REVIEW

PROLOGIS
3390 WEVERHAUSEL WAY S. SUITE 104
FEDERAL WAY, WA 98001
OVERALL FLOOR PLAN

DATE: 4/7/25
JOB NO.: 25-057

A110.1

TWINSTERS ARCHITECTURE
DENVER | IRVINE | LOS ANGELES | SAN JOSE | SEATTLE
www.twinsters.com | info@twinsters.com
THESE DRAWINGS AND SPECIFICATIONS ARE THE PROPERTY OF TWINSTERS AND SHALL NOT BE USED FOR ANY OTHER WORK EXCEPT BY AGREEMENT WITH TWINSTERS.

PLAN LEGEND

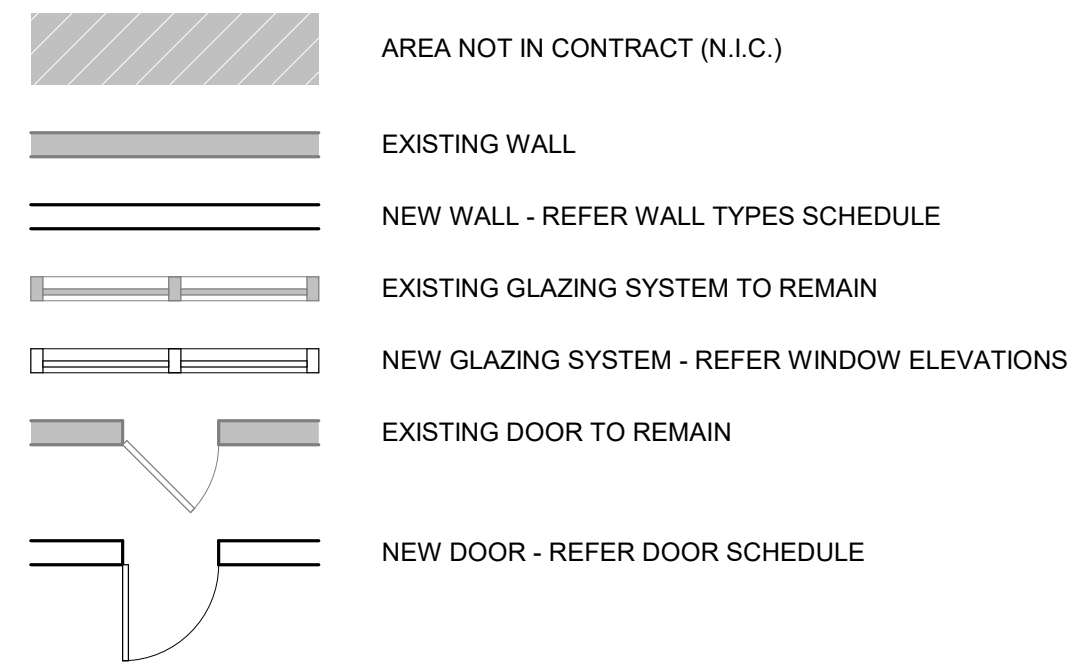

KEYNOTES

FLOOR PLAN NOTES

- ALL DIMENSIONS ARE TO FACE OF STUD, CONCRETE, MASONRY, OR ROUGH OPENING UNLESS OTHERWISE NOTED. FOR EXISTING CONDITIONS, DIMENSION SHALL BE FROM EXISTING FACE OF WALL CONSTRUCTION TO FACE OF STUD, CONCRETE, MASONRY, OR ROUGH OPENING OF NEW WALL.
- WHERE DIMENSIONS ARE NOTED AS "CLEAR", DIMENSIONS SHALL BE THE MINIMUM DIMENSIONS BETWEEN FINAL WALL FINISHES. REFER ANNOTATED PLANS FOR DOOR & WINDOW DESIGNATIONS. REFER DOOR SCHEDULE & WINDOW ELEVATIONS FOR ADDITIONAL INFORMATION.
- EXCEPT WHERE DIRECTED TO PLACE ITEMS OF WORK AT THE APPROXIMATE LOCATION SHOWN, DO NOT SCALE DRAWINGS FOR DIMENSIONAL INFORMATION. ALL ELEMENTS OF THE DRAWINGS MAY NOT BE SHOWN TO EXACT SCALE. ALL DIMENSIONS REQUIRED ARE SHOWN OR MAY BE DERIVED FROM THOSE SHOWN ON THE FLOOR PLANS, DETAIL PLANS, ELEVATIONS, SECTIONS, DETAILS, SCHEDULES, & SPECIFICATIONS. IF DIMENSIONS ARE NOT PRESENT, THE ARCHITECT IS TO BE NOTIFIED SO A CLARIFICATION CAN BE ISSUED.
- PARTITIONS SHALL BE LOCATED AT COLUMN CENTERLINES OR ALIGNED W/ COLUMN FACE UNLESS OTHERWISE NOTED.
- THE OUTSIDE EDGE OF DOOR FRAMES SHALL BE 4" CLEAR FROM THE ADJACENT PERPENDICULAR PARTITION UNLESS OTHERWISE NOTED. DIMENSIONS LOCATING DOORS ARE SET TO OUTSIDE EDGE OF DOOR FRAMES UNLESS OTHERWISE NOTED.
- ALL EXPOSED CORNERS, JOINTS, ETC., OF GYP. BD. WORK SHALL BE FINISHED IN TO LEVEL AS NOTED IN SPECIFICATIONS OR OTHERWISE NOTED ON DRAWINGS.
- WHERE NON-FIRE RATED PARTITIONS INTERSECT FIRE RATED PARTITIONS, THE FIRE RATED ASSEMBLY SHALL REMAIN INTACT & CONTINUOUS.
- DOORS & FRAMES SHALL BE INSTALLED TO PROVIDE MINIMUM ACCESSIBLE CLEARANCES. REFER ACCESSIBILITY DETAILS.
- BATT INSULATION, WHERE PROVIDED, TO BE FULL STUD CAVITY DEPTH & RUN FULL LENGTH OF WALL. BOX HEADERS SHALL BE COMPLETELY FILLED W/ INSULATION WHERE WALL IS DESIGNATED TO BE INSULATED.
- PROVIDE MOLD & MOISTURE RESISTANT GYP. BD. AT ALL WALL LOCATIONS CONTAINING PLUMBING PIPING IN LIEU OF GYP. BD. PROVIDE MINIMUM OF 2" EACH SIDE OF PIPE OR GROUP OF PIPES. TOILET ROOMS TO RECEIVE MOLD & MOISTURE RESISTANT GYP. BD. ON ALL WALLS EXCEPT WHERE WALL TILE IS SCHEDULED.
- CONTRACTOR TO PROVIDE BLOCKING BEHIND ALL CABINETS, COAT HOOKS, TV LOCATIONS AS WELL AS ALL WALL MOUNTED ACCESSORIES, INCLUDING TOILET ROOM ACCESSORIES, TOILET ROOM PARTITIONS, ETC.
- PROVIDE 5/8" GLASS-MAT TILE BACKER BD. IN LIEU OF GYP. BD. AT ALL WALL TILE LOCATIONS. REFER FINISH PLANS & ELEVATIONS FOR TILE LOCATIONS & EXTENTS.
- WHERE NEW WALLS OR FURRING ARE INDICATED TO BE DIMENSIONED OFF OF AN EXISTING WALL, THE NEW WALL SHALL BE STRAIGHT & PLUMB REGARDLESS OF THE CONDITION OF THE EXISTING WALL.
- PARTITIONS MEETING THE BUILDING EXTERIOR SHALL BE CENTERED ON THE CENTERLINE OF WINDOW MULLION UNLESS OTHERWISE NOTED OR DETAILED.
- ANY DIMENSIONS NOTED AS V.I.F. MUST BE CONFIRMED BY THE ARCHITECT BEFORE PROCEEDING W/ CONSTRUCTION.
- FINISH FACE OF MATERIAL OF NEW PARTITIONS SHALL ALIGN ON BOTH SIDES OF THE PARTITION W/ THE FACE OF THE MATERIALS ON EXISTING COLUMNS, WALLS, OR PARTITIONS UNLESS OTHERWISE NOTED.
- WHERE SHOWN, ALL FURNITURE & EQUIPMENT PLANS SHOWN AS DASHED ARE FOR REFERENCE ONLY. REFER PLANS & SPECIFICATIONS FOR ALL BASE CONTRACT FURNITURE TO BE PROVIDED.
- REFER FINISH SHEETS FOR FLOOR FINISH PATTERNS & FLOOR TRANSITION LOCATIONS.
- ALL MECHANICAL, ELECTRICAL, PLUMBING, & AV SYSTEMS SHALL BE CONCEALED WITHIN WALL PARTITIONS OR CEILING CAVITY UNLESS THERE IS EXPOSED STRUCTURE. REFER REFLECTED CEILING PLANS FOR ADDITIONAL INFORMATION.
- REFER DOOR SCHEDULE & WINDOW ELEVATIONS FOR ADDITIONAL INFORMATION.
- PROVIDE ACCESS DOORS IN PARTITIONS AT ALL LOCATIONS REQUIRED. ACCESS DOORS SHALL MAINTAIN FIRE RATING OF WALL. COORDINATE ALL LOCATIONS NOT SHOWN ON DRAWINGS W/ ARCHITECT PRIOR TO LOCATING IN THE FIELD.
- WHEN AN UNDERSLAB VAPOR BARRIER OR SIMILAR EXISTS DURING NEW UNDERSLAB WORK, TIE NEW UNDERSLAB VAPOR BARRIER OR SIMILAR INTO EXISTING CONDITIONS.
- CONTRACTOR SHALL RESTORE EXISTING SURFACES SCHEDULED TO REMAIN THAT ARE AFFECTED BY THE SCOPE OF WORK. CONTRACTOR SHALL SEAL TIGHT ALL NEW PENETRATIONS IN WALLS & FLOOR/CEILING SLABS TO PRESERVE THE REQUIRED FIRE RATING INTEGRITY.

TWIN SISTERS ARCHITECTURE
DENVER | IRVINE | LOS ANGELES | SAN JOSE | SEATTLE
www.twinsistersarch.com | info@twsistersarch.com
THESE DRAWINGS AND SPECIFICATIONS ARE THE PROPERTY OF TWIN SISTERS AND SHALL NOT BE USED FOR ANY OTHER WORK EXCEPT BY AGREEMENT WITH TWIN SISTERS.

PROLOGIS
**RIVERFRONT INDUSTRIAL PARK -
SPECULATIVE T.I.**
1601 INDUSTRIAL PARKWAY, SUITE 101
PUYALLUP, WA 98371
ISSUED FOR REVIEW

WALL TYPE KEY LEGEND

REFER WALL TYPE SHEET (A500) FOR CONSTRUCTION OF NEW WALL ASSEMBLIES.

WALL TAG NOMENCLATURE

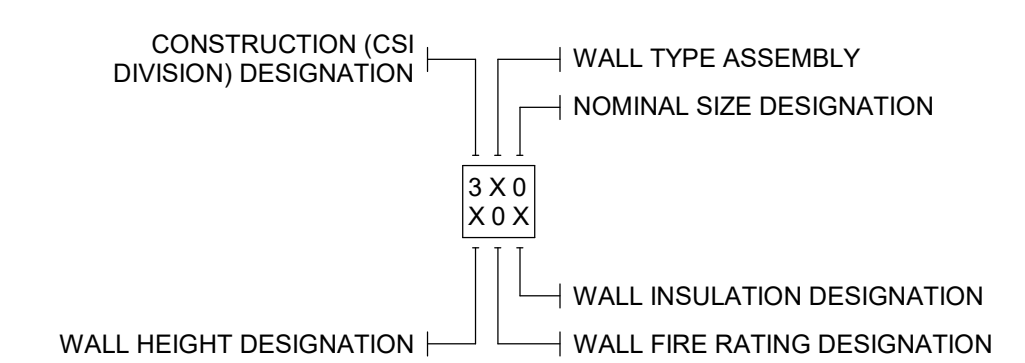

CONSTRUCTION DESIGNATION

3XD	DIVISION 03 - CONCRETE
4XD	DIVISION 04 - MASONRY
5XD	DIVISION 05 - COLD FORMED METAL STUD FRAMING (STRUCTURAL)
6XD	DIVISION 06 - WOOD STUD FRAMING
9XD	DIVISION 09 - NON-LOAD BEARING METAL STUD FRAMING

NOMINAL SIZE DESIGNATION

CONCRETE		MASONRY	
4 = 4"	4 = 4" (3-5/8")	8 = 8"	8 = 8" (5-5/8")
6 = 6"	6 = 6" (5-5/8")	8 = 8"	8 = 8" (7-5/8")
10 = 10"	10 = 10" (9-5/8")	12 = 12"	12 = 12" (11-5/8")

METAL STUD		WOOD STUD	
0 = 7/8" FURRING CHANNEL	1 = 1x (3/4" x X) FURRING	1 = 1x (3/4" x X) FURRING	1 = 1x (3/4" x X) FURRING
1 = 1-5/8"	2 = 2x2 (1-1/2" x 1-1/2")	2 = 2x2 (1-1/2" x 1-1/2")	2 = 2x2 (1-1/2" x 1-1/2")
2 = 2-1/2"	3 = 2x3 (1-1/2" x 2-1/2")	3 = 2x3 (1-1/2" x 2-1/2")	3 = 2x3 (1-1/2" x 2-1/2")
3 = 3-5/8"	4 = 2x4 (1-1/2" x 3-1/2")	4 = 2x4 (1-1/2" x 3-1/2")	4 = 2x4 (1-1/2" x 3-1/2")
4 = 4"	6 = 2x6 (1-1/2" x 5-1/2")	6 = 2x6 (1-1/2" x 5-1/2")	6 = 2x6 (1-1/2" x 5-1/2")
6 = 6"	8 = 2x8 (2" x 7-1/4")	8 = 2x8 (2" x 7-1/4")	8 = 2x8 (2" x 7-1/4")
8 = 8"	10 = 2x10 (1-1/2" x 9-1/4")	10 = 2x10 (1-1/2" x 9-1/4")	10 = 2x10 (1-1/2" x 9-1/4")
10 = 10"	12 = 2x12 (1-1/2" x 11-1/4")	12 = 2x12 (1-1/2" x 11-1/4")	12 = 2x12 (1-1/2" x 11-1/4")

WALL FIRE RATING DESIGNATION

0 = NON-RATED ASSEMBLY	1 = (1) HOUR FIRE RATED ASSEMBLY	2 = (2) HOUR FIRE RATED ASSEMBLY	3 = (3) HOUR FIRE RATED ASSEMBLY	4 = (4) HOUR FIRE RATED ASSEMBLY
------------------------	----------------------------------	----------------------------------	----------------------------------	----------------------------------

WALL INSULATION DESIGNATION

- = NO INSULATION	B = BATT INSULATION	R = RIGID INSULATION	S = CLOSED CELL SPRAY INSULATION
-------------------	---------------------	----------------------	----------------------------------

WALL HEIGHT DESIGNATION

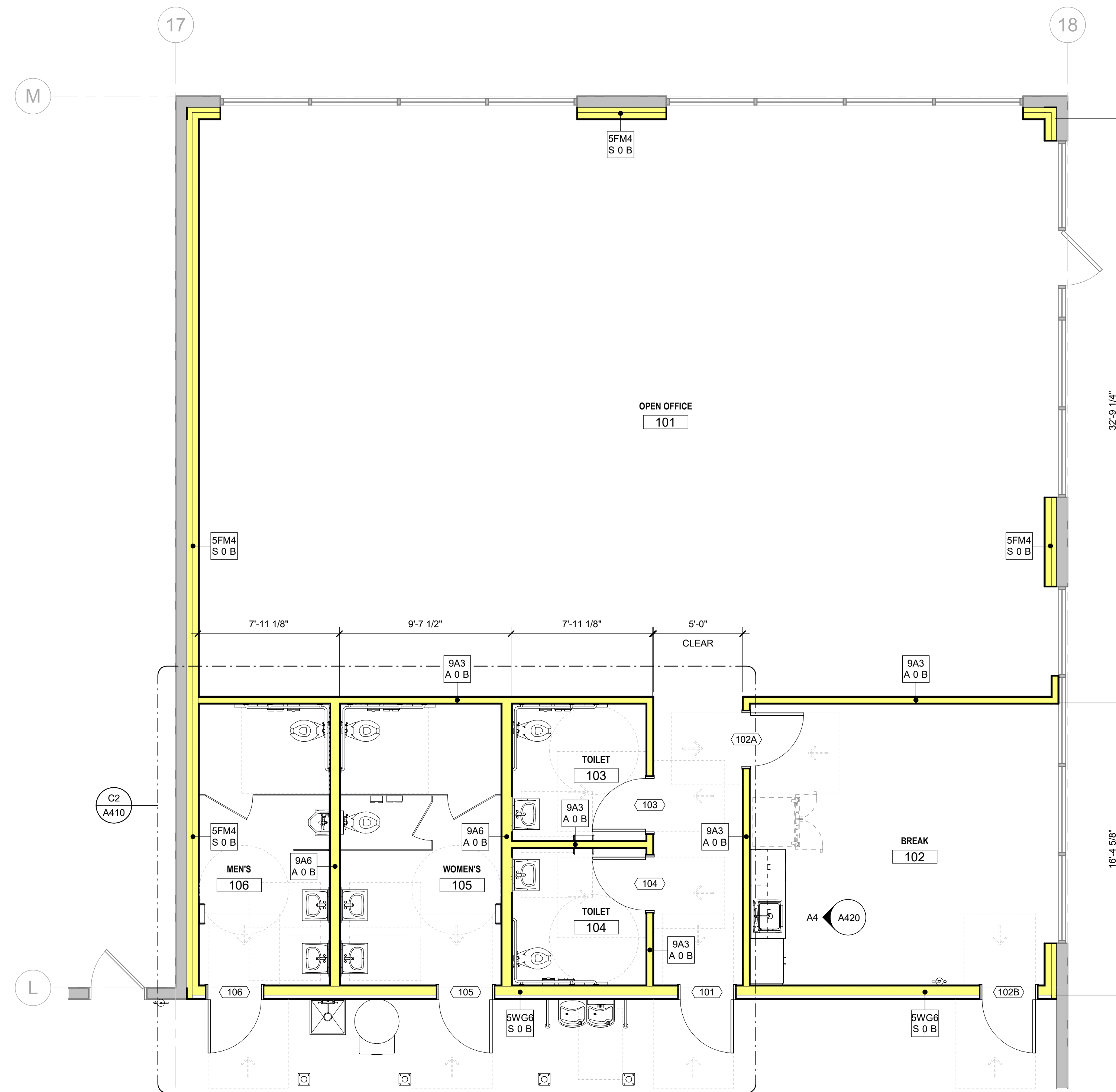
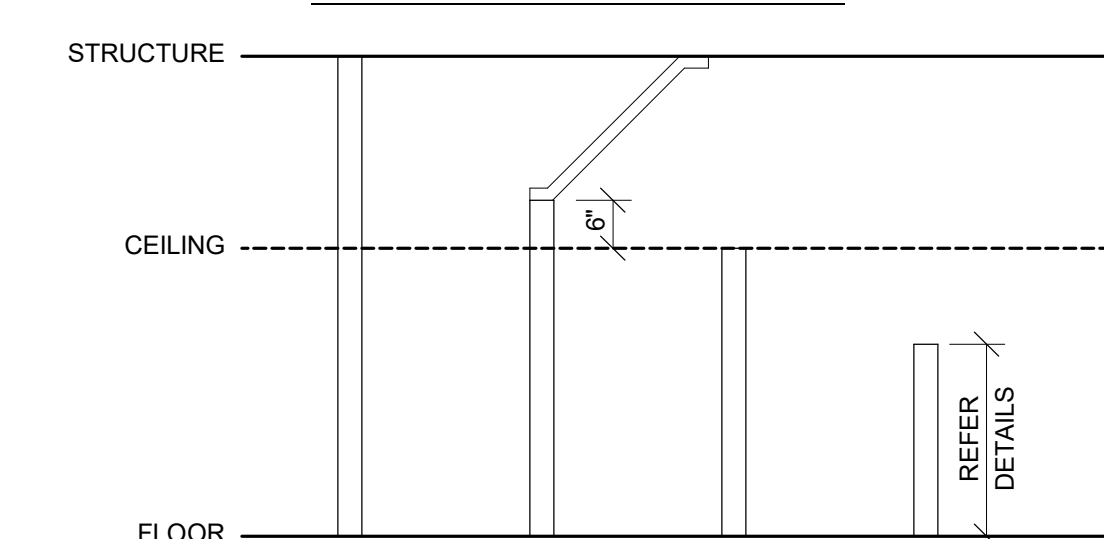

A4 OFFICE FLOOR PLAN

SCALE: 1/4" = 1'-0"

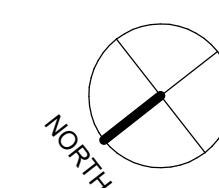

REMARKS

DATE

REV

PROLOGIS
3390 WEVERHAUSER WAY S. SUITE 104
FEDERAL WAY, WA 98001

OFFICE - FLOOR PLAN

DATE: 4/7/25

JOB NO.: 25-057

A111.1

4/20/25 9:11:33 AM