

City of Puyallup Traffic Scoping Worksheet

PROJECT INFORMATION

Project Title: Planet Fitness, Puyallup, WA Date: 10/02/2025

Applicant Name: Shaun Andriano Telephone Number: 518.320.8250

Project Description: Tenant Fit-Up in Existing Building Year of Occupancy: 2025

Project Location: 4102 S Meridian, Puyallup, WA 98373 Parcel Size: 5.3 Acres

Proposed Number of Access Point(s): 0 Existing Number of Access Point(s): 7

Land Use	Quantity	ITE Land Use Code	Average Daily Trips	AM Peak Hour Trips*	PM Peak Hour Trips*
Existing Use(s) <small>Because of limited LUC 872 data, trips were estimated using an average of LUC 890 and LUC 876 data (50/50 split), as agreed to in an August 25, 2025 email from Bryan Roberts)</small>					
Bed/Linen Superstore	9.9 kSF	LUC 876	657	10	57
	9.9 kSF	LUC 890	63	4	6
Proposed Use(s)					
Health/Fitness Club	19.8 kSF	LUC 492	594	35	75
Net New Trips			-126	+21	+12
Traffic Impact Fees: Net New PM Peak Hour Trips x \$4,500.00 = \$ <u>54,000.00</u>					

- * The peak hour project trips shall be rounded to the nearest tenth.
- * The project trips shall be estimated using the ITE's *Trip Generation*, ~~11th Edition~~. Data from newly released (August 18, 2025) 12th edition was used for trip estimation.
- * Trip generation regression equations shall be used when the R² value is 0.70 or greater.
- * For land uses that do not exist within the ITE's *Trip Generation*, actual field data shall be collected from three local facilities that have similar characteristics to the proposal.
- * For all single-family units and offices and specialty retail centers smaller than 30,000 SF, use ITE's *Trip Generation*, 11th Edition, average rate.

Identify all intersections that will be affected by 25 new project peak hour trips or more:

- | | |
|----------------|----------|
| 1. <u>None</u> | 4. _____ |
| 2. _____ | 5. _____ |
| 3. _____ | 6. _____ |
| 4. _____ | 8. _____ |

Prepared by: Traffic Engineer: Michael Wieszchowski
PE, PTOE Telephone Number: (518) 898-9554

Address: Greenman-Pedersen, Inc, 80 Wolf Rd, Suite 600, Albany, NY 12205

Office Use Only

TIS TAS TAIS No Further Work Required

Checklist (Please make sure you have included the following information):

Completed Worksheet Attach Site Plan Attach Trip Assignment Attach Trip Distribution

Mail or hand deliver to 333 South Meridian, Puyallup, WA 98371 or e-mail to broberts@puyallupwa.gov



Planet Fitness

South Meridian, Pulallup, WA 98373



24 Airport Road | Schenectady, NY 12302 | T: 518.320.8250

R:\2024\Projects\2400-15 PF Puyallup, WA (CDM)\Drawings\Revit\Central Model\2025-04-04 PF Puyallup (Central Model).rvt
4/16/2025 2:21:09 AM

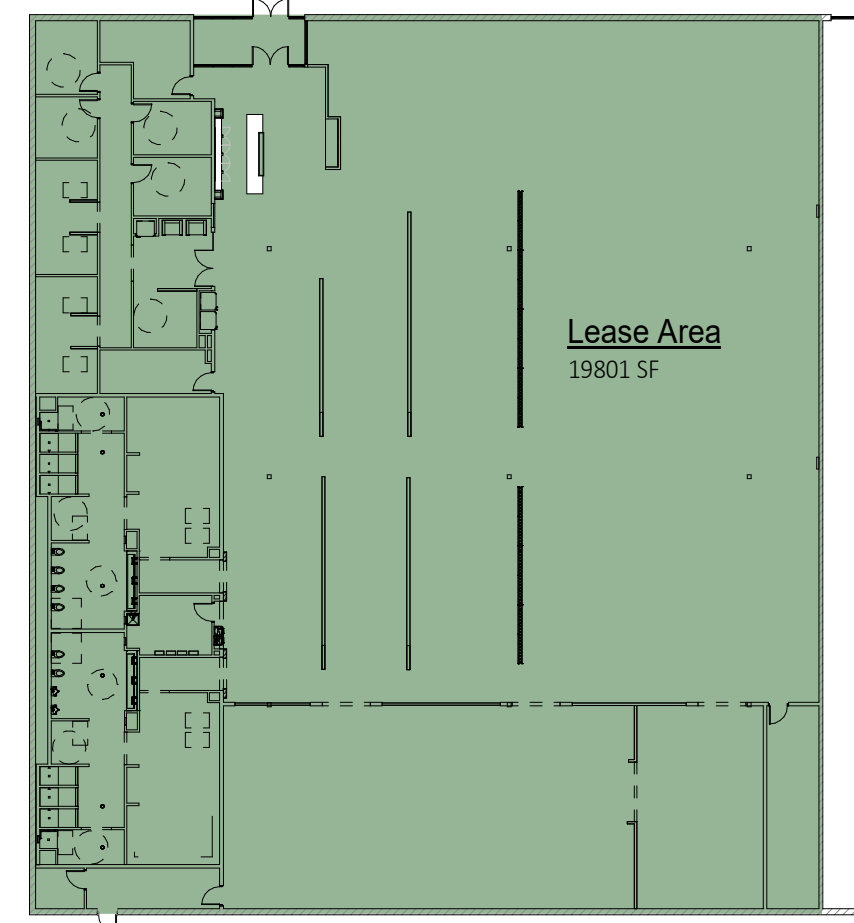

3 Lease Area Plan
SCALE: 1/32" = 1'-0"

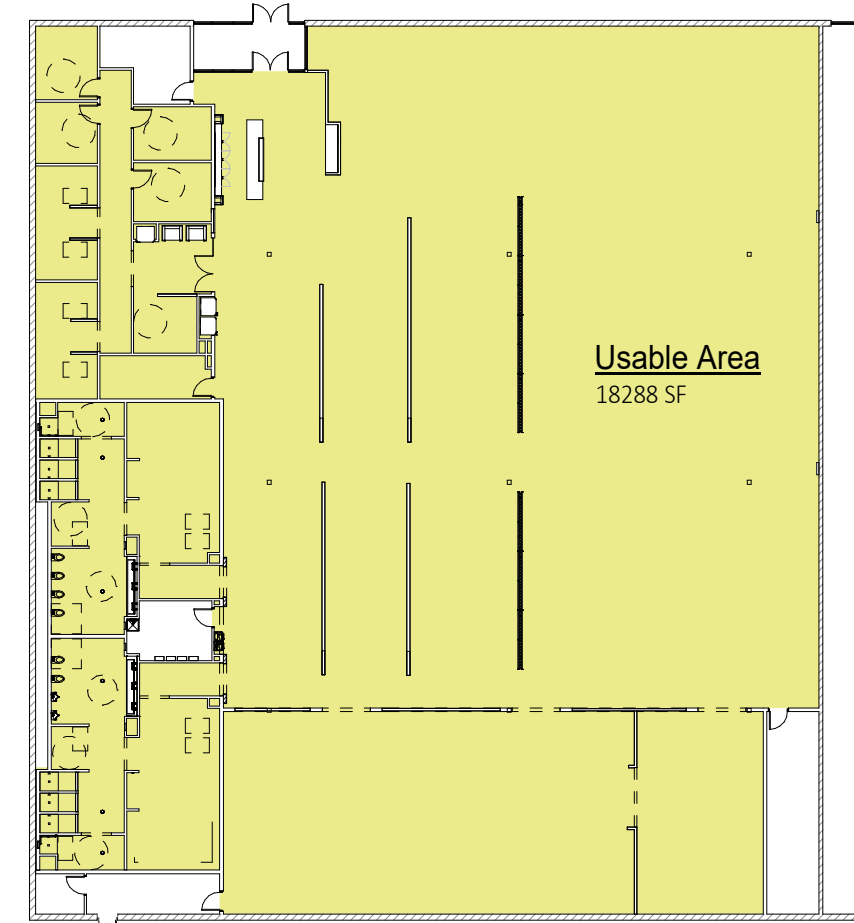

2 Usable Area Plan
SCALE: 1/32" = 1'-0"

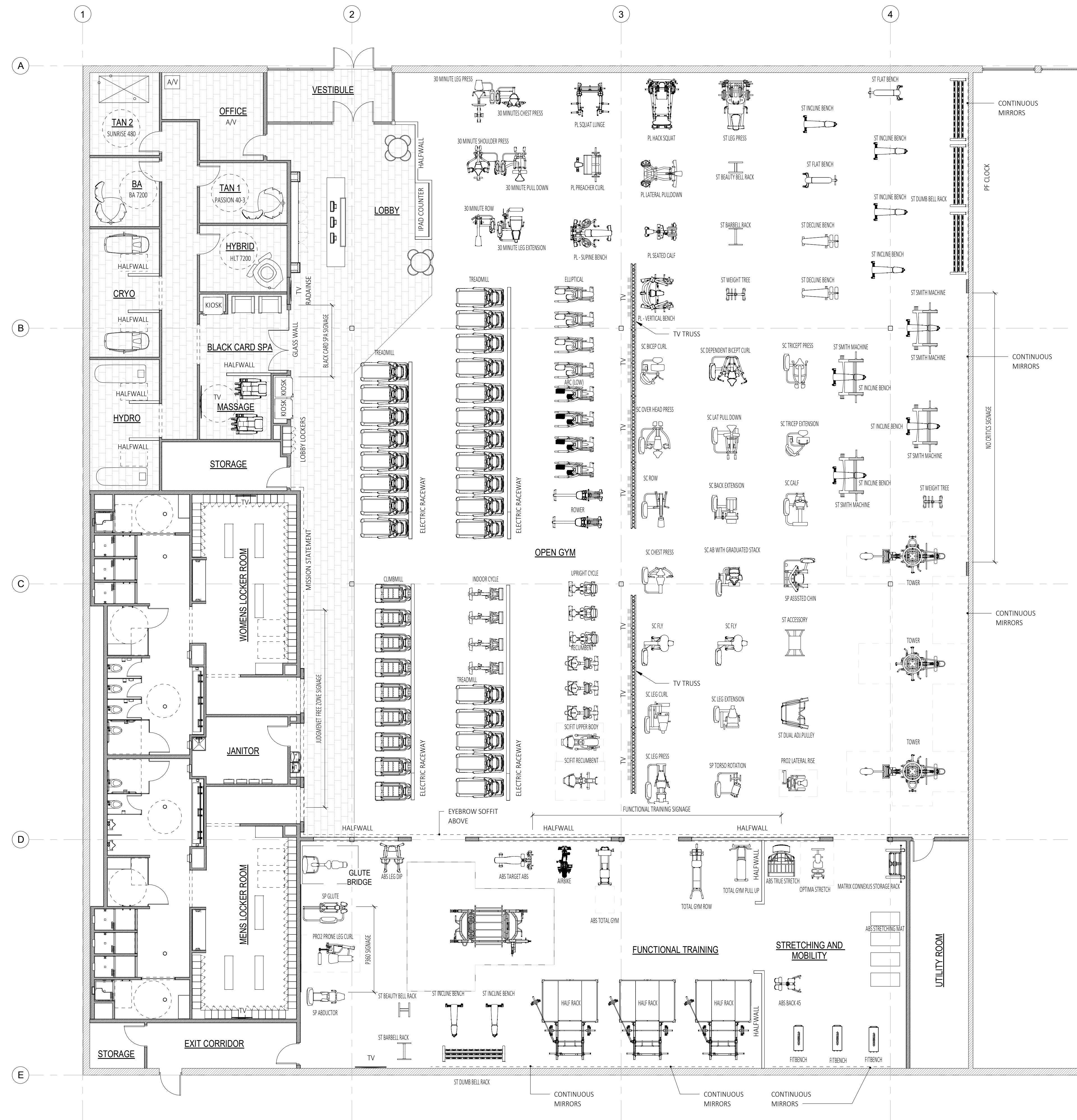

1 Schematic Floor Plan
SCALE: 1/8" = 1'-0"

Seal / Signature

△ Date Description

CONCEPT PLAN
04/08/2025

Project Name
PF Puyallup

Project Number
2400-15

Description
SCHEMATIC PLAN

Scale
As indicated

A-001