

Address 1601 Industrial PKWY Puyallup, Wa

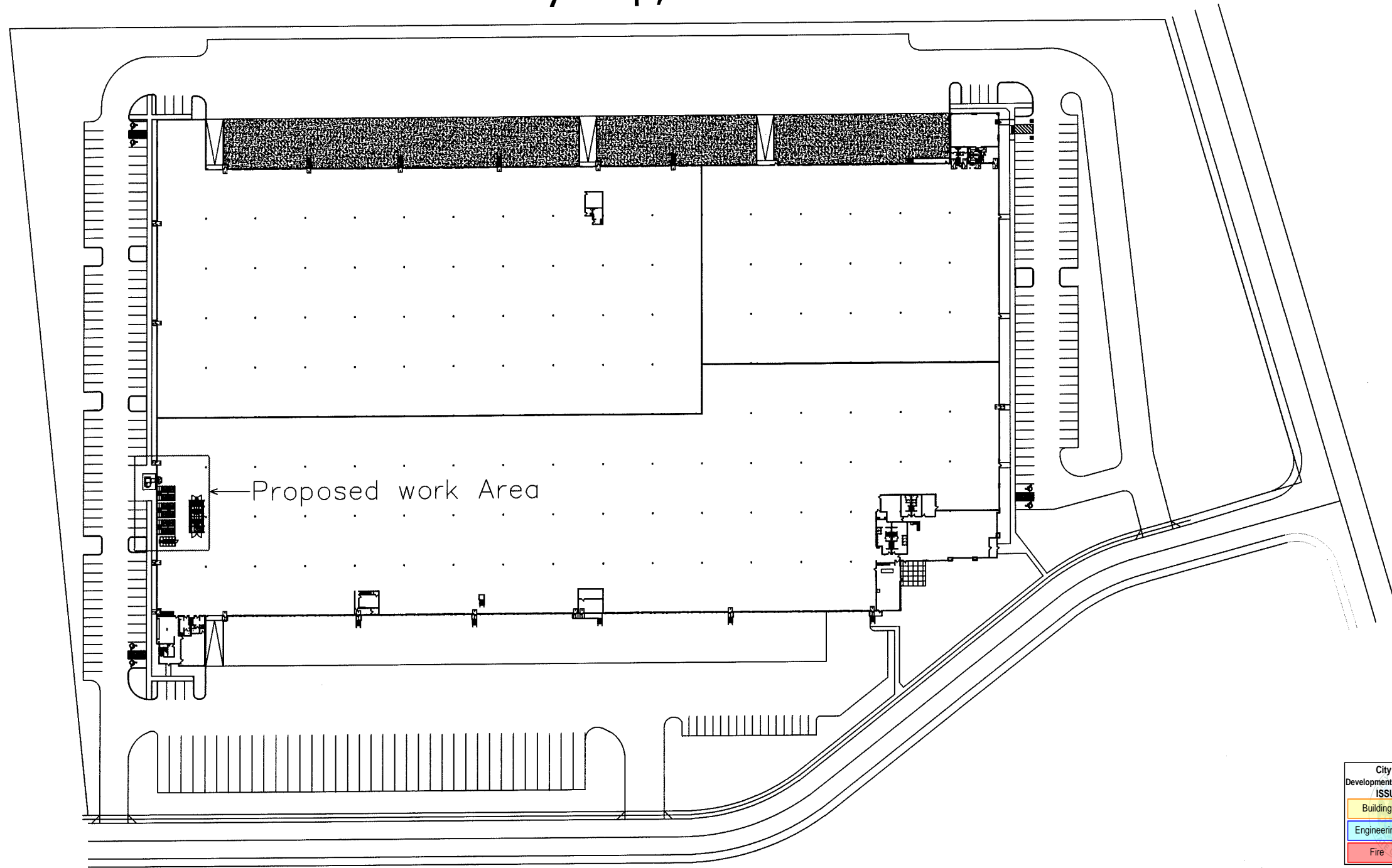

Index	
A1- Code Summary, General Notes, Site Plan	
Section #2 Egress Plans, Details	
Section #3 Engineering Documents and Drawings	
Section #4 Cut Sheets	

Scope of Work	
Installation of Pre-Fabricated , Spray Booths, Mix Room and Drying Enclosure	
No Change of Occupancy proposed, No alteration of columns or structure proposed, No alteration of any spaces outside of work area proposed, No seismic alterations proposed, No ADA upgrade proposed, No alteration of plumbing proposed.	

Code Compliance information	
Installation of Pre-Fabricated , Spray Booths, Mix Room, Air Make-up and Drying Enclosure	
Stories-1	
Building total Sq Ft - 385,000	
Tenant Space Sq Ft- 182,162	
Construction Type-III-B (Sprinkled)	
Occupancy Rating- S1,B & F-1	
Basement - No	
Sprinklers - Yes	
Fire Monitoring - Yes	
Natural Gas - Yes	
Separate Permits/Deferred Submittal	
1) Electrical- Crown Range Electric Com LLC RANGEEC793D	
1) Fire Suppression Crown Fire INC CROWNFP044LL	
2) Fire Alarm Patriot Fire PATRIFP8370Q	
3) Roof Penetrations Reference Permit #PRCTI20251201	
4) Natural Gas Piping Diamond Construction DIAMOC856J2	
Proposed Use: Industrial/Factory	

General Notes	
1)	Drawing on this page is for reference only, Contractor to visit and verify all dimensions and conditions on site. Any discrepancies reported to the design professional (Advanced Finishing Systems, Global Finishing or Shutter Consulting Engineers)
2)	No change to existing Grade proposed, No exterior alteration proposed, No ground disturbance proposed

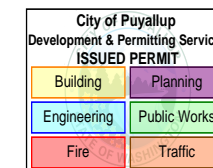

City of Puyallup
Building
REVIEWED FOR COMPLIANCE
BSnowden
12/03/2025
11:59:14 AM



City of Puyallup
Planning
Division
APPROVED
See permit conditions.
JHulseLew
12/19/2025
2:30:55 PM

The approved construction plans, documents, and all engineering must be posted on the job at all inspections in a visible and readily accessible location.

Full sized legible color plans are required to be provided by the permittee on site for inspection.

Approval of submitted plans is not an approval of omissions or oversights by this office or non compliance with any applicable regulations of local government. The contractor is responsible for making sure that the building complies with all applicable codes and regulations of the local government.

PRCTI20251520

ADVANCED FINISHING SYSTEMS
 2304 N. Killingsworth Portland, OR 97217 (503)285-4559 888-285-0330
 25 SW 4th Street Renton WA 98055 (425)856-0606 888-656-0606

TITLE
Code Entry Systems

COMPANY: Codel
 SCALE: NTS
 REV.#: # 1 OF 10
 DATE: 10/01/2025
 DRAWN BY: Ron Myers!
 JOB #: 8205
 DWG NO.: 01

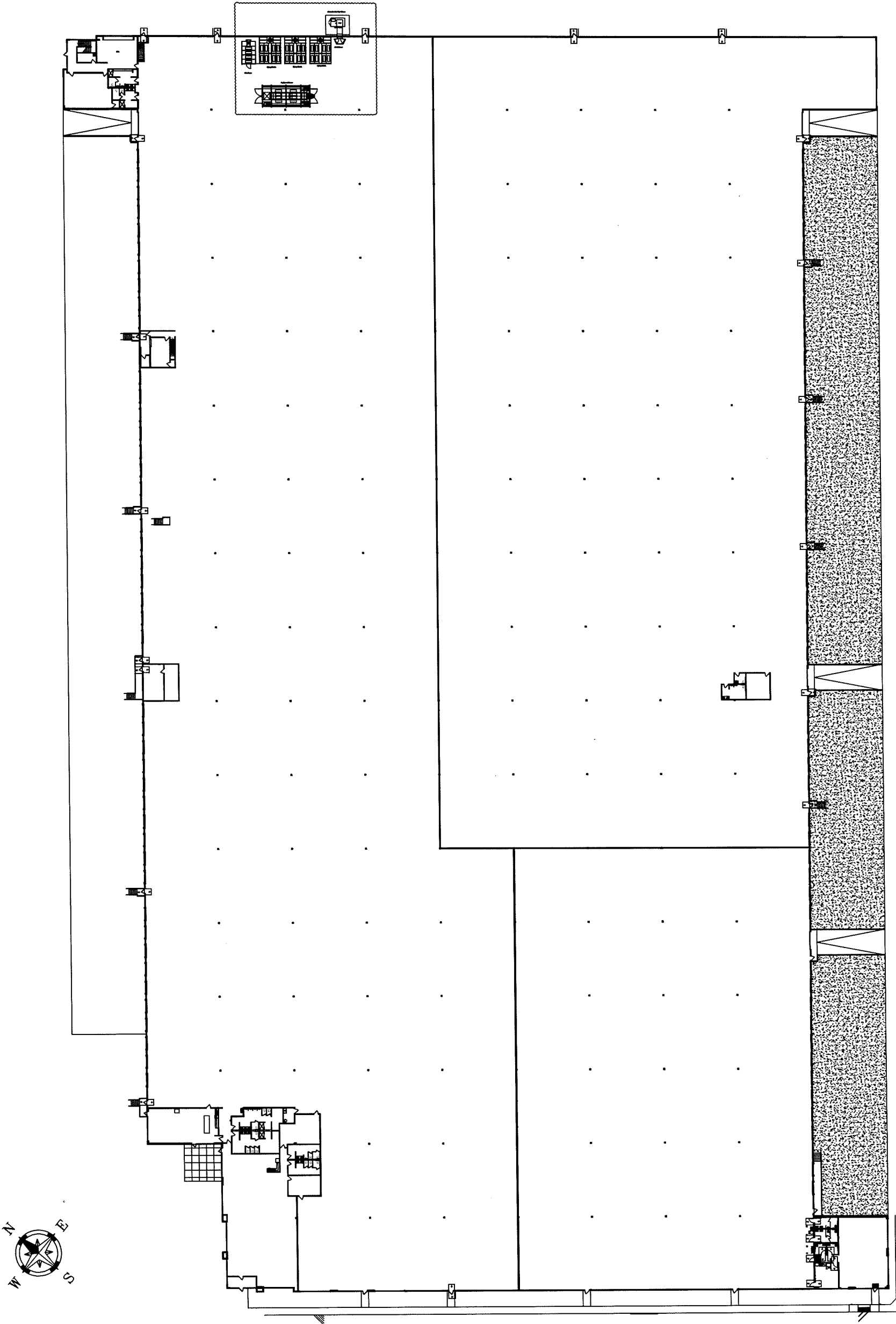

PRCTI20251520



**ADVANCED FINISHING
SYSTEMS**

2304 N. Killingsworth
Portland OR 97217
(503)285-0569
888-285-0330

235 SW 41st Street
Renton WA 98055
(425)656-0606
888-656-0606

TITLE

Codel Entry Systems

THIS DRAWING IS THE PROPERTY OF ADVANCED FINISHING SYSTEMS, INC. PROPERTY. IT CONTAINS PROPRIETARY INFORMATION AND MUST BE RETURNED UPON REQUEST. DO NOT CIRCULATE, REPRODUCE OR DUPLICATE TO OTHER PARTIES WITHOUT CONSENT OF A.F.S.

COMPANY	Codell	DATE:	10/01/2025
REV.#	SCALE: NTS	DRAWN BY: <i>Ron Myers!</i>	
#	# 8 OF 10	JOB #: 756S	
DWG NO.	08		



City of Puyallup Development & Permitting Services ISSUED PERMIT	
Building	Planning
Engineering	Public Works
Fire	Traffic

COMPANY	Codel	DATE	10/01/2025
REV. #	1/8"=1'	DRAWN BY	Ron Myers
#	# 8 OF 10	JOB #	7565
		DWG. NO.	08

See United Structural for
Seismic Anchoring Detail

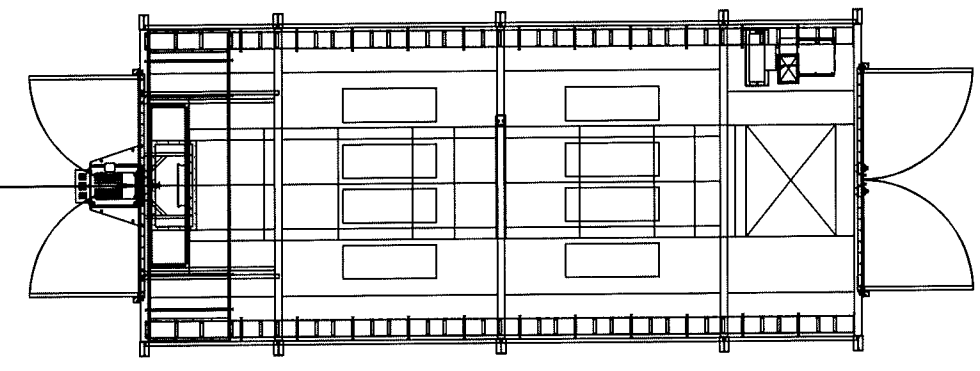

Drying Enclosure

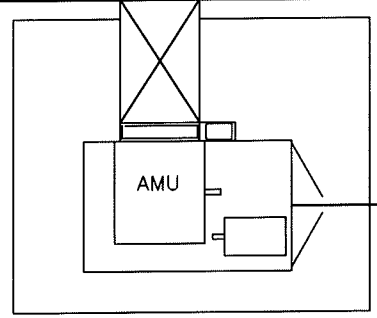
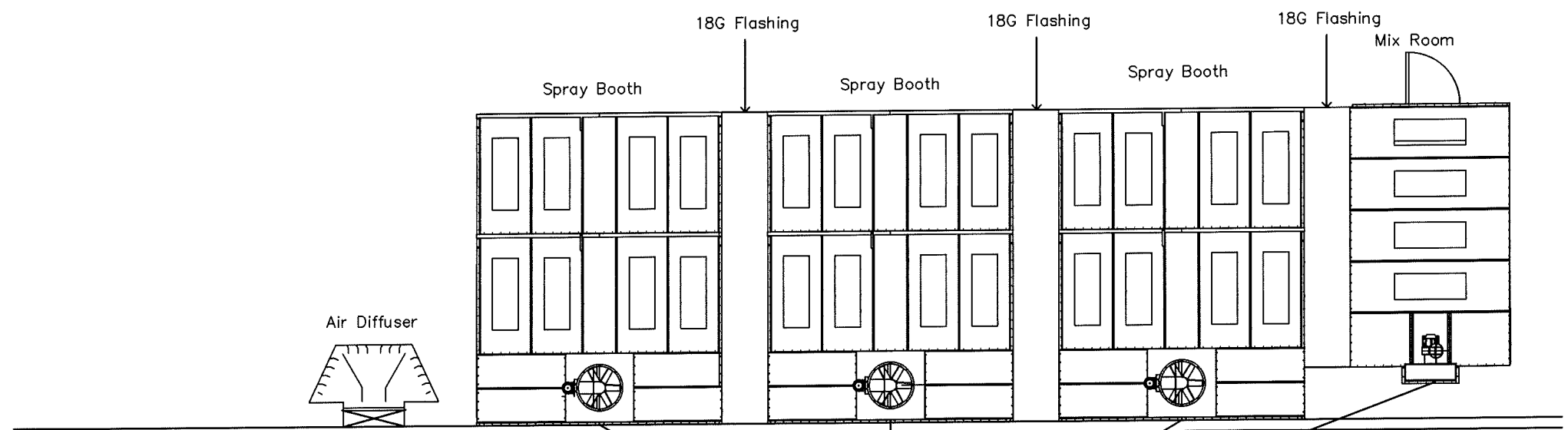

Concrete Pad By Others

Concrete Exterior Wall

See United Structural for
Seismic Anchoring Detail

TITLE

**ADVANCED FINISHING
SYSTEMS**

2304 N. Villagesworth
Portland, OR 97217
(503) 285-6569
888-265-0320

235 SW 41st Street
Renton, WA 98025
(425) 656-0606
888-656-0606

Codel Entry Systems

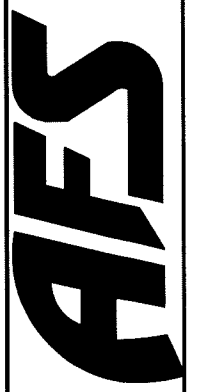

See Seismic Duct Bracing from Shutler Consulting engineers

City of Puyallup Development & Permitting Services ISSUED PERMIT	
Building	Planning
Engineering	Public Works
Fire	Traffic

THIS DRAWING IS THE PROPERTY OF ADVANCED FINISHING SYSTEMS, INC. IT IS TO BE USED ONLY FOR THE PROJECT AND SITE SPECIFICALLY IDENTIFIED HEREON. ANY REUSE OR ADAPTATION TO OTHER PROJECTS WITHOUT CONSENT OF AFS.

COMPANY	Hormann Door	DATE	09/08/25
REV.#	NTS	SCALE	NTS
#	5	OF	11
DWG. NO.	05	DRAWN BY	Ron Myers!
		JOB #	7565

TITLE
Code Entry Systems

ADVANCED FINISHING SYSTEMS
7204 N. Villaview
Bellevue, WA 98003
206-285-0330



PRCT120251520

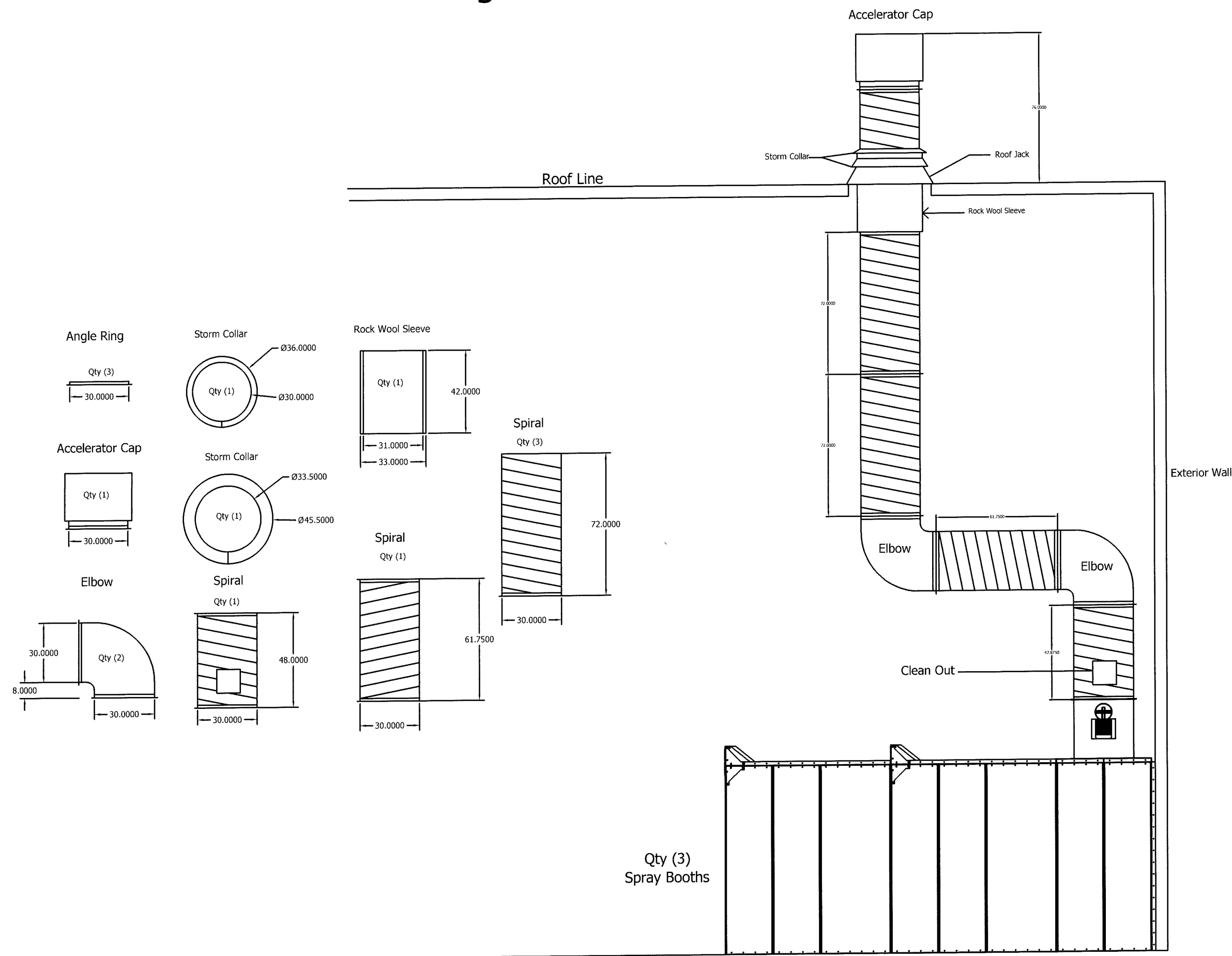

Angle Ring

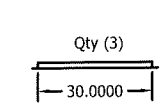

Accelerator Cap

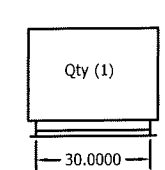

Elbow

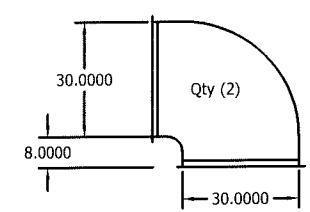

Storm Collar

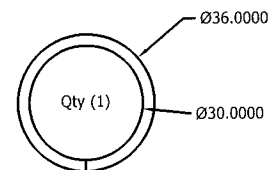

Storm Collar

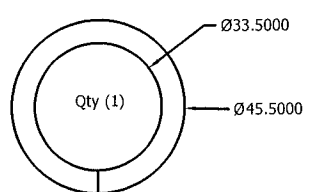

Spiral

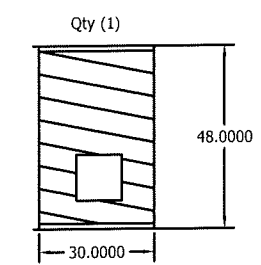

Rock Wool Sleeve

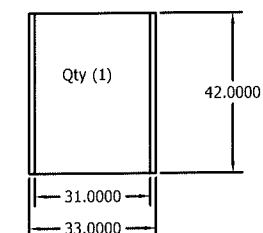

Spiral

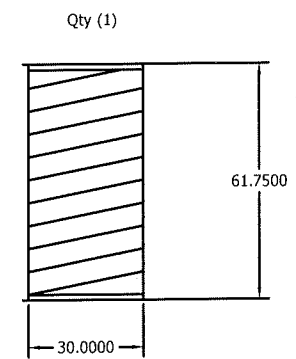

Spiral

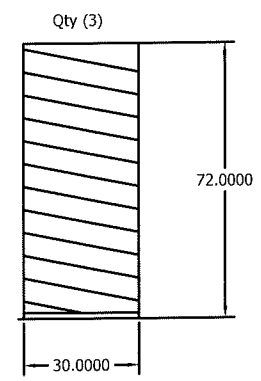

See Seismic Duct Bracing from Shutler Consulting engineers

City of Puyallup Development & Permitting Services ISSUED PERMIT	
Building	Planning
Engineering	Public Works
Fire	Traffic

PROPERTY CONTAINS ADVANCED FINISHING SYSTEMS PERMITTING SERVICES CALCULATE, APPROVE OR DENY TO OTHER PERMIT WITHOUT CONSENT OF A.F.S.	
COMPANY	Hormann Door DATE: 09/08/25
REV.#	SCALE: NTS
#	# 5 OF 11
	JOB # 7565
	DWG NO. 05

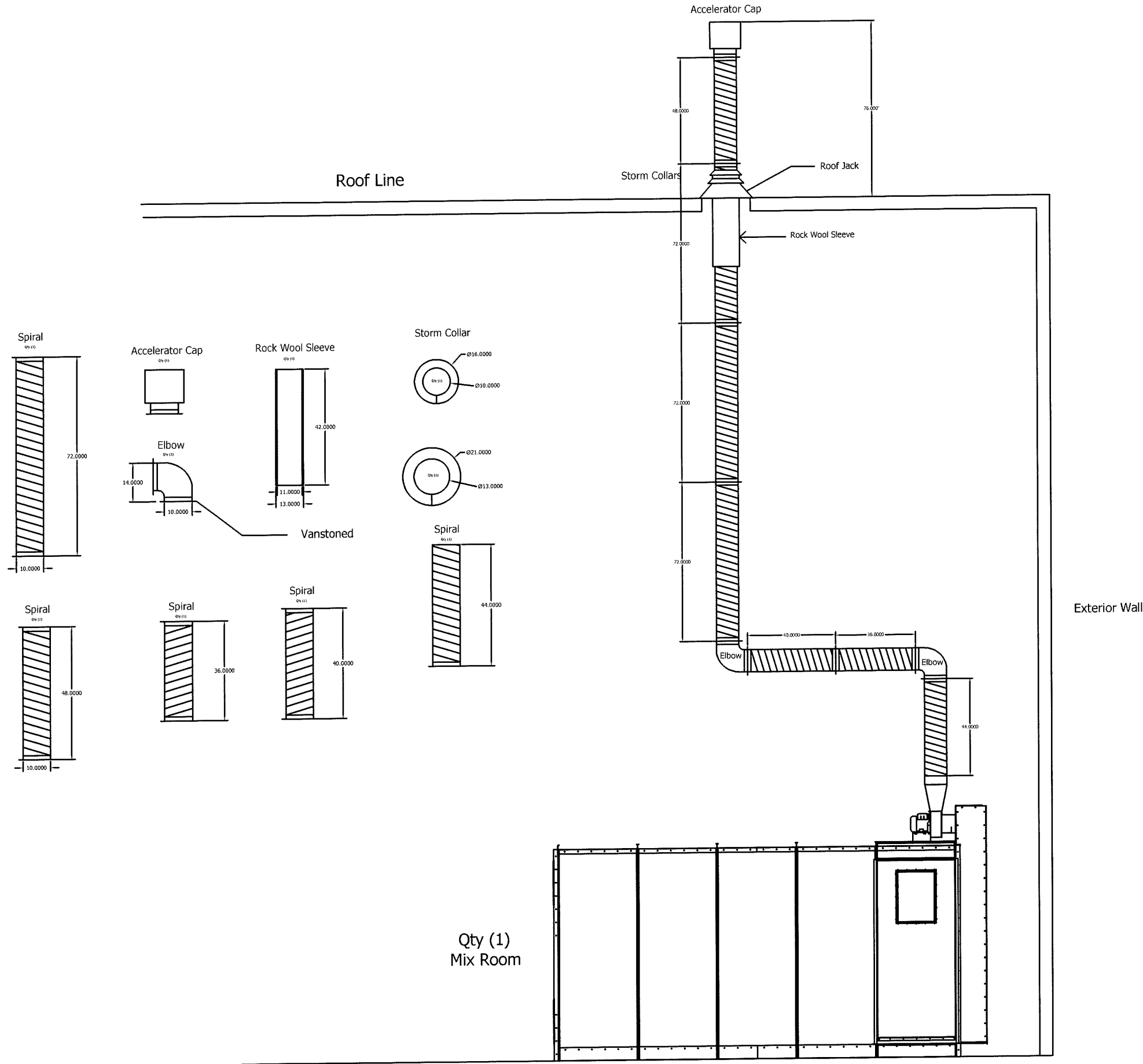

TITLE

Code Entry Systems

ADVANCED FINISHING SYSTEMS

7304 N. Killenworth
Puyallup, WA 98721
(206) 835-6665
888-225-6330

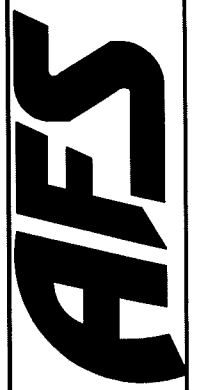

PRCTI20251520

Dry Enclosure

City of Puyallup Development & Permitting Services ISSUED PERMIT	
Building	Planning
Engineering	Public Works
Fire	Traffic

THIS DRAWING IS THE PROPERTY OF ADVANCED FINISHING SYSTEMS, INC. NO PARTS OF THIS DRAWING ARE TO BE REPRODUCED OR TRANSMITTED IN ANY FORM OR BY ANY MEANS, ELECTRONIC OR MECHANICAL, WITHOUT THE WRITTEN PERMISSION OF ADVANCED FINISHING SYSTEMS, INC.

COMPANY: **Hormann Door** DATE: 09/08/25
 SCALE: NTS DRAWN BY: Ron Myers!
 REV.# # JOB # 7565
 # 5 OF 11
 DWG. NO. 05

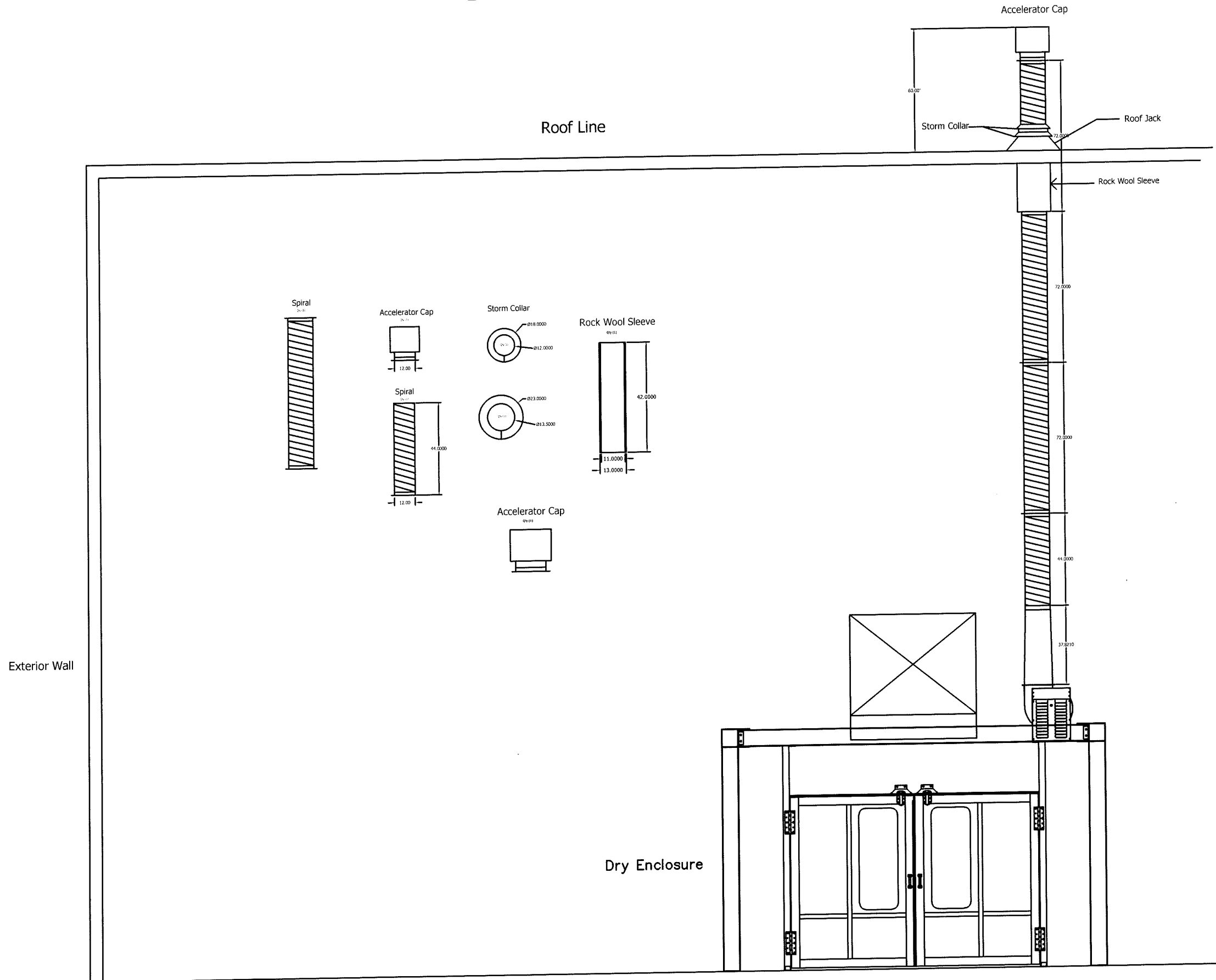

TITLE
Code Entry Systems

ADVANCED FINISHING SYSTEMS
 2304 N. Killingsworth
 Portland OR 97217
 (503) 285-4559
 888-265-0330

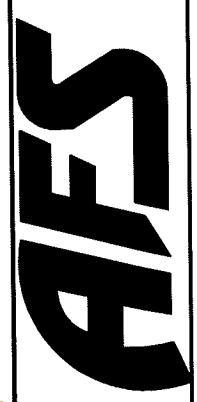

PRCT120251520

Air Make-Up Duct Detail

City of Puyallup Development & Permitting Services ISSUED PERMIT	
Building	Planning
Engineering	Public Works
Fire	Traffic

PROPERTY: IT CONTAINS UNLAWFUL INFORMATION AND MUST BE RETURNED UPON REQUEST. DO NOT CIRCULATE, REPRODUCE OR DISSEMINATE TO OTHER PARTIES WITHOUT CONSENT OF P.E.S.	
COMPANY	Hormann Door DATE: 09/08/25
REV. #	SCALE: NTS
#	# 5 OF 11
	DRAWN BY: Ron Myers
	JOB #:
	7565
	DWG. NO. 05

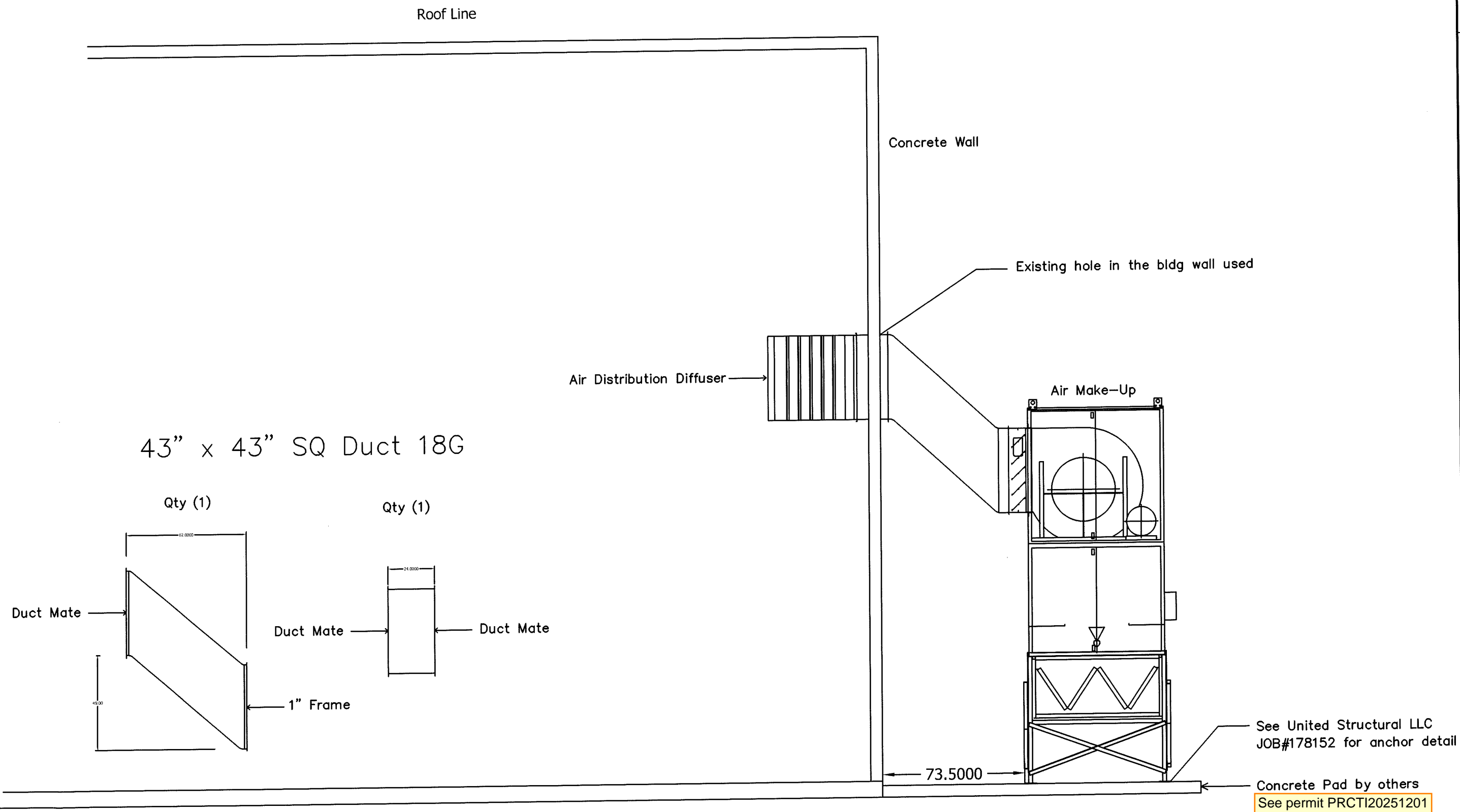

43" x 43" SQ Duct 18G

Qty (1)

Qty (1)

Duct Mate

Duct Mate

Duct Mate

1" Frame

See United Structural LLC
JOB#178152 for anchor detail

Concrete Pad by others
See permit PRCTI20251201

PRCTI20251520

TITLE
Code Entry Systems

ADVANCED FINISHING
SYSTEMS

AFS

2304 N. Williams
Puyallup, WA 98717
(206) 835-4569
888-285-0330

Paint Booth Exhaust Duct

City of Puyallup Development & Permitting Services ISSUED PERMIT	
Building	Planning
Engineering	Public Works
Fire	Traffic

THIS DRAWING IS AN UNLESS OTHERWISE SPECIFIED, THE PROPERTY, IT CONTAINS
PROCEEDING INFORMATION AND NOT BE REPRODUCED, REPRINTED, COPIED, OR
CIRCULATE, REPRODUCE OR DAMAGE TO OTHER PARTS WITHOUT CONSENT OF A.E.S.

DATE: 09/09/2025
DRAWN BY: Ron Myers!
JOB #: 7565

COMPANY: **Hormann Door**
SCALE: NTS
REV. # # 7 OF 11
DWG. NO. 07

TITLE: **Codel Entry Systems**

ADVANCED FINISHING SYSTEMS
2304 N. Killingsworth
Portland, OR 97217
(503) 985-0569
888-285-0330

235 SW 41st Street
Renton, WA 98055
(425) 855-0606
888-656-6066

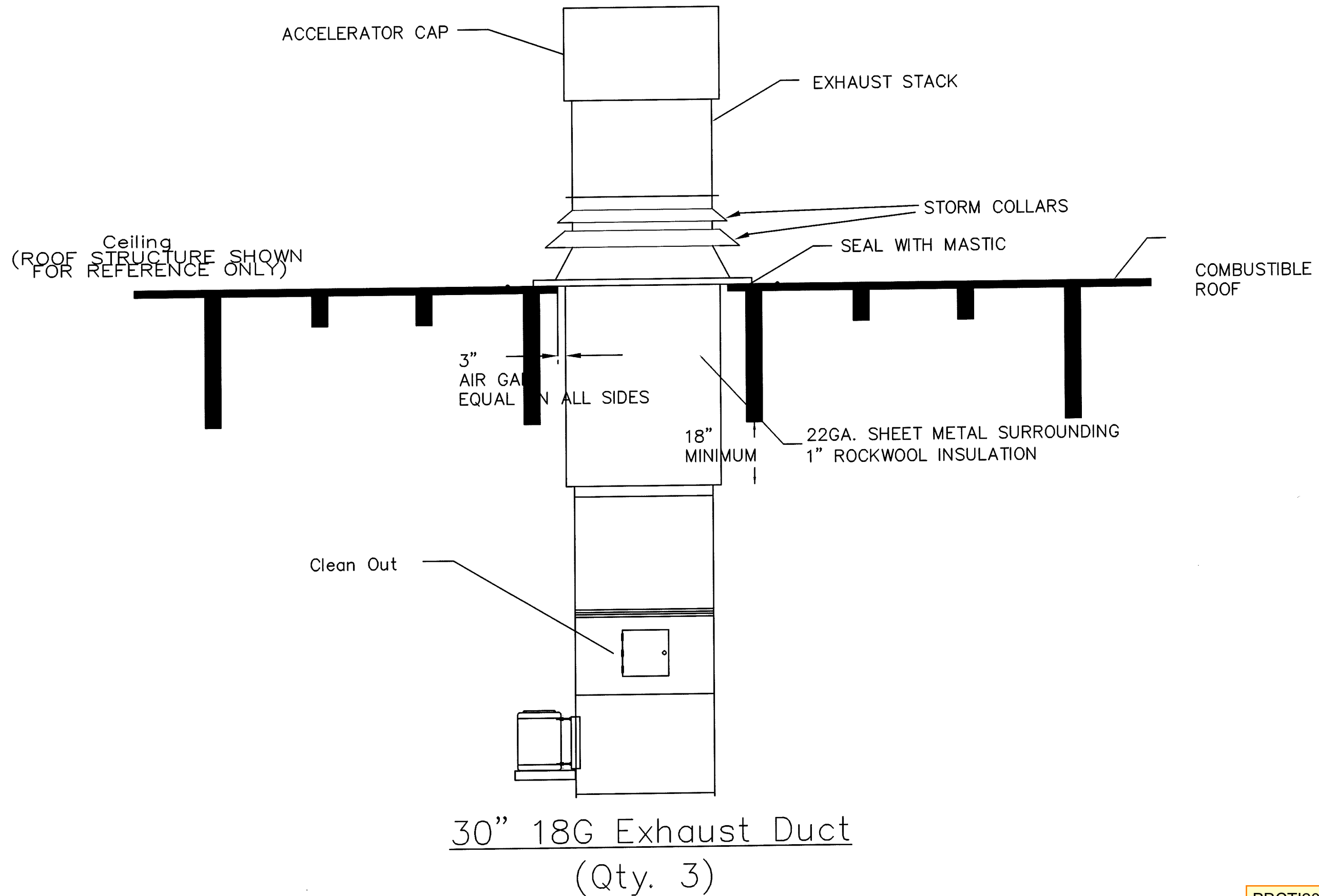

PRCTI20251520

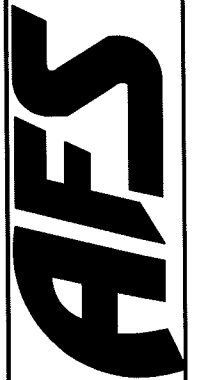

Mix Room Exhaust Duct Detail

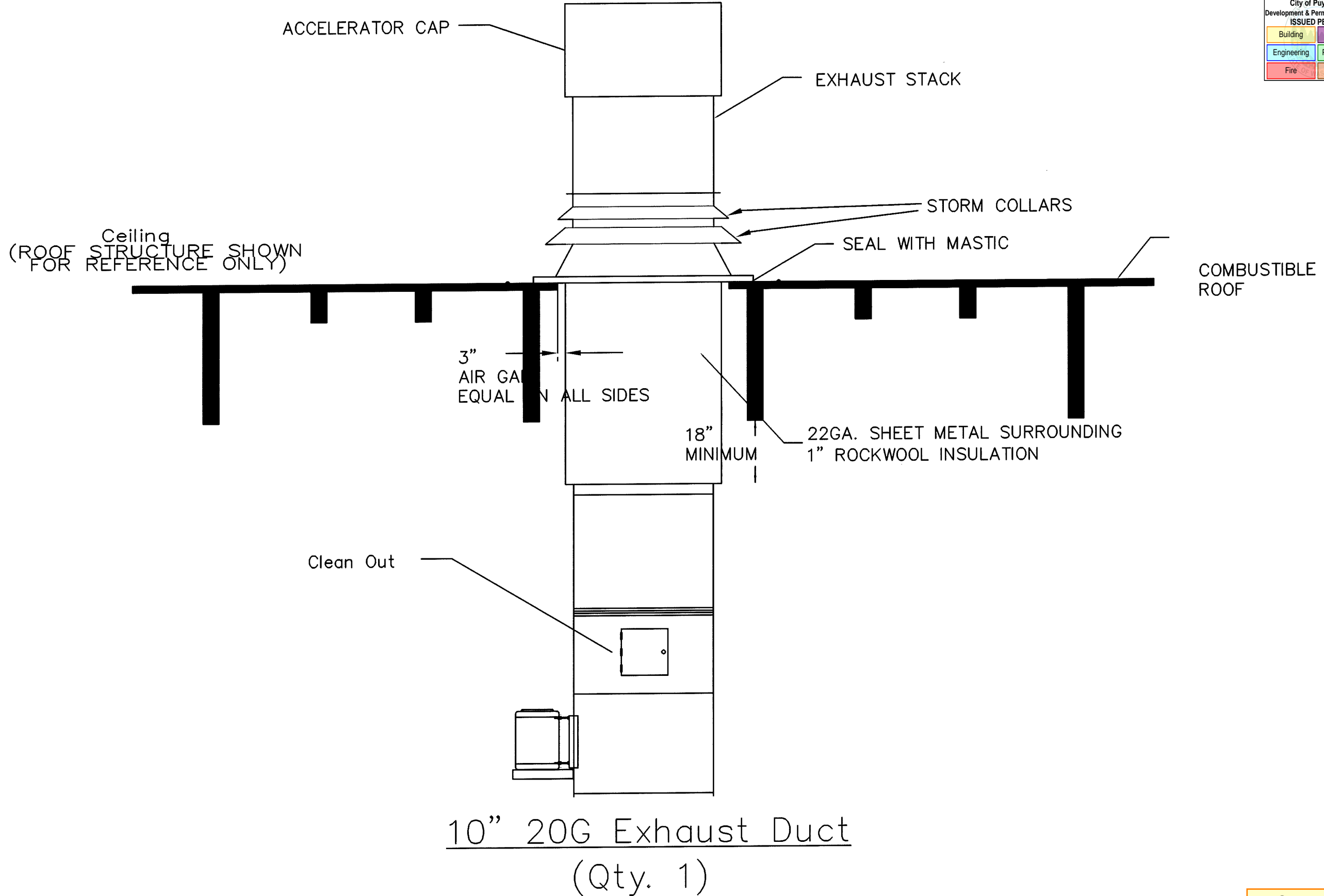

City of Puyallup
Development & Permitting Services
ISSUED PERMIT

Building	Planning
Engineering	Public Works
Fire	Traffic

THIS DRAWING IS THE PROPERTY OF ADVANCED FINISHING SYSTEMS, INC. IT CONTAINS TRADE SECRETS AND PROPRIETARY INFORMATION. IT IS TO BE USED ONLY FOR THE PROJECT AND SITE SPECIFICALLY IDENTIFIED HEREIN. ANY REUSE OR REPRODUCTION WITHOUT WRITTEN CONSENT OF A.F.S. IS STRICTLY PROHIBITED.

DATE: 09/09/2025
DRAWN BY: Ron Myers!
JOB #: 7565

COMPANY: **Hormann Door**
SCALE: NTS
REV. # #11 of 11
DWG. NO. 11

TITLE: **Codel Entry Systems**

ADVANCED FINISHING SYSTEMS
235 SW 4th Street
Renton WA 98055
(425) 656-0606
888-656-0606

2004 N. Killingsworth
Portland OR 97217
(503) 285-0569
888-265-0320

A.F.S.

PRCTI20251520

Dry Enclosure Exhaust Duct Detail

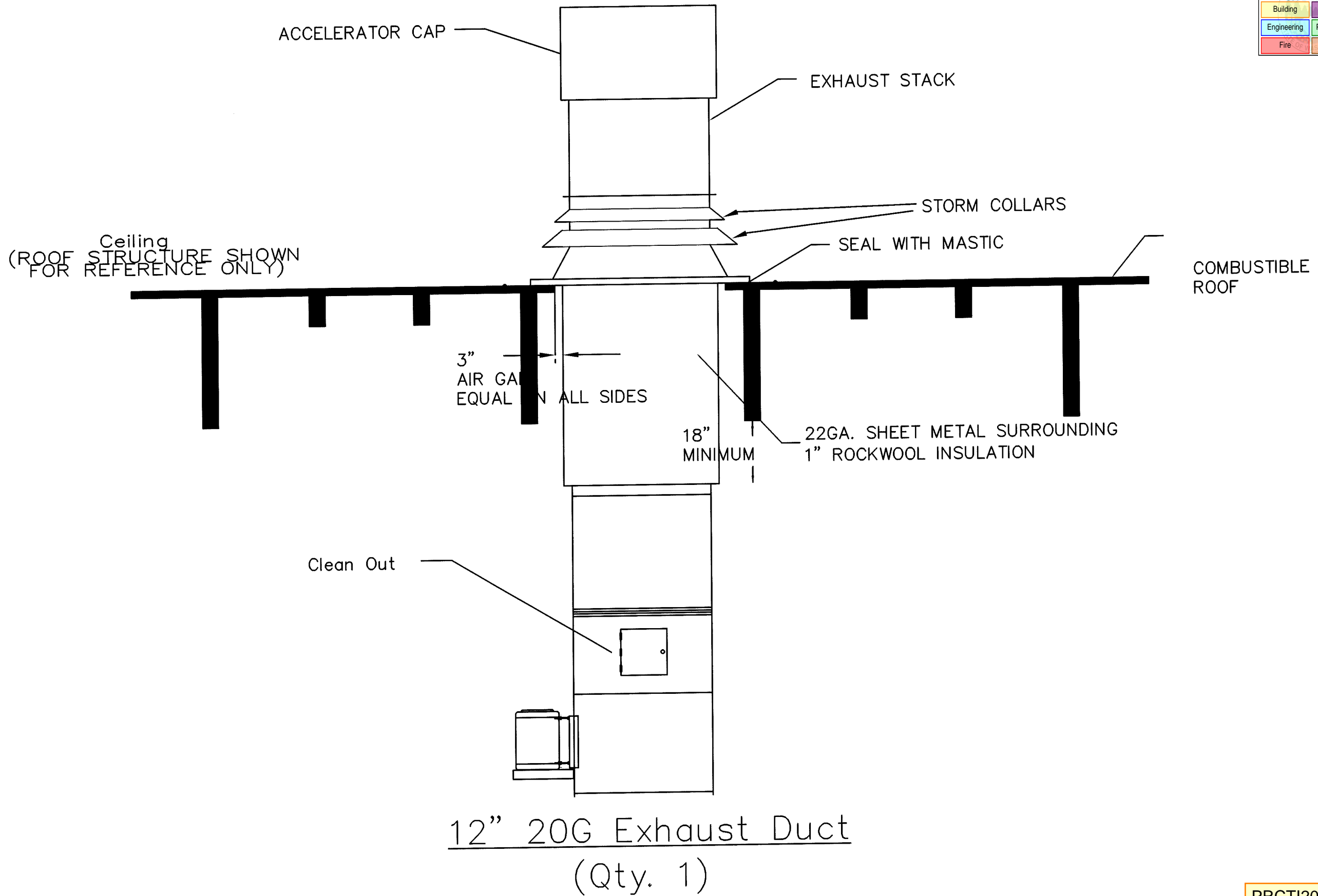

City of Puyallup Development & Permitting Services	
ISSUED PERMIT	
Building	Planning
Engineering	Public Works
Fire	Traffic

<small>THIS DRAWING IS AN UNRECORDED COPY. PROPERTY IT CONTAINS PROPERTY INFORMATION MUST BE RECORDED WITH PERMIT. DO NOT CIRCULATE, REPRODUCE OR MAKE TO OTHER PARTIES WITHOUT CONSENT OF A/E/S.</small>	
DATE:	09/09/2025
DRAWN BY:	Ron Myers
JOB #:	7565
SCALE:	NTS
# OF	10
DWG. NO.	08

TITLE

Codel Entry Systems

ADVANCED FINISHING SYSTEMS

235 SW 41st Street
Renton WA 98055
(206) 855-6606
888-655-6606

2304 N. 18th Street
Portland OR 97217
(503) 251-6555
888-251-0330

AES

PRCTI20251520