

TURNOVER OF AMENITY, BLDG A, BLDG B & BLDG C - 07/31/2026

Sunset Garden Senior Living Apartments

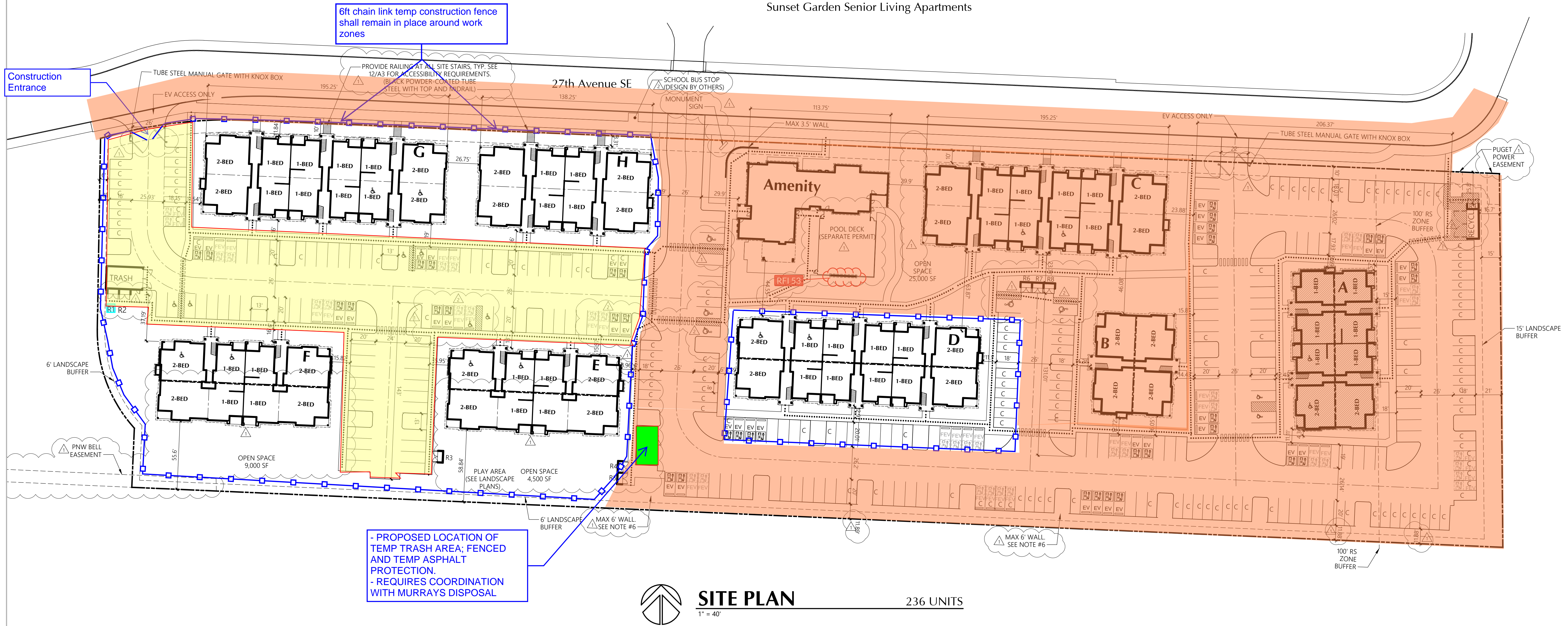

- PROPOSED LOCATION OF TEMP TRASH AREA; FENCED AND TEMP ASPHALT PROTECTION.
- REQUIRES COORDINATION WITH MURRAY'S DISPOSAL

SITE PLAN 236 UNITS

1" = 40'

- WORK ZONE - ALL PAVING AND SIDEWALKS COMPLETED BY END OF JUNE 2026
- TEMP CONSTRUCTION FENCE - 6FT CHAIN LINK
- COMPLETED WORK AREAS - INCLUDES 100% COMPLETE AND INSPECTED BUILDINGS A, C, AND CLUBHOUSE.
- INCLUDES COMPLETION OF ALL SITE WORK (PAVING, SIDEWALKS, FENCING, RETAINING WALLS, LANDSCAPING, LIGHTING, RECYCLE, CARPORTS, EV CHARGING)
- INCLUDES 100% COMPLETE AND INSPECTED ALL OFFSITE WORK (PAVING, STRIPING, CROSSINGS, SIDEWALK, LANDSCAPING, ETC)

PERMIT BLDG NAME	▲ PUYALLUP ADDRESS
A	206 27TH AVE SE, BLDG J
B	206 27TH AVE SE, BLDG H
C	206 27TH AVE SE, BLDG G
D	206 27TH AVE SE, BLDG E
E	206 27TH AVE SE, BLDG C
F	206 27TH AVE SE, BLDG A
G	206 27TH AVE SE, BLDG B
H	206 27TH AVE SE, BLDG D
CLUBHOUSE	206 27TH AVE SE, BLDG F

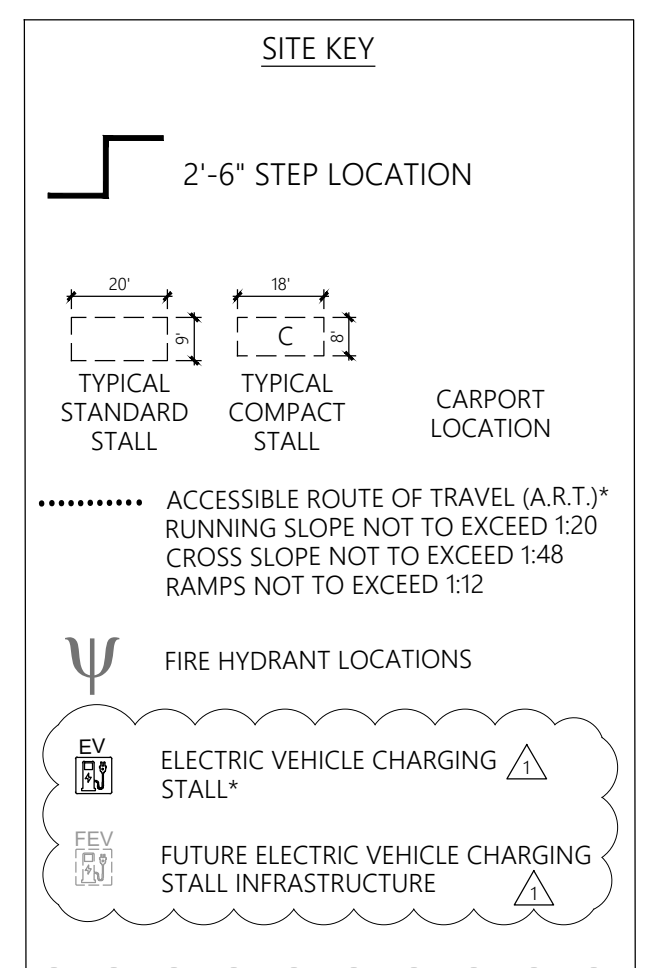

* Future electric vehicle stalls shall provide conduit from the electrical panel to either a pull box in the vicinity of the designated future electric vehicle charging locations or stub above grade in the vicinity of the designated future electric vehicle charging locations, protected from vehicles by a wheel stop.

APPROVED
BY *[Signature]*
CITY OF PUYALLUP
ENGINEERING SERVICES
DATE 04/14/2026

NOTE: THIS APPROVAL IS VOID AFTER 180 DAYS FROM APPROVAL DATE. THE CITY WILL NOT BE RESPONSIBLE FOR ERRORS AND/OR OMISSIONS ON THESE PLANS. FIELD CONDITIONS MAY DICTATE CHANGES TO THESE PLANS AS DETERMINED BY THE CITY ENGINEER

This site plan shall be accompanied by BRADLEY HEIGHTS PHASING LETTER DATED MARCH 20, 2026. The letter includes information not depicted on this plan that may be required to approve, or inspect the site during phased occupancy.

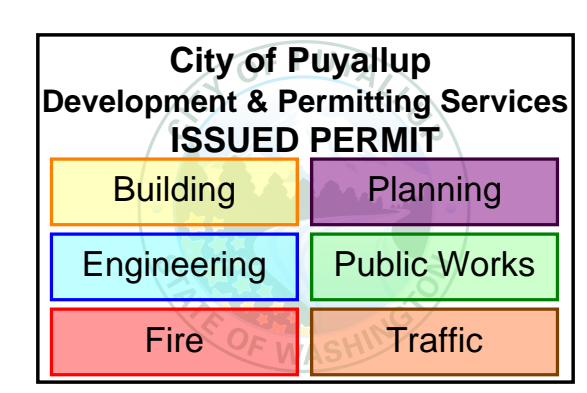

25 Central Way, Suite 210
Kirkland, Washington 98033
P: 425.454.7130 F: 425.658.1208
Web: www.milbrandtarch.com

© Copyright 2023
Milbrandt Architects, INC., P.S.
All rights reserved

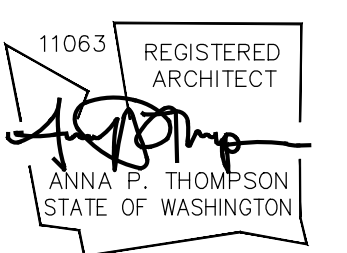

Site Plan
Building A

Bradley Heights Apartments
Puyallup, Wa

Timberlane Partners

Revisions

No.	Date	Description
▲ 8-30-24		Owner Changes/ Permit Corrections
▲ 4-24-25		Permit Corrections

Initial Publish Date:
Date Plotted: 5-6-25
Job No.: 23-06
Drawn By: APT/HDM
Sheet No.:

