

Radio Frequency Safety Survey Report Predictive (RFSSRP) Prepared For AT&T



Site Name: GOOD SAMARITAN
FA# 10029581
USID: 75153
Site ID: SIWA004480
Address: 407 14TH AVENUE SOUTHEAST,
PUYALLUP, WA 98371
County: PIERCE
Latitude: 47.17950
Longitude: -122.29055
Structure Type: ROOFTOP
Property Owner: MULTICARE HEALTH SYSTEM
IWM Job#: WSWOR0029867
RFDS Technology: 5G NR 1SR CBAND
Desktop Modeler: IXUS VERSION 4.11(0)

Report Information

Report Writer: Deepak Jat

Report Generated Date: 07-18-2024

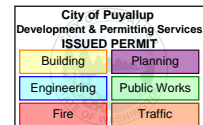

Compliance Statement

AT&T Mobility Compliance Statement: Based on the information collected, AT&T Mobility will be compliant when the remediation recommended in section 5 or appropriate remediation determined by AT&T is implemented.



Table of Contents

1. Executive Summary	4
1.1 Site Summary	4
1.2 Signage Summary (Proposed)	4
1.3 List of Documents used to prepare this Report.	4
2. Site Scale Map	5
3. Antenna Inventory	6
4. Predicted RF Emission Diagram(s).....	8
4.1 Predictive Cumulative MPE Contribution from All Sources at Antennas Centerline-1 Level (87.75 ft. AGL)	8
4.2 Predictive Cumulative MPE Contribution from All Sources at PH-2 Level (83.25 ft. AGL)	9
4.3 Predictive Cumulative MPE Contribution from All Sources at Antennas Centerline Level-2 (80 ft. AGL)	10
4.4 Predictive Cumulative MPE Contribution from All Sources at PH-3 Level (79.25 ft. AGL)	11
4.5 Predictive Cumulative MPE Contribution from All Sources at HVAC Level (71.66 ft. AGL)	12
4.6 Predictive Cumulative MPE Contribution from All Sources at Platform Level (68.66 ft. AGL)	13
4.7 Predictive Cumulative MPE Contribution from All Sources at Main Roof Level (64.66 ft. AGL)	14
4.8 Predictive Cumulative MPE Contribution from All Sources at Lower Roof-1 & 2 Level (63.66 ft. & 54.66 ft. AGL).....	15
4.9 Predictive Cumulative MPE Contribution from All Sources at Light Pole Level (20 ft. AGL)	16
4.10 Predictive Cumulative MPE Contribution from All Sources at Ground Level (0 ft. AGL)	17
4.11 Predictive Cumulative MPE Contribution from All Sources: Perspective View - 1	18
4.12 Predictive Cumulative MPE Contribution from All Sources: Perspective View - 2.....	19
4.13 Predictive Cumulative MPE Contribution from All Sources: Perspective View - 3.....	20
5. Statement of Compliance.....	21
5.1 Statement of AT&T Mobility Compliance.....	21
Appendix A – Statement of Limiting Conditions	24
Appendix B – FCC Guidelines and Emissions Threshold Limits	26
Appendix C – Rules & Regulations	28
Appendix D – General Safety Recommendations	29



MobileComm Professionals, Inc.
Your ISO 9001-2000 Certified, Quality Centric & Cost effective Services Partner

Appendix E – References..... 30

Appendix F – Proprietary Statement..... 33

1. Executive Summary

1.1 Site Summary

Max Predictive Spatial Average MPE% & Location on Site (General Public)	258.77% at Platform Level
Max Predictive Spatial Average MPE% & Location on Site Walking Surface (General Public)	163.64% at Main Roof Level
Max Predictive Spatial Average MPE% at Ground Level (General Public)	7.20%
AT&T Mobility Site Compliance	AT&T Mobility will be compliant by implementing remediation recommended as per section 5 in this report.
TABLE 1: Site Summary	

1.2 Signage Summary (Proposed)

AT&T Signage Locations	Sign Type									
	Safety Instructions	Notice Sign 2	Caution Sign 2	Caution Sign 2B	Caution Sign 2A	Caution 7"x7"	Warning Sign 1B	RF Exposure Map	Lock	Barriers
Access Point(s)										
Alpha			17		4					X
Beta			25							X
Gamma			16							X
TABLE 2: Signage Summary (Proposed)										

1.3 List of Documents used to prepare this Report.

- I. 10029581_WA6659_Good Samaritan Final Construction Design Rev 0.pdf
- II. 10029581_WA6659_Good Samaritan Final RFDS.pdf
- III. RFDS ID - RFDS-4370

2. Site Scale Map

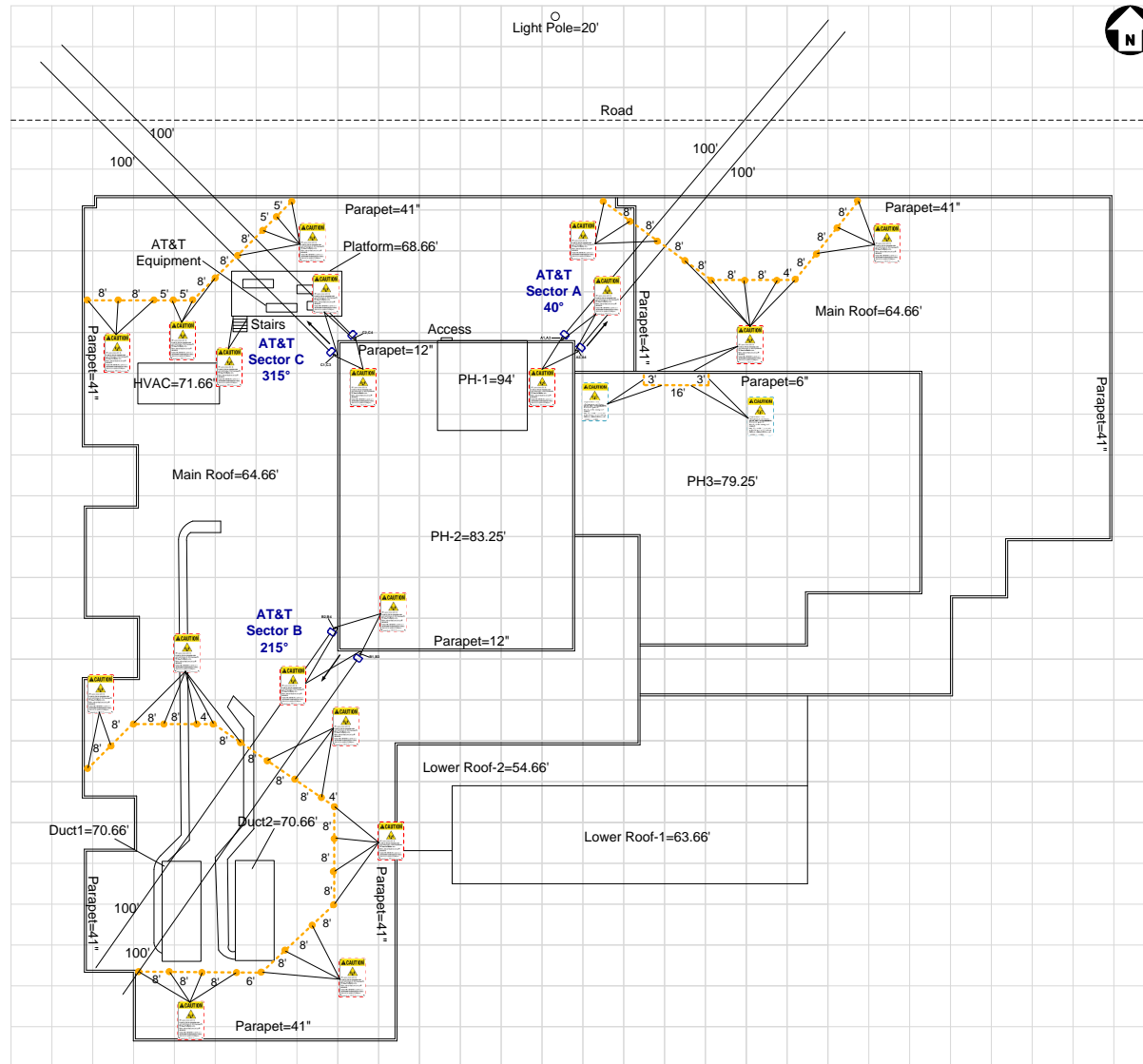

AT&T Antenna Panel OMNI	Proposed Barrier Posts	Proposed Signage										Map Scale = 10 ft	

4. Predicted RF Emission Diagram(s)

4.1 Predictive Cumulative MPE Contribution from All Sources at Antennas Centerline-1 Level (87.75 ft. AGL)

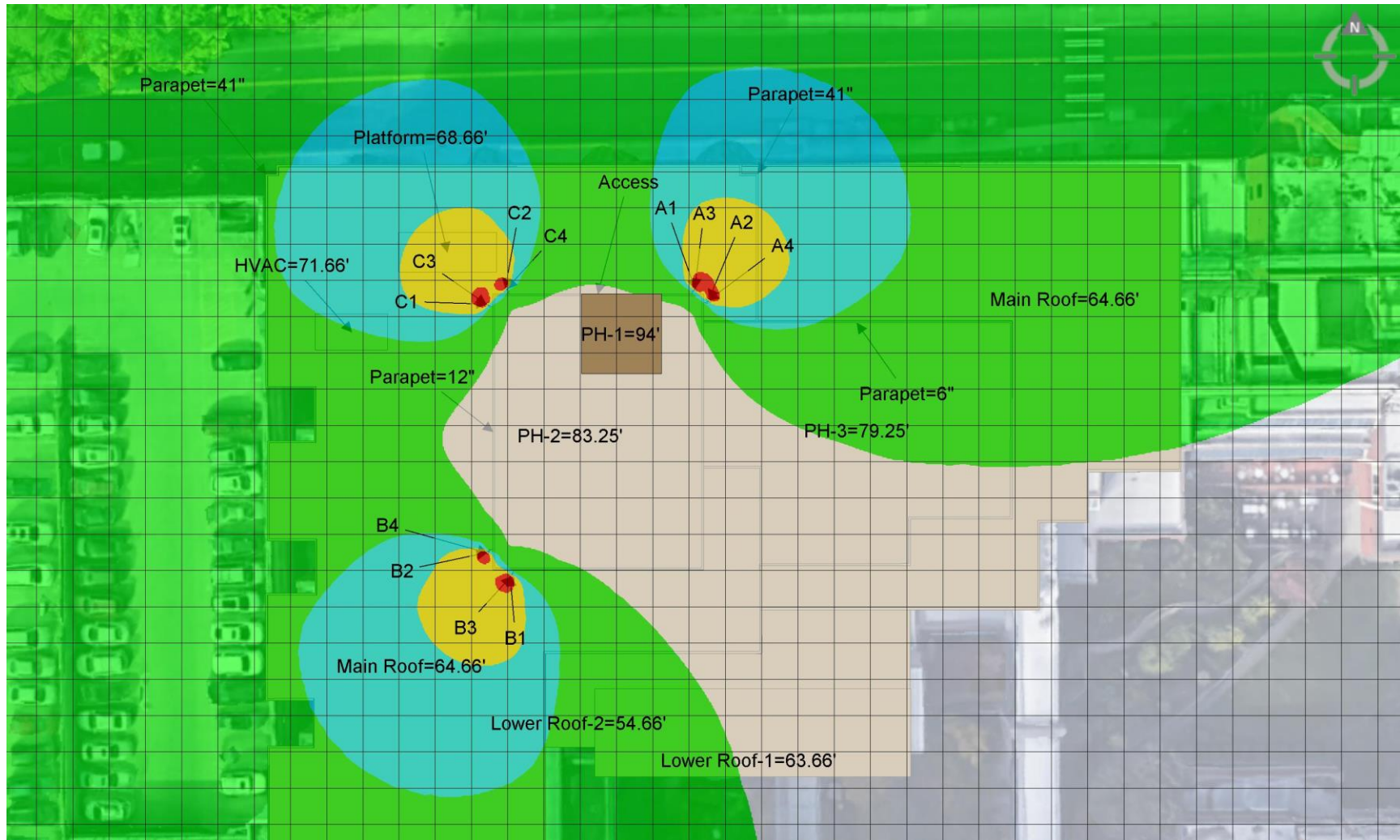

Max. Predictive Spatial Average MPE% = **335792.00%**

	% of FCC General Public Exposure Limit (Predictive Spatial Average)					
Proposed Barrier -----	Non-Simulated	0-5	5-100	100-500	500-5000	>5000
Proposed Posts ●						

Map Scale = 10 ft

4.2 Predictive Cumulative MPE Contribution from All Sources at PH-2 Level (83.25 ft. AGL)



Max. Predictive Spatial Average MPE% = **941.25%**

		% of FCC General Public Exposure Limit (Predictive Spatial Average)					
		Non-Simulated	0-5	5-100	100-500	500-5000	>5000
Proposed Barrier	-----						
Proposed Posts	●						

Map Scale = 10 ft

4.3 Predictive Cumulative MPE Contribution from All Sources at Antennas Centerline Level-2 (80 ft. AGL)

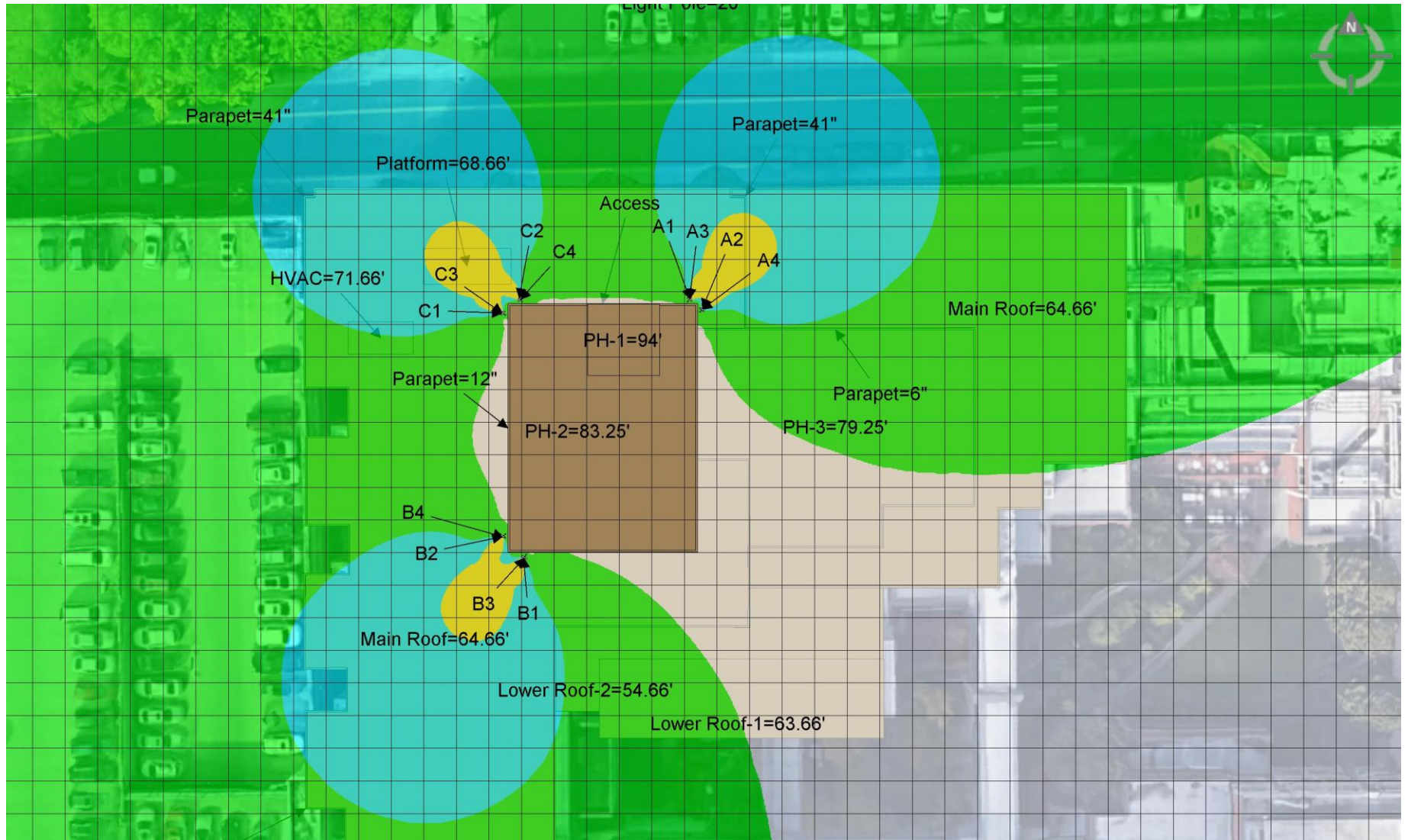

Max. Predictive Spatial Average MPE% = **11684.90%**

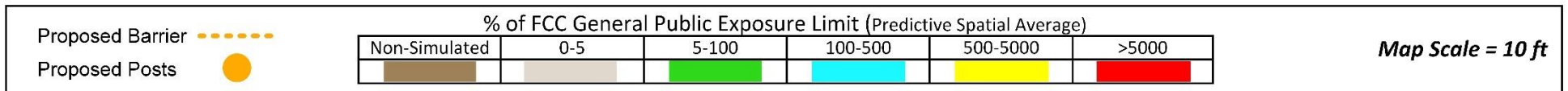

4.4 Predictive Cumulative MPE Contribution from All Sources at PH-3 Level (79.25 ft. AGL)

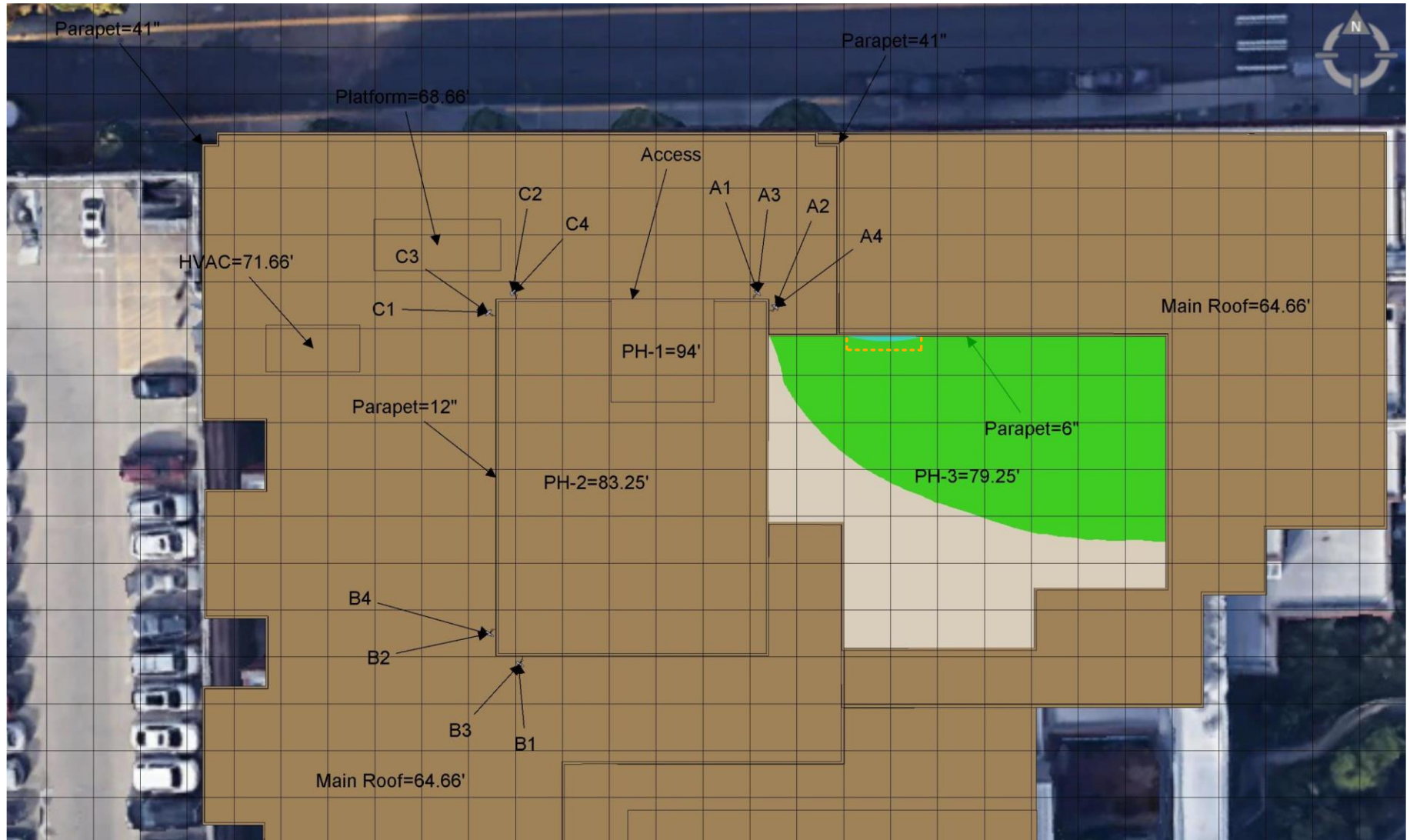

Max. Predictive Spatial Average MPE% = **116.09 %**

	% of FCC General Public Exposure Limit (Predictive Spatial Average)					
Proposed Barrier -----	Non-Simulated	0-5	5-100	100-500	500-5000	>5000
Proposed Posts ●						

Map Scale = 10 ft

4.5 Predictive Cumulative MPE Contribution from All Sources at HVAC Level (71.66 ft. AGL)

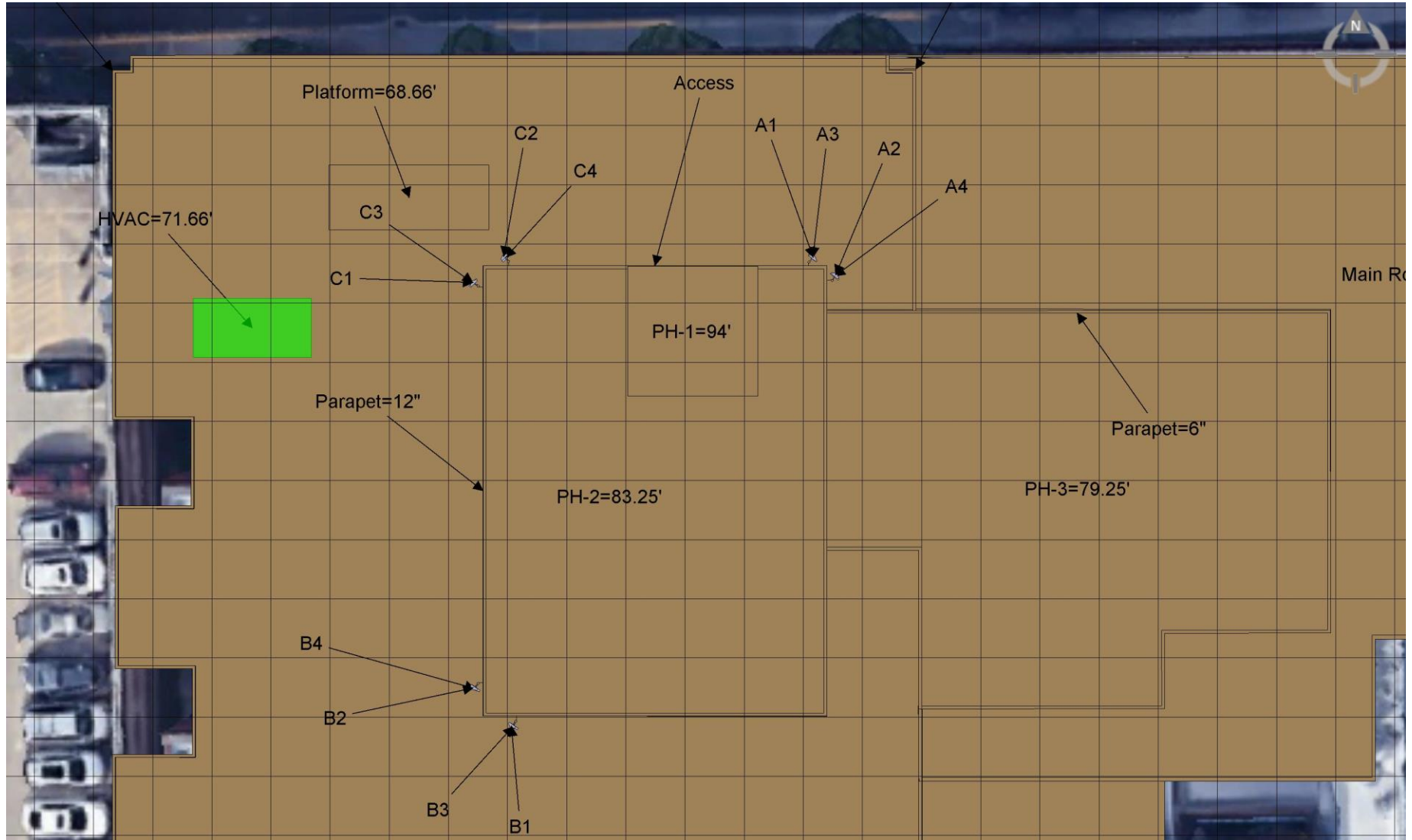

Max. Predictive Spatial Average MPE% = **81.43%**

Proposed Barrier ----- Proposed Posts ●	% of FCC General Public Exposure Limit (Predictive Spatial Average)							Map Scale = 10 ft
		Non-Simulated	0-5	5-100	100-500	500-5000	>5000	

4.6 Predictive Cumulative MPE Contribution from All Sources at Platform Level (68.66 ft. AGL)

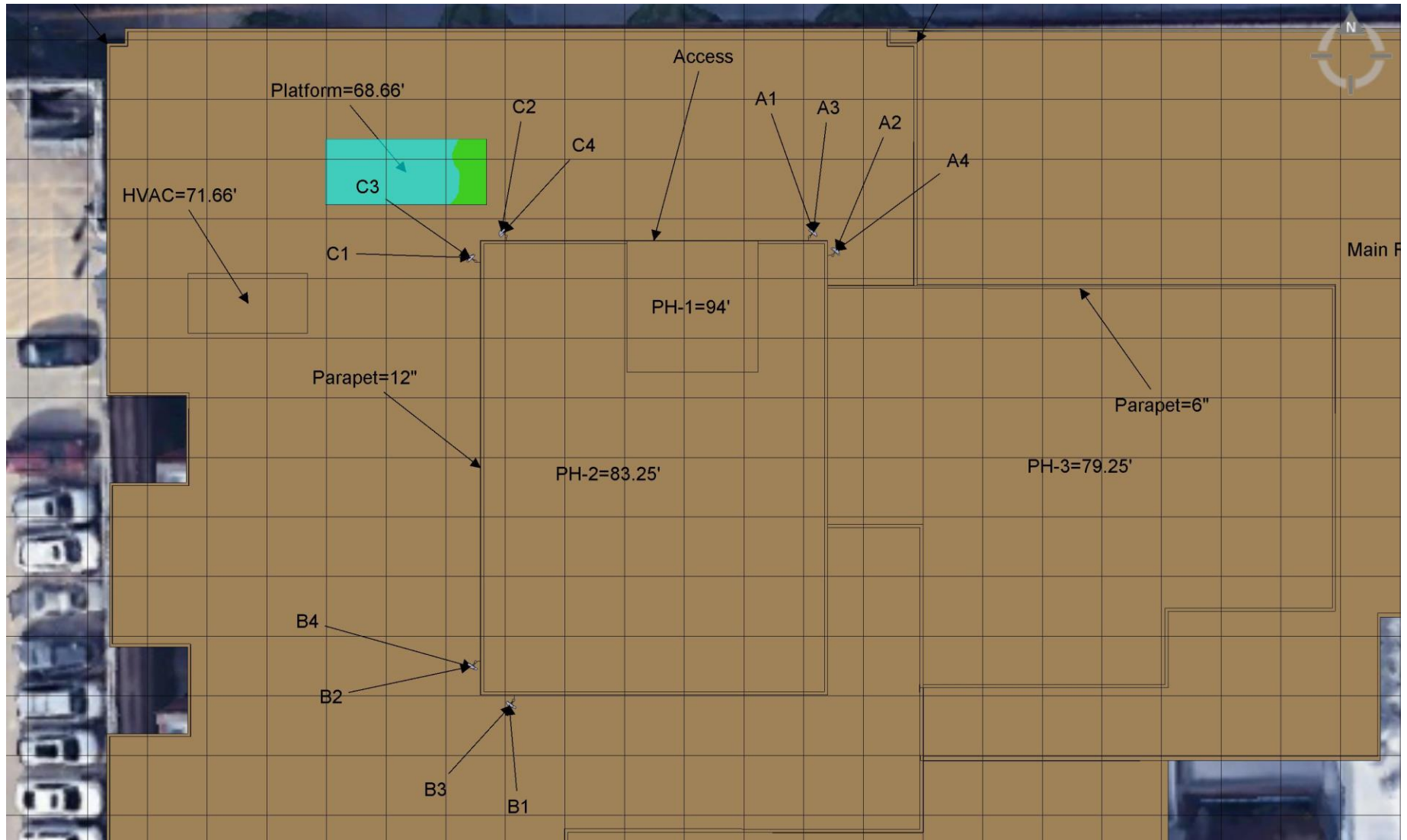

Max. Predictive Spatial Average MPE% = **258.77%**

		% of FCC General Public Exposure Limit (Predictive Spatial Average)					
		Non-Simulated	0-5	5-100	100-500	500-5000	>5000
Proposed Barrier	-----						
Proposed Posts	●						

Map Scale = 10 ft

4.7 Predictive Cumulative MPE Contribution from All Sources at Main Roof Level (64.66 ft. AGL)

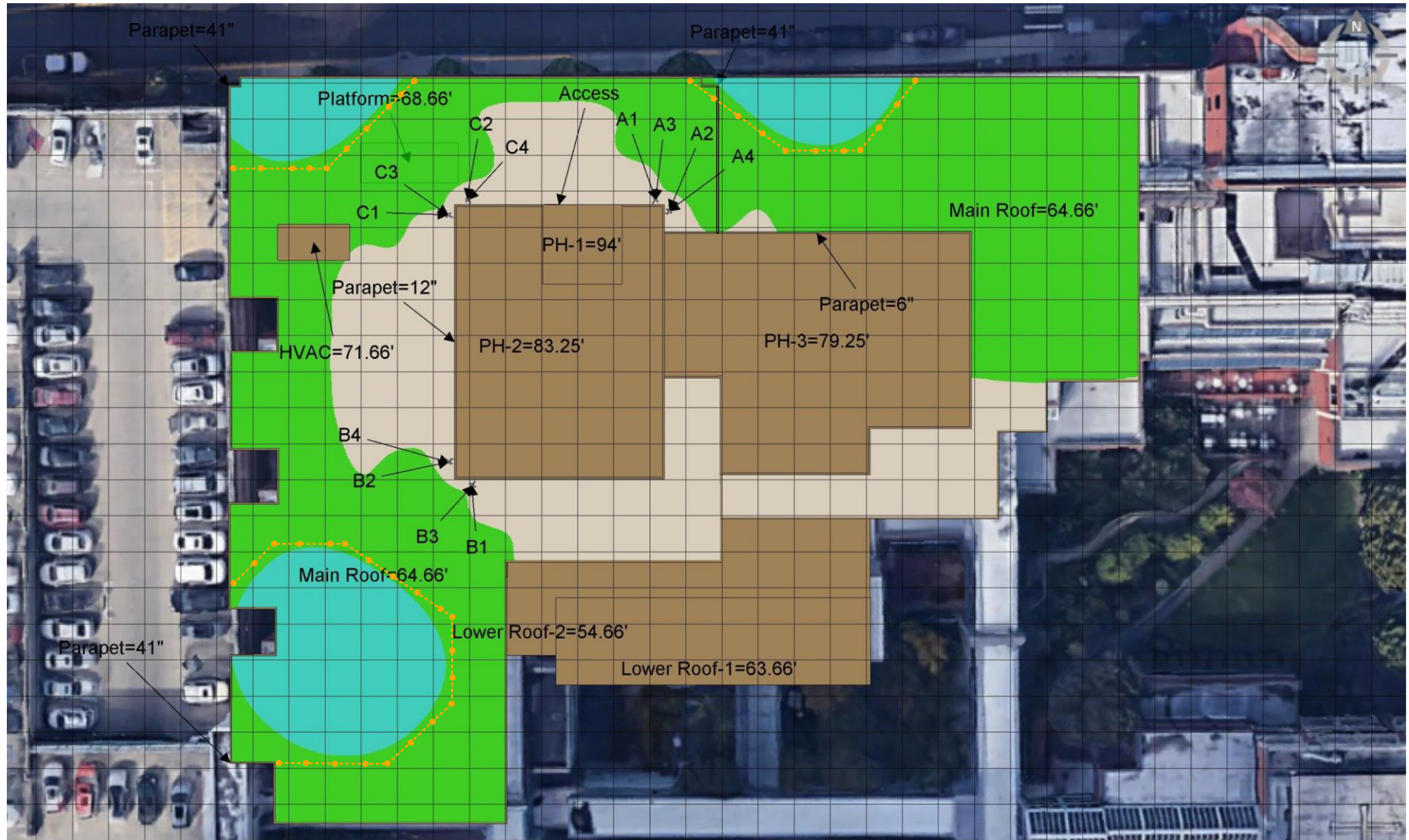

Max. Predictive Spatial Average MPE% = **163.64%**

	% of FCC General Public Exposure Limit (Predictive Spatial Average)					
Proposed Barrier - - - - -	Non-Simulated	0-5	5-100	100-500	500-5000	>5000
Proposed Posts ●						

Map Scale = 10 ft

4.8 Predictive Cumulative MPE Contribution from All Sources at Lower Roof-1 & 2 Level (63.66 ft. & 54.66 ft. AGL)



Max. Predictive Spatial Average MPE% = **34.97%**

		% of FCC General Public Exposure Limit (Predictive Spatial Average)					
		Non-Simulated	0-5	5-100	100-500	500-5000	>5000
Proposed Barrier							
Proposed Posts							

Map Scale = 10 ft

4.9 Predictive Cumulative MPE Contribution from All Sources at Light Pole Level (20 ft. AGL)

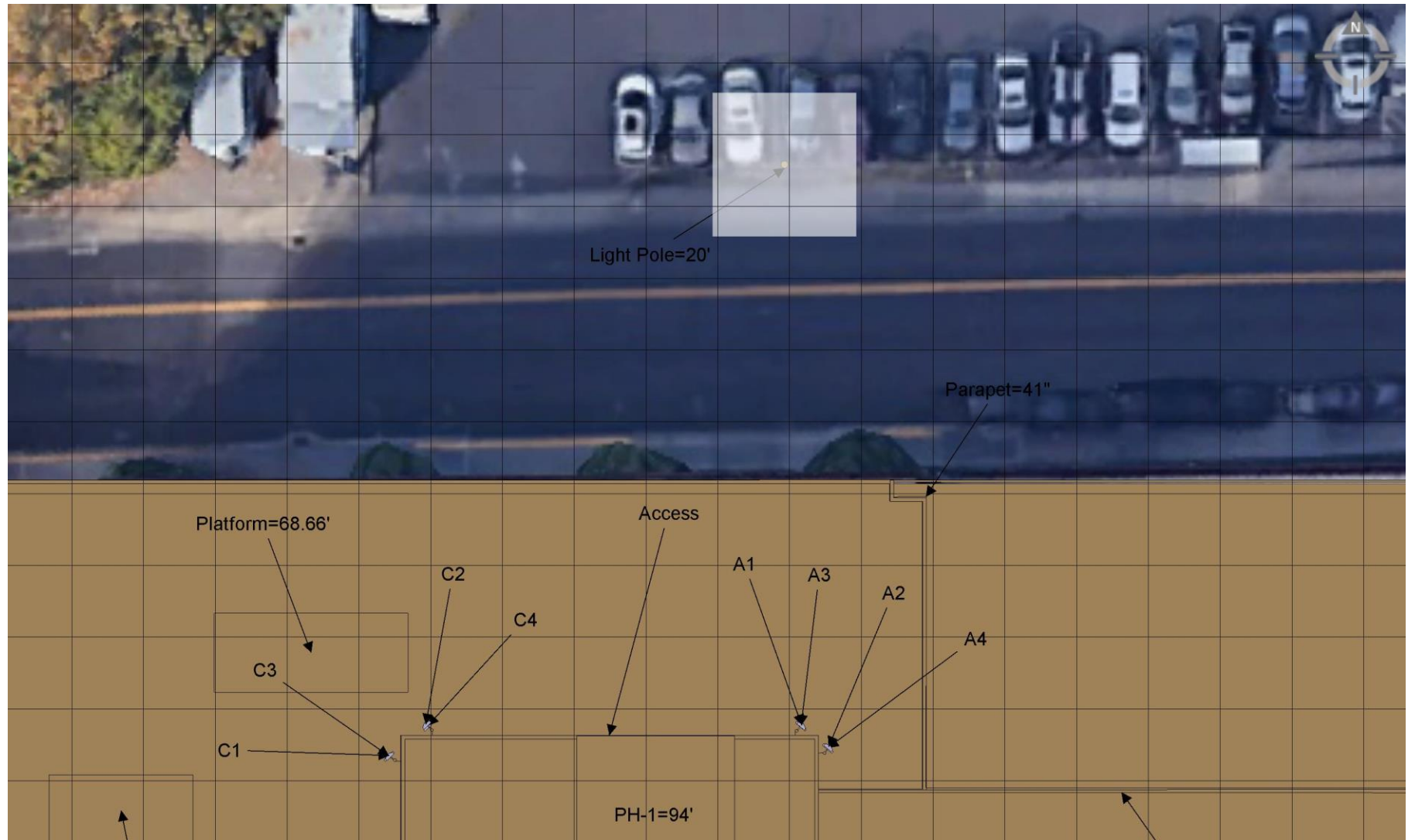

Max. Predictive Spatial Average MPE% = 1.22%

		% of FCC General Public Exposure Limit (Predictive Spatial Average)					
		Non-Simulated	0-5	5-100	100-500	500-5000	>5000
Proposed Barrier							
Proposed Posts							

Map Scale = 10 ft

4.10 Predictive Cumulative MPE Contribution from All Sources at Ground Level (0 ft. AGL)

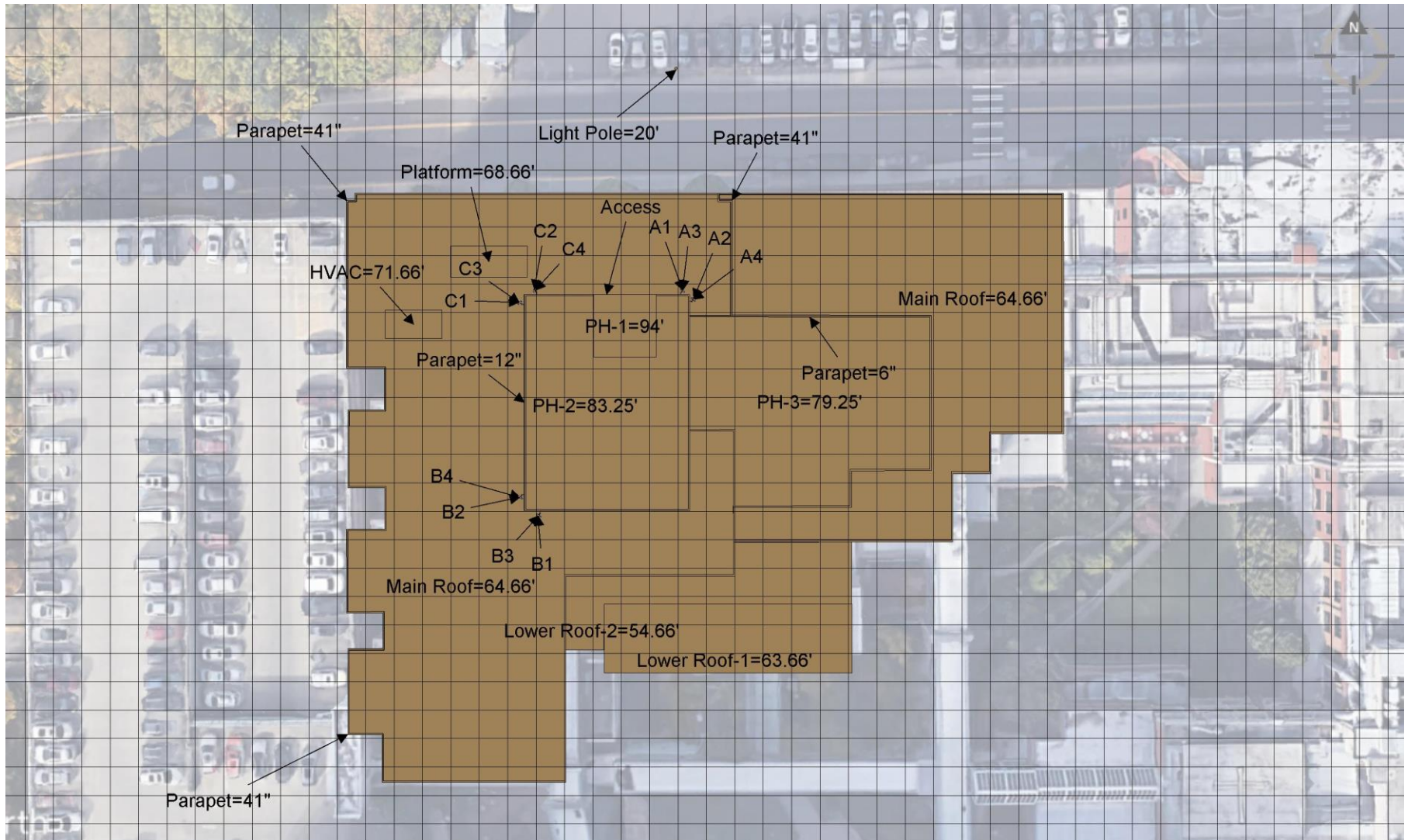

Max. Predictive Spatial Average MPE% = **7.20%**

		% of FCC General Public Exposure Limit (Predictive Spatial Average)						
		Non-Simulated	0-5	5-100	100-500	500-5000	>5000	
Proposed Barrier								Map Scale = 10 ft
Proposed Posts								

4.11 Predictive Cumulative MPE Contribution from All Sources: Perspective View - 1

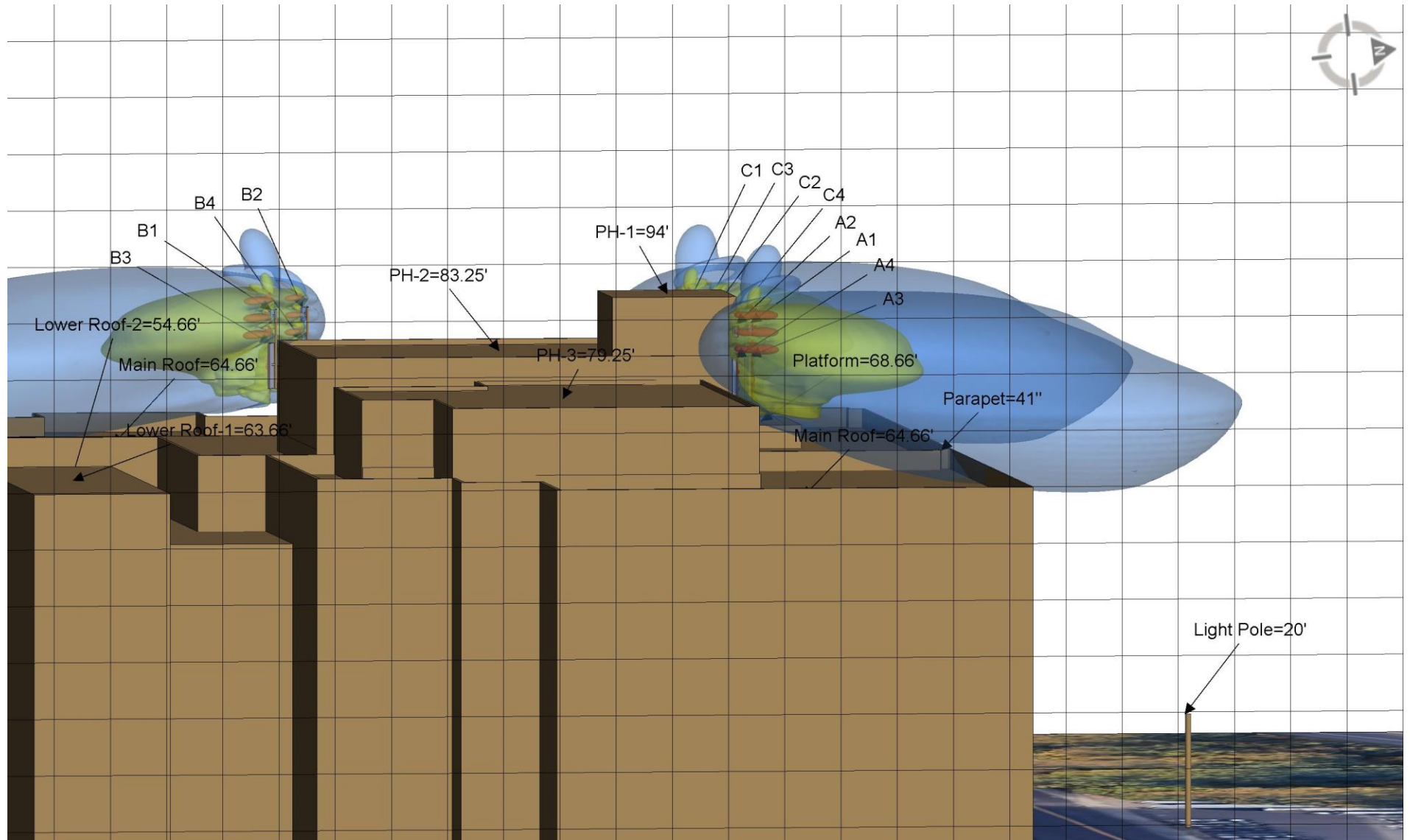

% of FCC General Public Exposure Limit

100-500	500-5000	>5000

Map Scale = 10 ft

4.12 Predictive Cumulative MPE Contribution from All Sources: Perspective View - 2

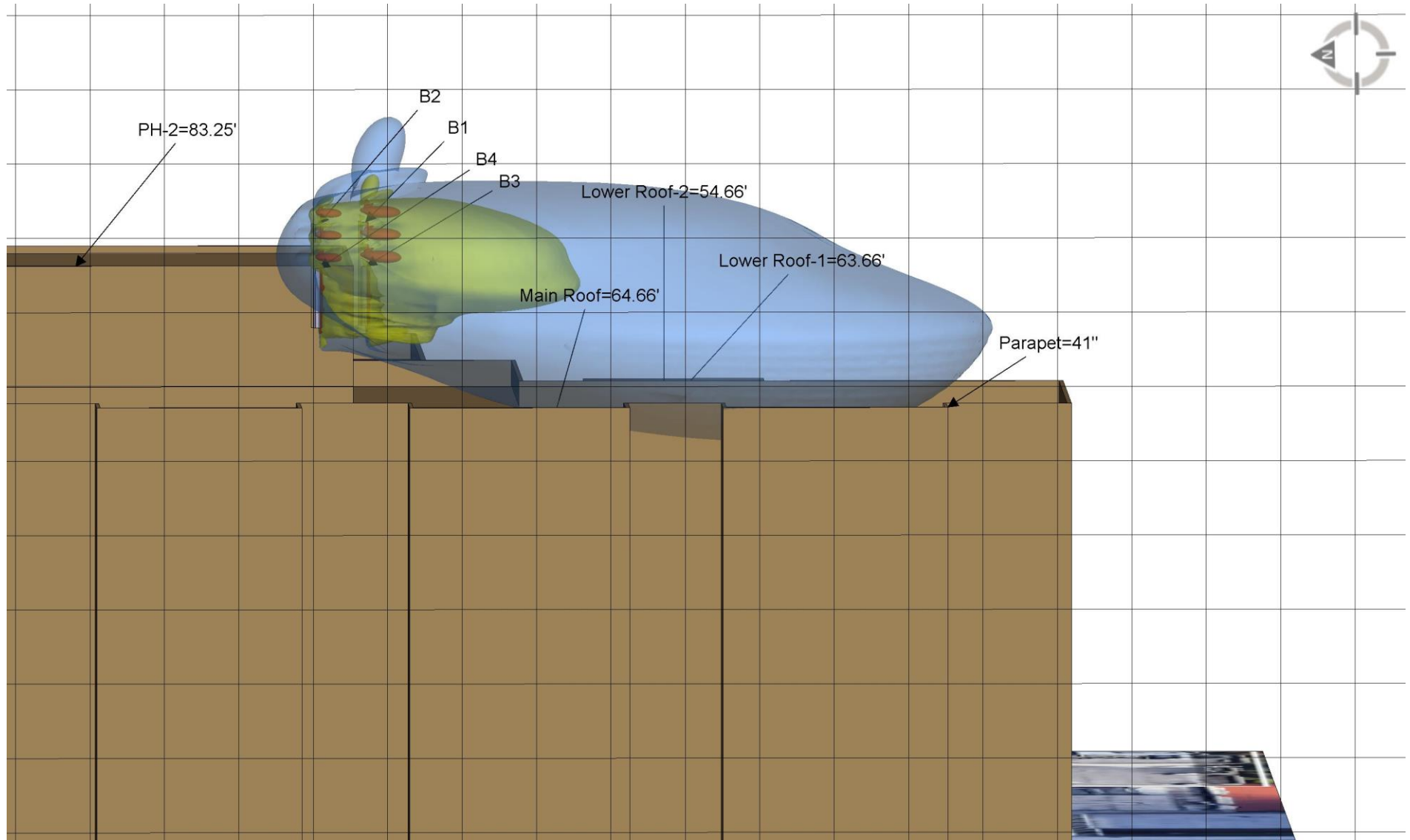

% of FCC General Public Exposure Limit

100-500	500-5000	>5000

Map Scale = 10 ft

4.13 Predictive Cumulative MPE Contribution from All Sources: Perspective View - 3

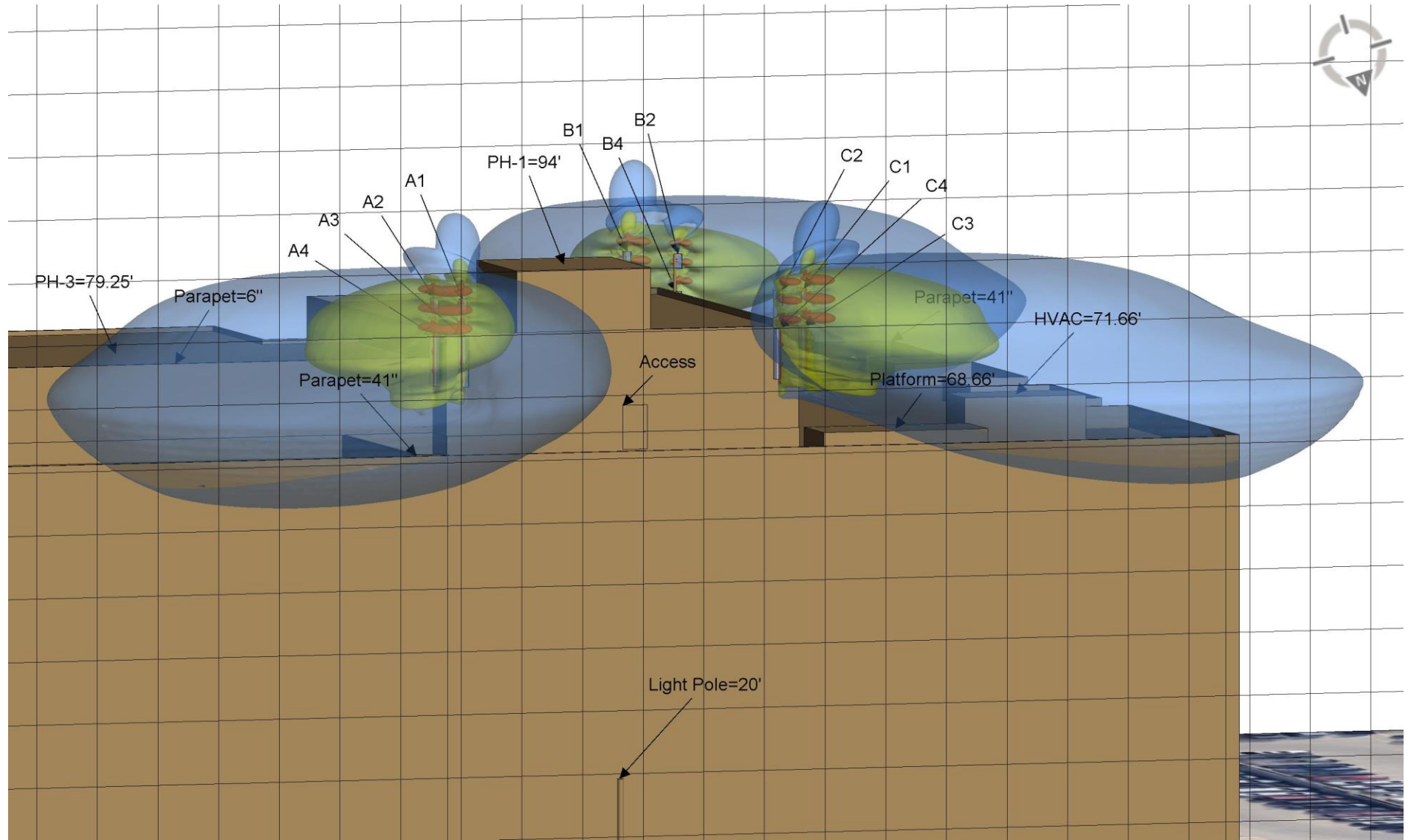

% of FCC General Public Exposure Limit

100-500	500-5000	>5000

Map Scale = 10 ft

5. Statement of Compliance

5.1 Statement of AT&T Mobility Compliance

At the time of our Analysis, AT&T Mobility is required to take action to fulfill their Obligations to comply with the FCC's mandate as defined in OET-65.

Recommendations

AT&T Alpha Sector:

- Two Caution 2 Signs to be posted at the back (1ft below antenna connectors on the pipe only) of the antenna (Ant. #A1 & Ant. #A2) facing outwards so approaching people can see as shown in "Recommendations Map – Detailed View" on page 23. (2 Total Signs)
- Two Caution 2 Signs to be posted 2 feet below the antenna bottom tip (Ant. #A3 & Ant. #A4) facing outwards so approaching people can see as shown in "Recommendations Map – Detailed View" on page 23. (2 Total Signs)
- Two Caution 2 Signs to be posted on the PH3 wall, 2 feet below PH3 edge facing outwards so approaching people can see as shown in "Recommendations Map – Detailed View" on page 23. (2 Total Signs)
- **Barrier 24ft "8ft x 8ft x 8ft" x 20ft "4ft x 8ft x 8ft" x 32ft "8ft x 8ft x 8ft x 8ft"** required with **Eleven Posts** with Caution 2 Sign posted on the top of each Post facing outwards so approaching people can see as shown in "Recommendations Map - Detailed View" on page 23. (11 Total Signs)
- Standard Barrier Solution is not possible due to Unprotected Roof Edge as per OSHA guidance at **PH3**. Hence a Custom Barrier Solution **3ft x 16ft x 3ft** (i.e., Paint Stripe, 3M Caution Tape etc.) Must be deployed using appropriate Caution 2A Sign(s) as shown in "Recommendations Map - Detailed View" on page 23. (4 Total Signs)

AT&T Beta Sector:

- Two Caution 2 Signs to be posted at the back (1ft below antenna connectors on the pipe only) of the antenna (Ant. #B1 & Ant. #B2) facing outwards so approaching people can see as shown in "Recommendations Map – Detailed View" on page 23. (2 Total Signs)
- Two Caution 2 Signs to be posted 2 feet below the antenna bottom tip (Ant. #B3 & Ant. #B4) facing outwards so approaching people can see as shown in "Recommendations Map – Detailed View" on page 23. (2 Total Signs)
- **Barrier 16ft "8ft x 8ft" x 22ft "8ft x 8ft x 4ft" x 36ft "8ft x 8ft x 8ft x 8ft x 4ft" x 24ft "8ft x 8ft" x 8ft x 24ft "8ft x 8ft x 8ft" x 30ft "6ft x 8ft x 8ft x 8ft"** required with **Twenty-One Posts** with Caution 2 Sign posted on the top of each Post facing outwards so approaching people can see as shown in "Recommendations Map - Detailed View" on page 23. (21 Total Signs)

AT&T Gamma Sector:

- Two Caution 2 Signs to be posted at the back (1ft below antenna connectors on the pipe only) of the antenna (Ant. #C1 & Ant. #C2) facing outwards so approaching people can see as shown in "Recommendations Map – Detailed View" on page 23. (2 Total Signs)
- Two Caution 2 Signs to be posted 2 feet below the antenna bottom tip (Ant. #C3 & Ant. #C4) facing outwards so approaching people can see as shown in "Recommendations Map – Detailed View" on page 23. (2 Total Signs)
- Two Caution 2 Signs to be posted on the handrail of the Stairs facing outwards so approaching people can see as shown in "Recommendations Map – Detailed View" on page 23. (2 Total Signs)
- **Barrier 34ft "5ft x 5ft x 8ft x 8ft" x 26ft "5ft x 5ft x 8ft x 8ft"** required with **Ten Posts** with Caution 2 Sign posted on the top of each Post facing outwards so approaching people can see as shown in "Recommendations Map - Detailed View" on page 23. (10 Total Signs)

Recommendations Map - Detailed View

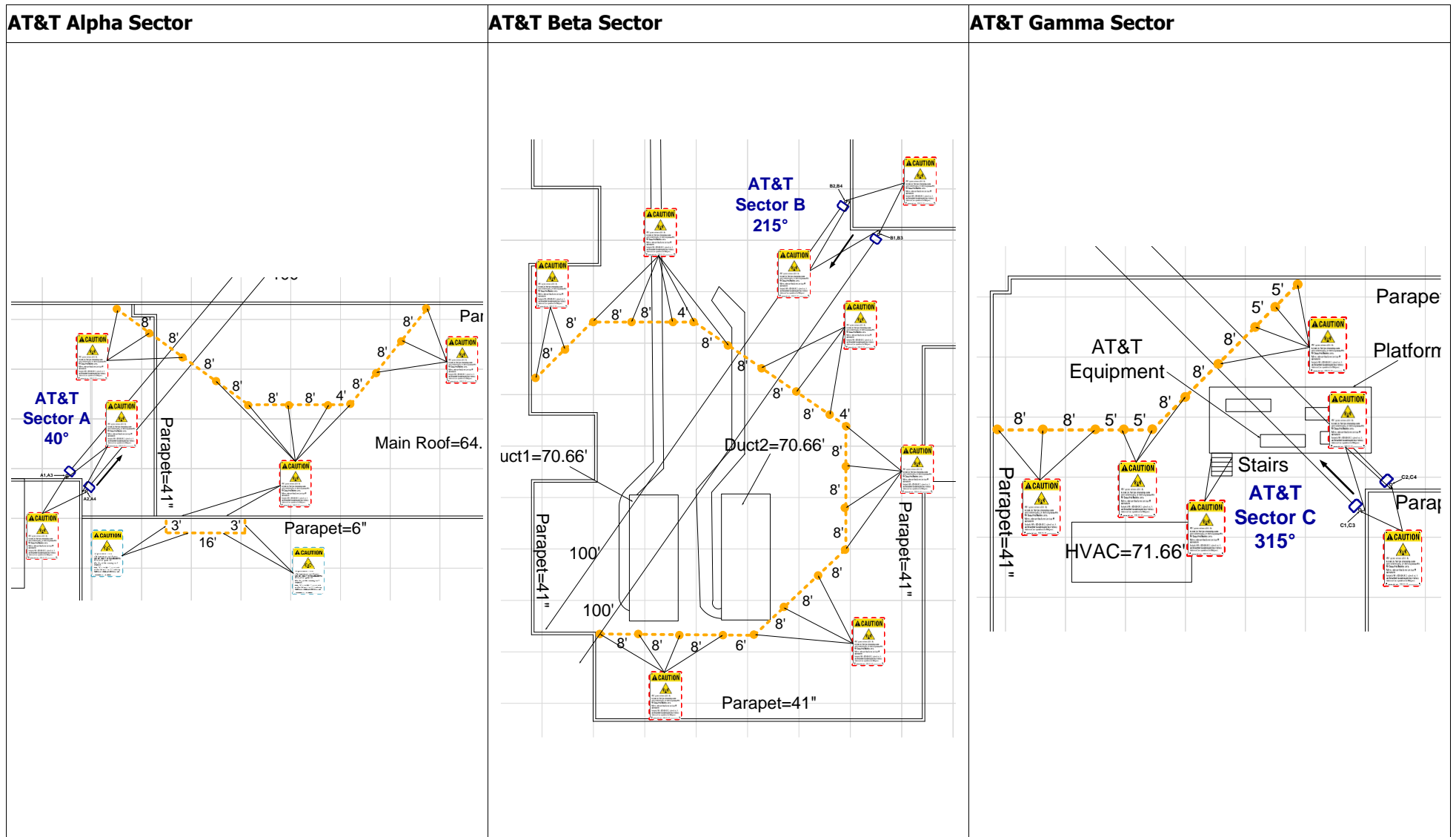

AT&T Antenna Panel OMNI		Proposed Barrier Posts		Proposed Signage										Map Scale = 10 ft
		Safety Instructions	Notice 2	Notice 2B Adjacent	Caution 2	Caution 2A	Caution 2B	Caution 2C	Caution 2D Adjacent	Caution 7"x7"	Warning 1B	RF Exposure Map	Lock	

Appendix A – Statement of Limiting Conditions

General Model Assumptions

In this site compliance report, it is assumed that all antennas are operating at full power at all times. AT&T has further recommended to assume a 75% duty cycle of maximum radiated power for all LTE & 5G carriers.

AT&T recommended to consider - For C-BAND and/or DoD AAS antenna(s) 75% TDD duty Cycle, 1.5dB Power Tolerance & 0.32 Power Reduction factor are used to calculate Transmitter Power & ERP/EiRP.

AT&T recommended to use worst-case tilts for the simulations. A small EDT range (e.g. +/-1 or +/-2 of given EDT) is also considered at applicable sites as per market specific guidelines.

Power Reduction Factor: IEC Standard 62232: 2017 allows for a statistically conservative power density model to more realistically define the RF exposure area. AT&T recommends a “0.32” factor to calculate the “Actual Maximum” (time averaged) power value, which accounts for “Beam Scanning,” “Scheduling,” and “RBS Utilization” This recommended value is a conservative figure modelled and supported by other vendors and through measurements published in scientific articles and white papers by IEEE and others. Those publication are listed below:

- 1. IEEE Access, Time-Averaged Realistic Maximum Power Levels for the Assessment of RF Exposure for 5G Radio Base Stations Using Massive MIMO (Published Sept. 18, 2017 / BJÖRN THORS, ANDERS FURUSKÄR, DAVIDE COLOMBI, AND CHRISTER TÖRNEVIK)*
- 2. IEEE Explore, A Statistical Approach for RF Exposure Compliance Boundary Assessment in Massive MIMO Systems (Published Jan. 25, 2018 / Paolo Baracca, Andreas Weber, Thorsten Wild, Christophe Grangeat)*
- 3. IEEE Access, In-situ Measurement Methodology for the Assessment of 5G NR Massive MIMO Base Station Exposure at Sub-6 GHz Frequencies (Published Dec. 20, 2019 / SAM AERTS, LEEN VERLOOCK, MATTHIAS VAN DEN BOSSCHE, DAVIDE COLOMBI, LUC MARTENS, CHRISTER TÖRNEVIK AND WOUT JOSEPH)*
- 4. Applied Sciences, Analysis of the Actual Power and EMF Exposure from Base Stations in a Commercial 5G Network (Published July 30, 2020 / Davide Colombi, Paramananda Joshi, Bo Xu, Fatemeh Ghasemifard, Vignesh Narasaraju and Christer Törnevik)*
- 5. Ofcom Technical Report, Electromagnetic Field (EMF) measurements near 5G mobile phone base stations (Published Feb. 21, 2020 / Davide Colombi, Paramananda Joshi, Bo Xu, Fatemeh Ghasemifard, Vignesh Narasaraju and Christer Törnevik)*

MobileComm believes these areas to be safe for entry by occupationally trained personnel utilizing appropriate personal protective equipment (in most cases, a personal monitor). Thus, at any time, if power density measurements were made, we believe the real time measurements would indicate levels below those depicted in the RF emission diagram(s) in this report. By modelling in this way, MobileComm has conservatively shown exclusion areas – areas that should not be entered without the use of a personal monitor, carriers reducing power, or performing real-time measurements to indicate real-time exposure levels.

Use of Generic Antennas

For the purposes of this report, the use of “Generic” as an antenna model, or “Other Carrier” for an operator means the information about a carrier, their FCC license and/or antenna information was not provided and could not be obtained while on site. In the event of unknown information, MobileComm will use our industry specific knowledge of equipment, antenna models, and transmit power to model the site. Information about similar facilities is used when the service is identified and



associated with a particular antenna. If no information is available regarding the transmitting service associated with an unidentified antenna, using the antenna manufacturer's published data regarding the antenna's physical characteristics makes more conservative assumptions.

Where the frequency is unknown, MobileComm uses the closest frequency in the antenna's range that corresponds to the highest Maximum Exposure Limit (MPE), resulting in a conservative analysis.

Appendix B – FCC Guidelines and Emissions Threshold Limits

All power density values used in this report were analyzed as a percentage of current Maximum Permissible Exposure (% MPE) as listed in the FCC OET Bulletin 65 Edition 97-01 and ANSI/IEEE Std C95.1. The FCC regulates Maximum Permissible Exposure in units of microwatts per square centimeter ($\mu\text{W}/\text{cm}^2$). The number of $\mu\text{W}/\text{cm}^2$ calculated at each sample point is called the power density. The exposure limit for power density varies depending upon the frequencies being utilized. Wireless Carriers and Paging Services use different frequency bands each with different exposure limits, therefore it is necessary to report results and limits in terms of percent MPE rather than power density.

All results were compared to the FCC (Federal Communications Commission) radio frequency exposure rules, 47 CFR 1.1307(b)(1) – (b)(3), to determine compliance with the Maximum Permissible Exposure (MPE) limits for General Population/Uncontrolled environments as defined below.

General Population/Uncontrolled exposure limits apply to situations in which the general public may be exposed or in which persons who are exposed as a consequence of their employment may not be made fully aware of the potential for exposure or cannot exercise control over their exposure. Therefore, members of the general public would always be considered under this category when exposure is not employment related, for example, in the case of a telecommunications tower that exposes persons in a nearby residential area.

Public exposure to radio frequencies is regulated and enforced in units of microwatts per square centimeter ($\mu\text{W}/\text{cm}^2$). The general population exposure limit for the 700 and 800 MHz Bands is approximately 467 $\mu\text{W}/\text{cm}^2$ and 567 $\mu\text{W}/\text{cm}^2$ respectively, and the general population exposure limit for the 1900 MHz PCS and 2100 MHz AWS bands is 1000 $\mu\text{W}/\text{cm}^2$. Because each carrier will be using different frequency bands, and each frequency band has different exposure limits, it is necessary to report percent of MPE rather than power density.

Occupational/Controlled exposure limits apply to situations in which persons are exposed as a consequence of their employment and in which those persons who are exposed have been made fully aware of the potential for exposure, have been properly trained in RF safety and can exercise control over their exposure. Occupational/Controlled exposure limits also apply where exposure is of a transient nature as a result of incidental passage through a location where exposure levels may be above general population/uncontrolled limits (see below), as long as the exposed person has been made fully aware of the potential for exposure, have been trained in RF safety and can exercise control over his or her exposure by leaving the area or by some other appropriate means. The Occupational/Controlled exposure limits all utilized frequency bands is five (5) times the FCC's General Public / Uncontrolled exposure limit.

Additional details can be found in FCC OET 65.

Table 1: Limits for Maximum Permissible Exposure (MPE)				
(A) Limits for Occupational/Controlled Exposure				
Frequency Range (MHz)	Electric Field Strength (E) (V/m)	Magnetic Field Strength (H) (A/m)	Power Density (S) (mW/cm ²)	Averaging Time [E] ² , [H] ² , or S (minutes)
0.3-3.0	614	1.63	(100)*	6
3.0-30	1842/f	4.89/f	(900/f ²)*	6
30-300	61.4	0.163	1.0	6
300-1,500	--	--	f/300	6
1,500-100,000	--	--	5	6
(B) Limits for General Public/Uncontrolled Exposure				
Frequency Range (MHz)	Electric Field Strength (E) (V/m)	Magnetic Field Strength (H) (A/m)	Power Density (S) (mW/cm ²)	Averaging Time [E] ² , [H] ² , or S (minutes)
0.3-1.34	614	1.63	(100)*	30
1.34-30	824/f	2.19/f	(180/f ²)*	30
30-300	27.5	0.073	0.2	30
300-1,500	--	--	f/1,500	30
1,500-100,000	--	--	1.0	30

Appendix C – Rules & Regulations

Explanation of Applicable Rules and Regulations

FCC has set forth guidelines in OET Bulletin 65 for human exposure to radio frequency electromagnetic fields. Currently, there are two different levels of MPE - General Public MPE and Occupational MPE. An individual classified as Occupational can be defined as an individual who has received appropriate RF training and meets the conditions outlined below. General Public is defined as anyone who does not meet the conditions of being Occupational. FCC Rules and Regulations define compliance in terms of total exposure to total RF energy, regardless of location of or proximity to the sources of energy.

It is the responsibility of all licensees to ensure these guidelines are maintained at all times. It is the ongoing responsibility of all licensees composing the site to maintain ongoing compliance with FCC rules and regulations.

A building owner or site manager can use this report as part of an overall RF Health and Safety Policy. It is important for building owners/site managers to identify areas in excess of the General Population MPE and ensure that only persons qualified as Occupational are granted access to those areas.

Occupational Environment Explained

The FCC definition of Occupational exposure limits apply to persons who:

- are exposed to RF energy as a consequence of their employment;*
- have been made aware of the possibility of exposure; and*
- can exercise control over their exposure.*

FCC guidelines go further to state that persons must complete RF Safety Awareness training and must be trained in the use of appropriate personal protective equipment.

In order to consider this site an Occupational Environment, the site must be controlled to prevent access by any individuals classified as the General Public. Compliance is also maintained when any non-occupational individuals (the General Public) are prevented from accessing areas indicated as Red or Yellow in the attached RF Emissions diagram. In addition, a person must be aware of the RF environment into which they are entering. This can be accomplished by an RF Safety Awareness class, and by appropriate written documentation such as this Site Compliance Report.

Appendix D – General Safety Recommendations

The following are general recommendations appropriate for any site with accessible areas in excess of 100% General Public MPE. These recommendations are not specific to this site. These are safety recommendations appropriate for typical site management, building management, and other tenant operations.

1. All individuals needing access to the main site should be instructed to read and obey all posted placards and signs.
2. The site should be routinely inspected and this or similar report updated with the addition of any antennas or upon any changes to the RF environment including:
 - adding new antennas that may have been located on the site
 - removing of any existing antennas
 - changes in the radiating power or number of RF emitters
3. Post the appropriate SAFETY INSTRUCTIONS, NOTICE, CAUTION & WARNING sign at the main site access point(s) and other locations as required. Note: Please refer to RF Exposure Diagrams in Appendix B, to inform everyone who has access to this site that beyond posted signs there may be levels in excess of the limits prescribed by the FCC. The signs below are examples of signs meeting FCC guidelines.



4. Ensure that the site door remains locked (or appropriately controlled) to deny access to the general public if deemed as policy by the building/site owner.
5. For a General Public environment the five color levels identified in predicted RF emission diagram can be interpreted in the following manner:
 - White represents areas predicted to be greater than or equal to 0% and less than 5% of the MPE general public limits
 - Green represents areas predicted to be greater than or equal to 5% and less than 100% of the MPE general public limits
 - Blue represents areas predicted to be greater than or equal to 100% and lesser than 500% of the MPE general public limits.
 - Yellow represents areas predicted to be greater than or equal to 500% and lesser than 5000% of the MPE general public limits.
 - Red areas indicates predicted levels greater than or equal to 5000% of the MPE general public limits.
6. All persons (arborist, landscapers, construction/utility workers, etc.) that are accessing adjacent elevated surfaces that exceed the General Public (GP) limits MPE must be made aware of these potential exceedances and their fields, where applicable.

Appendix E – References

1 - FCC Definition

FCC defines an Occupational or Controlled environment as one where persons are exposed to RF fields as a consequence of their employment and where those persons exposed have been made fully aware of the potential for exposure and can exercise control over their exposure. Typical criteria for an Occupational or Controlled environment is restricted access (i.e. locked doors, gates, etc.) to areas where antennas are located coupled with proper RF warning signage.

FCC defines a site as a General Public or Uncontrolled environment when human exposure to RF fields occurs to the general public or in which persons who are exposed as a consequence of their employment may not be fully aware of the potential for exposure or cannot exercise control over the exposure. Typical criteria for a General Public or Uncontrolled environment are unrestricted access (i.e. unlocked or no restrictions) to areas where antennas are located without proper RF warning signage being posted.

2 - Physical Testing measurement procedure and Tools

The Narda Broadband Field Meter NBM-550 can make rapid conformance measurements with evaluation in the time domain when used in conjunction EA5091 probe. This probe is a so-called Shaped Probe, i.e. it is frequency weighted so that it automatically takes account of the FCC Occupational limit values. To collect data, the probe is pointed towards the potential source(s) of EME radiation and moved slowly from ground level up to slightly above head height (approx. 6 ft).

Spatial Average Measurement A technique used to average a minimum of ten (10) measurements taken in a ten (10) second interval from zero (0) to six (6) feet. This measurement is intended to model the average energy an average sized human body will absorb while present in an electromagnetic field of energy.

3 - Site Safety Procedures

The following items are general safety recommendations that should be administered on a site by site basis as needed by the carrier.

General Maintenance Work: *Any maintenance personnel required to work immediately in front of antennas and / or in areas indicated as above 100% of the Occupational MPE limits should coordinate with the wireless operators to disable transmitters during their work activities.*

Training and Qualification Verification: *All personnel accessing areas indicated as exceeding the General Population MPE limits should have a basic understanding of EME awareness and RF Safety procedures when working around transmitting antennas. Awareness training increases a workers understanding to potential RF exposure scenarios. Awareness can be achieved in a number of ways (e.g. videos, formal classroom lecture or internet based courses).*

Physical Access Control: Access restrictions to transmitting antennas locations is the primary element in a site safety plan. Examples of access restrictions are as follows:

- Locked door or gate
- Alarmed door
- Locked ladder access

- Restrictive Barrier at antenna locations (e.g. Chain link with posted RF Sign)

RF Signage: *Everyone should obey all posted signs at all times. RF signs play an important role in properly warning a worker prior to entering into a potential RF Exposure area.*

Assume all antennas are active: *Due to the nature of telecommunications transmissions, an antenna transmits intermittently. Always assume an antenna is transmitting. Never stop in front of an antenna. If you have to pass by an antenna, move through as quickly and safely as possible thereby reducing any exposure to a minimum.*

Maintain a 3 foot clearance from all antennas: *There is a direct correlation between the strength of an EME field and the distance from the transmitting antenna. The further away from an antenna, the lower the corresponding EME field is.*

Rooftop RF Emissions Diagram: *Section 4 of this report contains an RF Emissions Diagram that outlines various theoretical Maximum Permissible Exposure (MPE) areas on the rooftop. This analysis is all theoretical and a worst case scenario. This analysis is based on one of two access control criteria: General Public criteria means the access to the site is uncontrolled and anyone can gain access. Occupational criteria means the access is restricted and only properly trained individuals can gain access to the antenna locations.*

4 - Definitions

5% Rule - *The rules adopted by the FCC specify that, in general, at multiple transmitter sites actions necessary to bring the area into compliance with the guidelines are the shared responsibility of all licenses whose transmitters produce field strengths or power density levels at the area in the question in excess of 5% of the exposure limits. In other words, any wireless operator that contributes 5% or greater of the MPE limit in the area corrective actions to bring the site into compliance.*

Compliance- *The determination of whether a site is safe or not with regards to Human Exposure to Radio Frequency Radiation from transmitting antennas.*

Decibel (dB) – *A unit for measuring power or strength of a signal.*

Duty Cycle – *The percent of pulse duration to the pulse period of a periodic pulse train. Also, may be a measure of the temporal transmission characteristic of an intermittently transmitting RF source such as a paging antenna by dividing average transmission duration by the average period for transmission. A duty cycle of 100% corresponds to continuous operation.*

Effective (or Equivalent) Isotropic Radiated Power (EIRP) – *The product of the power supplied to the antenna and the antenna gain in a given direction relative to an isotropic antenna, this product is divided by the cable losses*

Effective Radiated Power (ERP) – *In a given direction, the relative gain of a transmitting antenna with respect to the maximum directivity of a half wave dipole multiplied by the net power accepted by the antenna from the connecting transmitter.*

Gain (of an antenna in dbd) – *The ratio of the maximum intensity in a given direction to the maximum radiation in the same direction from a reference dipole. Gain is a measure of the relative efficiency of a directional antennas as compared to a reference dipole.*

General Population/Uncontrolled Environment – *Defined by the FCC, as an area where RFR exposure may occur to persons who are unaware of the potential for exposure and who have no control of their exposure. General Population is also referenced as General Public.*

Generic Antenna – *For the purposes of this report, the use of “Generic” as an antenna model means the antenna information was not provided and could not be obtained while on site. In the event of unknown information, MobileComm will use our industry specific knowledge of antenna models to select a worst case scenario antenna to model the site.*

Isotropic Antenna – *An antenna that is completely non-directional. In other words, an antenna that radiates energy equally in all directions.*

Maximum Measurement – *This measurement represents the single largest measurement recorded when performing a spatial average measurement.*

Maximum Exposure Limit (MPE) – *The RMS and peak electric and magnetic field strength, their squares, or the plane-wave equivalent power densities associated with these fields to which a person may be exposed without harmful effect and with acceptable safety factor.*

Occupational/Controlled Environment – *Defined by the FCC, as an area where Radio Frequency Radiation (RFR) exposure may occur to persons who are aware of the potential for exposure as a condition of employment or specific activity and can exercise control over their exposure.*

Radio Frequency Radiation – *Electromagnetic waves that are propagated from antennas through space.*

Spatial Average Measurement – *A technique used to average a minimum of ten (10) measurements taken in a ten (10) second interval from zero (0) to six (6) feet. This measurement is intended to model the average energy an average sized human body will absorb while present in an electromagnetic field of energy.*

Transmitter Power Output (TPO) – *The radio frequency output power of a transmitter’s final radio frequency stage as measured at the output terminal while connected to a load.*



Appendix F – Proprietary Statement

This report was prepared for the use of AT&T Mobility, LLC to meet requirements specified in AT&T's corporate RF safety guidelines. It was performed in accordance with generally accepted practices of other consultants undertaking similar studies at the same time and in the same locale under like circumstances. The conclusions provided by MobileComm are based solely on the information provided by AT&T Mobility and all observations in this report are valid on the date of the investigation. Any additional information that becomes available concerning the site should be provided to MobileComm so that our conclusions may be revised and modified, if necessary. This report has been prepared in accordance with Standard Conditions for Engagement and authorized proposal, both of which are integral parts of this report. No other warranty, expressed or implied, is made.