

E-21-0370

Trench 30' 4" conduit from pole to CTL HH. Remove and replace (3) sidewalk panels (125' Sq ft concrete).

CTL HH

Pole

City of Puyallup  
Development & Permitting Services  
ISSUED PERMIT

Building	Planning
Engineering	Public Works
Fire	Traffic

2508 7th St SE

7th St SE

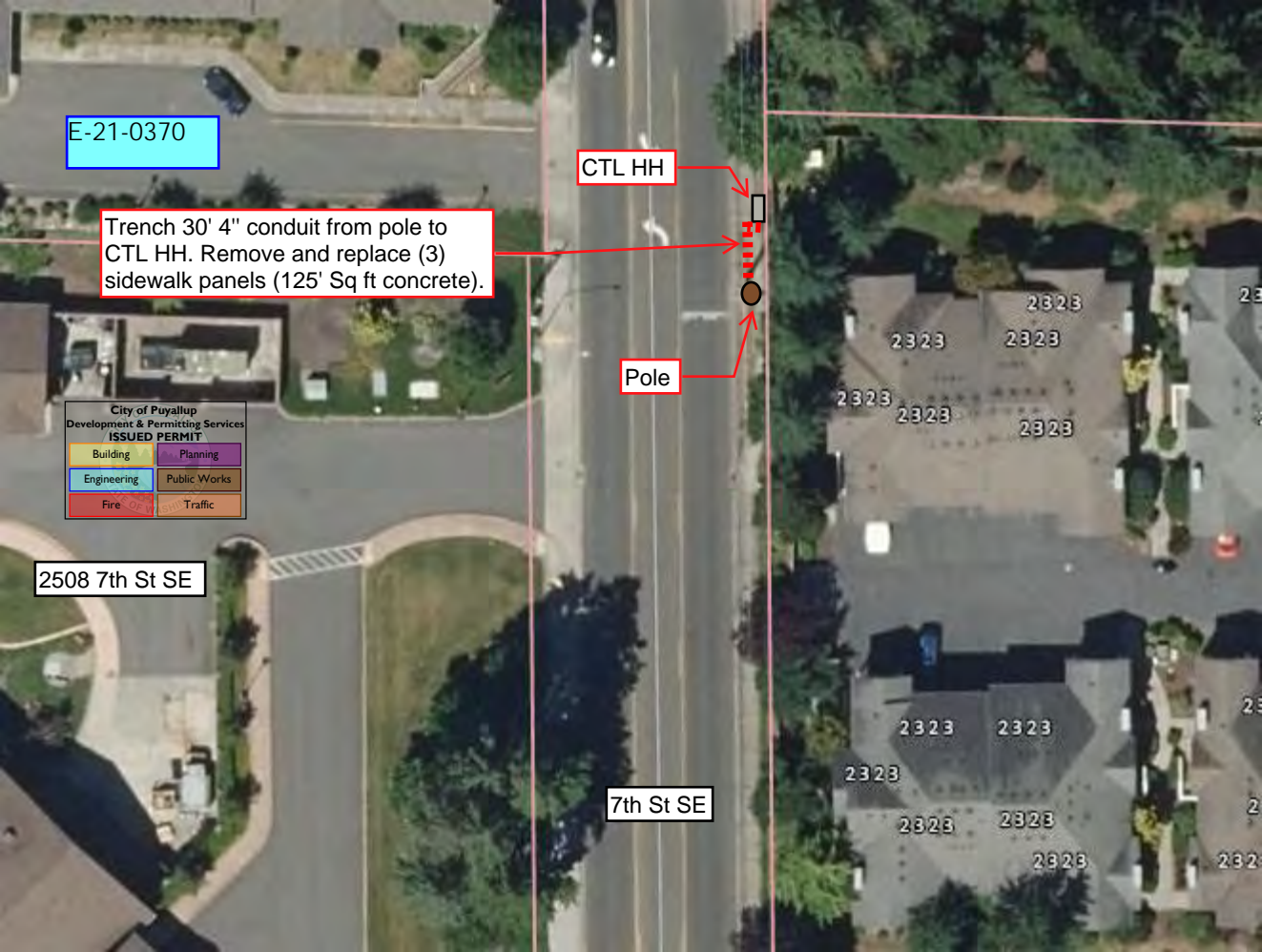

# Site Survey For: 2508 7TH ST SE, PUYALLUP, WA 98374, USA

E-21-0370



## WORK LOCATION

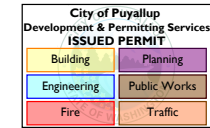

### NARRATIVE / SPECIAL REMARKS

**EQUIPMENT:**  
 (1) WALL MOUNTED AC CONFIGURED CIENA 3916, (1) WALL MOUNTED FDP, 500' 24 FOC.

**FIBER:**  
 POF: AT MH180, SPLICE LPU10,771-772 FROM 72CT [HR25] INTO 24CT [HR67]. COUNT WILL FALL TO HH2307. AT HH2307, SPLICE COUNT INTO A NEW 24CT AND PLACE THROUGH EXISTING CONDUIT TO POLE 567439-155623/A1550311. AT POLE 567439-155623/A1550311, RISE UP AND PLACE AERIAL TO POLE A1563234. AT POLE A1563234, LEAVE 100' LOOP AND DIP DOWN POLE AND CONTINUE TO PULL FIBER THROUGH EXISTING CONDUIT INTO MPOP. AT MPOP, TERMINATE ON A NEW FDP AND USE COUNT TO TURN UP A NEW SWITCH. CUSTOMER HANDOFF: ELECTRICAL

**CUSTOMER REQUIREMENTS:**  
 NONE

**PERMIT:**  
 CITY OF PUYALLUP/4 WEEKS/SPLICING ALONG 23RD AVE SE IN MH180, ALONG 7TH ST SE IN HH2307, AERIAL PLACEMENT ALONG 7TH ST SE FOR 1 SPAN CROSSING ROAD.

### HELD ORDER INFORMATION

**SERVICE ORDER #:** N.868610

**CUSTOMER NAME:** LIFE CARE CENTERS OF AMERICA  
 LIFE CARE CENTERS OF AMERICA CONTACT: DAANYAH LACY, (469) 872-5087, DLACY@CAROUSELINDUSTRIES.COM  
 ALT LCON NAME: ELIZABETH DAVIES, (253) 661-5948, ELIZABETH\_DAVIES@LCCA.COM  
 FIBER ENGINEER CONTACT: CARLA DESPRES, (253) 229-2155, CARLA.DESPRES@LUMEN.COM

**CUSTOMER ADDRESS:**  
 LIFE CARE CENTERS OF AMERICA  
 2508 7TH ST SE, PUYALLUP, WA 98374, USA

### ASSOCIATES PROJECTS

LIST ALL ASSOCIATED PROJECTS:

Rev 0 - Revised CAD  
 Rev Date - 05/18/2021  
 Reviewed by - Nadim Serhal

SITE LOCATION ID #:

### MISC. INFORMATION

RIGHT OF WAY REQUIRED: NO  
 STATE PERMITS REQUIRED: NO  
 COUNTY PERMITS REQUIRED: NO  
 CITY PERMITS REQUIRED: YES

ADDITIONAL PERMIT INFORMATION:

ADDITIONAL PERMIT INFORMATION:

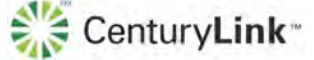

Project Description: LIFE CARE CENTERS OF AMERICA		Engineering Contact	Name: CARLA DESPRES Phone Number: (253) 229-2155	TOWNSHIP:	19N
Project #: N.868610	WC CLI: PYLPWA01	Contact Engineer	Name: JERRAD SUMNER Phone Number: (509) 607-1137	RANGE:	04E
Community Name: PUYALLUP		Construction Coordinator	Name: DAVID MONTGOMERY Phone Number: (253) 221-0192	SECTION:	03
Exchange Key:	Remote Switch Key:	Revision Number:	Revision Date:	SHEET NUMBER: SHEET 01 OF 05	

CONFIDENTIAL - Disclose and Distribute Soley to CTL Employees Having a Need to Know

# MARGIN LABELS

E-21-0370 Approved Resub

City of Puyallup Development & Permitting Services ISSUED PERMIT	
Building	Planning
Engineering	Public Works
Fire	Traffic

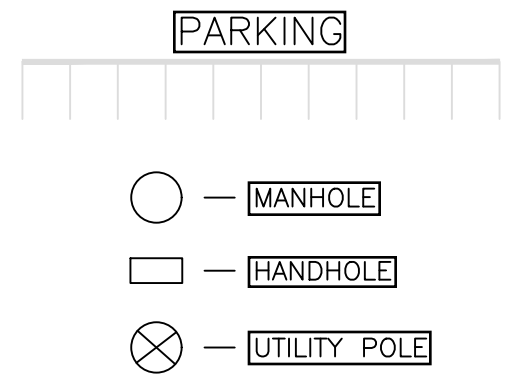
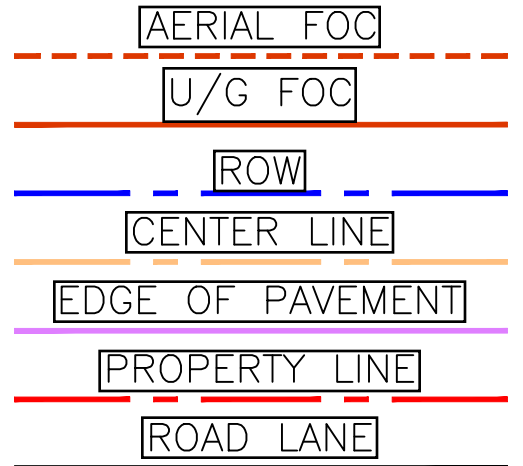
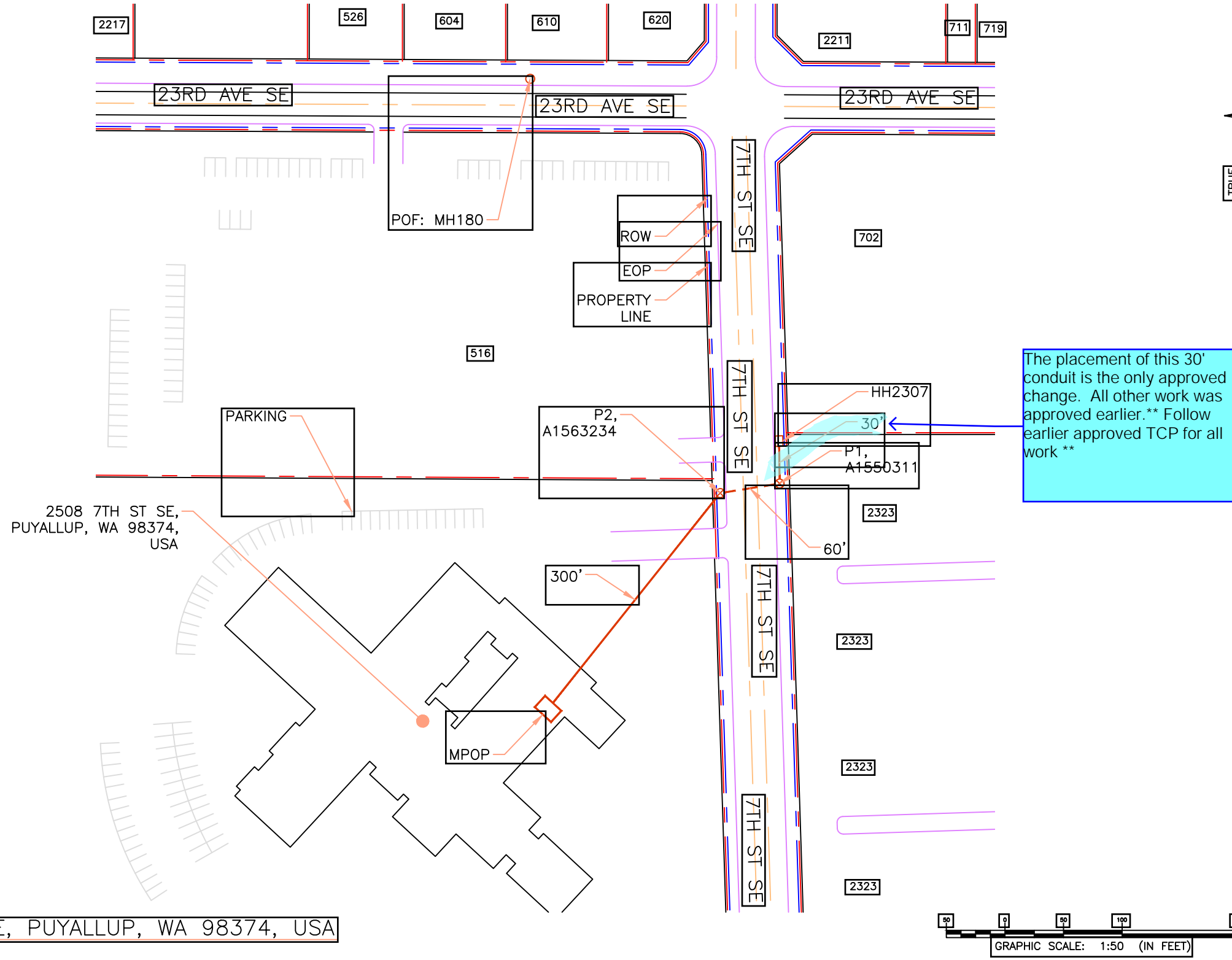

The placement of this 30' conduit is the only approved change. All other work was approved earlier. \*\* Follow earlier approved TCP for all work \*\*

**SITE OVERVIEW**  
2508 7TH ST SE, PUYALLUP, WA 98374, USA  
SCALE: 1:50

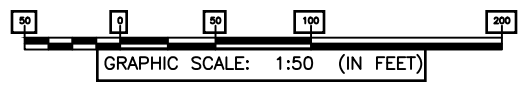

Project Description: LIFE CARE CENTERS OF AMERICA		Engineering Contact	Name: CARLA DESPRES Phone Number: (253) 229-2155	TOWNSHIP:	
Project #: N.868610	WC CLI: PYLPWA01	Contact Engineer	Name: JERRAD SUMNER Phone Number: (509) 607-1137	RANGE:	
Community Name: PUYALLUP		Construction Coordinator	Name: DAVID MONTGOMERY Phone Number: (253) 221-0192	SECTION:	CONFIDENTIAL - Disclose and Distribute Soley to CTL Employees Having a Need to Know
Exchange Key:	Remote Switch Key:	Revision Number:	Revision Date:	SHEET NUMBER:	SHEET 02 OF 05

MARGIN LABELS

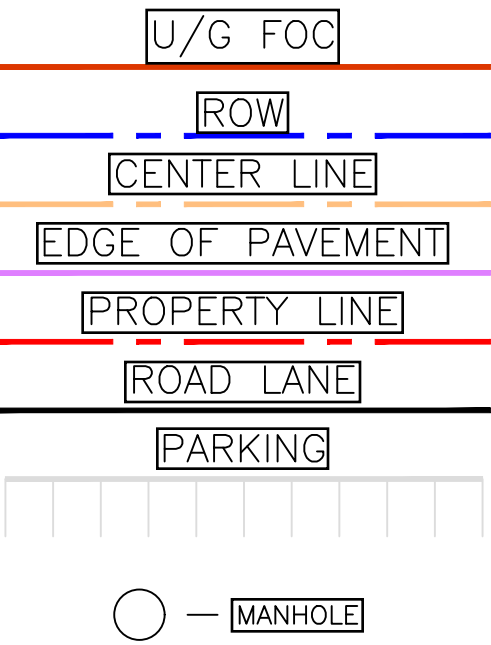

E-21-0370

City of Puyallup  
Development & Permitting Services  
**ISSUED PERMIT**

Building	Planning
Engineering	Public Works
Fire	Traffic

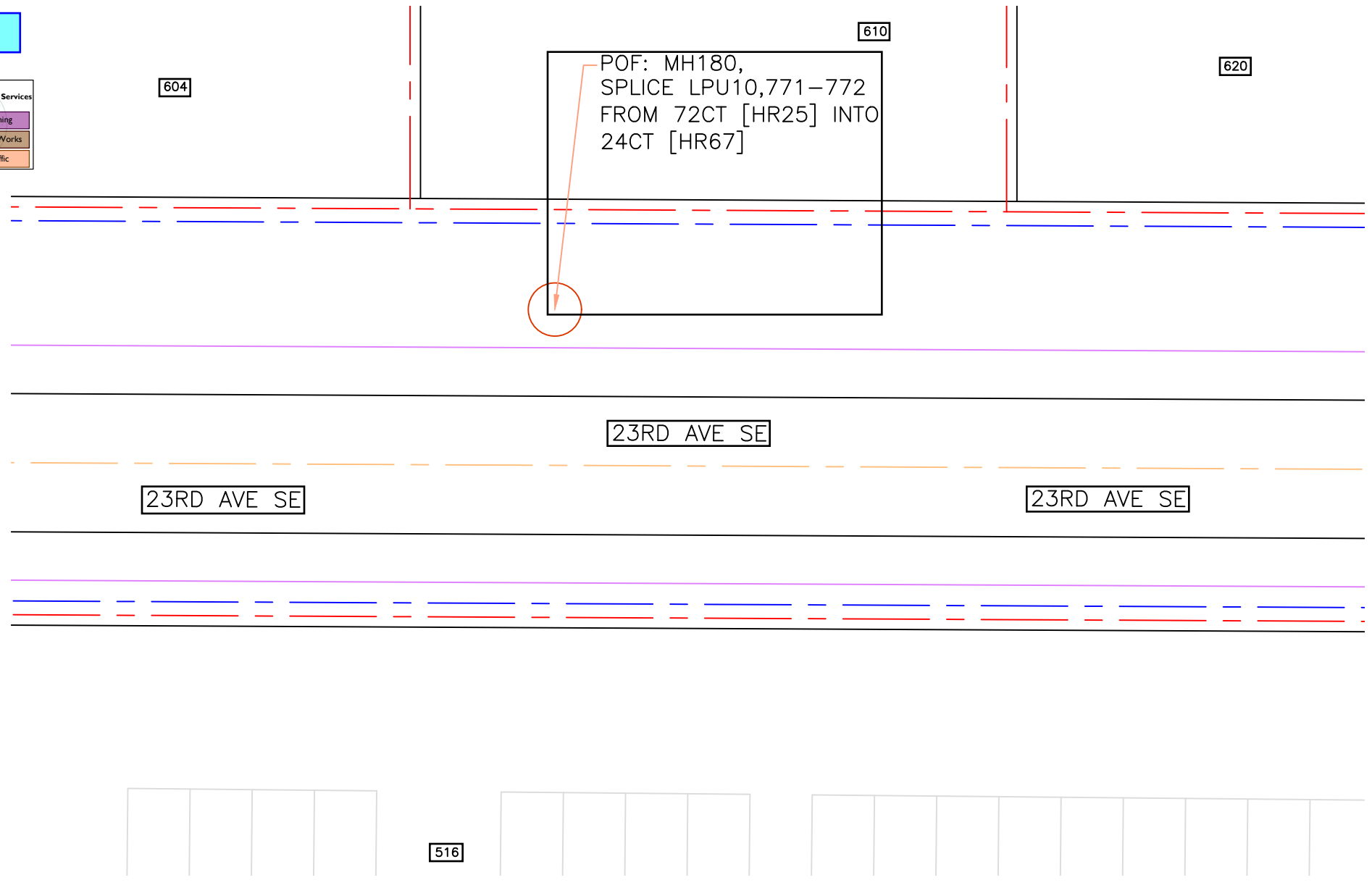

POF: MH180,  
SPLICE LPU10,771-772  
FROM 72CT [HR25] INTO  
24CT [HR67]

**POF: MH VIEW**  
SCALE: 1:10

**NEXIUS**  
ACCELERATING NETWORK & BUSINESS TRANSFORMATION  
11241 WILLOWS RD NE  
REDMOND, WA 98052

Project Description: LIFE CARE CENTERS OF AMERICA		Engineering Contact	Name: CARLA DESPRES Phone Number: (253) 229-2155	TOWNSHIP: 19N	<p><b>CenturyLink™</b></p>
Project #: N.868610	WC CLI: PYLPWA01	Contact Engineer	Name: JERRAD SUMNER Phone Number: (509) 607-1137	RANGE: 04E	
Community Name: PUYALLUP		Construction Coordinator	Name: DAVID MONTGOMERY Phone Number: (253) 221-0192	SECTION: 03	<p>CONFIDENTIAL - Disclose and Distribute Soley to CTL Employees Having a Need to Know</p>
Exchange Key:	Remote Switch Key:	Revision Number:	Revision Date:	SHEET NUMBER: SHEET 03 OF 05	

# MARGIN LABELS

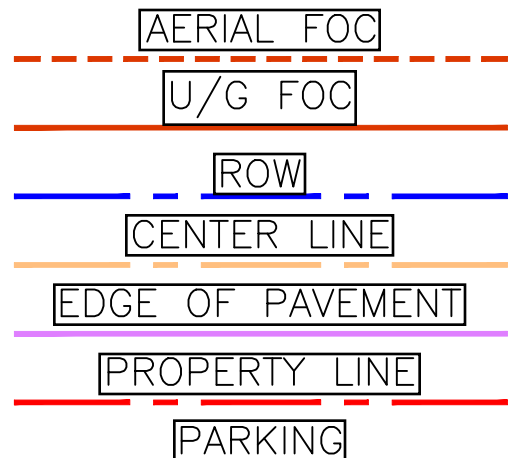

- HANDHOLE
- UTILITY POLE

POLE 1,  
PSE 567439-155234  
A1550311  
NEUTRAL HEIGHT 34'4"  
SECONDARY 27'5"  
016 24'6"  
004 23'5"  
005 20'5"  
ATTACH HEIGHT 20'5"  
OVERLASH

POLE 2,  
A1563234  
004 23'8"  
005 22'6"  
ATTACH HEIGHT 22'6"  
OVERLASH

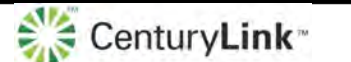

**CONFIDENTIAL - Disclose and Distribute Soley to CTL Employees Having a Need to Know**

SHEET NUMBER: SHEET 04 OF 05

E-21-0370

City of Puyallup  
Development & Permitting Services  
**ISSUED PERMIT**

Building	Planning
Engineering	Public Works
Fire	Traffic

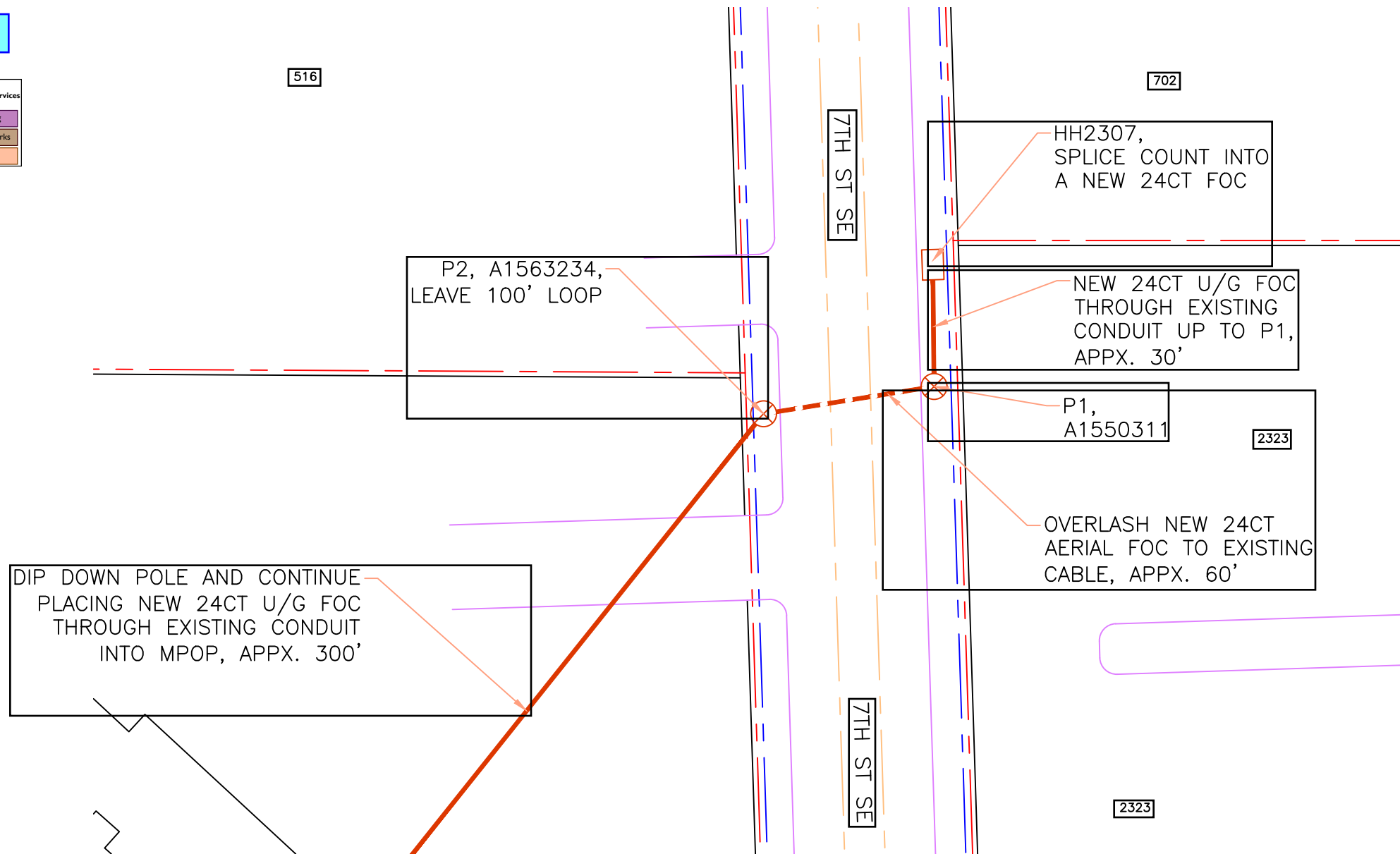

**HH/POLE VIEW**  
SCALE: 1:20

Project Description: LIFE CARE CENTERS OF AMERICA

Project #: N.868610

Community Name: PUYALLUP

Exchange Key:

WC CLI: PYLPWA01

Remote Switch Key:

Engineering Contact	Name: CARLA DESPRES Phone Number: (253) 229-2155	TOWNSHIP: 19N
Contact Engineer	Name: JERRAD SUMNER Phone Number: (509) 607-1137	RANGE: 04E
Construction Coordinator	Name: DAVID MONTGOMERY Phone Number: (253) 221-0192	SECTION: 03

Revision Number:	Revision Date:
----	----
----	----

MARGIN LABELS

E-21-0370

City of Puyallup Development & Permitting Services ISSUED PERMIT	
Building	Planning
Engineering	Public Works
Fire	Traffic



U/G FOC

PARKING

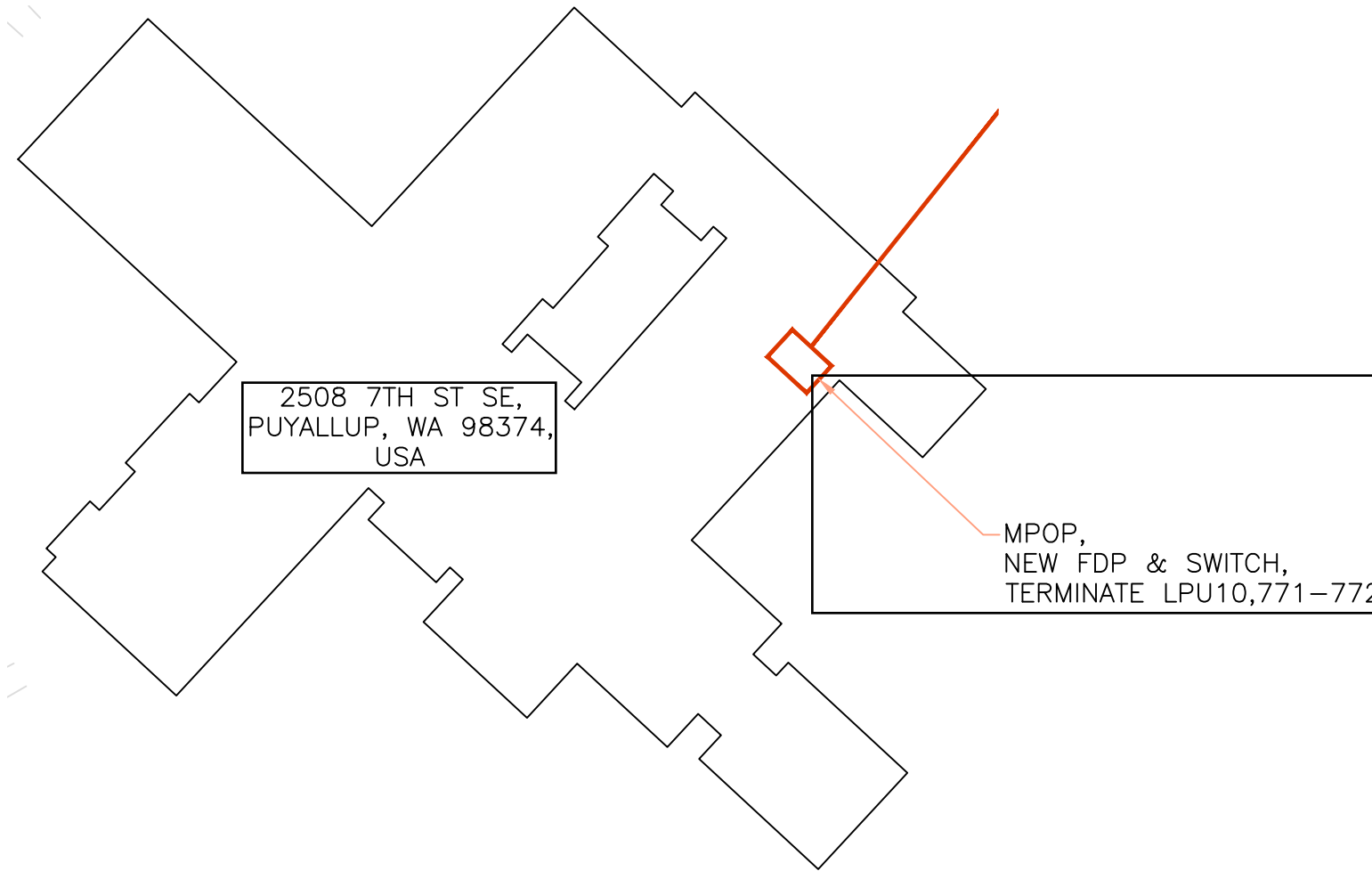

**BUILDING VIEW**  
SCALE: 1:30



Project Description: LIFE CARE CENTERS OF AMERICA		Engineering Contact	Name: CARLA DESPRES Phone Number: (253) 229-2155	TOWNSHIP: 19N	
Project #: N.868610	WC CLLI: PYLPWA01	Contact Engineer	Name: JERRAD SUMNER Phone Number: (509) 607-1137	RANGE: 04E	
Community Name: PUYALLUP		Construction Coordinator	Name: DAVID MONTGOMERY Phone Number: (253) 221-0192	SECTION: 03	CONFIDENTIAL - Disclose and Distribute Soley to CTL Employees Having a Need to Know
Exchange Key:	Remote Switch Key:	Revision Number:	Revision Date:	SHEET NUMBER: SHEET 05 OF 05	