

PORTION OF THE S 1/2 OF SEC 26 AND N 1/2 OF SEC 35 TWP. 20N., RGE. 4 E. W.M. PIERCE COUNTY, WA

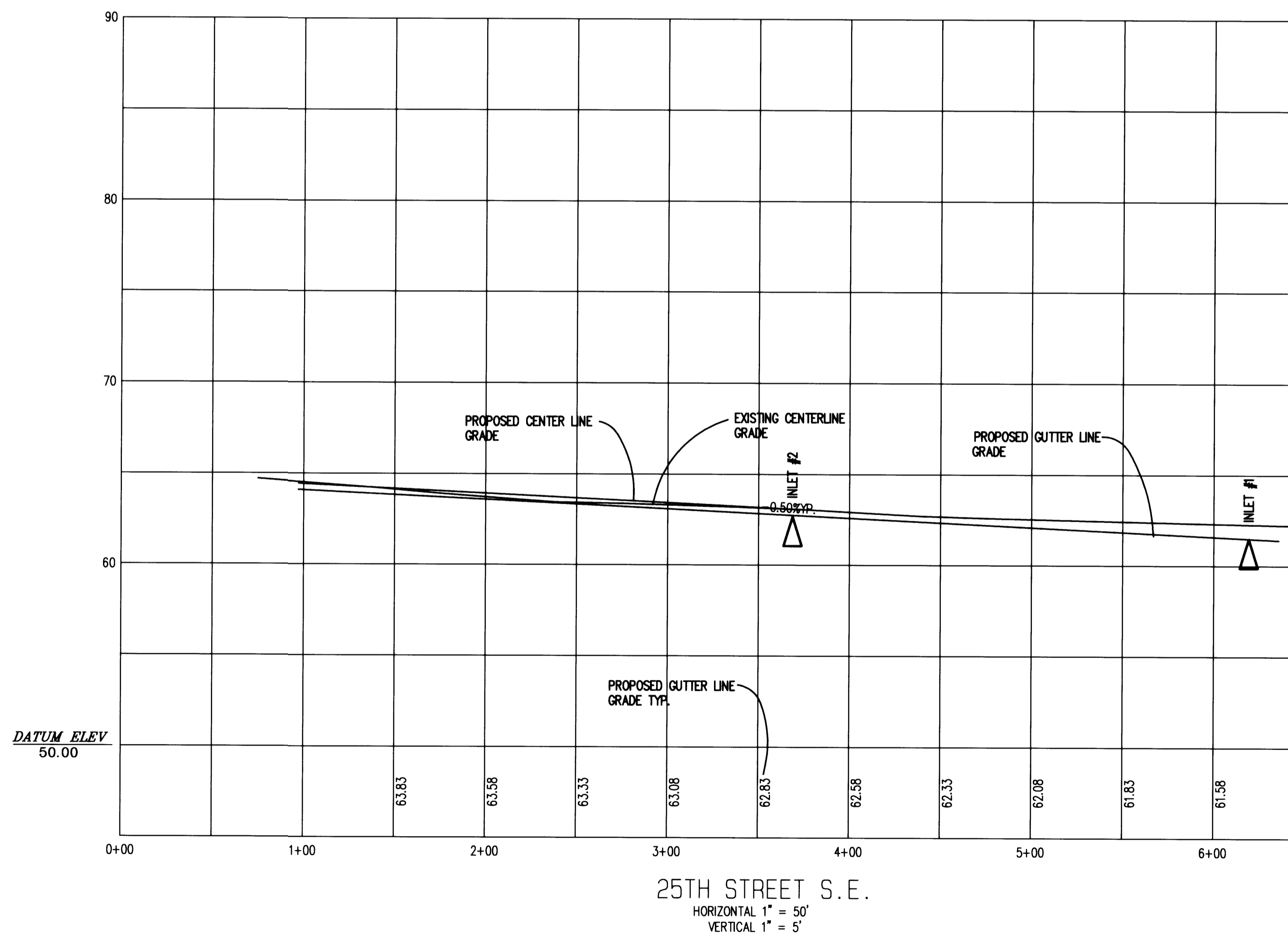
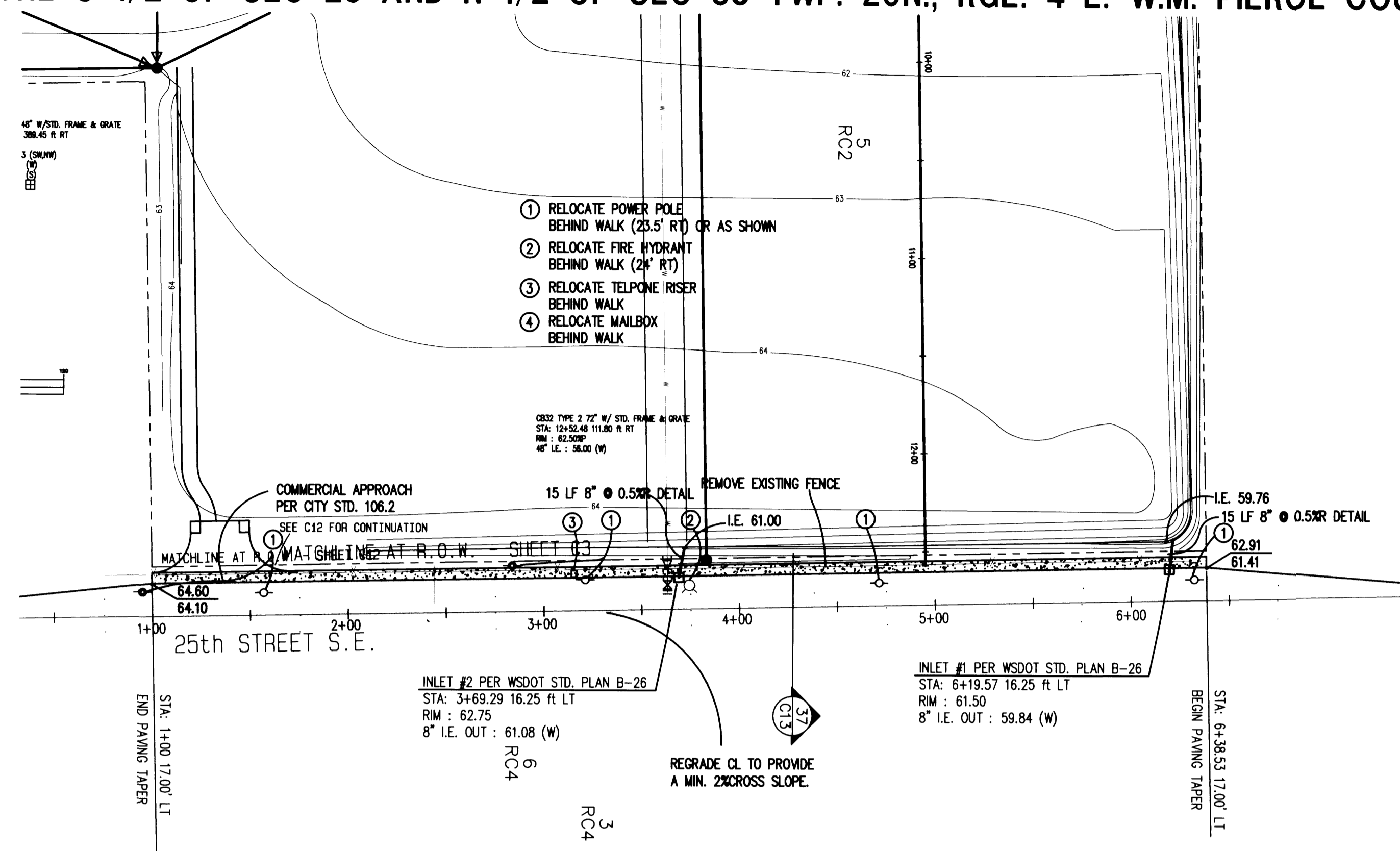

**APPROVED**  
 BY: *[Signature]*  
 CITY OF PUYALLUP  
 CITY ENGINEER  
 DATE: 6/13/00

NOTE:  
 THIS APPROVAL IS VOID AFTER 1 YEAR FROM APPROVAL DATE. THE CITY WILL NOT BE RESPONSIBLE FOR THE ERRORS AND/OR OMISSIONS ON THESE PLANS.  
 FIELD CONDITIONS MAY DICTATE CHANGES TO THESE PLANS AS DETERMINED BY THE CITY ENGINEER.

**BROWN CONNALLY ROWAN ARCHITECTS INC**  
 JEFFREY E. BROWN, PRINCIPAL  
 222 EAST 26th STREET SUITE 106 TACOMA, WA 98421  
 TEL (206)827-4387 FAX (206)827-4395

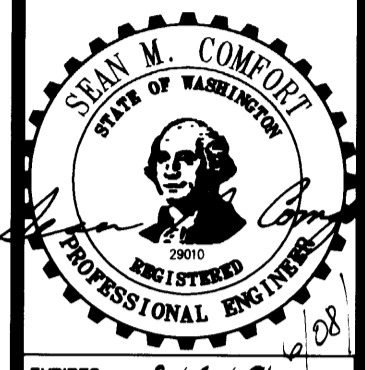

EXPIRES	2/6/01
Scale	
Revisions	

Drawn By	VW	Checked By	SS
----------	----	------------	----

Project No.		Date:	MAY 26, 2000
-------------	--	-------	--------------

Project: **CASCADE CHRISTIAN SCHOOLS**  
 PUYALLUP, WA 98371  
 306 NORTH MERIDIAN

Drawing Title: **ROAD PLAN AND PROFILE**

Sheet No.: **RD1**

CALL 48 HOURS BEFORE YOU DIG  
 1-800-424-5555

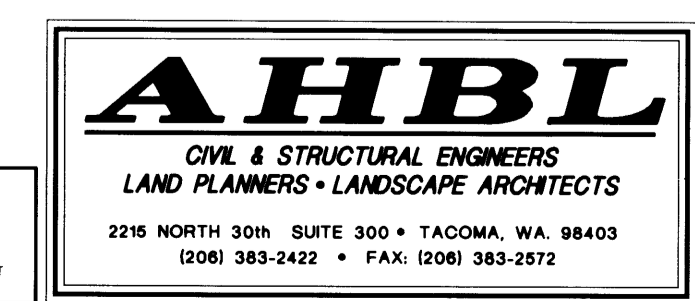

REUSE OF DOCUMENTS  
 THIS DOCUMENT AND THE DESIGN ARE BEING INCORPORATED HEREIN AS AN INSTRUMENT OF PROFESSIONAL SERVICE OF THE PROPERTY OF AHBL AND IS NOT TO BE USED IN WHOLE OR IN PART FOR ANY OTHER PROJECT WITHOUT THE WRITTEN AUTHORIZATION OF AHBL.

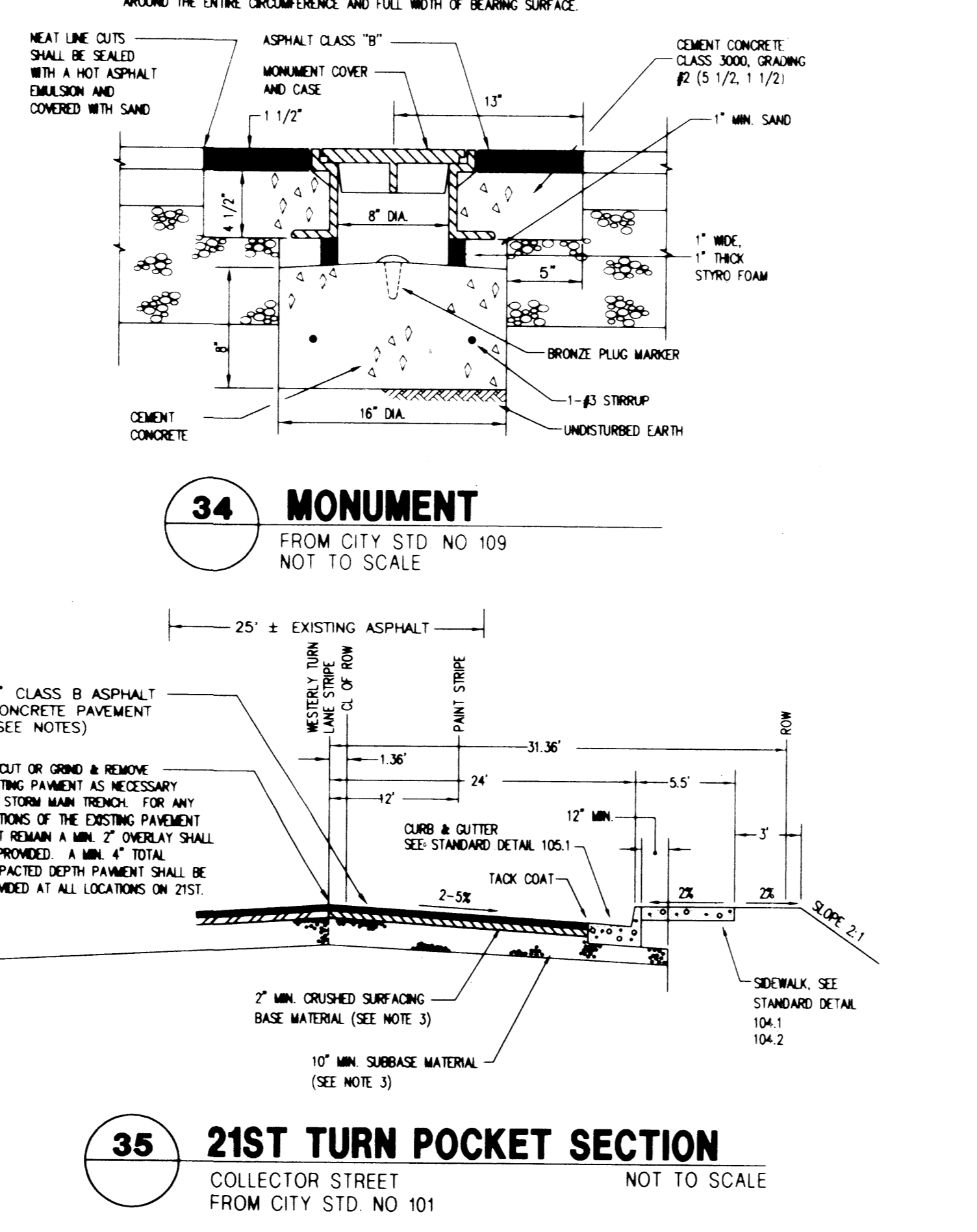
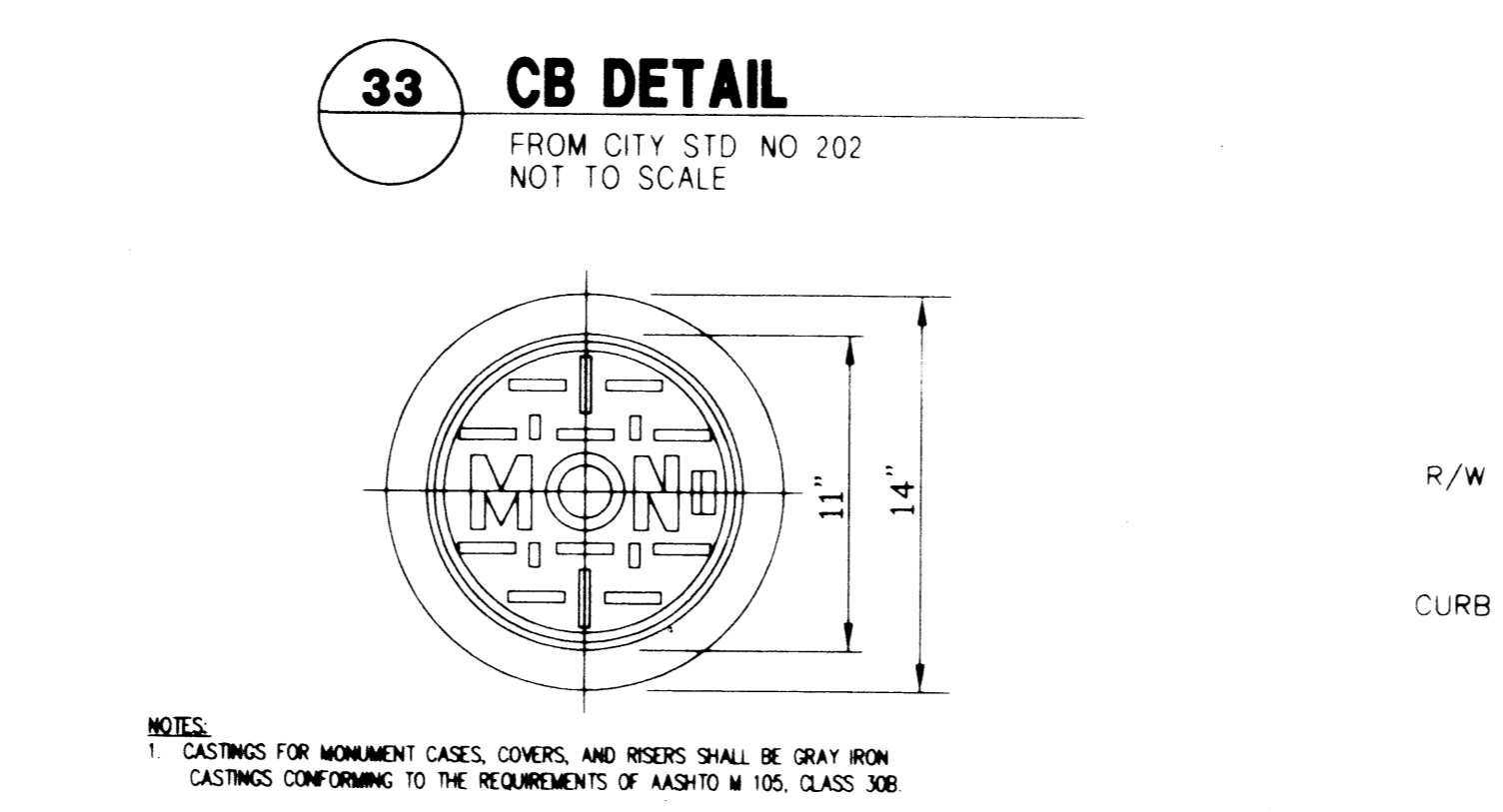
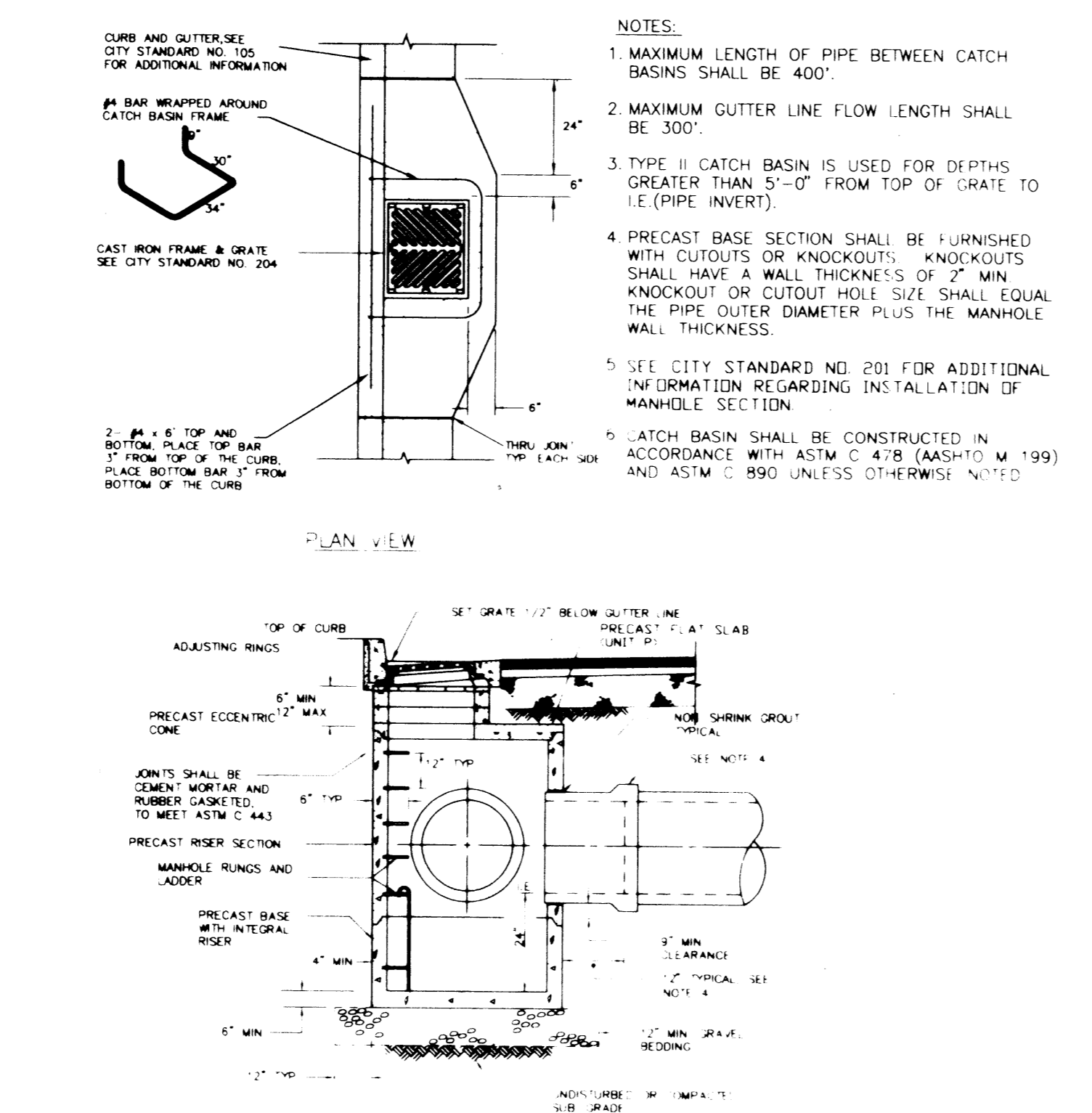
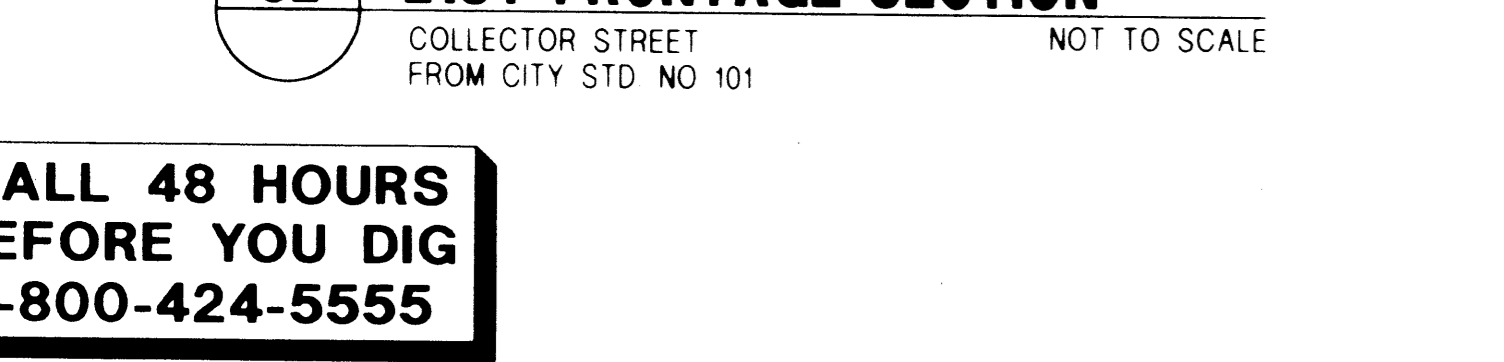
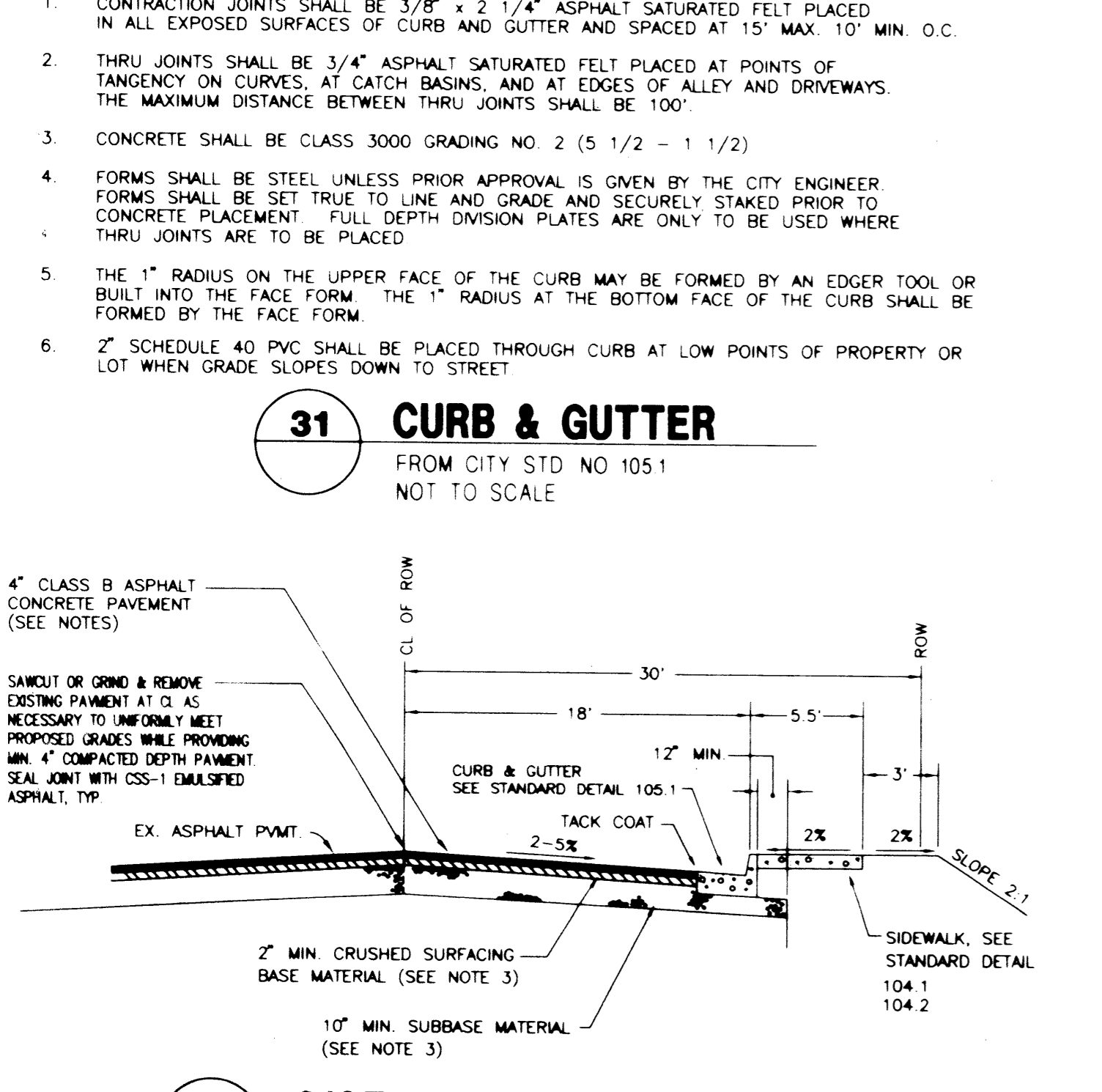
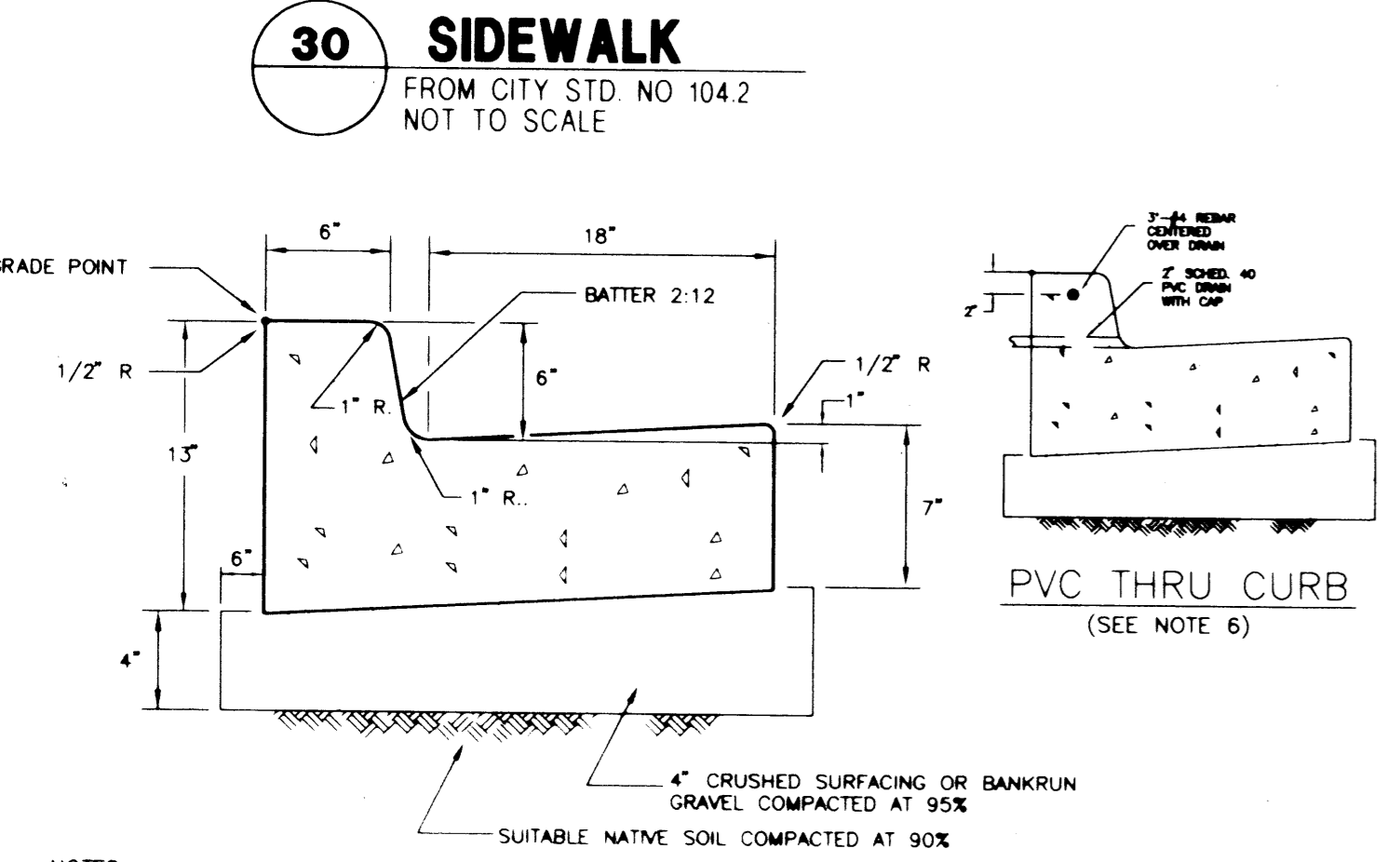
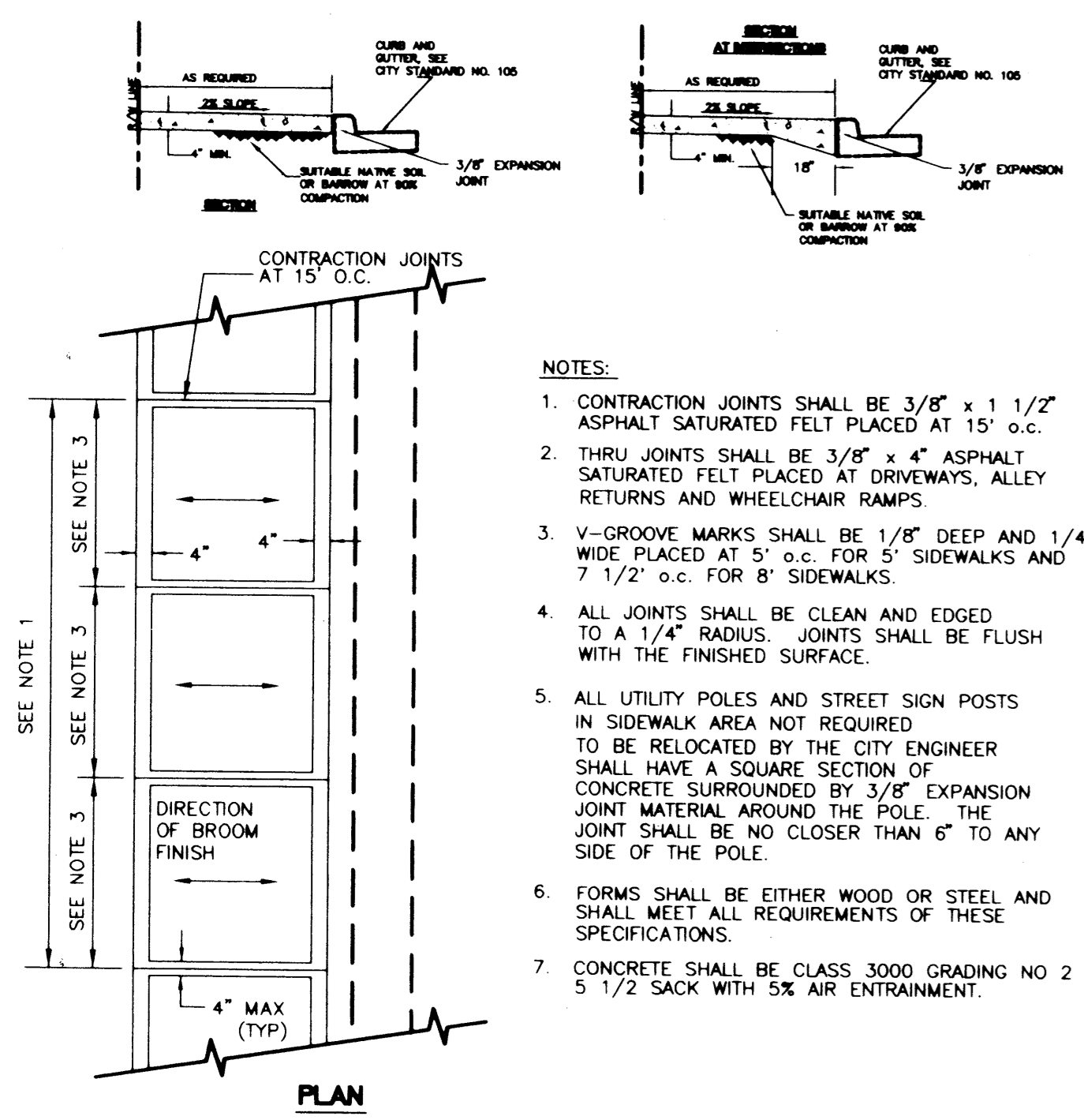

NOTES:  
1. MAXIMUM LENGTH OF PIPE BETWEEN BASINS SHALL BE 400'.  
2. MAXIMUM GUTTER LINE FLOW LENGTH SHALL BE 300'.  
3. TYPE II CATCH BASIN IS USED FOR DEPTHS GREATER THAN 5'-0" FROM TOP OF GRATE TO I.E. (PIPE INVERT).  
4. PRECAST BASE SECTION SHALL BE FURNISHED WITH CUTOUTS OR KNOCKOUTS. KNOCKOUTS SHALL HAVE A WALL THICKNESS OF 2" MIN. KNOCKOUT OR CUTOUT HOLE SIZE SHALL EQUAL THE PIPE OUTER DIAMETER PLUS THE MANHOLE WALL THICKNESS.  
5. SEE CITY STANDARD NO 201 FOR ADDITIONAL INFORMATION REGARDING INSTALLATION OF MANHOLE SECTION.  
6. CATCH BASIN SHALL BE CONSTRUCTED IN ACCORDANCE WITH ASTM C 478 (AASHTO M 199) AND ASTM C 890 UNLESS OTHERWISE NOTED.

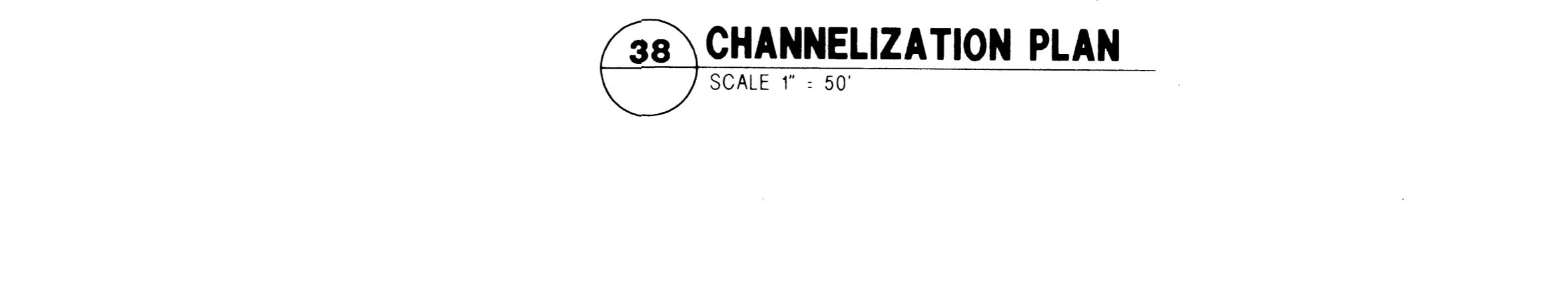
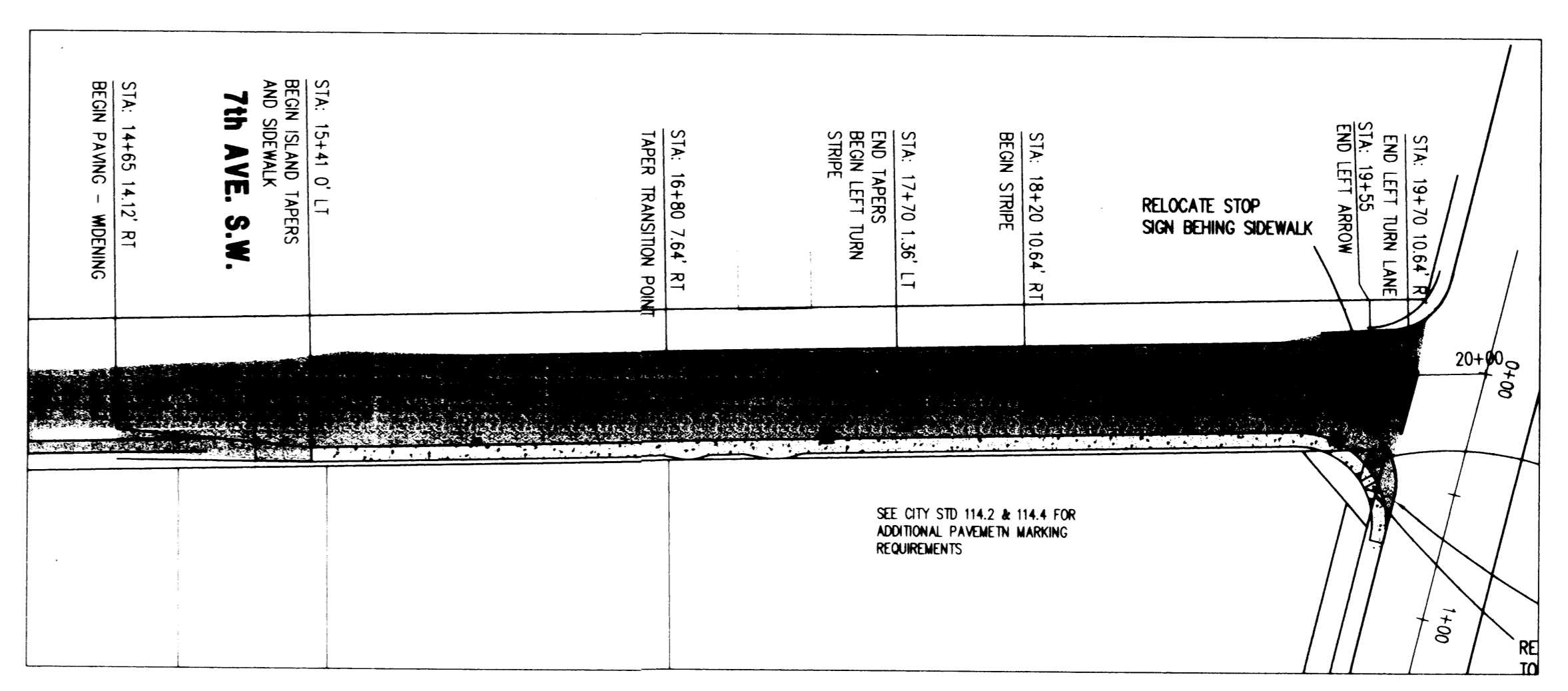

**APPROVED**  
BY: *[Signature]*  
CITY OF PUYALLUP  
CITY ENGINEER  
DATE: 6/13/00  
NOTE: THIS APPROVAL IS VOID AFTER 1 YEAR FROM APPROVAL DATE. THE CITY WILL NOT BE RESPONSIBLE FOR THE ERRORS AND/OR OMISSIONS ON THESE PLANS.  
FIELD CONDITIONS MAY DICTATE CHANGES TO THESE PLANS AS DETERMINED BY THE CITY ENGINEER.

*[Signature]*  
5/26/00

**BROWN CONNALLY ROWAN ARCHITECTS**  
JEFFREY E. BROWN, PRINCIPAL  
222 EAST 26th STREET  
SUITE 106  
TACOMA, WA 98421  
TEL: (206)827-4387  
FAX: (206)827-4395

Drawn By: SMS  
Checked By: SMS  
Project No.:  
Date: MAY 26, 2000

**CASCADE CHRISTIAN SCHOOLS**  
GENERAL NOTES & DETAILS  
Sheet No. **R02**

**CALL 24 HOURS BEFORE YOU DIG**  
1-800-424-5555

**AHBL**  
CIVIL & STRUCTURAL ENGINEERS  
LAND PLANNERS • LANDSCAPE ARCHITECTS  
2215 NORTH 30th • SUITE 300 • TACOMA, WA 98403  
(206) 383-2422 • FAX: (206) 383-2872

REUSE OF DOCUMENTS  
THIS DOCUMENT IS THE PROPERTY OF AHBL AND IS NOT TO BE REPRODUCED OR TRANSMITTED IN ANY FORM OR BY ANY MEANS, ELECTRONIC OR MECHANICAL, INCLUDING PHOTOCOPYING, RECORDING, OR BY ANY INFORMATION STORAGE AND RETRIEVAL SYSTEM, WITHOUT THE WRITTEN PERMISSION OF AHBL.