

PORTION OF THE N 1/2 OF SEC 35 TWP. 20N., RGE. 4 E. W.M. PIERCE COUNTY, WA

**APPROVED**  
 BY: *[Signature]*  
 CITY OF PUYALLUP  
 CITY ENGINEER  
 DATE: 5/22/96  
 NOTE: THIS APPROVAL IS VOID AFTER 1 YEAR FROM APPROVAL DATE.  
 ANY ERRORS AND/OR OMISSIONS ARE NOT THE RESPONSIBILITY OF THE CITY OF PUYALLUP.

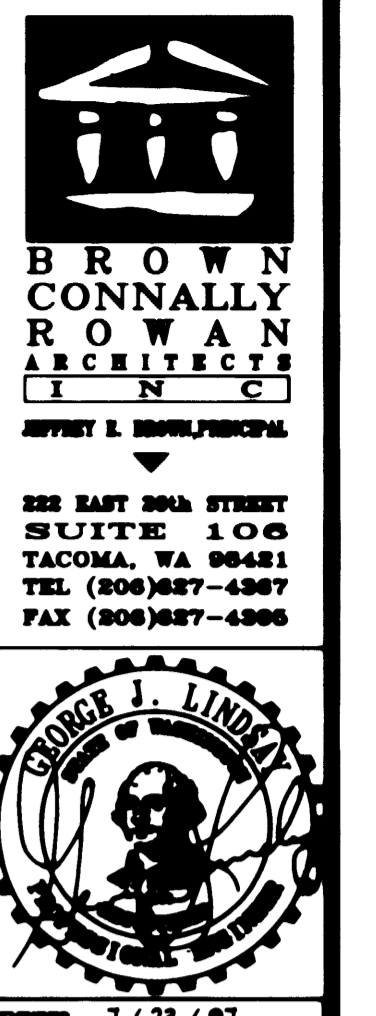

**NOTES:**

- EXISTING UTILITY INFORMATION ON PIONEER WAY HAS BEEN TAKEN FROM CITY DESIGN PLANS AND SHALL BE VERIFIED BY THE CONTRACTOR PRIOR TO CONSTRUCTION. FIELD OBSERVATION INDICATES THAT STORM LINES AND STRUCTURES AT THE FINAL CONNECTION ON THE NORTH SIDE OF PIONEER WAY ARE NOT EXACTLY AS SHOWN. THE CONTRACTOR SHALL NOTIFY THE ENGINEER OF PIPE SIZES AND SLOPES FROM THE CONNECTION POINT TO DEER CREEK. PRIOR TO CONSTRUCTION.
- OTHER EXISTING UTILITIES ARE PRESENT AND ARE LIKELY TO CONFLICT WITH THE PROPOSED STORM CROSSING ON PIONEER WAY. CONTRACTOR SHALL PROTECT EX. UTILITIES. CONTRACTOR SHALL NOTIFY THE ENGINEER AND COORDINATE RELOCATIONS WITH THE OWNERS OF THESE UTILITIES AS NECESSARY.
- STIPING SHALL BE PROVIDED PER CITY STANDARD NO. 114.4 AT LOCATIONS SHOWN ON THIS PLAN.

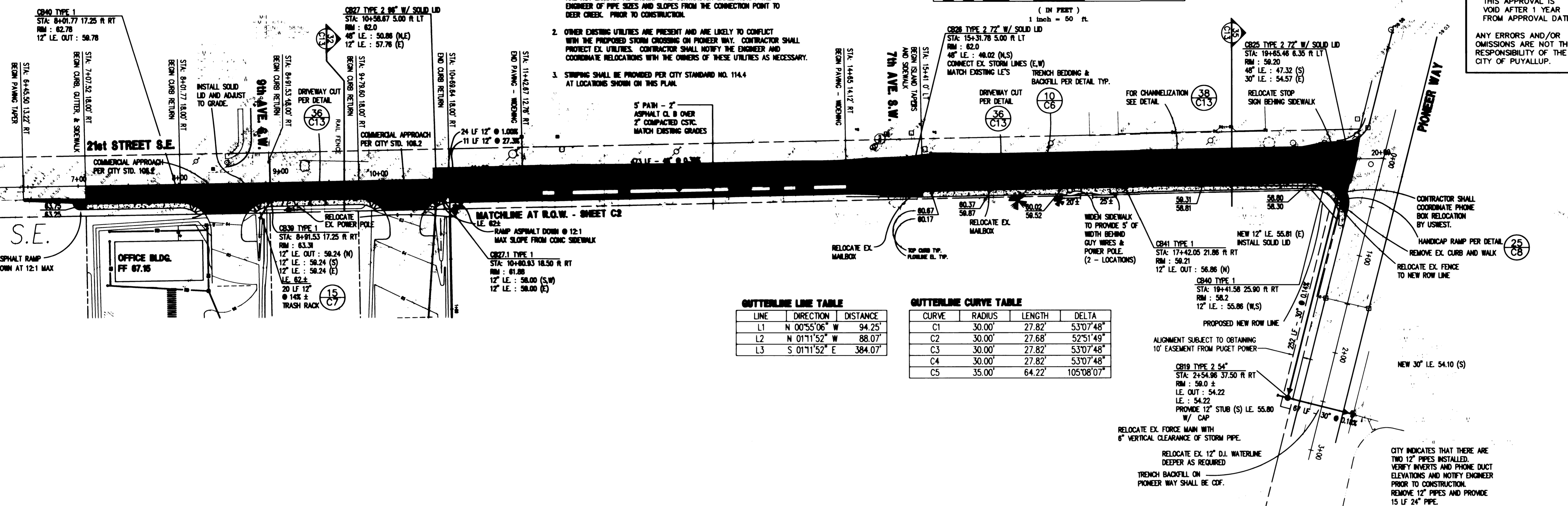
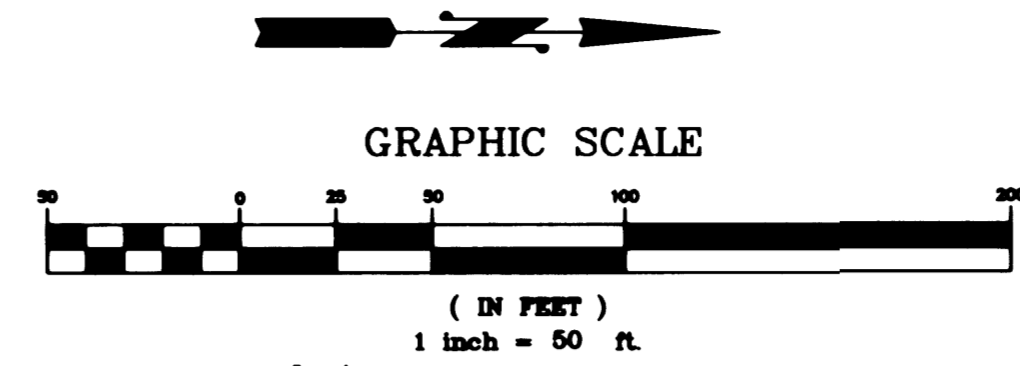

**GUTTERLINE LINE TABLE**

LINE	DIRECTION	DISTANCE
L1	N 00°55'06" W	94.25'
L2	N 01°11'52" W	88.07'
L3	S 01°11'52" E	384.07'

**GUTTERLINE CURVE TABLE**

CURVE	RADIUS	LENGTH	DELTA
C1	30.00'	27.82'	53°07'48"
C2	30.00'	27.68'	52°51'49"
C3	30.00'	27.82'	53°07'48"
C4	30.00'	27.82'	53°07'48"
C5	35.00'	64.22'	105°08'07"

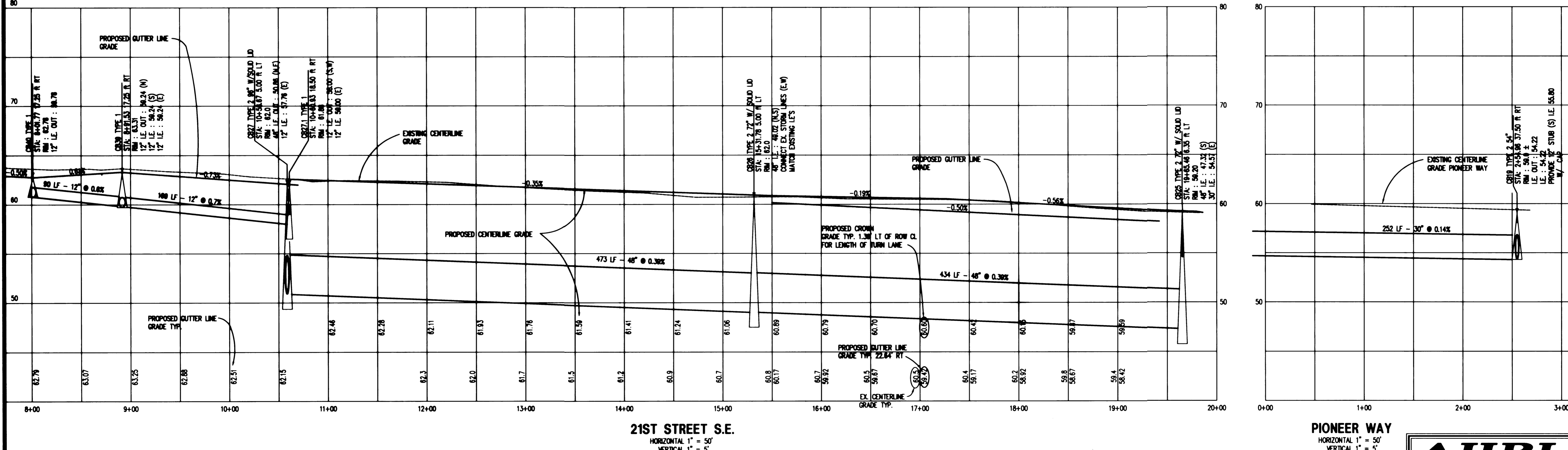

Revisions  
 Drawn By: VIV  
 Checked By: SS  
 Project No.:  
 Date: MAY 21, 1996  
 Project: **CASCADE CHRISTIAN SCHOOLS**  
 PUYALLUP, WA 98071  
 306 NORTH HERODIAN  
**OFFSITE STORM & 21ST IMPROVEMENTS**

**AHBL**  
 CIVIL & STRUCTURAL ENGINEERS  
 LAND PLANNERS • LANDSCAPE ARCHITECTS  
 228 NORTH 308 SUITE 300 • TACOMA, WA 98403  
 (206) 363-2422 • FAX: (206) 363-2872

**CALL 48 HOURS BEFORE YOU DIG**  
 1-800-424-5555

Sheet No. **C11**

PORTION OF THE N 1/2 OF SEC 35 TWP. 20N., RGE. 4 E. W.M. PIERCE COUNTY, WA

**APPROVED**  
 BY: *[Signature]*  
 CITY OF PUYALLUP  
 CITY ENGINEER  
 DATE: 5/22/96  
 NOTE:  
 THIS APPROVAL IS  
 VOID AFTER 1 YEAR  
 FROM APPROVAL DATE.  
 ANY ERRORS AND/OR  
 OMISSIONS ARE NOT THE  
 RESPONSIBILITY OF THE  
 CITY OF PUYALLUP.

**BROWN  
 CONNALLY  
 ROWAN  
 ARCHITECTS  
 INC.**  
 SUITE 100  
 TACOMA, WA 98401  
 TEL: (206)867-4867  
 FAX: (206)867-4896

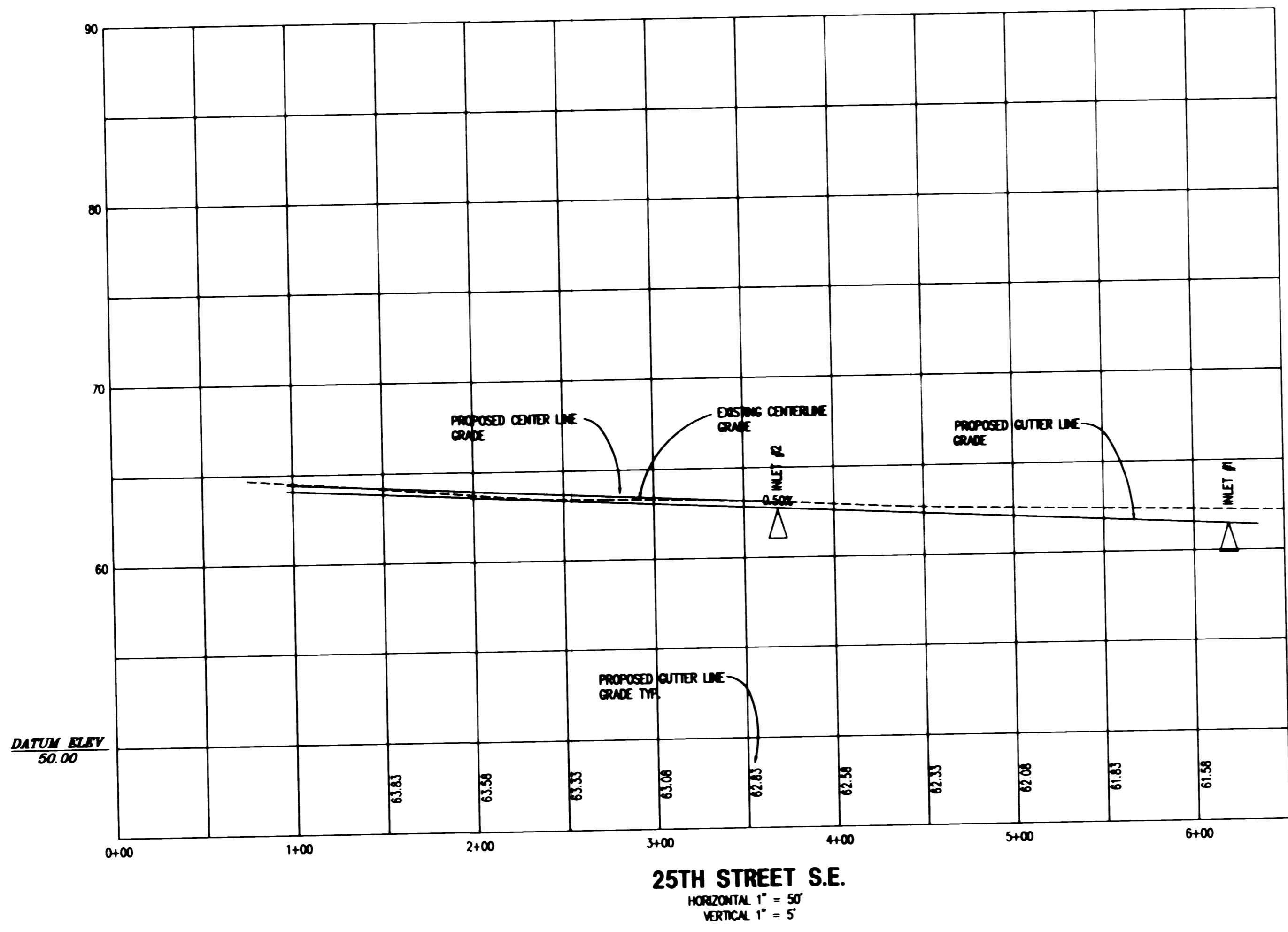
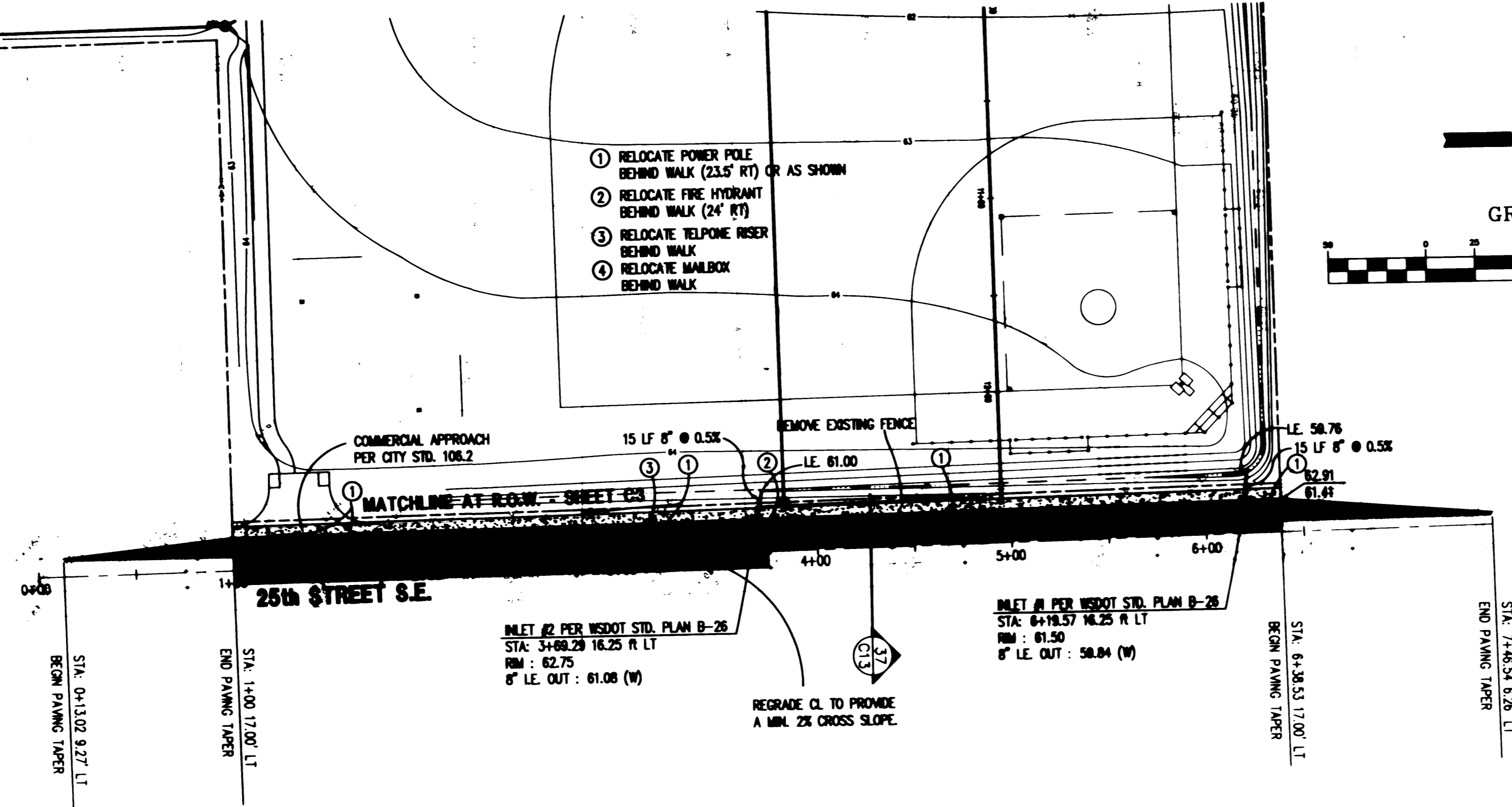
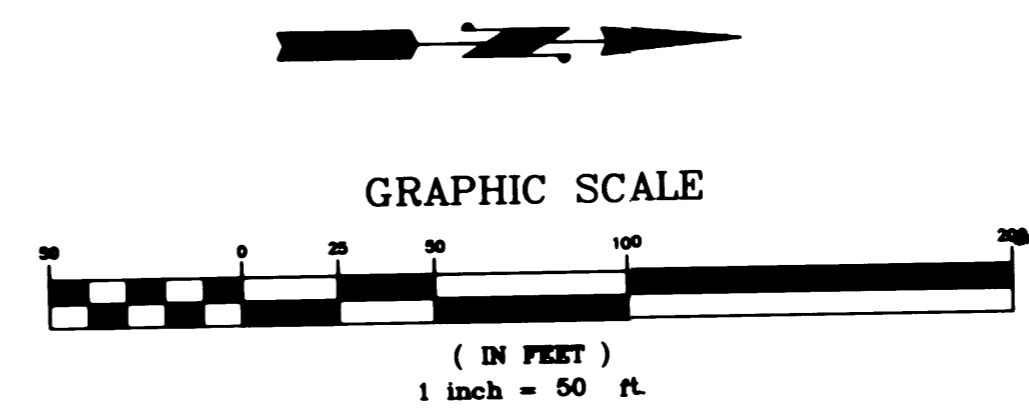

**25TH STREET S.E.**  
 HORIZONTAL 1" = 50'  
 VERTICAL 1" = 5'

**CALL 48 HOURS  
 BEFORE YOU DIG  
 1-800-424-5555**

HOUSE OF DOCUMENTS  
 THE ENGINEER AND THE OWNER SHALL  
 BE RESPONSIBLE FOR THE ACCURACY OF  
 THE INFORMATION CONTAINED HEREIN AS AN INSTRUMENT OF  
 SERVICE. THE ENGINEER SHALL BE RESPONSIBLE FOR THE  
 ACCURACY OF THE INFORMATION CONTAINED HEREIN AS AN  
 INSTRUMENT OF SERVICE. THE ENGINEER SHALL BE RESPONSIBLE  
 FOR THE ACCURACY OF THE INFORMATION CONTAINED HEREIN  
 AS AN INSTRUMENT OF SERVICE.

**AHBL**  
 CIVIL & STRUCTURAL ENGINEERS  
 LAND PLANNERS • LANDSCAPE ARCHITECTS  
 2216 NORTH 300th SUITE 300 • TACOMA, WA 98403  
 (206) 363-3422 • FAX: (206) 363-3672

Project: **CASCADE CHRISTIAN SCHOOLS**  
 306 NORTH MERIDIAN PUYALLUP, WA 98371  
 Drawing Title: **OFFSITE STORM & IMPROVEMENTS**  
 Sheet No. **C12**

Project No. \_\_\_\_\_  
 Date: MAY 21, 1996  
 Drawn By: WV  
 Checked By: SS

Revisions  
 Drawn By: WV  
 Checked By: SS

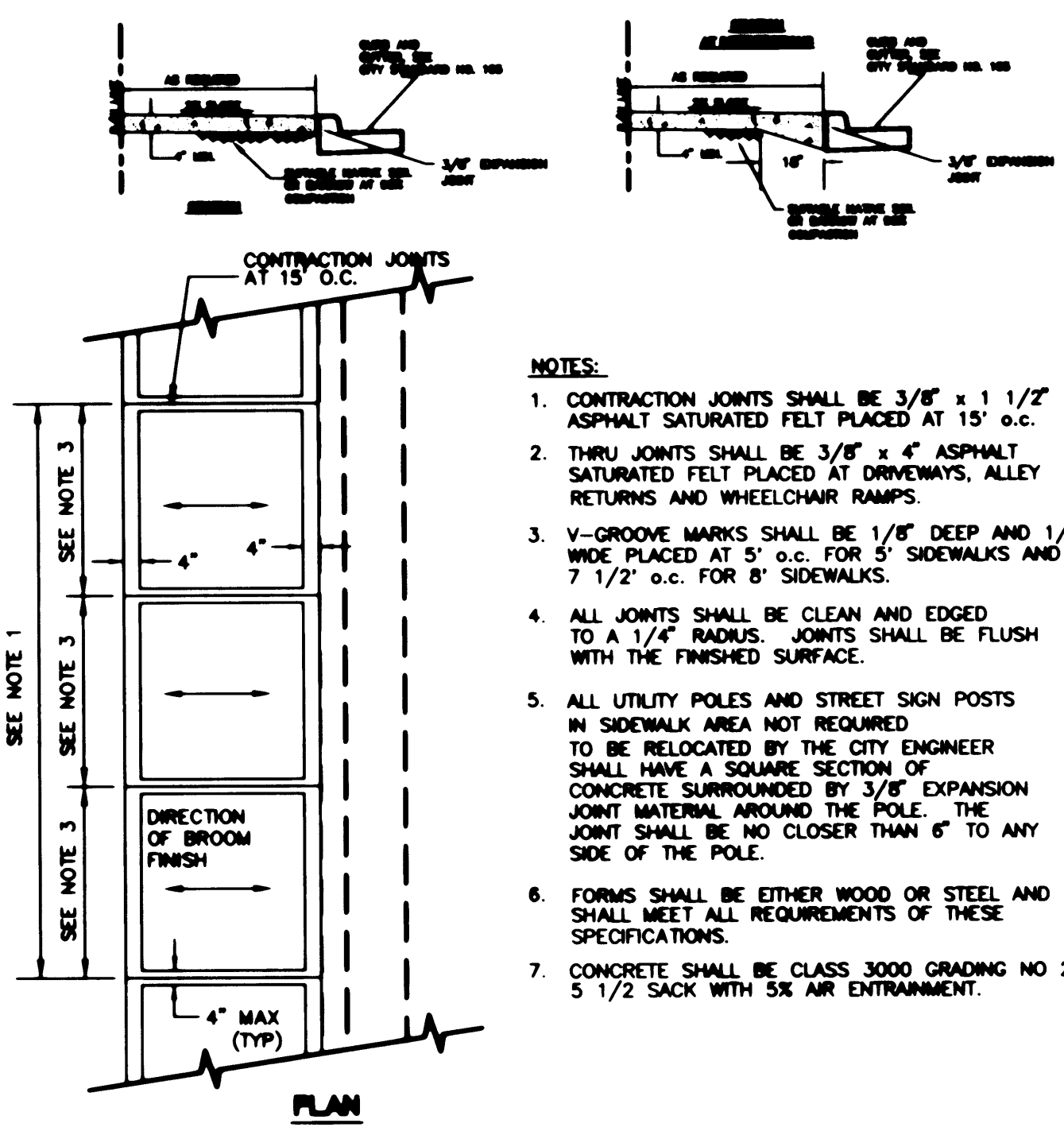

- NOTES:**
- CONTRACTION JOINTS SHALL BE 3/8" x 1 1/2" ASPHALT SATURATED FELT PLACED AT 15' o.c.
  - THRU JOINTS SHALL BE 3/8" x 4" ASPHALT SATURATED FELT PLACED AT DRIVEWAYS, ALLEY RETURNS AND WHEELCHAIR RAMPS.
  - V-GROOVE MARKS SHALL BE 1/8" DEEP AND 1/4" WIDE PLACED AT 5' o.c. FOR 5' SIDEWALKS AND 7 1/2' o.c. FOR 8' SIDEWALKS.
  - ALL JOINTS SHALL BE CLEAN AND EDGED TO A 1/4" RADIUS. JOINTS SHALL BE FLUSH WITH THE FINISHED SURFACE.
  - ALL UTILITY POLES AND STREET SIGN POSTS IN SIDEWALK AREA NOT REQUIRED TO BE RELOCATED BY THE CITY ENGINEER SHALL HAVE A SQUARE SECTION OF CONCRETE SURROUNDED BY 3/8" EXPANSION JOINT MATERIAL AROUND THE POLE. THE JOINT SHALL BE NO CLOSER THAN 6" TO ANY SIDE OF THE POLE.
  - FORMS SHALL BE EITHER WOOD OR STEEL AND SHALL MEET ALL REQUIREMENTS OF THESE SPECIFICATIONS.
  - CONCRETE SHALL BE CLASS 3000 GRADING NO 2 5 1/2 SACK WITH 5% AIR ENTRAINMENT.

**30 SIDEWALK**

FROM CITY STD. NO 104.2  
NOT TO SCALE

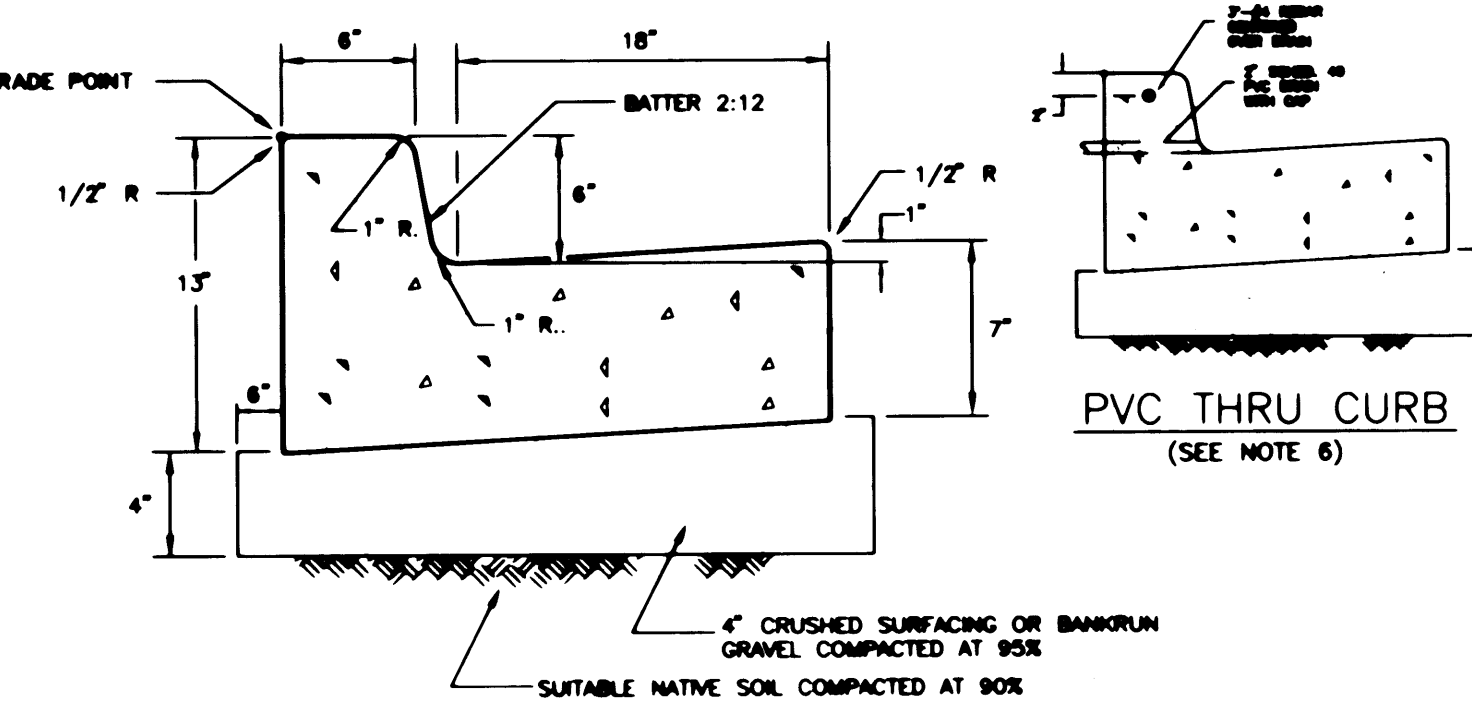

- NOTES:**
- CONTRACTION JOINTS SHALL BE 3/8" x 2 1/4" ASPHALT SATURATED FELT PLACED IN ALL EXPOSED SURFACES OF CURB AND GUTTER AND SPACED AT 15' MAX. 10' MIN. O.C.
  - THRU JOINTS SHALL BE 3/4" ASPHALT SATURATED FELT PLACED AT POINTS OF TANGENCY ON CURVES, AT CATCH BASINS, AND AT EDGES OF ALLEY AND DRIVEWAYS. THE MAXIMUM DISTANCE BETWEEN THRU JOINTS SHALL BE 100'.
  - CONCRETE SHALL BE CLASS 3000 GRADING NO. 2 (5 1/2 - 1 1/2)
  - FORMS SHALL BE STEEL UNLESS PRIOR APPROVAL IS GIVEN BY THE CITY ENGINEER. FORMS SHALL BE SET TRUE TO LINE AND GRADE AND SECURELY STAKED PRIOR TO CONCRETE PLACEMENT. FULL DEPTH DIVISION PLATES ARE ONLY TO BE USED WHERE THRU JOINTS ARE TO BE PLACED.
  - THE 1" RADIUS ON THE UPPER FACE OF THE CURB MAY BE FORMED BY AN EDGER TOOL OR BUILT INTO THE FACE FORM. THE 1" RADIUS AT THE BOTTOM FACE OF THE CURB SHALL BE FORMED BY THE FACE FORM.
  - 2" SCHEDULE 40 PVC SHALL BE PLACED THROUGH CURB AT LOW POINTS OF PROPERTY OR LOT WHEN GRADE SLOPES DOWN TO STREET.

**31 CURB & GUTTER**

FROM CITY STD. NO 105.1  
NOT TO SCALE

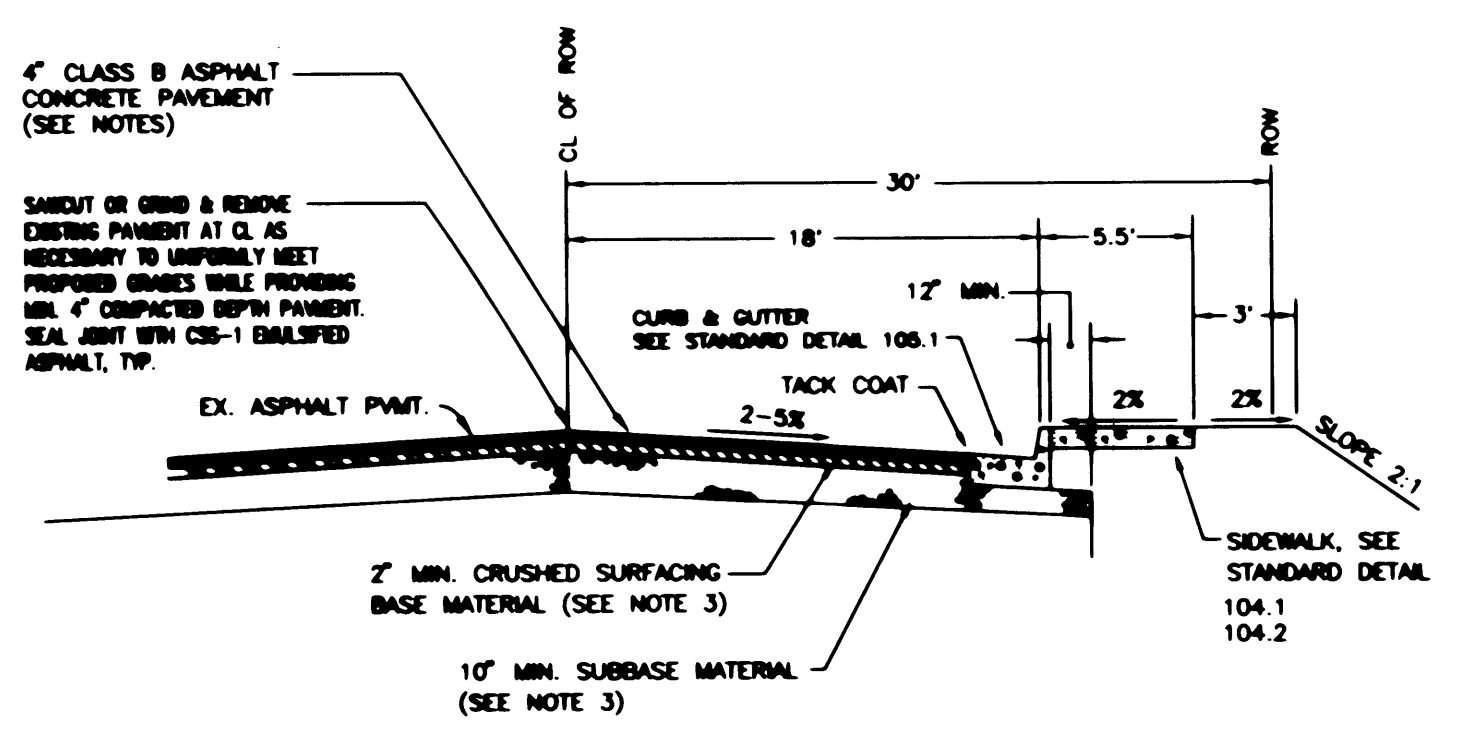

**32 21ST FRONTAGE SECTION**

COLLECTOR STREET  
FROM CITY STD. NO 101  
NOT TO SCALE

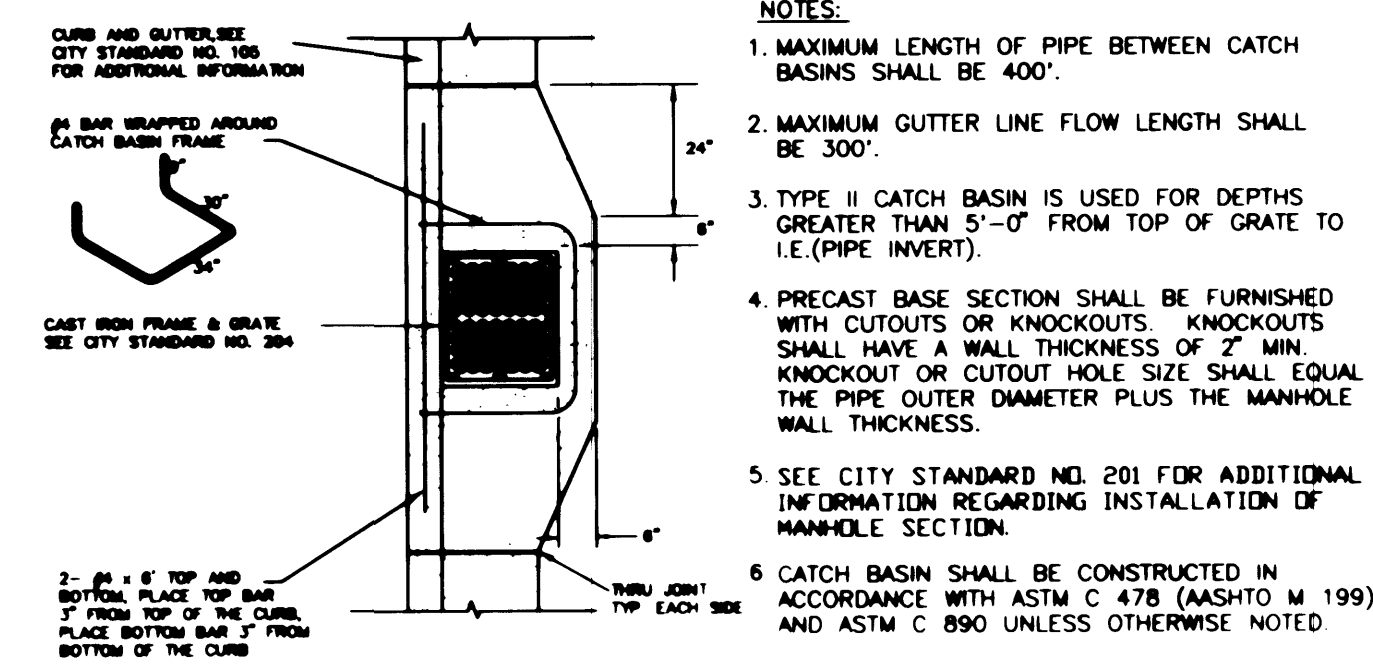

- NOTES:**
- MAXIMUM LENGTH OF PIPE BETWEEN CATCH BASINS SHALL BE 400'.
  - MAXIMUM GUTTER LINE FLOW LENGTH SHALL BE 300'.
  - TYPE II CATCH BASIN IS USED FOR DEPTHS GREATER THAN 5'-0" FROM TOP OF GRATE TO I.E. (PIPE INVERT).
  - PRECAST BASE SECTION SHALL BE FURNISHED WITH CUTOUTS OR KNOCKOUTS. KNOCKOUTS SHALL HAVE A WALL THICKNESS OF 2" MIN. KNOCKOUT OR CUTOUT HOLE SIZE SHALL EQUAL THE PIPE OUTER DIAMETER PLUS THE MANHOLE WALL THICKNESS.
  - SEE CITY STANDARD NO. 201 FOR ADDITIONAL INFORMATION REGARDING INSTALLATION OF MANHOLE SECTION.
  - CATCH BASIN SHALL BE CONSTRUCTED IN ACCORDANCE WITH ASTM C 478 (ASHTO M 199) AND ASTM C 890 UNLESS OTHERWISE NOTED.

**33 CB DETAIL**

FROM CITY STD. NO 202  
NOT TO SCALE

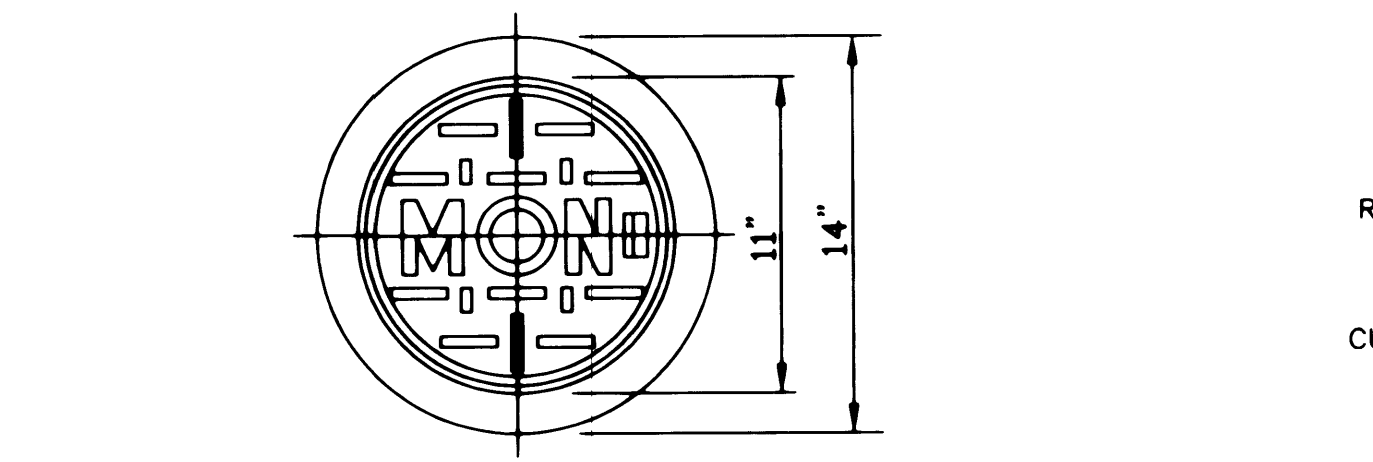

**34 MONUMENT**

FROM CITY STD. NO 109  
NOT TO SCALE

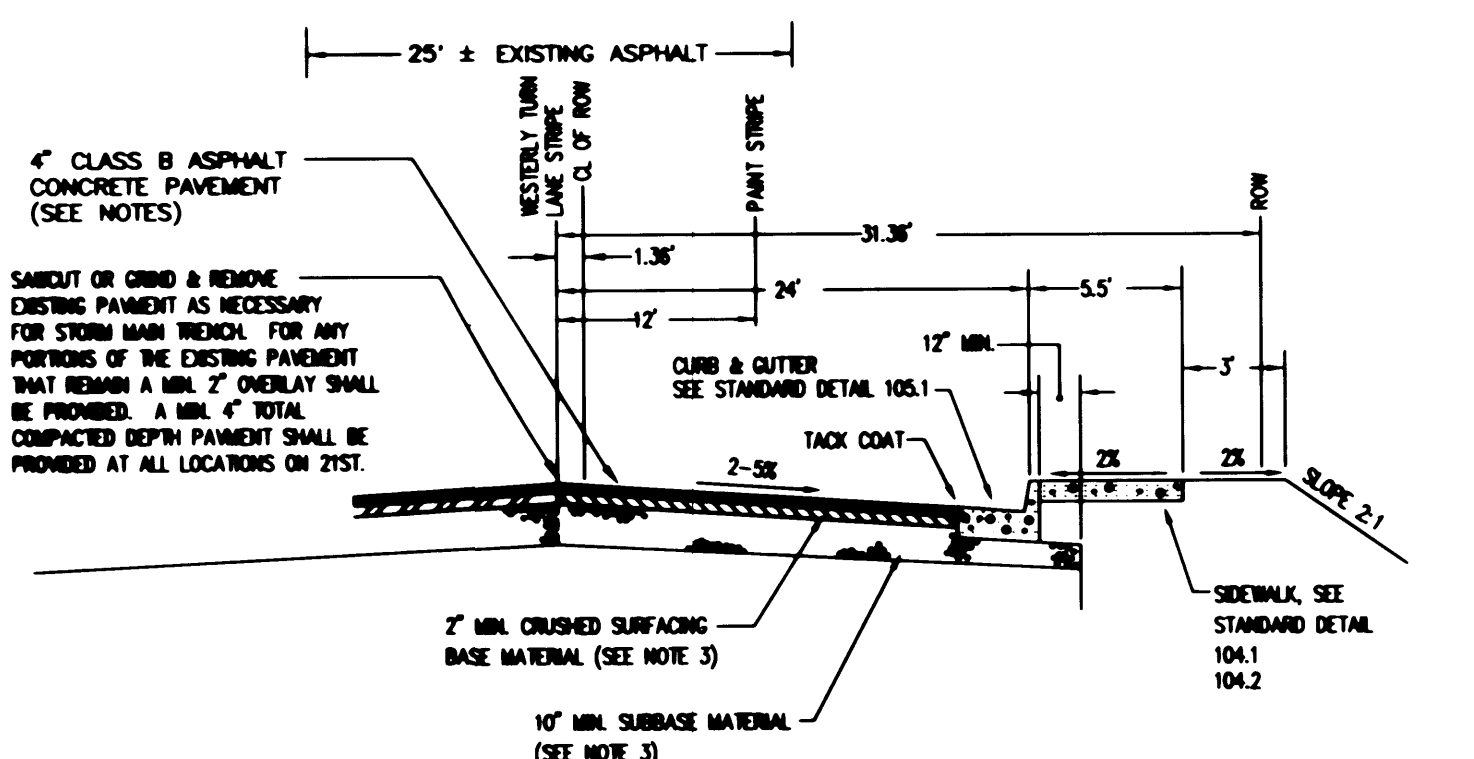

**35 21ST TURN POCKET SECTION**

COLLECTOR STREET  
FROM CITY STD. NO 101  
NOT TO SCALE

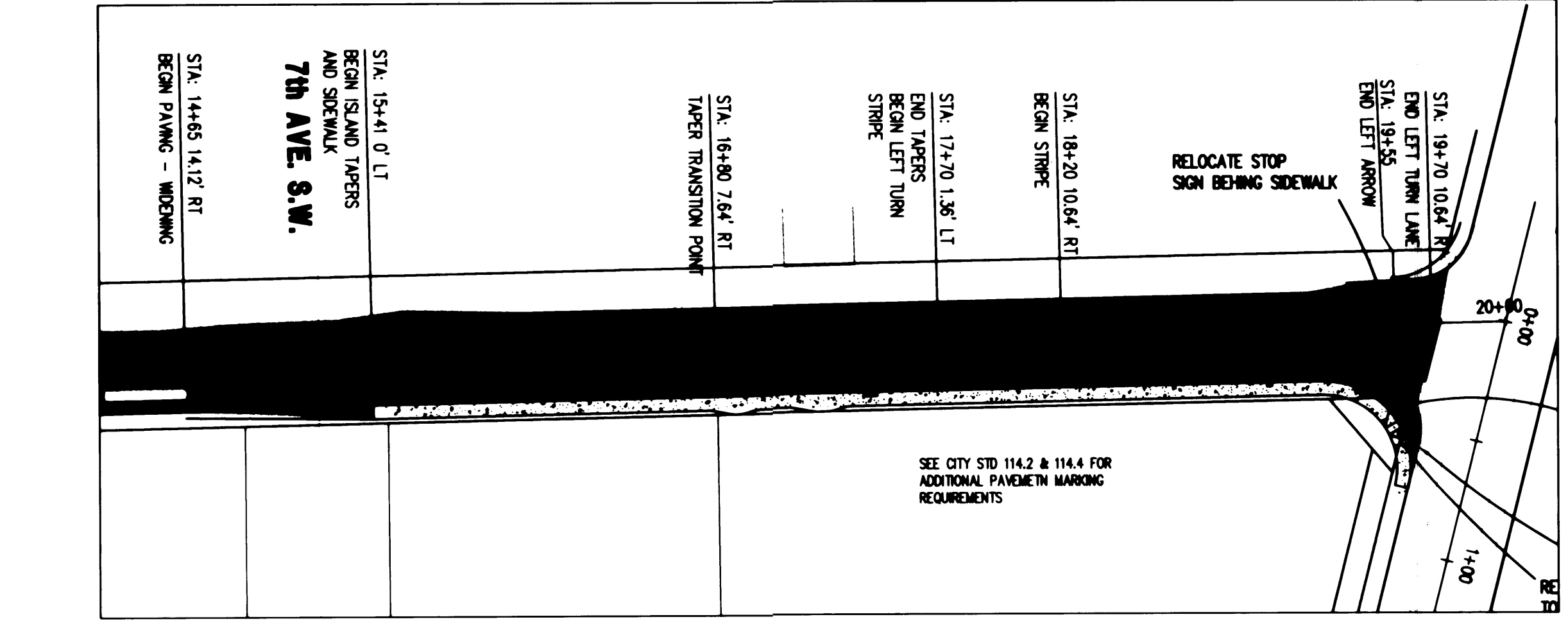

**38 CHANNELIZATION PLAN**

SCALE 1" = 50'

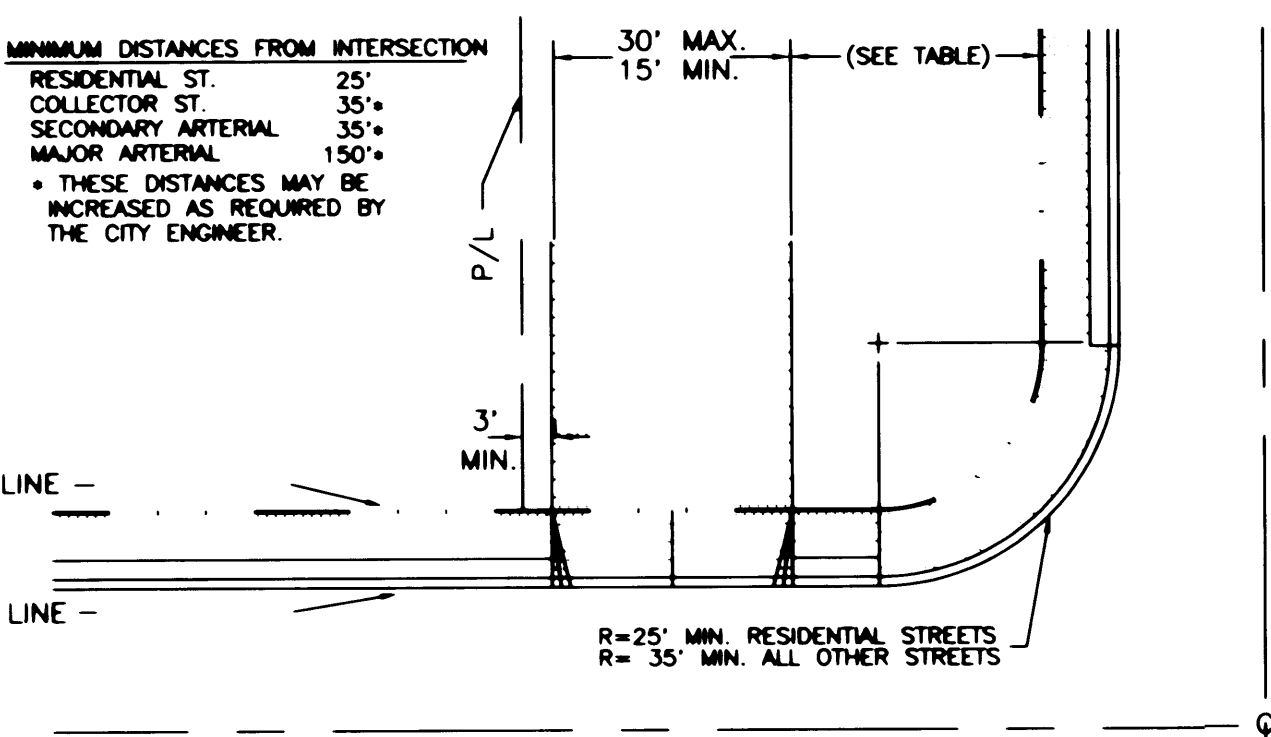

**36 DRIVEWAY APPROACH**

FROM CITY STD. NO 106.1  
NOT TO SCALE

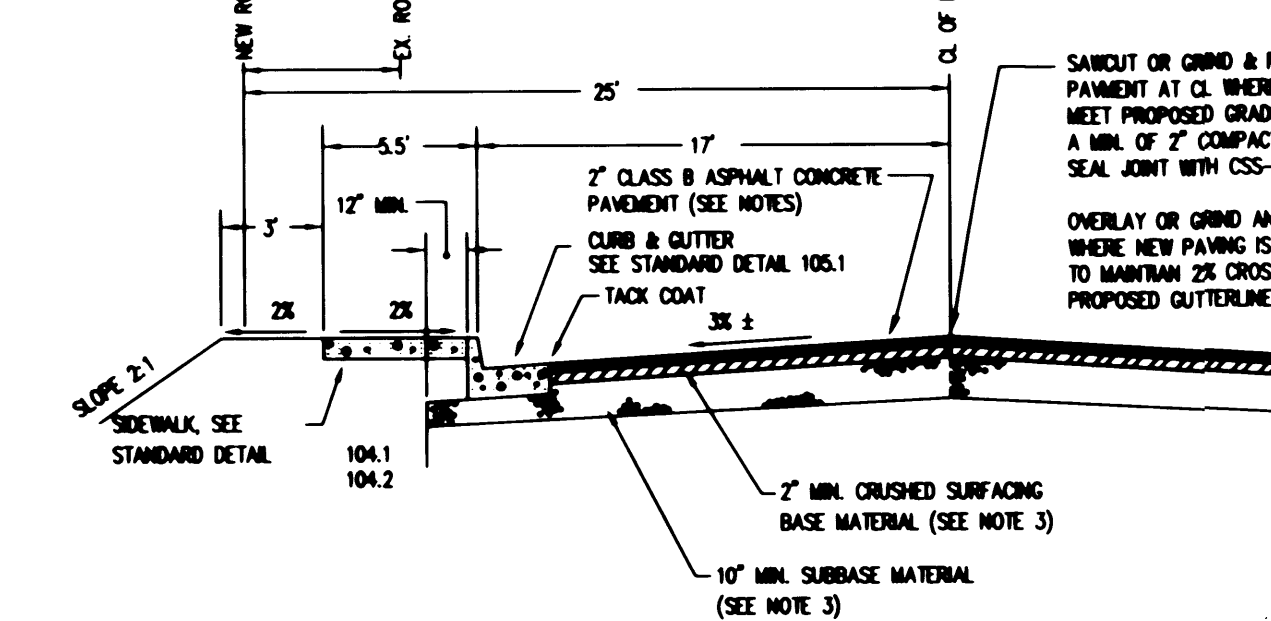

**37 25TH FRONTAGE SECTION**

RESIDENTIAL STREET  
FROM CITY STD. NO 101  
NOT TO SCALE

**APPROVED**  
BY: *[Signature]*  
CITY OF PUYALLUP  
CITY ENGINEER  
DATE: 5/22/96  
NOTE: THIS APPROVAL IS VOID AFTER 1 YEAR FROM APPROVAL DATE. THE CITY WILL NOT BE RESPONSIBLE FOR THE ERRORS AND/OR OMISSIONS ON THESE PLANS.  
FIELD CONDITIONS MAY DICTATE CHANGES TO THESE PLANS AS DETERMINED BY THE CITY ENGINEER.

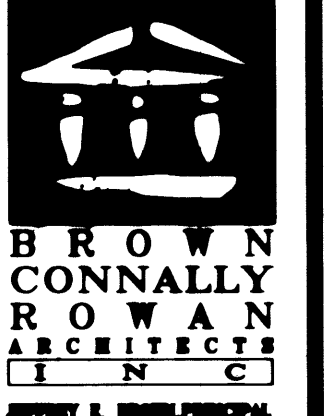

**BROWN CONNALLY ROWAN ARCHITECTS**  
225 EAST 30th STREET  
SUITE 100  
TACOMA, WA 98481  
TEL (800) 887-4367  
FAX (800) 887-4366

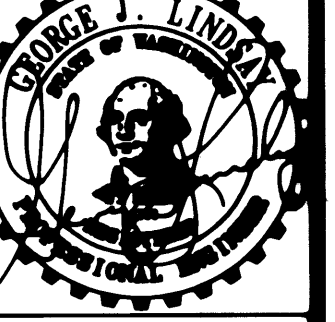

DATE: 7/23/97

Drawn By: SMS  
Checked By: SMS  
Project No:  
Date: MAY 21, 1996

Project: **CASCADE CHRISTIAN SCHOOLS**

Drawing Title: **GENERAL NOTES & DETAILS**

Sheet No. **C13**

**AHBL**  
CIVIL & STRUCTURAL ENGINEERS  
LAND PLANNERS • LANDSCAPE ARCHITECTS  
2218 NORTH 30th BLVD SUITE 300 • TACOMA, WA 98403  
(206) 363-2422 • FAX: (206) 363-2672

**CALL 48 HOURS BEFORE YOU DIG**  
1-800-424-5555

REVISIONS  
NO. DESCRIPTION  
DATE