

A PORTION OF SECTION 28, TOWNSHIP 20 NORTH, RANGE 04 EAST, W.M.

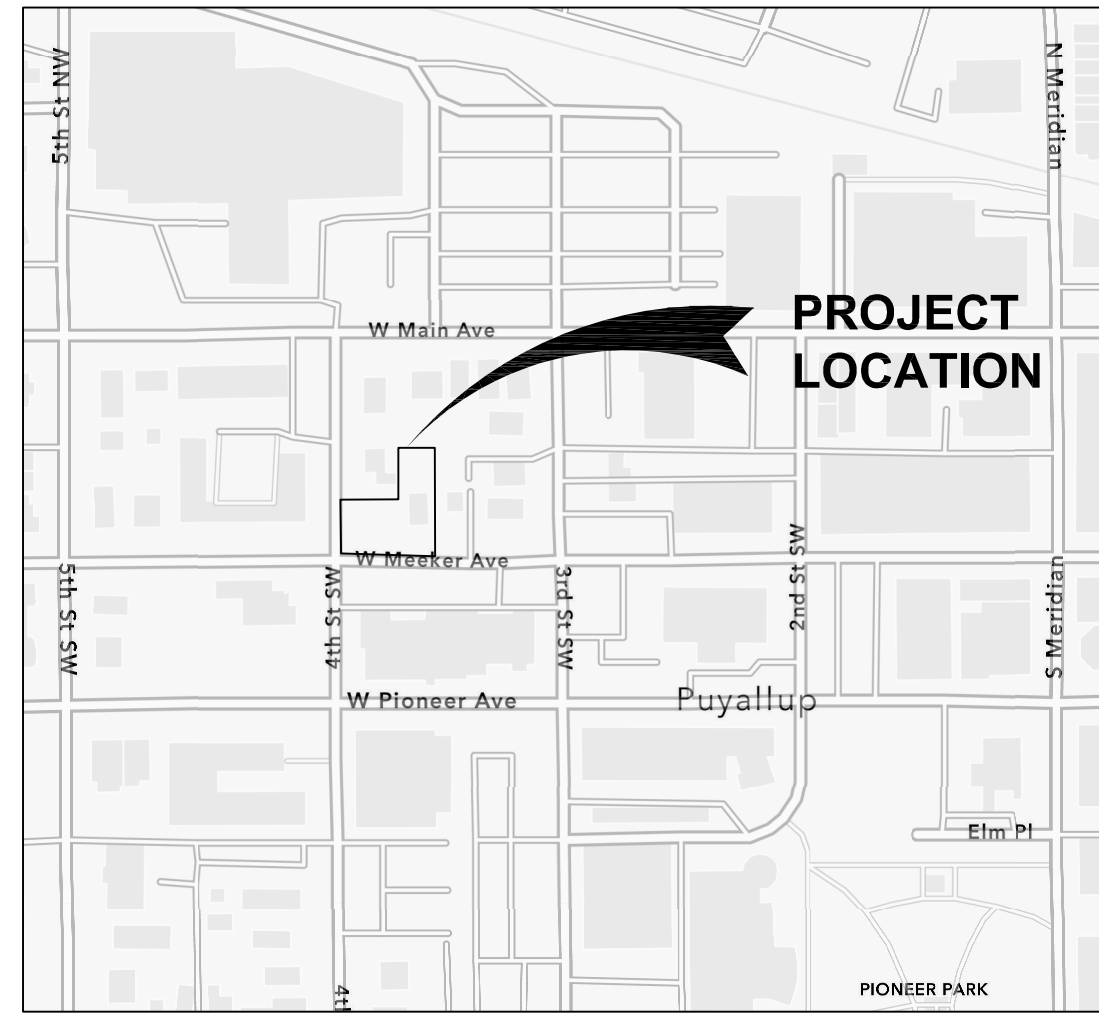

VICINITY MAP
NTS

ACCESSIBLE PATH OF TRAVEL NOTE:
WALKWAYS AND SIDEWALKS ALONG ACCESSIBLE ROUTES OF TRAVEL (1) SHALL BE CONTINUOUSLY ACCESSIBLE, (2) ARE MINIMUM 48" IN WIDTH, (3) HAVE A MAXIMUM 1.5% CROSS SLOPE, AND (4) WHERE NECESSARY TO CHANGE ELEVATION AT A SLOPE EXCEEDING 5% LONGITUDINALLY (i.e., 1:20) SHALL HAVE RAMPS COMPLYING WITH ADA STANDARDS, SECTION 405. WHERE A WALK CROSSES OR ADJOINS A VEHICULAR WAY, AND THE WALKING SURFACES ARE NOT SEPARATED BY CURBS, RAILINGS OR OTHER ELEMENTS BETWEEN PEDESTRIAN AREAS AND VEHICULAR AREAS SHALL BE DEFINED BY A CONTINUOUS DETECTABLE WARNING; COMPLYING WITH ADA STANDARDS, SECTION 406.8

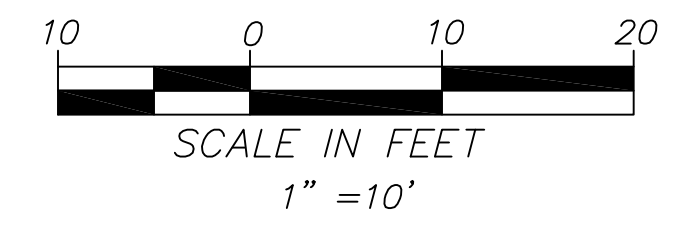

OWNER/APPLICANT:
CITY OF PUYALLUP
CAPITAL IMPROVEMENT PROJECTS DIVISION
333 S MERIDIAN
PUYALLUP, WA 98371
TEL: (253) 290-2126
PROJECT MANAGER: LANCE HOLLINGSWORTH

SITE INFORMATION
PARCEL#: 7060000242 & 7060000230
ADDRESS: 321 & 313 W MEEKER
TOTAL LOT AREA: 10,813 SF (0.25 AC)
ON-SITE SURFACE AREAS
TOTAL OFFSITE DISTURBED AREA: 866 SF (0.02 AC)
TOTAL ONSITE DISTURBED AREA: 10,813 SF (0.25 AC)
NEW/REPLACED IMPERVIOUS AREA: 7,321 SF (0.17 AC)
SITE PERVIOUS/LANDSCAPE AREA: 4,358 SF (0.10 AC)

PROPOSED USE: PUBLIC PARKING
PARKING INFORMATION:
60 DEGREE SPACES: 3
2 REGULAR
1 ADA VAN ACCESSIBLE
90 DEGREE SPACES: 11
4 REGULAR
7 COMPACT
TOTAL PARKING STALLS: 14

GENERAL SITE INFORMATION
ZONING: RM-CORE - REGIONAL GROWTH CENTER-ORIENTED
HIGH DENSITY MULTIPLE-FAMILY RESIDENTIAL ZONE

- CONSTRUCTION NOTES:**
- SAWCUT AT NEAREST EXPANSION JOINT AND SIDEWALK PANEL PER CITY STANDARD CURB CUT DETAIL 01.02.10.
 - INSTALL CONCRETE CURB AND GUTTER PER CITY STANDARD DETAIL 01.02.09.
 - INSTALL COMMERCIAL CEMENT CONCRETE DRIVEWAY APPROACH PER CITY STANDARD DETAIL 01.02.18.
 - INSTALL CONCRETE SIDEWALK PER CITY STANDARD DETAIL 01.02.02.
 - INSTALL 4" MINIMUM COMPACTED DEPTH HMA PER CITY STANDARD DETAIL 01.01.20.
 - INSTALL BARRIER CURB, (TYPICAL).
 - INSTALL 3" POROUS HMA OVER 2" PERMEABLE ASPHALT TREATED BASE OVER 6" PERMEABLE BALLAST MATERIAL PER GEOTECHNICAL REPORT PROVIDED BY NV5 DATED NOVEMBER 30, 2022. SEE ALLEY SECTION CITY STANDARD DETAIL 01.01.10A FOR MATERIAL SPECS.
 - INSTALL CUSTOM 1 LEFT ARROW AND 1 RIGHT ARROW "PARKING ENTRANCE - PUBLIC PARKING" SIGNS WITH 2 BLUE "P" SIGNS. USE CITY STANDARD DETAIL 01.04.01 FOR POST INSTALLATION. SEE SIGN DETAILS THIS SHEET.
 - INSTALL CUSTOM 1 LEFT ARROW AND 1 RIGHT ARROW "EXIT ONLY" SIGNS. USE CITY STANDARD DETAIL 01.04.01 FOR POST INSTALLATION. SEE SIGN DETAILS THIS SHEET.
 - INSTALL TYPE 1 PAVEMENT ARROWS PER CITY STANDARD DETAIL 01.03.14.
 - INSTALL MINIMUM 6' YELLOW CLEAR ZONE PAINT ON VERTICAL CURB, (TYPICAL).
 - INSTALL 4" THERMOPLASTIC PARKING STRIPES, (TYPICAL).
 - CONNECT 6" PERFORATED PIPE TO EXISTING CATCH BASIN FOR EMERGENCY OVERFLOW. FINAL DETAILS TO BE AT FINAL ENGINEERING.
 - INSTALL VAN ACCESSIBLE STALL WITH ACCESS AISLE ON THE PASSENGER SIDE PER ADA STANDARDS.
 - INSTALL ADA SIGN WITH VAN PLAQUE PER ADA STANDARDS.
 - 1-FOOT HEIGHT "COMPACT" THERMOPLASTIC STENCIL

4TH STREET SW

W MEEKER AVENUE

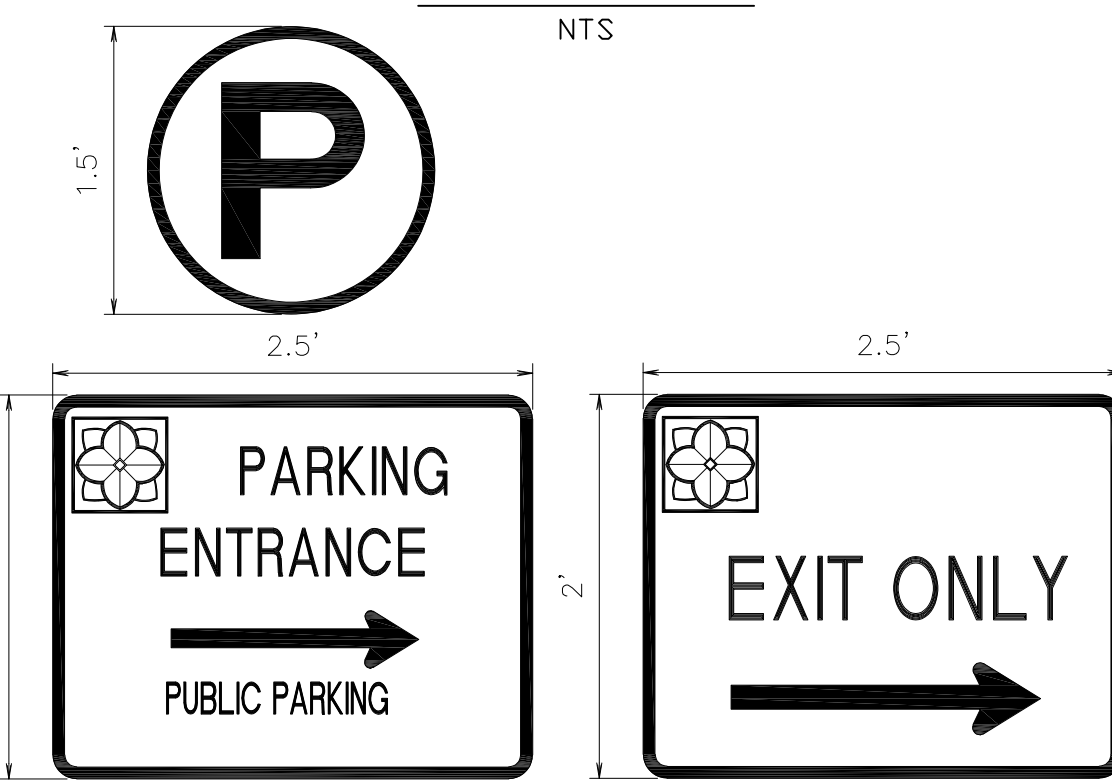
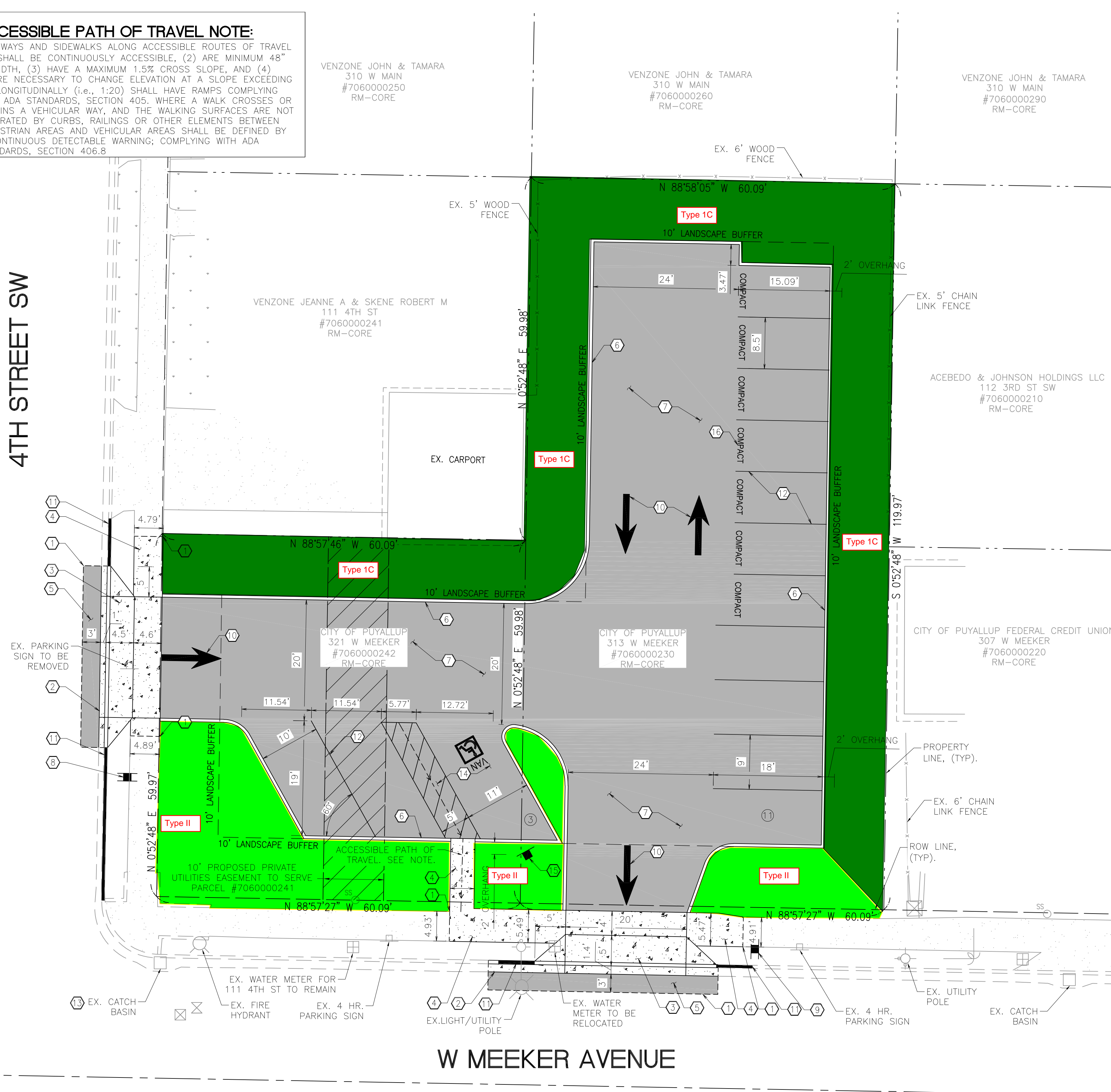

- NOTES:**
- USE WHITE LEGEND ON GREEN BACKGROUND.
 - USE 6"x6" CITY OF PUYALLUP DAFFODIL ICON.
 - ENTRANCE SIGN IS 3" AND 2" LETTERS.
 - EXIT SIGN IS 4" LETTERS.

SIGN DETAILS

ESTIMATED EARTHWORK QUANTITIES:
CUT: 310 CY
FILL: 310 CY
NET: 0 CY
AREA TO BE DISTURBED = 0.27 AC

UTILITY CONFLICT NOTE:
THE CONTRACTOR SHALL BE RESPONSIBLE FOR VERIFYING THE LOCATION, DIMENSION, AND DEPTH OF ALL EXISTING UTILITIES WHETHER SHOWN ON THESE PLANS OR NOT BY POTHOLES THE UTILITIES AND SURVEYING THE HORIZONTAL AND VERTICAL LOCATION PRIOR TO CONSTRUCTION. THIS SHALL INCLUDE CALLING UTILITY LOCATE @ 1-800-424-5555 (OR 811) TO PHYSICALLY VERIFY WHETHER OR NOT CONFLICTS EXIST. LOCATIONS OF SAID UTILITIES AS SHOWN ON THESE PLANS ARE BASED UPON UTILITY LOCATES AS RECORDED ON THE GIVEN SURVEY. IF CONFLICTS SHOULD OCCUR, THE CONTRACTOR SHALL CONSULT THE PROJECT MANAGER TO RESOLVE ALL PROBLEMS PRIOR TO PROCEEDING WITH CONSTRUCTION.

LEGEND:

PROPOSED	EXISTING
CURB AND GUTTER	CURB AND GUTTER
ASPHALT	ASPHALT
CONCRETE SIDEWALK	CONCRETE
SAWCUT	

DRAWN BY: L. HOLLINGSWORTH	ISSUE DATE XXXX			
DESIGNED BY: L. HOLLINGSWORTH	PROJECT NUMBER 21-035			
CHECKED BY: D. YOUNG	DRAWING FILE NO. XXXXX			
NO.	DATE	REVISION	BY	APPROVED



City of
PUYALLUP

W MEEKER AVE PUBLIC PARKING
321 & 313 W MEEKER AVE PUYALLUP, WA
STEINMAN LANDSCAPE PLAN
#21-035 SHEET 1 OF 1

