

PERMIT SET



**East Town Crossing**  
 Pioneer Way & Shaw Road  
 Puyallup, WA

**LYON**  
 Landscape Architects  
 2111 South C Street, Tacoma, WA 98402  
 253-678-4173 | Eric@LyonLA.com

Overall Landscape Plan

SCALE: 1" = 20'-0"	DESIGN: ML
DATE: April 12, 2023	DRAWN: ML
PROJECT: East Town Crossing	CHECKED: EW
PROJECT NO: LLA0222.20	REVISION NUMBER:
	APPD:

REVISIONS

PROJECT

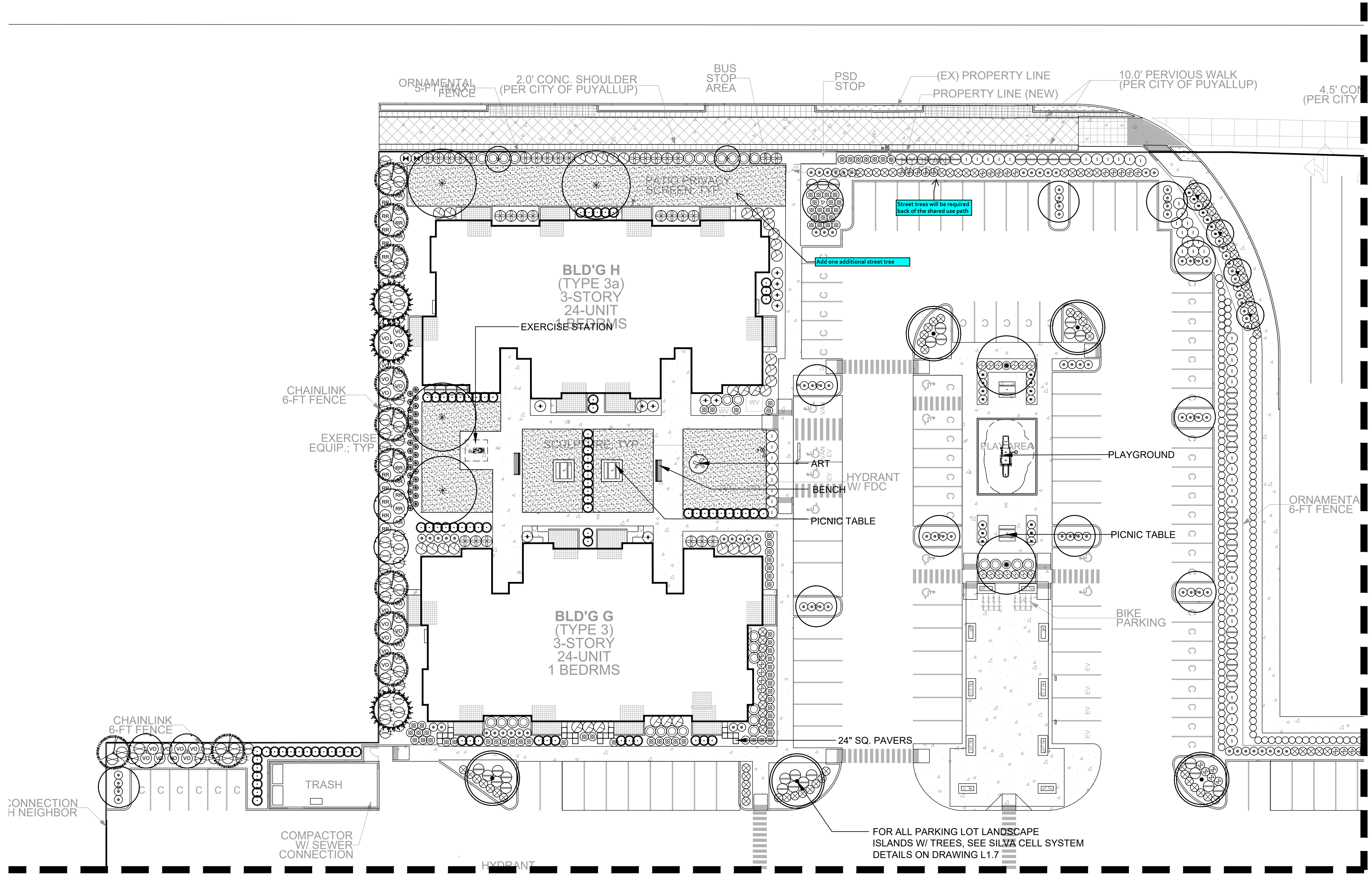

SEE SHEET L1.4

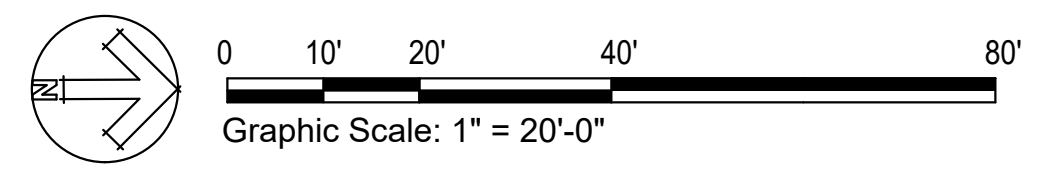

PERMIT SET



**East Town Crossing**  
 Pioneer Way & Shaw Road  
 Puyallup, WA

PROJECT

**LYON**  
 Landscape Architects  
 2111 South C Street, Tacoma, WA 98402  
 253-678-4173 | Eric@LyonLA.com

Landscape Plan

SCALE: 1" = 20'-0"	DESIGN: ML
DATE: April 12, 2023	DRAWN: ML
PROJECT: East Town Crossing	CHECKED: EW
NO: LLA0222.20	REVISION NUMBER:
	APPD.

L1.1

SEE SHEET L1.1

DETAILS ON DRAWING L1.7

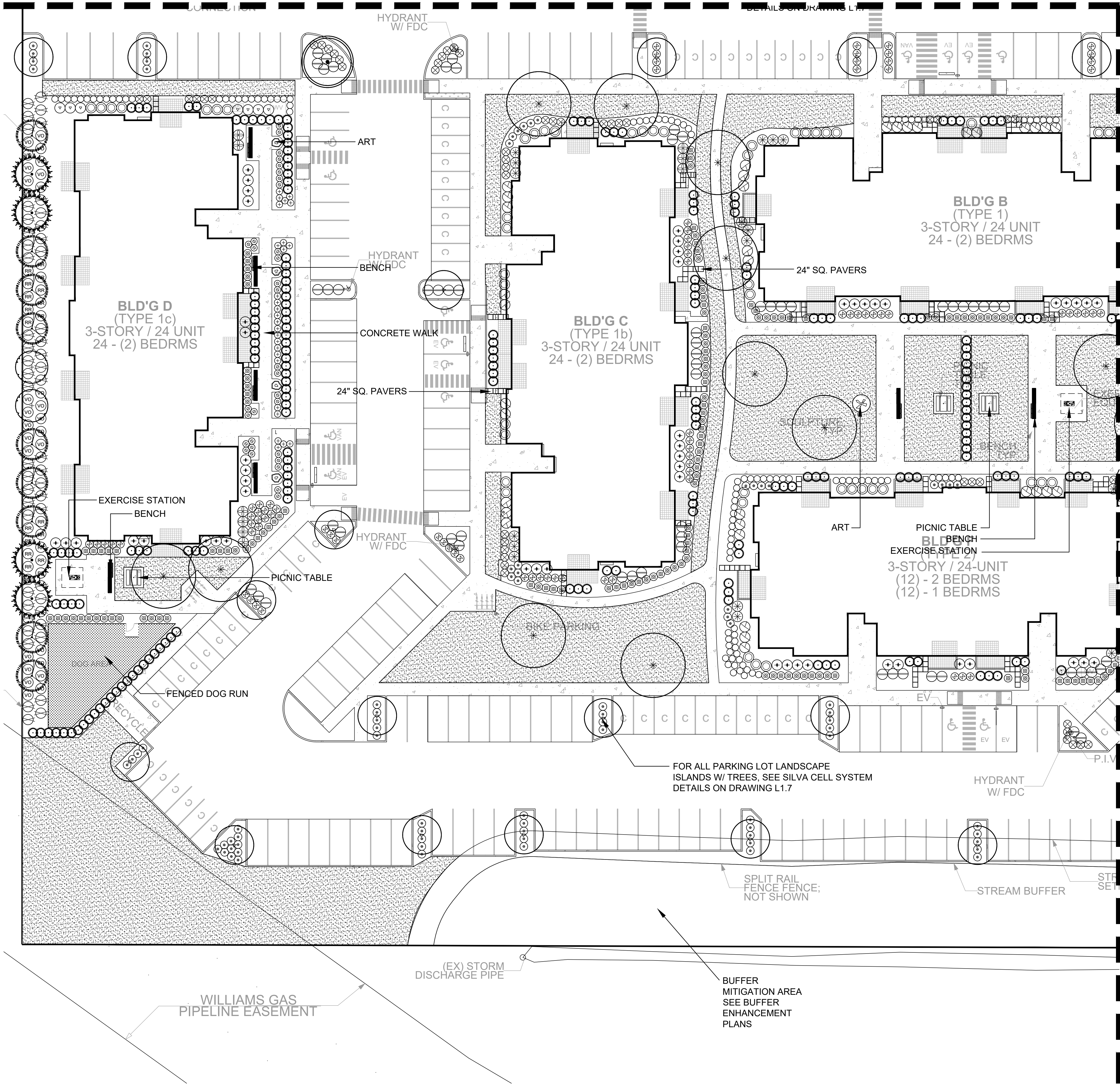

PERMIT SET



**East Town Crossing**  
Pioneer Way & Shaw Road  
Puyallup, WA

PROJECT

**LYON**  
**Landscape Architects**  
2111 South C Street, Tacoma, WA 98402  
253-678-4173 | Eric@LyonLA.com

Landscape Plan

L1.2

SCALE: 1" = 20'-0"	DESIGN: ML
DATE: April 12, 2023	DRAWN: ML
PROJECT: East Town Crossing	CHECKED: EW
PROJECT NO: LLA0222.20	REVISION NUMBER:

REVISIONS	APPD.

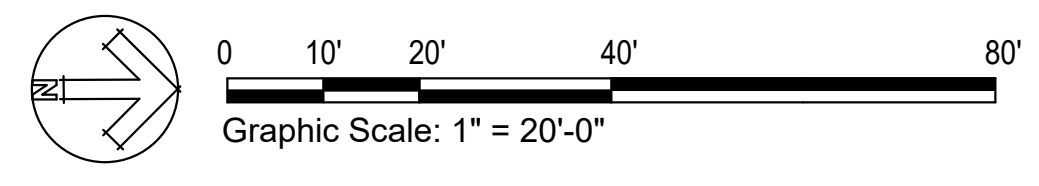





**PLANT SCHEDULE**

QTY. BOTANICAL NAME COMMON NAME SIZE & SPACING, NOTES

**TREES**

2	Acer circinatum*	Vine Maple	8'-10' HT, multi-stem, min 3 branches, spacing per plan, B&B
24	Acer griseum	Paperbark Maple	2" caliper, spacing per plan, B&B
6	Acer rubrum 'Scarsen'	Scarlet Sentinel Maple	2" caliper, 40' OC spacing, B&B
20	Acer x freemanii	Autumn Blaze Maple	3" caliper, spacing per plan, B&B
38	Calocedrus decurrens*	Incense Cedar	6'-8' HT, spacing per plan, B&B
43	Cercidiphyllum japonicum	Katsura	2" caliper, spacing per plan, B&B
41	Pseudotsuga menziesii*	Douglas Fir	8'-10' HT, spacing per plan, B&B
14	Thuja plicata*	Western Red Cedar	6'-8' HT, spacing per plan, B&B
19	Ulmus Americana 'Princeton'	Princeton American Elm	2" cal, 40' OC spacing, B&B
337	Juniperus scopulorum 'Skyrocket'	Sky Rocket Juniper	6'-8' HT, spacing per plan, B&B

**SHRUBS & PERENNIALS**

132	Abelia grandiflora 'Edward Goucher'	Abelia Edward Goucher	3 Gallon @ 4' OC Spacing
2	Arbutus unedo 'Compacta'	Compact Strawberry Tree	5 Gallon @ 6' OC Spacing
112	Azalea 'Gumpo White'	Gumpo White Azalea	3 Gallon @ 4' OC Spacing
30	Blechnum spicant	Deer Fern	2 Gallon @ 2.5' OC Spacing
46	Choisya ternata	Mexican Orange Blossom	3 Gallon @ 4' OC Spacing
315	Cornus stolonifera 'Arctic Fire'	Arctic Fire Dogwood	3 Gallon @ 4' OC Spacing
15	Euonymus alatus 'Compactus'	Dwarf Burning Bush	3 Gallon @ 4' OC Spacing
102	Frades escallonia 'Pink Princess'	Pink Princess Escallonia	3 Gallon @ 4' OC Spacing
5	Hamamelis x intermedia 'Jelena'	Jelena Witch Hazel	3" HT, spacing per plan
95	Hydrangea macrophylla 'Nikko Blue'	Nikko Blue Hydrangea	24"-30" HT, spacing per plan
7	Hydrangea quercifolia	Oakleaf Hydrangea	5 Gallon @ 4' OC Spacing
91	Lavandula angustifolia 'Munstead'	Munstead English Lavender	2 Gallon @ 2.5' O.C. Spacing
214	Mahonia aquifolium 'Compacta'	Compact Oregon Grape	5 Gallon @ 5' OC Spacing
27	Polystichum munitum	Western Sword Fern	3 Gallon @ 4' OC Spacing
85	Rosa rugosa	Rugosa Rose	5 Gallon @ 5' OC Spacing
620	Sarcococca ruscifolia	Fragrant Sweet Box	3 Gallon @ 3' OC Spacing
274	Spiraea betulifolia 'Tor'	Tor Birchleaf Spirea	3 Gallon @ 3' OC Spacing
60	Syringa patula 'Miss Kim'	Miss Kim Lilac	30"-36" HT, spacing per plan
114	Vaccinium ovatum	Evergreen Huckleberry	5 Gallon @ 5' OC Spacing
177	Viburnum x davidii	David Viburnum	5 Gallon @ 4' OC Spacing

**GROUNDCOVERS & GRASSES**

483	Arctostaphylos uva-ursi 'Vancouver Jade'	Kinnikinnick 'Vancouver Jade'	1 Gallon @ 30" OC Spacing
46	Calamagrostis x acutiflora 'Karl Foerster'	Karl Foerster Grass	2 Gallon @ 3' OC Spacing
124	Calluna vulgaris 'Firefly'	Firefly Heather	1 Gallon @ 3' OC Spacing
443	Helictotrichon sempervirens	Blue Oat Grass	1 Gallon @ 3' OC Spacing
88	Hemerocallis 'Stella de Oro'	Star of Gold Day Lily	1 Gallon @ 3' OC Spacing
00	Liriope muscari 'Big Blue'	Big Blue Lily Turf	4" Pot @ 18" OC Spacing
32	Pennisetum alopecuroides 'Hamein'	Dwarf Hamein Fountain Grass	1 Gallon @ 3' OC Spacing



Special Sun Mixture Turf 80% Perennial Ryegrass Country Green Turf Farms  
20% Fine Fescue Hydroseed @ 8 lbs per 1,000 sf



SEED MIX #2	MARSH MIX	SUNMARK COMPANIES (1-888-214-7333)
29.5%	SAW BEAKED SEDGE	SEEDING RATE: 20 LBS/ACRE (½ LBS/1000 SF)
27%	SLOUGH SEDGE	
25%	SMALL WINGED SEDGE	
15%	CREEPING SPIKE RUSH	
3%	SMALL FEATHERED BULRUSH	
0.5%	SLENDER RUSH	

**LANDSCAPE SPECIFICATIONS & NOTES**

**1. MATERIALS**

- Topsoil. Topsoil shall be a blend of the following products; 30% sand; 20% peat; 30% composted cow manure; and 20% fish compost. Available from Rainier Landscape Supply, 253-271-0626 or approved substitution.
- Mulch. Mulch shall be a dark fine organic material. Mulch depth on all beds shall be 4".
- Fertilizer. Agraform 21-gram tablet time release fertilizer shall be used in all plantings. Place 1 for each ground cover, 2 for each shrub and 4 for each tree. They shall be placed in the plant pits as detailed. Also, top dress all plants with a suitable 'starter' fertilizer.
- Tree Stakes. Tree stakes shall be 2" diameter x 8' length Lodgepole pine. Fasteners shall be 1" PVC Chain-Lock, placed as detailed.
- A minimum of 25% of all shrub and groundcover species shall be native to PNW. This is met with an asterisk by the name in the plant schedule.

**2. SOIL PREPARATION**

- Refer to 8.2 Soil Quantity Standards of the Puyallup Vegetation Management Standards for soil requirements.
- Prior to any landscape work, contractor shall remove, or have removed, all debris from the other building trades from the landscape surfaces. NO landscape work shall commence until the areas are cleared of other trades debris.
- Cultivate the existing ground surface to a minimum depth of 4" and remove all rocks over 1" and other debris.
- Fine grade the subgrade to adjoining surfaces in preparation of adding specified topsoil.
- The quantity, depth and quality of the topsoil placed on site is regulated by BMP T5.13 of the 2005 WDOE stormwater manual.
  - A topsoil layer with a minimum organic matter content of 10% dry weight in planting beds, and 5% organic matter in turf areas, and a pH from 6.0 to 8.0 or matching the pH of the undisturbed soil. The topsoil layer shall have a minimum depth of 8 inches. Subsoils below the topsoil layer should be scarified at least 4 inches with some incorporation of the upper material to avoid stratified layers, where feasible.
- Beds. Place a minimum of 8" of specified topsoil on all beds and till or cultivate the topsoil a minimum depth of 12". Remove all rock and debris which may surface. Finished grade of topsoil shall be 4.5" below adjoining paved surfaces, allowing 4" for mulch. Therefore, finished grade shall be 1/2" below paved surface.
- Parking Lot Island Beds. Soil depth shall be 18" in all parking lot islands, allowing for 4" mulch of organic material.
- Lawns. Place 6" compacted depth, of specified topsoil. Roll and compact to about 80% compaction rate. Finished grade of topsoil shall be approximately 3/4" below adjoining paved surfaces, so that when rolled and compacted, sod shall be flush with adjoining pavement.

**3. PLANTING OF TREES, SHRUBS AND GROUNDCOVERS**

- All planting material shall meet or exceed the most recent standards established in the publication 'American Standards for Nursery Stock', ANSI Z60.1-2004 or current successor, of the American Association of Nurserymen (AAN).
- All work shall be performed and completed in a professional manner. All public rights of way shall be cleared of all mud and debris at the completion of every work day. All on-site storage and work areas shall be maintained in a safe and hazard free condition.
- Contractor responsible to verify quantities.
- Contractor is to confirm that all beds are prepared and ready for planting, without interference with other trades.
- Layout all plants as per plan and approval by Landscape Architect, making sure the plants are orientated to give best appearance to the viewer.
- Pit plant all plants into prepared soil and plant per the details. While planting, water the plants into the plant pits thoroughly soaking the root balls and soil. Place fertilizer tablets as specified, filling plant pits with specified topsoil. Top dress fertilize when completed.
- Contractor may be required to cut geotech fabric for proper planting depths in and around the retaining walls. Coordinate with General Contractor.

**4. PLANTING OF SOD**

- Prior to work, have limits of sod approved by Landscape Architect. Contractor responsible to verify quantities.
- Place topsoil then roll, compact and rake to a smooth finished grade, free of depressions and high spots.
- Prior to placing sod, water the soil to get it moist.
- Install sod with the seams all running in one direction, while staggering joints. Finish roll the sod in place assuring that all the joints are tight. Water thoroughly until final acceptance. Contractor shall be responsible for mowing every 7 days until project and landscaping is accepted by Landscape Architect and/or owner.

**5. WARRANTY**

- All landscaping shall be warranted for one year from FINAL ACCEPTANCE. Plants requiring replacement shall be of the original variety and size as specified herein.

**6. IRRIGATION**

- All plants shall be irrigated with an in-ground automatic irrigation system

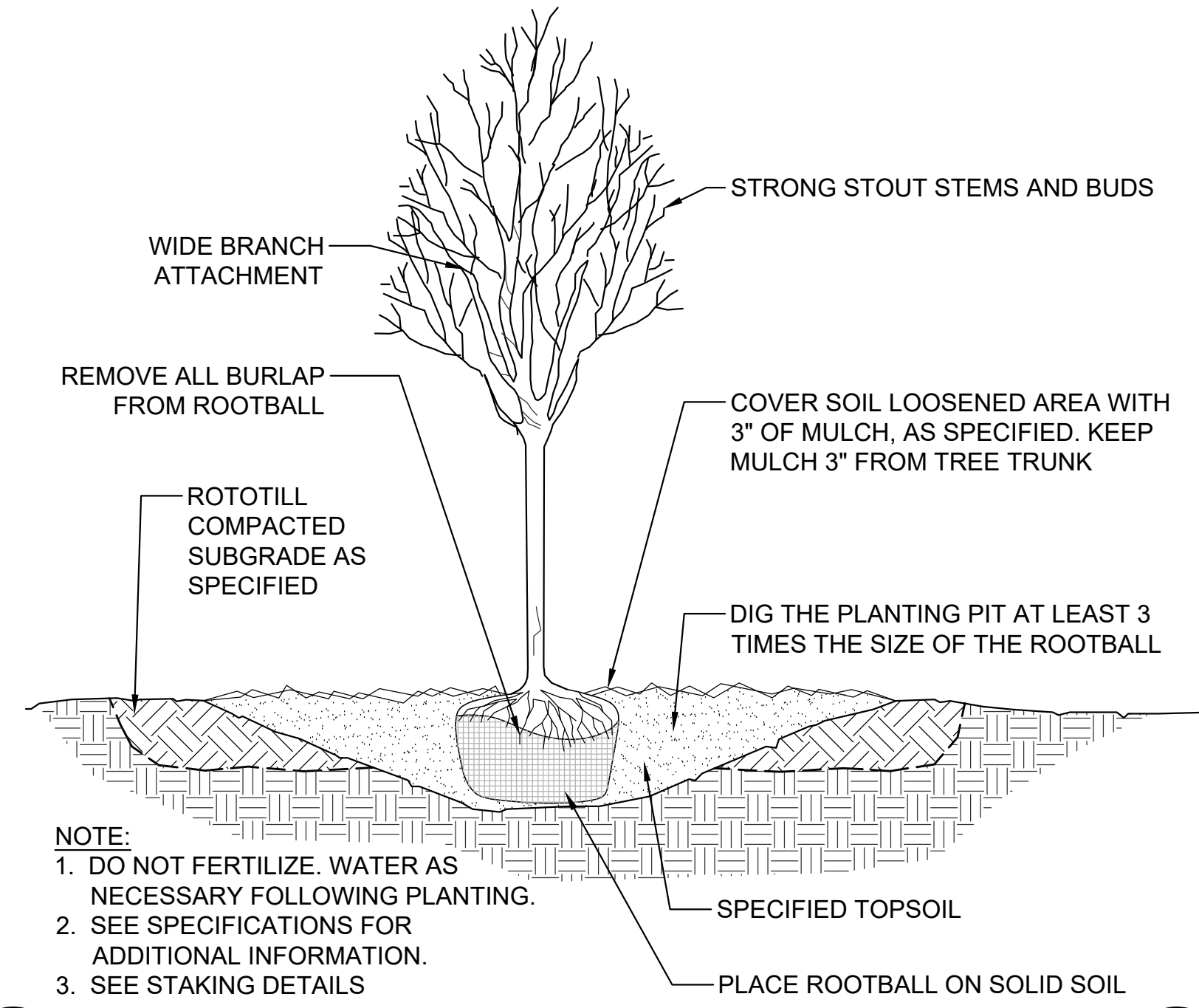

- NOTE:
- DO NOT FERTILIZE. WATER AS NECESSARY FOLLOWING PLANTING.
  - SEE SPECIFICATIONS FOR ADDITIONAL INFORMATION.
  - SEE STAKING DETAILS

**DECIDUOUS TREE PLANTING DETAIL**

SCALE: NTS

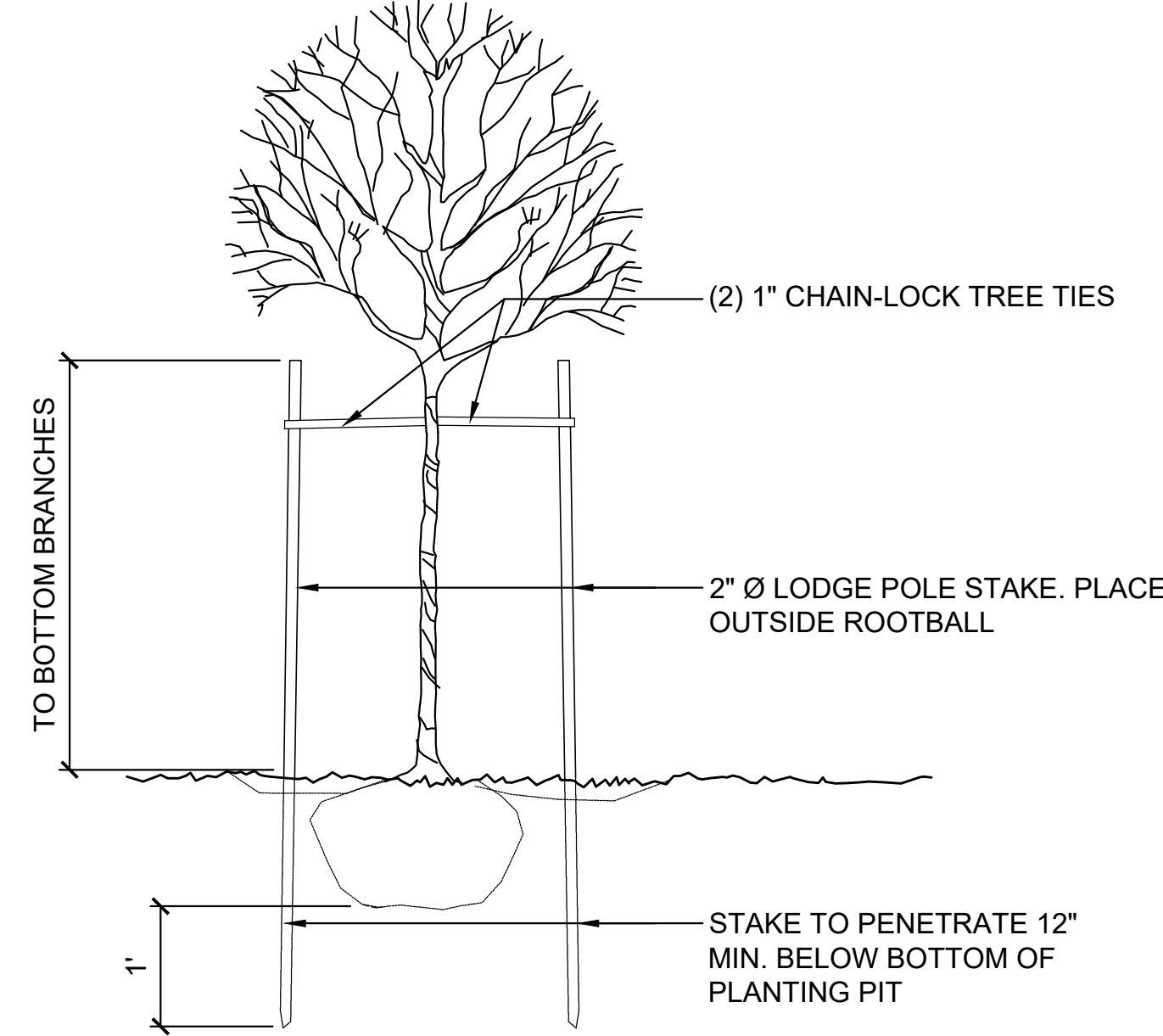

**DECIDUOUS TREE STAKING DETAIL**

SCALE: NTS

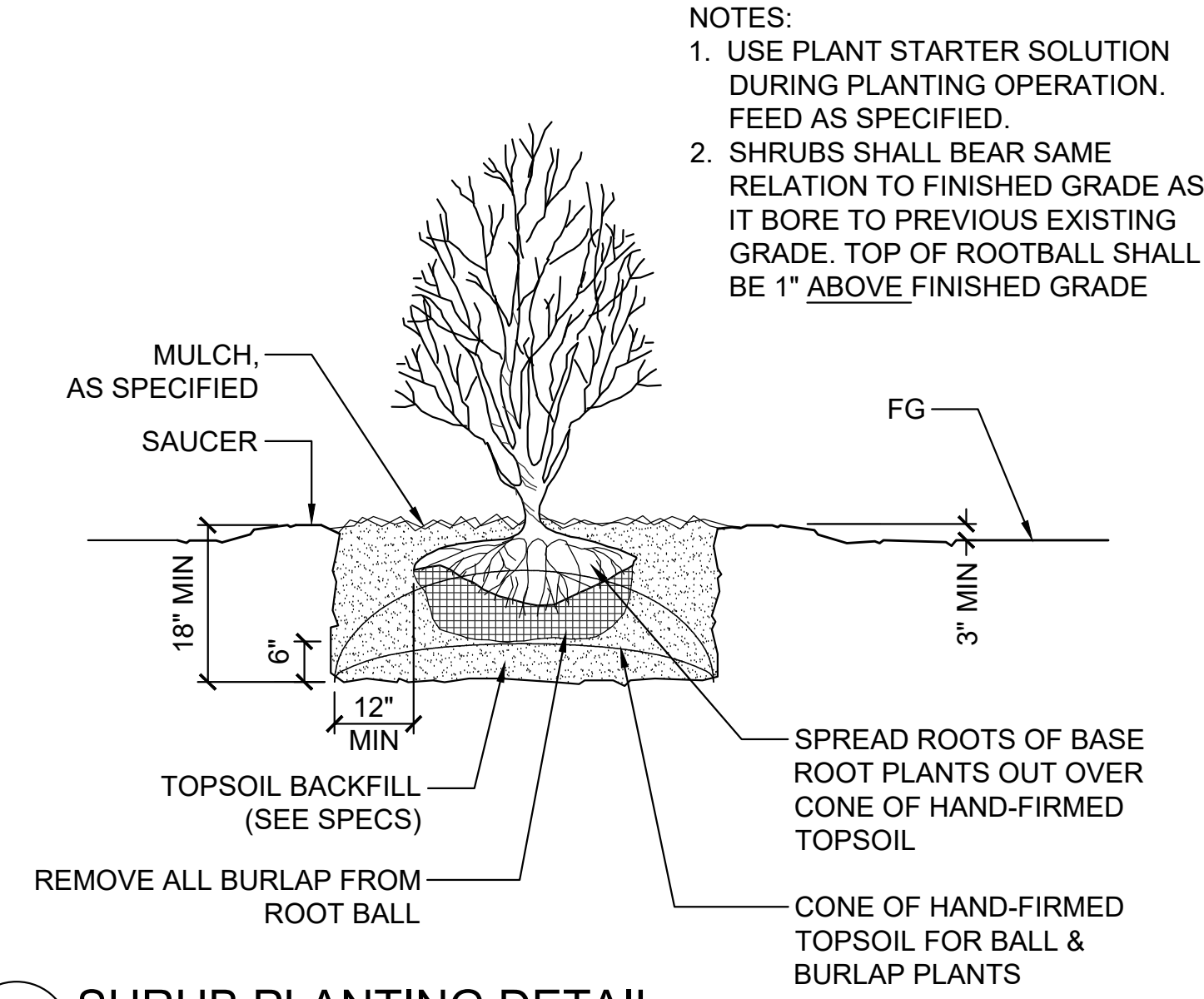

- NOTES:
- USE PLANT STARTER SOLUTION DURING PLANTING OPERATION. FEED AS SPECIFIED.
  - SHRUBS SHALL BEAR SAME RELATION TO FINISHED GRADE AS IT BORE TO PREVIOUS EXISTING GRADE. TOP OF ROOTBALL SHALL BE 1\"/>

**SHRUB PLANTING DETAIL**

SCALE: NTS

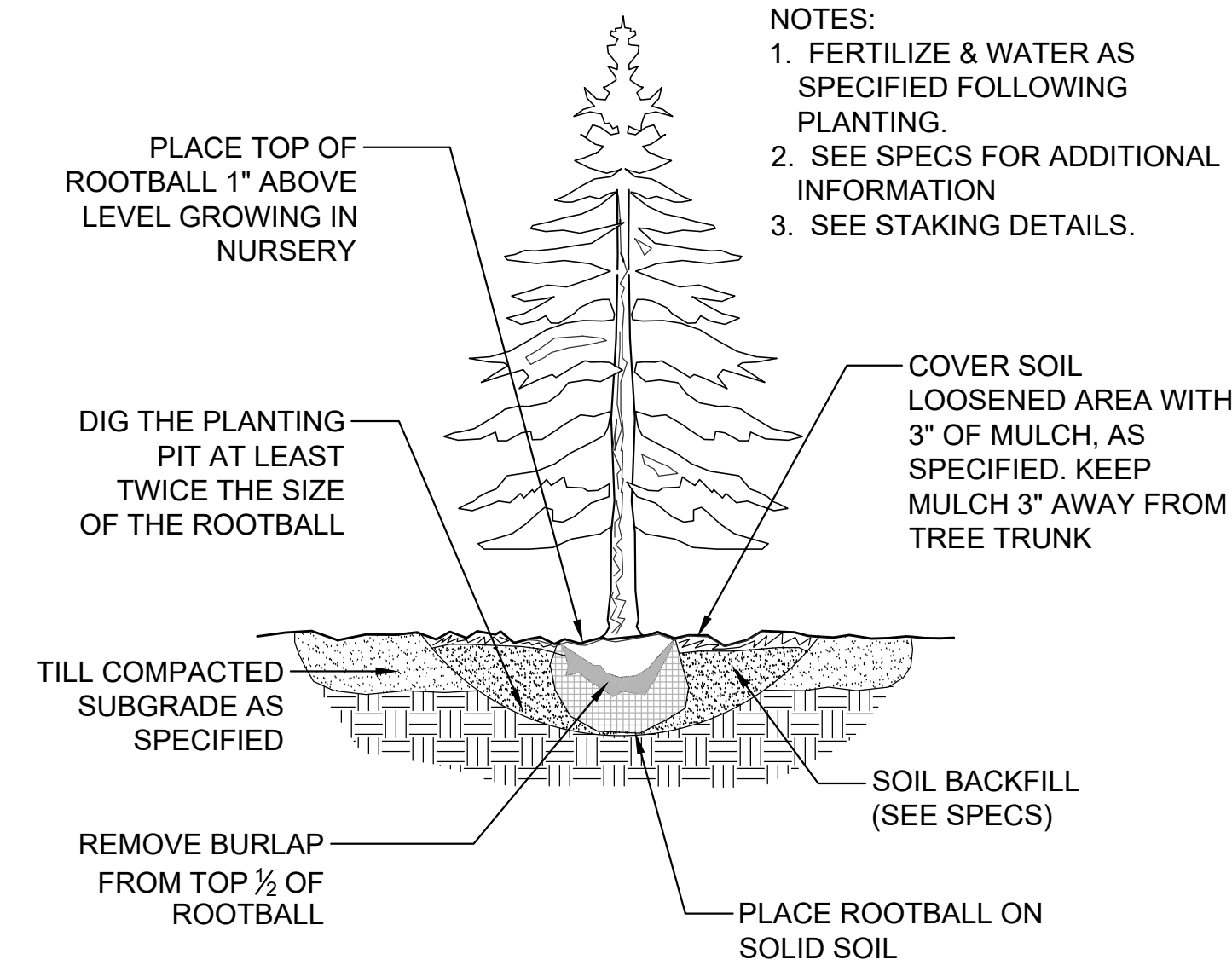

- NOTES:
- FERTILIZE & WATER AS SPECIFIED FOLLOWING PLANTING.
  - SEE SPECS FOR ADDITIONAL INFORMATION
  - SEE STAKING DETAILS.

**CONIFER PLANTING DETAIL**

SCALE: NTS

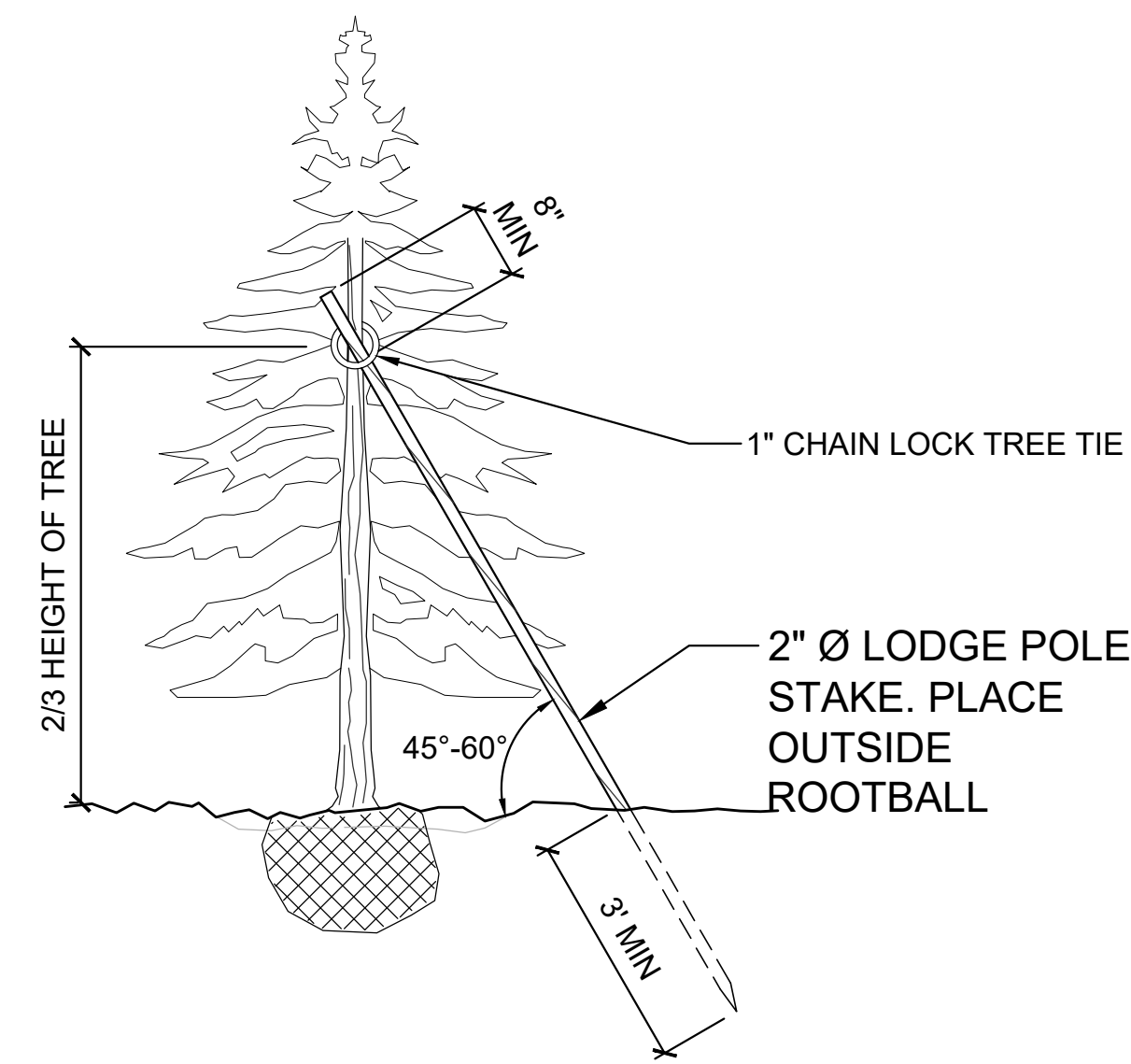

**CONIFER TREE STAKING**

SCALE: NTS

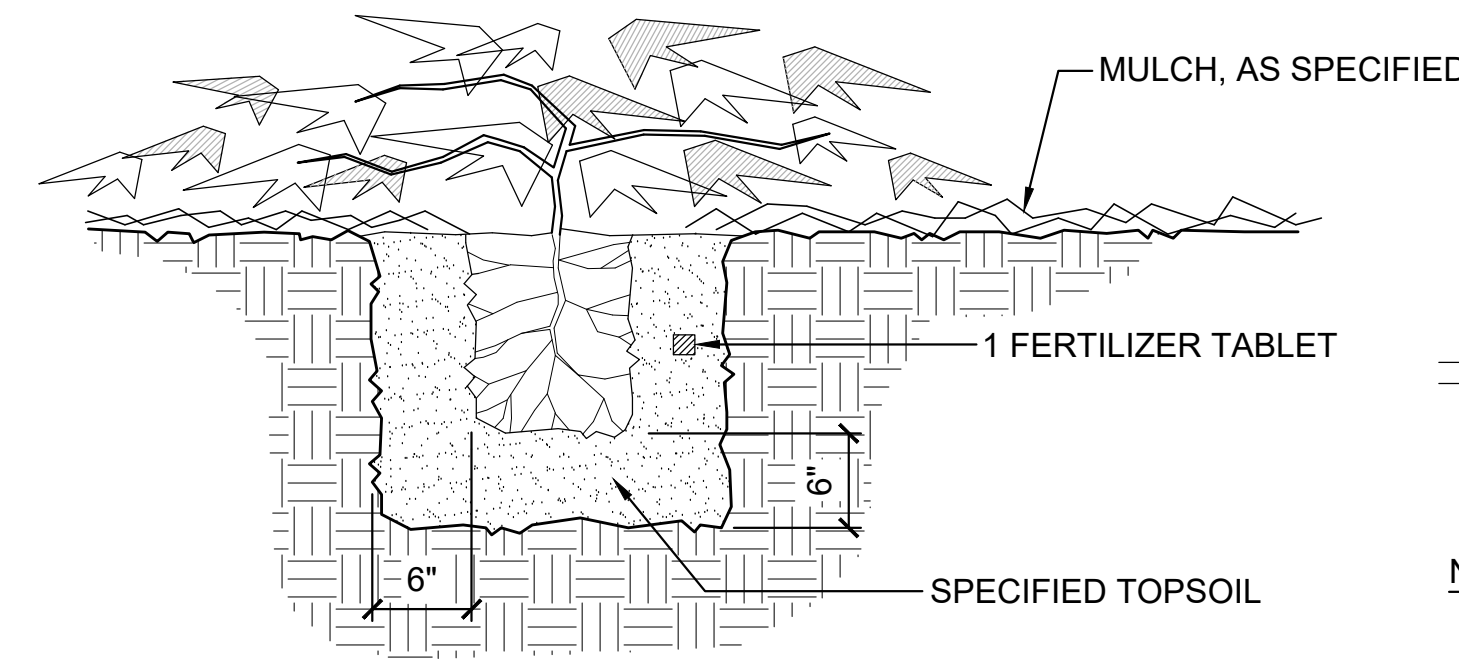

**GROUNDCOVER PLANTING DETAIL**

SCALE: NTS

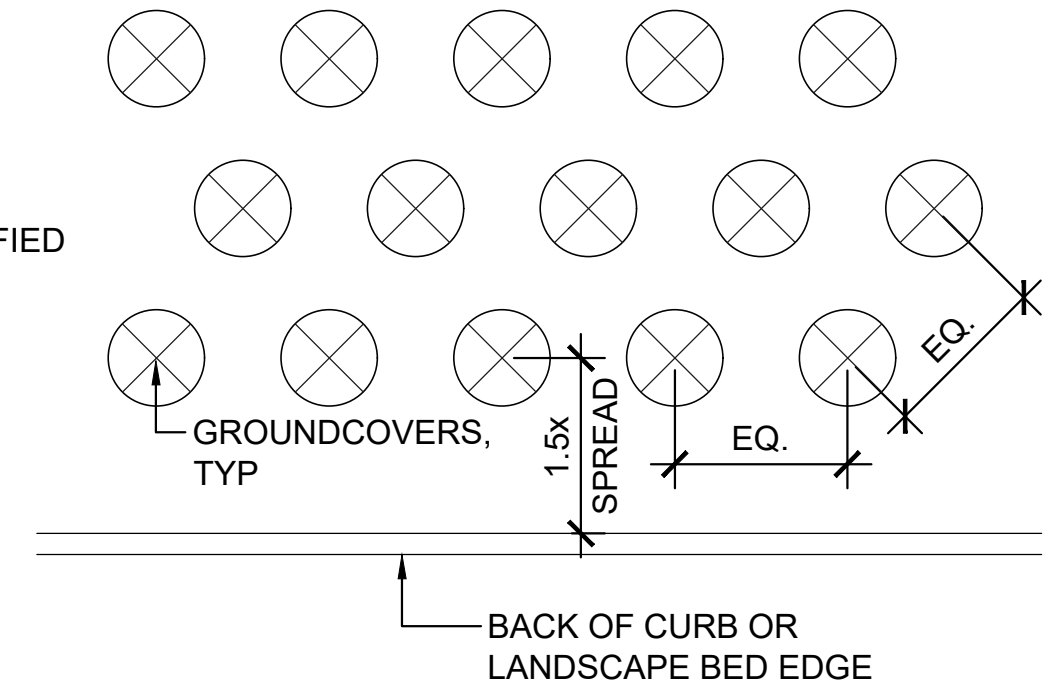

- NOTE:
- ALL GROUNDCOVER SHALL BE PLANTED AT EQUAL TRIANGULAR SPACING AS PER PLAN, UNLESS SHOWN OTHERWISE
  - SET GROUNDCOVER BACK FROM CURB OR WALKWAY AT LEAST 1-1/2 TIMES THE SPREAD OF SUCH GROUNDCOVER



SCALE: As Shown	DESIGN: ML
DATE: April 12, 2023	DRAWN: ML
PROJECT: East Town Crossing	CHECKED: EW
PROJECT NO: LLA0222.20	REVISION NUMBER:
	APPD:

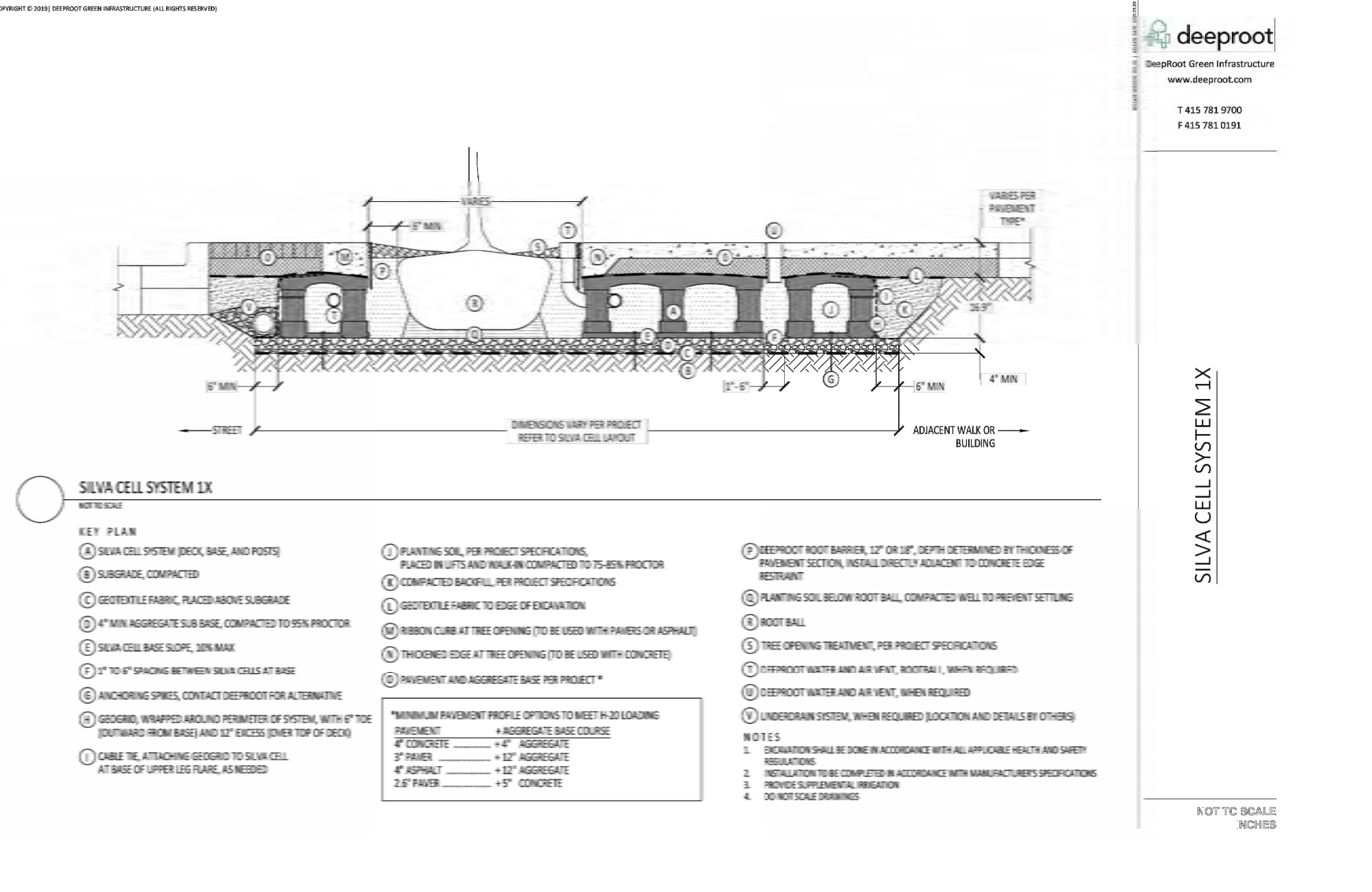
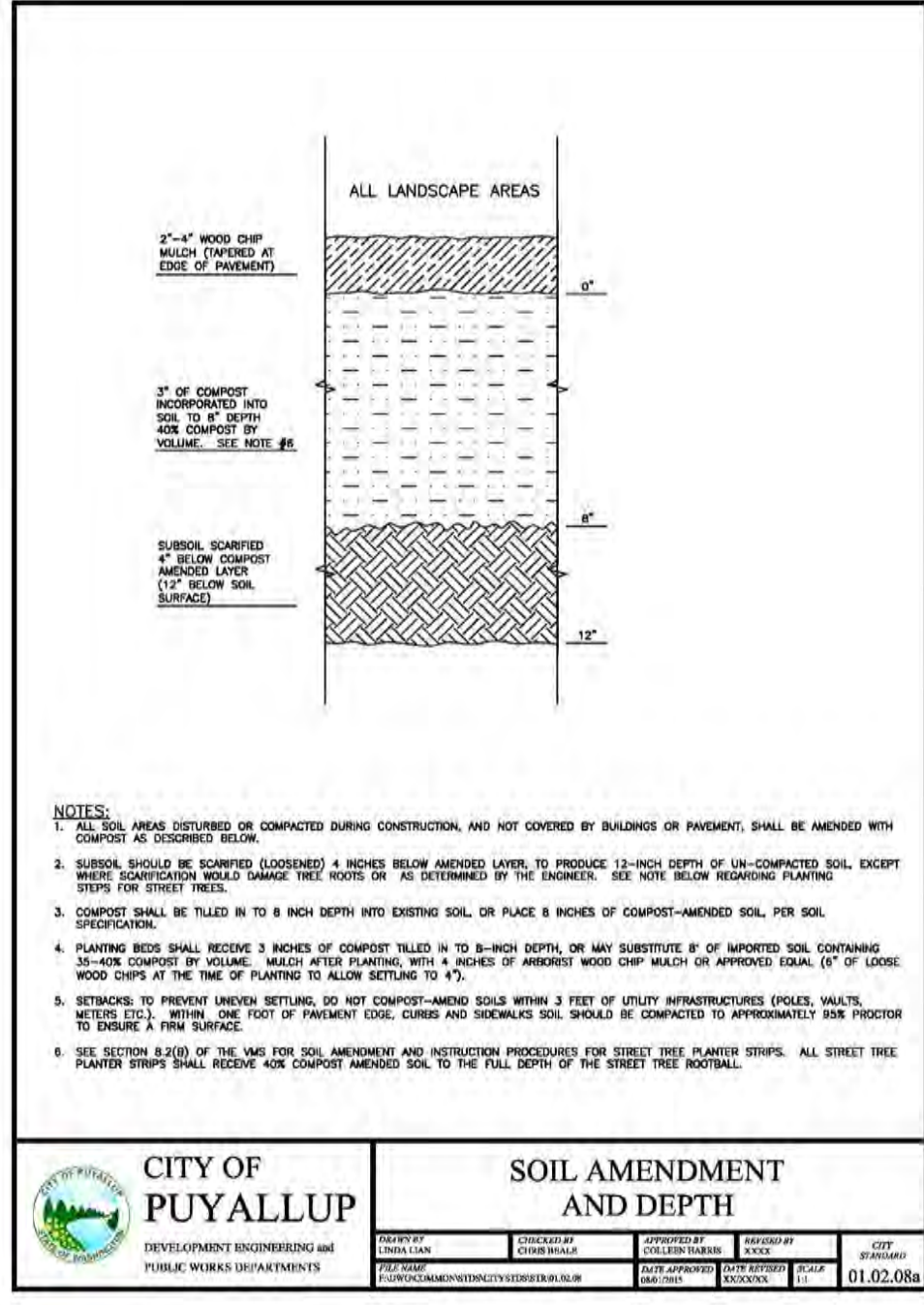
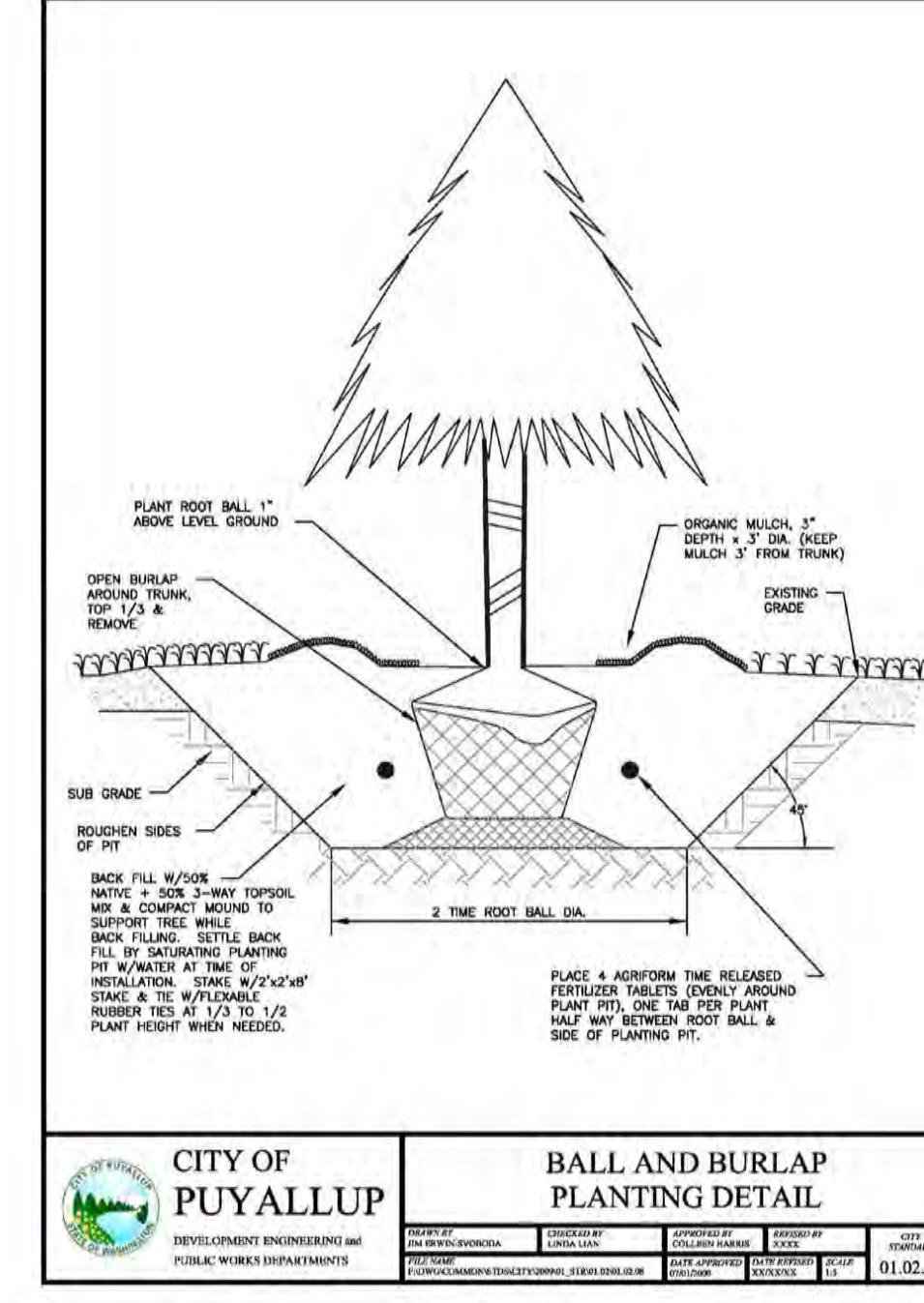
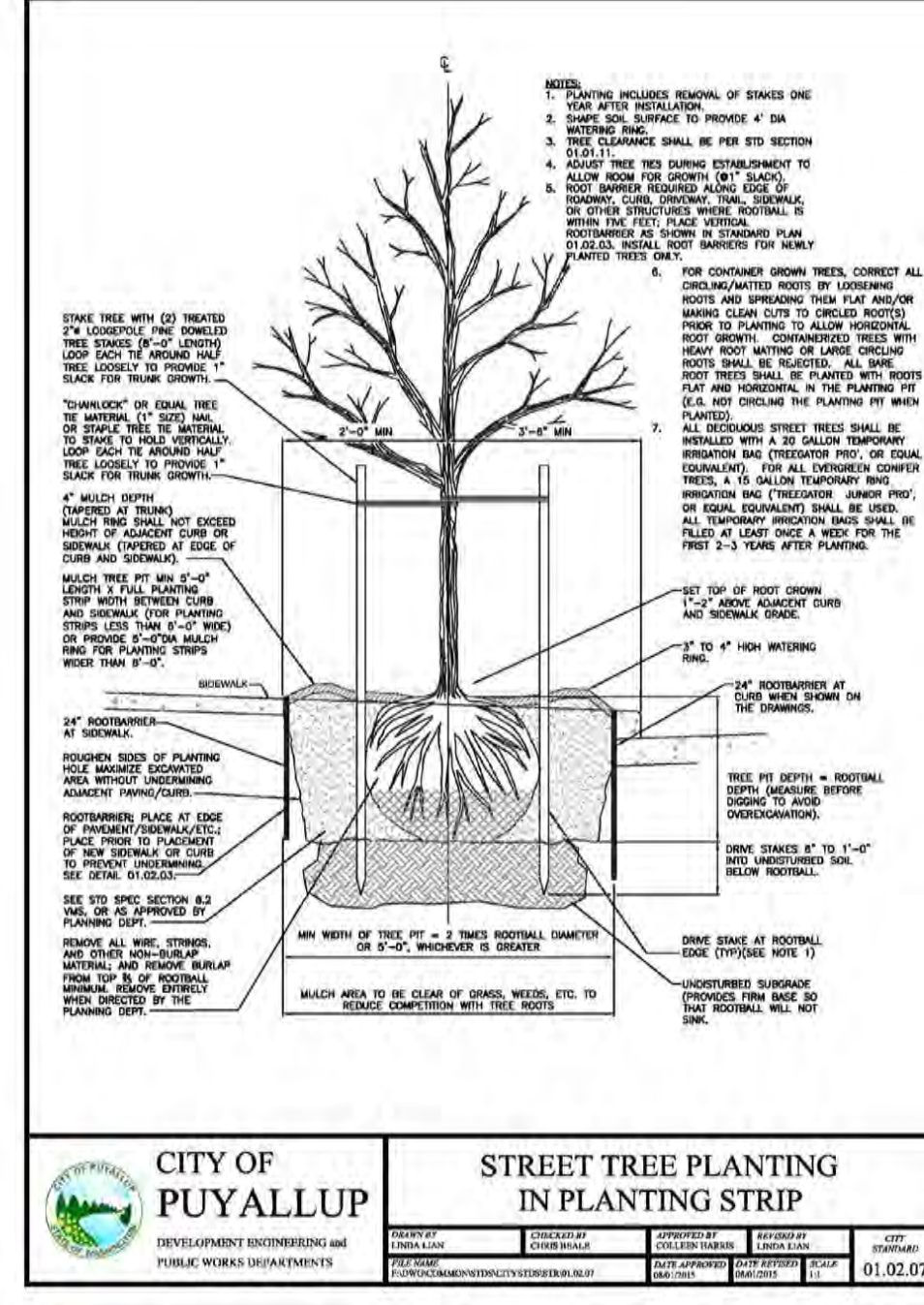
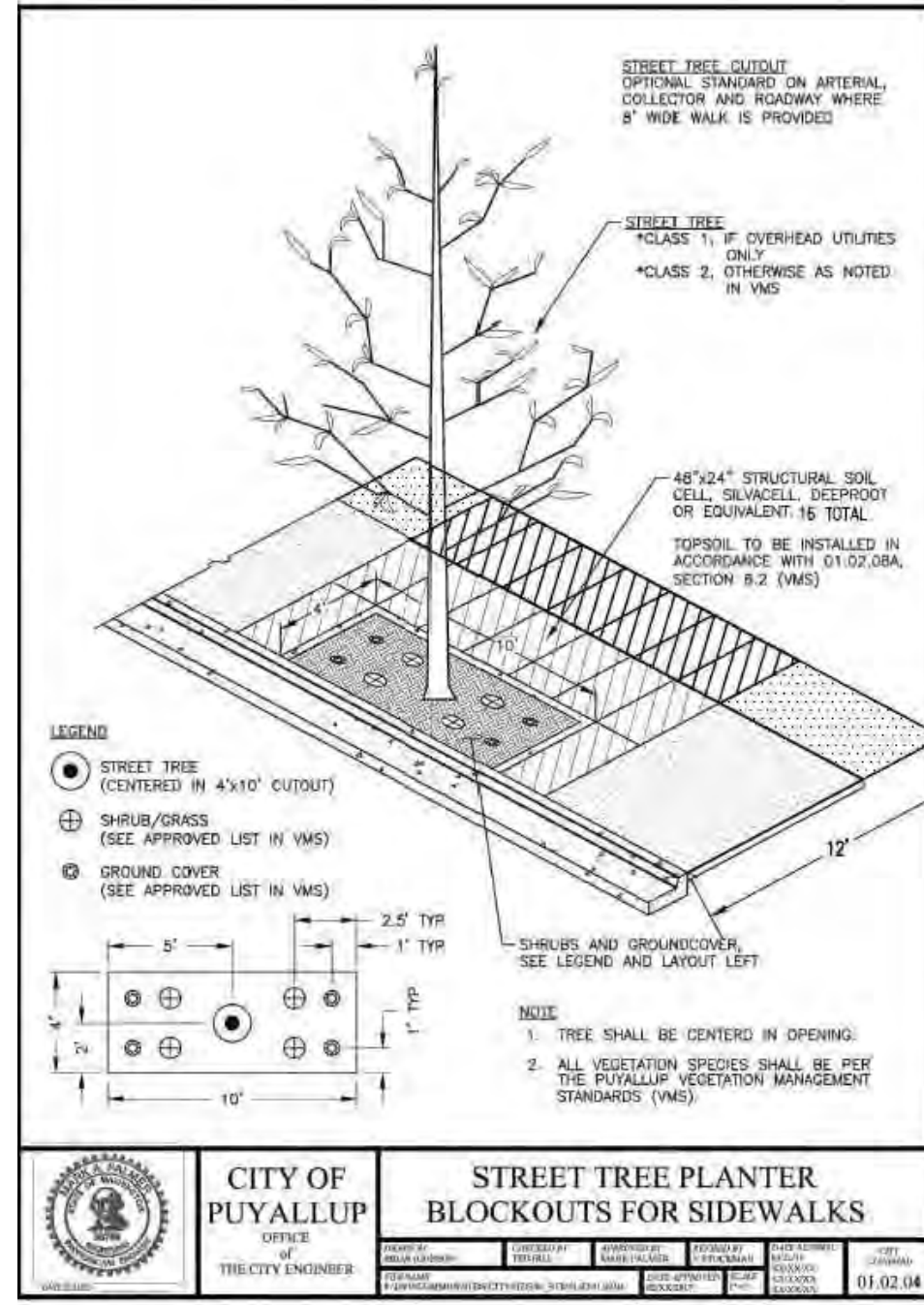
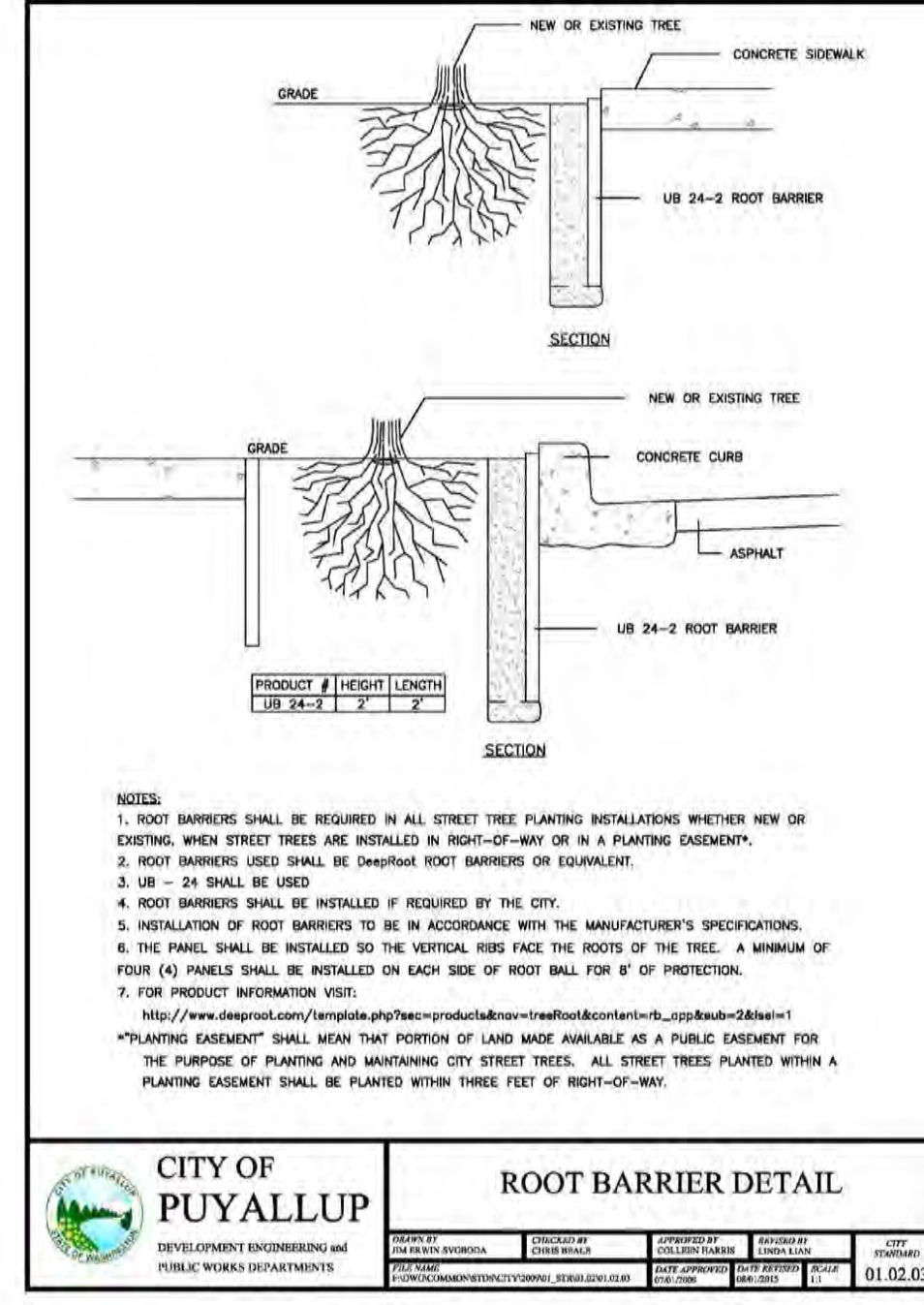
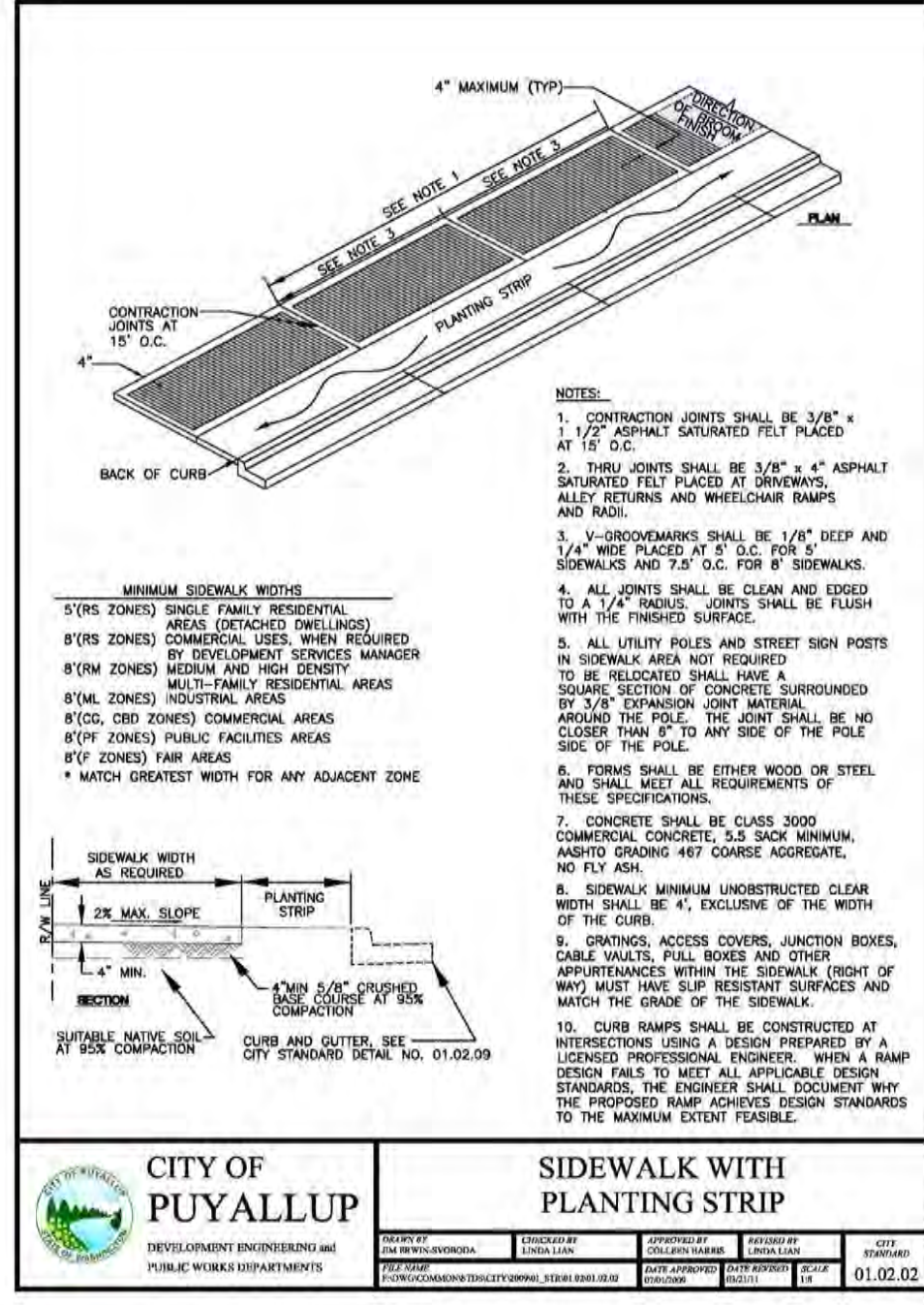

PERMIT SET



East Town Crossing  
Pioneer Way & Shaw Road  
Puyallup, WA

PROJECT



2111 South C Street, Tacoma, WA 98402  
253-678-4173 | Eric@lyonLA.com

Planting Details  
City of Puyallup

SCALE:	As Shown	DESIGN:	ML
DATE:	April 12, 2023	DRAWN:	ML
PROJECT:	East Town Crossing	CHECKED:	EW
NO.	LA0222.20	REVISION NUMBER:	

L1.7

APPD.	
REVISIONS	



PLANT IMAGES

TREES



Vine Maple



Paperbark Maple



Scarlet Sentinel Maple



Katsura Tree



Princeton American Elm



Autumn Blaze Maple



Incense Cedar



Western Red Cedar



Douglas Fir

SHRUBS



Abelia Grandiflora



Compact Strawberry Tree



Gumpo White Azalea



Deer Fern



Mexican Orange Blossom



Arctic Fire Dogwood



Dwarf Burning Bush



Pink Princess Escallonia



Jelena Witch Hazel



Nikko Blue Hydrangea



Oakleaf Hydrangea



Munstead Lavender



Compact Oregon Grape



Western Sword Fern



Rugosa Rose



Fragrant Sweet Box



Miss Kim Lilac



Evergreen Huckleberry



David's Viburnum

GRASSES & PERENNIALS



Kinnikinnick



Firefly Heather



Big Blue Lily Turf



Blue Oat Grass



Karl Foerster Feather Reed Grass



Stella de Oro Day Lily



Hameln Fountain Grass

PERMIT SET



2111 South C Street, Tacoma, WA 98402  
253-678-4173 | Eric@LyonLA.com

Plant Images

SCALE: Not to Scale	DESIGN: ML
DATE: April 12, 2023	DRAWN: ML
PROJECT: East Town Crossing	CHECKED: EW
PROJECT NO: LLA0222.20	REVISION NUMBER:

APPD.
REVISIONS

L1.8



East Town Crossing  
Pioneer Way & Shaw Road  
Puyallup, WA

PROJECT

ultraPLAY UPLAY TODAY

PIKE'S PEAK

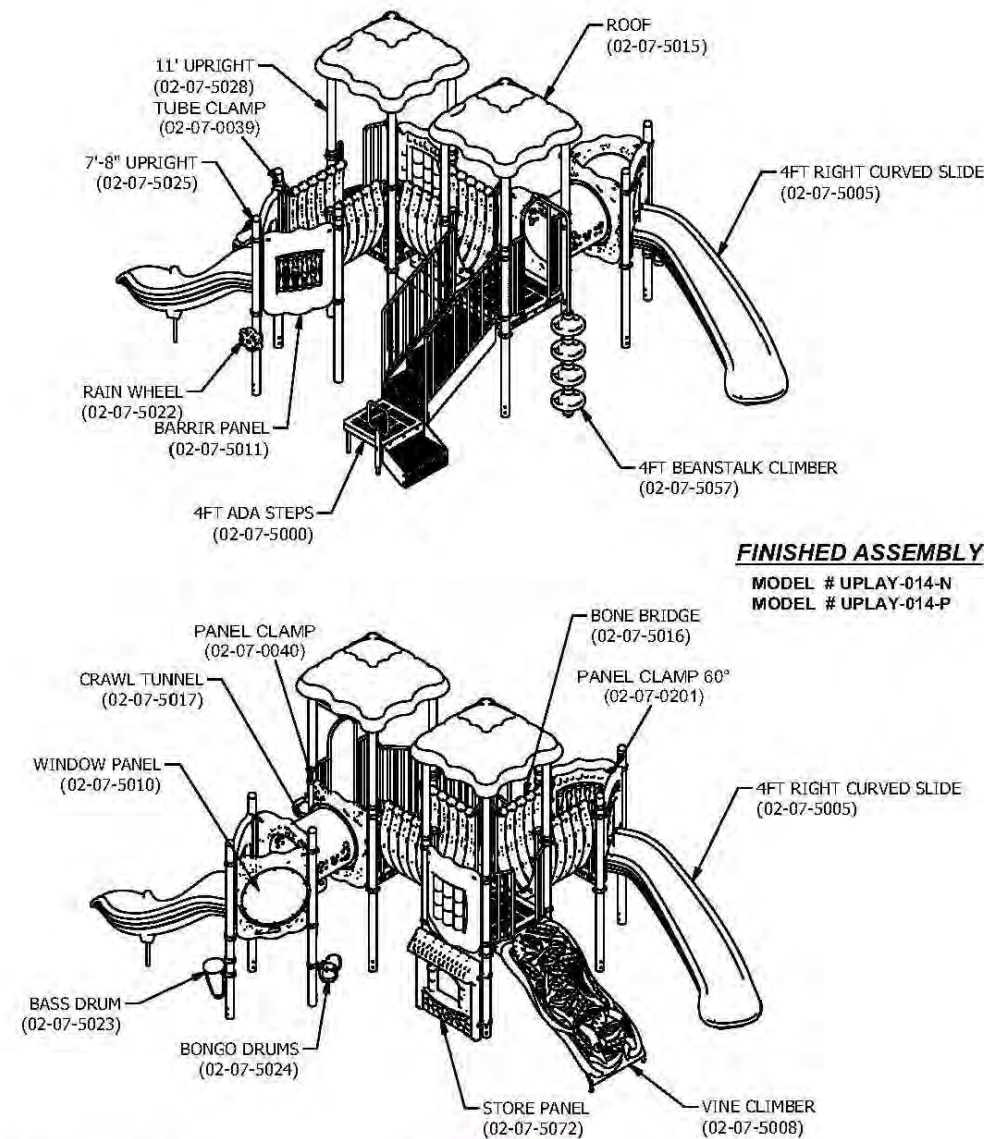

Issued/Revised: 12/11/2014



800.458.5872

www.ultraplay.com 27

PLAYGROUND EQUIPMENT



EXERCISE EQUIPMENT



ELECTRIC VEHICLE CHARGING STATIONS



BIKE RACKS

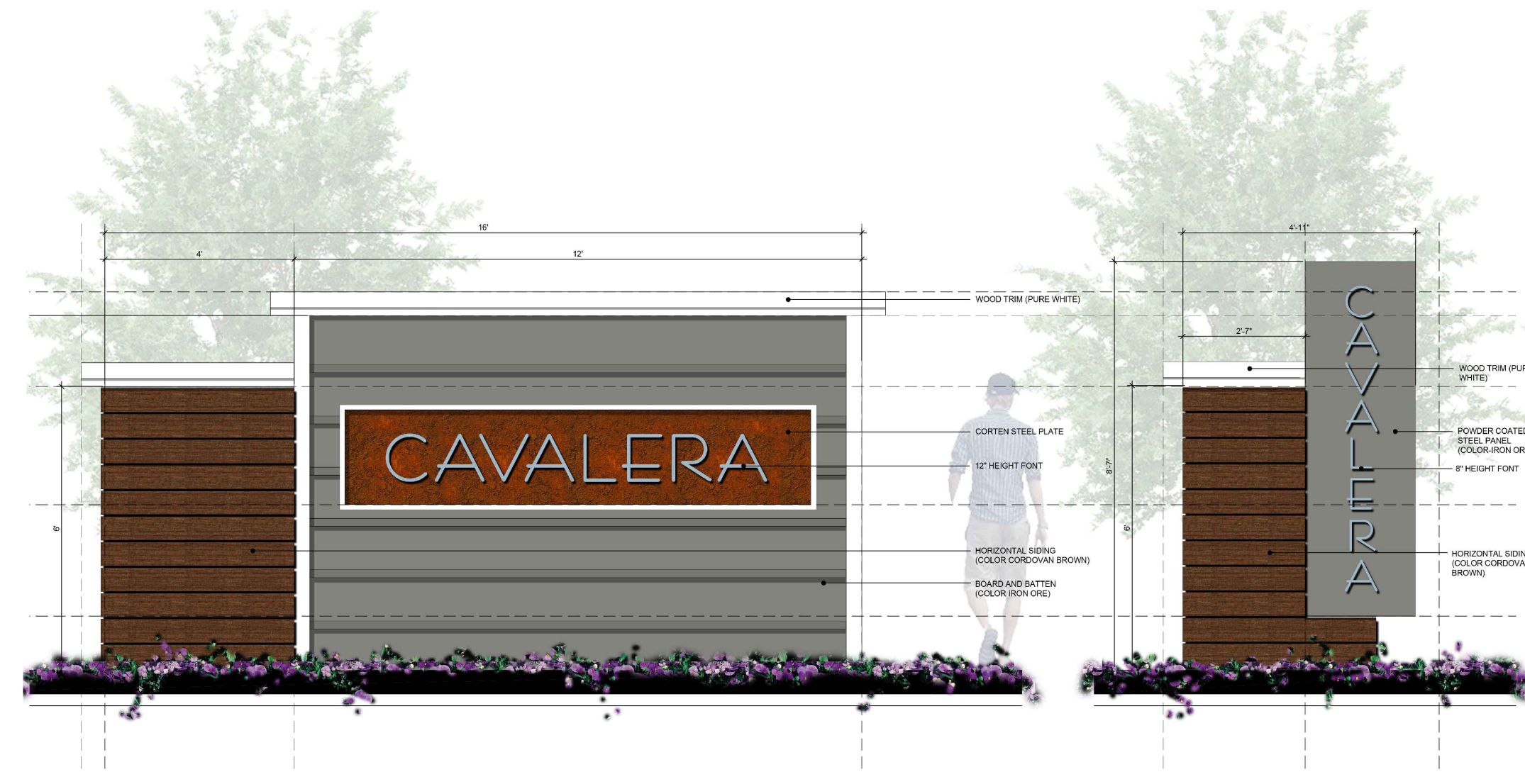

ENTRY MONUMENT



ORNAMENTAL IRON FENCE

PERMIT SET



East Town Crossing  
Pioneer Way & Shaw Road  
Puyallup, WA

PROJECT

**LYON**  
Landscape Architects  
2111 South C Street, Tacoma, WA 98402  
253-678-4173 | Eric@LyonLA.com

Site Plan Images

REVISIONS	APPD.

SCALE: Not to Scale	DESIGN: ML
DATE: April 12, 2023	DRAWN: ML
PROJECT: East Town Crossing	CHECKED: EW
PROJECT NO: LLA0222.20	REVISION NUMBER: