

AREA SUBJECT TO MITIGATION PER ENVIRONMENTAL ENGINEER

OFF-SITE WETLAND W/ 80' BUFFER

BUFFER SUBJECT TO VARIANCE APPLICATION: 12' LANDSCAPE BUFFER W/ 6' HIGH WOOD FENCE, 4' BERM & 4' RETAINING WALL TOWARD SITE INTERIOR (20.26.500(1))

20.26.500(6) HEIGHT SETBACK: 36'-8" TO YIELD UP TO 40' HEIGHT

20.26.500(6) HEIGHT SETBACK: 36'-8" TO YIELD UP TO 40' HEIGHT

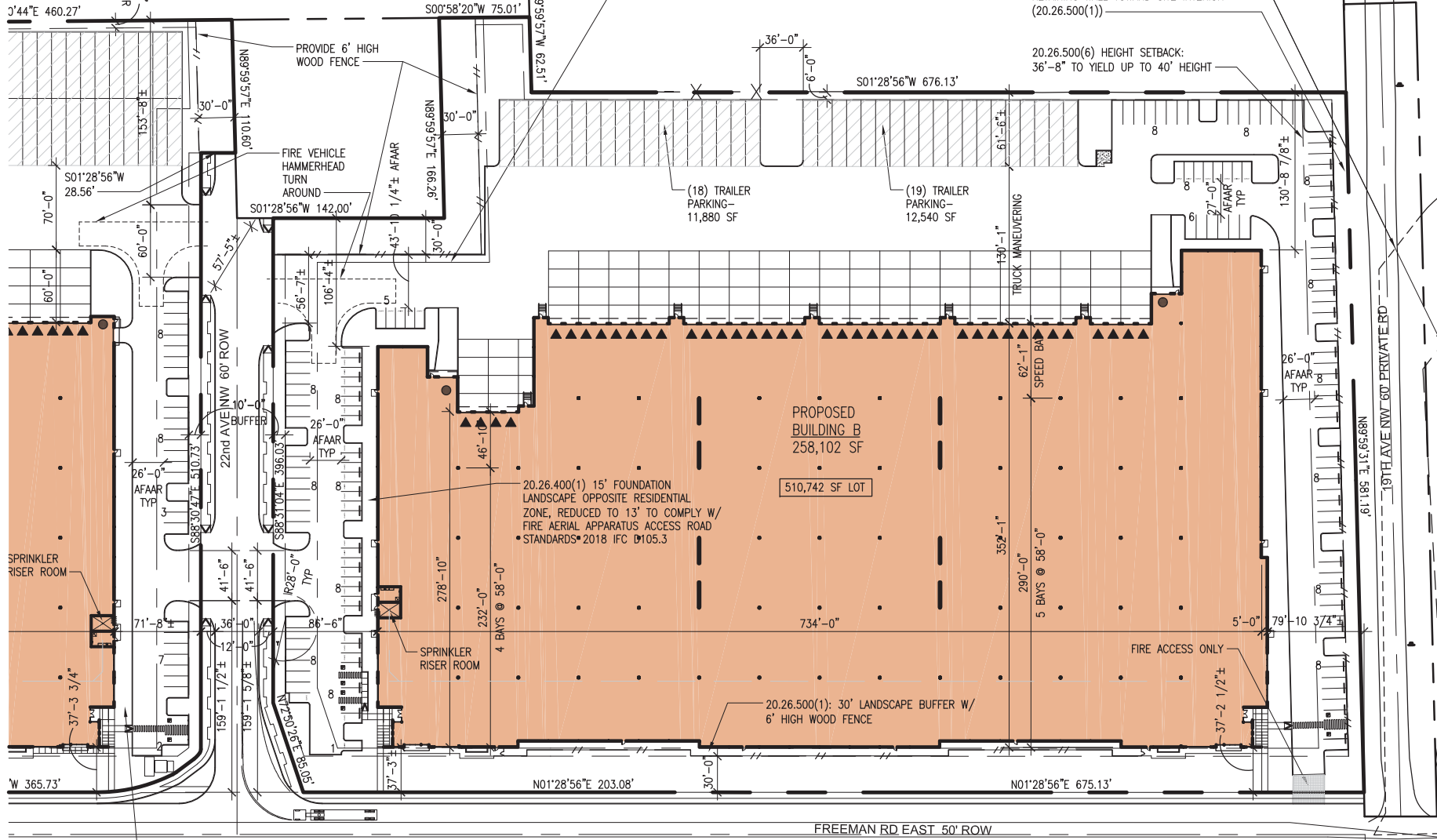

REDUCED SITE PLAN: NTS  
 FREEMAN LOGISTICS  
 PUYALLUP, WA - 98371

Digitally signed by  
 Randy Brown  
 Date:  
 2023.11.27  
 17:34:45 -08'00'

**SYNTHESIS PLLC**  
 THE FUSION OF ARCHITECTURE, DESIGN, TECHNOLOGY & PEOPLE  
 12503 NE Bel-Red Road, Suite 100  
 Bellevue, WA 98005  
 p 425 646 1818 f 425 646 4141

201401.13.031  
**A1.1-SITE**  
 supplemental drawing  
**11/27/2023**  
 date

# VICINITY MAP

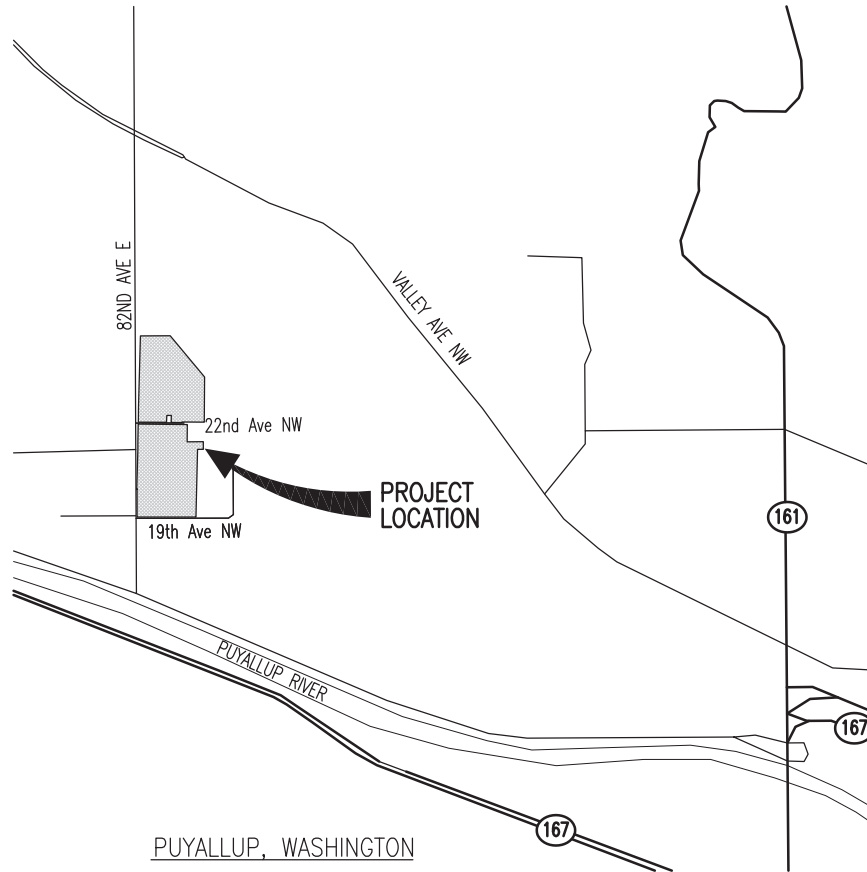

<b>VICINITY MAP</b>
<b>FREEMAN LOGISTICS</b>
PUYALLUP, WA - 98371

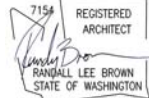
	Digitally signed by <b>Randy Brown</b> Date: 2023.11.27 17:35:04 -08'00'
---	---

12503 NE Bel-Red Road, Suite 100 Bellevue, WA 98005 p 425 646 1818 f 425 646 4141
© 2021 SYNTHESIS PLLC

201401.13.031
<b>A1.1-VICI</b>
supplemental drawing
<b>11/27/2023</b>
date