



Pre-Application

THE WASHINGTON STATE FAIR
**INTERNATIONAL
 VILLAGE**



**JEFF BROWN
 ARCHITECTURE**

JEFF BROWN ARCHITECTURE
 12181 C STREET SOUTH
 TACOMA, WA 98444

PROJECT LEAD

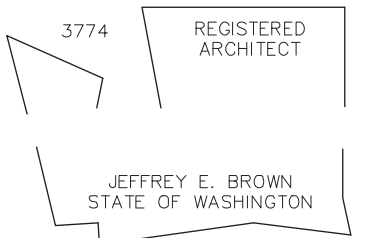

PROJECT NAME/ADDRESS

INTERNATIONAL VILLAGE
 Washington State Fair
 Puyallup, WA

COPY RIGHT 2022 JEFF BROWN ARCHITECTURE
 THESE DOCUMENTS HAVE BEEN PREPARED
 SPECIFICALLY FOR THE ABOVE NAMED PROJECT.
 THEY ARE NOT SUITABLE FOR USE ON OTHER
 PROJECTS OR IN OTHER LOCATIONS WITHOUT THE
 APPROVAL AND PARTICIPATION OF THE
 ARCHITECT.

PROJECT NUMBER

DRAWING TYPE

| DATE | ISSUE | NO. |
|------|-------|-----|
| | | |
| | | |
| | | |
| | | |
| | | |

SHEET TITLE

SHEET #

PA.0

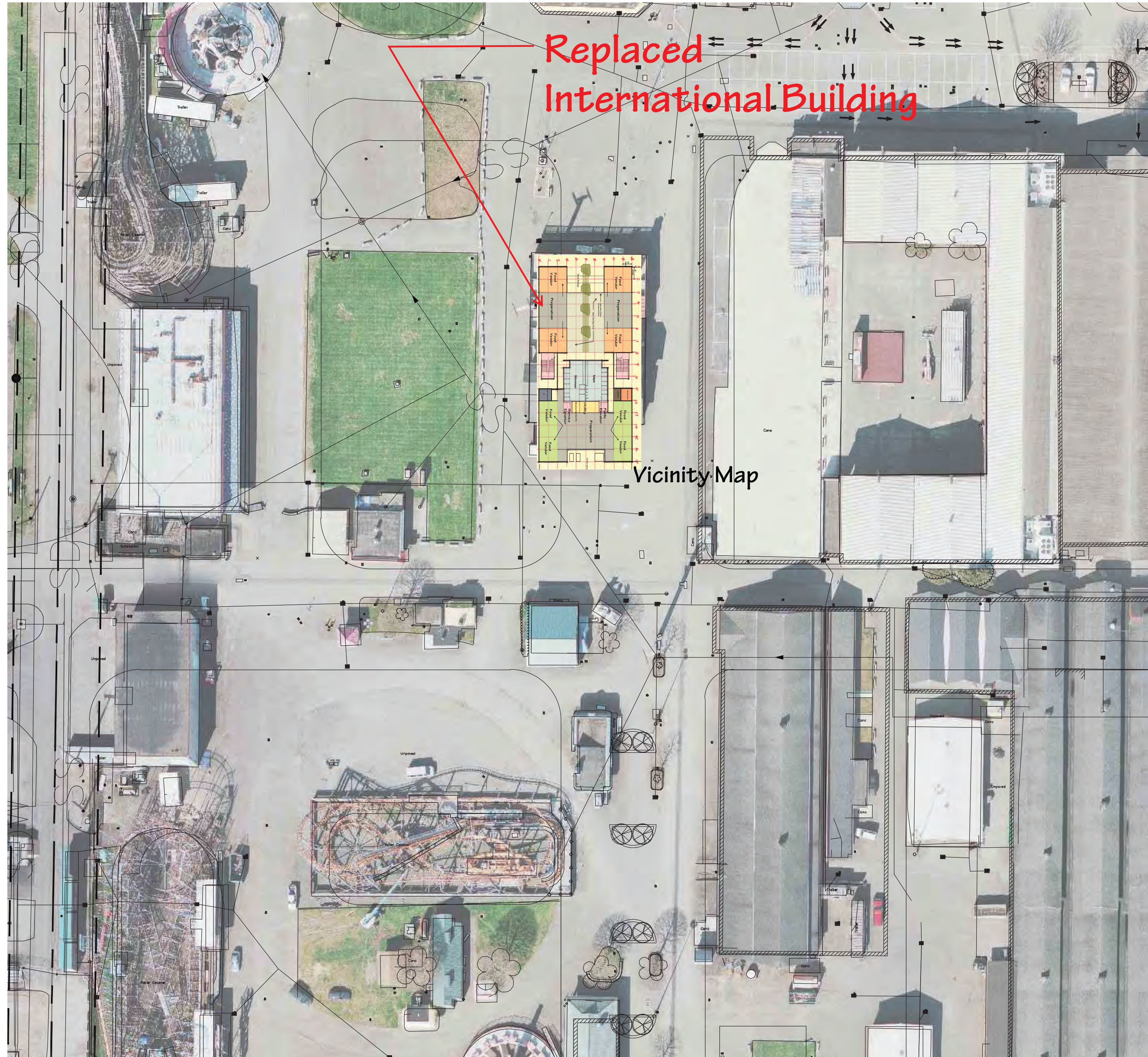

SITE PLAN



**Vicinity Map
SITE NARRATIVE**

The site for the New International Village is the same as at the original facility. A survey was conducted which located most of the utility infrastructure. Soils testing was also conducted. As the project proceeds, the Fair is focused on the appropriate connection to utilities. There is also a focus on fire hydrants, fire flow and emergency vehicle access. We have appreciated earlier Gold Gate discussion with the City pertaining to these critical issues. It is important to the Fair to incrementally be aware of the larger site issues as incremental projects proceed. An ongoing discussion of life safety strategy is welcomed.

THE WASHINGTON STATE FAIR
**INTERNATIONAL
VILLAGE**



**JEFF BROWN
ARCHITECTURE**

JEFF BROWN ARCHITECTURE
12181 C STREET SOUTH
TACOMA, WA 98444

PROJECT LEAD

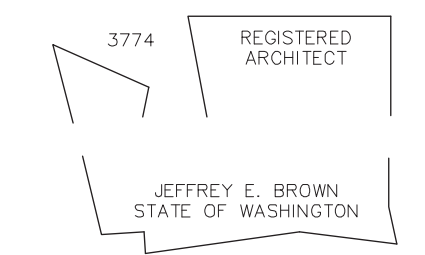

PROJECT NAME/ADDRESS

COPY RIGHT 2022 JEFF BROWN ARCHITECTURE
THESE DOCUMENTS HAVE BEEN PREPARED
SPECIFICALLY FOR THE ABOVE NAMED PROJECT.
THEY ARE NOT SUITABLE FOR USE ON OTHER
PROJECTS OR IN OTHER LOCATIONS WITHOUT THE
APPROVAL AND PARTICIPATION OF THE
ARCHITECT.

PROJECT NUMBER _____

DRAWING TYPE _____

Site Plan

| DATE | ISSUE | NO. |
|-------|-------|-------|
| _____ | _____ | _____ |
| _____ | _____ | _____ |
| _____ | _____ | _____ |
| _____ | _____ | _____ |
| _____ | _____ | _____ |

SHEET TITLE _____

SHEET # _____



JEFF BROWN ARCHITECTURE

JEFF BROWN ARCHITECTURE
12181 C STREET SOUTH
TACOMA, WA 98444

PROJECT LEAD

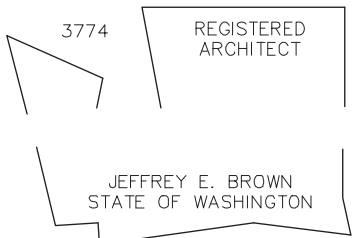

PROJECT NAME/ADDRESS

INTERNATIONAL VILLAGE
Washington State Fair
Puyallup, WA

COPY RIGHT 2022 JEFF BROWN ARCHITECTURE
THESE DOCUMENTS HAVE BEEN PREPARED SPECIFICALLY FOR THE ABOVE NAMED PROJECT. THEY ARE NOT SUITABLE FOR USE ON OTHER PROJECTS OR IN OTHER LOCATIONS WITHOUT THE APPROVAL AND PARTICIPATION OF THE ARCHITECT.

PROJECT NUMBER

DRAWING TYPE

Floor Plan

DATE ISSUE NO.

SHEET TITLE

SHEET #

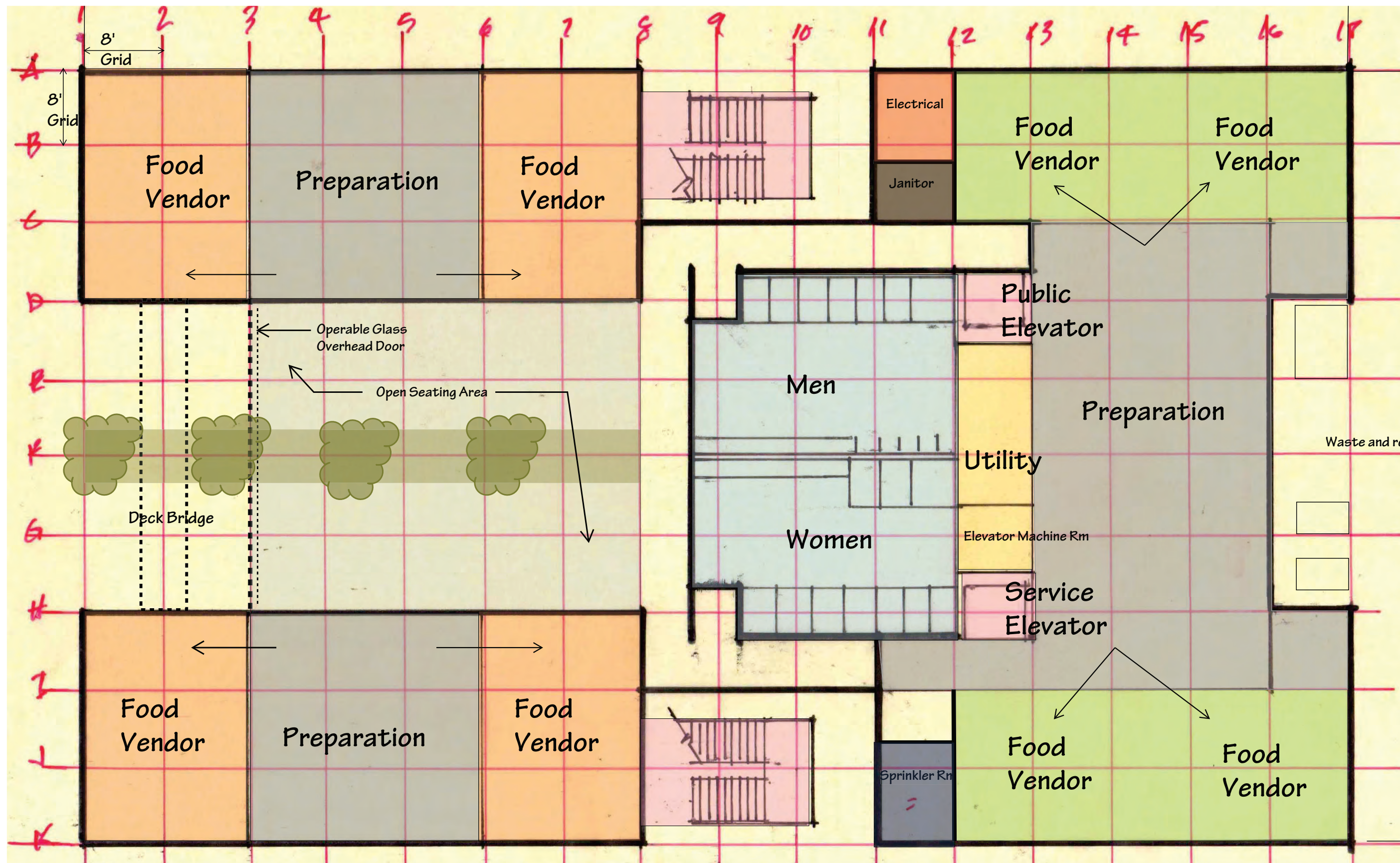

GROUND FLOOR

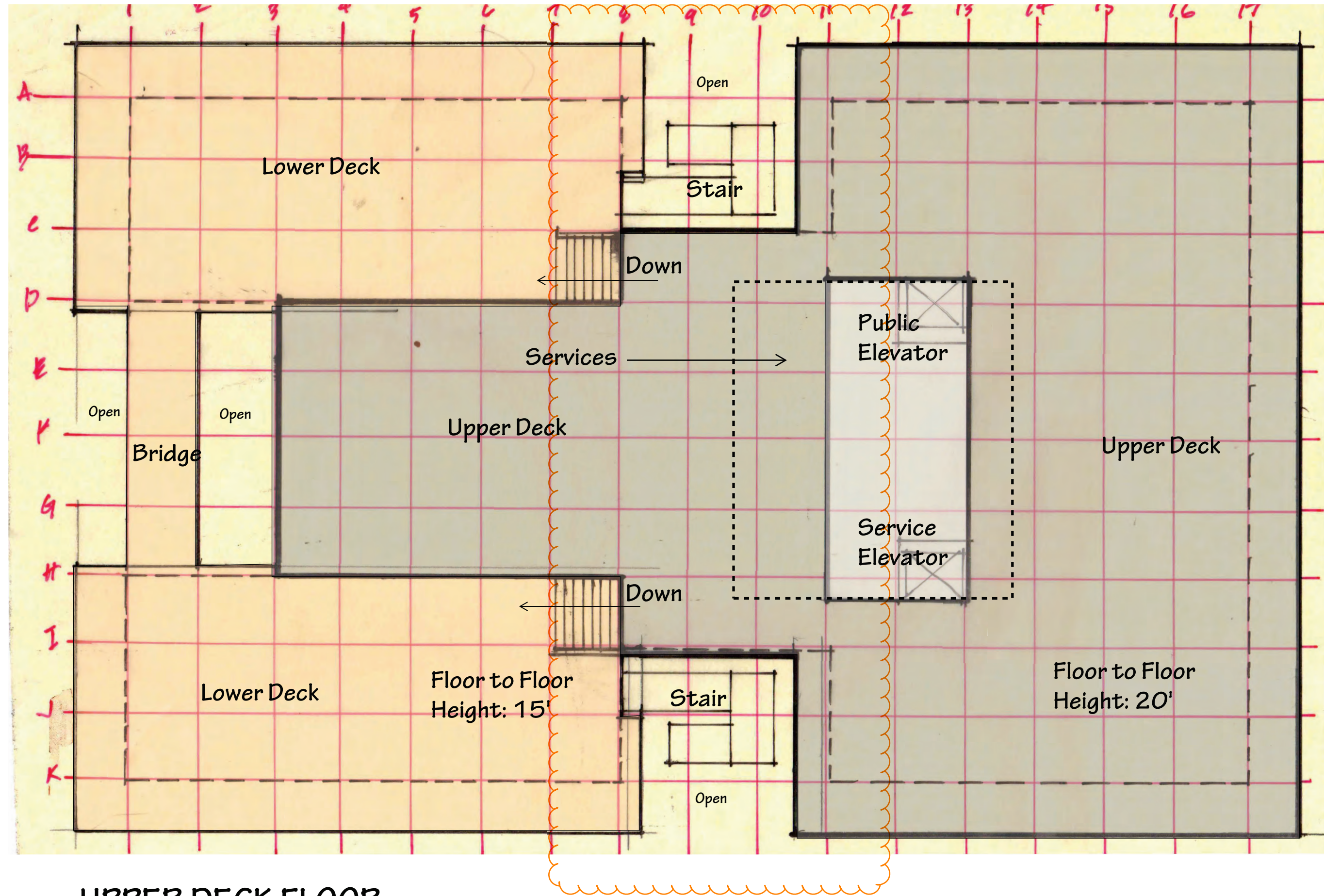

UPPER DECK FLOOR

INTERNATIONAL VILLAGE NARRATIVE

The International Village Food Facility has been a mainstay of the Washington State Fair for decades. With the changing needs of patrons and an aging facility, the Fair has elected to replace the International Village with a contemporary version of the same venue and re-open for the FAIR 100 year celebration in the fall of 2025..

The proposed replacement structure covers the same approximate footprint as the existing restaurant and is also a two-story facility. The floor area of the lower floor is approximately 10,000 SF. The roof is slightly larger.

The lower floor holds the traditional Fair-style food vendors on the perimeter. This Pre-application concept illustrates perimeter food vendors and an interior outdoor court. At the South end is a restroom core and an elevator with mechanical and electrical support rooms. This end of the building may also include a larger preparatory kitchen for service for the roof top dining services.

The upper floor is a roof top dining venue, much like the current International Village facility. This level will serve food and drinks as well. On the East and West flanks of the structure are two exterior exit stairs to the open-air roof dining venue.

The new facility will be fire sprinklered and will have a fire alarm system meeting current standards.

The new facility will also revisit the utility requirements electrical service, sanitary sewer, storm water service and current natural gas. In addition, grease hoods and a grease interceptor will be addressed.

1007.1.1 Two exits or exit access doorways. Where two exits, exit access stairways or ramps, or any combination thereof, are required from any portion of the exit access, they shall be placed a distance apart equal to not less than one-half of the length of the maximum overall diagonal dimension of the building or area to be served measured in a straight line between them. Interlocking or scissor stairways shall be counted as one exit stairway.
Exceptions:
** 2. Where a building is equipped throughout with an automatic sprinkler system in accordance with Section 903.3.1.1 or 903.3.1.2, the separation distance shall be not less than one-third of the length of the maximum overall diagonal dimension of the area served.

***The proposed floor design does not appear to meet the egress separation requirement. Provide code path that supports current egress design for anticipated occupant load.

THE WASHINGTON STATE FAIR INTERNATIONAL VILLAGE