

SITE INFORMATION

PARCEL NO. 0419034036
 ADDRESS: 1019 - 1021 39TH AVENUE S.E.
 PARCEL AREA: 61.28 ACRES

LEGAL DESCRIPTION
 Section 03 Township 19 Range 04 Quarter 42 LOT 1 OF BLR 2022-03-22-5003 A POR OF BLR 2019-05-22-5002 LY IN CY OF PUYALLUP MORE PARTICULARLY DESC AS FOLL COM AT STONE MON MARKING S 1/4 COR OF SEC SD STONE MON LIES N 86 DEG 31 MIN 42 SEC W 2621.06 FT FROM SE COR OF SD SEC 3 TH N 00 DEG 00 MIN 24 SEC E ALG W LI OF SE 1/4 OF SD SEC 3 43.08 FT TO PT OF BEG TH CONT ALG W LI OF SD SE 1/4 N 00 DEG 00 MIN 24 SEC E 2556.43 FT TH S 87 DEG 44 MIN 17 SEC E 496.53 FT TH S 00 DEG 04 MIN 00 SEC W 132.96 FT TH S 16 DEG 29 MIN 57 SEC E 15.96 FT TH S 00 DEG 00 MIN 36 SEC E 335.82 FT TH S 52 DEG 49 MIN 01 SEC E 132.81 FT TH S 89 DEG 15 MIN 41 SEC E 28.82 FT TH S 82 DEG 14 MIN 13 SEC E 58.63 FT TH S 53 DEG 48 MIN 38 SEC E 13.69 FT TH S 37 DEG 10 MIN 59 SEC W 232.64 FT TH S 00 DEG 15 MIN 12 SEC E 225.75 FT TH S 89 DEG 59 MIN 00 SEC W 80.33 FT TH S 00 DEG 00 MIN 36 SEC W 489.86 FT TH N 89 DEG 59 MIN 00 SEC E 547.26 FT TH N 00 DEG 00 MIN 36 SEC E 860.97 FT TH S 89 DEG 41 MIN 48 SEC E 381.02 FT TH S 33 DEG 03 MIN 35 SEC E 199.54 FT TH S 00 DEG 13 MIN 45 SEC W 1645.13 FT TH N 86 DEG 31 MIN 42 SEC W 295.47 FT TH S 00 DEG 13 MIN 45 SEC W 332.49 FT TH N 87 DEG 01 MIN 38 SEC W 580.68 FT TH N 00 DEG 52 MIN 42 SEC E 677.52 FT TH N 89 DEG 59 MIN 36 SEC W 125.03 FT TH S 45 DEG 04 MIN 35 SEC W 283.07 FT TO A NON-TANG CURVE CONCAVE TO W HAVING A RAD OF 205 FT RAD PT OF WHICH BEARS N 87 DEG 53 MIN 38 SEC W TH SLY ALG ARC OF SD CURVE THRU A CIA OF 33 DEG 00 MIN 39 SEC FOR 118.11 FT TH S 32 DEG 19 MIN 16 SEC W 41.17 FT TH S 45 DEG 04 MIN 35 SEC W 113.76 FT TO A C TO L HAVING A RAD OF 254 FT TH ALG ARC OF SD CURVE THRU A CIA OF 18 DEG 36 MIN 33 FOR 82.50 FT TH S 25 DEG 10 MIN 59 SEC W 11.39 FT TH S 19 DEG 13 MIN 48 SEC W 41.03 FT TH S 13 DEG 32 MIN 58 SEC W 10.80 FT TO A NON-TANG CURVE CONCAVE TO E HAVING A RAD OF 254 FT RAD PT OF WHICH BEARS S 77 DEG 48 MIN 15 SEC E TH SLY ALG ARC OF SD CURVE THRU A CIA OF 06 DEG 43 MIN 28 SEC FOR 29.81 FT TH S 87 DEG 01 MIN 38 SEC E 27.68 FT TH S 02 DEG 58 MIN 22 SEC W 33.74 FT TH N 87 DEG 38 SEC W 28.12 FT TH S 03 DEG 27 DEG 46 SEC W 10.16 FT TH N 87 DEG 01 MIN 38 SEC W 59.99 FT TH S 47 DEG 58 MIN 22 SEC W 29.08 FT TH N 86 DEG 31 MIN 42 SEC W 12.85 FT TH N 00 DEG 00 MIN 24 SEC E 69.13 FT TH N 86 DEG 31 MIN 42 SEC W 58.60 FT TH S 45 DEG 04 MIN 35 SEC W 23.32 FT TH S 00 DEG 00 MIN 24 SEC W 55.66 FT TH N 86 DEG 31 MIN 42 SEC W 28.05 FT TO POB EASE OF REC OUT OF 04-19-03-4-031, 4-032 & 4-034 SEG 2019-0472 05/30/19 JP 20190652DC 03/31/22 JP

PARCEL NO. 0419034037
 ADDRESS: 1023 39TH AVENUE S.E.
 PARCEL AREA: 15.77 ACRES

LEGAL DESCRIPTION
 Section 03 Township 19 Range 04 Quarter 42 LOT 2 OF BLR 2022-03-22-5003 A POR OF BLR 2019-05-22-5002 LY IN CY OF PUYALLUP MORE PARTICULARLY DESC AS FOLL COM AT STONE MON MARKING S 1/4 COR OF SEC 3 SD STONE MON LIES N 86 DEG 31 MIN 42 SEC E 2621.06 FT FROM SE COR OF SD SEC 3 TH N 00 DEG 00 MIN 24 SEC E 2599.51 FT TH S 87 DEG 44 MIN 17 SEC E 496.53 FT TO POB TH S 00 DEG 04 MIN 17 SEC W 132.96 FT TH S 16 DEG 29 MIN 57 SEC E 15.96 FT TH S 00 DEG 00 MIN 36 SEC E 335.82 FT TH S 52 DEG 49 MIN 01 SEC E 132.81 FT TH S 89 DEG 15 MIN 41 SEC E 28.82 FT TH S 82 DEG 14 MIN 13 SEC E 58.63 FT TH S 53 DEG 48 MIN 38 SEC E 78.9 FT TH S 89 DEG 41 MIN 48 SEC E 655.79 FT TH S 83 DEG 08 MIN 36 SEC E 199.54 FT TH N 00 DEG 13 MIN 45 SEC W 55.66 FT TH N 86 DEG 31 MIN 42 SEC W 1118.01 FT TO POB EASE OF REC OUT OF 04-19-03-4-031 & 4-034 SEG 2019-0472 05/30/19 JP 20190652DC 03/31/22 JP

OVERALL SCOPE OF WORK

SUB-STATION AREA (PARCEL 0419034036)
 CONSTRUCT NEW 1,350 SF MEDIUM VOLTAGE (MV) SWITCHGEAR BUILDING

SUB-STATION AREA & DATA CENTER SITE (PARCELS 0419034036 & 0419034037)
 INSTALL NEW MEDIUM VOLTAGE UNDERGROUND ELECTRICAL FEEDER FROM SWITCHGEAR BUILDING TO EXISTING DATA CENTER

SOUTH UTILITY YARD (PARCEL 0419034037)
 INSTALL 4 NEW AIR COOLED CHILLERS & PUMPS
 INSTALL 1 NEW COOLING TOWER
 INSTALL 3 NEW HYBRID FLUID COOLERS

NORTH UTILITY YARD (PARCEL 0419034037)
 REMOVE 2 EXISTING DIESEL GENERATORS
 INSTALL 10 NEW DIESEL GENERATORS
 INSTALL NEW MV SWITCHES
 INSTALL 7 NEW PAD MOUNTED TRANSFORMERS
 INSTALL 2 NEW AIR COOLED CHILLERS & PUMPS
 INSTALL 1 NEW HYBRID FLUID COOLER

DIESEL FUEL QUANTITIES*	
EXISTING FUEL STORAGE	
BULK STORAGE TANK OR GENERATOR	EXISTING QUANTITY (GAL)
FUEL OIL STORAGE TANK NO. 1	25,000
FUEL OIL STORAGE TANK NO. 2	25,000
FUEL OIL STORAGE TANK NO. 3	25,000
FUEL OIL STORAGE TANK NO. 4	25,000
GENERATOR NO. A-1	1,500
GENERATOR NO. A-2	1,500
GENERATOR NO. A-3	1,500
GENERATOR NO. B-1	2,000
GENERATOR NO. B-2	2,000
GENERATOR NO. B-3	2,000
GENERATOR NO. C-1	1,500
GENERATOR NO. C-2	1,500
GENERATOR NO. C-3	1,500
TOTAL EXISTING FUEL STORAGE	115,000
NEW OR MODIFIED FUEL STORAGE	
BULK STORAGE TANK OR GENERATOR	PROPOSED QUANTITY (GAL)
REMOVE GENERATOR NO. A-1	(1,500)
REMOVE GENERATOR NO. A-2	(1,500)
NEW GENERATOR 1-GSS-1	8,400
NEW GENERATOR 2-GSS-1	8,400
NEW GENERATOR 3-GSS-1	8,400
NEW GENERATOR 4-GSS-1	8,400
NEW GENERATOR 5-GSS-1	8,400
NEW GENERATOR 6-GSS-1	8,400
NEW GENERATOR 7-GSS-1	8,400
NEW GENERATOR 8-GSS-1	8,400
NEW GENERATOR 9-GSS-1	8,400
NEW GENERATOR 10-GSS-1	8,400
TOTAL FUEL STORAGE	196,000
TOTAL NET NEW FUEL STORAGE ADDED	81,000

*NOTE: ALL FUEL STORAGE IS IN ABOVE GROUND FUEL STORAGE TANKS.

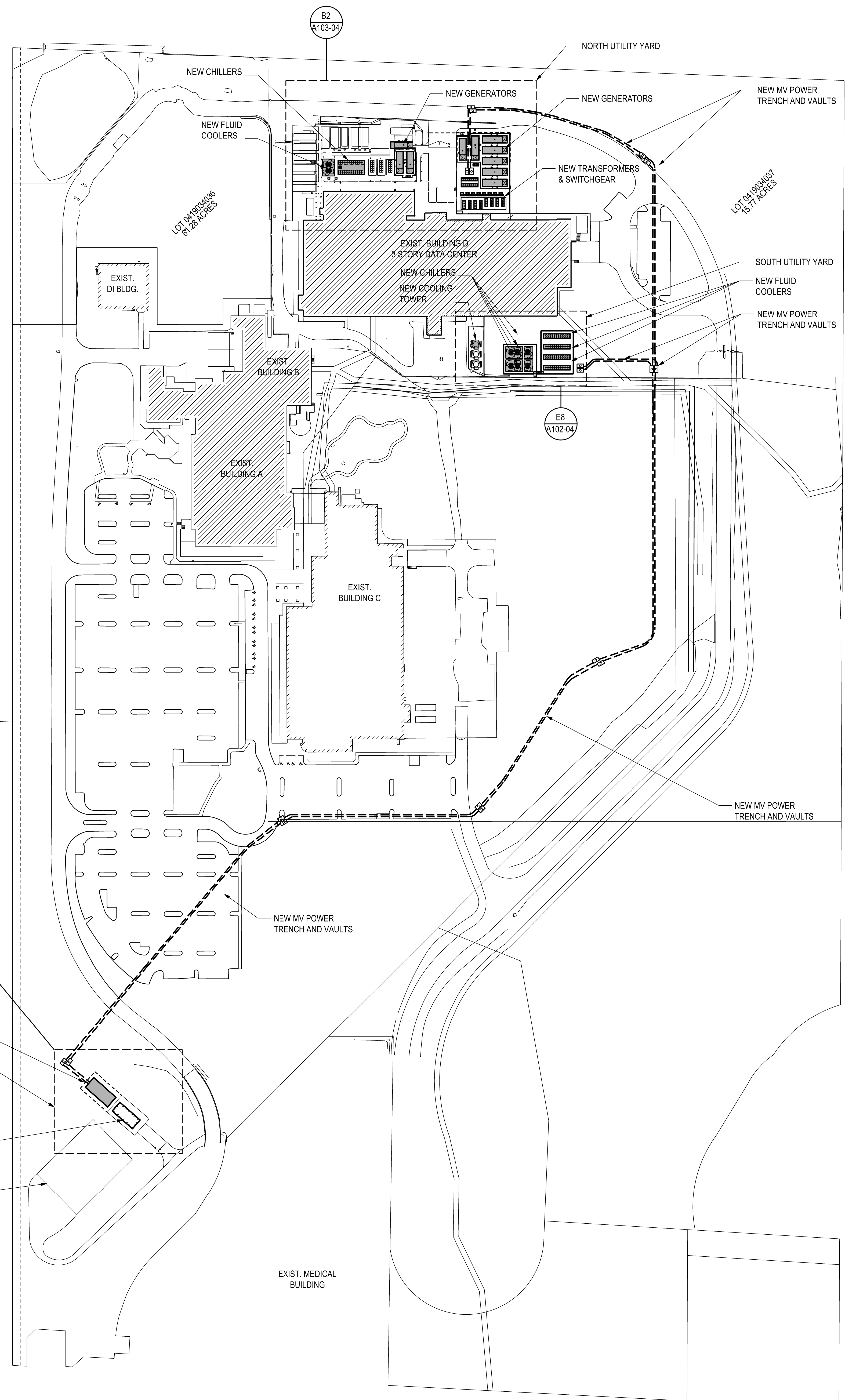

D1
A102-04

NEW SWITCHGEAR BUILDING

SUB-STATION AREA

EXIST. SWITCHGEAR BUILDING

EXIST. PSE SUB-STATION

A6 OVERALL SITE PLAN
 SCALE: 1" = 100'

OWNER:
 BENAROYA CAPITAL, LLC
 Centeris Data Centers
 9675 SE 36th St, Suite 115
 Mercer Island, WA 98040
 +1.253.200.4120

CONSULTANT:

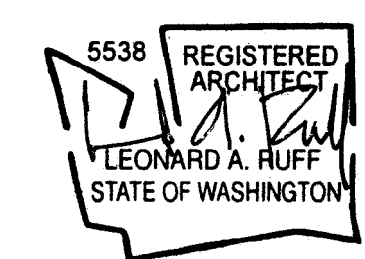

CASCADE MISSION CRITICAL, LLC
 Data Center Consulting and Design
 6210 36th Avenue N.E., Seattle, WA 98115
 P: 206-294-1288 www.cascadecritical.com

CENTERIS VOLTAGE PARK
 1023 39th Avenue South East
 Puyallup, WA 98374-2121
 SITE PLAN & SEPA SUBMITTAL

ISSUED/REVISED DATE
 SEPA SUBMITTAL 2/2/24

SEPA SUBMITTAL
 FEBRUARY 2, 2024
 OVERALL SITE PLAN

A-101-04

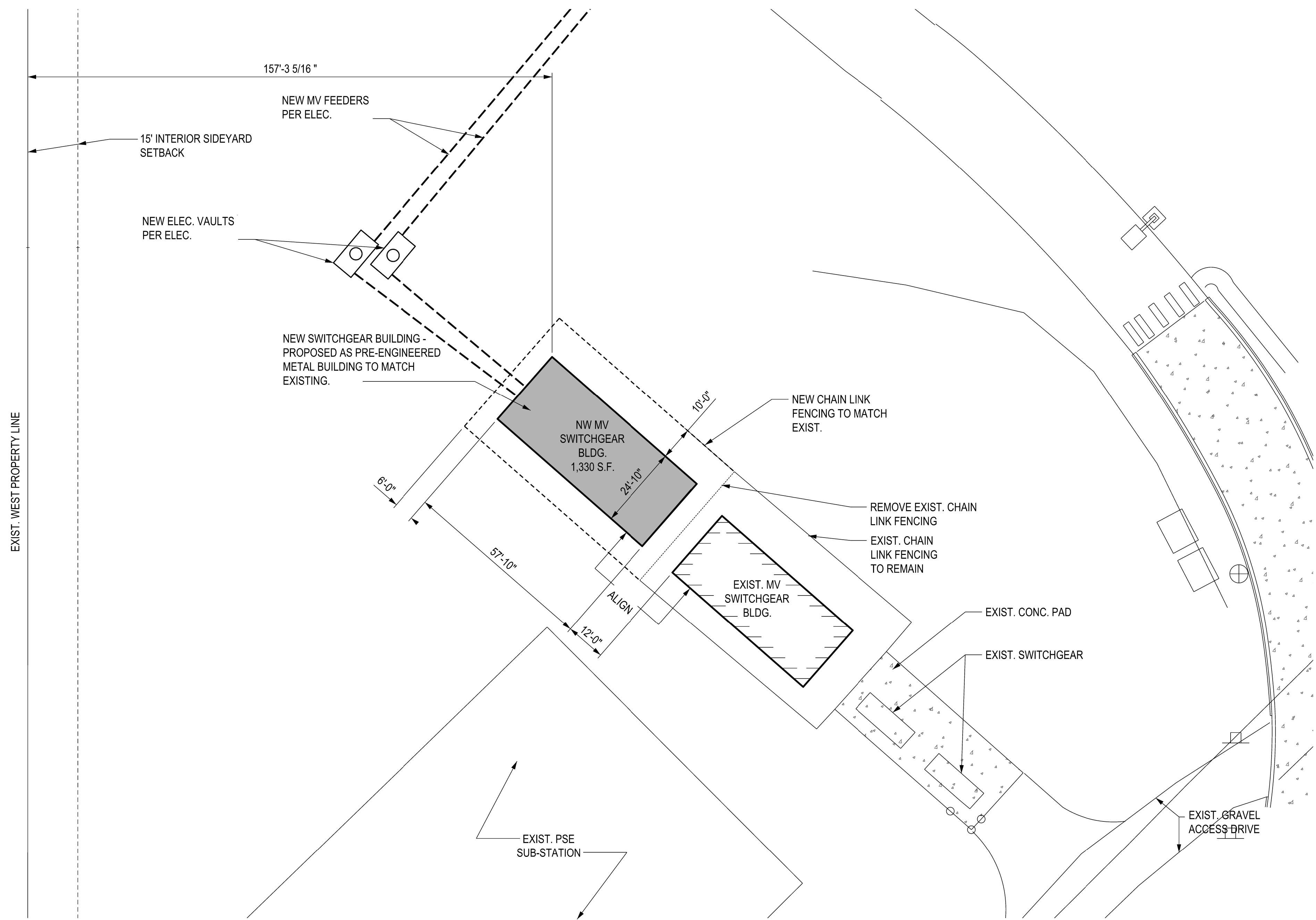

D1 ENLARGED SITE PLAN - MV SWITCHGEAR BUILDING
SCALE: 1" = 20'-0"

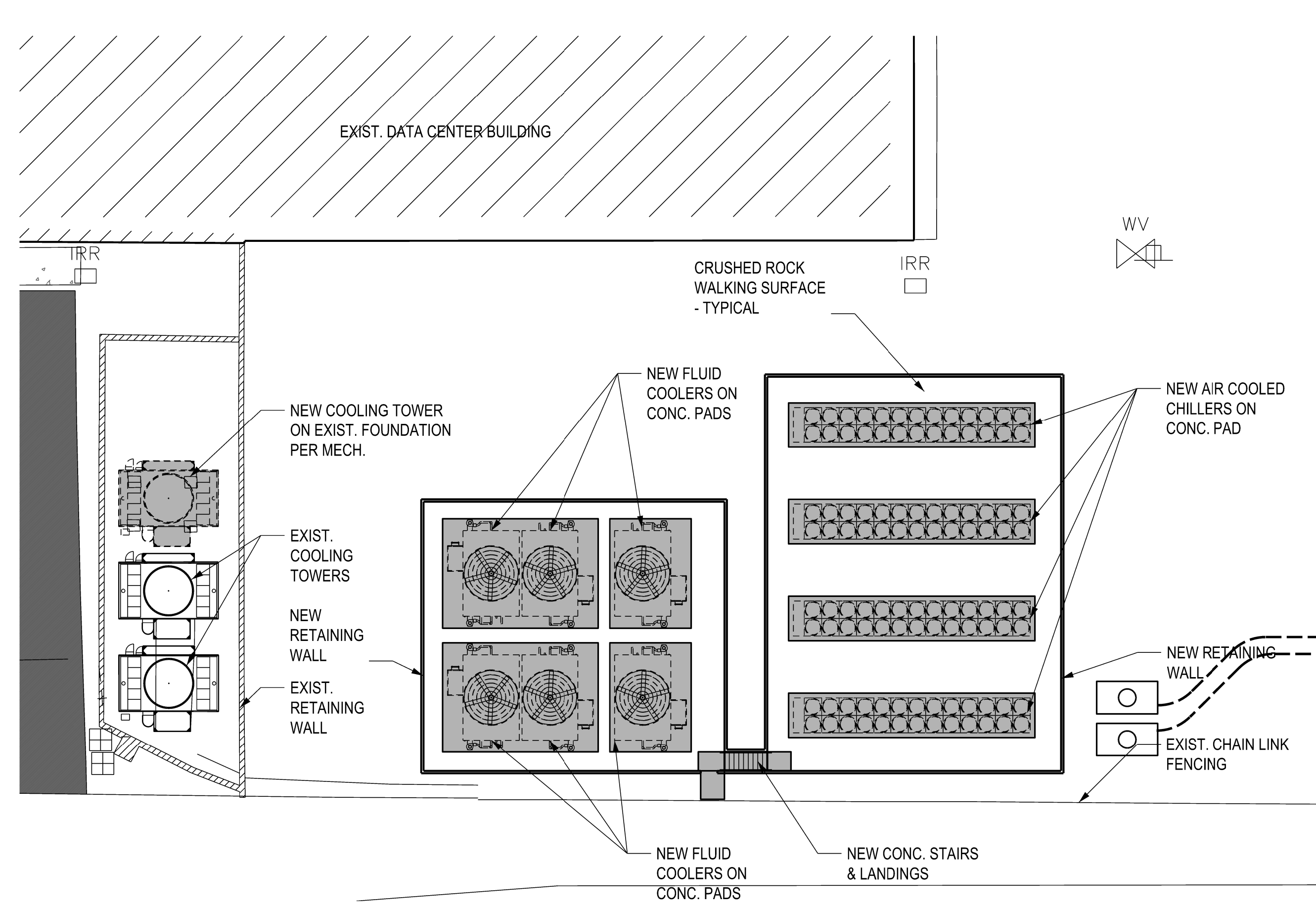

E8 ENLARGED SITE PLAN - SOUTH UTILITY YARD
SCALE: 1" = 20'-0"

OWNER:
BENAROYA CAPITAL, LLC
Centeris Data Centers
9675 SE 36th St, Suite 115
Mercer Island, WA 98040
+1.253.200.4120

CONSULTANT:

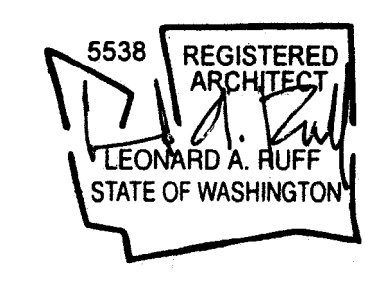

CASCADE MISSION CRITICAL, LLC
Data Center Consulting and Design
6210 36th Avenue N.E. Seattle, WA 98115
P: 206-294-1288 www.cascademissioncritical.com

CENTERIS VOLTAGE PARK
1023 39th Avenue South East
Puyallup, WA 98374-2121
SITE PLAN & SEPA SUBMITTAL

ISSUED/REVISED	DATE
SEPA SUBMITTAL	2/2/24

SEPA SUBMITTAL
FEBRUARY 2, 2024

ENLARGED SITE PLANS
MV SWITCHGEAR BUILDING
SOUTH UTILITY YARD

A-102-04

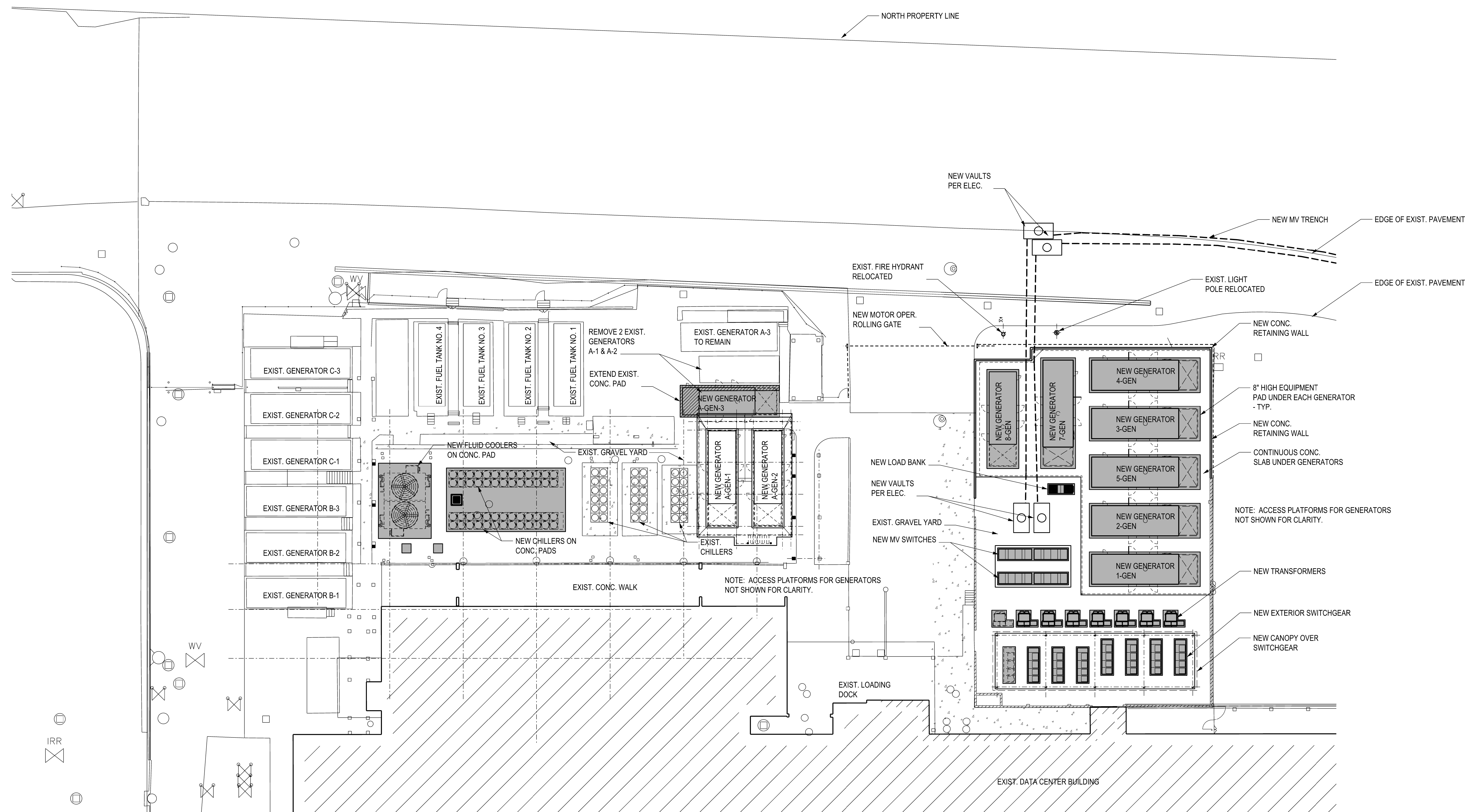



ENLARGED SITE PLAN - NORTH UTILITY YARD
 SCALE: 1" = 20'-0"

OWNER:
 BENAROYA CAPITAL, LLC
 Centeris Data Centers
 9675 SE 36th St, Suite 115
 Mercer Island, WA 98040
 +1.253.200.4120

CONSULTANT:

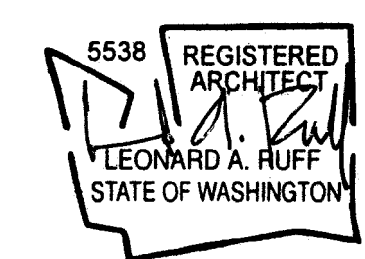

CASCADE MISSION CRITICAL, LLC
 Data Center Consulting and Design
 6210 36th Avenue N.E., Seattle, WA 98115
 P: 206-294-1288 www.cascadecritical.com

CENTERIS VOLTAGE PARK
 1023 39th Avenue South East
 Puyallup, WA 98374-2121
SITE PLAN & SEPA SUBMITTAL

ISSUED/REVISED	DATE
SEPA SUBMITTAL	2/2/24

SEPA SUBMITTAL
 FEBRUARY 2, 2024
 ENLARGED SITE PLAN
 NORTH UTILITY YARD

A-103-04