

PROJECT:
FREEMAN ROAD LOGISTICS BUILDING A

LOCATION:
 FREEMAN ROAD
 PUYALLUP, WA

CLIENT:
 VECTOR DEVELOPMENT CO.
 11335 NE 122ND WAY,
 SUITE 105
 KIRKLAND, WA 98034

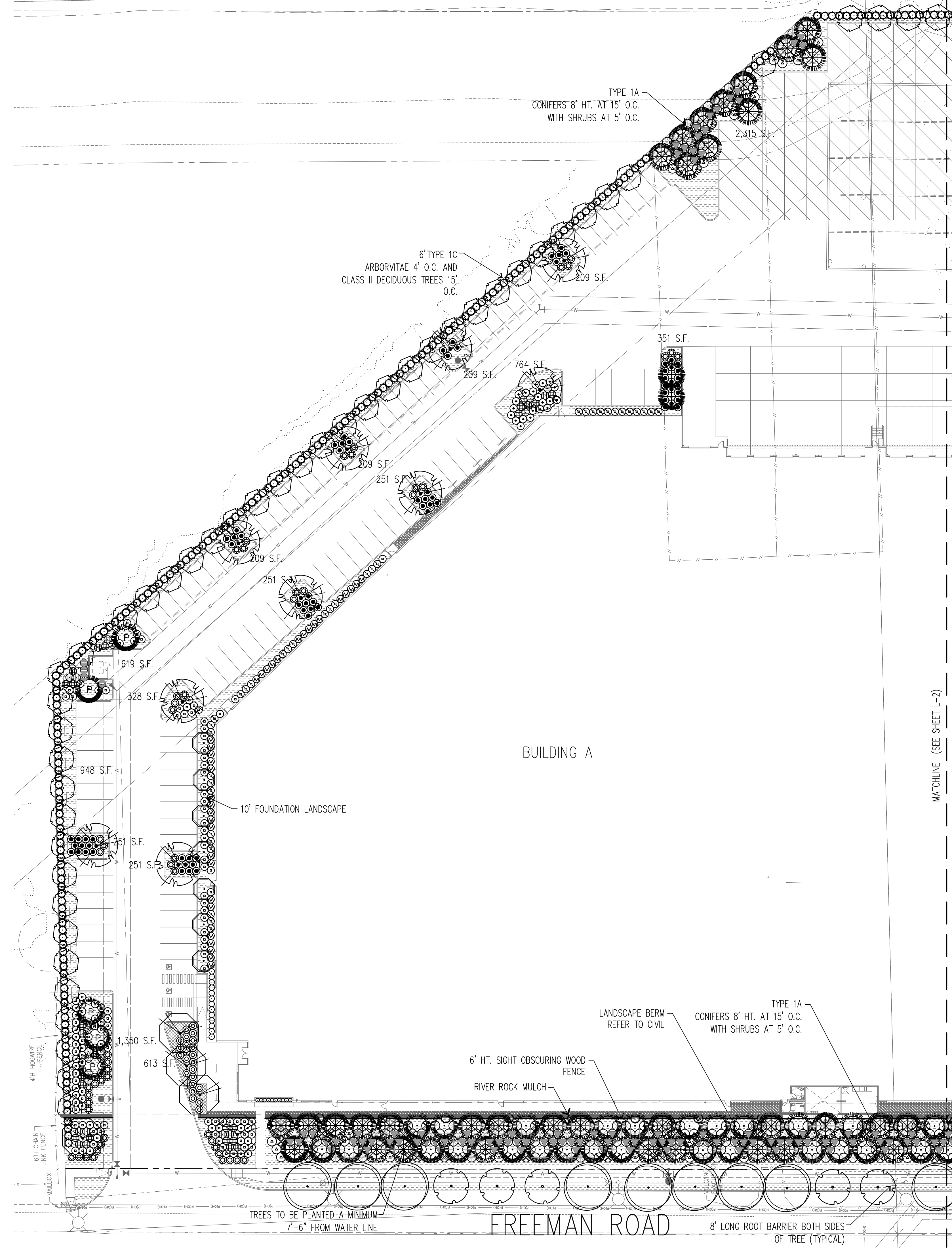

PLANT LEGEND

SYMBOL	COMMON NAME
STREET TREES (CLASS III-IV)	
	STREET KEEPER HONEYLOCUST
	GREEN PILLAR PIN OAK
	BOULEVARD LINDEN
	MUSAHSINO COLUMNAR ZELCOVA
MED / LARGE DECIDUOUS TREES (CLASS III-IV)	
	EMERALD QUEEN MAPLE
	SYCAMORE MAPLE
	GREENSPIRE LINDEN
COLUMNAR DECIDUOUS TREES (CLASS II)	
	SERVICEBERRY
	HORNBEAM
	PURPLE DAWYCK BEECH
EVERGREEN TREES (CLASS III-IV)	
	WEeping ALASKA CEDAR
	SERBIAN SPRUCE
	AUSTRIAN PINE
	DOUGLAS FIR
	EXCELSA WESTERN RED CEDAR
EVERGREEN HEDGE	
	SCHIPKA LAUREL
	HICKS YEW
	ARBORVITAE
EVERGREEN SHRUBS	
	STRAWBERRY TREE
	JAPANESE AUCUBA
	ENGLISH BOXWOOD
	WHITE ROCKROSE
	RED TIPS HONEYSUCKLE
	OREGON GRAPE
	PACIFIC WAX MYRTLE
	HEAVENLY BAMBOO
	VARIEGATED OSMANTHUS
	OTTO LUYKEN LAUREL
	PORTUGAL LAUREL
	SPREADING YEW
	DAVID'S VIBURNUM
	SPRING BOUQUET
DECIDUOUS SHRUBS	
	JAPANESE BARBERRY
	REDTWIG DOGWOOD
	WINGED EUONYMUS
	NINEBARK
	SHRUBBY CINQUEFOIL
	SPIREA
	SNOWBERRY
GROUNDCOVER	
	KINKINKINICK
	DWARF REDTWIG DOGWOOD
	BIGROOT CRANESBILL
EROSION CONTROL HYDROSEED	

NOTE:
 REFER TO SHEET L-3 FOR FULL PLANT SCHEDULE WITH SIZES.

LANDSCAPE LEGEND

	6' HIGH SIGHT OBSCURING WOOD FENCE
	ROOT BARRIER DEEPROOT UB-24 (MIN. 8' LENGTH)
	RIVER ROCK 6-12" DIA. MIN. 6" DEEP

LANDSCAPE PLAN

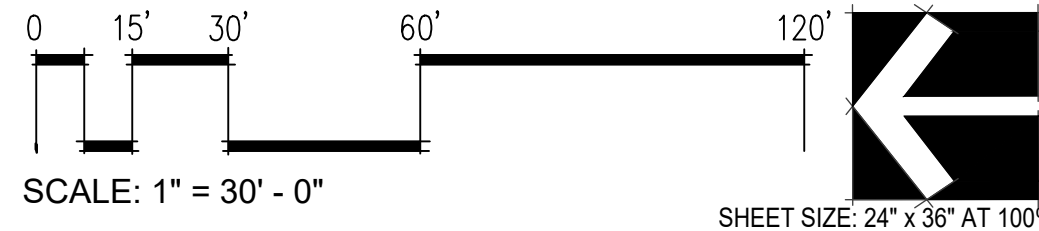

NO.	DATE	REVISION
11	23.2020	SEPA
19	12.2022	SEPA RESUBMITTAL
11	13.2023	SEPA RESUBMITTAL
01	31.2024	BUILDING PERMIT
06	17.2024	SEPA RESUBMITTAL

DESIGNED CB
 DRAWN CB
 CHECKED CB

PROFESSIONAL SEAL

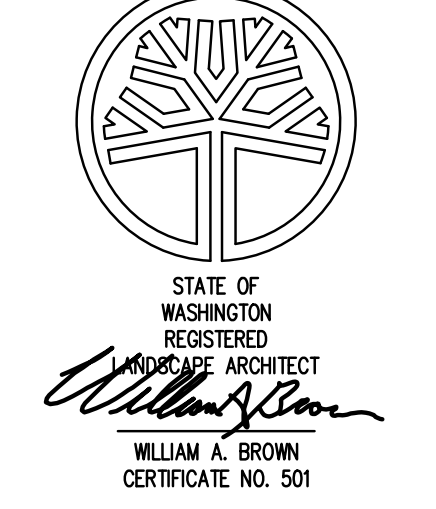

DATE 07.26.2021
 PROJECT NO. 202116

LANDSCAPE PLAN

SHEET NUMBER
L-1

PROJECT:
FREEMAN ROAD LOGISTICS BUILDING A

LOCATION:
 FREEMAN ROAD
 PUYALLUP, WA

CLIENT:
 VECTOR DEVELOPMENT CO.
 11335 NE 122ND WAY,
 SUITE 105
 KIRKLAND, WA 98034

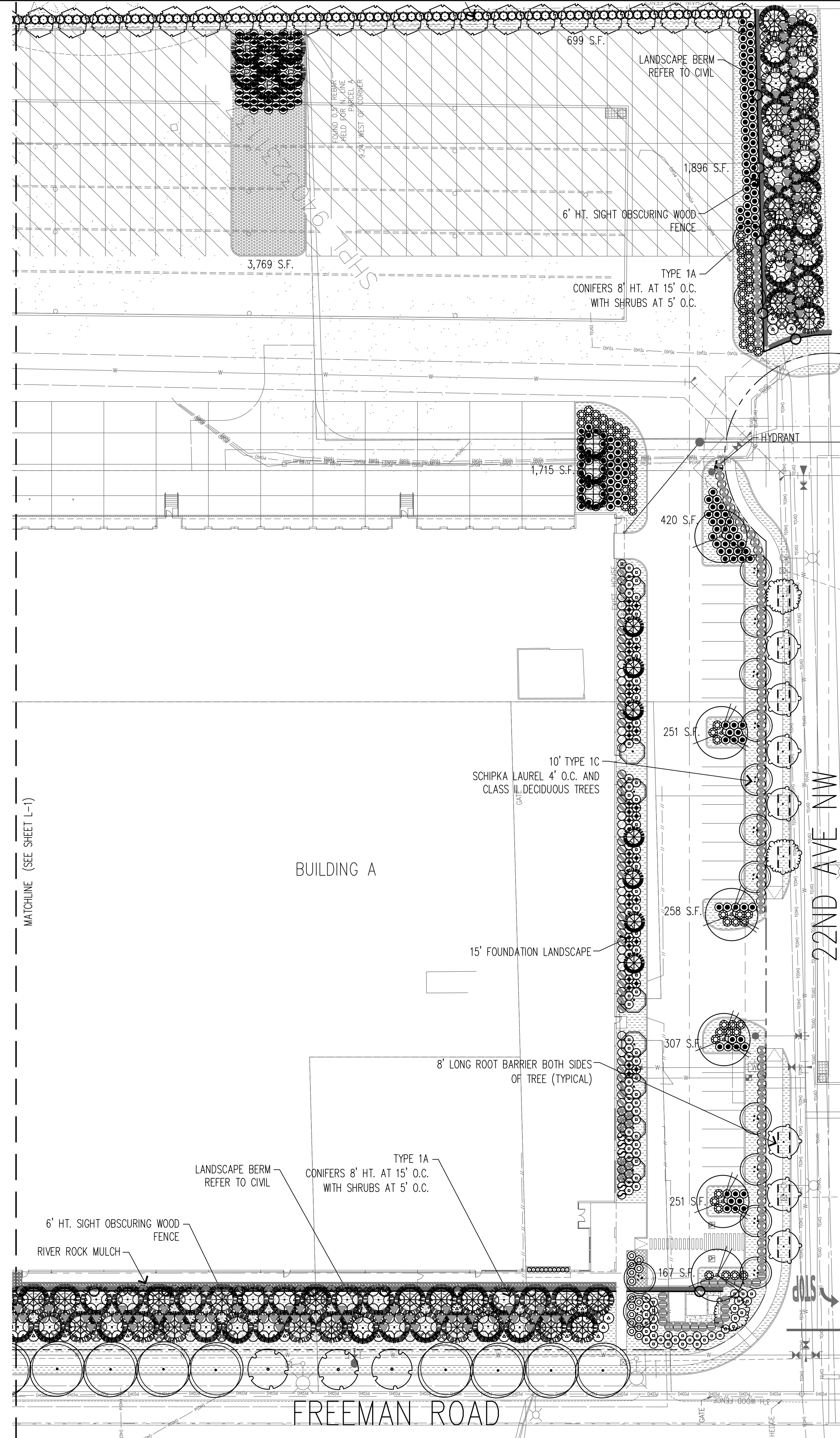

PLANT LEGEND

SYMBOL	COMMON NAME
	STREET TREES (CLASS III-IV) STREET KEEPER HONEYLOCUST GREEN PILLAR PIN OAK BOULEVARD LINDEN MUSASHINO COLUMNAR ZELOOVA
	MED / LARGE DECIDUOUS TREES (CLASS III-IV) EMERALD QUEEN MAPLE SYCAMORE MAPLE GREENSPIRE LINDEN
	COLUMNAR DECIDUOUS TREES (CLASS II) SERVICEBERRY HORNBEAM PURPLE DAWYCK BEECH
	EVERGREEN TREES (CLASS III-IV) WEEPING ALASKA CEDAR SERBIAN SPRUCE AUSTRIAN PINE DOUGLAS FIR EXCELSA WESTERN RED CEDAR
	EVERGREEN HEDGE SCHIPKA LAUREL HICKS YEW ARBORVITAE
	EVERGREEN SHRUBS STRAWBERRY TREE JAPANESE AUCUBA ENGLISH BOXWOOD WHITE ROCKROSE RED TIPS HONEYSUCKLE OREGON GRAPE PACIFIC WAX MYRTLE HEAVENLY BAMBOO VARIEGATED OSMANTHUS OTTO LUYKEN LAUREL PORTUGAL LAUREL SPREADING YEW DAVID'S VIBURNUM SPRING BOUQUET
	DECIDUOUS SHRUBS JAPANESE BARBERRY REDTWIG DOGWOOD WINGED EUONYMUS NINEBARK SHRUBBY CINQUEFOIL SPIREA SNOWBERRY
	GROUNDCOVER KINNIKINICK DWARF REDTWIG DOGWOOD BIGROOT CRANESBILL
	EROSION CONTROL HYDROSEED

NOTE:
 REFER TO SHEET L-3 FOR FULL PLANT SCHEDULE
 WITH SIZES.

LANDSCAPE LEGEND

NO.	DATE	REVISION
11.23.2020	SEPA	
19.12.2022	SEPA RESUBMITTAL	
11.13.2023	SEPA RESUBMITTAL	
01.31.2024	BUILDING PERMIT	
06.17.2024	SEPA RESUBMITTAL	

DESIGNED CB
 DRAWN CB
 CHECKED CB

PROFESSIONAL SEAL

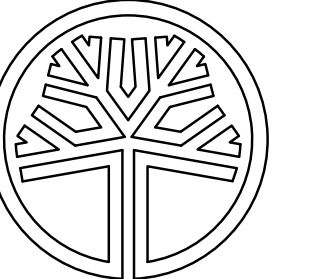

STATE OF WASHINGTON
 REGISTERED PROFESSIONAL ARCHITECT
 WILLIAM A. BROWN
 CERTIFICATE NO. 501

DATE: 07.26.2021

PROJECT NO: 202116

TITLE

LANDSCAPE PLAN

SHEET NUMBER
L-2

LANDSCAPE PLAN

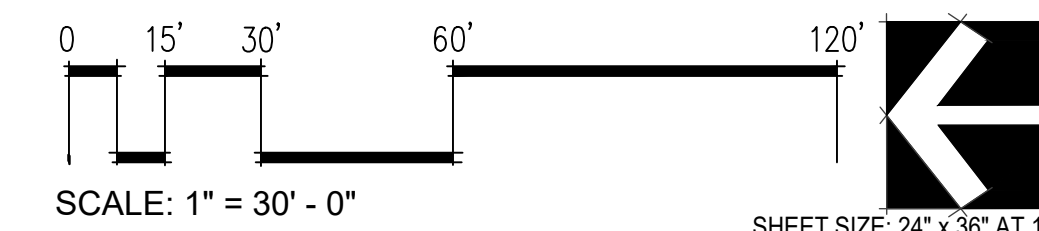

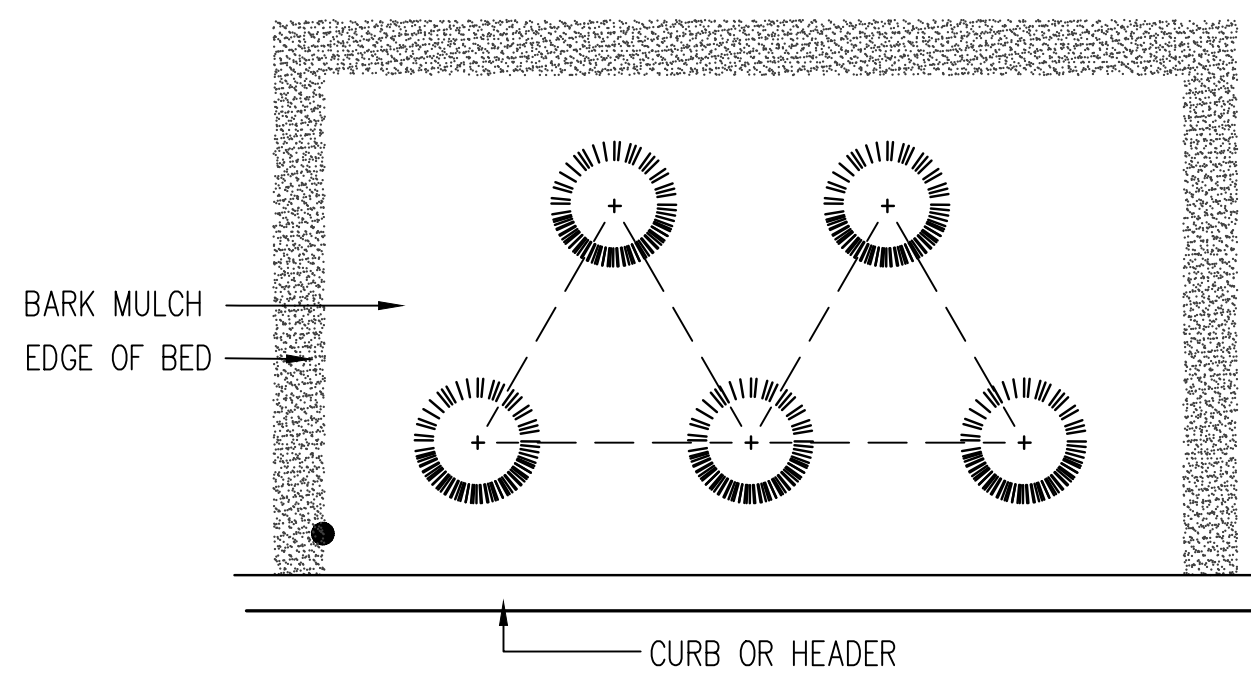

NOTE: SPACING TO BE TRIANG. PER DISTANCE SHOWN ON PLANT SCHEDULE

1 GROUND COVER SPACING
 NTS

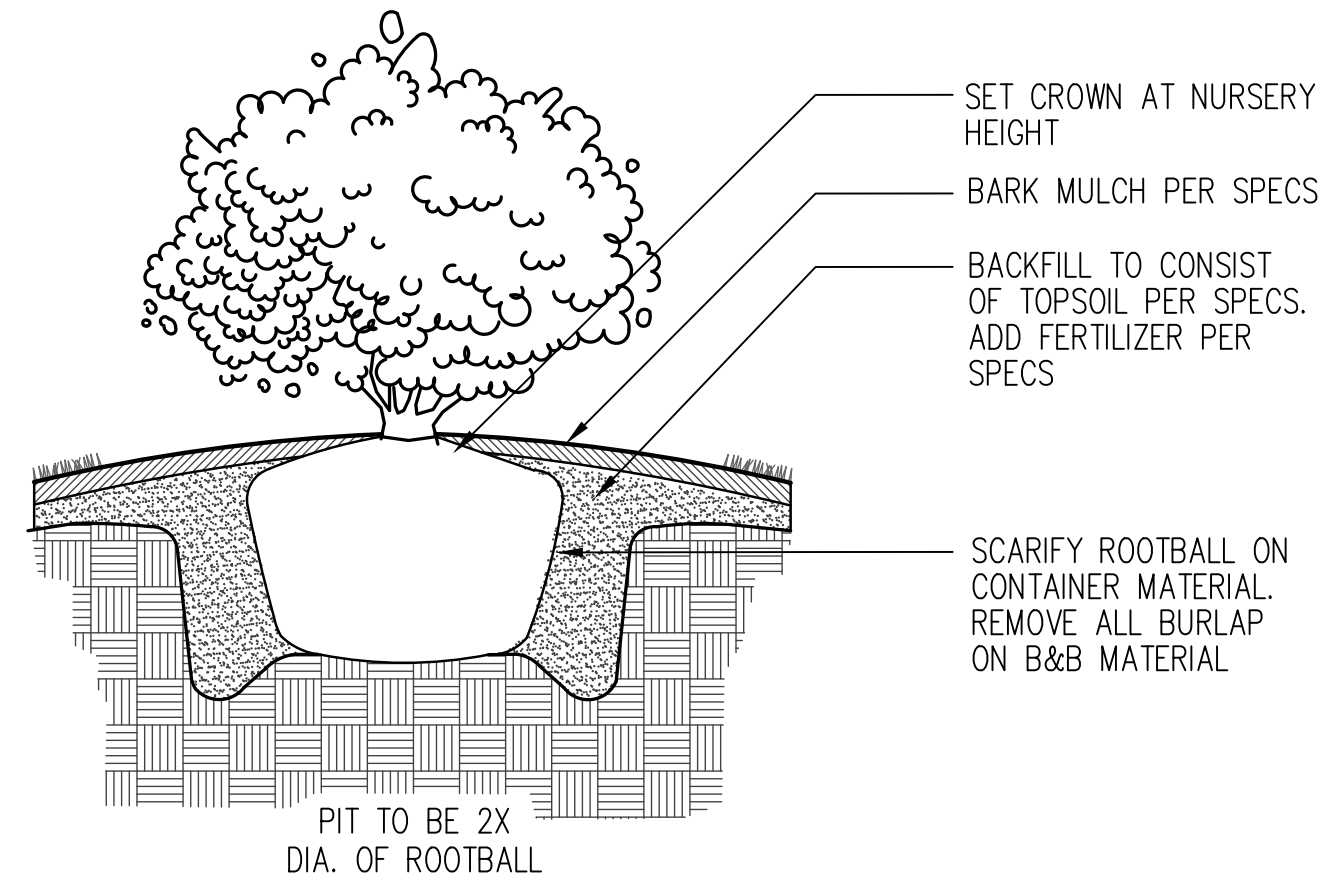

2 SHRUB PLANTING
 NTS

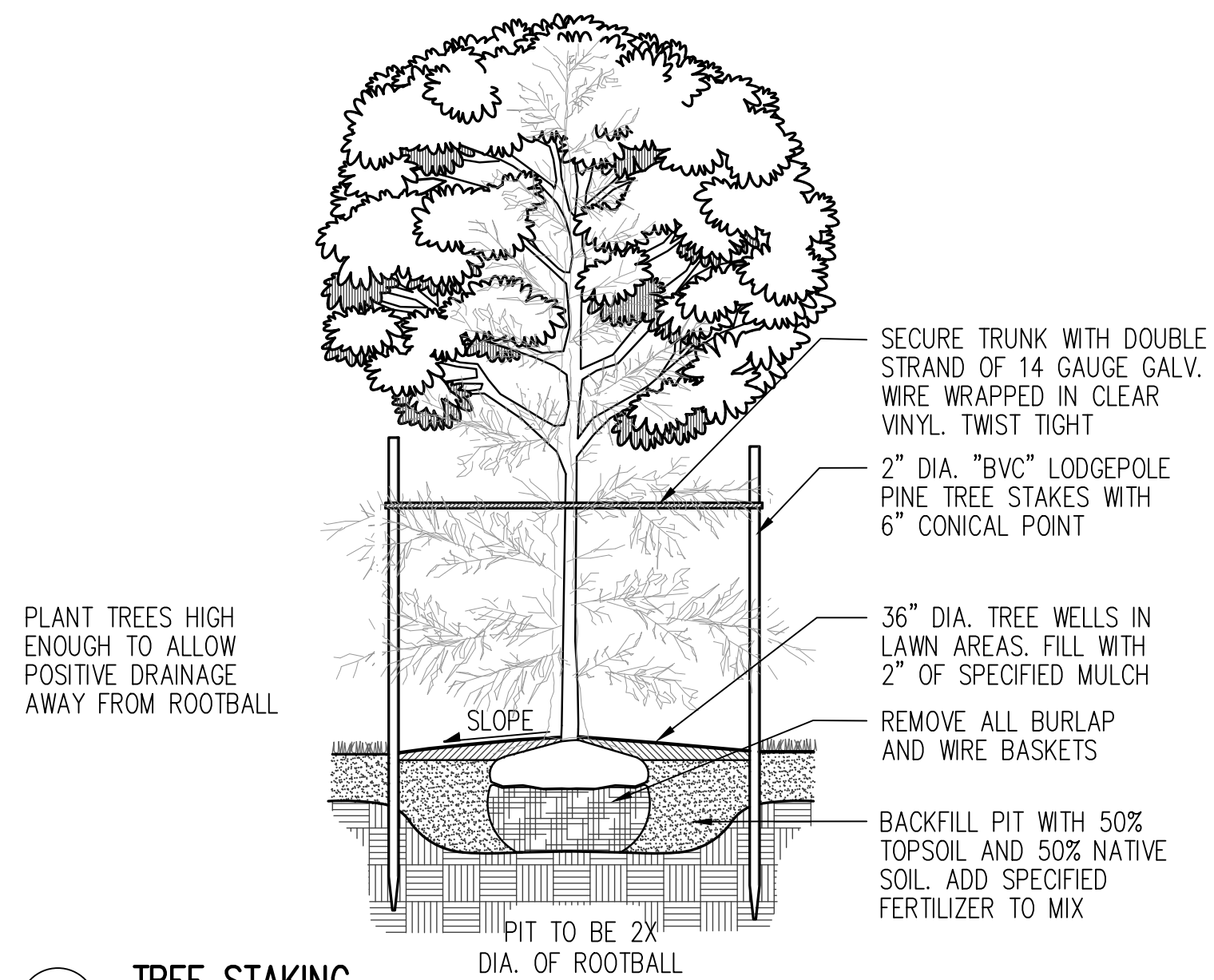

3 TREE STAKING
 NTS

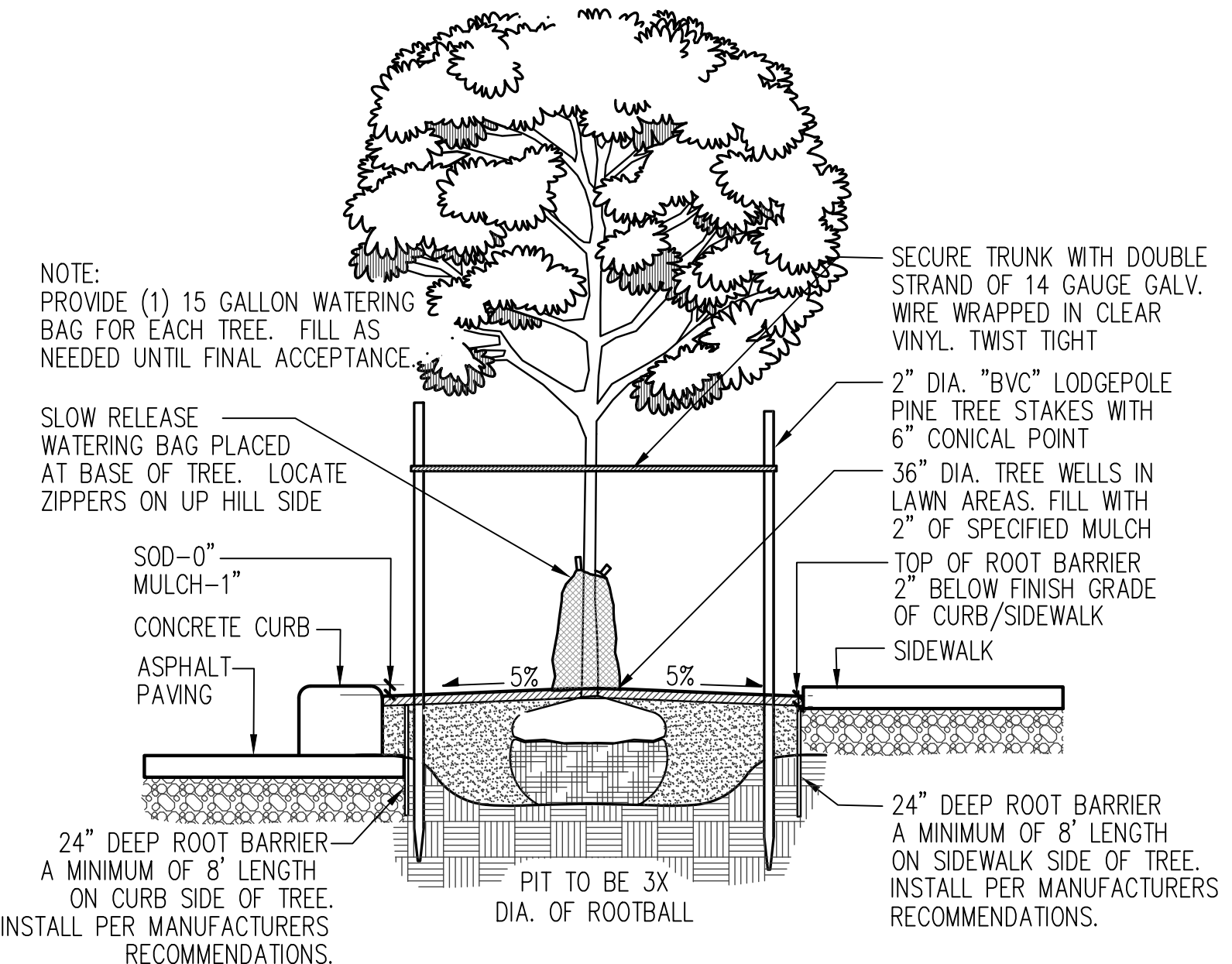

4 STREET TREES PLANTING
 NTS

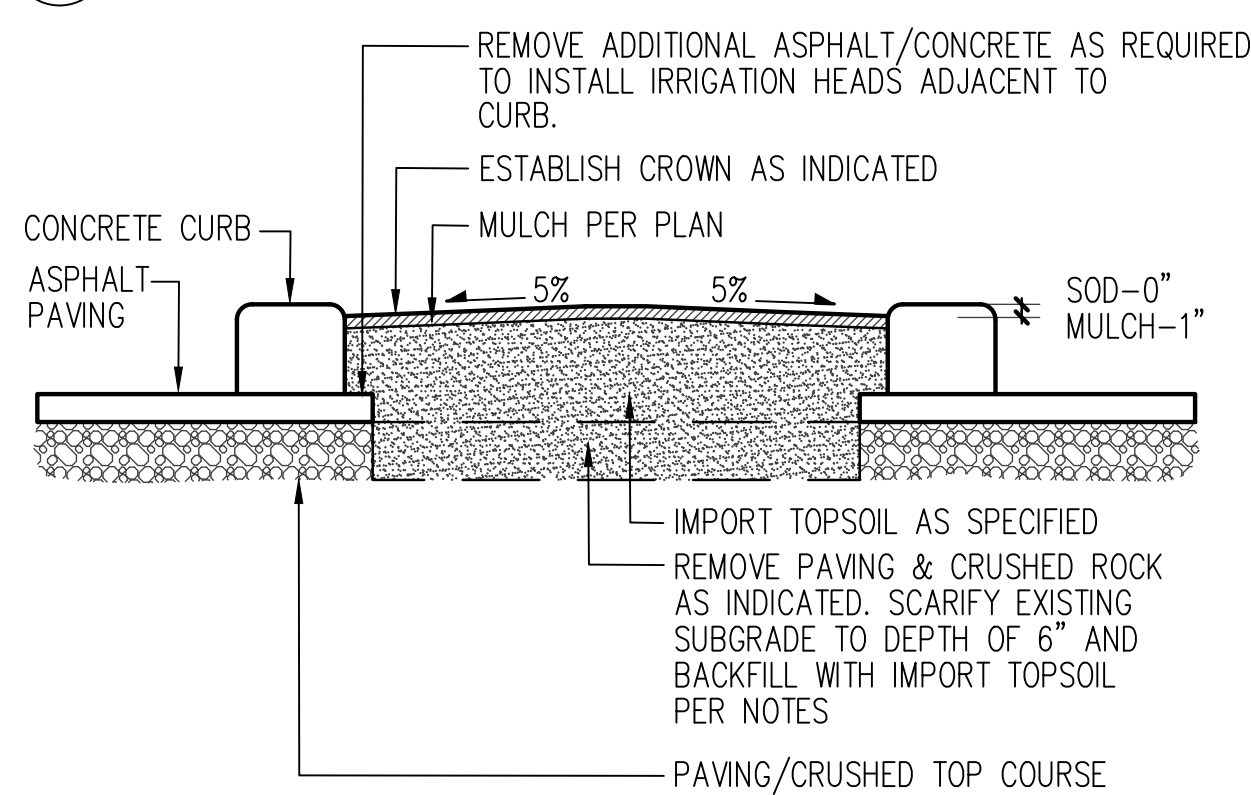

5 LANDSCAPE ISLAND
 NTS

PLANT SCHEDULE

SYMBOL	BOTANICAL NAME / COMMON NAME	QTY	SIZE	REMARKS
STREET TREES (CLASS III-IV)				
	GLEDDISIA TRIACANTHOS 'DRAVES' / STREET KEEPER HONEYLOCUST	TBD	MIN. 1" CAL.	B & B
	QUERCUS PALUSTRIS 'GREEN PILLAR' / GREEN PILLAR PIN OAK	TBD	MIN. 1" CAL.	B & B
	TILIA AMERICANA 'BOULEVARD' / BOULEVARD LINDEN	TBD	MIN. 1" CAL.	B & B
	ZELCOVA SERRATA 'MUSASHINO' / MUSASHINO COLUMNAR ZELCOVA	TBD	MIN. 1" CAL.	B & B
MEDIUM DECIDUOUS TREES (CLASS III-IV)				
	ACER PLATANOIDES 'EMERALD QUEEN' / EMERALD QUEEN MAPLE	6	MIN. 1-1/2" CAL.	B & B
	ACER PSEUDOPLATANUS / SYCAMORE MAPLE	10	MIN. 1-1/2" CAL.	B & B
	TILIA CORDATA 'GREENSPIRE' / GREENSPIRE LINDEN	4	MIN. 1-1/2" CAL.	B & B
COLUMNAR DECIDUOUS TREES (CLASS II)				
	AMELANCHIER X G. 'AUTUMN BRILLIANCE' / SERVICEBERRY	25	MIN. 1-1/2" CAL.	B & B
	CARPINUS BETULUS 'FRANS FONTAINE' / HORNBEAM	65	MIN. 1-1/2" CAL.	B & B
	FAGUS SYLVATICA 'DAWYCK' / DAWYCK BEECH	15	MIN. 1-1/2" CAL.	B & B
EVERGREEN TREES (CLASS II-IV)				
	CHAMAECYPARIS NOOTKATENSIS 'PENDULA' / ALASKA CEDAR	7	MIN. 5' HT.	B & B
	PICEA OMORIKA / SERBIAN SPRUCE	5	MIN. 5' HT.	B & B
	PINUS NIGRA / AUSTRIAN PINE	11	MIN. 5' HT.	B & B
	PSEUDOTSUGA MENZIESII / DOUGLAS FIR	57	MIN. 8' HT.	B & B
	THUJA PLICATA 'EXCELSA' / EXCELSA WESTERN RED CEDAR	58	MIN. 8' HT.	B & B
EVERGREEN HEDGE				
	PRUNUS L. 'SCHIPKAENSIS' / SCHIPKA LAUREL	88	MIN. 48" HT.	B & B
	TAXUS MEDIA X 'HICKSII' / HICKS YEW	19	MIN. 48" HT.	B & B
	THUJA OCCIDENTALIS 'FASTIGIATA' / ARBORVITAE	264	MIN. 48" HT.	B & B

PLANT SCHEDULE

SYMBOL	BOTANICAL NAME / COMMON NAME	QTY	SIZE	REMARKS
EVERGREEN SHRUBS				
	ARBUTUS UNEDO 'COMPACTA' / STRAWBERRY TREE	36	5 GAL.	
	AUCUBA JAPONICA 'ROZANNIE' / JAPANESE AUCUBA	34	5 GAL.	
	BUXUS S. 'GRAHAM BLANDY' / ENGLISH BOXWOOD	20	5 GAL.	
	CISTUS X HYBRIDUS / WHITE ROCKROSE	10	5 GAL.	
	LONIERCA N. 'RED TIPS' / RED TIPS HONEYSUCKLE	78	5 GAL.	
	MAHONIA AQUIFOLIUM 'COMPACTA' / OREGON GRAPE	188	5 GAL.	
	MYRICA CALIFORNICA / PACIFIC WAX MYRTLE	207	5 GAL.	
	NANDINA D. 'SIENNA SUNRISE' / HEAVENLY BAMBOO	15	5 GAL.	
	OSMANTHUS H. 'GOSHIKI' / VARIEGATED OSMANTHUS	6	5 GAL.	
	PRUNUS L. 'OTTO LUYKEN' / OTTO LUYKEN LAUREL	45	5 GAL.	
	PRUNUS LUSITANICA / PORTUGAL LAUREL	32	5 GAL.	
	TAXUS X MEDIA 'DENSIFORMIS' / SPREADING YEW	224	5 GAL.	
	VIBURNUM DAVIDII / DAVID'S VIBURNUM	188	5 GAL.	
	VIBURNUM T. 'SPRING BOUQUET' / SPRING BOUQUET	21	5 GAL.	
DECIDUOUS SHRUBS				
	BERBERIS T. ATROPURPUREA 'PYGMY RUBY' / JAPANESE BARBERRY	12	5 GAL.	
	CORNUS SERICEA 'BAILEY' / REDTWIG DOGWOOD	323	5 GAL.	
	EUONYMUS ALATUS 'COMPACTUS' / WINGED EUONYMUS	29	5 GAL.	
	PHYSOCARPUS O. 'SUMMER WINE' / NINEBARK	36	5 GAL.	
	POTENTILLA 'GOLDFINGER' / SHRUBBY CINQUEFOIL	118	5 GAL.	
	SPIRAEA X BUMALDA 'ANTHONY WATERER' / SPIREA	5	5 GAL.	
	SYMPHORICARPOS ALBUS / SNOWBERRY	157	5 GAL.	
GROUND COVER				
	ARCHTOSTAPHYLOS UVA-URSI / KINKINNICK	TBD	1 GAL.	36" O.C.
	CORNUS SERICA 'KELSYI' / DWARF REDTWIG DOGWOOD	TBD	1 GAL.	24" O.C.
	GERANIUM MACRORRHIZUM / BIGROOT CRANESBILL	TBD	1 GAL.	24" O.C.
EROSION CONTROL SEED MIX:				
	45% FESTUCA ARUNDINACEA VAR. / DWARF TALL FESCUE			HYDROSEED SEED-80 LBS / ACRE
	30% LOLIUM PERENNE VAR. BARCLAY / DWARF PERENNIAL RYE (BARCLAY)			MULCH-1,500 LBS / ACRE
	20% FESTUCA RUBRA / RED FESCUE			
	5% AGROSTIS TENUIS 'HIGHLAND STRAIN' / COLONIAL BENTGRASS			

LANDSCAPE NOTES

- ALL NEW PLANTING BEDS TO RECEIVE A MINIMUM 18" OF TOPSOIL. INSTALLED IN THREE LIFTS OF 6" DEPTH, WITH THE FIRST LIFT ROTOTILLED INTO THE SUBGRADE TO A MINIMUM DEPTH OF 8". TOPSOIL TO CONSIST OF 40% BY VOLUME NATIVE LOAM SOIL, 40% BY VOLUME SAND, AND 20% BY VOLUME COMPOST. TOPSOIL TO BE UNIFORMLY AMENDED FOR FERTILITY AND PH AS RECOMMENDED BY A CURRENT SOILS TEST PROVIDED BY A APPROVED SOIL TEST LABORATORY FOR NEW LANDSCAPE PLANTING.
- ALL NEW PLANTER BEDS TO HAVE MEDIUM/FINE (3" MINUS) BARK MULCH INSTALLED TO A MINIMUM DEPTH OF 2". MAINTAIN A 6" MULCH FREE RING AROUND TRUNKS OF ALL TREES AND SHRUBS.
- GROUND COVER TO EXTEND UNDER ALL DECIDUOUS TREE CANOPIES AT THE SPECIFIED SPACING TO PROVIDE COMPLETE COVERAGE IN ALL PLANTING BEDS SHOWN TO RECEIVE GROUND COVER. GROUND COVER BENEATH EVERGREEN TREES TO MAINTAIN A 3' CLEARANCE FROM BASE OF TREE.
- TREES TO MAINTAIN A MINIMUM 5' CLEARANCE FROM FIRE HYDRANTS, 7.5' FROM WATER AND SEWER LINES, 7.5' FROM DRIVEWAYS AND BUILDINGS (TYPE I AND TYPE II), 10' FROM UTILITY POLES AND SIGNS, 30' FROM INTERSECTIONS (FACE OF CURB) AND STREET SIGNS (LEADING SIDE). SHRUBS TO MAINTAIN A MINIMUM 3' CLEARANCE FIRE HYDRANTS, BACKFLOW DEVICES, AND METERS.
- ALL PLANT MATERIAL HAS BEEN SELECTED TO BE DROUGHT TOLERANT. SUBSTITUTIONS IF REQUIRED TO ALSO BE DROUGHT TOLERANT, BE OF THE SAME GENERAL CHARACTER OF PLANT SUBSTITUTED, AND TO BE APPROVED BY LANDSCAPE ARCHITECT.
- ALL NEW PLANTING TO BE FERTILIZED WITH STARTER FERTILIZER 2-4-2, OR APPROVED EQUAL, APPLIED AT MANUFACTURERS RECOMMENDED RATE. TREES AND SHRUBS TO BE FERTILIZED WITH AGSAFE 20-10-5, 21 GRAM PLANT TABS, APPLIED AT MANUFACTURERS RECOMMENDED RATE.
- LANDSCAPE DRAWINGS ARE BASED ON THE SITE PLANS PREPARED BY SYNTHESIS ARCHITECTS PLLC. IMMEDIATELY NOTIFY LANDSCAPE ARCHITECT OF ANY FIELD CHANGES TO THE SITE PLAN THAT MAY REQUIRE ADJUSTMENT OF DESIGN.
- REFER TO CIVIL ENGINEERING DRAWINGS FOR GRADING AND DRAINAGE INFORMATION. IMMEDIATELY NOTIFY LANDSCAPE ARCHITECT ON ANY ADVERSE DRAINAGE CONDITIONS WHICH MAY AFFECT HEALTH OF PLANT MATERIAL.
- ALL TREES IN PLANTER STRIPS AND TREES WITHIN 4' OF SIDEWALK TO HAVE ROOT BARRIER INSTALLED MEETING CITY OF PUYALLUP STANDARDS. 24" DEEP PANELS A MINIMUM 8' LENGTH CENTERED ON TREE ON SIDEWALK SIDE OF TREE.
- WARRANTY ALL PLANTING FOR 1 YEAR FROM FINAL ACCEPTANCE. REPLACE PLANTING THAT HAS DIED OR DYING.
- ALL NEW LANDSCAPE TO BE IRRIGATED WITH A HIGH EFFICIENCY IRRIGATION SYSTEM. EROSION CONTROL HYDROSEED TO HAVE TEMPORARY ABOVE GRADE IRRIGATION. TREES AND SHRUBS WITHIN EROSION CONTROL AREAS TO HAVE DRIP POINT SOURCE EMITTERS. IRRIGATION TO BE PROVIDED WITH A ET ADJUSTED IRRIGATION CONTROLLER WITH A ON SITE ET SENSOR.
- NO IRRIGATION TO BE INSTALLED WITHIN R.O.W. OR FUTURE R.O.W. PROVIDE (1) SLOW RELEASE 15 GALLON WATERING BAG FOR EACH TREE IN R.O.W. FILL EACH WATERING BAG WITH WATER 1-2 TIMES A WEEK OR AS NEEDED UNTIL FINAL ACCEPTANCE.

LANDSCAPE LEGEND

- ROOT BARRIER
- NDS EP-2450, 24" DEEP ROOT BARRIER

NO.	DATE	REVISION
11.23.2020	SEPA	
19.12.2022	SEPA RESUBMITTAL	
11.13.2023	SEPA RESUBMITTAL	
01.31.2024	BUILDING PERMIT	
06.17.2024	SEPA RESUBMITTAL	

DESIGNED CB
 DRAWN CB
 CHECKED CB

PROFESSIONAL SEAL

 WILLIAM A. BROWN
 CERTIFICATE NO. 501

DATE 07.26.2021
 PROJECT NO. 202116

LANDSCAPE DETAILS

PROJECT:
**FREEMAN ROAD
 LOGISTICS
 BUILDING A**

LOCATION:
 FREEMAN ROAD
 PUYALLUP, WA

CLIENT:
 VECTOR
 DEVELOPMENT CO.
 11335 NE 122ND WAY,
 SUITE 105
 KIRKLAND, WA 98034

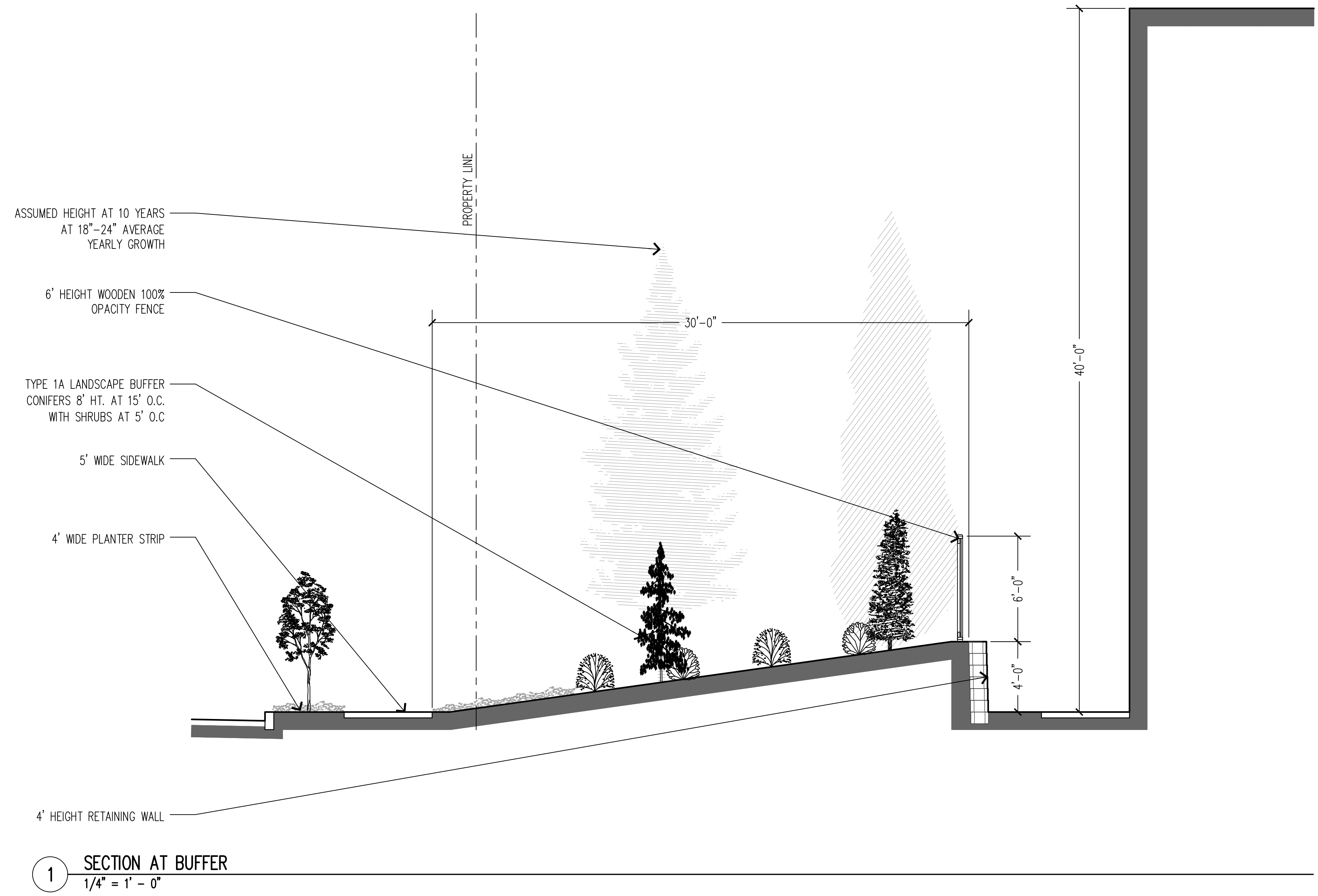

NO.	DATE	REVISION
	11.23.2020	SEPA
	19.12.2022	SEPA RESUBMITTAL
	11.13.2023	SEPA RESUBMITTAL
	01.31.2024	BUILDING PERMIT
	06.17.2024	SEPA RESUBMITTAL

DESIGNED CB
 DRAWN CB
 CHECKED CB

PROFESSIONAL SEAL

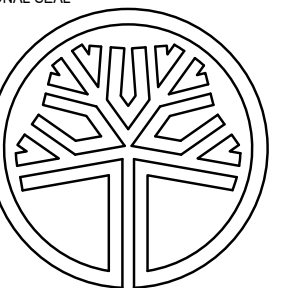

STATE OF
 WASHINGTON
 REGISTERED
 PROFESSIONAL ARCHITECT
William A. Brown
 WILLIAM A. BROWN
 CERTIFICATE NO. 501

DATE 07.26.2021

PROJECT NO. 202116

TITLE

**LANDSCAPE
 BUFFER
 SECTION**

SHEET NUMBER

L-4