

Bell Property

Section 15, Township 20 N, Range 4 E, Willamette Meridian, Pierce County, Washington

Parking Floor Dimensions

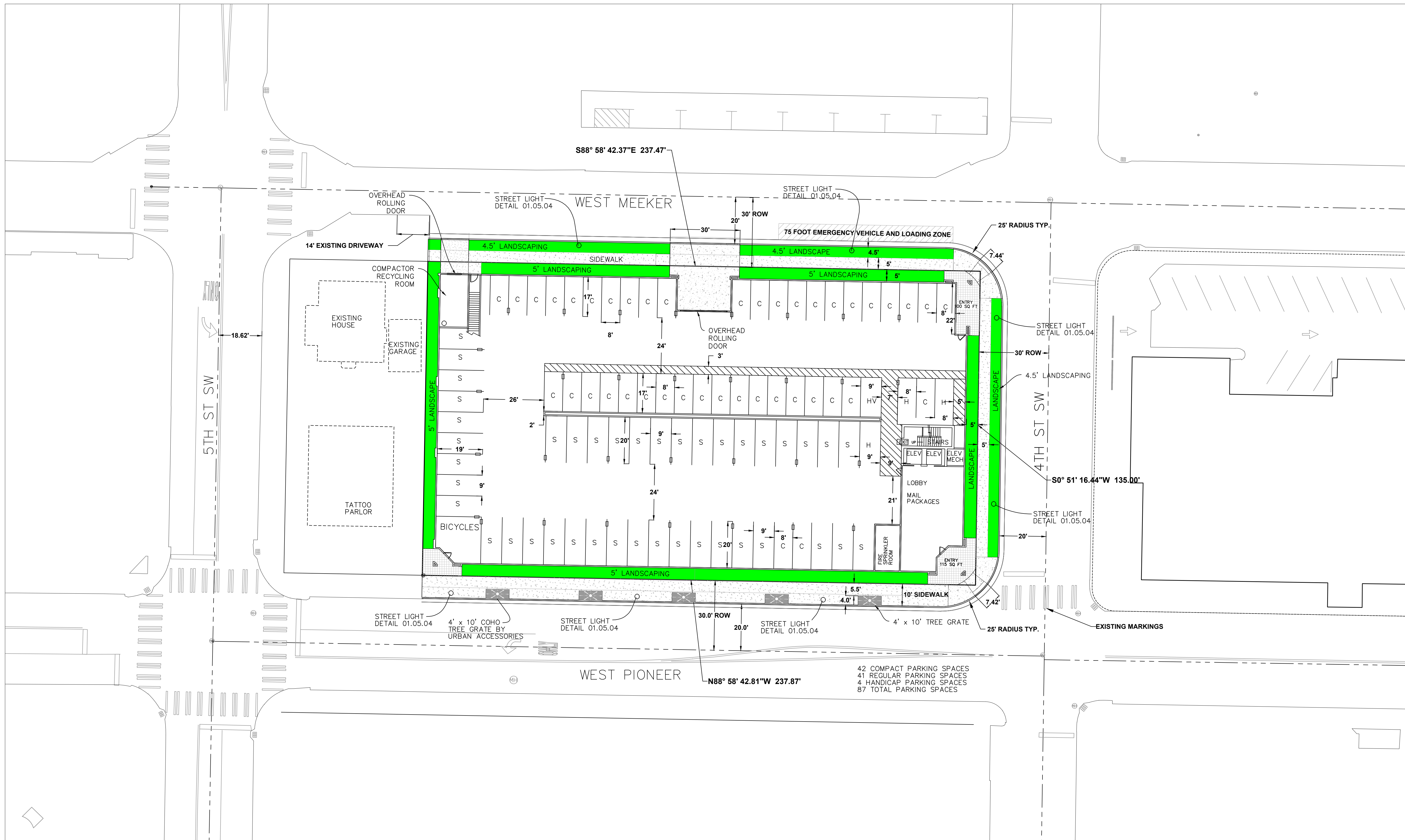
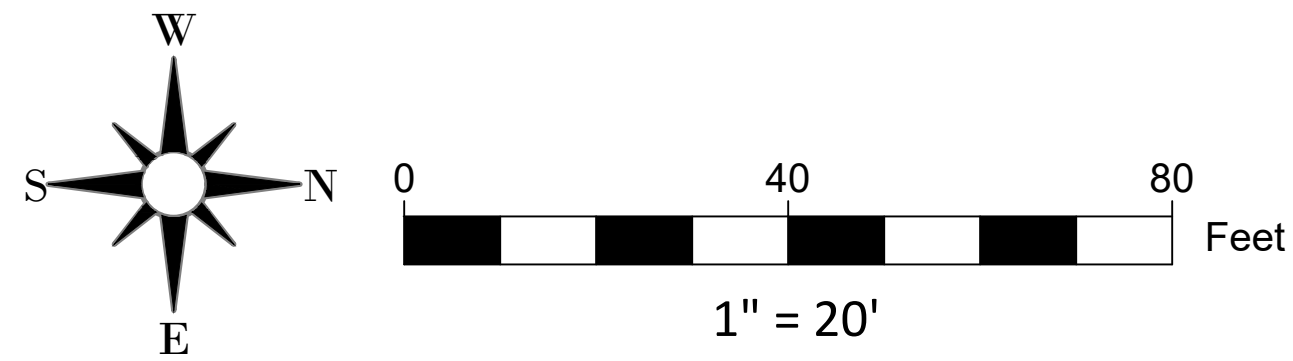

42 COMPACT PARKING SPACES
41 REGULAR PARKING SPACES
4 HANDICAP PARKING SPACES
87 TOTAL PARKING SPACES



NO.	REVISION	DATE
1		
2		
3		
4		
5		
6		
7		
8		
9		
10		

JOB NO.	3856
DATE	12/19/2021
DESIGNED BY/PEEG	BRAUN BY TREVOR GREEN
CHECKED BY/JUN. JOB	
APPROVED BY/PAUL GREEN	

AZURE GREEN
CONSULTANTS

+ feasibility + planning + engineering + surveying

409 East Pioneer, Suite A - Puyallup, WA 98372 phone: 253.770.3144 / fax: 253.770.3142

Parking Floor Dimensions

Bell Property

Azure Green Consultants
409 East Pioneer, Puyallup WA, 98372
Phone 253.770.3144

DRAWING
S1
SHEET 1
OF 1

Project Desc: ### C:\Users\trevor\OneDrive\AzureGreen\Dropbox\WCS\Jen\3340 Bell\Bell_Vello_02122024.dwg Plot Date/Time: 2/12/2024 4:32 PM