

# City of Puyallup Traffic Scoping Worksheet

## PROJECT INFORMATION

Project Title: SHAO RESIDENCE Date: Mar 22, 2024

Applicant Name: Mingqi Shao Telephone Number: 425-403-9149

Project Description: Short Plat Year of Occupancy: \_\_\_\_\_

Project Location: 2317 Shaw Rd, Puyallup, WA Parcel Size: 71,002 sf (1.63 ac)

Proposed Number of Access Point(s): 3 Existing Number of Access Point(s): 1

Land Use	Quantity	ITE Land Use Code	Average Daily Trips	AM Peak Hour Trips*	PM Peak Hour Trips*
Existing Use(s)					
SFDU	1	ITE LUC 210	9	0.7	0.9
Note: The existing home will remain on the site with parcel short plat					
Proposed Use(s)					
SFDU	3	ITE LUC 210	28	2.1	2.8
<b>Net New Trips</b>				2.1	2.8
<b>Traffic Impact Fees:</b> Net New PM Peak Hour Trips x \$4,500.00 = \$ <u>12,600</u>					

- \* The peak hour project trips shall be rounded to the nearest tenth.
- \* The project trips shall be estimated using the ITE's *Trip Generation*, 11<sup>th</sup> Edition.
- \* Trip generation regression equations shall be used when the R<sup>2</sup> value is 0.70 or greater.
- \* For land uses that do not exist within the ITE's *Trip Generation*, actual field data shall be collected from three local facilities that have similar characteristics to the proposal.
- \* For all single-family units and offices and specialty retail centers smaller than 30,000 SF, use ITE's *Trip Generation*, 11th Edition, average rate.

Identify all intersections that will be affected by 25 new project peak hour trips or more:

- |               |            |
|---------------|------------|
| 1. <u>n/a</u> | 4. <u></u> |
| 2. <u></u>    | 5. <u></u> |
| 3. <u></u>    | 6. <u></u> |
| 4. <u></u>    | 8. <u></u> |

Prepared by: Traffic Engineer: William Popp Telephone Number: 425-401-2124

Address: William Popp Associates; P.O. Box 3664, Bellevue, WA 98007

### Office Use Only

TIS ☐ TAS ☐ TAIS ☐ No Further Work Required ☐

Checklist (Please make sure you have included the following information):

- ☐ Completed Worksheet ☐ Attach Site Plan ☐ Attach Trip Assignment ☐ Attach Trip Distribution  
☐ Mail or hand deliver to 333 South Meridian, Puyallup, WA 98371 or e-mail to broberts@puyallupwa.gov

# SAMPLE – Site Plan Exhibit

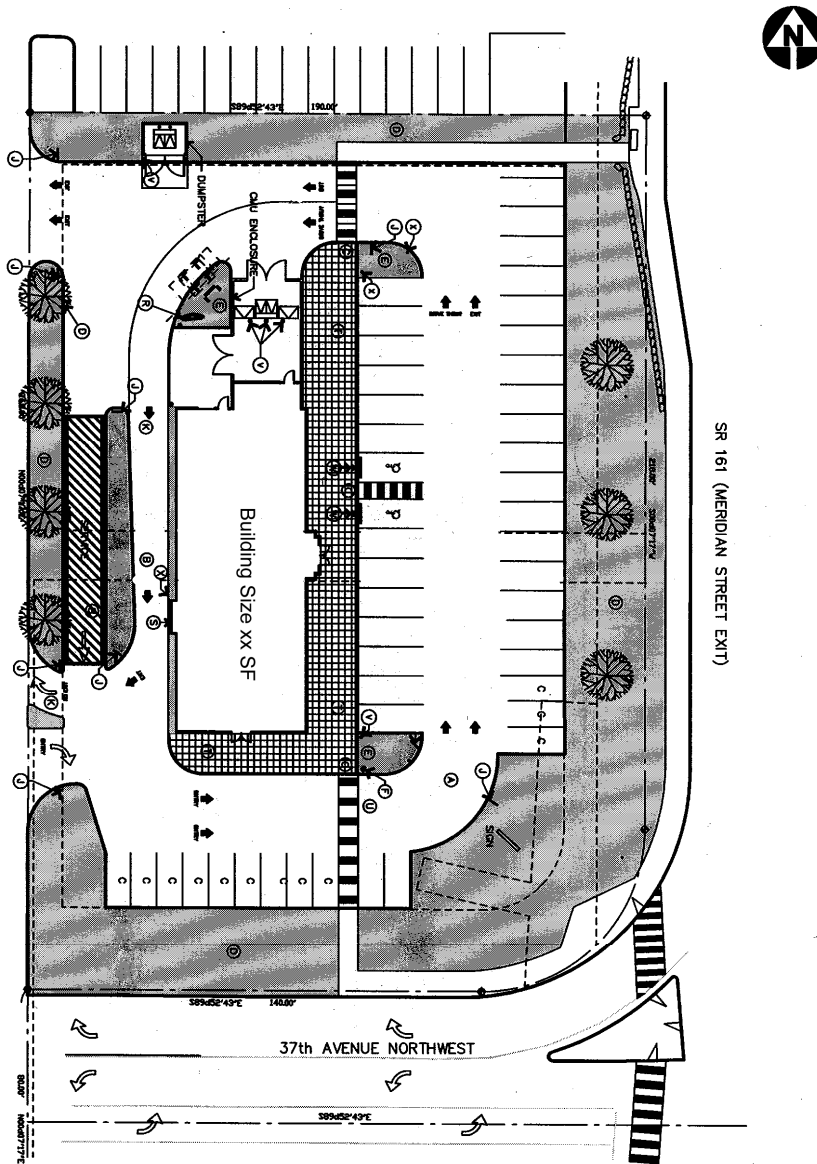

**Site Plan**

**Project Name:** \_\_\_\_\_

**Project Address:** \_\_\_\_\_

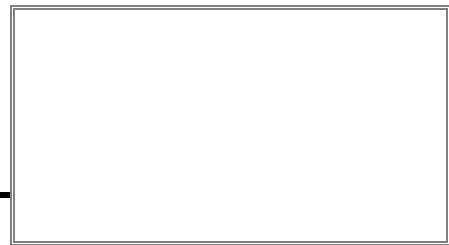

**Vicinity Map**

# SAMPLE – Trip Distribution Exhibit

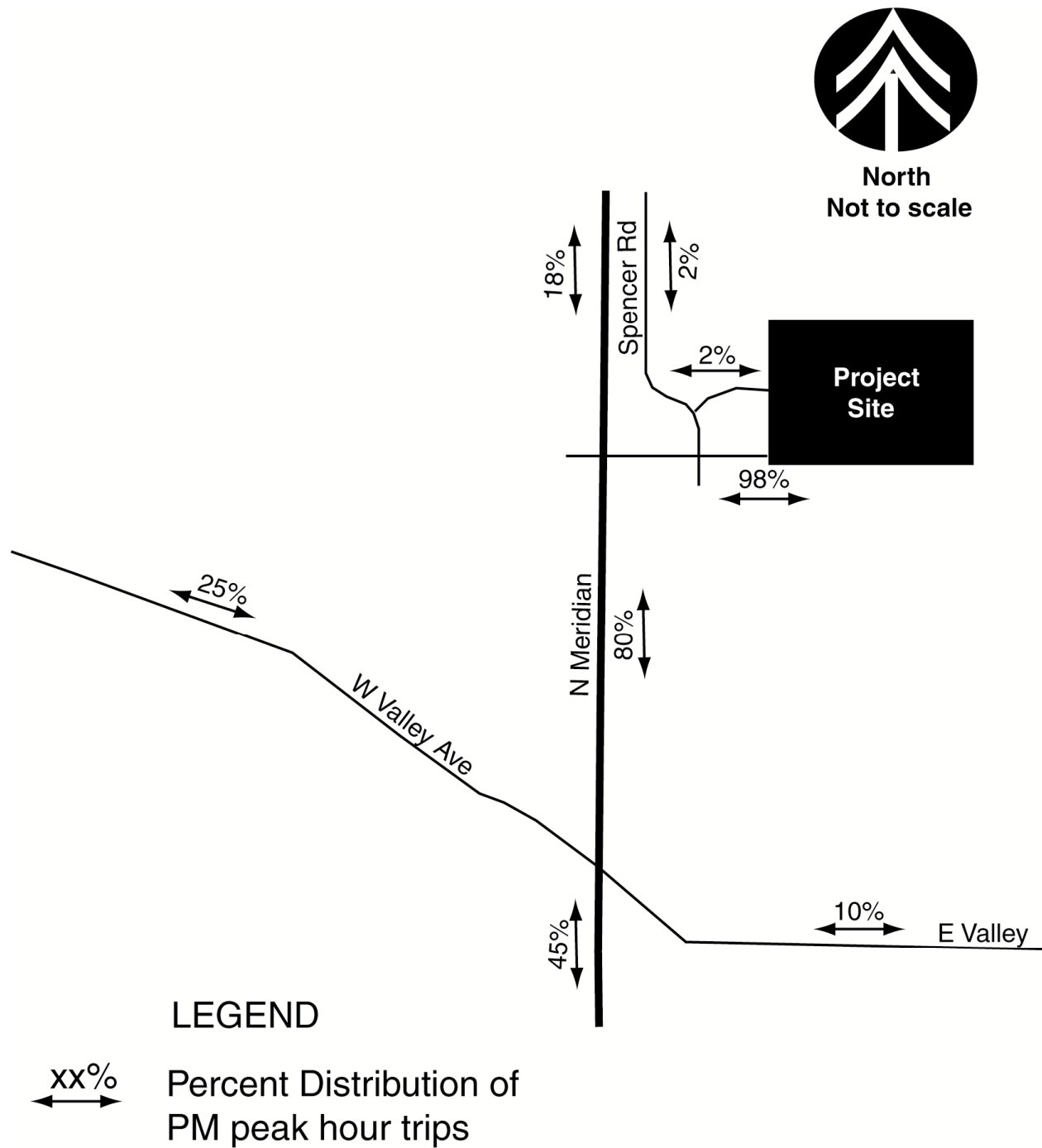

Note: Trips were distributed based on existing PM peak hour counts.

# SAMPLE – Trip Assignment Exhibit

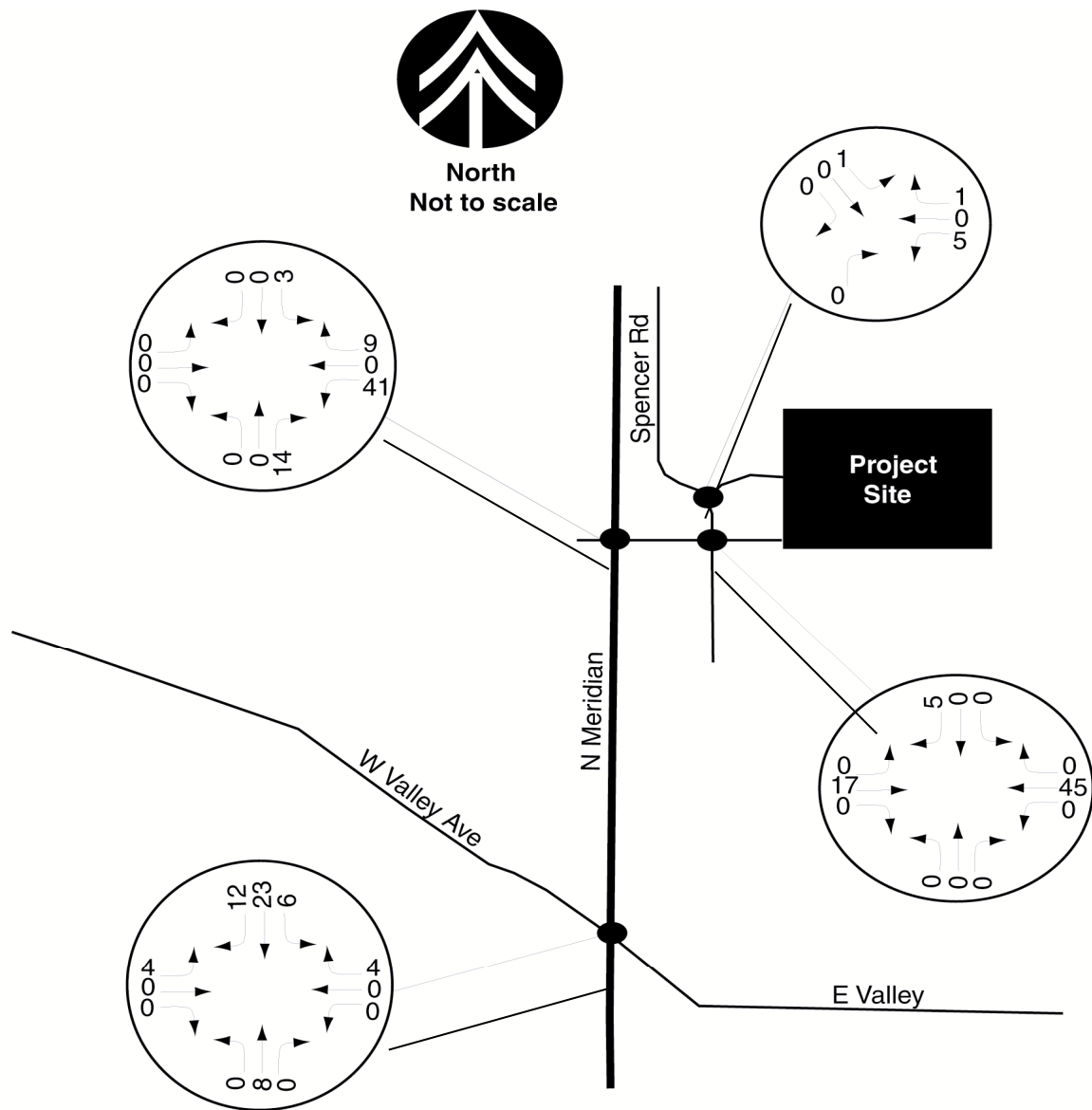

## LEGEND

xx → PM peak hour approach volume